

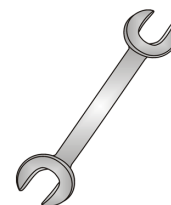

# Tow-Trust Towbars

Important: Please read General Notes overleaf before fitting



Issue 1

## TPUG15SN PEUGEOT 208 2012> / CITROEN C3 2017>

Item	Qty	Description	Item	Qty	Description
A	1	TPUG15 Crossmember	E	2	M12 x 110 Grade 10.9 Bolts & Nyloc Nuts
B	2	Handed Side Arms	F	12	M10 x 35 Bolts, 6 Nyloc Nuts & 6 S/P Washers
C	2	Angle Brackets	G	2	15mm Spacer Plates
D	1	ACS1 / 9201 Swan Neck	H	4	M10 Small Metal Cage Nuts
			J	14	10 x 25 Flat Washers
			K	4	12 x 25 Flat Washers
			L	1	VASP8 L/H Socket Plate

### TOWBAR INSTALLATION:

1. Remove two fixings securing the bumper lower edge.
2. Locate Towbar mounting points on the lower and outside face of each chassis member, these are usually covered with tape.
3. Insert Items H through the square access point in the side face of each chassis member and line up the Towbar mounting point.
4. Using Item F with Item J fix Items B to each chassis member.
5. Using Item F with Item J fix Item C to the lower face of each chassis member and Item B.
6. Using Item F with Item J fix Item A between each side arm.
7. Using Item E with Item K and Item G fix Item D and Item L to Item A.
8. Fully tighten all fixings ensuring the Towbar is rigid, square and secure.
9. Secure bumper lower edge with original fixings.

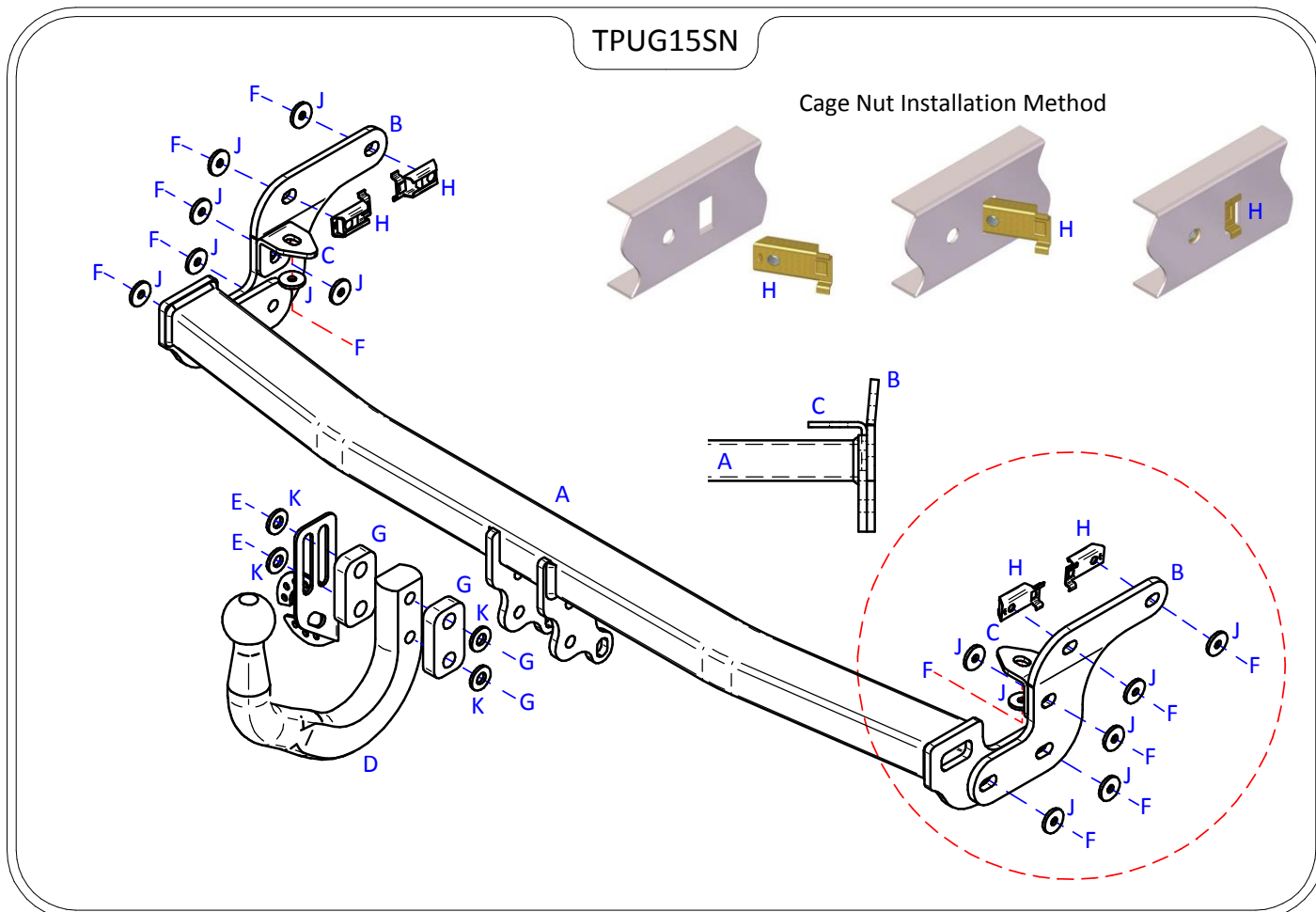

### Note:

1. Recommended Torque Setting for M12 Grade 10.9 -139 Nm. (For other Torque Settings see notes overleaf.)
2. Nose load limits and vehicle manufacturers trailer / caravan weight limits must be observed.