

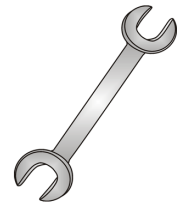

Tow-Trust Towbars

Important: Please read General Notes overleaf before fitting



Issue 2

TM15VK MERCEDES A CLASS (W176) / B CLASS (W246) / CLA Inc. SHOOTING BRAKE

Item	Qty	Description	Item	Qty	Description
A	1	Crossmember	D	1	Flip Up Socket Plate (TTFP/RH)
B	2	Handed Side Arms	E	8	M10 x 35 (10.9) & Nyloc Nuts
C	1	6202 Detachable Neck	F	6	M12 x 35 Bolts, 2 Nuts & 6 S/P Washers
			G	2	M12 x 25 Bolts & S/P Washers
			H	2	M12 x 25 Bolts & S/P Washers
			J	16	10 x 30 Flat Washers
			K	6	12 x 30 Flat Washers
			L	4	12 x 25 Flat Washers

BUMPER REMOVAL:

1. All models: Remove the boot interior trim.
2. All models: Remove the rear light clusters. Remove the rear bumper, two fixings found in each wheel arch, one tip fixing either side. A Class / B Class: three fixings along lower edge. CLA: five fixings along lower edge, peel back carpet to reveal 2 more fixings. All models: Two fixings through the rear panel found inside the vehicle.
3. Carefully release bumper tips from the vehicle then pull bumper rearwards.
4. Unclip any necessary wiring looms.
5. CLA only: Remove undertray to ease Towbar fitment.
6. All models: Remove the rear impact beam from the rear panel. (Impact beam is not refitted with the Towbar assembly)

TOWBAR INSTALLATION:

1. Using Item E with Item J fix Item A to the rear panel. (Always ensure the original gaskets are between Item A and the rear panel, we also advise an adequate sealant to be added around the Towbar and rear panel joints to stop water ingress).
2. Insert Items B through the Towbar end plates and secure to the outside face of each chassis member with Items F and Items K.
3. Using Items F and Item K fix Items B to Item A.
4. Using Item G with Item L and Item H with Item L fix Item C and Item D to Item A.
5. Fully tighten all fixings ensuring the Towbar is rigid, square and secure.
6. Refit the rear bumper, light clusters and boot interior trim. CLA only: Refit undertray.

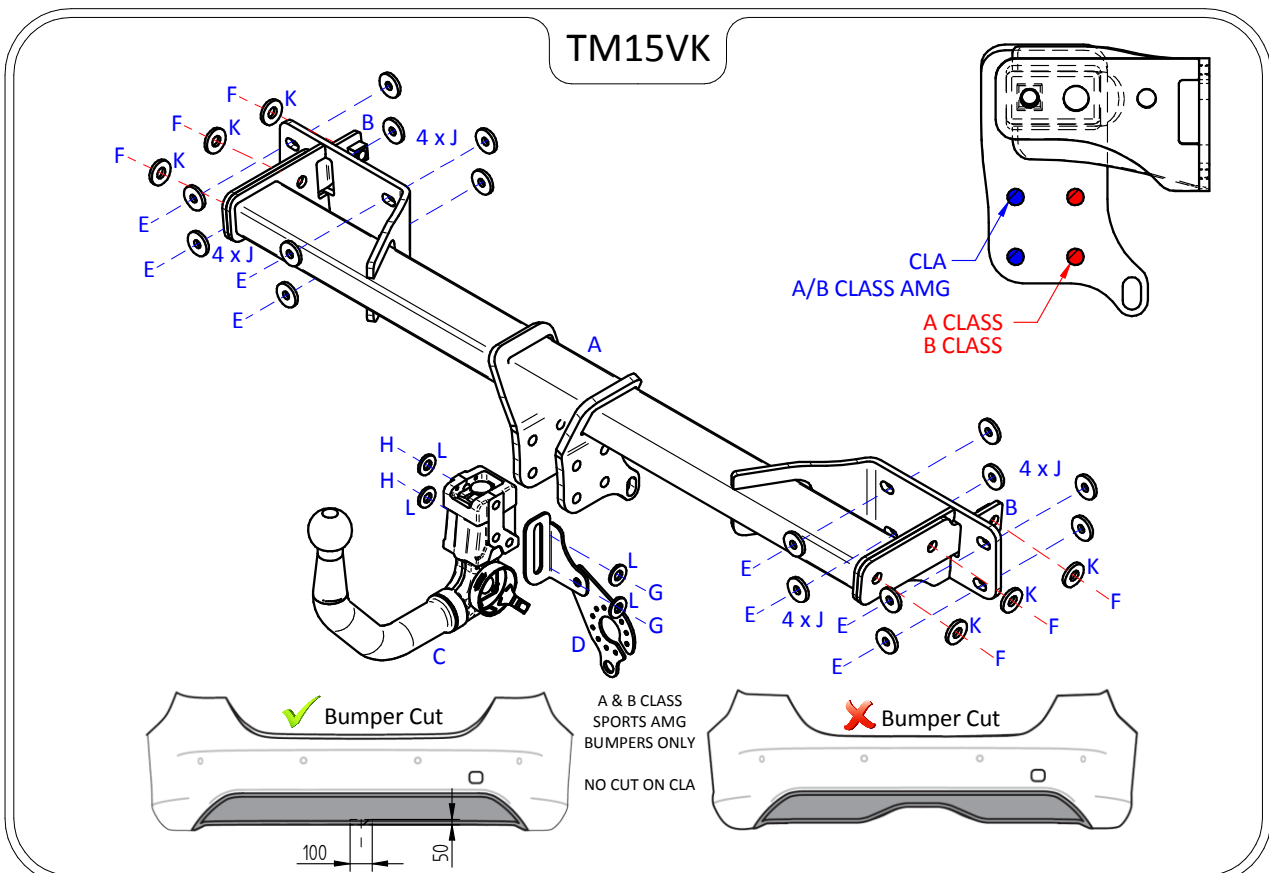

Note:

1. Recommended Torque Setting for M12 Grade 10.9 -139 Nm. (For other Torque Settings see notes overleaf.)
2. Nose load limits and vehicle manufacturers trailer / caravan weight limits must be observed.