



# Tow-Trust Towbars

Important: Please read General Notes overleaf before fitting



Issue 6

## TH1 Honda CR - V (No Spare Wheel on Rear Door) 2007 - 2012

Item	Qty	Description	Item	Qty	Description
A	1	Crossmember	F	2	M16 x 50 Bolts, Nuts & S/P Washers
B	1	Extension Bar	G	2	M12 x 85 Grade 10.9 Bolts & Nyloc Nuts
C	1	L/H Side Arm	H	4	M12 x 35 Bolts, 2 Nuts & 4 S/P Washers
D	1	R/H Side Arm	J	1	M16 x 80 Bolt, Nut & S/P Washer
E	2	40 x 12.5 Spacers	K	8	M10 x 40 x 1.25 Bolts & S/P Washers
			M	4	12 x 25 Flat Washers
			N	8	10 x 30 Flat Washers
			P	6	M12 Bolt Caps
			R	4	M16 Bolt Caps
			S	2	16 x 27 Flat Washers

1. Remove plastic under tray. Five fixings along lower edge, one fixing in left hand wheel arch and three fixings recessed centrally. (Under tray is not refitted with the towbar).
2. Lower the exhaust. (Support to prevent damage.)
3. Using Item K with Item N loosely bolt Item C and Item D to the existing captive nuts in the lower face of each chassis member.
4. Using Item H loosely bolt Item A to Item C and Item D.
5. Locate Item E around the central towing eye and using Item J with Item S bolt into place.
6. Using Item G with Item M bolt Item B to Item A.
7. Using Item F bolt the ball bracket and wiring plate (not supplied in this kit) to the mounting plate.
8. Fully tighten all nuts and bolts and ensure the towbar is rigid and secure.
9. Refit exhaust.
10. Replace bumper edge with the two existing plastic fixings.

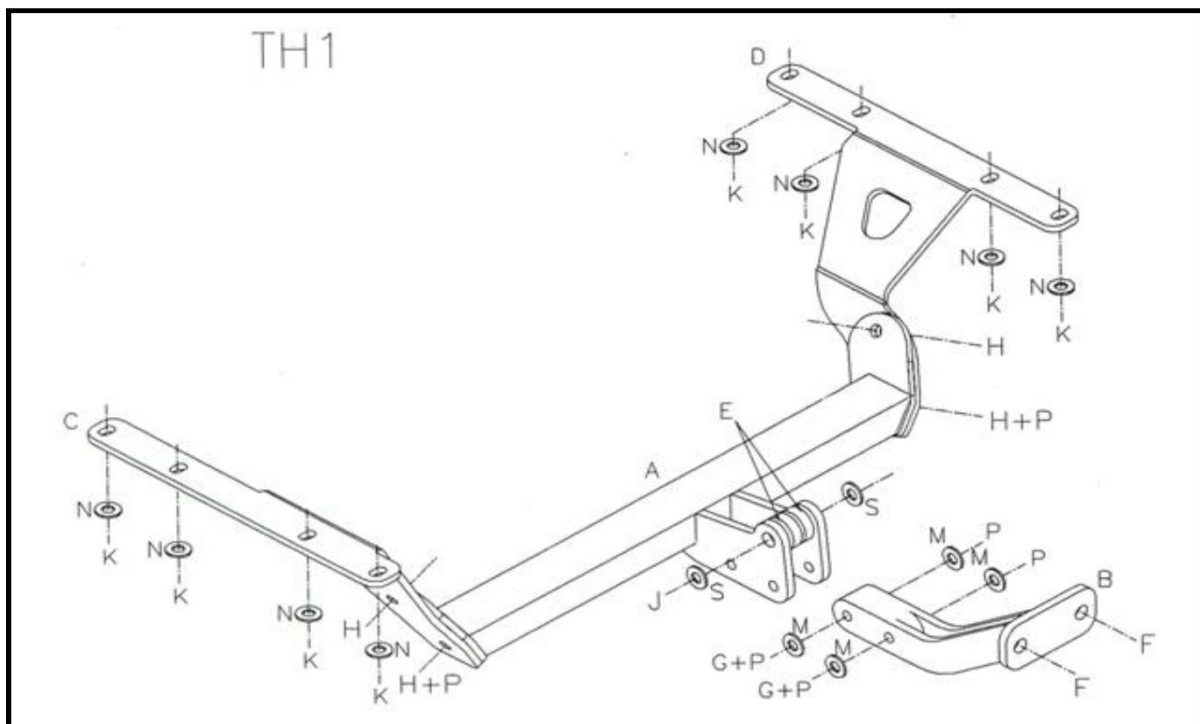

**Note:**

1. Recommended Torque Setting for M12 Grade 10.9 -139 Nm. (For other Torque Settings see notes overleaf.)
2. Nose load limits and vehicle manufacturers trailer / caravan weight limits must be observed.