

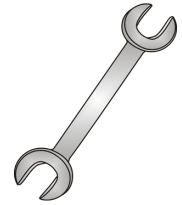

Tow-Trust Towbars

Important: Please read General Notes overleaf before fitting



Issue 4

TF178 Ford Mondeo Hatch / Saloon 2007>

| Item | Qty | Description | Item | Qty | Description |
|------|-----|------------------|------|-----|------------------------------------------|
| A | 1 | Crossmember | E | 2 | M16 x 50 Bolts, Nuts & S/P Washers |
| B | 2 | Handed Side Arms | F | 1 | M12 x 100 Grade 10.9 Bolts & Nyloc Nuts |
| C | 1 | Extension Bar | G | 6 | M12 x 40 Bolts, 4 Nuts & 6 S/P Washers |
| D | 2 | Nuts on Straps | H | 6 | M10 x 40 Grade 10.9 Bolts, & S/P Washers |
| | | | K | 4 | 12 x 25 Flat Washers |
| | | | L | 6 | 10 x 30 Flat Washers |
| | | | M | 2 | M12x40 Grade 10.9 Bolts & S/P Washers |

1. Remove rear bumper. Two fixings on lower edge, three fixings in wheel arch, two fixings on top edge. Pull bumper tips out from body clips.
2. Remove bumper beam. (This is not refitted with the towbar).
3. Lower rearmost exhaust box.
4. Remove heat shield.
5. Locate Item **B** into each chassis and using Item **H** with Item **L** loosely bolt into place. Locate Item **D** into each chassis and loosely bolt through remaining mounting point using Item **H** with Item **L**. Note: Mounting point holes for Hatch and Saloon are not the same (see sketch).
6. Using Item **G** bolt Item **A** to Item **B**.
7. Fully tighten all nuts and bolts and ensure the towbar is rigid and secure.
8. Refit heat shield, exhaust and bumper
9. Using Item **F** with Item **K** bolt Item **C** to Item **A**.
10. Using Item **E** bolt the ball bracket and wiring plate (not supplied in this kit) to the mounting plate.

NOTE: TITANIUM X (Silver Lower Edge): Bumper cut 87mm WIDE x 97mm DEEP.

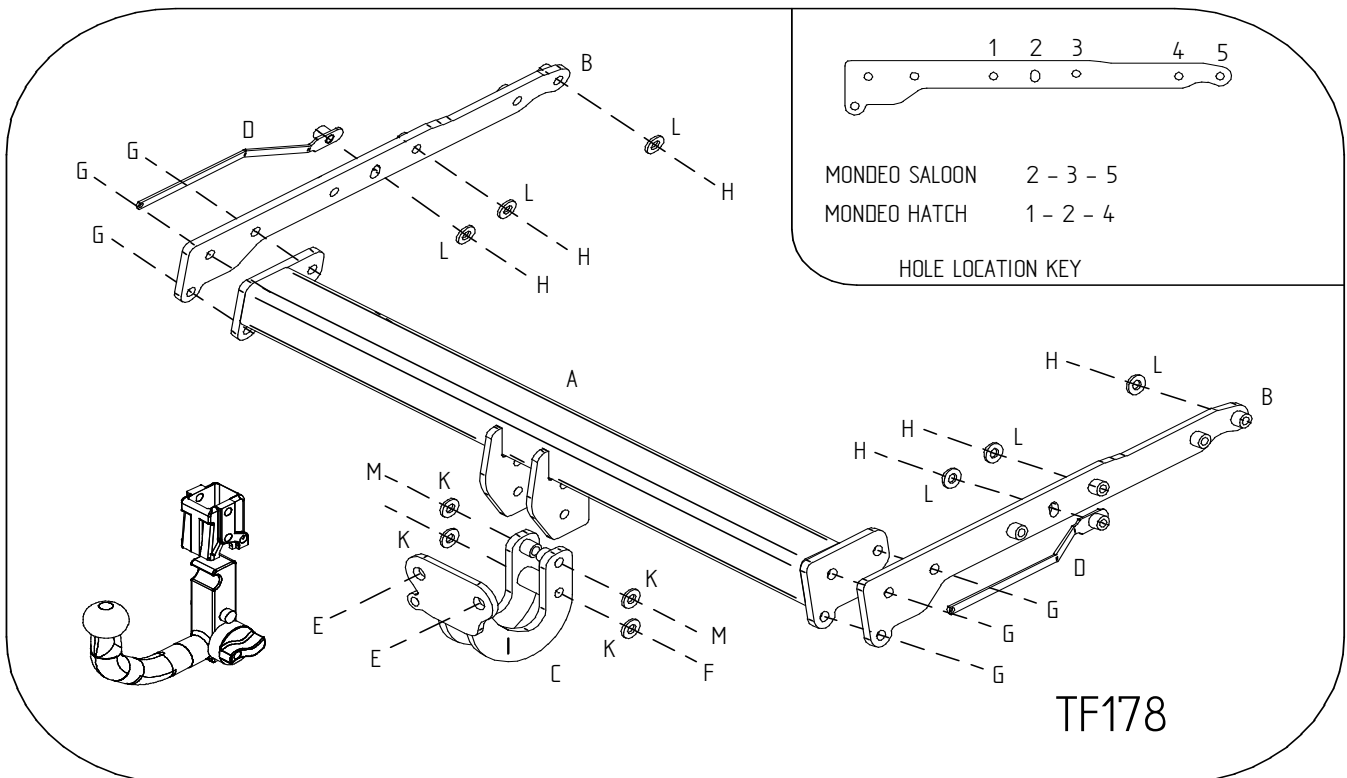

Note:

1. Recommended Torque Setting for M10Grade 10.9 -78 Nm M12 Grade 10.9 -139 Nm.
2. Nose load limits and vehicle manufacturers' trailer / caravan weight limits must be observed.