

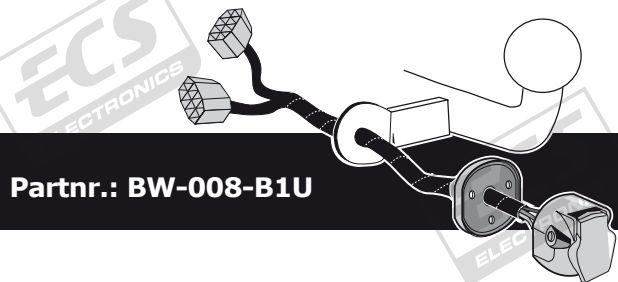

- **BMW 1 Series E81, E82, E87, E88**
- **BMW 1 Series F20, F21 (without PDC cut off function)**
- **BMW 3 Series E90, E91, E92, E93**
- **BMW 3 Series F30, F31, F34 (without PDC cut off function)**
- **BMW 5 Series E60, E61, F07, F10, F11** (for RHD see next page)
- **BMW 7 Series E65, E66, F01, F02**
- **BMW X1 Series E84**
- **BMW X3 Series F25 (without PDC cut off function)**
- **BMW X5 Series E70**
- **BMW X6 Series E71**

This kit doesn't cut off Park Assist , if applicable



Partnr.: BW-008-B1U

- Fitting instructions electric wiring kit tow bar with 12-N socket up to DIN/ISO Norm 1724.
- We would expressly point out that assembly not carried out properly by a competent installer will result in cancellation of any right to damage compensation, in particular those arising by virtue of the product liability act.
- Contents of these kits and their fitting manuals are subject to alteration without notice, please ensure that these instructions are read and fully understood before commencing installation.
- Do not overload circuits; the maximum loads per connection are detailed in this manual.
- Attention! Before Installation, please read this manual carefully and inform your customer to consult the vehicle owners manual to check for any vehicle modifications required before towing.
- In the event of functional problems, troubleshooting must be limited to about 0.5 hours, contact the technical support:
t.skinner@ecs-electronics.com / 07440 202 052.



Right Hand Drive (RHD)

Installation Supplement Instructions

Updated: 06/06/2013

For RHD installation instruction please note the following:

For the BMW 5 (F10 and F11) series connect the CANbus on the off-side (Driver's side) of the dashboard.

Note: There are CAN wires on the passenger side behind the glove box but these do not carry the towbar roadlighting signals.

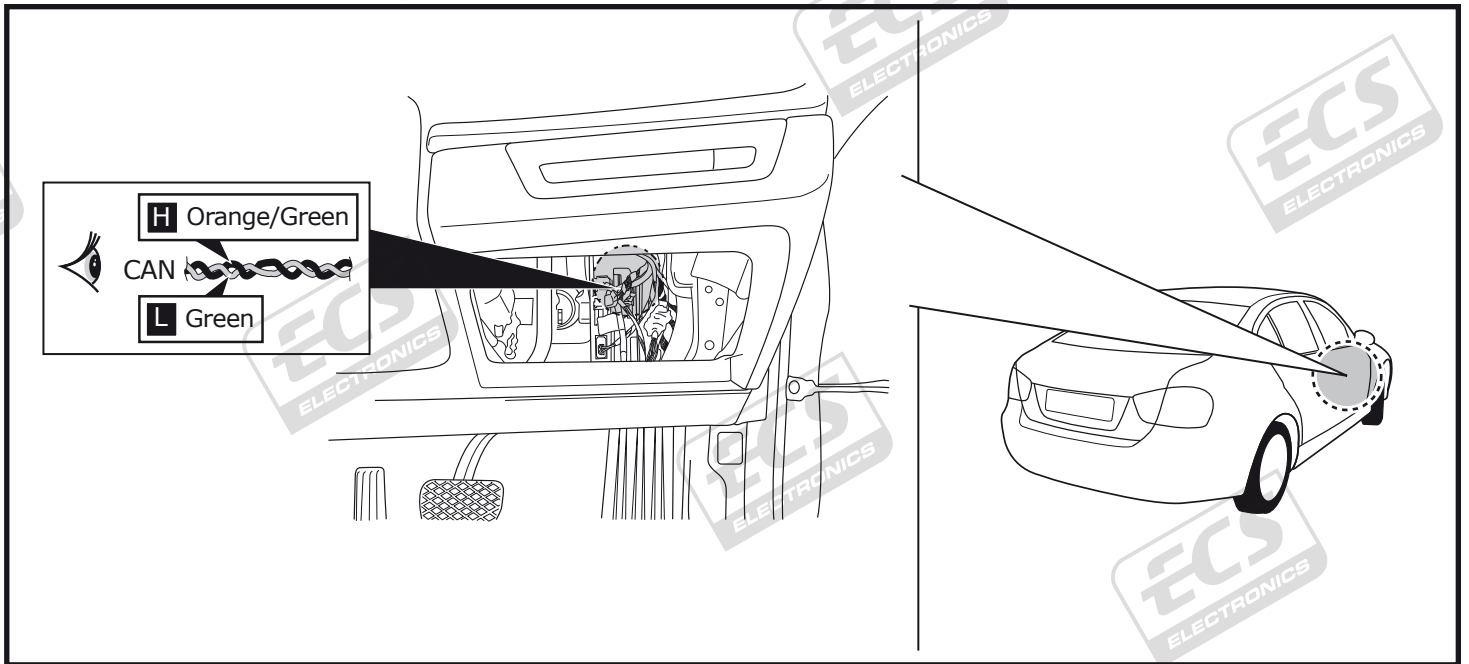

Part list

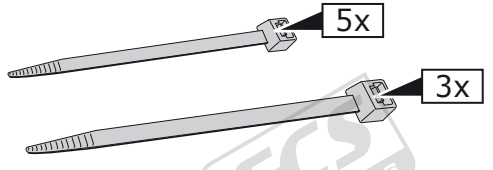
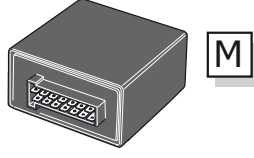
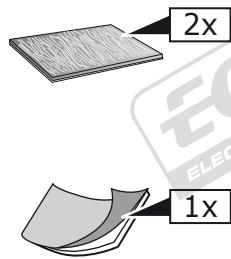
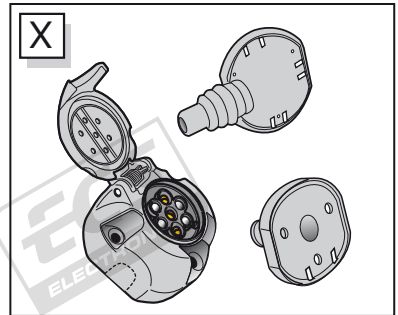
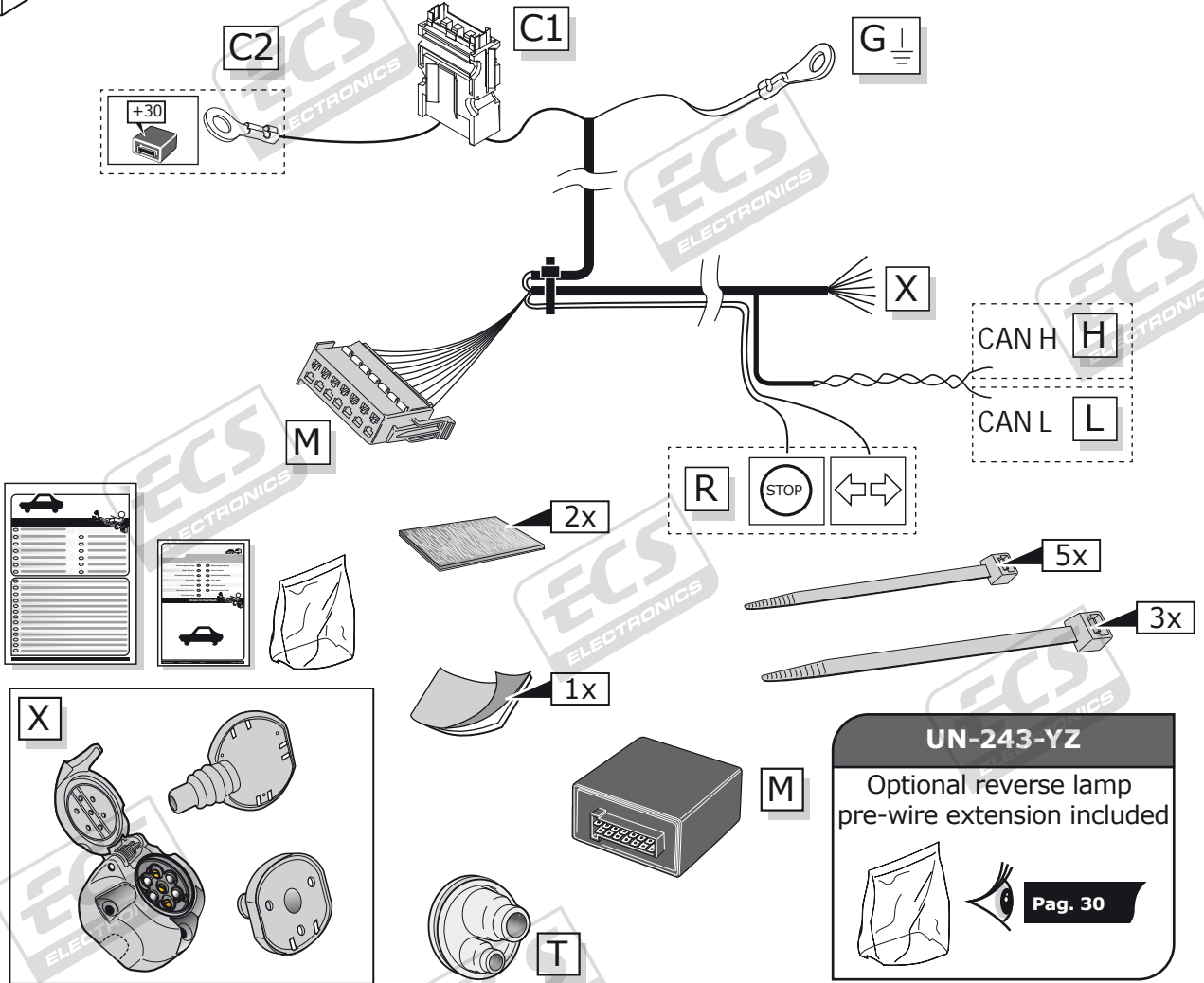
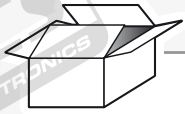

UN-243-YZ
 Optional reverse lamp pre-wire extension included

Pag. 30

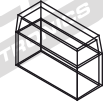
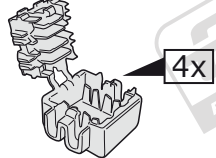
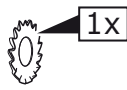
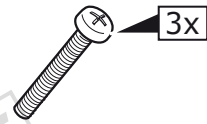

INFO

FIRST INQUIRE AT THE DEALER IF AN EXPANSION SET FOR A TOWING HOOK PLUS HEAT INSULATION (IN CONNECTION WITH COOLING) APPLIES TO YOUR VEHICLE.

INFO

BMW 5 Series F10, F11
BMW 7 Series F01, F02



Pag. 5

BMW X3 Series F25



Pag. 8

BMW 1 Series E81, E82, E87, E88
BMW 3 Series E90, E91, E92, E93
BMW 5 Series E60, E61, F07
BMW 7 Series E65, E66
BMW X1 Series E84
BMW X5 Series E70
BMW X6 Series E71

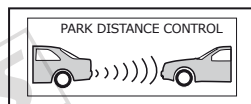

Pag. 11

BMW 5 Series E60, E61, F07
BMW 7 Series E65, E66
BMW X1 Series E84
BMW X5 Series E70
BMW X6 Series E71

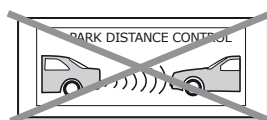

Pag. 14

BMW 1 Series E81, E82, E87, E88
BMW 3 Series E90, E91, E92, E93

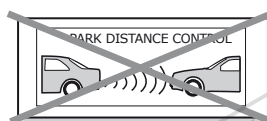

Pag. 17

BMW 1 Series F20, F21



Pag. 20

BMW 3 Series F30, F31, F34



Pag. 23

BMW 5 Series F10, F11
BMW 7 Series F01, F02

ROUTING

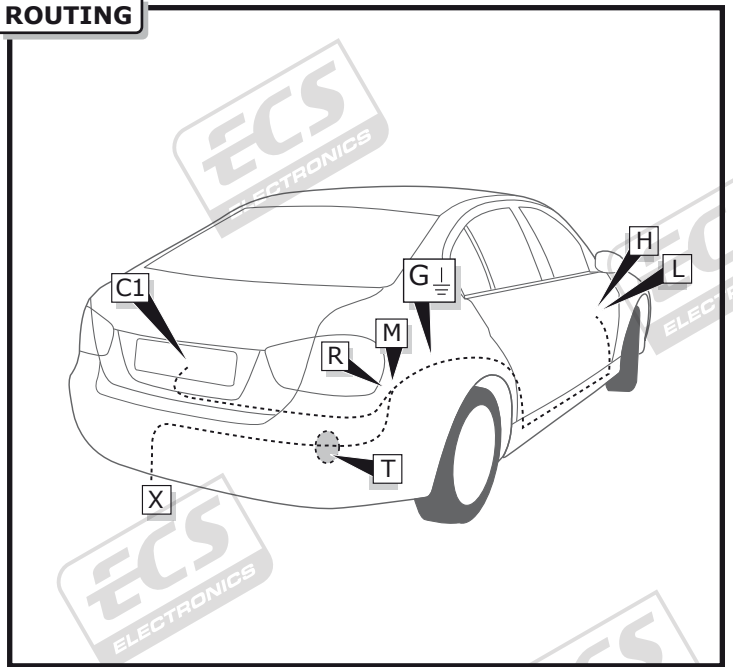

1

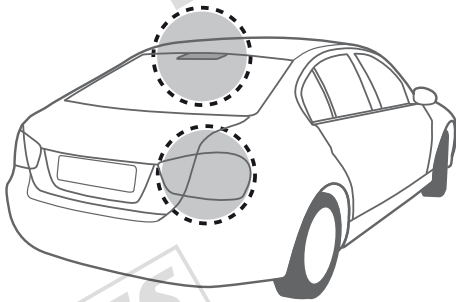
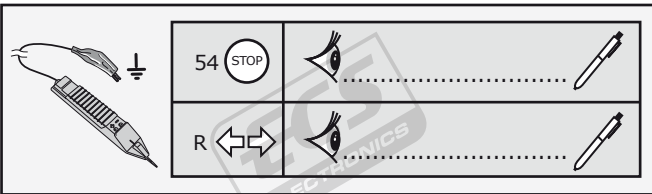

2

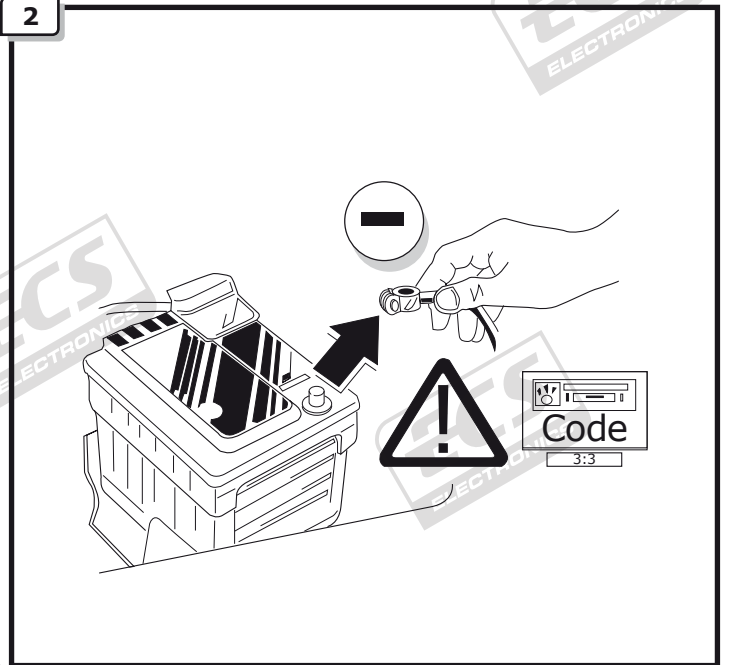

3

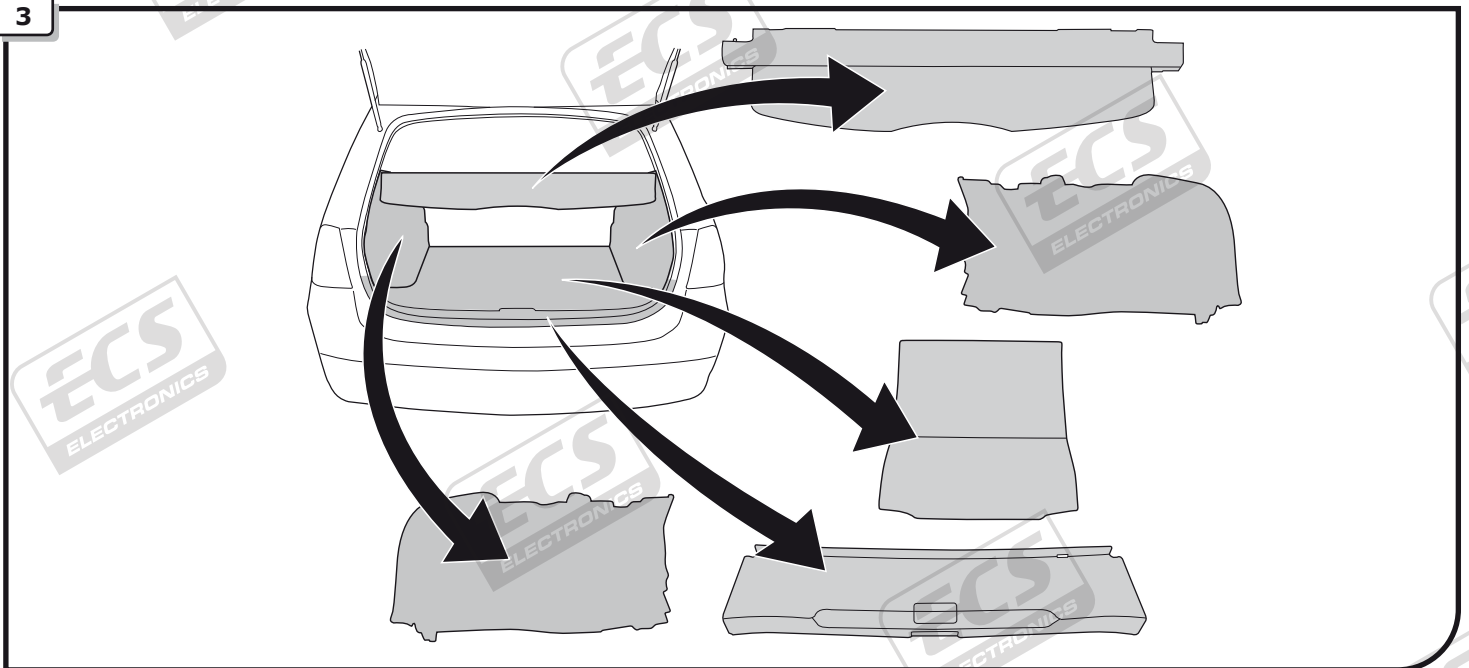

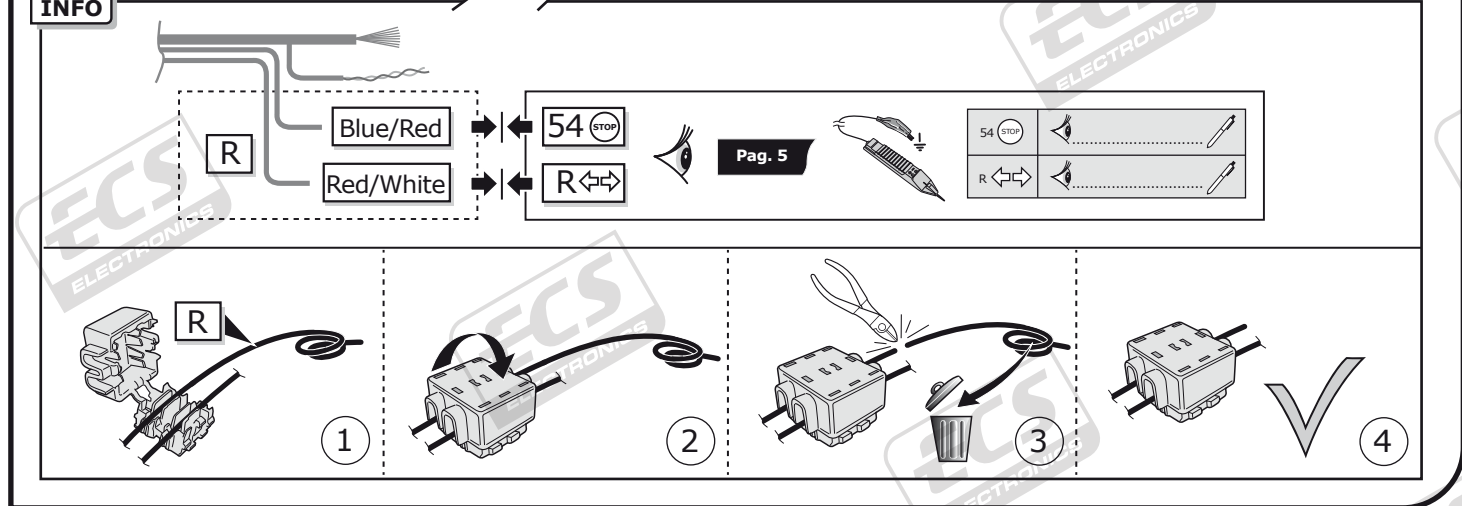
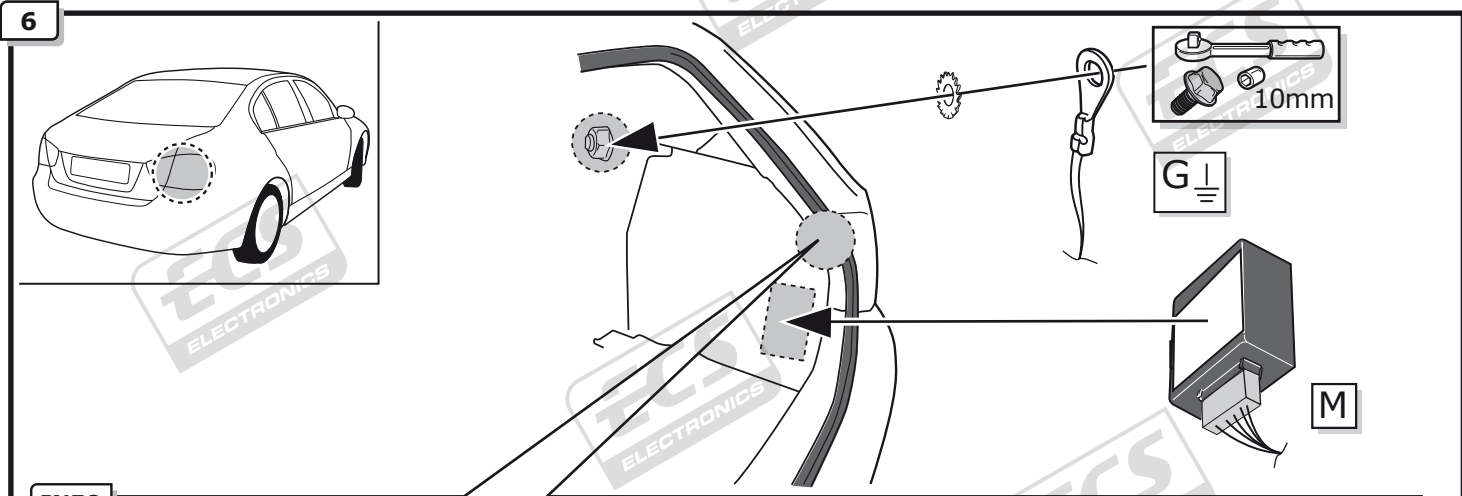
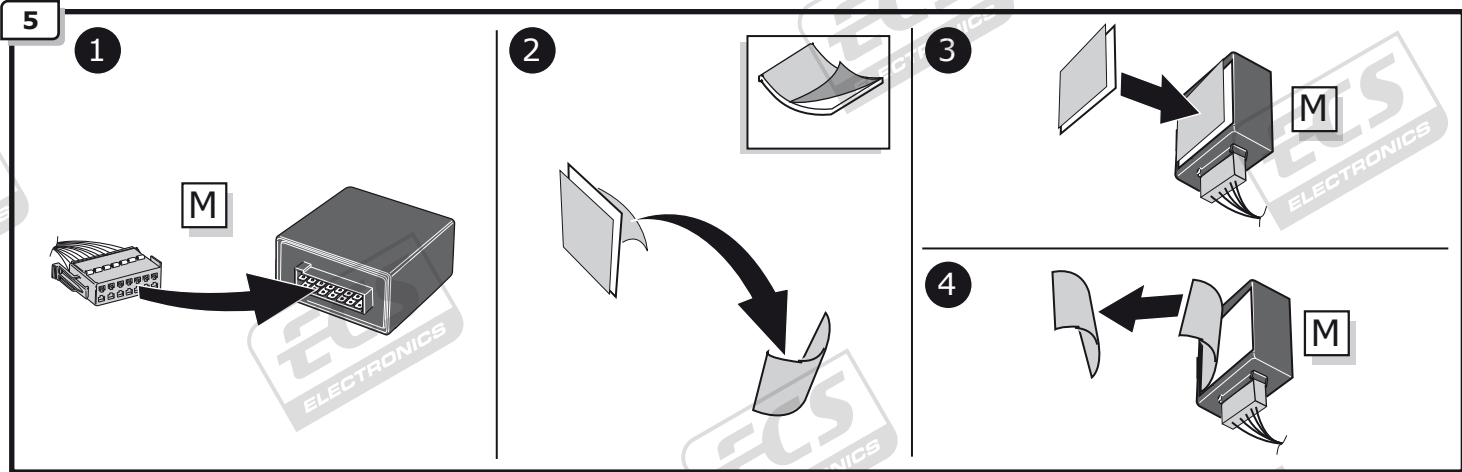
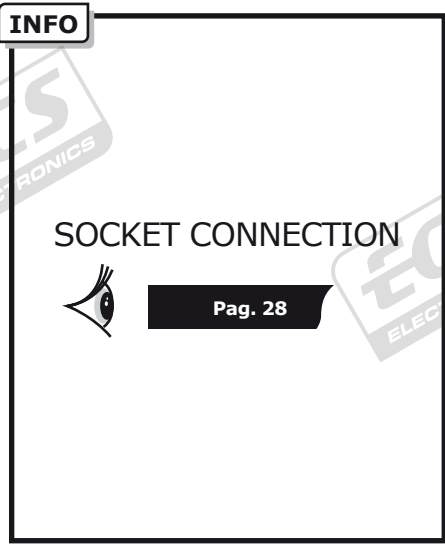
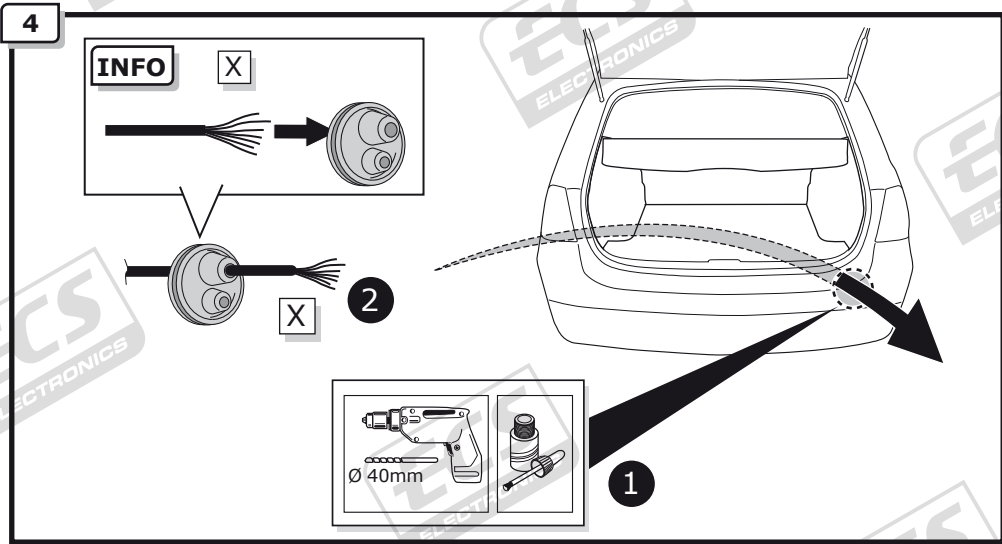

7

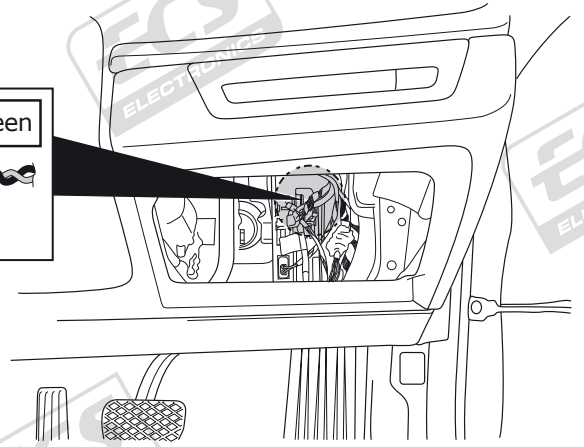
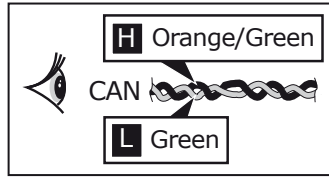
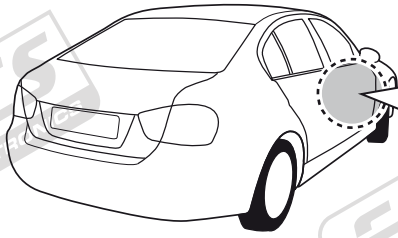

8

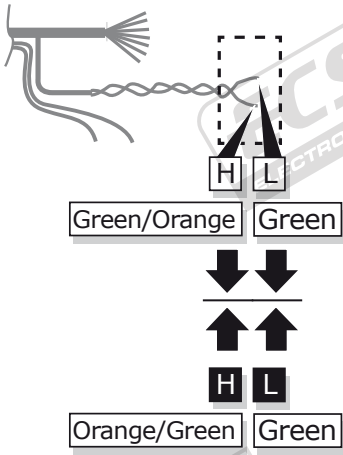

<p>INFO</p>		

9



Pag. 26

BMW X3 Series F25

ROUTING

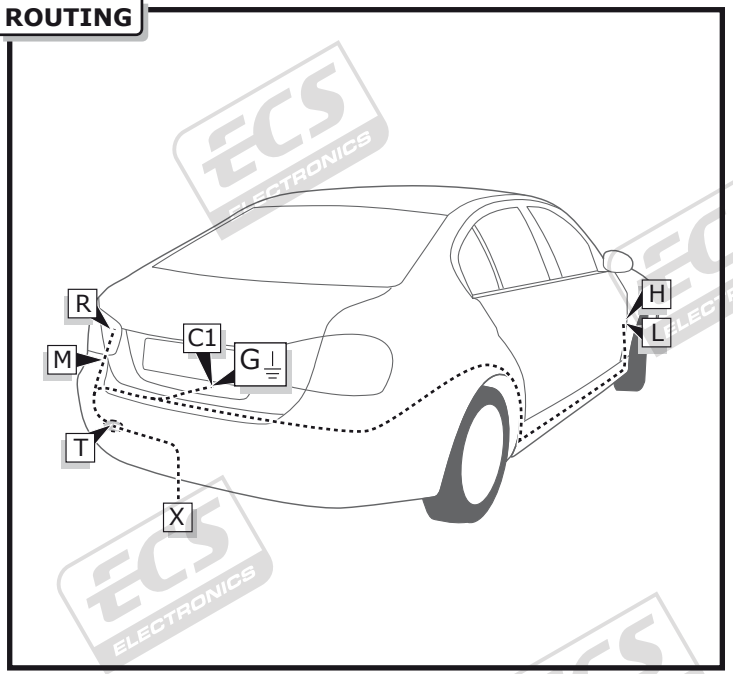

10

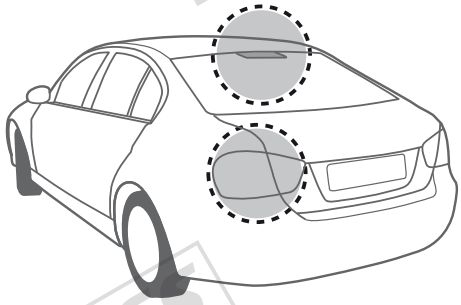
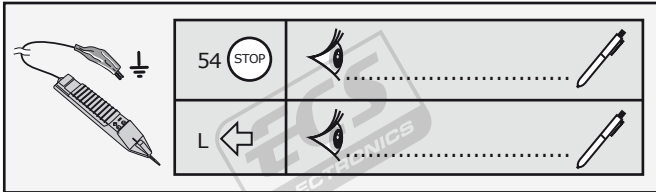

11

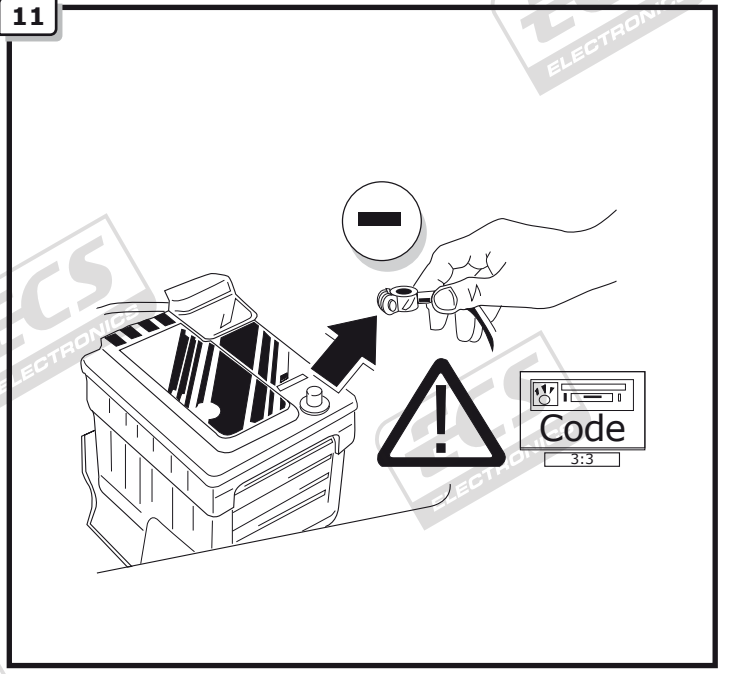

12

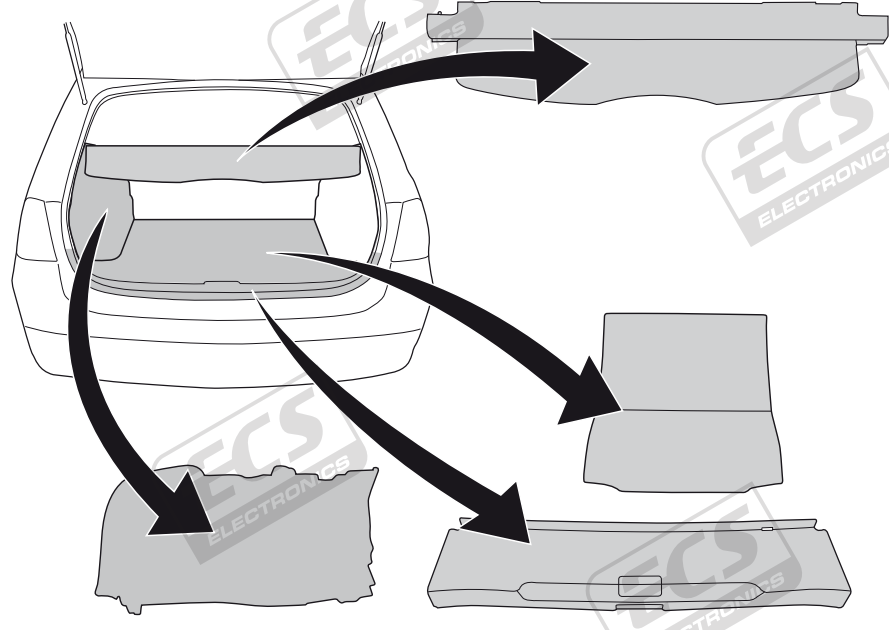

13

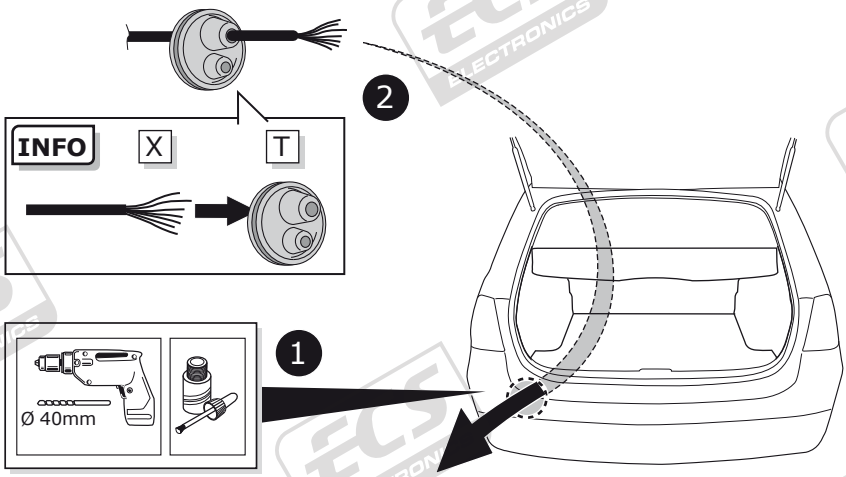

INFO

SOCKET CONNECTION



Pag. 28

14

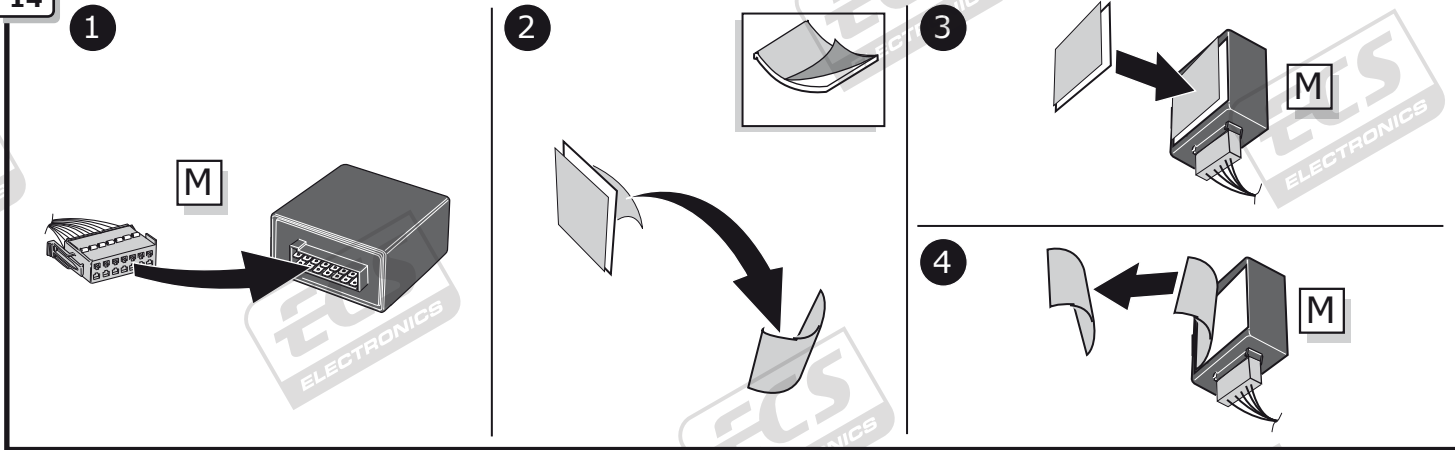

15

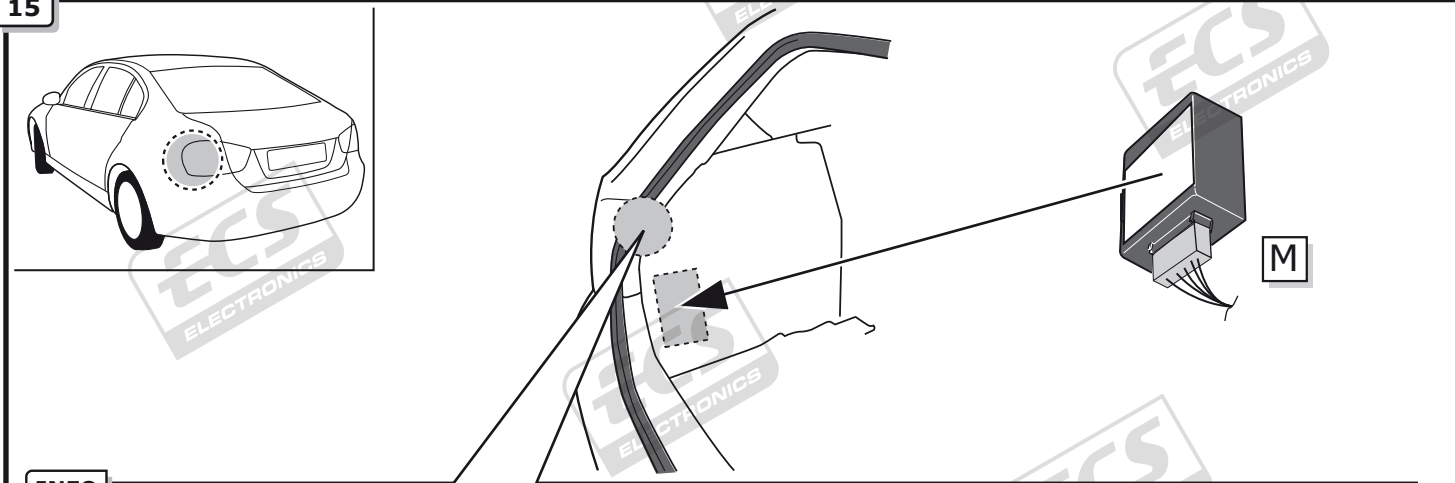

INFO

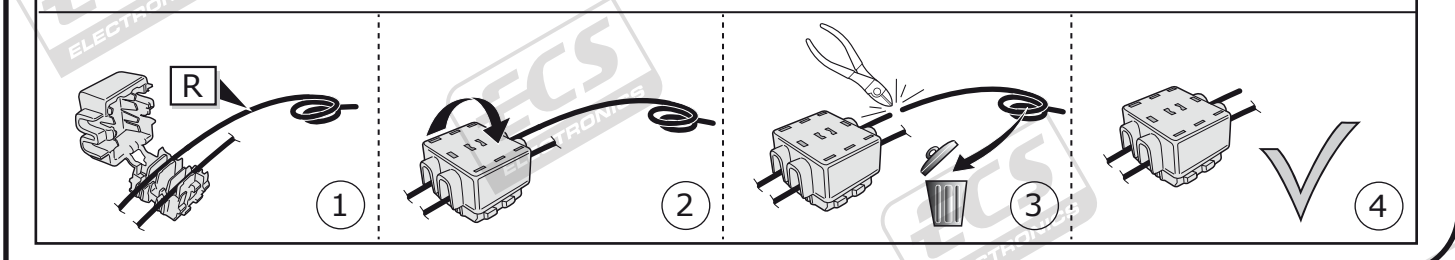
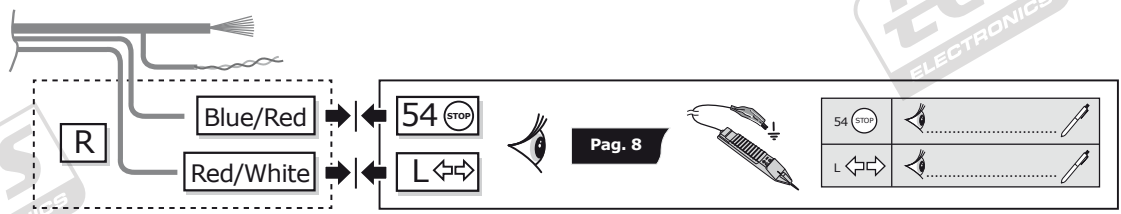

16

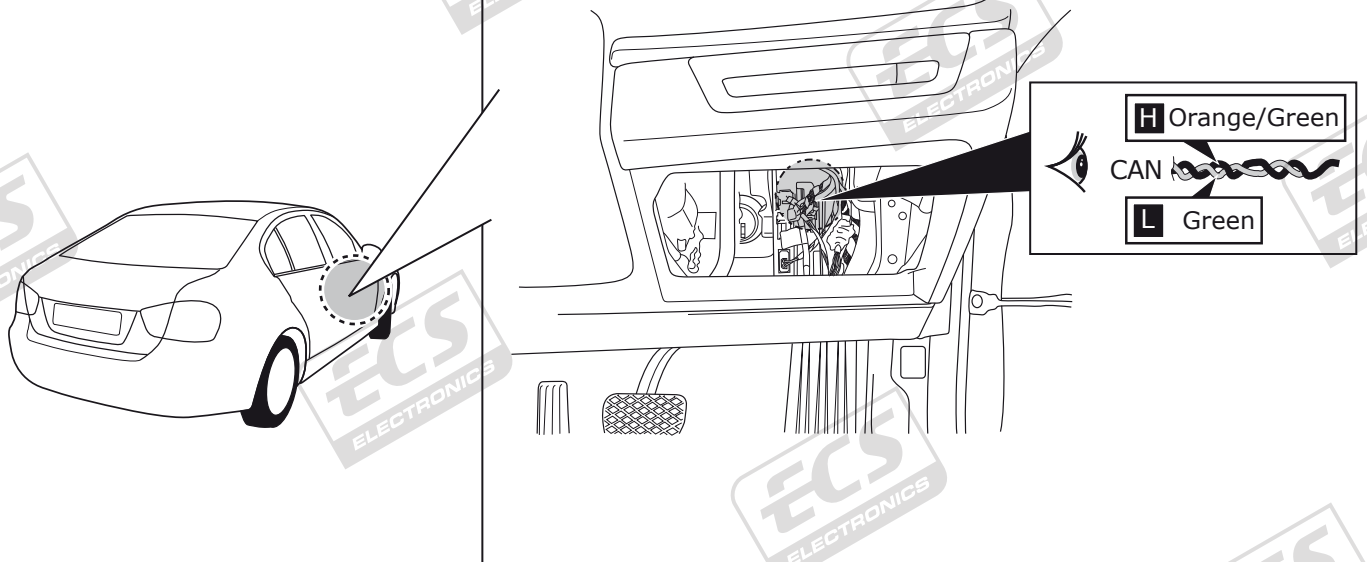

17

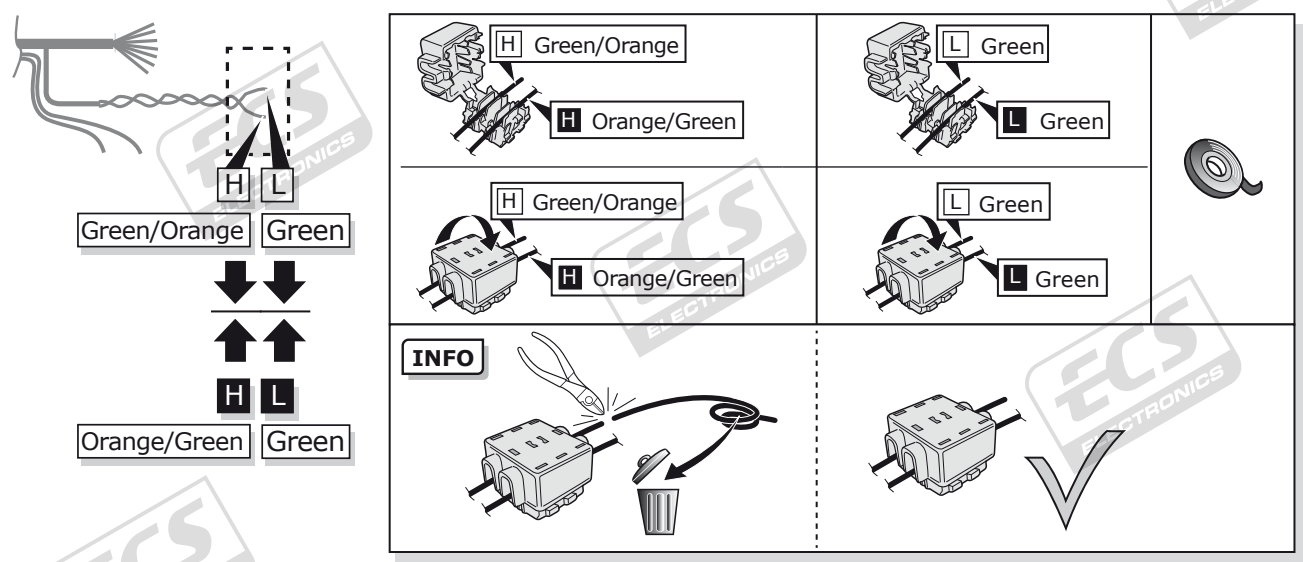

18

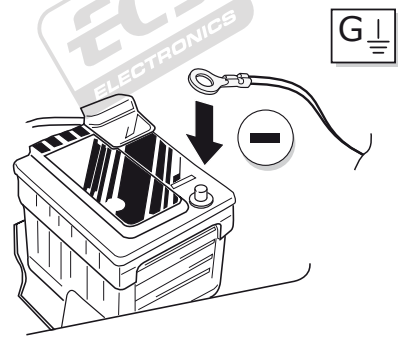

19



BMW 1 Series E81, E82, E87, E88
BMW 3 Series E90, E91, E92, E93
BMW 5 Series E60, E61, F07
BMW 7 Series E65, E66
BMW X1 Series E84
BMW X5 Series E70
BMW X6 Series E71

ROUTING

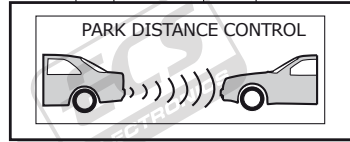
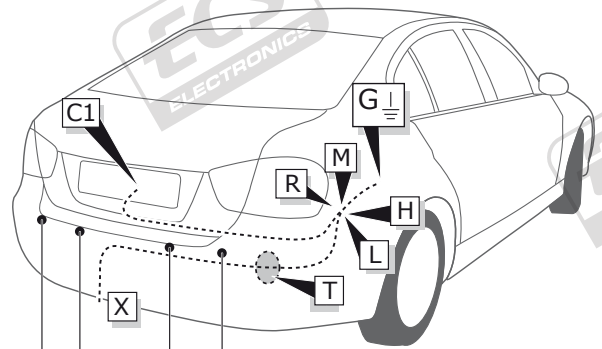

20

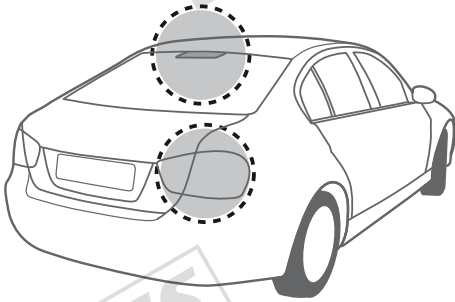
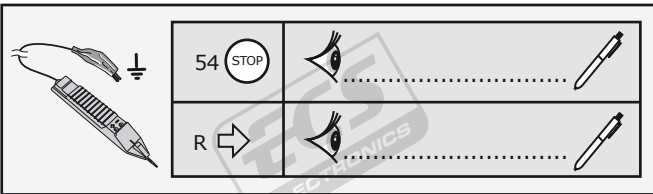

21

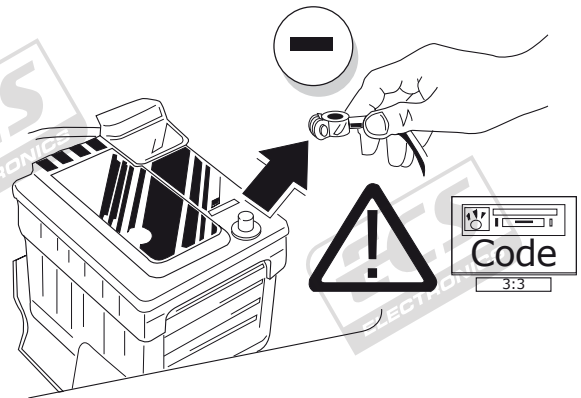

22

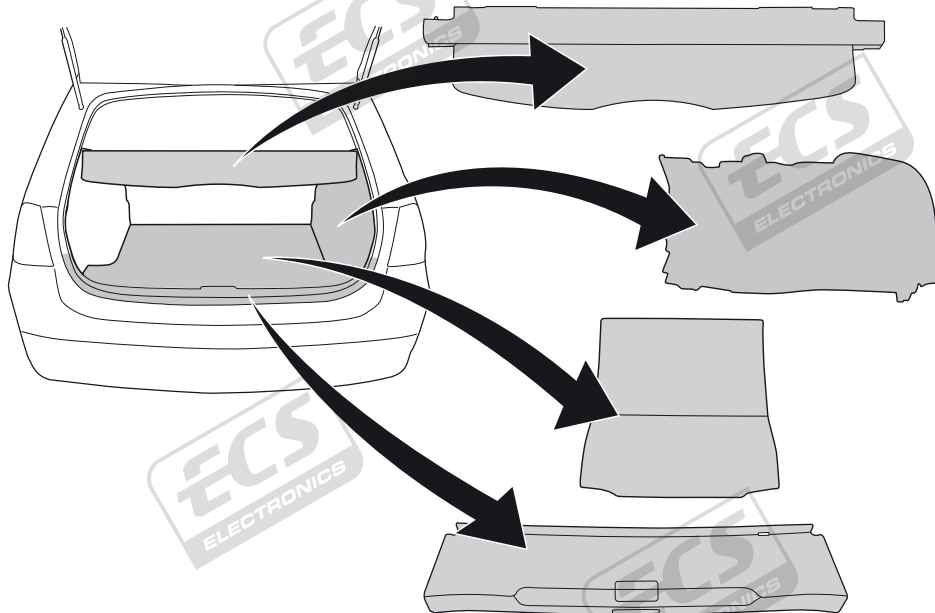

23

INFO

X



2

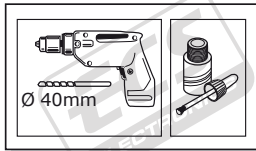

1

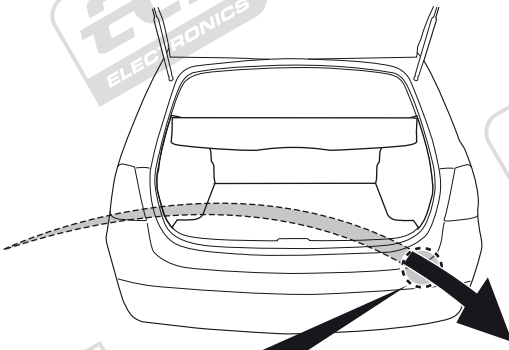

INFO

SOCKET CONNECTION



Pag. 28

24

1

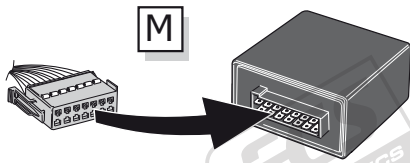

2

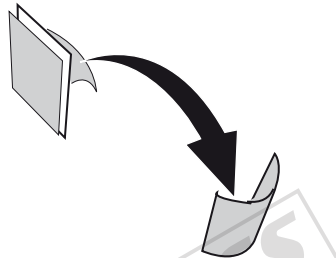

3

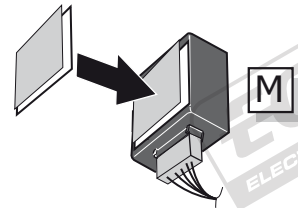

4

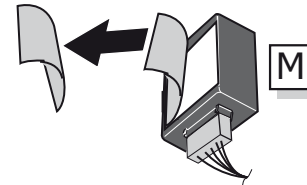

25

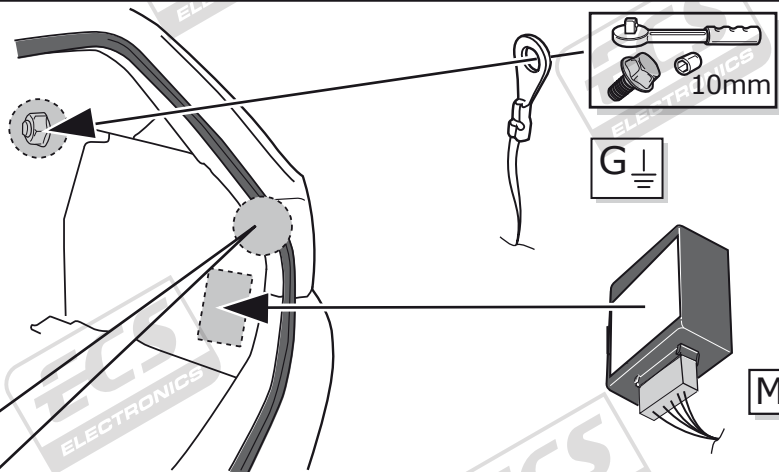
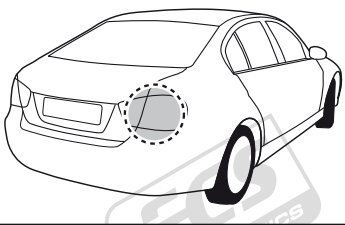

INFO

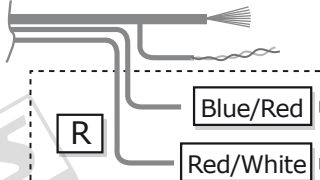

R

Blue/Red

Red/White

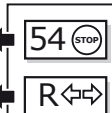

Pag. 11

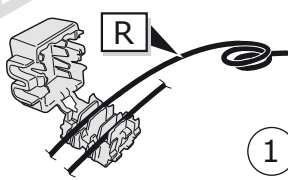
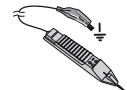

1

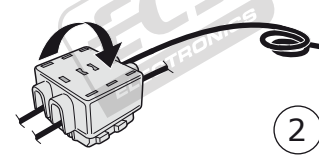

2

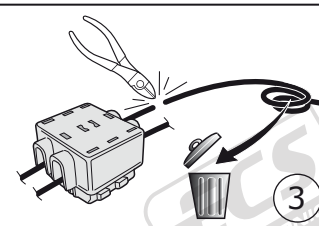

3

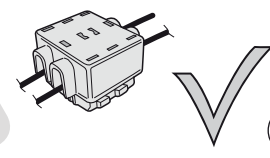

4

26

OPTION 1: E60 / E61

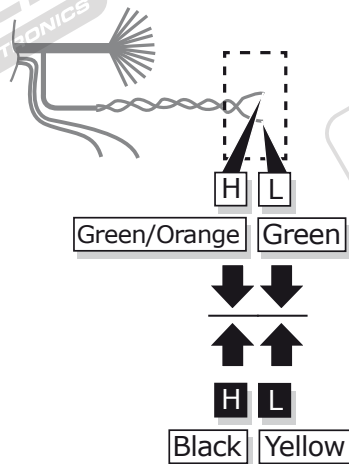
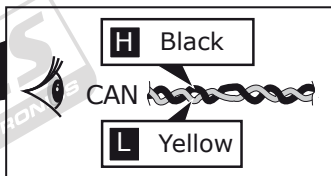
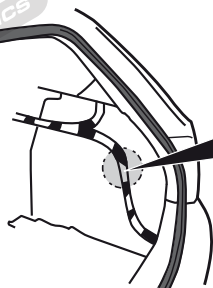
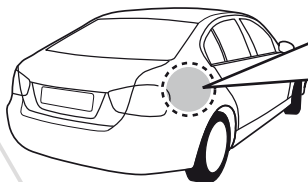

 H Green/Orange	 L Green	
 H Black	 L Yellow	
 H Green/Orange	 L Green	
 H Black	 L Yellow	
INFO		

27

OPTION 2: Other models

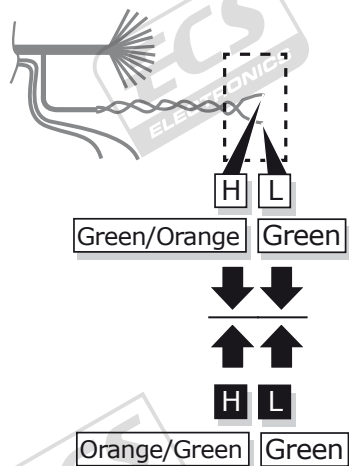
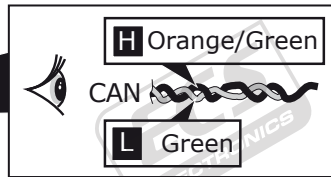
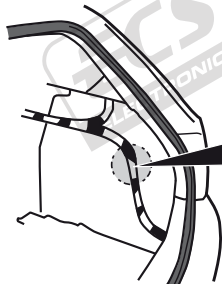
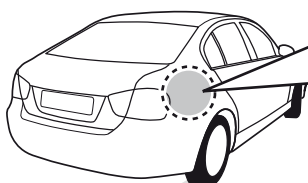

 H Green/Orange	 L Green	
 H Orange/Green	 L Green	
 H Green/Orange	 L Green	
 H Orange/Green	 L Green	
INFO		

28



Pag. 26

BMW 5 Series E60, E61, F07
BMW 7 Series E65, E66
BMW X1 Series E84
BMW X5 Series E70
BMW X6 Series E71

ROUTING

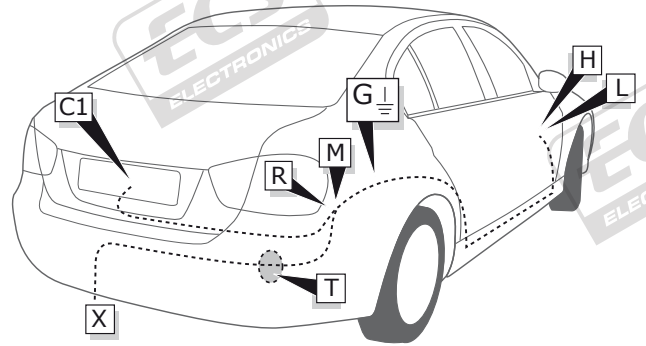

29

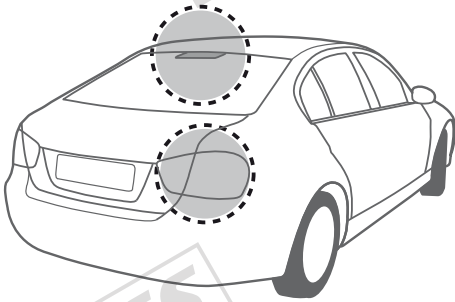
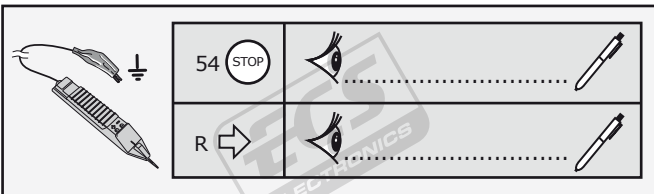

30

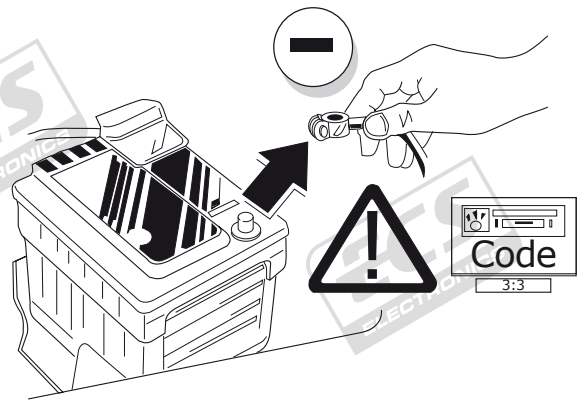

31

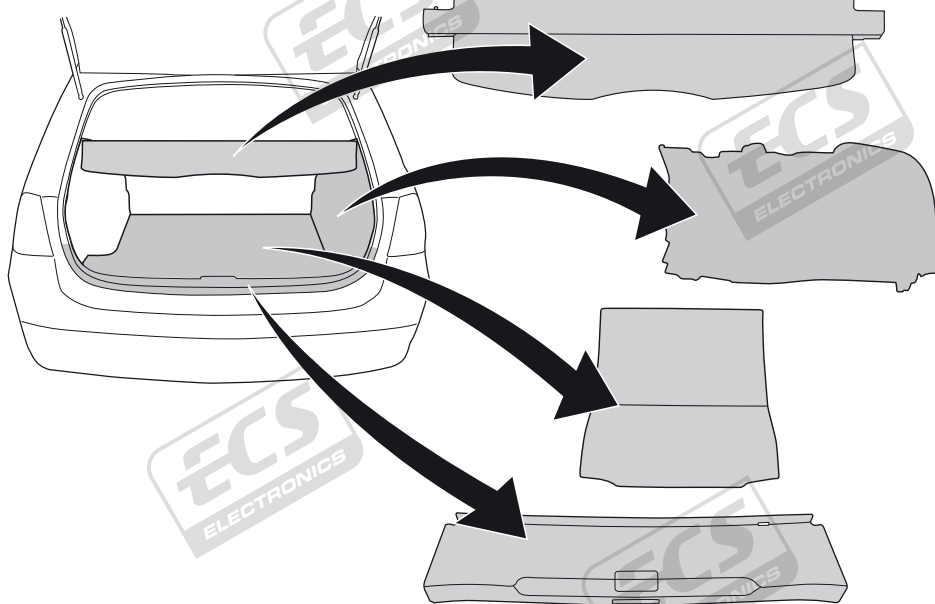

32

INFO

X

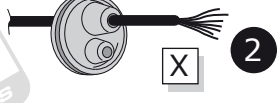

2

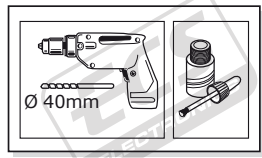

1

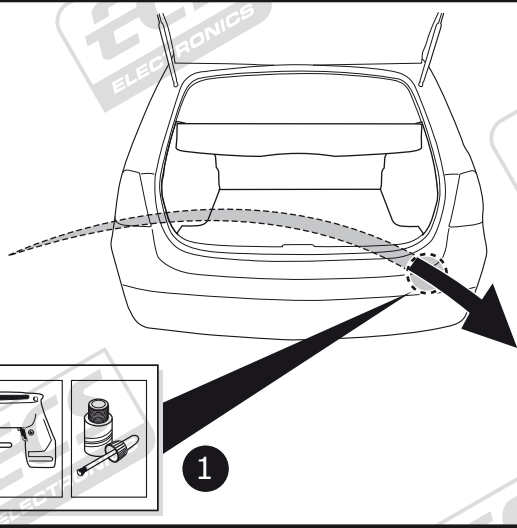

INFO

SOCKET CONNECTION



Pag. 28

33

1

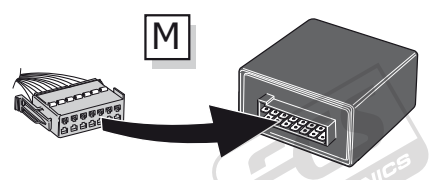

2

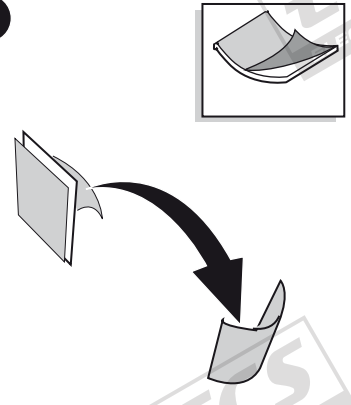

3

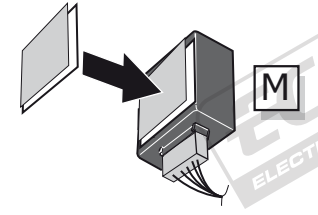

4

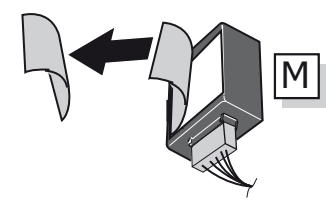

34

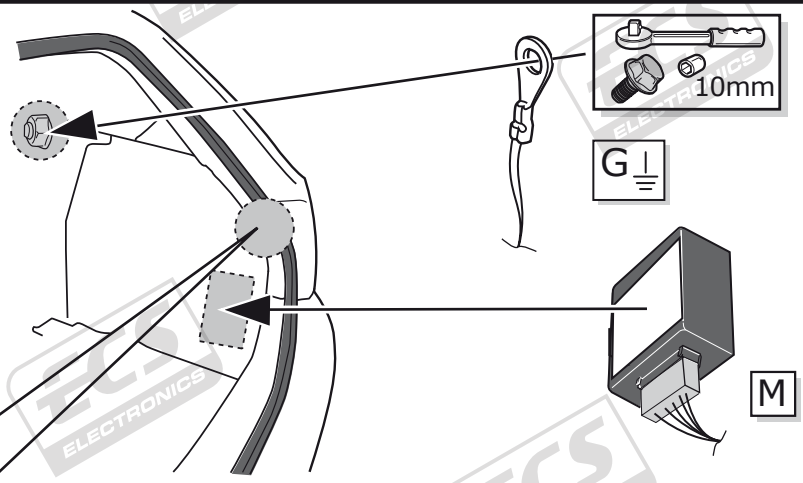
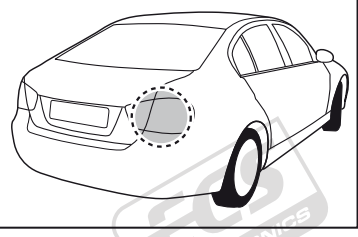

INFO

R

Blue/Red
Red/White

54 STOP
R ↔



Pag. 14

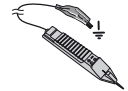

54 STOP
R ↔

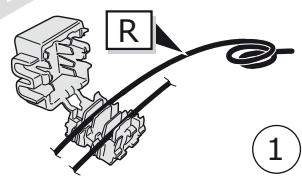

1

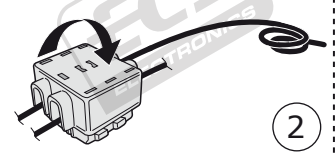

2

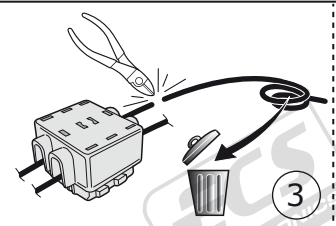

3

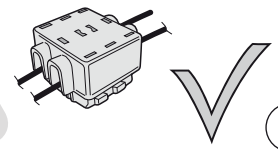

4

35

OPTION 1: E60 / E61

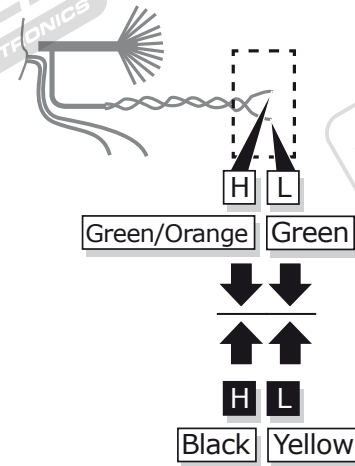
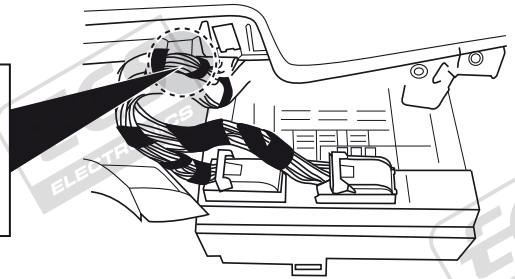
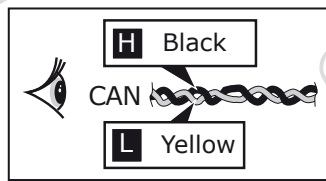
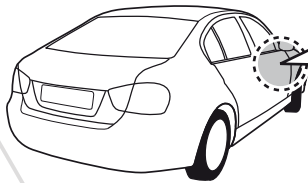

INFO		

36

OPTION 2: Other models

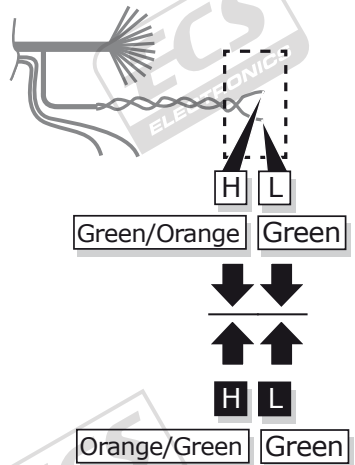
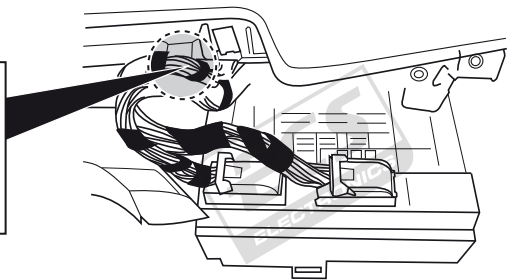
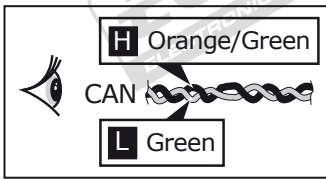
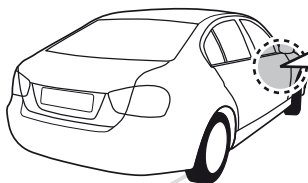

INFO		

37



Pag. 26

BMW 1 Series E81, E82, E87, E88
BMW 3 Series E90, E91, E92, E93

ROUTING

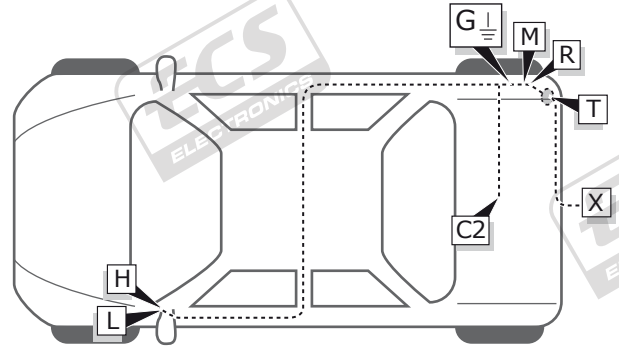

38

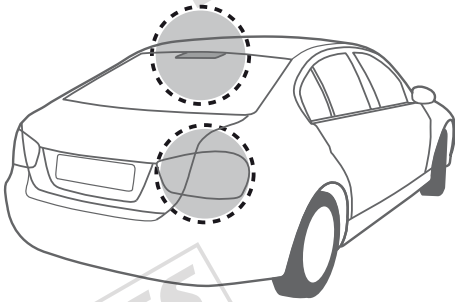
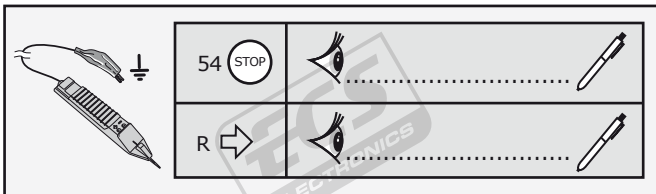

39

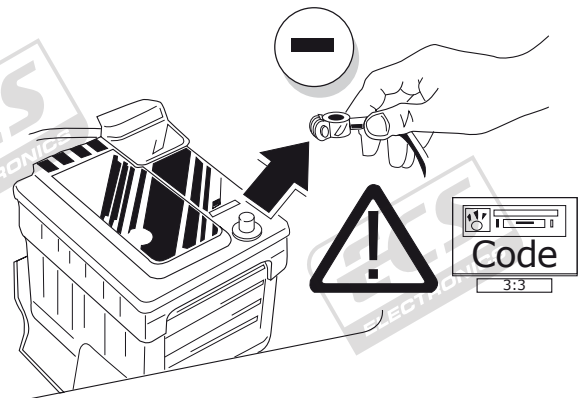

40

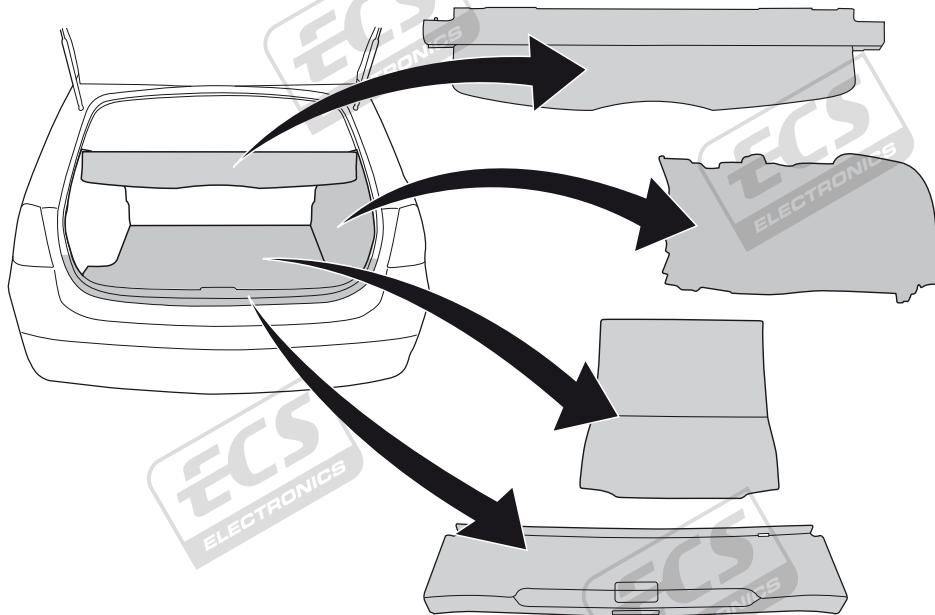

41

INFO

X



2

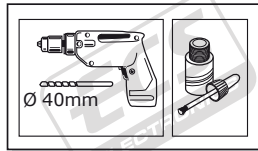

1

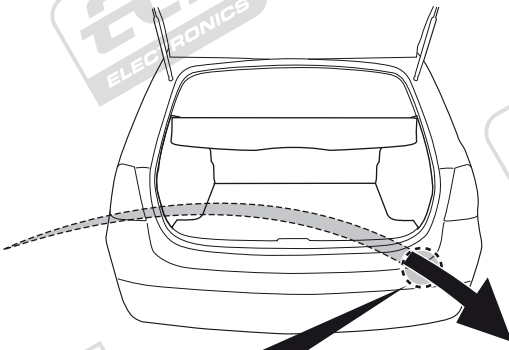

INFO

SOCKET CONNECTION



Pag. 28

42

1

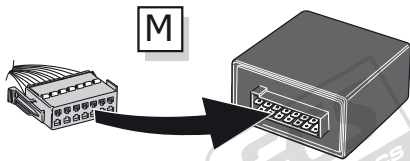

2

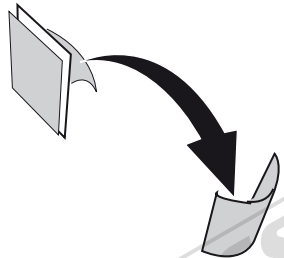

3

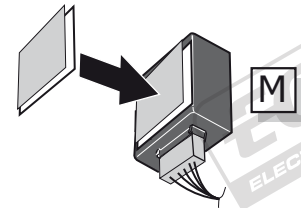

4

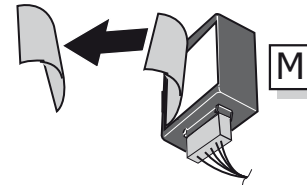

43

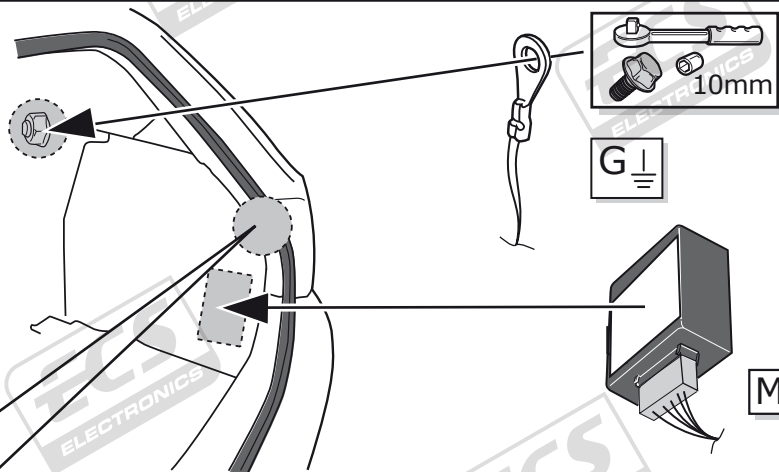
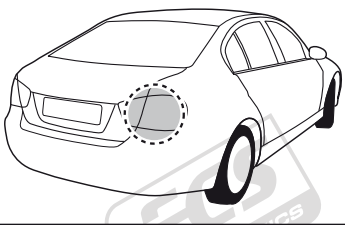

INFO

R

Blue/Red

Red/White

54 STOP

R ↔



Pag. 17

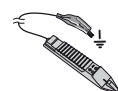

54 STOP

R ↔

R ↔

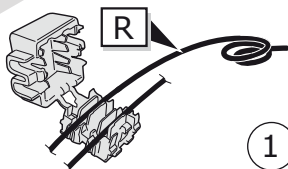

1

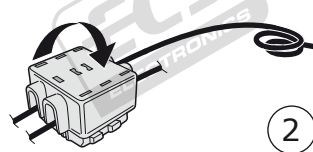

2

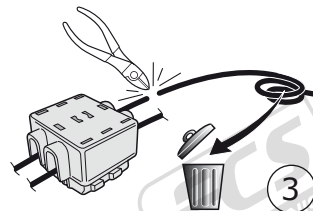

3

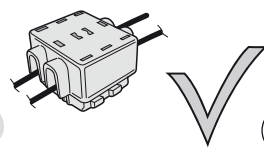

4

44

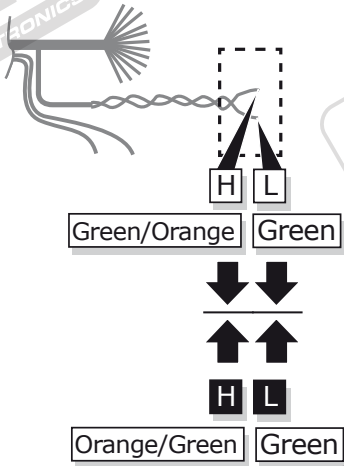
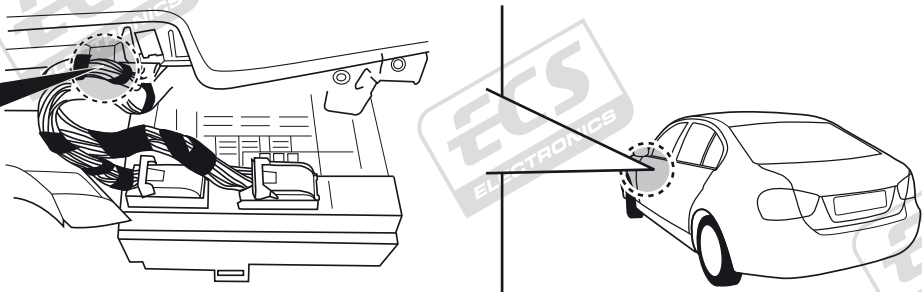
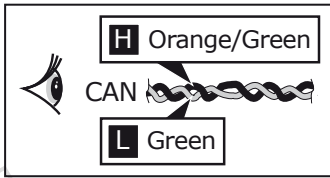

H Green/Orange L Orange/Green	L Green L Green	
H Green/Orange H Orange/Green	L Green L Green	
INFO 		

45



Pag. 26

BMW 1 Series F20, F21

INFO



without PDC cut off function

PARK DISTANCE CONTROL



PARK DISTANCE CONTROL



ROUTING

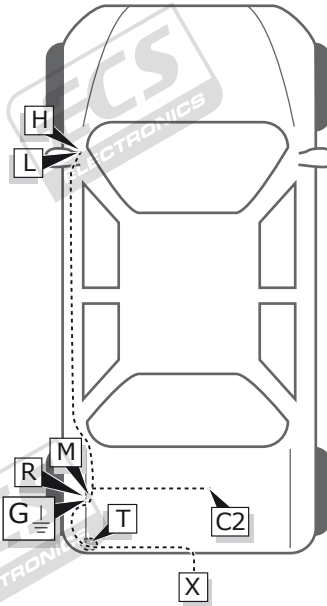

46

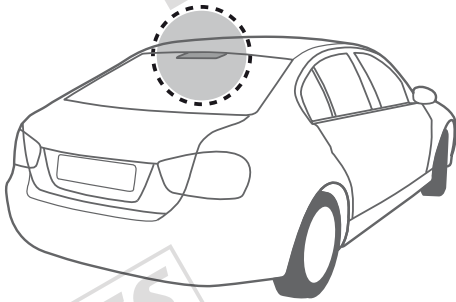
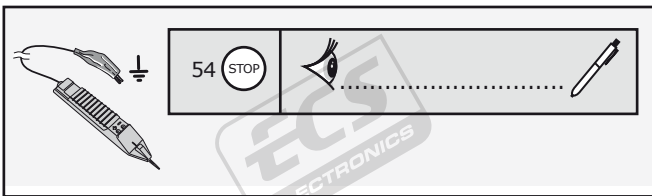

47

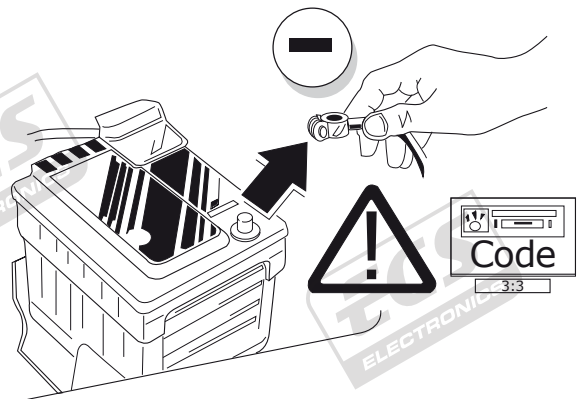

48

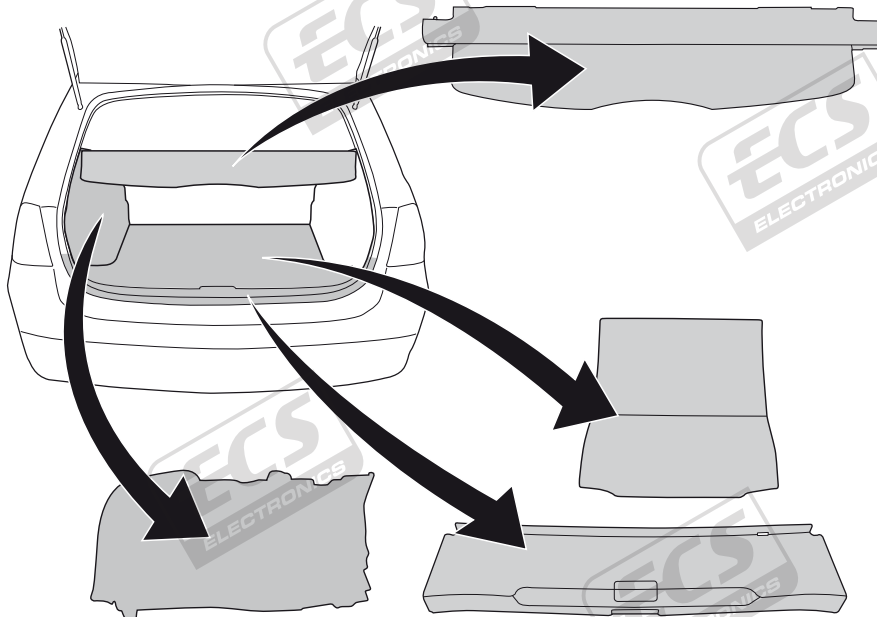

52

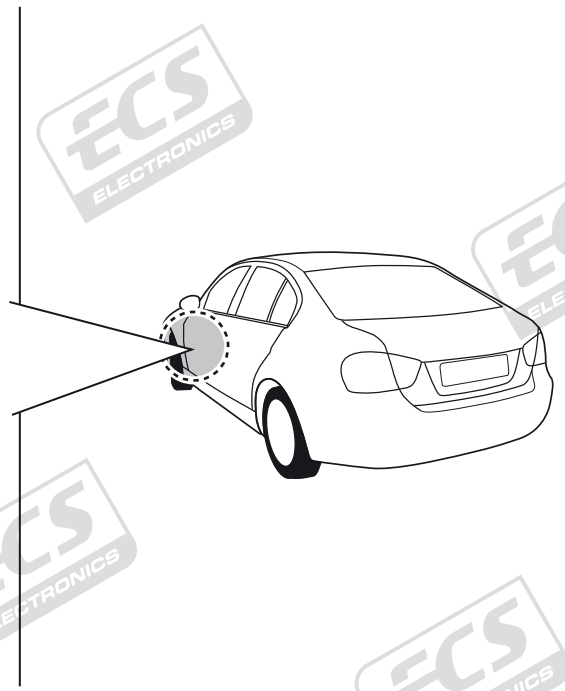
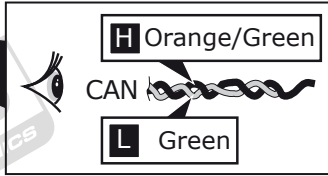
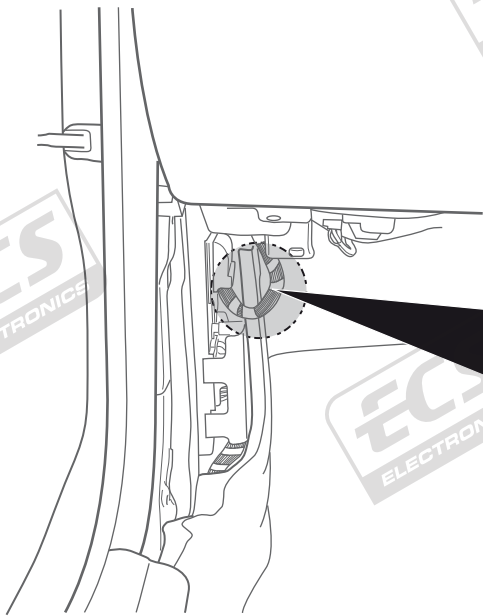

53

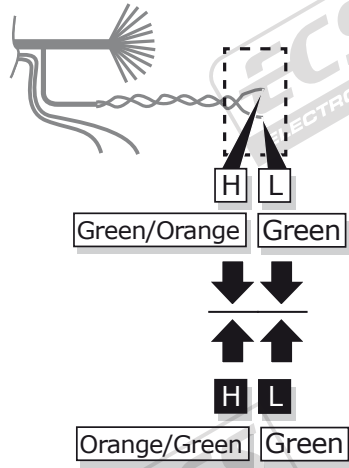

<p>H Green/Orange L Green</p>	<p>H Orange/Green L Green</p>	<p>H Green/Orange L Green</p>	<p>H Orange/Green L Green</p>
<p>H Green/Orange L Green</p>	<p>H Orange/Green L Green</p>		
<p>INFO</p>			

54

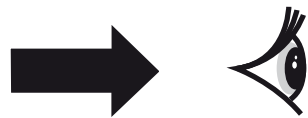

Pag. 26

BMW 3 Series F30, F31, F34

ROUTING

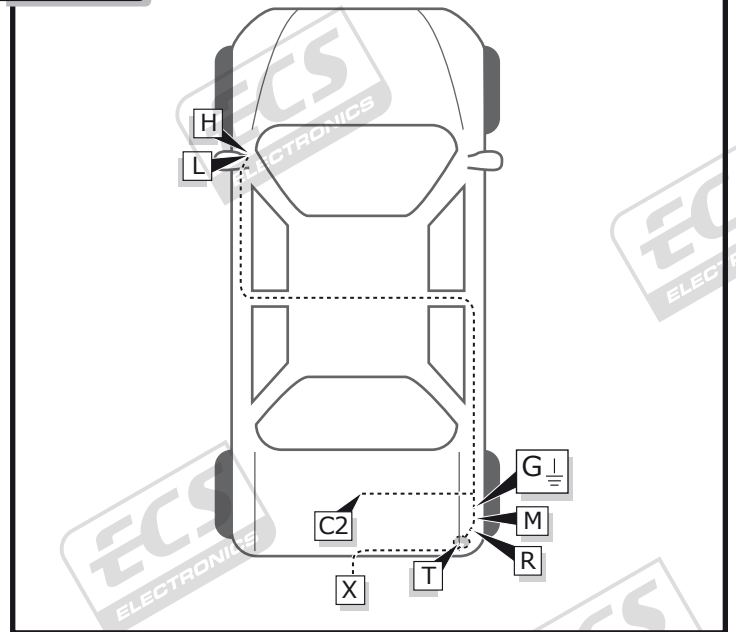

55

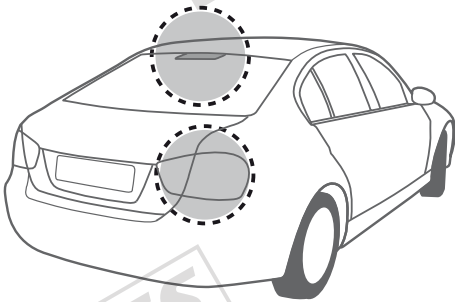
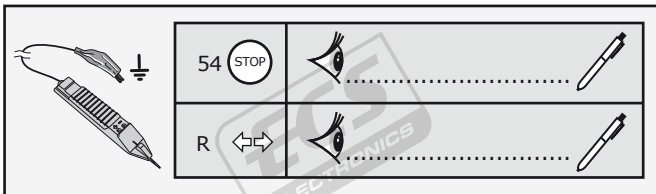

56

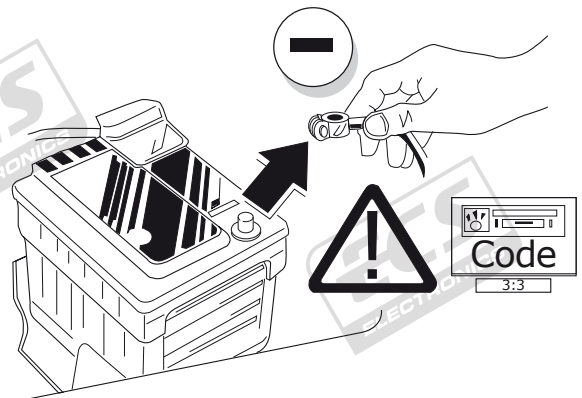

57

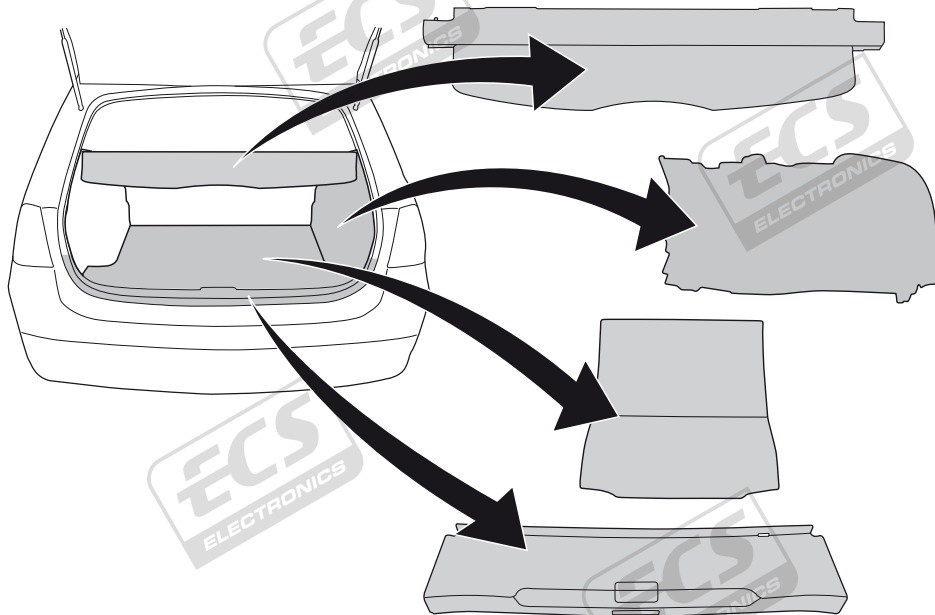

58

INFO

X

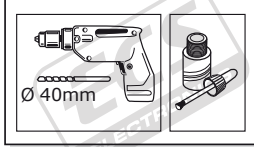
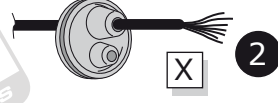
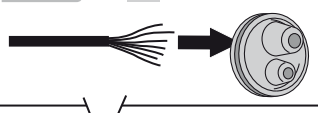

1

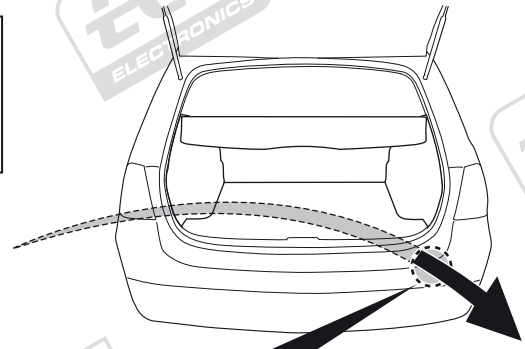

INFO

SOCKET CONNECTION



Pag. 28

59

1

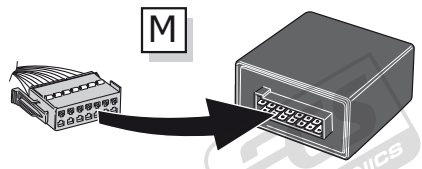

2

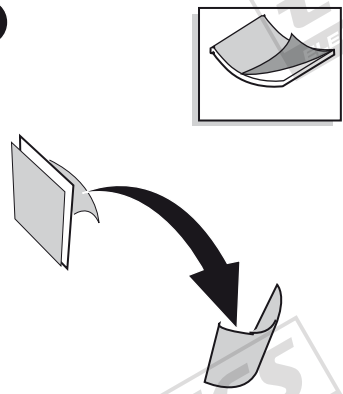

3

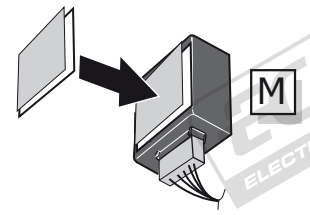

4

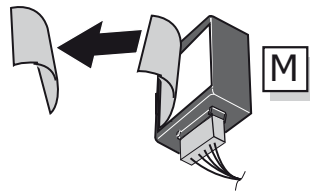

60

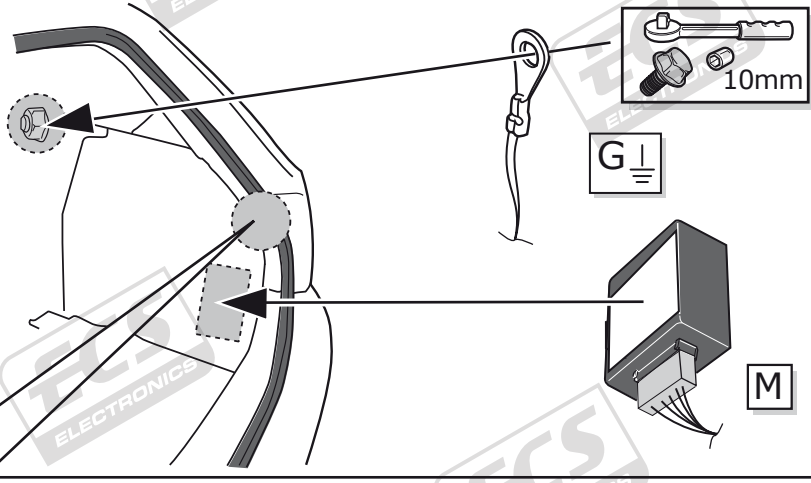
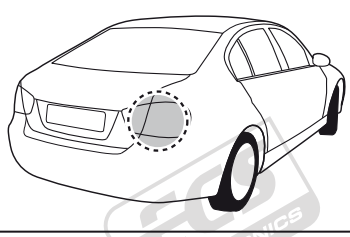

INFO

R

Blue/Red
Red/White

54 STOP
R ↔



Pag. 23

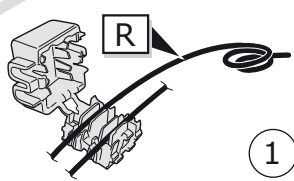
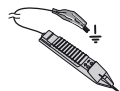

1

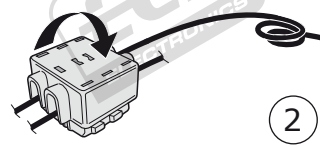

2

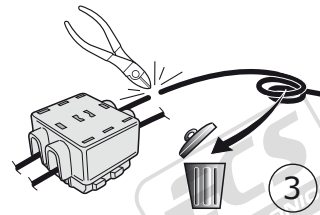

3

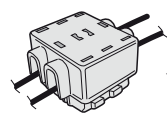

4

61

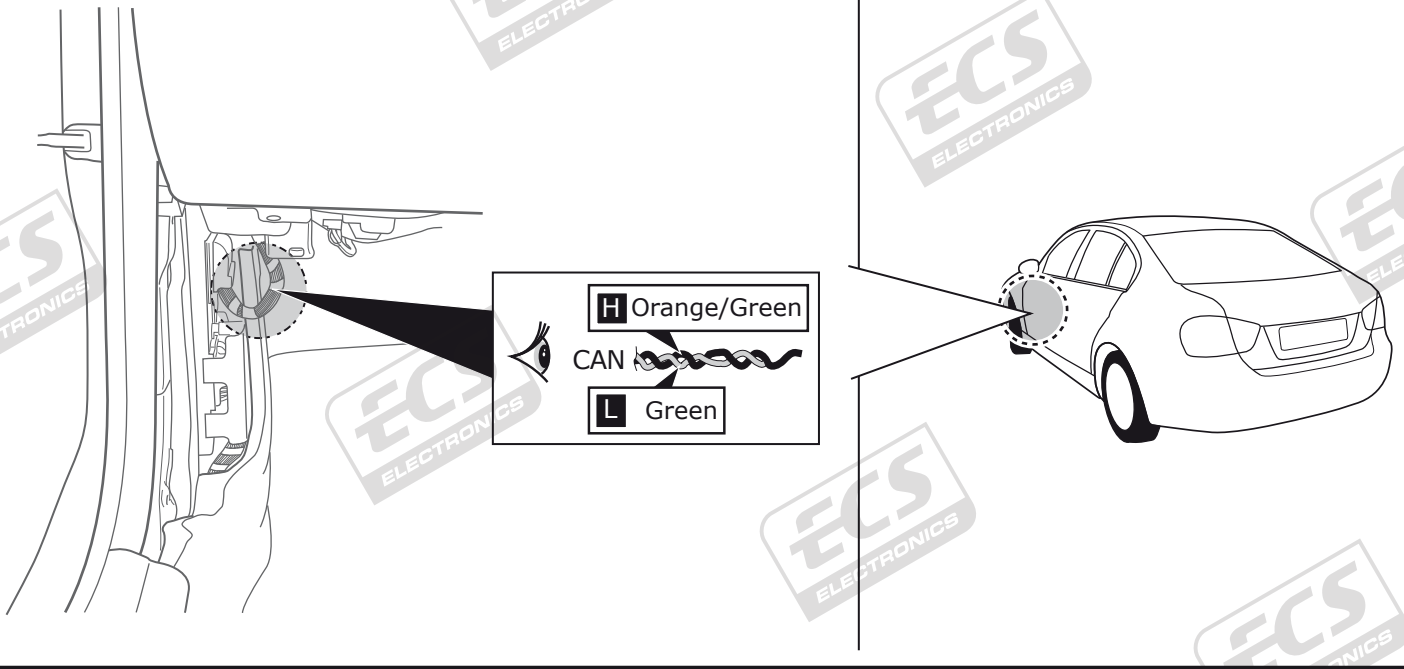

62

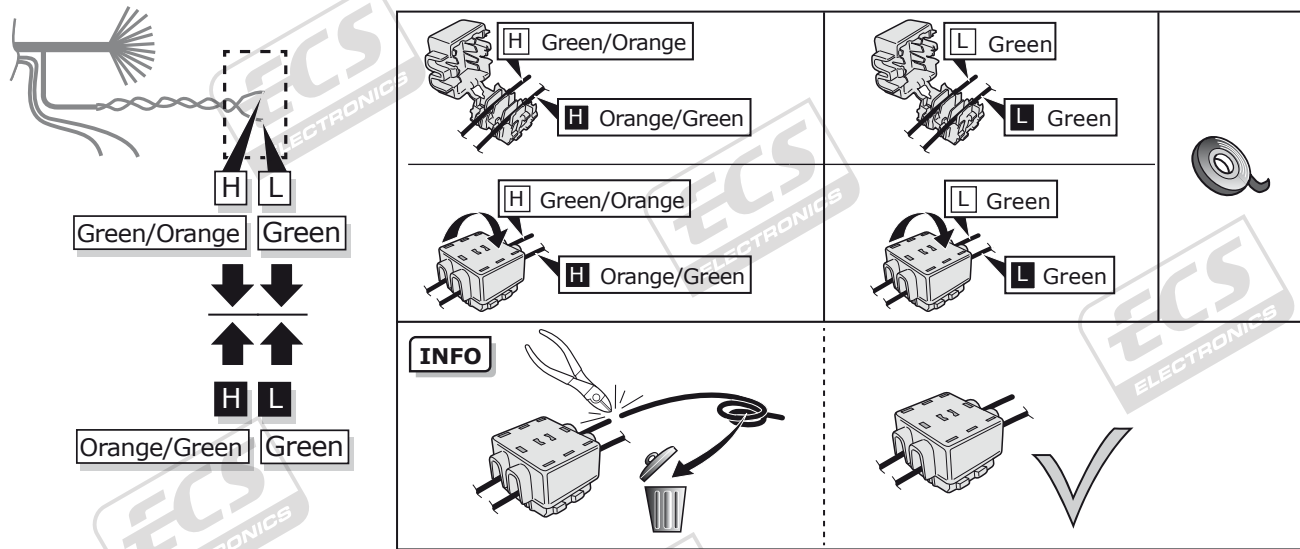

63



Pag. 26

64

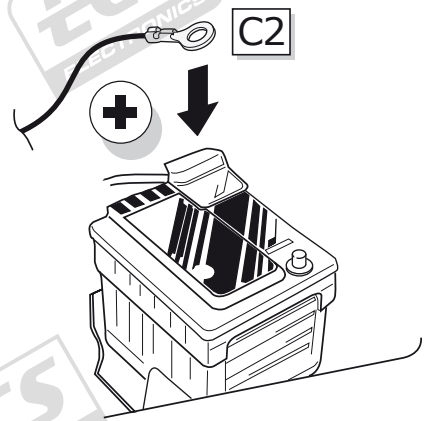
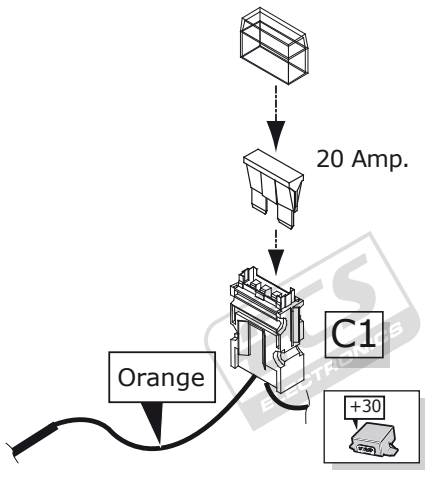

65

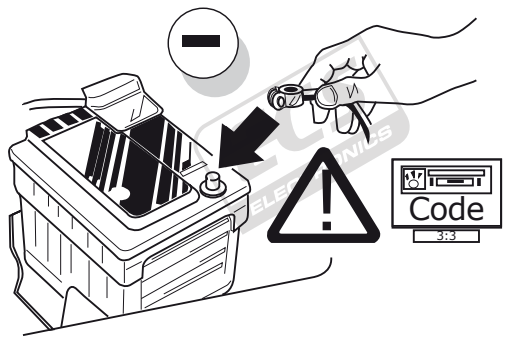

66



! TEST ALL THE CIRCUITS WITH A TEST DEVICE WITH THE CORRECT POWER LOAD FOR EACH FUNCTION. A TEST DEVICE WITH LED'S CANNOT BE USED FOR THIS PURPOSE.

INFO

REINSTALL TRIM.

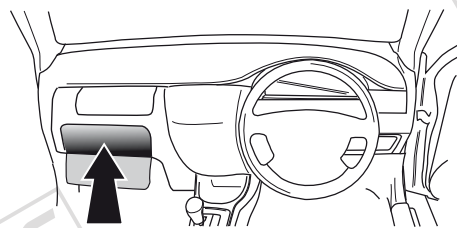

User guide



INFO

SOCKET CONNECTION





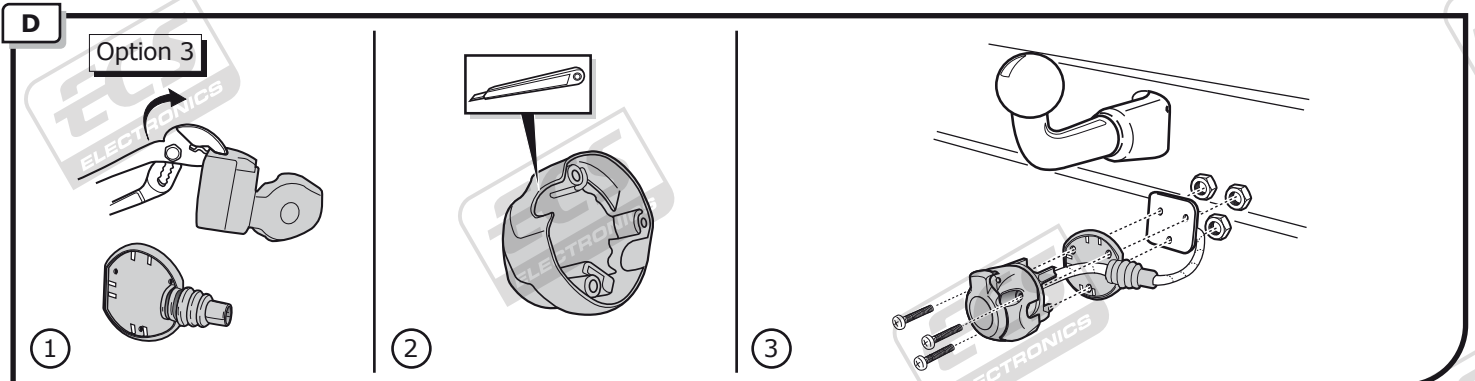
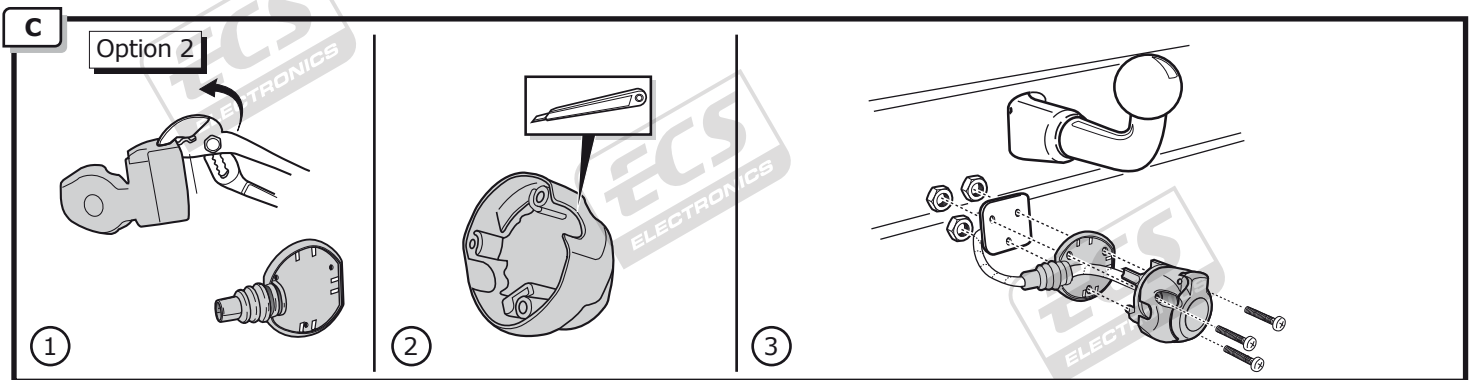
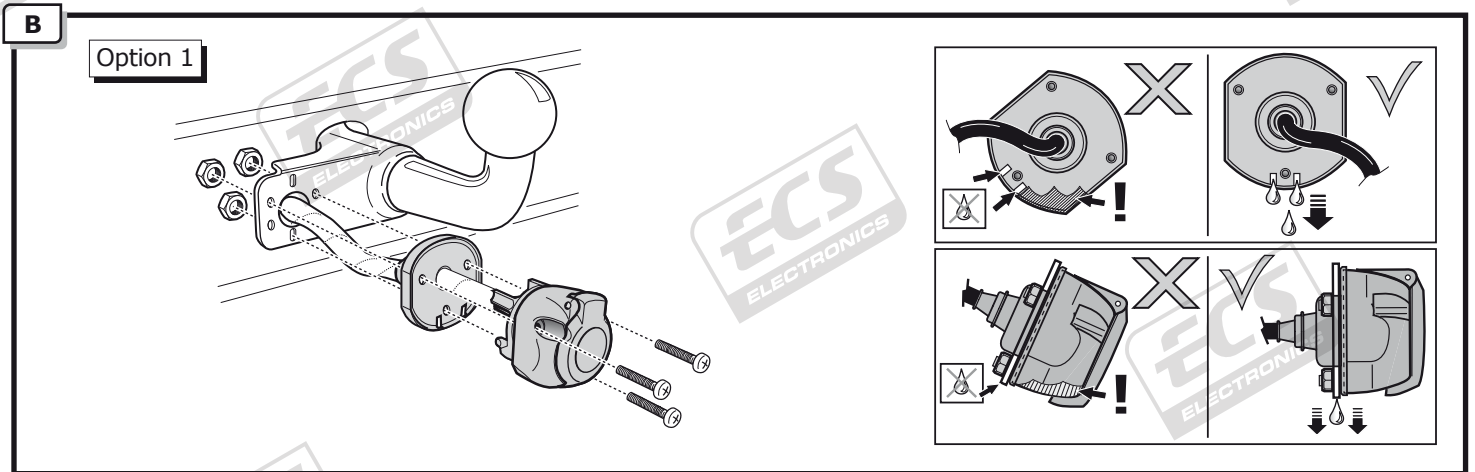
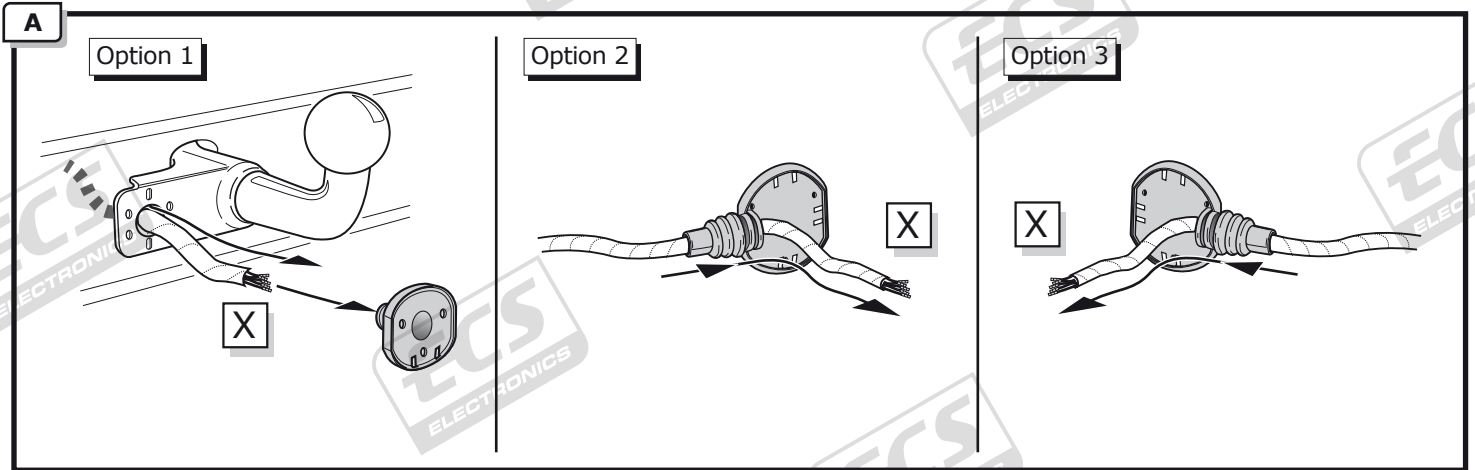

DIN/ISO 1724	←	🚗	⏚ 1-7	→	☀️	⊞	☀️
	1/L	2	3/31	4/R	5/58-R	6/54	7/58-L
Pmax	21W	21W		21W	42W	3x21W	42W
Colour	Yellow	Blue	White	Green	Brown	Red	Black

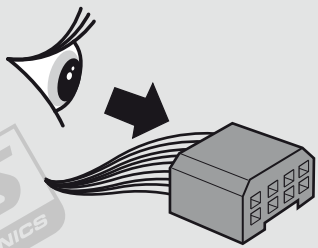
INFO SOCKET CONNECTION

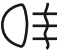

INFO POWER SCHEDULE BW-008-B1U



L		54	
R		54G	
58L		BU	
58R		Ground/31	

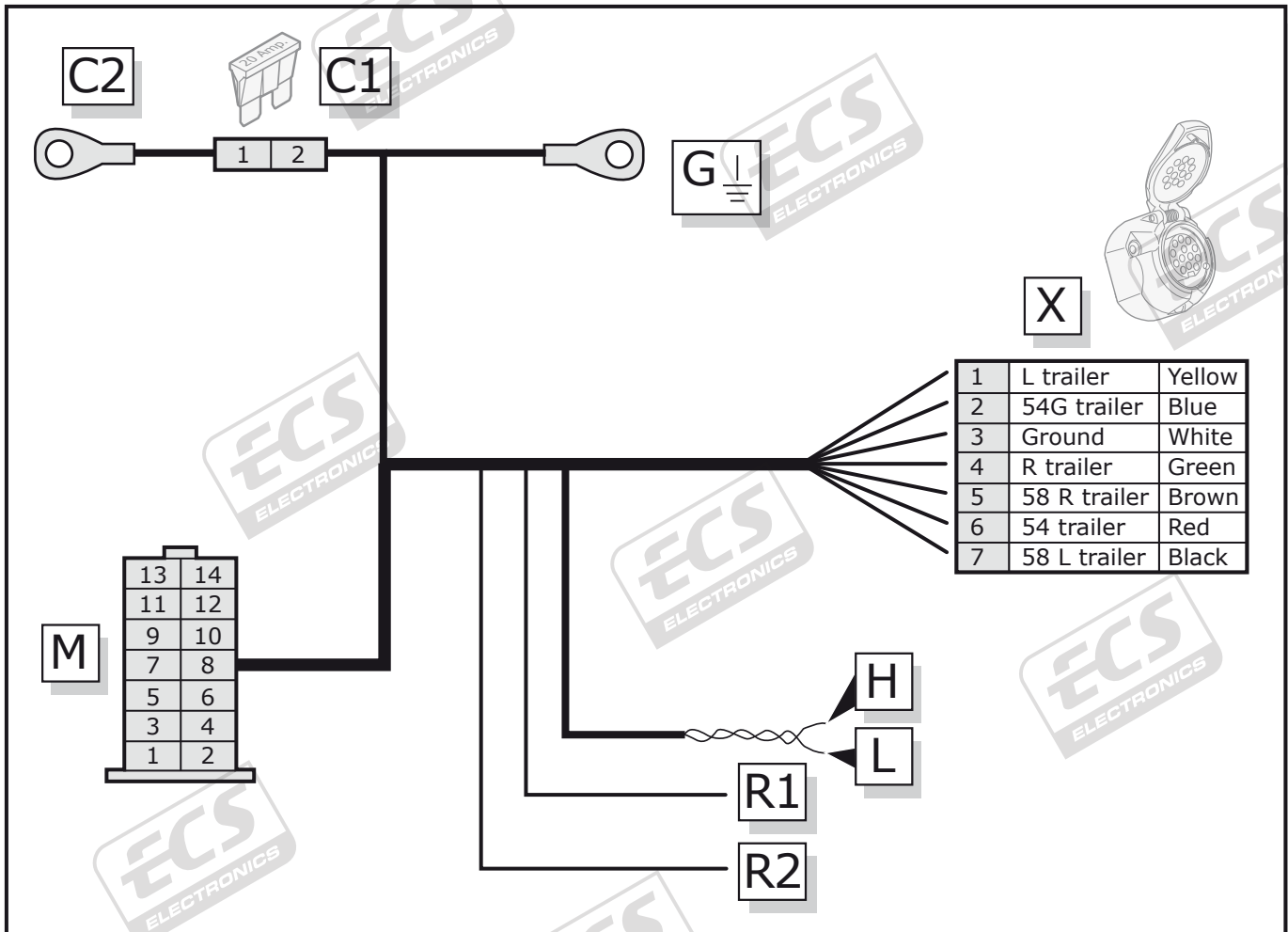

M	1	Red	54 trailer	out
	2	Orange	+30 (12 V)	in
	3	Red/White	R	in
	4	Yellow	L trailer	out
	5	Blue/Red	54	in
	6	Black	58 L trailer	out
	7	Green	CAN L	in
	8	White	Ground	-
	9	Green/Orange	CAN H	in
	10	Green	R trailer	out
	11	Blue	54G trailer	out
	12	Brown	58 R trailer	out
	13	-	-	-
	14	Orange	+30	in

H	Green/Orange	Can H	in
----------	--------------	-------	----

L	Green	Can L	in
----------	-------	-------	----

R1	Blue/Red	54	in
-----------	----------	----	----

R2	RD/WH	R	in
-----------	-------	---	----

G	WH	Ground	-
----------	----	--------	---

C1	1	Red	+30 (12 V)	in
	2	Orange	+30 (12 V)	out

UN-243-YZ Reverse lamp pre-wire extension

⚠ MAX = 21W

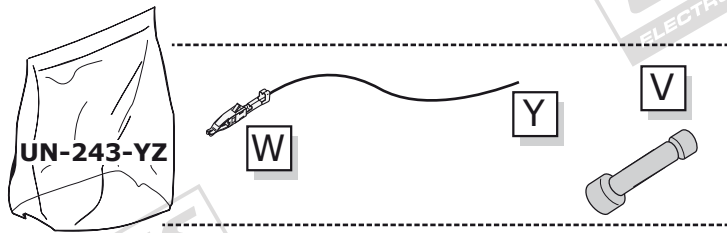

A

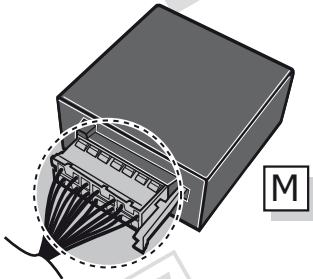

1

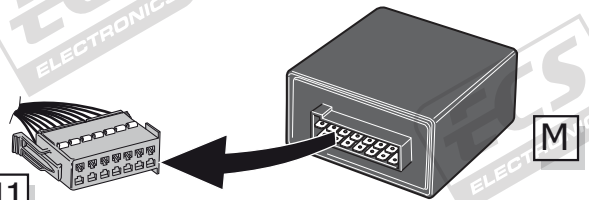

2

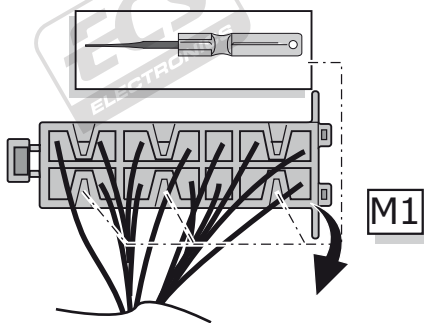

3

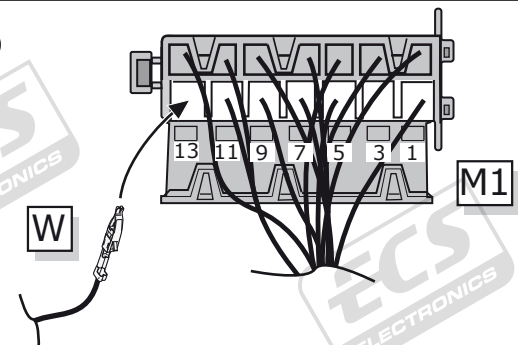

4

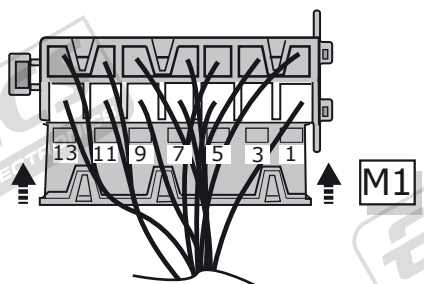

5

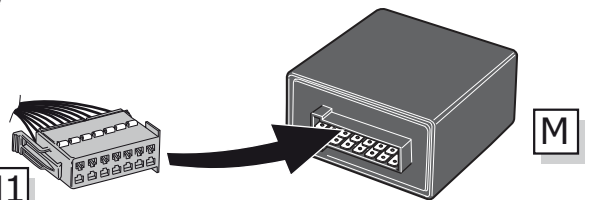

B

⚠ MAX = 21W

