

6. Screw the flexible drain hose on the washbasin.

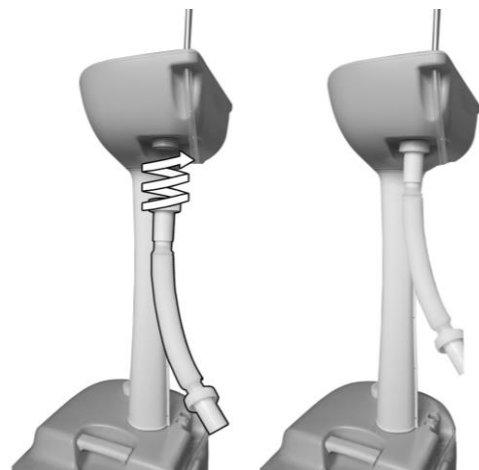

7. Filling water in the base tank and you can use it



Portable Handwash Stand **CHH-7701**

User Manual and Care Instructions

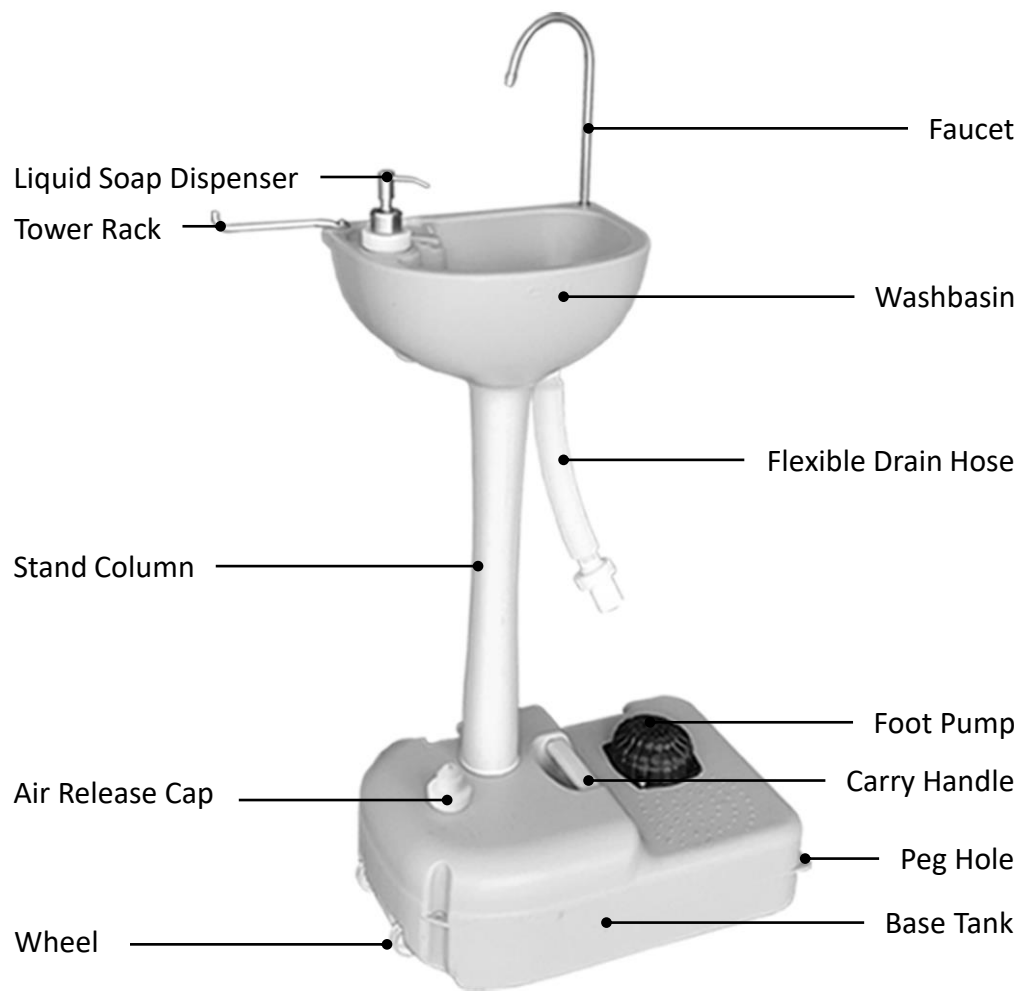

Base tank can be fixed on ground through four holes at the corner by pegs if necessary.

(Pegs are sold separately, not included in normal packing.)

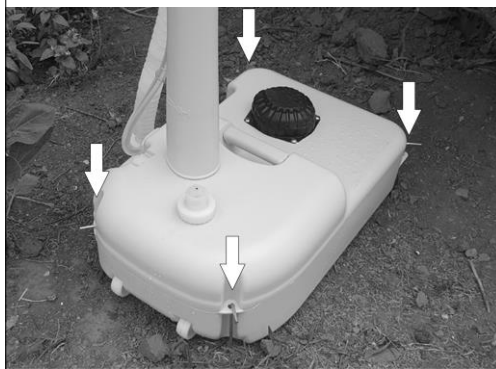

For saving water and environmental protection, flexible drain hose can connect with CHH portable toilet, CHH water tank or other container for collecting the hand wash water.



CHH-7701+3924T



CHH-7702



CHH-7702+567

1. Please always assemble according to the instruction.
2. Base tank can be fixed on ground through four peg holes at the corner of necessary.
3. Ensure that the air release cap is clean to prevent contamination blocking the intake.



CHH-561b Base Tank

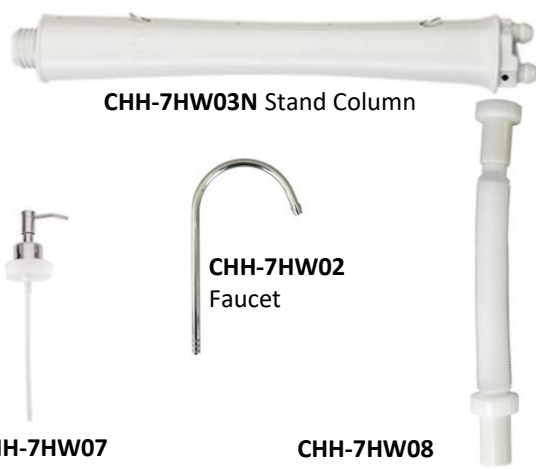

CHH-7HW03N Stand Column



CHH-7HW07
Liquid Soap Dispenser



CHH-7HW02
Faucet



CHH-7HW08
Flexible Drain Hose



CHH-7HW01 Washbasin

Parameter:

1. Base tank capacity: 17L
2. Foot pump ability: 220ml
3. Hand soap tank capacity: 3L
4. Hand soap dispenser ability: 1ml
5. Product size after assemble: L 50*W 33*H 103cm
6. Flexible drain hose size: 31-80cm

1. Screw the stand column clockwise into the base tank.

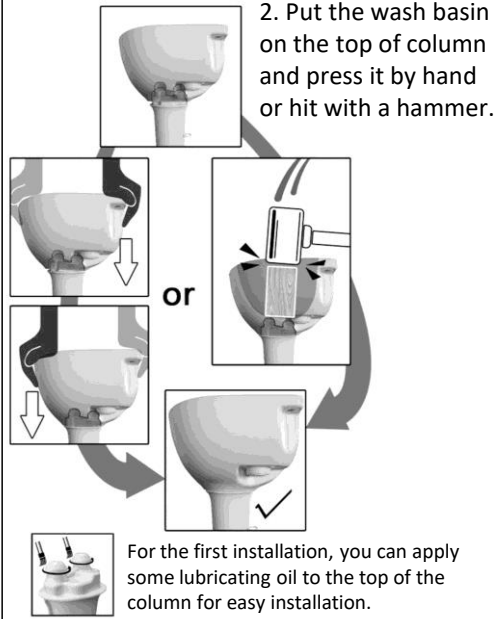
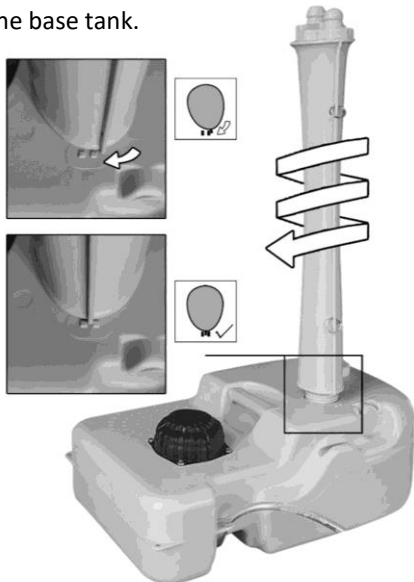

3. Run the water pipe through the corresponding rings and hole according to the following pictures.

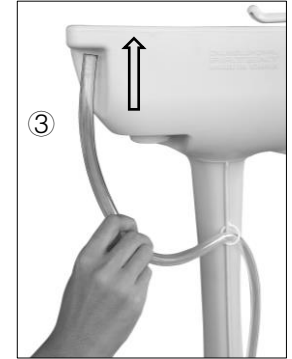
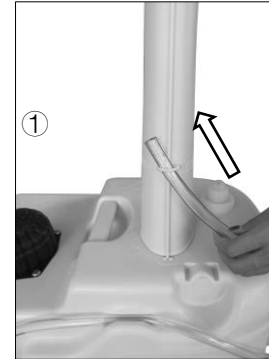

4. Insert the faucet into the water pipe and push back it in the hole of washbasin.



5. Fill the liquid soap into the tank and assemble the dispenser

