

## POST FRAME BUILDING WALL (NEW) (Draped Method)

- IDEAL INSULATION FOR POST FRAME BUILDING APPLICATIONS
- QUICK AND EASY TO INSTALL
- REDUCES HEAT LOSS AND HEAT GAIN ALL YEAR ROUND
- WILL BLOCK UP TO 96% OF RADIANT HEAT TRANSFER

### INSTALLATION METHOD

1. Start at the top purlin and attach EcoFoil® insulation securely to it.
2. As you unroll the insulation, allow it to drape slightly between purlins.
3. Attach the product to the purlins using staples.
4. Run subsequent EcoFoil® Insulation and butt it up to the previous installed layer
5. Seal all seams with EcoFoil® tape.
6. Affix roofing panels as usual.

#### Builder's Notes:

- If a white interior finish is desired, EcoFoil® white reflective insulation may be used. Install as per usual method, however with poly-white side facing interior.
- Use EcoFoil® white poly tape to seal all seams and butt joints.
- When EcoFoil® insulation comes in direct contact with ACQ lumber, it may discolour. This will not affect the overall insulation value of EcoFoil® insulation.

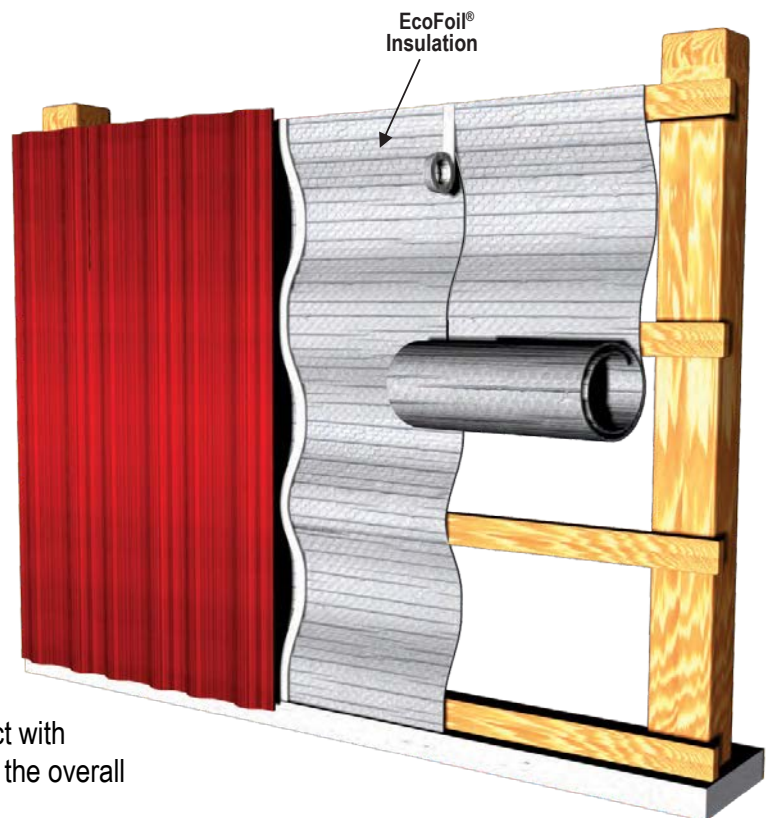

### SUGGESTED PRODUCTS FOR THIS APPLICATION:

<b>EcoFoil® Insulation Product</b>	EF2210, EF2510, EF2220, EF2520 (Available in Various Dimensions)
<b>EcoFoil® Tape</b>	EF15073 (Reflective), EF15853 (White Poly)

- a) Check local building codes for compliance before installation. This installation sheet is intended solely to illustrate the proper location and placement of EcoFoil® Reflective Insulation products in specific constructions applications. They are not intended to illustrate proper construction methods (which is ultimately the responsibility of the builder or contractor). The installation instructions are only recommendations relating to the location and placement of EcoFoil® Reflective Insulation products and EcoFoil® makes no claims that these construction systems are universally accurate.
- b) All warranties are void if EcoFoil® Reflective Insulation products are used in exterior applications, or in non-enclosed systems or buildings.
- c) Exercise caution when using EcoFoil® Reflective Insulation products near and around electrical wiring and devices.



**POST FRAME BUILDING WALL (NEW)  
(FURRING METHOD)**

- IDEAL INSULATION FOR POST FRAME BUILDING APPLICATIONS
- QUICK AND EASY TO INSTALL
- REDUCES HEAT LOSS AND HEAT GAIN ALL YEAR ROUND
- WILL BLOCK UP TO 96% OF RADIANT HEAT TRANSFER

**INSTALLATION METHOD**

1. Attach EcoFoil® insulation to the top purlin of the building wall and unroll product vertically.
2. Attach the product to purlins using staples.
3. Run subsequent EcoFoil® Insulation and butt it up to the previous installed layer.
4. Seal all seams with EcoFoil® tape.
5. Affix wall panels as usual.

**Builder's Notes:**

- If a white interior finish is desired, EcoFoil® white reflective insulation may be used. Install as per usual method, however with white side facing interior.
- Use EcoFoil® white tape to seal all seams and butt joints.
- When EcoFoil® insulation comes in direct contact with ACQ lumber, it may discolour. This will not affect the overall insulation value of EcoFoil® insulation.



**SUGGESTED PRODUCTS FOR THIS APPLICATION:**

<b>EcoFoil® Insulation Product</b>	EF2210, EF2510, EF2220, EF2520 (Available in Various Dimensions)
<b>EcoFoil® Tape</b>	EF15073 (Reflective), EF15853 (White Poly)

- a) Check local building codes for compliance before installation. This installation sheet is intended solely to illustrate the proper location and placement of EcoFoil® Reflective Insulation products in specific constructions applications. They are not intended to illustrate proper construction methods (which is ultimately the responsibility of the builder or contractor). The installation instructions are only recommendations relating to the location and placement of EcoFoil® Reflective Insulation products and EcoFoil® makes no claims that these construction systems are universally accurate.
- b) All warranties are void if EcoFoil® Reflective Insulation products are used in exterior applications, or in non-enclosed systems or buildings.
- c) Exercise caution when using EcoFoil® Reflective Insulation products near and around electrical wiring and devices.

