

**CATHEDRAL CEILING with STAPLE TAB
(IN-BETWEEN JOISTS)**

- PERFORMANCE UNAFFECTED BY MOISTURE AND HUMIDITY
- QUICK AND EASY TO INSTALL
- REDUCES HEAT LOSS AND HEAT GAIN ALL YEAR ROUND
- WILL BLOCK UP TO 96% OF RADIANT HEAT TRANSFER

INSTALLATION METHOD

1. Insert 1 1/2" - 2" insulation baffles between rafters.
2. Install unfaced mass insulation between rafters, as per manufacturer's instructions.
3. Install EcoFoil® reflective insulation with staple tabs by pushing the material back in-between the rafters and staple tabs to the rafters every 12"-18" on both sides.
4. Install drywall to the underside of the ceiling as per the usual method.

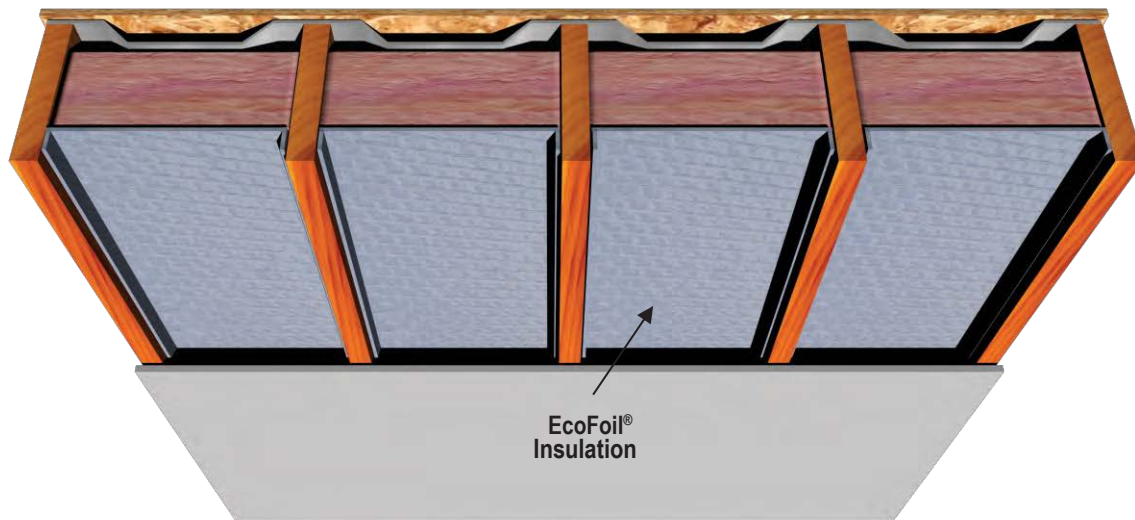

SUGGESTED PRODUCTS FOR THIS APPLICATION:

EcoFoil® Insulation Product	EF2222 Series
EcoFoil® Tape	Not Required (Product to be Stapled)

- a) Check local building codes for compliance before installation. This installation sheet is intended solely to illustrate the proper location and placement of EcoFoil® Reflective Insulation products in specific constructions applications. They are not intended to illustrate proper construction methods (which is ultimately the responsibility of the builder or contractor). The installation instructions are only recommendations relating to the location and placement of EcoFoil® Reflective Insulation products and EcoFoil® makes no claims that these construction systems are universally accurate.
- b) All warranties are void if EcoFoil® Reflective Insulation products are used in exterior applications, or in non-enclosed systems or buildings.
- c) Exercise caution when using EcoFoil® Reflective Insulation products near and around electrical wiring and devices.

