

Delock GSM UMTS LTE Antenna SMA Plug 2.5 dBi 2 m RG-174 omnidirectional adhesive mounting

Description

This GSM UMTS LTE antenna by Delock allows the use of different frequency bands indoors. It is completely ZigBee 868 / 915 MHz, DECT and Z-Wave compatible.



2 m

Item no. 89494

EAN: 4043619894949

Country of origin: China

Package: Zip poly bag

Specification

- Connector: SMA plug
- LTE Band: 1-6/8-10/19/25/33-37/39
- Frequency range: 824 - 960, 1920 - 2170 Mhz
- GSM, UMTS, ZigBee 868 / 915 MHz, DECT, Z-Wave
- Antenna gain: 2.5 dBi
- Impedance: 50 Ohm
- Polarisation: vertical
- VSWR: 2.0
- Operating temperature: -40 °C ~ 85 °C
- Colour: black
- Dimensions (LxWxH): ca. 126.0 x 16.2 x 8.8 mm
- Cable category: coaxial
- Cable type: RG-174
- Cable colour: black
- Cable attenuation: 1,8 dB @ 1.8 GHz per meter
- Cable diameter: ca. 2.7 mm
- Cable length incl. connector: ca. 2 m

System requirements

- Device with free SMA connector

Package content

- GSM UMTS LTE antenna

Images

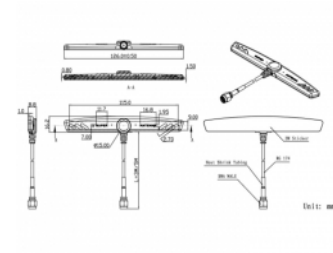

General

Mounting type:	Self adhesive
Suitable for indoor:	yes
Suitable for outdoor:	no

Interface

connector:	1 x SMA
------------	---------

Technical characteristics

Frequency range:	1710 MHz - 2170 MHz 824 MHz - 960 MHz
Antenna gain:	2.5 dBi
Impedance:	50 Ω
Operating temperature:	-40 °C ~ 85 °C
Polarisation:	linear vertical
VSWR:	2.0

Physical characteristics

Housing colour:	black
Housing material:	ABS
Cable category:	coaxial
Cable type:	RG-174
Cable attenuation:	1.5 dB @ 1.5 GHz per meter RG-174
Cable colour:	black
Cable diameter:	2.7 mm
Cable length incl. connector:	2 m
Length:	126 mm
Width:	16.2 mm

Height:	8.8 mm
Colour:	black