



Glion Dolly XL Electric Scooter User Manual

12/15/2022



Glion DollyXL Electric Scooter User Manual

Thank you for purchasing a Glion Electric Scooter. For your safety and the reliable operation of this product, please carefully read this User Manual in its entirety AND VIEW INSTRUCTIONAL VIDEOS on our website BEFORE operating this product. The information in this manual is accurate as of the time of printing. To determine whether updates have been added, please visit our website at www.getglion.com for the latest version of the User Manual. The website also provides videos demonstrating how to fold, unfold, and operate the scooter. Your Glion Electric Scooter is covered by a warranty. For the specifics of this warranty, visit our website at www.getglion.com. Please register your Glion Electric Scooter at www.getglion.com for warranty coverage.

Please do not hesitate to contact us if you have any questions:

support@getglion.com

www.getglion.com

Probity Cell LLC

701 4th Avenue, Suite 3

Holdrege, NE 68949



WARNING: THIS MANUAL CONTAINS IMPORTANT SAFETY, PERFORMANCE, AND SERVICE INFORMATION. Read it before you take the first ride on your new Glion Electric Scooter and keep it for reference. Whenever you ride this motorized scooter, you risk death or serious injury from loss of control, collisions, and falls. **THIS IS NOT A STUNT VEHICLE, AND SHOULD NOT BE USED AS SUCH.** When riding, use common sense and good judgment: Always wear a helmet and protective safety gear. Ride on legal surfaces. Ride at a speed you can control. Be alert and prepared for changes in your riding surface. Never ride intoxicated or in any other manner that impairs your ability to drive this scooter safely. Yield to pedestrians at ALL TIMES!



TABLE OF CONTENTS

SAFETY SPECIFICATIONS AND OWNER OBLIGATIONS	3
GLION MODEL 255 SPECIFICATIONS	6
GLION MODEL 255 PARTS DIAGRAM	7
UNFOLD/FOLD INSTRUCTIONS	8
OVERVIEW OF YOUR GLION ELECTRIC SCOOTER	11
OPERATING YOUR GLION ELECTRIC SCOOTER	14
BATTERY AND CHARGER	15
DOLLY FEATURE	17
SCOOTER COVER (OPTIONAL ACCESSORY).....	18
GLION ELECTRIC SCOOTER MAINTENANCE	20
GENERAL TROUBLESHOOTING	21
CLEANING, STORING, AND SERVICING	24
PRODUCT REGISTRATION.....	24
GLION LIMITED WARRANTY	25

SAFETY SPECIFICATIONS AND OWNER OBLIGATIONS

1. **LEGAL RIDING LOCATIONS:** Always check and obey local laws or regulations, which govern where you can legally operate the scooter. Only operate the scooter where legally permitted, and do so with caution. The scooter can only be operated on private property unless it is street legal in your jurisdiction. While many state laws approve its legal use in bike lanes, some states do not consider a motorized scooter street legal. Please familiarize yourself with the applicable laws and regulations for electric scooters where you plan on riding it. Keep safely away from cars and motor vehicle traffic at all times.



WARNING: Many states require specific safety devices. It is your responsibility to familiarize yourself with the laws of the state where you ride and to comply with all applicable laws, including properly equipping yourself and your electric scooter as the law requires. Observe all local electric scooter laws and regulations. Observe regulations about electric scooter lighting, licensing of electric scooters, riding on sidewalks, laws regulating bike path and trail use, helmet laws, and special electric scooter traffic laws. **IT'S YOUR RESPONSIBILITY TO KNOW AND OBEY THE LAWS.**

2. **SAFETY GEAR:** Always wear an approved safety helmet (with chin strap securely buckled), gloves, elbow and knee pads, appropriate shoes (lace-up with rubber soles), and bright or reflective clothing while operating this scooter.



WARNING: Failure to wear a helmet while riding may result in serious injury or death.

3. **SAFE OPERATING CONDITIONS:**

- Do not operate this scooter in traffic.
- Do not operate this scooter on surfaces that are wet, frozen, oily, or unpaved.
- Never carry passengers or objects that can hinder your ability to safely operate this scooter.
- Never use headphones or a cell phone to talk or text while riding.

4. **PREGNANT OPERATORS:** Pregnant women should not operate this scooter.

5. **DRIVING IMPAIRED:** Never use alcohol or drugs before or while operating this scooter. The use of such hinders your ability to safely operate the scooter.

6. **STUNTS:** This scooter is not designed for stunts or tricks and should not be used as such. High speeds, jumps, wheelies, and other trick maneuvers are dangerous and can result in loss of control, accidents, and injury/death to self or others.

7. **HILLS:** When climbing hills, you may need to manually kick the scooter forward to assist the motor and maintain your speed depending on the steepness of the hill and rider weight. **WHEN DESCENDING HILLS, CAREFULLY CONTROL YOUR SPEED! The scooter has a short wheel base. It may become unsteady at excessive speeds. Avoid excessive speeds that can be associated with downhill rides.** Always activate the brake and check the brake BEFORE beginning to go downhill. Never go downhill without brake being checked first.



WARNING: Failure to control your speed when descending a hill can result in serious injury or death.

8. **GUEST USE:** Never permit a guest to use this scooter unless the guest has read the user manual and all the warnings. Always provide a guest with helmet, elbow pads, and knee pads before permitting the guest to operate the scooter. Never allow more than one person at a time to ride the scooter.



WARNING: This product should not be used by persons unwilling or unable to take responsibility for their own actions.

9. **INSURANCE:** YOUR INSURANCE POLICIES MAY NOT PROVIDE COVERAGE FOR ACCIDENTS INVOLVING THE USE OF THIS SCOOTER. TO DETERMINE IF COVERAGE IS PROVIDED, CONTACT YOUR INSURANCE COMPANY OR AGENT **BEFORE** USING THE SCOOTER.

10. **OPERATOR AGE:** Do not allow anyone under the age of 16 to operate this scooter. This scooter is designed for operation by and the transport of only one person age 16 or older.

11. **SURROUNDINGS:** Ride your scooter in a controlled environment away from vehicles, obstacles, and other hazards. Never operate the scooter near steps or swimming pools.

12. **INTENDED USE:** This scooter is not designed or intended for stunt tricks, including but not limited to jumps, wheelies, and curb grinding. Keep both hands on the handlebar and both feet on the standing board while operating the scooter.

13. **SPEED:** The scooter's maximum speed is approximately 29 km/h (18 mph). For your safety, limit the speed to not more than 20 km/h (13 mph), and be careful to control your speed when descending hills. The scooter has a short wheel base and can become unsteady at excessive downhill speeds.

14. **VISIBILITY:** Do not ride your scooter at night or in conditions of poor visibility. If riding in such conditions is unavoidable, limit your speed to 15 km/h (10 mph) or less, turn on the lights on the scooter and wear reflective clothing or vest. Be ready to horn and brake at any time.



WARNING: Riding at dawn, dusk, or at times of poor visibility without a lighting system that meets state and local laws, and without approved reflectors, is illegal, dangerous, and can result in serious injury or death.

15. **TEMPERATURE:** The scooter battery is designed to have operating environmental temperature range. Riding temperature is between -10°C (14 °F) and 40°C (104 °F). Charging temperature is between 50 °F and 77°F. Storage temperature is between 50 °F and 77°F. Do not operate the scooter outside of the designed temperature range.

16. **WEATHER CONDITIONS:** Avoid riding in wet or icy conditions. Stop the scooter and walk it across rough or slippery road conditions.



WARNING: Wet or icy weather impairs traction, braking, and visibility for riders and other vehicles and pedestrians sharing the roads. The risk of accident is dramatically increased in wet or icy conditions. The scooter is not intended for use at elevations greater than 2000m above sea level. Prolonged exposure to UV rays and rain may damage the enclosure materials. Store indoors when not in use.

17. **SURFACE CONDITIONS:** The scooter is intended for use on hard, flat, dry paved surfaces without loose debris such as sand, leaves, rocks or gravel. Wet, slick, bumps, uneven or rough surfaces may impair traction and contribute to possible accidents. **Do not ride your scooter in mud, gravel, sand, ice, or water. Watch out for potential obstacles that could catch your wheel or force you to swerve suddenly or lose control. Avoid sharp bumps, drainage grates and sudden surface changes.** Stop the scooter and carefully walk it across rough or slippery road conditions.

18. **WATER RESISTANCE:** Although some water resistance measures have been made, riding the scooter through standing water, rain, wet or muddy conditions runs the risk of severely damaging it. Do not immerse the scooter in water or directly spray the scooter when cleaning. When parked outside where rain is possible, cover the handlebar controls with water resistant materials to protect the electric controls.

19. **SAFETY WHEN NOT RIDING:** When the scooter is not being used for riding, place it in a safe stable and secured environment. Keep it away from fire, water and other hazards. When the scooter is in its upright vertical self-standing mode, especially in moving public transportation or other crowded space, pay attention to its stability as accidental tip over could cause personal injury as well as damage to the scooter. **Always hold the retractable dolly handle to prevent it from tipping over and falling to the ground.**

20. **MAXIMUM RIDER WEIGHT:** Maximum rider weight is 255lb/115kg.

GLION MODEL 255 SPECIFICATIONS

Size	Unfolded Dimension	1180x1130x600mm (46"x45"x24")
	Folded Dimension	1080x470x230mm (43"x19"x9")
	Net Weight	19.4 Kg (42 lbs)
Performance	Maximum Load	115 KG (255 lbs)
	Top Speed	28 km/h* (High mode 17.5 mph) 19 km/h (Mid mode 12 mph) 8 km/h (Eco mode 5mph)
	Range	47 km * (30 mile)
Battery	Voltage	36V
	Type	Li-ion Battery
	Capacity	12.8 AH
Motor	Type	Brushless DC Motor
	Rated Output Power	400W
	Rated Voltage	36V
Charger	Input Voltage	100-240V
	Charging time 2A charger	5.5 hour

* Top speed and range per charge depends on rider weight, wind speed, temperature, riding style, riding surface, battery condition, and other factors. Actual top speed and range per charge may vary. **30 mile range is achieved under the following conditions: 150lb rider weight, 70 degree weather, constant 10mph speed, no stop and go, flat surface with wind speed less than 1 mph. Faster speed, 'stop and go' and higher rider weight will shorten range.**

GLION MODEL 255 PARTS DIAGRAM



Scooter Side View Unfolded

UNFOLD/FOLD INSTRUCTIONS

For video instructions, please visit our website at www.getglion.com. We encourage you to view the video instructions prior to unfolding/folding operation to avoid damage to your Glion scooter.

UNFOLDING YOUR SCOOTER:

For shipping safety, the bottle holder is taken off and included in the package. Instructions for installing the bottle holder is included below in step 4.



Step 1. Make sure the scooter is turned off. The LCD Display on the right handle grip should not be lit. If it is lit, press the middle power button for 2 seconds to turn it off.



Step 2. Step on the folding pedal and lift the handlebar. **Push the handlebar forward until you hear it click and lock into place in the unfolded or operating position. Make sure the folding pin completely sits at the bottom of the notch to avoid a folding accident.**



Step 3. Pull down the collar on the handlebar to release the collar lock. Lift the handlebar grips until the left and right t-bar collars (C) snap into place and the handle grips are locked in the operating position.

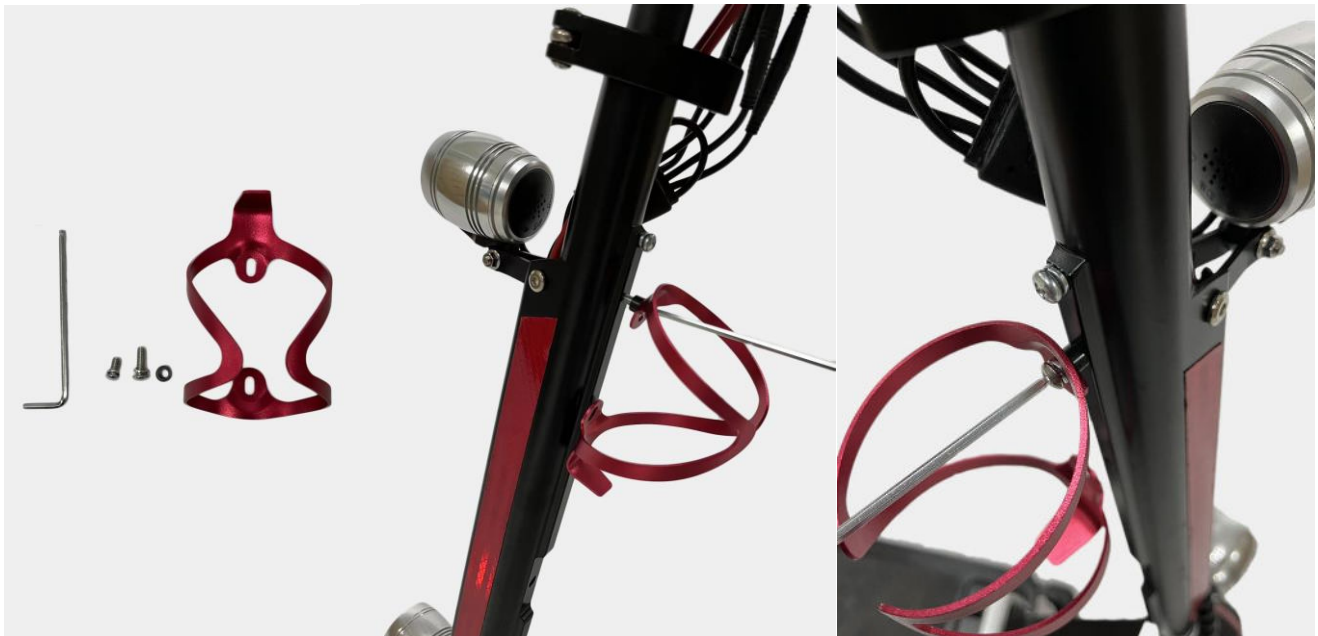

Step 4. Install the bottle holder using the Allen wrench and screws included in the package on the vertical handle bar. There are 2 screws and a small collar included in each package. Install the long screw together with the collar on the top position as show above. Then install the short screw in the lower position.

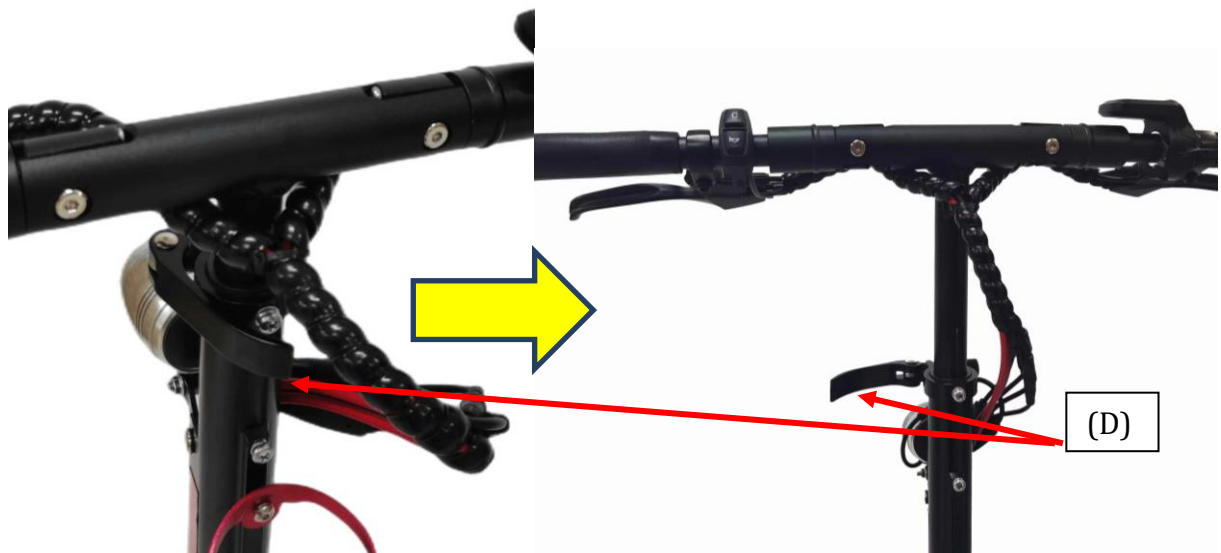

Step 5. Open the handlebar's quick release lever (D) to allow the upper telescope handlebar to be pulled.



Step 6. Press the handlebar retract positioning button and raise the handlebar to the desired height. **Tightly close the quick release lever (D). Make sure the quick release lever is securely tightened.** You should have to press firmly on the quick release lever to close it. If the quick release lever is loose when closed, open the quick release, thumb tighten the quick release thumb screw and then firmly close it. Press down on the t-bar to make sure t-bar does not retract down while quick release is locked. **IF T-BAR MOVES DOWN, MAKE SURE TO TIGHTEN THE QUICK RELEASE THUMB SCREW MORE AND TIGHTEN THE QUICK RELEASE LEVER AGAIN.**

FOLDING YOUR SCOOTER:

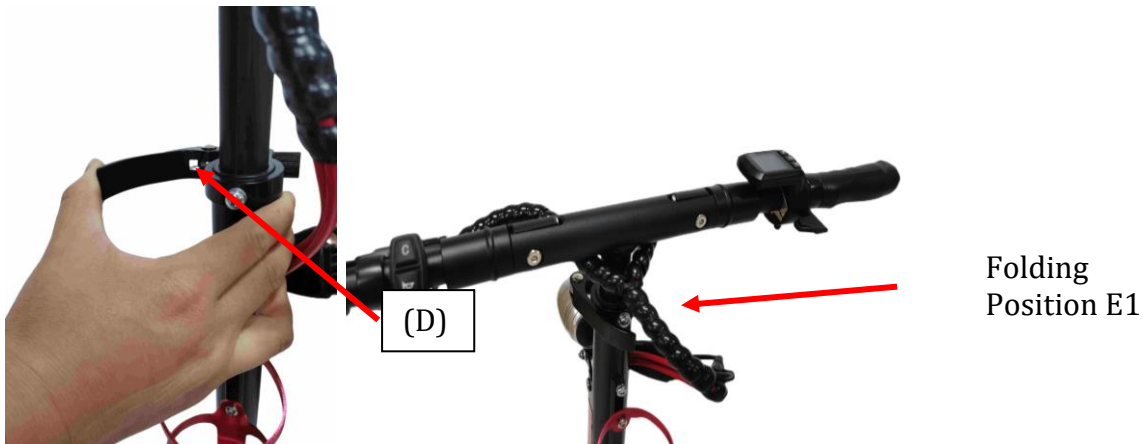

Step 1. Make sure the scooter is off. The LCD screen on the right handle grip should not be lit. Open the handlebar quick release lever (D). Lower handlebar T-bar to the folded position (E1). The handlebar retract positioning button should lock into place in the folded position. **Close the quick release lever (D). If you do not close the quick release lever, you should not proceed to fold the t-bar handle in step 2 below.**



Step 2. Fold the handlebar grips by first fully pulling the T-bar collar (C) out and then folding the grip down. Do the same for each side. **Be careful not to get your fingers in between the collar and the center of the t-bar to avoid being pinched in case the collar escaped your hold.** Use the other hand to hold the t-bar to add pulling strength as the collar spring is designed to be strong to maintain stability.

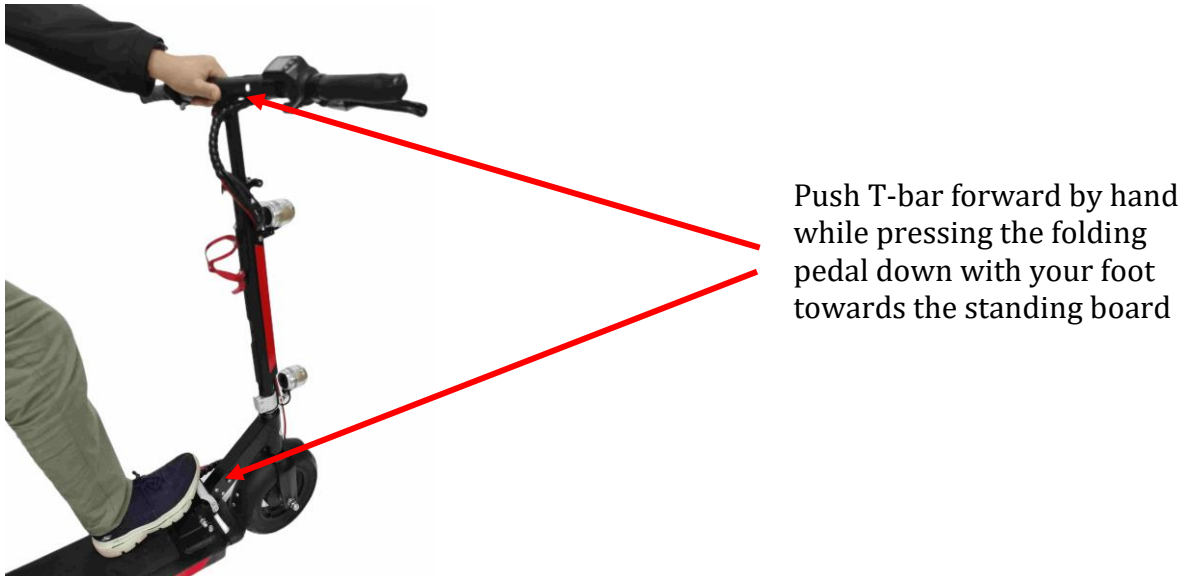

Step 3. **While pushing the T-bar a little forward**, put one foot on the folding pedal and press down towards the standing board. The folding mechanism should unlock. **(Pushing T-bar forward is very important as it unlocks the folding pedal. Without pushing T-bar forward while stepping on the folding pedal could damage the folding mechanism).**



Step 4. Fold down the handlebar until you hear a click and the folding mechanism locks into the folded position.

OVERVIEW OF YOUR GLION ELECTRIC SCOOTER



WARNING: For your safety, please take the time to familiarize yourself with the handlebar controls and with its movements and balance before attempting to ride your scooter with the motor engaged. Please see our demonstration videos on our website at www.getglion.com.

1. **Powering On/Off:** To turn the scooter on or off, you must press and hold for about 2 seconds the on/off switch in the middle of the LCD as shown below **(F)**. The LCD display is lit when the power is on and dark when off. The scooter will automatically turn off after five minutes of non-use.
2. **Head Light/Rear Light/Braking Light On/Off:** To turn the headlight/rear light on or off, you must first turn the power to the scooter on. While the scooter power is on, quickly press the on/off switch once, the headlight/rear light should be turned on. Flash press a second time, the light will be turned off. While the scooter is powered on, squeezing either/both of the hand brakes will turn on the braking light on the rear fender. Again, to turn on or off the scooter, press and hold for about two seconds. Turning the lights on or off is a quick press.

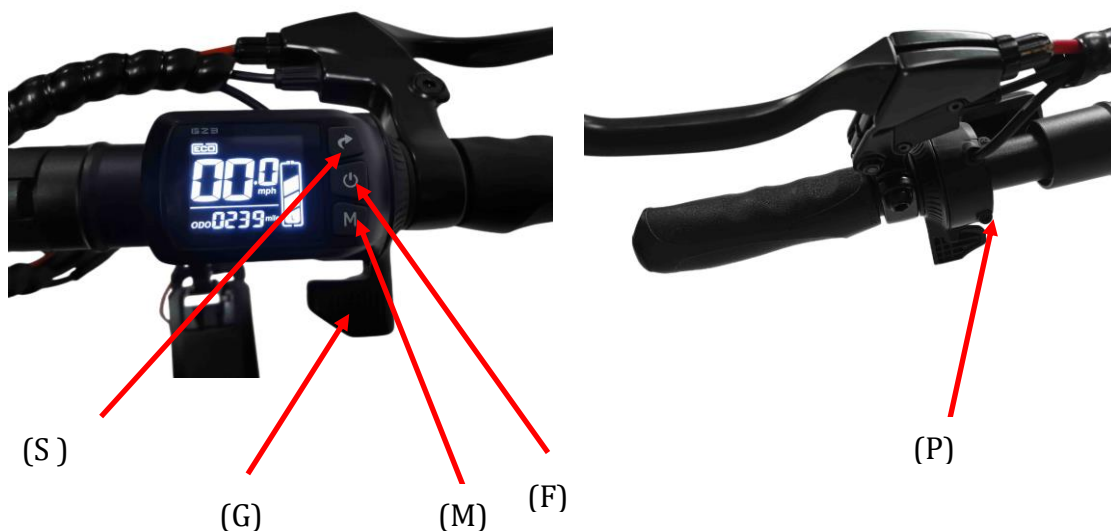

3. **Accelerator, LCD Display, Speed Setting, and Battery Indicator:** The thumb press tab is the accelerator **(G)**. The further you press down the accelerator, the more energy you will release to the motor. **NOTE:** As a safety feature, to prevent unintended motor engagement, the motor will not start from a stand-still position should you accidentally press the accelerator. The scooter controller must detect motion from the motor before it releases energy to the motor. You must first manually kick the scooter forward to get the motor wheel to move for initial speed before the controller releases energy to the motor. Also, the scooter is rear wheel drive. Be sure to have your body weight towards the front of the scooter when engaging the motor to avoid a wheelie. Use provided Allen wrench to loosen/tighten the **LCD positioning set screw (P)** underneath the LCD screen to adjust the LCD screen and accelerator for your viewing and pressing angle. **Make sure you do not over tighten the set screw to hinder the thumb press accelerator operation. Test the thumb press accelerator:** While the scooter is powered off, use your right thumb to press down the accelerator tab and then release it. The tab should spring back smoothly once you release the pressure on the tab. Try a few times to make sure the tab springs back smoothly. If not, please loosen the LCD positioning set screw a little bit. Make sure it is not too tight or too loose. If it's too loose, your LCD screen will be moving while accelerator is pressed.

There are 3 speed settings: Eco, Mid and High. Short press Speed Mode (S) once to toggle through speed mode settings. For each of the settings top speed, refer to page 6 specifications. The scooter default speed is Eco mode for your safety. Please practice balancing and riding skills using Eco mode in a controlled safe environment before using Mid or High mode. **Note:** Never press and change speed mode while riding the scooter. Always stop first before changing the speed mode.

The M button (M) on the LCD display is for single trip mile/battery, voltage/odometer and Walking Mode. Long pressing it will initiate the Walking Mode, propelling the scooter to

move at a constant 2mph speed. Release the button to stop Walking Mode. Short press the M button once will show single trip mileage – distance traveled since the scooter is turned on. Turning off the scooter power will reset the single trip mileage back to zero. Short pressing the M button again will show the battery voltage. The voltage should be between 30 volts (completely drained) and 41.8 volts (fully charged).

Speed, Battery Level Indicator and Odometer. When the scooter is turned on speed, battery level and odometer is shown on the LCD display. We encourage users to charge the battery while battery level is at half to prolong battery life span. **Do not check the battery level when operating the scooter. The battery indicator is only accurate when the motor is not engaged.** To better understand battery level, short press the M button to check the voltage. Battery is near empty if it is close to 33 volts.



- 4. Brake:** The scooter comes with both front and rear braking. The left hand side is the rear braking and the right hand side is the front braking. Always apply the left hand rear braking before applying front braking to avoid throwing yourself towards the front, especially going downhill. As an additional safety feature, the scooter is designed to cut power to the motor when the brake is applied. In the case where the brake is applied, the motor will not start to prevent accidents. **In a safe, controlled environment, please familiarize yourself with the braking distance of the scooter at different speeds before operating near intersections, pedestrians and other obstacles.**



- 5. Cruise Control and Horn:** The scooter's left handle is equipped with a horn and a cruise control button. A short press will initiate the horn. To activate the cruise control while riding, just press the control once to cruise at the current speed (equal or under the top speed of the current speed mode). To stop the cruise control, apply either of the hand brakes. **Always be ready to brake at any time while cruise control is activated.**



6. **Kickstand:** The kickstand (H) is located towards the rear wheel on the left side of the standing board. Be sure to always lift the kickstand before beginning operation of the scooter.
7. **Dolly Feature.** The Dolly Feature includes the wheelies located behind the rear wheel and the retractable handle located at the front of the standing board. The dolly handle has two positions. Position 1: The closed position. Here, the dolly handle is fully retracted into the board and locked into place so that it cannot be extended without first pressing the center button. Position 2: The dolly handle is extended. This position is for rolling the folded scooter behind or next to you. The wheelies allow the scooter to roll by your side and also to stand vertically with the wheelies and the T-bar as the base. See Dolly Features on later pages for further details.



WARNING: For your safety and for the safety of others, please take the time to practice accelerating, braking and familiarize yourself with the scooter's braking distance in an open and safe area before taking your scooter out into the general environment. IT IS YOUR RESPONSIBILITY TO MAINTAIN CONTROL OF YOUR SCOOTER AT ALL TIMES!

OPERATING YOUR GLION ELECTRIC SCOOTER

Getting Ready:

1. Fully charge the battery. For safety reasons, the battery is only 80% charged when shipped from the factory (See Page 16 Battery Charging Instructions Below).
2. Choose a controlled environment away from vehicles, obstacles, and other hazards for riding. **Even if you have experience with motorized scooters, vehicles, bicycles, etc., you must familiarize yourself with the function, handling, braking distance, performance, and safety of this scooter in a safe and controlled environment.**
3. Always check and obey all local laws and regulations. *Your insurance policies may or may not provide coverage for accidents involving the use of this motorized scooter. To determine if coverage is provided, check with your insurance company or agent. Do not assume your existing insurance policies provide coverage.*
4. Unfold the scooter (See Unfolding Instructions above).
5. Adjust the handlebar to height of your choosing.
6. Raise the kickstand.
7. Complete a final roadworthiness safety check before operation.
 - a. Make sure folding mechanism, handlebar height, dolly handle and handlebar quick release, wheel lug nuts, other nuts, bolts, fasteners, etc., are secure.
 - b. Inspect the frame, fork and handlebars for cracks or broken connections.
8. IF RIDING YOUR ELECTRIC SCOOTER FOR THE FIRST TIME, FAMILIARIZE YOURSELF WITH ITS MOVEMENTS AND BALANCING ON IT BY **MANUALLY OPERATING IT WITH THE POWER TURNED OFF. CAREFULLY CONTROL YOUR SPEED!** IN A SAFE AND CONTROLLED ENVIRONMENT, ON A FLAT SURFACE, FACING FORWARD, WITH BOTH HANDS SECURELY ON THE HANDLEBAR GRIPS, PLACE ONE FOOT TOWARDS THE FRONT OF THE STANDING BOARD AND THE OTHER FOOT ON THE GROUND. USE THE GROUND LEG TO MANUALLY PUSH OR KICK THE SCOOTER FORWARD. ONCE YOU GAIN SOME SPEED, GENTLY PLACE THE GROUND FOOT ON THE STANDING BOARD BEHIND YOUR FRONT FOOT. REPEAT THE SAME MOVEMENTS ONCE THE SCOOTER SLOWS DOWN TO KEEP IT PROPELLED FORWARD. RIDING THE SCOOTER WITHOUT THE POWER ENGAGED DOES NOT DAMAGE IT. **DO NOT OPERATE THE SCOOTER WITH THE POWER TURNED ON UNTIL YOU FEEL CONFIDENT MANUALLY**

PROPELLING THE SCOOTER. THEN FOLLOW BELOW INSTRUCTIONS AND TRY RIDING IT POWERED ON WITH THE SPEED SETTING AT DEFAULT ECO LEVEL.

Riding the Scooter Powered:

1. Raise the kickstand.
2. Press and hold the power button about two seconds to turn on the scooter. The LCD screen should be lit when the scooter is turned on. The default speed setting is Eco. Adjust the speed setting according to your needs.
3. With both hands on the handlebar and one foot located towards the front half of the standing board and one foot on the ground, manually push the scooter forward and slowly press the accelerator. **The scooter is rear wheel drive. Be sure to have the foot on the standing board located towards the front of the standing board when engaging the motor to avoid a wheelie.**
4. As the motor begins to slowly propel the scooter forward, place the foot which pushed off the ground onto the riding board behind your front foot. Press the thumb accelerator more to increase speed and carefully glide on (Glīon). Remember, as a safety feature, you will have to manually propel the scooter to get the motor moving before the electric motor will engage. If you manually propel the scooter and the motor does not engage, it might be because you did not reach the minimum speed.

Stopping the Scooter:

1. Squeeze the left hand brake to begin the braking process. The harder and faster you squeeze, the quicker the stopping process. If more braking power is needed, also squeeze the right hand brake. In a safe, controlled environment, please familiarize yourself with the braking distance of the scooter at various speeds before operating near intersections, pedestrians and other obstacles.



WARNING: Always ride at speeds you can comfortably and safely control. Take the time to familiarize yourself with the hand brakes and the distance it takes to come to a complete stop at various speeds. Keep both hands on the handle grips while operating the scooter at all times. Failure to do so could result in serious injury or death.

BATTERY AND CHARGER

Each electric scooter is equipped with a lithium battery and a smart charger designed specifically for each other. **ONLY USE THE CHARGER SUPPLIED BY THE MANUFACTURER TO CHARGE THE SCOOTER.** Do not charge the battery with any other charging system. If the battery or charger is damaged due to improper use, the limited manufacturer warranty shall be void. Do not operate the charger near flammable materials such as carpet. Ensure a dry environment. Never allow the charger or cable to come into contact with water as this may result in electric shock. Never touch the charger or cable with wet hands. Disconnect the charger from the outlet if any fault arises during charging. Always pull the plug, not the cable. Do not allow the charger or cables to be damaged or crushed by sharp edges or heat. The charger supplied with the electric scooter should be regularly examined for damage to the cord, plug, enclosure and other parts. In the event of such damage, the scooter must not be charged until the charger has been repaired or replaced. Unplug the charger and disconnect from the scooter when not in use.

BATTERY:

1. Fully charge the battery before first time operation or first time after a long period of non-usage (see *Instructions For Charging* below). For safety reasons, the battery is only

80% charged when shipped from the factory. The battery is fully charged when the LED light on the charger turns green.

2. Always charge the battery in a clean, dry location, free of debris.
3. Charge the battery frequently. The battery can be recharged at any time. Do not think that you need to fully deplete the battery before recharging it. In fact, frequent partial discharge/charge cycles will prolong the battery life vs. full discharge/charge cycles.
4. Fully charge the battery before storing the scooter for extended periods.
5. When not in use, periodically recharge the battery once every three months.
6. Battery damage due to water, collision, improper storage and other non-normal factors is not covered by the limited manufacturer warranty.

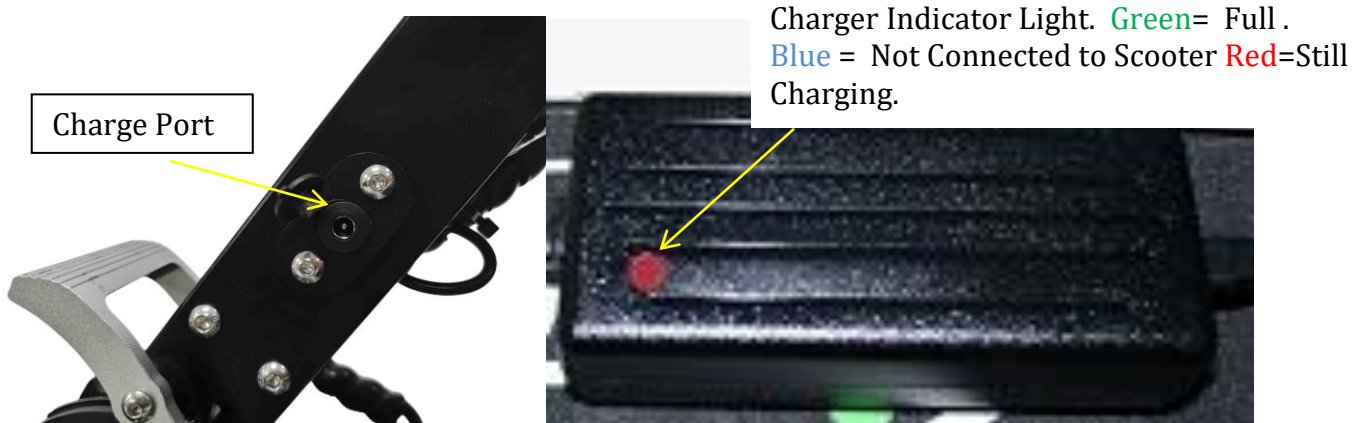

CHARGER:

1. When you plug the charger into the wall outlet and before you connect it to the scooter, the LED light on the charger shows blue. The battery is charging the scooter when the LED light on the charger is red. When the battery is 95% full, it will turn green. It will continue to charge with very small current for about 30 minutes after the LED turns green. When battery is 100% full, the charger will stop charging and the charging light will remain green.
2. The provided charger has a built in overcharge protection to prevent the battery from being overcharged.
3. Charging time is approximately 5.5 hours for a fully discharged battery.
4. Regularly inspect the charger for damage to the cord, plug, enclosure and other parts. In the event of such damage, the charger must not be used until it has been repaired or replaced.
5. Unplug the charger from the wall outlet when not in use.
6. Use only the charger supplied with this scooter or a recommended replacement specified by Glion.
7. Charger supplied by Glion is Model No. HP1202L3(90w), manufactured by High Power Technology (KunShan) Inc. Operating temperature is 0°C (32° F) ~ 40°C (104° F).



WARNING: Failure to confirm compatibility, properly install, operate and maintain any charger, component or accessory can result in serious injury or death.

INSTRUCTIONS FOR CHARGING:

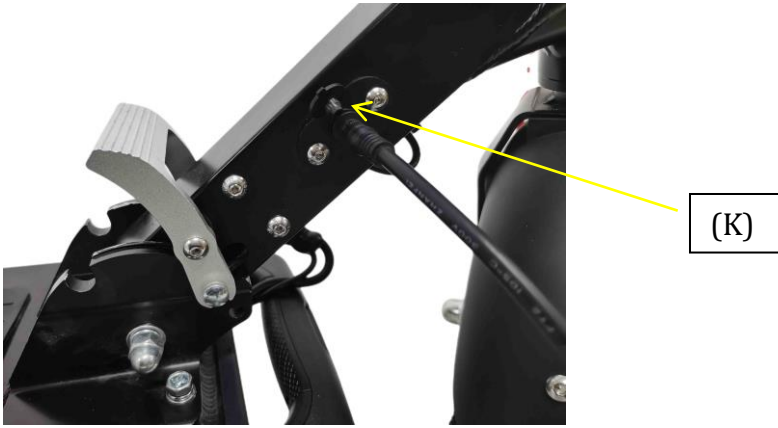

1. Turn the scooter off. The charge port **(K)** is located on the right side of the neck of the scooter above the folding mechanism. Open the charge port rubber protective cover and securely plug the charger into the charge port.
2. Plug the charger into the power outlet.
3. A solid red light on the charger indicates the battery is charging. A solid green light indicates the battery is fully charged.
4. Remove the plug from the power outlet, then remove the charger from the scooter's charge port. Secure the charge port rubber protective cover.

USAGE:

1. You will not damage the battery by riding the scooter until the battery is fully discharged and the scooter motor shuts down. However, we do ask to promptly recharge the battery after a full discharge. Do not store your scooter with an empty battery.
2. Avoid operating the scooter when the battery is hot.

DOLLY FEATURE

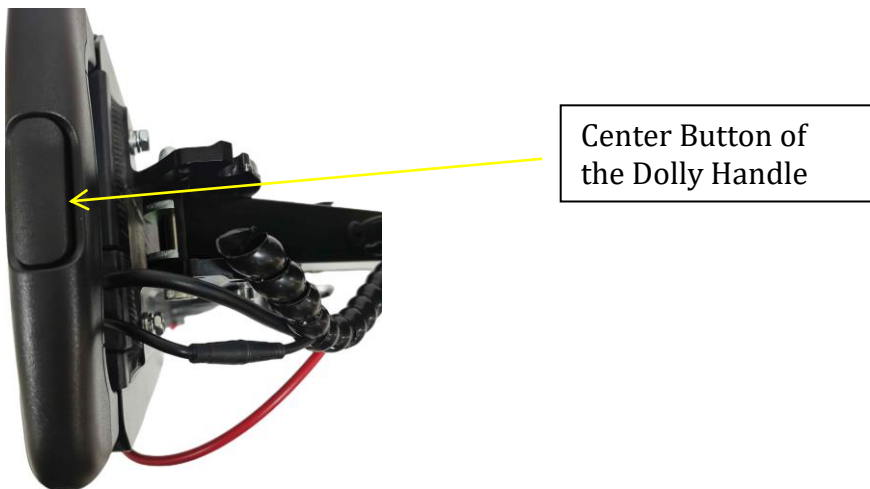

You must press the center button of the dolly handle to extend it from the board or retract it into the board. When you fully retract the dolly handle into the board, make sure the handle locks into the operating position and is secure so that it cannot be extended without first pressing the center button on the dolly handle.



The dolly handle has two positions. Position 1: The closed position. In this position, the dolly handle is fully retracted into the board and locked into place so that it cannot be extended without first pressing the center button. Position 2: The dolly handle is extended. This position is for rolling the folded scooter behind or next to you. (The wheelies allow the scooter to roll by your side and also to stand vertically with the wheelies and the T-bar as the base.)

SCOOTER COVER (OPTIONAL ACCESSORY)

1. Cover Installation and Removal

Fold your Glion Electric Scooter and place it horizontally on the floor and drape the cover over the front tire and across the scooter.



Pull the bottom of the cover over the T-bar so the cover now extends from the front tire on one side to the bottom of the T-bar on the other side.



Tilt your scooter upright and zip the cover down to the rear tire.



To Remove the Scooter Cover Reverse the Installation Steps.

2. Helmet Pocket and Handlebar Carrying Access



The scooter cover has a side pocket allowing rider to store helmet as shown above. The scooter cover also has two slits in the side so you can easily carry the scooter holding the lower handlebar downtube.

3. Cover Storage Pouch



The scooter cover also serves as a storage pouch for the cover. The cover can be stuffed into a sewn pouch located inside of the cover. First, access the pouch from the opening in the cover for the retractable handle and carefully reverse the pouch so you can see the pouch's Glion logo. Stuff the scooter cover inside of the pouch. The pouch's Glion logo should continue to face outside.



WARNING: Check to make sure the dolly handle is fully retracted into the board and locked into place before operating the scooter. Failure to do so could result in serious injury or death.

GLION ELECTRIC SCOOTER MAINTENANCE

MECHANICAL:

1. Due to vibration nuts and bolts can become loose. Make sure that all lug nuts, other nuts and bolts are securely fastened and tighten them if necessary. To test: Pick your scooter up 1-2 inches and bounce it off the ground. Do a quick visual and tactile inspection of the whole scooter. Make sure you inspect all visible nuts, bolts, and structural welds. If anything sounds, feels, or looks loose, or shows signs of stress replace or secure them.



WARNING: Like any mechanical device, an electric scooter and its components are subject to wear and stress. Different materials and mechanisms wear or fatigue from stress at difference rates and have different life cycles. If a component's life cycle is exceeded, the component can suddenly and catastrophically fail, causing serious injury or death to the rider. Scratches, cracks, fraying and discoloration are signs of stress-caused fatigue and indicate that a part is at the end of its useful life and needs to be replaced. While the materials and workmanship of your electric scooter or of individual components may be covered by a warranty for specified period of time by the manufacturer, this is no guarantee that the product will last the term of the warranty. **Product life is often related**

to the kind of riding you do and to the treatment to which you submit your electric scooter.

BATTERY:

When used normally, the lithium battery provided with your scooter should not lose more than 30% of its capacity within the first 500 charging cycles. Average battery life for a properly maintained lithium ion battery is approximately 1,000 charge/discharge cycles. If you notice your travel distance significantly diminished despite having a full charge, it is a sign the lithium ion battery needs to be replaced.

Fully charge the battery before storing the scooter for extended periods. Periodically recharge the battery at least every 3 months during storage. Leaving the battery depleted and uncharged for more than 3 months could permanently damage the battery and is not covered by warranty.



**WARNING: Risk of Fire – No User Serviceable Parts
AVERTISSEMENT- Risque d'incendie et de choc électrique -
Aucune des pièces ne peut être réparée par l'utilisateur**

BATTERY DISPOSAL:

Your Gliion product uses lithium ion batteries, which must be recycled or disposed of in an environmentally safe manner. Do not dispose of a lithium ion battery in a fire. The battery may explode. Do not dispose of a lithium ion battery with your household trash. The incineration, landfilling, or combining a lithium ion battery with your household trash is prohibited in most jurisdictions. Locate a place that collects and recycles lithium ion batteries. To search online, go to www.call2recycle.org and enter your zip code, or if you prefer to locate a place by phone, dial 1-877-2-RECYCLE to find the nearest retailer that collects lithium ion batteries.

STORAGE AND DAILY CARE

1. Do not store the scooter in direct sunlight, in damp places, or in temperatures below -10° C (14° F) or above 40° C (104° F).
2. Fully charge the battery every three months if not in use.
3. Keep the scooter clean (See section on Cleaning and Servicing).

GENERAL TROUBLESHOOTING

If you experience problems with your scooter, please refer first to the following troubleshooting guide:

Problem: The scooter does not power on.

Possible causes/solutions:

1. The scooter is not turned on. **Solution:** Turn on scooter by pressing and holding the on/off button approximately 2 seconds.
2. The battery is not charged. **Solution:** Charge Battery.
3. The wire connectors near the neck or handlebars are loose. **Solution:** See below instructions for how to check wire connectors.

How to check wire connectors:

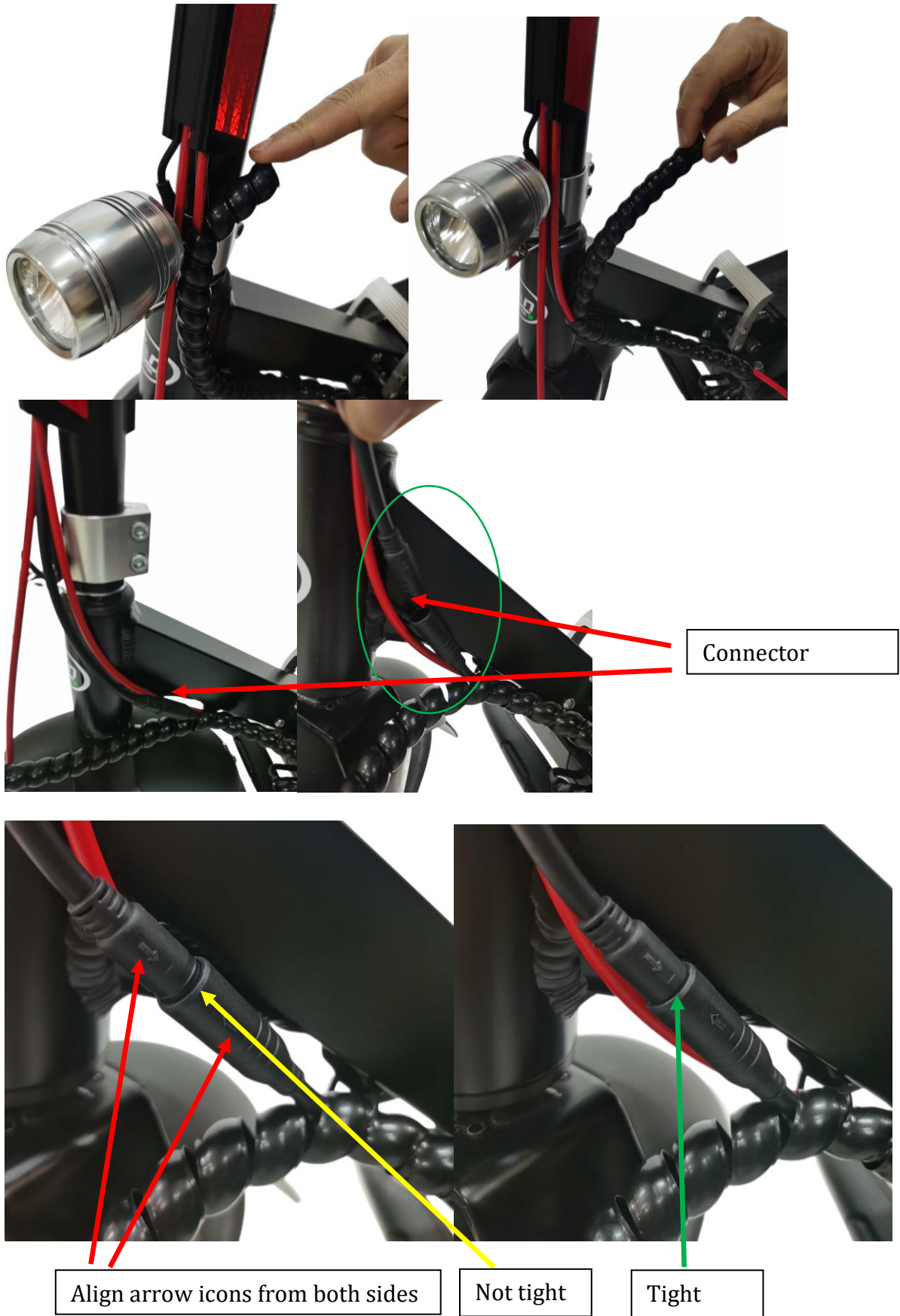

A: Neck wire main connector: There are 2 connectors located inside of the wrapping material near the neck area. You need to first unwrap it to expose the connectors. Starting from behind the lower headlight where the wiring comes out of the lower handlebar, slowly unwind the curly wrapping material to expose the wires. After unwrapping this section of the material, you should see the **main water resistant connector**. Check the connector to see if it's fully seated. If not fully seated, align the

arrow icons on both sides of the connector and firmly connect them. Make sure it is fully seated and tight.



There is another smaller connector along this wiring near the neck. That is for the charging port. If the scooter battery is not taking charges, this connector may need to be checked. If it is loose, you can see the color in between the two sides of the connector. Just align the arrows from both sides and plug them firmly together until tight.



B: Upper handlebar connectors: There are five connectors behind the upper headlight. If any of them are loose, you can see the inside color between two ends of the connectors. Make sure they are all tightly connected.

Problem: The Scooter braking is soft.

Possible causes/solutions:

Braking cable wire needs to be adjusted. **Solution:** Tighten the braking cable for front wheel or rear wheel by turning the wire bolt clockwise as shown in below pictures.



Front & rear braking cable adjustment

Problem: The Scooter Operates Intermittently.

Possible causes/solutions:

1. The battery is low on charge **Solution:** Recharge Battery.
2. Power connector is loose. **Solution:** Refer to above “Power Not On” problem and check the connectors.

Problem: Short ride time/runs slow.

Possible causes/solutions:

1. Rider weight. **Solution:** Do not exceed 115 kg (255 lbs.) maximum weight limit.
2. Riding conditions. **Solution:** Use only on flat, dry surfaces. Avoid steep inclines and areas with debris on surface.
3. Battery not fully charged. **Solution:** Charge battery until full.
4. Old/Damaged Battery. **Solution:** Replace Battery. Contact Customer Service on our website: www.getglion.com.
5. Deflated tires or flat tires. **Solution:** check tire pressure. Contact Customer Service for replacement tires and how to fix flat tires.

IF YOU’VE CONSULTED THE TROUBLESHOOTING GUIDE AND ARE STILL HAVING PROBLEMS WITH YOUR SCOOTER, PLEASE CONTACT CUSTOMER SERVICE AT: support@getglion.com. Also visit our website for replacement parts, product support, and instructional videos. Use only replacement parts supplied by Glion.

CLEANING, STORING, AND SERVICING

1. **KEEP YOUR SCOOTER DRY:** Do not ride your scooter in wet conditions unless unavoidable. Dry off your scooter immediately and do not store in the vertical position for 48 hours.
2. **KEEP YOUR SCOOTER CLEAN:** Remove dust and dirt from your scooter with a wrung-out, damp rag. Dry immediately. Never use solvents. Do not spray your scooter down with water or submerge it. Keep hair and carpet fibers free from axles.
3. **STORAGE:** Battery performance is susceptible to temperature. Do not store your scooter in direct sunlight or in a high temperature environment like inside of your car. Store your scooter indoors, out of the elements. Room temperature is ideal for storage. Avoid storing the scooter in wet environments. Recharge the battery in full after it has been completely discharged and before storing the scooter for longer periods. Even in storage, please monitor the battery level and recharge the battery fully at least once every 3 months. Storage temperature should be between -10° C (14° F) or above 40° C (104° F)
4. **SERVICE AND DISPOSAL.** Should your scooter require service, please contact customer service at: support@getglion.com. Your satisfaction is our greatest priority! **If you need to dispose of the scooter, please make sure you take out the battery from the battery compartment and contact a local recycling agency for battery disposal instructions. Battery must not be disposed together with waste as it has high risks of causing fire, explosion and pollution if not handled properly. Please dispose of the rest of the scooter according to your local laws and regulations.**

PRODUCT REGISTRATION

We encourage you to register your Glion Electric Scooter with us. Registration helps us ensure your continued satisfaction and enables us to contact you with new product instructions. Also, registration and proof of purchase are necessary to make a warranty claim. Please register your Glion Electric Scooter at www.getglion.com/product-registration/. Please keep your original

proof of purchase in a safe place in the event of a warranty claim. We recommend keeping your box and packaging material in the event you need to send the scooter in for repair or maintenance.



WARNING: Please register your electric scooter with us. If you don't, we may not be able to contact you directly with important safety recall information.

GLION LIMITED WARRANTY

Your Glion Electric Scooter is covered by a warranty. For the specifics of this warranty, visit our website at www.getglion.com.

UNDER NO CIRCUMSTANCES SHALL PROBITY CELL LLC, DBA GLION® (“Probity Cell”) BE LIABLE FOR CONSEQUENTIAL, INCIDENTAL OR SPECIAL DAMAGES ARISING DIRECTLY OR INDIRECTLY IN CONNECTION WITH USE, OR INABILITY TO USE, THIS PRODUCT. IN NO EVENT SHALL PROBITY CELL’S LIABILITY FOR BREACH OF WARRANTY, BREACH OF CONTRACT, NEGLIGENCE OR STRICT LIABILITY EXCEED THE COST OF THE PRODUCT COVERED HEREBY. NO PERSON IS AUTHORIZED TO ASSUME FOR PROBITY CELL ANY OTHER LIABILITY IN CONNECTION WITH THE SALE OF THIS PRODUCT.

Some states do not allow the exclusion or limitation of consequential, incidental or special damages, so the above limitation or exclusion may not apply to you. Probity Cell’s limited warranty gives you specific legal rights, and you may also have other rights, which vary from state to state.

YOUR INSURANCE POLICIES MAY NOT PROVIDE COVERAGE FOR ACCIDENTS INVOLVING THE USE OF THIS SCOOTER. TO DETERMINE IF COVERAGE IS PROVIDED, YOU SHOULD CONTACT YOUR INSURANCE COMPANY OR AGENT.