

mode
earn phone

MEP2 User Manual

OVERVIEW

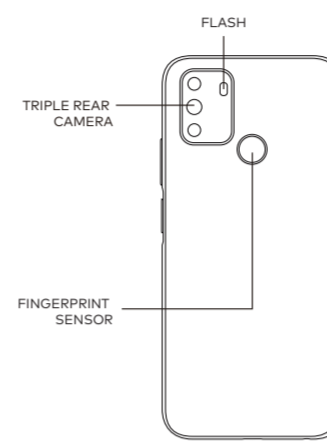
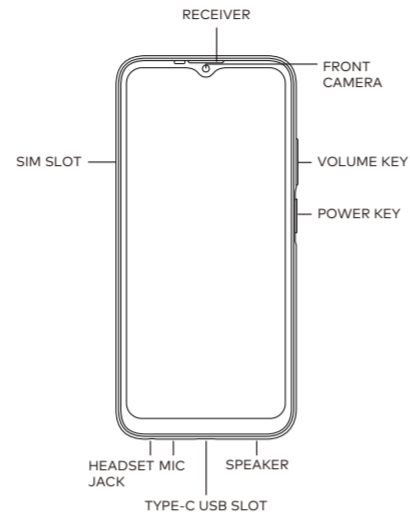

FEATURES

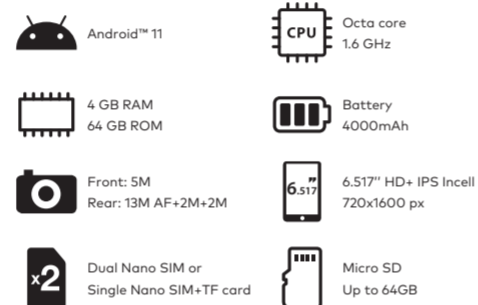

GETTING STARTED

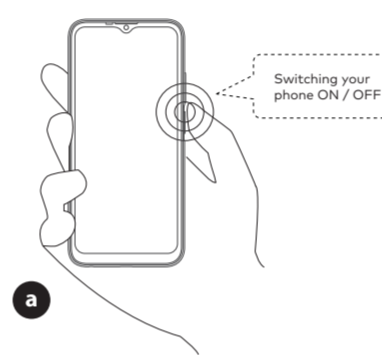

GETTING STARTED

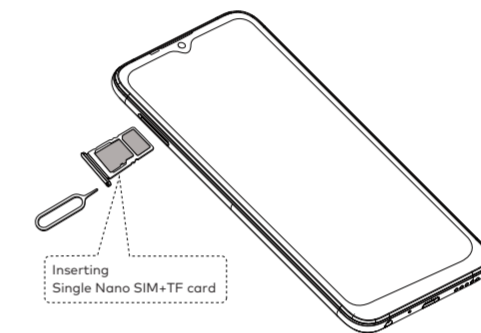

STATUS BAR

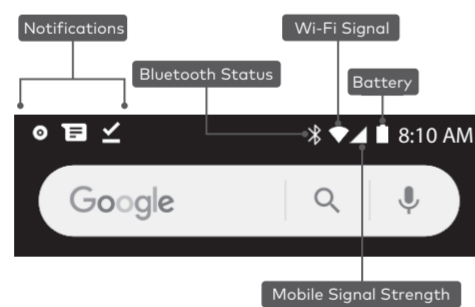

QUICK SETTINGS

Use Quick Settings to easily get to frequently used settings, like turning on airplane mode. To open Quick Settings, swipe down twice from the top of the screen. To change the setting, just touch the icon.

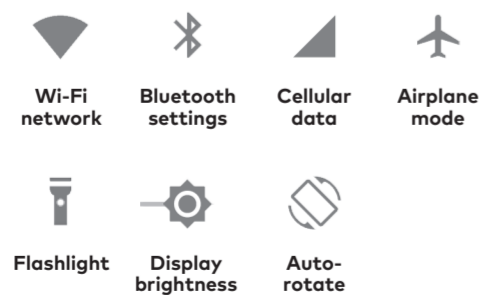

Organize your Home screens:

- To change your wallpaper, add a shortcut, adjust Search settings, or change screen order, touch & hold the background of any Home screen.
- You can have any number of Home screens. To add a new screen, drag an app from the apps drawer to the rightmost part of the home screen.
- To create a folder, slide one icon quickly on top of another.
- To name or rename a folder, open it and touch its name.

To change the wallpaper:

- Touch & hold the background, then touch Wallpapers.
- Swipe right to left to choose a wallpaper image.
- Touch Set wallpaper to set the image chosen.

To add an app icon to a Home screen:

- Go to the Home screen where you want to place the app.
- Swipe up to show the App Drawer.
- Swipe down, to find the app you want.
- Touch & hold the app until the Home screen appears, slide it into the desired location.

Note:

To remove an app icon from the Home screen without removing it permanently from your device, touch & hold it, slide your finger toward the top of the screen, and drop the app over Remove.

To add Shortcuts:

- Touch & hold the background, then touch Shortcuts.
- Choose a shortcut you want to add on your home screen.
- Touch & hold the selected shortcut until the home screen appears, then release hold when placed in the desired location.

Settings



Settings controls the core Android settings for networks, hardware, location, security, language, accounts, etc. You can control many other settings for your device and account by swiping down from the top of the screen twice and touching the settings icon.

App Drawer



To open your app drawer, just swipe up anywhere from your home screen. This is where you can see all your apps, including those that come with your phone and those you downloaded on Google Play. You can move app icons to any of your Home screens.

From the App Drawer, you can:

- Open an app by touching its icon.
- Place an app icon on a Home screen.
- Get more apps by downloading on Google Play.

Google and Android are trademarks of Google LLC. The Android robot is reproduced or modified from work created and shared by Google and used according to terms described in the Creative Commons 3.0 Attribution License.