

Master Password Guide

stashcan®

meet the StashCan®.
the voice-activated, app-controlled
lockbox.

Patent Pending 2021 LockedBrands LLC.
LockedBrands, The StashCan® and the LockedBrands logo are all trademarks of LockedBrands LLC.
All Rights Reserved.

Next

Master Password Basics

- Each StashCan® has its own specific master password which is automatically created when you register it.
- The master password can be accessed from two places:
 - From the email that you registered your StashCan® with.
 - Within the StashCan® app with versions E1.0101 and newer.

Master Password Basics

When to use your master password:

- The master password can be used at all times, even if your StashCan® is not connected to WiFi.
- However it was designed to be used as a last resort to open the box -- when all else fails. If your lockbox cannot connect to internet, WiFi access, or no Voice ID is enabled. For example, your lockbox cannot connect to public wifi like most hotels offer. That would be an ideal time to use the Master Password to open your lockbox.

This Guide will walk you through all of the steps. Let's get started!

How to enter the Master Password

- Start by opening the StashCan® app and pressing the “Master Password” button on the menu.

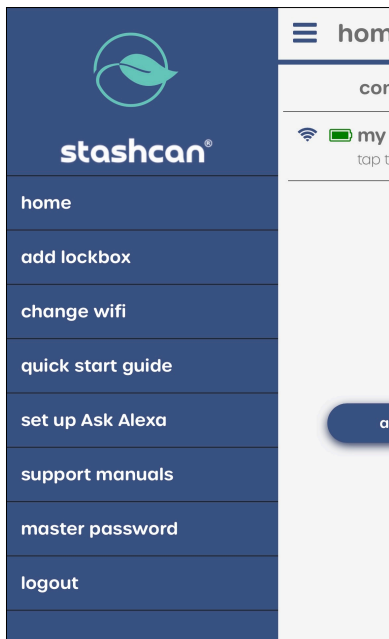

How to enter the Master Password

- To enter the Master Password, your StashCan® needs to be reset. This is done with the following steps:
 1. Hold down the reset button for 10 seconds until the LED ring becomes yellow.
 2. Release the button once the LED ring turns yellow.
 3. The LED ring will turn purple after releasing the reset button. You are now in Master Password mode.

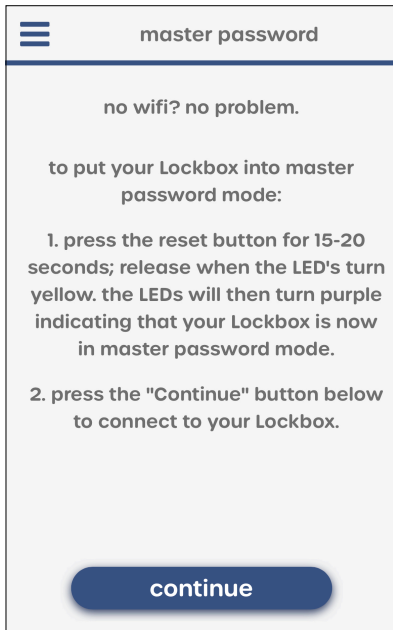

How to enter the Master Password

When the StashCan®'s LED light is purple:

4. On any smart device, open Settings and go to WiFi.
5. Select and connect to the Network that begins with "Lockbox".
6. Wait for your device to connect to the StashCan®.

*It will show a check mark when connected.

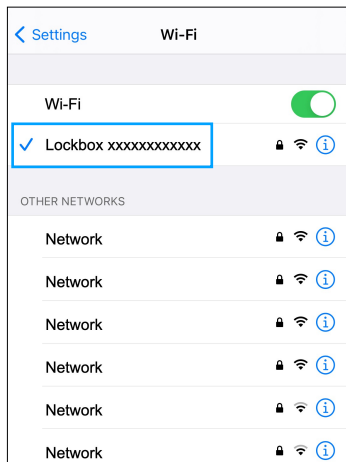

How to enter the Master Password

7. Return to the StashCan® app
8. Press on the continue once you have connected to the Lockbox's network.

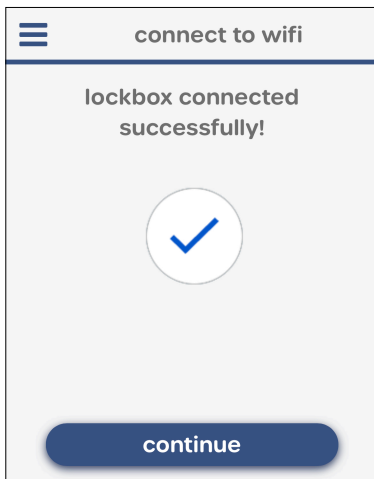

How to enter the Master Password

8. The Master Key input screen will appear with the master password automatically filled. If not, the master password can be found in the registration email you received when you registered the StashCan®.

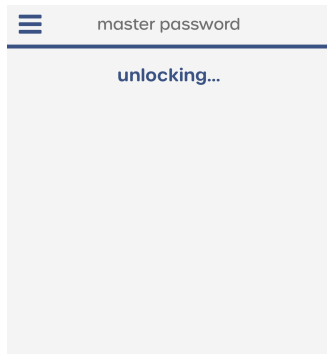
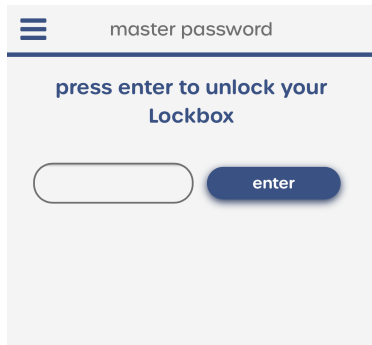

Congratulations, you are now able to open your StashCan®!

How to exit Master Password Mode

9. To exit Master Password mode, press "exit". You will be prompted to 'cycle power' and then press continue. To cycle power, simply turn your lockbox off and back on. The app will refresh & bring you back to the home screen.

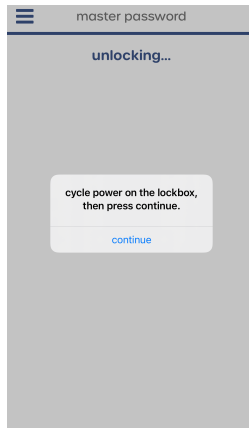
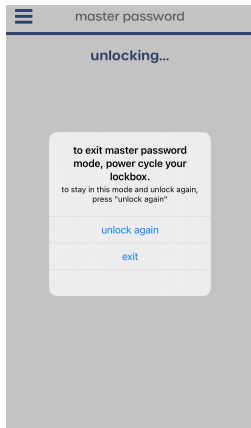

stashcan®

Patent Pending 2021 LockedBrands LLC.
LockedBrands, The StashCan® and the LockedBrands logo are all trademarks of LockedBrands LLC.
All Rights Reserved.