



Daisy Chain

with Emily Miller

Spring is finally here, and time for a refresh on a seed bead classic, the daisy chain! Variations on this simple theme have been around for years. They make great rings, bracelets, and necklaces; you might even see them as eyeglass leashes! Emily looked around at all the different styles and (not loving any of them) came up with a new spin, just for beadshop.com! She'll show you two projects to try, the Posy Ring so you can have a little bit of springtime on any finger (and what a sweet gift for a friend!), and the easy to wear Groovy Necklace that will have you channeling hippie summer vibes. This is such a cool project and it will travel well, if you are planning a trip to the beach or the mountain meadows you can bring your



For these projects you'll want a variety of 11/0 Miyuki Seed Beads for your petals/leaves, and an 8/0 for the centers. You'll be stringing on 4lb FireLine and using Size 12 Beading Needles

Let's get started!

Right Angle Weave is stitched in a circle of beads, with one bead on each side, in order to add more beads, add 3 more beads to a common side. Continue to pass through beads as many times as needed to get into position to add the next group of beads. The thread will always turn a corner, (or right angle) between the beads.

Posy Ring

Step 1

Cut a 1 yard piece of FireLine, and add a size 12 beading needle.

Step 2

Pick up one 11/0, one 8/0, and two 11/0 beads. Move the beads down the thread, within about 8" of the end of the thread.

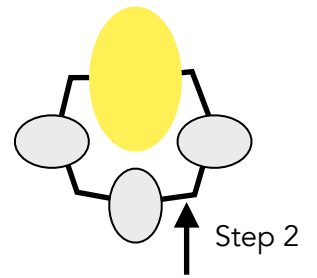

Step 3

Pass the through all the beads again, exiting the 8/0. Pull tight.

Step 4

Pick up three 11/0 beads and pass through the 8/0 again.

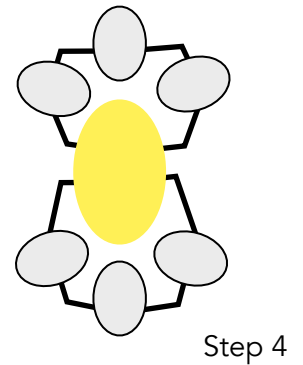

Step 5

Pass through the 11/0s again, and add two 11/0s.

Step 6

Pass through the first set of 11/0s again, exiting on the opposite side of the 8/0.

Step 7

Pick up two 11/0s and pass through two of the second set of 11/0s, exiting the middle bead.

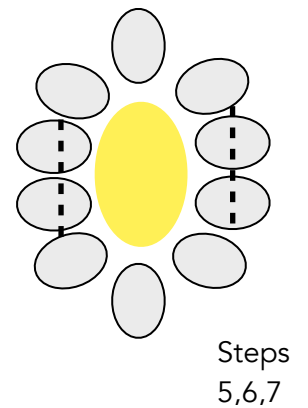

Step 8

Pick up three 11/0 in 1 leaf color, 1 flower color and 1 leaf color. Pass through all the beads a second time, exiting the flower color bead. *That flower color bead becomes the bottom middle bead of the next flower.*

Step 9

Begin again at step 1, picking up one 11/0, one 8/0 and one 11/0. Pass through all the beads a second time, exiting the 8/0, continue from step 4.

Continue to make daisies until you have enough for a ring, join by using 2 leaf color beads to connect two flowers.

Step 10

Pick up one leaf color 11/0, pass through the center 11/0 bead of the first daisy, pick up 1 leaf color bead and pass through the center 11/0 of the last daisy.

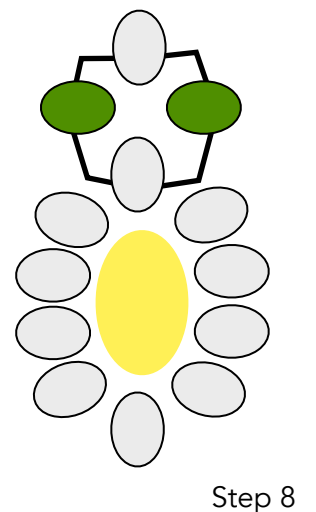

Groovy Necklace

To go with your Posy ring, make a Groovy necklace! With just a few added colors and two extra steps to add leaves, it's a whole new look!

Step 1

Cut a 1.5 yards of FireLine 4lb thread, add a size 12 beading needle.

Step 2

Pick up one 11/0, one 8/0, and two 11/0 beads. Move the beads down the thread, within about 8" of the end of the thread.

Step 3

Pass through all the beads again, exiting the 8/0. Pull tight.

Step 4

Pick up three 11/0 beads and pass through the 8/0 again.

Step 5

Pass through the 11/0s again, and add two 11/0s

Step 6

Pass through the first set of 11/0s again, exiting on the opposite side of the 8/0.

Step 7

Pick up two 11/0's and pass through two of the second set of 11/0s, exiting the middle bead.

Step 8

Pick up three 11/0 in 1 leaf color, 1 (new) flower color, and 1 leaf color. Pass through all the beads a second time, exiting a leaf color bead.

That new flower color bead becomes the bottom middle bead of the next flower.

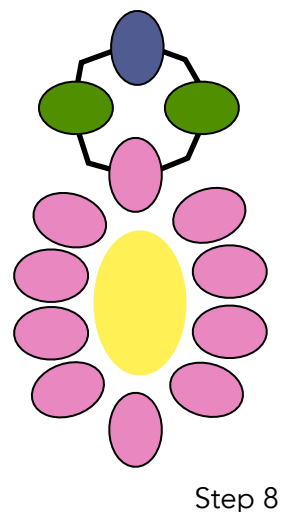
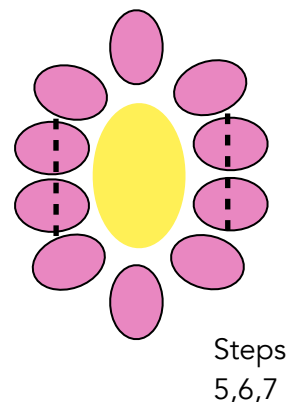
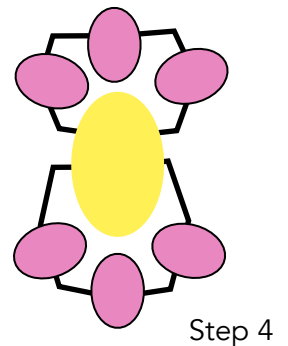
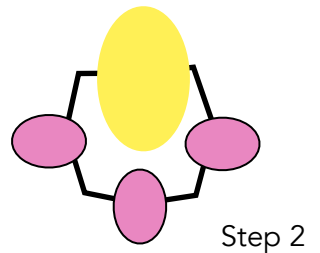

Step 9

Pick up three size 11/0 leaf color beads, and pass through the first leaf bead.

Step 10

Pass through all the leaf beads again.

Step 11

Pass through a flower 11/0, and into the leaf bead on the opposite side.

Step 12

Pick up three size 11/0 leaf color beads, and pass through the original leaf bead. Circle around a second time then pass through the new flower color bead.

A few notes

Remember that RAW is stitched by passing through beads in a circle, with a bead at each position, NSEW. To move to another spot to add beads, you may have to pass through several beads again.

Add a new thread by starting a new thread and needle, pass it through a few beads, tie a knot around the thread and repeat twice more for a total of 3 knots. Cut off the tail of thread. Continue to weave, until several more flowers are made. Pass the old thread through a few beads, knot around the thread in the beads, repeat twice more for 3 knots. Pass the old thread through a few more beads and cut off excess.

Personalizing your daisy chain is easy. Choose any color for your flowers, and even change the center size 8/0 bead! Try mixing flower colors in each flower, too!

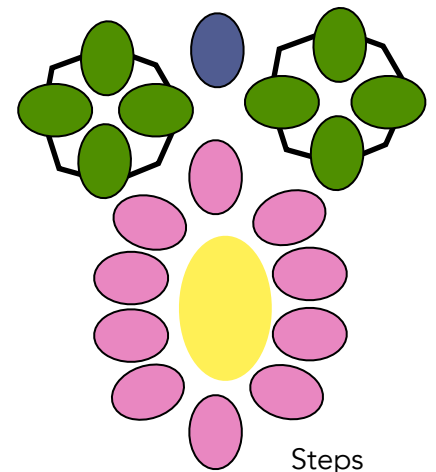

Steps
9,10,11

