



Location Courtesy of the Somerset-Historical Center



Trailers shown with optional canopy, crossbar kit and 2 bike racks.



FLEETWOOD...TIMELESS QUALITY
FOR YOUR QUALITY TIMES

Fleetwood Folding Camping Trailers – Continuing the Legacy of Quality, Value, and Camping Fun.

REPUTATION



In **1967**, as families in large numbers discovered traveling with recreation vehicles, The Coleman Company began building folding camping trailers in scenic Somerset, Pennsylvania, in a state-of-the-art factory designed to produce the highest quality camping trailers available anywhere.

By **1979**, Coleman camping trailers, through innovative thinking, skillful engineering, meticulous manufacturing, and caring customer service from the Somerset facility, along with the industry's best dealer network, became North America's #1 selling brand...a position solidly maintained ever since.

In **1989**, Fleetwood Enterprises, the leader in the RV industry with its popular travel trailer and motor home brands, purchased Coleman Recreation Vehicles, Inc. to become a full-line manufacturer of top selling recreation vehicles of all sizes. With Fleetwood's dedicated focus on recreation vehicles and the reputation of the Somerset facility and people, our sales and market share leadership grew to new heights.

In **2003** Fleetwood ceased using the Coleman brand, instead letting the well-known Fleetwood brand represent the ongoing accomplishments of the Somerset facility and workforce. Our facility's average employee seniority is 17 years!

TODAY the Somerset facility, measuring a sprawling 11 acres under one roof, is capable of producing over 100 trailers a day, and continues to invest in cutting-edge technologies to augment the hundreds of dedicated and highly skilled craftspeople. We still sew our tents, engineer our lift systems, fabricate our frames, build our furniture, and focus on continued innovation, quality, value, and especially customer service – like no one else in our industry. We are very excited about our **2006** product lines, and are confident we have the folding camping trailer to suit your lifestyle. We also believe that an informed and satisfied customer is our best advertisement.



We hope you'll find this brochure informative, and that you'll agree...

Fleetwood is the best value and investment you'll find in a folding camping trailer.

Fleetwood...Leader in Market Share

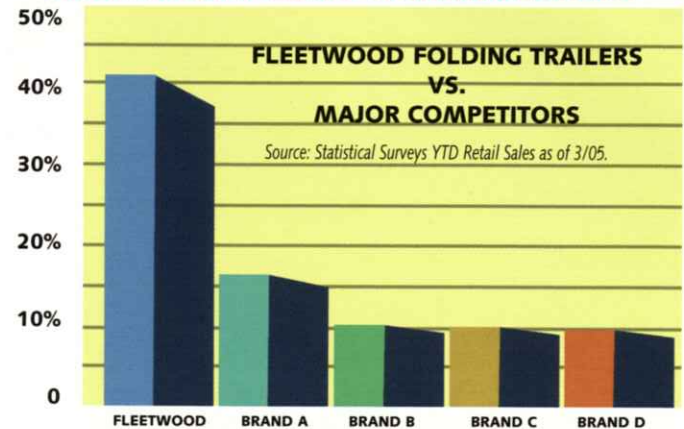

Fleetwood...Leader In Innovation

- 1968 Camping Trailer Design Patent
- 1970 Camping Trailer Step and Door, Tent channels, Lift system Patents
- 1980 Camping Trailer Air Conditioner Mount Patent
- 1985 Camping Trailer Galley Patent
- 1987 Camping Trailer Tent Retainer Patent
- 1989 Camping Trailer Expandable Bed Patent
- 1993 Camping Trailer Mini-blinds Patent
- 1996 Camping Trailer Hydraulic Lift Patent
- 1999 Camping Trailer Cargo Deck, Slide Out Patents
- 2000 Camping Trailer Step and Storage Patent
- 2001 Camping Trailer Expandable Bed, Bed Support System Patents

Other Patents Applied For

Fleetwood has been recognized for other innovations including: Cassette Potti, Sunbrella tent material, Yakima roof rack, front storage compartment, electric brakes as standard equipment, folding bath walls and camping trailer commode with sewage system hook-up to name a few.

Fleetwood...Leader in Customer Satisfaction



Fleetwood's CSI (Customer Satisfaction Index) gathered each year by Fleetwood from actual customers is a "report card" for each manufacturing facility. Somerset, PA, sole manufacturing facility for Fleetwood Folding Trailers, has consistently won the top CSI award yearly since its inception in 1991, with an average CSI rating of 96%. During that period of time Fleetwood's Somerset facility has produced over 240,000 trailers!

NO competitor has even come close!

Folding Trailers vs. Travel Trailers



Crank Up the Fun Without Paying At the Pump!

Looking for deluxe comforts and conveniences in an easy to own RV? Think you need a large travel trailer type RV to find these amenities? Think again! Fleetwood folding camping trailers offer comparable comforts and conveniences in an RV that is far easier to own than a travel trailer.

Facts You May Not Have Considered...

Many communities ban residential parking of large RVs, unless they are garage-able. Unlike travel trailers, many Fleetwood folding camping trailers are garage-able – likely saving you hundreds of dollars each year in storage fees, maintenance costs, and lost resale value.

Travel trailers require larger tow vehicles with poor fuel efficiency – an expense you'll be paying even when not towing a trailer. Fleetwood folding camping trailers can be towed by smaller, more fuel efficient vehicles.

Large tow vehicle and travel trailer combinations can be difficult and time consuming to maneuver into many campsites – especially secluded or more natural sites. Fleetwood folding camping trailers are far easier to maneuver – that means less time spent setting up camp and more time taking it easy.

From large comfortable sleeping areas to private bathrooms and complete kitchens, from inside entertainment to outside cooking, chances are you'll find just what you're looking for in an easy to tow and fun-to-own Fleetwood folding camping trailer.

Compare Living Space...

Compare the floorplan of the Fleetwood Niagara (above) and a comparable travel trailer floorplan below.

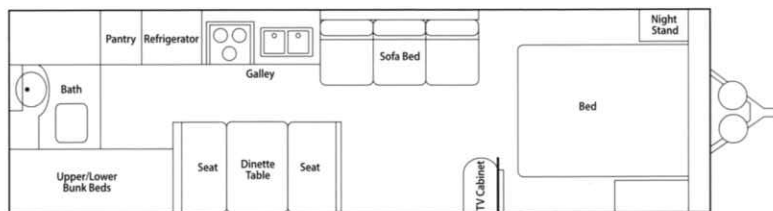
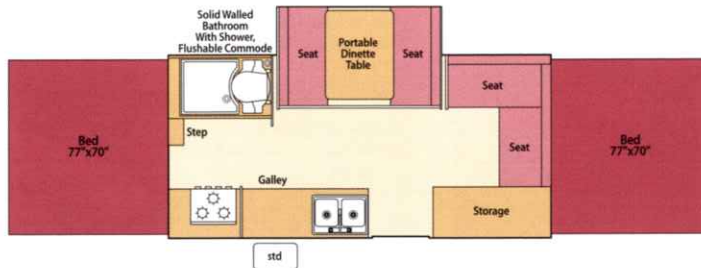

Compare Features...

FEATURE	FLEETWOOD HIGHLANDER SERIES	COMPARABLE SIZE TRAVEL TRAILER
Living quarters length x width	26'10" x 6'9"	app. 27' x 7'9"
Interior height	85"	app. 80"
Solid wall enclosed private bathroom	Std.	Std.
Shower	Std.	Std.
Ceramic commode	Std.	Opt./Std.
Exterior shower	Std.	Opt./Std.
Residential style permanent galley	Std.	Std.
Double bowl sink	Std.	Std.
Microwave oven	Std.	Opt./Std.
Conventional oven	Std.	Opt./Std.
Three burner stove	Std.	Std.
Water heater	Std.	Std.
Deluxe cabinet doors	Std.	Opt./Std.
Exterior cooking appliance	Std.	Opt./Std.
Drawers	Std.	Std.
Dinette seating area	Std.	Std.
Casual seating area	Std.	Std.
Built-in stereo	Std.	Opt./Std.
CATV connection	Std.	Opt./Std.
Adult bed size	70" x 77"	app. 60" x 74"
Additional bed sizes	70" x 77"	2 bunks @ app. 29" x 72"
Dinette bed size	43" x 71" Niagara model 51" x 81" Sequoia model	app. 40" x 74"
Sofa bed size	–	app. 40" x 72"
Slide-out equipped	Niagara model	Some models
Air conditioner ready	Std.	Std.
Alloy wheels	Std.	Opt./Std.
Exterior access storage compartment	Std.	Opt./Std.
Under floor fresh water holding tank	Std.	Std.
Black water holding tank	Std.	Std.
Hook-up to on site sewage connection	Std.	Std.
Storage bumper	Std.	Opt./Std.
Exterior 110V outlet	Std.	Opt./Std.
Patio light	Std.	Opt./Std.
Molded wheel well skirts	Std.	Opt./Std.
Electric brakes	Std.	Std.
One-piece entry door	Std.	Std.
Slide-out entry step	Std.	Std.

Fleetwood Folding Trailers...Easy to Tow, Easy to Stow

Unloaded weight	2,865lbs Sequoia 3,055lbs Niagara	app. 5,500lbs
GVWR	3,770lbs	app. 7,500lbs
Unloaded hitch weight	285-290lbs	app. 700lbs
Towing and Storage Length	19'3"	app. 31'
Towing and Storage Height	64" (no A.C.)	app. 120" (no A.C.)

CONSTRUCTION AND FEATURES – THE FLEETWOOD ADVANTAGE

Thoughtfully Designed...Carefully Engineered

No Matter Which Fleetwood You Choose...You Get The Same Rugged, Quality Construction

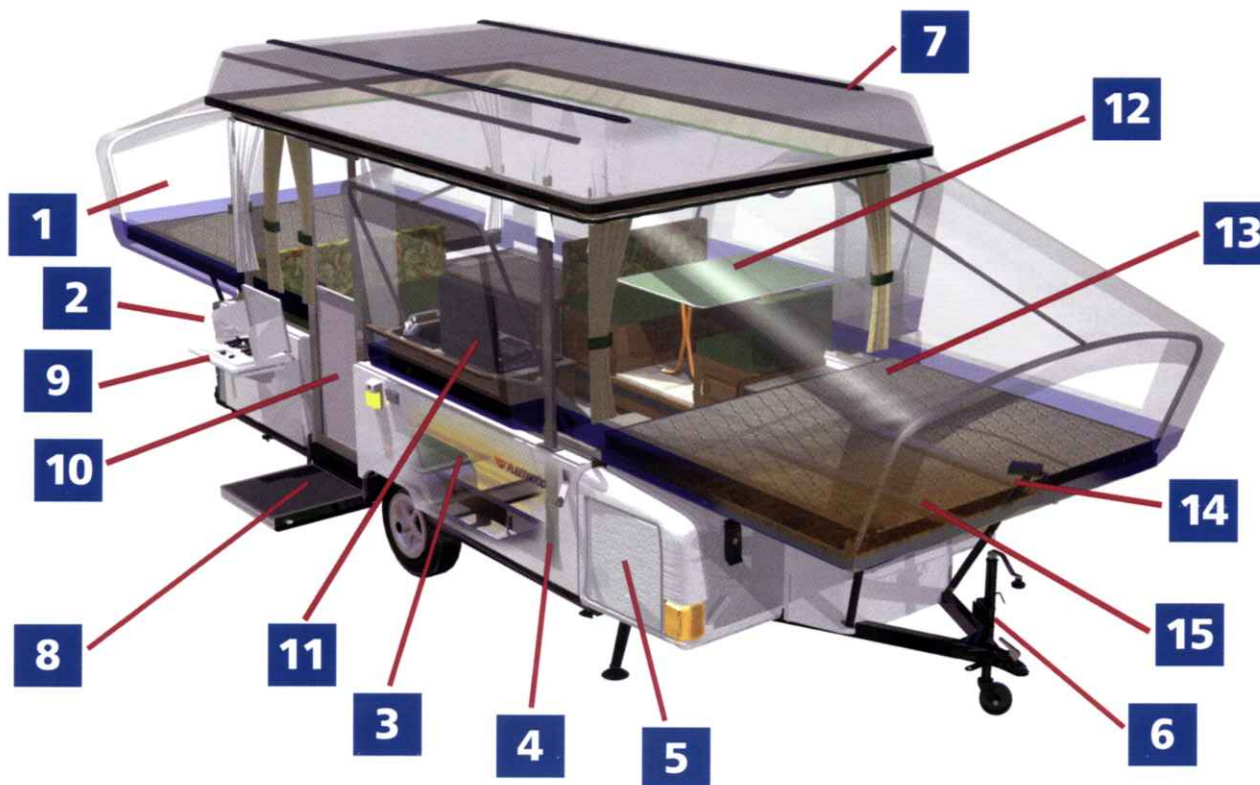

1 WINDOWS

- Clear vinyl windows allow more natural light inside on overcast days.
- Fine mesh screening keeps even the tiniest insects out.

2 FRONT & REAR PANELS

- Americana Series features front and rear TPO panels that are chip resistant and provide protection against stones, road debris or unexpected objects when backing up.
- Destiny & Highlander Series feature rigid panels with "Rock Guard" Diamond Plate on front panel.
- Panels can easily and inexpensively be replaced if damaged.

3 WALL CONSTRUCTION

- All models feature galvanized and painted steel body panels that are riveted to the trailer framework for flexibility and durability, and permit easy and inexpensive replacement if ever damaged.

4 LIFT SYSTEM

- Stainless steel lift posts will not corrode, or bind, and do not need to be protected from rain behind tent flaps.
- Posts are bolted directly to the trailer's frame, not screwed to the floor, and are designed to channel rain water harmlessly to the ground – not into the trailer.
- Lift system does not require you to monitor an over-crank warning cable – ours can not be overcranked, and our system doesn't require you to install additional support posts to support the weight of the trailer roof once it's up. Many competitors do.
- The crank mechanism features a "Posi-Lock," allowing the operator to stop and release the crank handle without fear of kick-back or free-fall.
- Our time tested lift system, in use for almost 40 years, doesn't rely upon "direct drive" components with plastic threads that only halfway engage the drive shaft, or unplated "flexible push rods" (springs actually) to raise the roof. Competitors do.
- Limited lifetime warranty.



STANDARD ON ALL MODELS:

- Air Conditioner Prepped Roof (Installation Kits Required)
- Electric Brakes
- Four Crank-Down Stabilizer Jacks (Sand Pads Included on Slide-Out Models)
- Galvanized Steel Side Body Panels
- Tubular Steel Frame
- Heavy Duty Slipper Leaf Spring Suspension
- One-Piece Structurwood® Floor and Beds
- Full Perimeter Thick-Walled Aluminum Body and Bed Rails
- Posi-Lock Stainless Steel Lift System
- One-Piece Aluminum Framed Screen Door
- Positive Locking Safety Chains
- Sectionalized Sunbrella 302 Tenting – Including Window Flaps
- Spare Tire, Mount, Lug Wrench
- Clear Window Vinyl
- Vinyl Spare Tire Cover
- Vinyl LP Tank Cover
- 20lb LP Tank
- Power Converter with Charger
- 12V Electric Water Pump
- Exterior Patio Light
- Exterior 110V Outlet
- Lined Window Curtains
- Lined Bed Privacy Curtains
- Decorative Full-Perimeter Valance
- Bumper
- Exterior Hook Up For Outdoor Cooking
- 3-Way Operation Refrigerator



5 FRONT STORAGE TRUNK

- Impact and water-resistant rotational molded front storage trunk (See cargo capacities on page 11).
- Easy access from top and side.
- Inside can be washed out and drained with a removable floor plug.
- No gimmicky sliding mechanisms or two-piece lids to add weight and complexity.

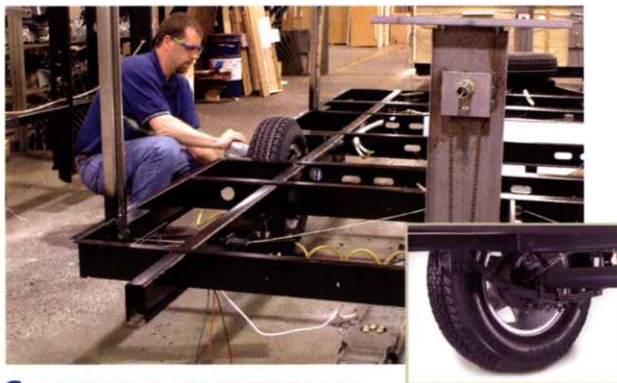

6 FRAME & SUSPENSION

- Full perimeter tubular steel frame offers greater strength and durability.
- Tongue (select models) and bumper are stone finish powder coat painted to prevent rusting.
- Trailer wiring is protected inside the frame members to prevent damage from stones and other road debris.
- Soft riding yet rugged automotive style steel leaf spring suspensions.
- E-Z Lube axles permit simplified maintenance.
- Five-bolt hubs and standard brakes provide peace of mind.
- Limited lifetime warranty (frame only).

7 ROOF

- All roofs feature durable aluminum exterior skins, folded along all four sides to provide greater side wall strength without additional seams. Competitors' brittle fiberglass skinned roofs require separate sidewalls and additional seams potentially prone to failure due to top latch forces.
- Destiny and Highlander roofs feature single seam construction – with approximately half the visible seaming of competitive roofs.
- Americana roofs feature standard roof rack tracks, stylish impact resistant TPO end caps, and the same dependable roof technology of our Destiny and Highlander roofs.
- Limited 5 year warranty



8 STEPPER™ DOOR

- Exclusive Stepper Door with deadbolt lock on the Americana Series provides an extra-wide and sturdy entry step into the trailer.
- FlexTread™ "non-slip" step
- The Stepper Door features a convenient, lockable storage compartment.
- Highlander & Destiny Series offer a self-storing slide-out step.



9 OUTDOOR COOKING

- Americana and Highlander models come standard with your choice of 2 burner stove OR RVQ grille.
- See page 9 for items and descriptions.
- Destiny models offer 2 burner stove or RVQ grille as an optional accessory.

10 SCREEN DOOR

- One-piece screen door requires no assembly and easily sets into place.
- It's self-contained in a single frame so the trailer does not need to be perfectly level for installation.
- The extra-wide door is a full 24 1/2 inches wide to allow easy access into the trailer.
- The door handle is located at waist-level for easy use without stooping or bending to reach.
- The automatic spring-loaded door return provides automatic closing.



11 GALLEY

- The Swing-Level® (Americana Series) and Fold-Over (Destiny Series) galleys set up quickly and easily and provide plenty of upper and lower storage.
- Items don't need to be removed when traveling and the Swing-Level galley design provides a no-spill feature so items remain in place when positioning the galley.
- Highlander Series feature a fixed residential height galley for spacious storage and no set-up.

12 DINETTE TABLE

- All models offer a portable dinette table that can be used inside or out.
- Americana & Highlander Series provide a thermoformed moisture-resistant table top.

13 TENTING

- Sunbrella® 302 tenting is used exclusively on all models. Made of breathable woven acrylic material that's hypoallergenic and water resistant.
- Sunbrella 302 resists mildew, dry rot, fading, or cracking.
- Because of Sunbrella 302's special breathable design, moisture and odors escape while minimizing condensation – eliminating the need of a roof vent.
- Tenting meets or exceeds the Federal Government's FMVSS 302 code standards for flammability.
- Tenting is attached at bed ends to prevent mattresses from getting wet during set-up and take-down.
- Sectional design provides a less expensive way to replace damaged or torn tenting.
- Continuous, double-needle stitching and double lap-fold seams prevent unraveling and provide strong water-tight seals from the very first time it gets wet.
- Limited 5-year warranty.

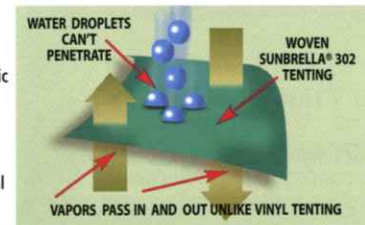

14 FLOOR & BED PLATFORM

- One-piece Weyerhaeuser Strukturwood® eliminates seams, warping, buckling and delaminating.
- 100% quality control provides consistent panels with no soft spots, knotholes or core voids.
- Our use of Strukturwood® is so dependable that Weyerhaeuser agrees with our practice of not coating the exposed bottom surfaces. (See page 11).
- Limited 25-year warranty.

15 BEDS

- Americana & Highlander Series offers exclusive BackSaver™ support system for easy set-up without bending or stooping (Destiny Series features self-storing bed supports).
- The beds glide out with minimal effort and feature full-perimeter aluminum frames to prevent warping and binding.
- Bed supports are easy to position and are self-storing so they can't be misplaced.
- All beds tested to 1,100 lbs. capacity.



Metal Seat Frames provide stronger support and lasting durability on Americana and Highlander Series.

Exclusive Self-storing Dolly Jack & Safety Lock Chains

Dolly jack features a permanently attached wheel and will not interfere with tow vehicle's tailgate or rear mounted spare tire. (Highlander Series features center mount jack.) Safety lock chains provide a positive locking connection between the trailer and tow vehicle.



HIGHLANDER SERIES

SEQUOIA | NIAGARA *Featured Model: NIAGARA*

ULTIMATE OUTDOOR COMFORT

The Highlander Series sets the standard in folding trailer comfort and convenience. Full-featured like a travel trailer but lightweight and easy to tow like a folding trailer.

Standard Features

In addition to items listed on page 4

- Single Seam, Aluminum Skinned, Insulated Roof, Awning Rail
- Waist Level Lift System Crank Location
- Galvanized Steel Front, Rear and Side Body Panels with Diamond Plate Front Guard
- Alloy Wheels with Chrome Lugs Nuts
- Slide-Out Dinette on Niagara
- Solid-Walled Bathroom with Flushable Ceramic Commode Compatible with On-Site Sewage Hook-Ups and Primitive Type Sites
- Painted Metal Framed Seat Bases
- BackSaver Bed Support Legs – Painted, Self-Storing
- Slide-Out Entry Step
- Center-Mount Dolly Jack with Removable Wheel
- Stationary Galley Needs No Set Up
- Decorative Routed Cabinet Doors
- Double Bowl Stainless Steel Sink
- 20 Gallon Capacity Under-Floor Water Storage Tank
- 6 Gallon Capacity Water Heater
- 26 Gallon Total Water Storage Capacity
- Outside Shower
- Exclusive 3.7 cu.ft. Refrigerator with Freezer Compartment. 3-Way Operation
- 3-Burner Inside Stove with Oven
- Microwave Oven
- Water-Resistant Composite Carry-Out Dining Table
- Choice of RVQ Outside Grille OR 2-Burner Outside Stove
- 16,000 BTU Furnace
- Wardrobe Rack
- 2-Speaker Stereo with CD Player
- CATV Connection
- Cutlery Tray
- Casual Seating Area
- Exterior Access Storage Compartment
- 2 - 20 Lb. LP Tanks
- 4x4 Tube Storage Bumper



FLEETWOOD HIGHLANDER EXCLUSIVE!
3.7 cu. ft. refrigerator with freezer.



TRAVEL TRAILER AMENITIES with folding trailer ease.



Shown with optional canopy.



HIGHLANDER SOLID WALL BATHROOM
makes set-up as easy as 1, 2, 3.



FLEETWOOD HIGHLANDER EXCLUSIVE!
Residential style flushable ceramic commode.



AMERICANA *SERIES*

UTAH

**BACK BY
POPULAR
DEMAND
FOR 2006!**



UTAH Standard Features

In addition to items listed on page 4 of the main brochure.

- Aluminum Skinned, Insulated Roof With RackTracks, Styled End Caps, Awning Rail
- Convenient Waist Level Located Lift System Crank
- Dent Resistant Plastic Front and Rear Body Panels
- Dent and Water Resistant Molded Plastic Front Storage Trunk
- Alloy Wheels with Chrome Lugs Nuts
- Painted Metal Framed Seat Bases
- BackSaver Bed Support Legs – Painted, Self-Storing
- Stepper Door Entry Step with Integral Storage Compartment
- Swing-Up Dolly Jack and Wheel
- No-Tip Full-Storage Swing-Level Upper Galley
- Deep Bowl Porcelain Sink
- 20 Gallon Capacity Under-Floor Water Storage Tank
- 26 Gallon Total Water Storage Capacity (Includes Std. Water Heater)
- 6 Gallon Capacity Water Heater
- Outside Shower
- Refrigerator - 1.9 cu.ft. 3-Way Operation
- 3-Burner Inside Stove
- Water-Resistant Composite Carry-Out Dining Table
- Choice of RVQ Outside Grille OR 2-Burner Outside Stove
- Slide-Out Dinette
- Quilted Mattresses



SWING LEVEL® GALLEY WITH 1.9 CU. FT. REFRIGERATOR – STANDARD!

Shown with optional furnace.



CASSETTE POTTI available as an option.

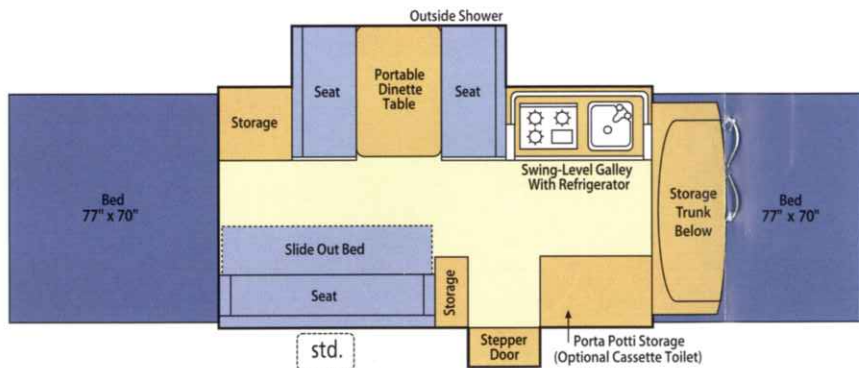

std. Indicates location of standard equipment RVQ grille or outside stove. (See page 9 of brochure).

AMERICANA

DIMENSIONS AND CAPACITIES

	UTAH
Box Size (Inside Length)	12'
Gross Vehicle Weight Rating (GVWR), (lbs.)	3,500
Unloaded Vehicle Weight (UVW), (lbs.)	2,580
Unloaded Tongue Weight (UTW), (lbs.)	195
Maximum Carrying Capacity (MCC), (lbs.)	920
Storage Trunk Capacity (cu. ft.)	19
Cabinet Storage (cu. ft.)	38
Total Storage Capacity (cu. ft.) ¹	57
Tire Size	ST185/80D13
Dimensions (Open - Length x Width)	25'x11'9"
Dimensions (Closed - Length x Width)	19'2"x7'5"
Height (Closed)	54"
Height (Open)	99"
Interior Height	80"
Convertible Bench/Bed Size	33" x 72"
Convertible Dinette/Bed Size	43"x71"
Water Storage Capacity (*Incl. Std. 6 gal water heater cap)	26 Gal.*
Main Water Tank Location (not including water heater)	Under Floor
Converter/Charger (Amperage)	25

¹ Does not include temporary storage space in open areas of each floor plan.

- GVWR (Gross Vehicle Weight Rating) is the maximum permissible weight of this trailer when fully loaded. It includes all weight at the trailer axle(s) and tongue or pin.
- All dry weights are based on the standard model and do not include optional features or equipment.
- Maximum Carrying Capacity is determined by subtracting Gross Dry Weight from the GVWR. The Maximum Carry Capacity does NOT include the weight of fresh water, propane, or water in the water heater.
- Trailer open width includes slide-out step and/or slide-out.
- Water weight equals 8.3 lbs per gallon. LP Gas weight equals 4.2 lbs. per gallon.
- Hitch weights are dependent upon how the trailer is equipped with options, on board cargo and tank fluid levels. Actual hitch weights may be higher or lower than shown. It is recommended that the tow vehicle and hitch for your trailer have sufficient capacity to accommodate actual usage.
- Some accessories and options may be dealer installed.
- Installed option weights will decrease the cargo carrying capacity. Consult Owner's Manual for accessory weights.
- Storage trunk models equipped with hot water have reduced cargo capacity because of hot water heater location.
- Refrigerator, furnace, cassette toilet, hot water and outside shower are factory installed options.

FLEETWOODRV.COM To locate a dealer near you, visit our website or call 1-800-444-4905. We can also be contacted at Fleetwood Customer Relations, P.O. Box 7638, Riverside, CA 92513-7638.

IMPORTANT-PLEASE READ Product information, photography and illustrations included in this publication were as accurate as possible at the time of printing. For further product information and changes, please visit our website at www.fleetwoodrv.com/foldingtrailers or contact your local Fleetwood dealer. Prices, materials, design and specifications are subject to change without notice. All weights, fuel, liquid capacities and dimensions are approximate. Fleetwood has designed its recreational vehicles to provide a variety of uses for customers. Each vehicle features optimal seating, sleeping, storage and fluid capacities. The user is responsible for selecting the proper combination of loads (i.e.: occupants, equipment, fluids, cargo, etc.) to ensure that the vehicle's capacities are not exceeded.



Driven to Explore

www.fleetwoodrv.com

For complete info see your Fleetwood Folding Trailer dealer. © 2005. Fleetwood Enterprises, Inc. Fleetwood® and the Fleetwood Signatures are registered trademarks of Fleetwood Enterprises, Inc. and are protected by laws governing their use. Printed in the USA.

AMERICANA SERIES

SANTA FE | CHEYENNE | TIMBERLAKE | SUN VALLEY
 BAYSIDE | WILLIAMSBURG *Featured Model: BAYSIDE*

AFFORDABLE FAMILY FUN

"Roughing it" in the great outdoors takes on a new meaning with the sleek Americana Series. Amenities include a Swing-Level® galley, Stepper™ Door, waist level crank, and Rack Track roof rails.

Standard Features

In addition to items listed on page 4

- Aluminum Skinned, Insulated Roof with RackTracks, Styled End Caps, Awning Rail
- Convenient Waist Level Located Lift System Crank
- Dent Resistant Plastic Front and Rear Body Panels
- Dent and Water Resistant Molded Plastic Front Storage Trunk (exc. Santa Fe, Sun Valley)
- Alloy Wheels with Chrome Lugs Nuts
- Painted Metal Framed Seat Bases
- BackSaver Bed Support Legs – Painted, Self-Storing
- Stepper Door Entry Step with Integral Storage Compartment
- Swing-Up Dolly Jack and Wheel
- No-Tip Full-Storage Swing-Level Upper Galley
- Deep Bowl Porcelain Sink
- 20 Gallon Capacity Under-Floor Water Storage Tank
- 26 Gallon Total Water Storage Capacity on Timberlake, Bayside, Williamsburg (Includes Std. Water Heater)
- 6 Gallon Capacity Water Heater (optional on Santa Fe, Cheyenne, Sun Valley)
- Outside Shower (optional on Santa Fe, Cheyenne, Sun Valley)
- Refrigerator - 1.9 cu.ft. 3-Way Operation
- 3-Burner Inside Stove
- Water-Resistant Composite Carry-Out Dining Table
- Choice of RVQ Outside Grille OR 2-Burner Outside Stove
- Slide-Out Dinette on Bayside and Williamsburg
- Quilted Mattresses

TIMBERLAKE & WILLIAMSBURG
feature a full bathroom.



SWING LEVEL® GALLEY
WITH 1.9 CU. FT.
REFRIGERATOR – STANDARD!
Shown with optional furnace.



Shown with optional canopy and rigid LP cover.



AMERICANA SERIES BAYSIDE MODEL
with spacious interior and all the comforts of home



OPTIONAL CASSETTE POTTI
 available on Santa Fe and Bayside

DESTINY SERIES

YUMA | SEA PINE *Featured Model: SEA PINE*

ECONOMICAL COMFORT

When you want quality, comfort and convenience at a great price, the Destiny Series is just what you are looking for! Available in two best selling floorplans.

Standard Features

In addition to items listed on page 4

- Single Seam, Aluminum Skinned, Insulated Roof, with Awning Rail
- Bumper Level Lift System Crank Location
- Painted, Self-Storing Bed Support Legs
- Slide-Out Entry Step
- Swing-Up Dolly Jack and Wheel
- Full-Storage Fold-Over Upper Galley
- 10 Gallon Water Storage
- Refrigerator – 1.9 cu.ft. 3-Way Operation
- Stainless Steel Sink
- 2-Burner Inside Stove
- Diamond plate front stone guard



SPACIOUS INTERIOR
with all the room you will need.



Shown with optional RVQ grille.



FRONT SEATING AREA
easily converts to an additional bed.

FOLD-OVER GALLEY sets up quickly and provides full upper and lower storage, complete with 1.9 cu. ft. refrigerator – standard!



Optional furnace shown

FLEETWOOD ACCESSORIES

Personalize and Customize Your Outdoor Living Space



SCREEN ROOM

Featuring fine mesh screening and full perimeter skirting. (See page 6 for optional canopy. Canopy must be purchased separately.)



DELUXE ADD-A-ROOM

Featuring fine mesh screening, privacy panels, clear vinyl rain flaps and heavy-duty zippered sections for easy set-up and take-down. (Canopy must be purchased separately.)



GAS GRILLE OR STOVE

Perfect for outdoor cooking. (Americana and Highlander Series offer grill OR stove as a standard feature. Destiny Series offers optional stove or grille.)

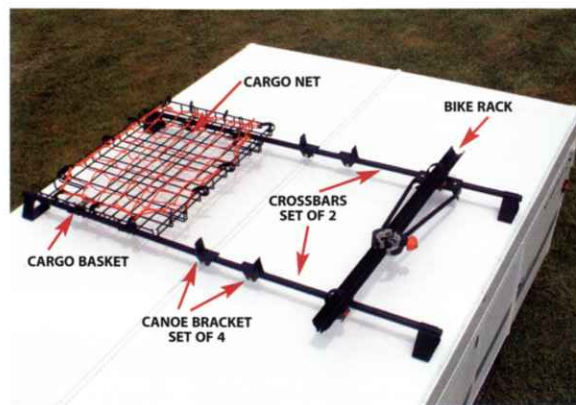

YAKIMA® ROOF RACK gives you the option to take all your toys with you. Available with optional canoe brackets, straps, bike carrier, cargo basket.



KEEP COOL ALL SUMMER with roof mounted air conditioning. (Dealer installed only. Check for proper BTU sizing and installation requirements.)



FORCED AIR FURNACE Energy efficient LP gas forced air furnace with electronic ignition provides 16,000 BTUs of heating with thermostat controlled comfort.



AMERICANA® RIGID SPARE TIRE AND LP COVER

For the very best in protection and appearance, choose these stylish covers.

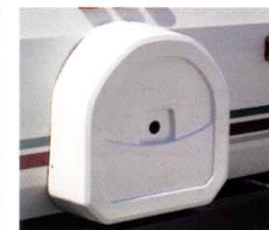

HIGHLANDER® RIGID SPARE TIRE AND LP TANK COVER

Finishing touches for the ultimate folding camping trailer.



CAMPER CADDIE

This handy soft-side detachable and roll up wardrobe makes trip preparation quick, easy and provides loads of personal storage.



MIRRORED VANITY MATE

Provides convenient storage for tooth brushes, toiletries, paper towels and other daily necessities.



HANDY PORTABLE FAN/LIGHT COMBINATION

For added ventilation & night time reading.

CHOOSE OPTIONAL DECOR PACKAGE: 1 Camper Caddie, 2 Fan/Lights, 1 Vanity Mate

2006 Fleetwood Folding Trailer Floorplans & Specifications

Choose The Living Space That Is Perfect For Your Family

DESTINY SERIES

YUMA

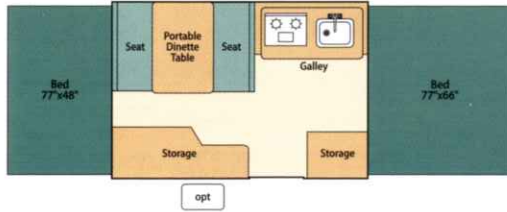

SEA PINE

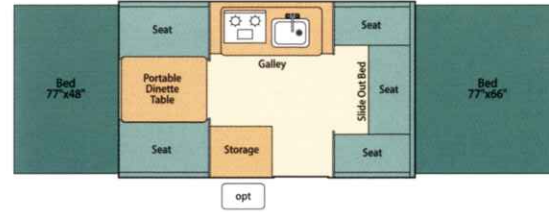

opt Indicates location of optional equipment RVQ grille or outside stove. (See page 9).

AMERICANA SERIES

SANTA FE

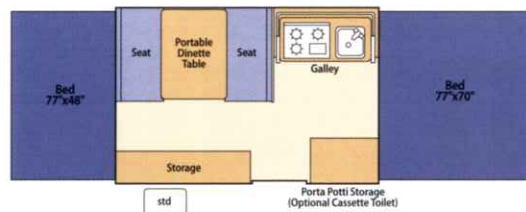

TIMBERLAKE

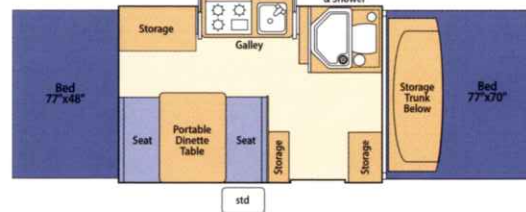

WILLIAMSBURG

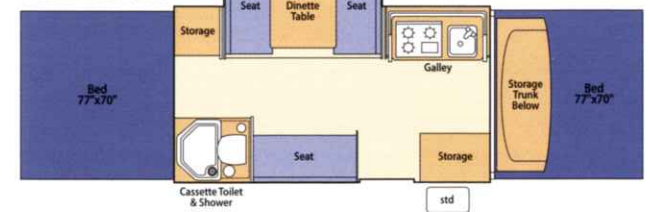

CHEYENNE

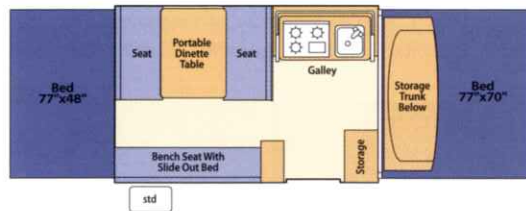

BAYSIDE

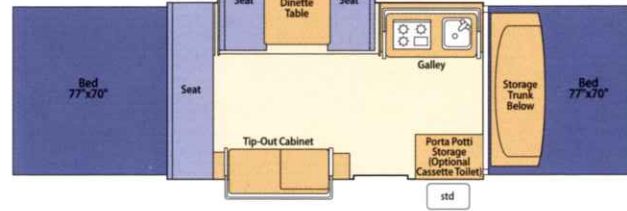

SUN VALLEY

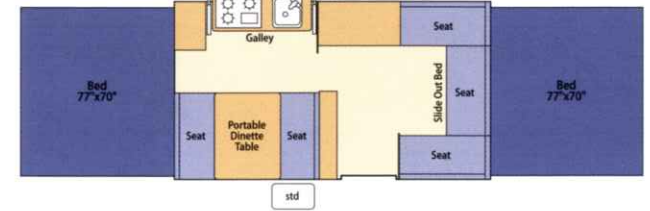

HIGHLANDER SERIES

SEQUOIA

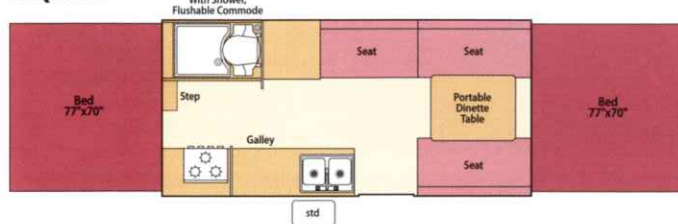

NIAGARA

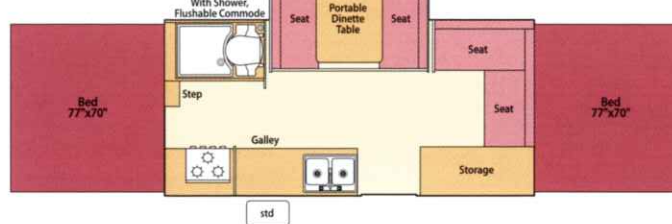

std. Indicates location of standard equipment RVQ grille or outside stove. (See page 9).

DIMENSIONS AND CAPACITIES	DESTINY		AMERICANA						HIGHLANDER	
	YUMA	SEA PINE	SANTA FE	CHEYENNE	TIMBERLAKE	SUN VALLEY	BAYSIDE	WILLIAMSBURG	NIAGARA	SEQUOIA
Box Size (Inside Length)	9'6"	11'	10'	10'	10'	12'	12'	12'	14'	14'
Gross Vehicle Weight Rating (GVWR), (lbs.)	2,400	2,500	3,000	3,000	3,000	3,500	3,500	3,500	3,770	3,770
Unloaded Vehicle Weight (UVW), (lbs.)	1,560	1,750	1,770	2,010	2,150	2,095	2,635	2,610	3,055	2,865
Unloaded Tongue Weight (UTW), (lbs.)	165	160	185	135	160	160	195	195	285	290
Maximum Carrying Capacity (MCC), (lbs.)	840	750	1,230	990	850	1,405	865	890	715	905
Storage Trunk Capacity (cu. ft.) (*19 with optional water heater)	N/A	N/A	N/A	22*	19	N/A	19	19	N/A	N/A
Cabinet Storage (cu. ft.)	39	56	40	36	26	51	42	42	59	44
Total Storage Capacity (cu. ft.) ¹	39	56	40	58	45	51	61	61	59	44
Tire Size	5.30 x 12	ST175/80D13	ST185/80D13	ST185/80D13	ST185/80D13	ST185/80D13	ST185/80D13	ST185/80D13	ST205/75D14	ST205/75D14
Dimensions (Open - Length x Width)	20'5"x8'1"	21'7"x8'1"	21'4"x8'9"	21'4"x8'9"	21'4"x10'2"	25'x10'2"	25'x11'9"	25'x11'9"	26'10"x10'6"	26'10"x8'1"
Dimensions (Closed - Length x Width)	14'x7'5"	15'8"x7'5"	15'2"x7'5"	17'2"x7'5"	17'2"x7'5"	17'2"x7'5"	19'2"x7'5"	19'2"x7'5"	19'3"x7'5"	19'3"x7'5"
Height (Closed)	52"	53"	53"	53"	53"	54"	54"	54"	64"	64"
Height (Open)	98"	98"	99"	99"	99"	99"	99"	99"	105"	105"
Interior Height	80"	80"	80"	80"	80"	80"	80"	80"	85"	85"
Convertible Bench/Bed Size	N/A	35"x80"	N/A	34"x67"	N/A	41"x81"	N/A	N/A	N/A	N/A
Convertible Dinette/Bed Size	41"x66"	41"x80"	43"x71"	43"x71"	39"x67"	39"x67"	43"x71"	43"x71"	43"x71"	51"x81"
Water Storage Capacity (*Incl. Std. 6 gal water heater cap)	10 Gal.	10 Gal.	20 Gal.	20 Gal.	26 Gal.*	20 Gal.	26 Gal.*	26 Gal.*	26 Gal.*	26 Gal.*
Water Storage Capacity (with Opt. 6 gal. water heater)	16 Gal.	16 Gal.	26 Gal.	26 Gal.	N/A	26 Gal.	N/A	N/A	N/A	N/A
Main Water Tank Location (not including water heater)	Above Floor	Under Floor	Under Floor	Under Floor	Under Floor	Under Floor	Under Floor	Under Floor	Under Floor	Under Floor
Converter/Charger (Amperage)	25	25	25	25	25	25	25	25	35	35

¹ Does not include temporary storage space in open areas of each floor plan.

- GVWR (Gross Vehicle Weight Rating) is the maximum permissible weight of this trailer when fully loaded. It includes all weight at the trailer axle(s) and tongue or pin.
- All dry weights are based on the standard model and do not include optional features or equipment.
- Maximum Carrying Capacity is determined by subtracting Gross Dry Weight from the GVWR. The Maximum Carry Capacity does NOT include the weight of fresh water, propane, or water in the water heater.
- Trailer open width includes slide-out step and /or slide-out.
- Water weight equals 8.3 lbs per gallon. LP Gas weight equals 4.2 lbs. per gallon.
- Hitch weights are dependent upon how the trailer is equipped with options, on board cargo and tank fluid levels. Actual hitch weights may be higher or lower than shown. It is recommended that the tow vehicle and hitch for your trailer have sufficient capacity to accommodate actual usage.
- Some accessories and options may be dealer installed.
- Installed option weights will decrease the cargo carrying capacity. Consult Owner's Manual for accessory weights.
- Storage trunk models equipped with hot water have reduced cargo capacity because of hot water heater location.
- Refrigerator, furnace, cassette toilet, hot water and outside shower are factory installed options.

"Weyerhaeuser agrees with Fleetwood's practice of not coating the exposed bottom surface of the Structurwood panels used in their trailers. In our opinion, moisture from occupancy load, or from other internal or external sources may become trapped in the Structurwood substrate if it is coated on the underside with a system that impairs the ability of the substrate to dry thoroughly. Trapped moisture, over time may cause premature decay or rot." Weyerhaeuser

What Drives You?

Maybe it's feeling like you're the only one on Earth. Perhaps it's the unique sense of closeness with the great outdoors. Or, it might be the joy that comes from spending quality time with family and friends. Whatever the reason, we know that you have a strong drive to experience everything that comes with spending time on the road. And for more than 50 years, we've shared that passion with you. Because we're RV enthusiasts ourselves, you can see our passion in the vehicles we design and build. Own a Fleetwood, and you'll feel like you're not just traveling, but embarking on an experience unlike any other. Set your own course for adventure and get out there and explore the world around you. Once you do, you'll see what it is that drives us - it's you.

FLEETWOOD FOLDING TRAILER WARRANTY

Limited Lifetime Warranty
Frame and Lift System.

Limited 25 Year Warranty
Floor and Bed Platform Wood.

Limited 5 Year Warranty
Roof Assembly and Tent Material.

Limited 1 Year Warranty
Hitch to Bumper.

The limited lifetime warranty on specified structural components covers repair of defective parts, labor, and freight for the first full year and repair of specified defective parts and labor for years two and beyond from the date of purchase...for as long as you own your trailer.

National Coverage

Traveling to Spokane? Buffalo? We've got you covered with one of the nation's largest trained service networks. In fact, **335 Fleetwood Folding Trailer dealers** are just a phone call away.



www.fleetwoodrv.com

FLEETWOOD TRAVELCADE CLUB As a Fleetwood owner, you're eligible to become a member of our owners' group, Fleetwood Travelcade Club. It's a perfect way to meet other Fleetwood owners who love to travel to beautiful resorts and vacation spots all across America. Call (877) 577-2560 and join the fun! Or visit www.fleetwood.com/clubs to learn more.

FLEETWOODRV.COM To locate a dealer near you, visit our website or call 1-800-444-4905. We can also be contacted at Fleetwood Customer Relations, P.O. Box 7638, Riverside, CA 92513-7638.

IMPORTANT-PLEASE READ Product information, photography and illustrations included in this publication were as accurate as possible at the time of printing. For further product information and changes, please visit our website at www.fleetwoodrv.com/foldingtrailers or contact your local Fleetwood dealer. Prices, materials, design and specifications are subject to change without notice. All weights, fuel, liquid capacities and dimensions are approximate. Fleetwood has designed its recreational vehicles to provide a variety of uses for customers. Each vehicle features optimal seating, sleeping, storage and fluid capacities. The user is responsible for selecting the proper combination of loads (i.e.: occupants, equipment, fluids, cargo, etc.) to ensure that the vehicle's capacities are not exceeded.

Your local Fleetwood Folding Trailer dealer is:

