

2 0 0 0

Adventure...

Discovery...

Nature's Beauty...

Togetherness...

Stress Relief...

Family Fun...



...We'll  
Take  
You  
There!

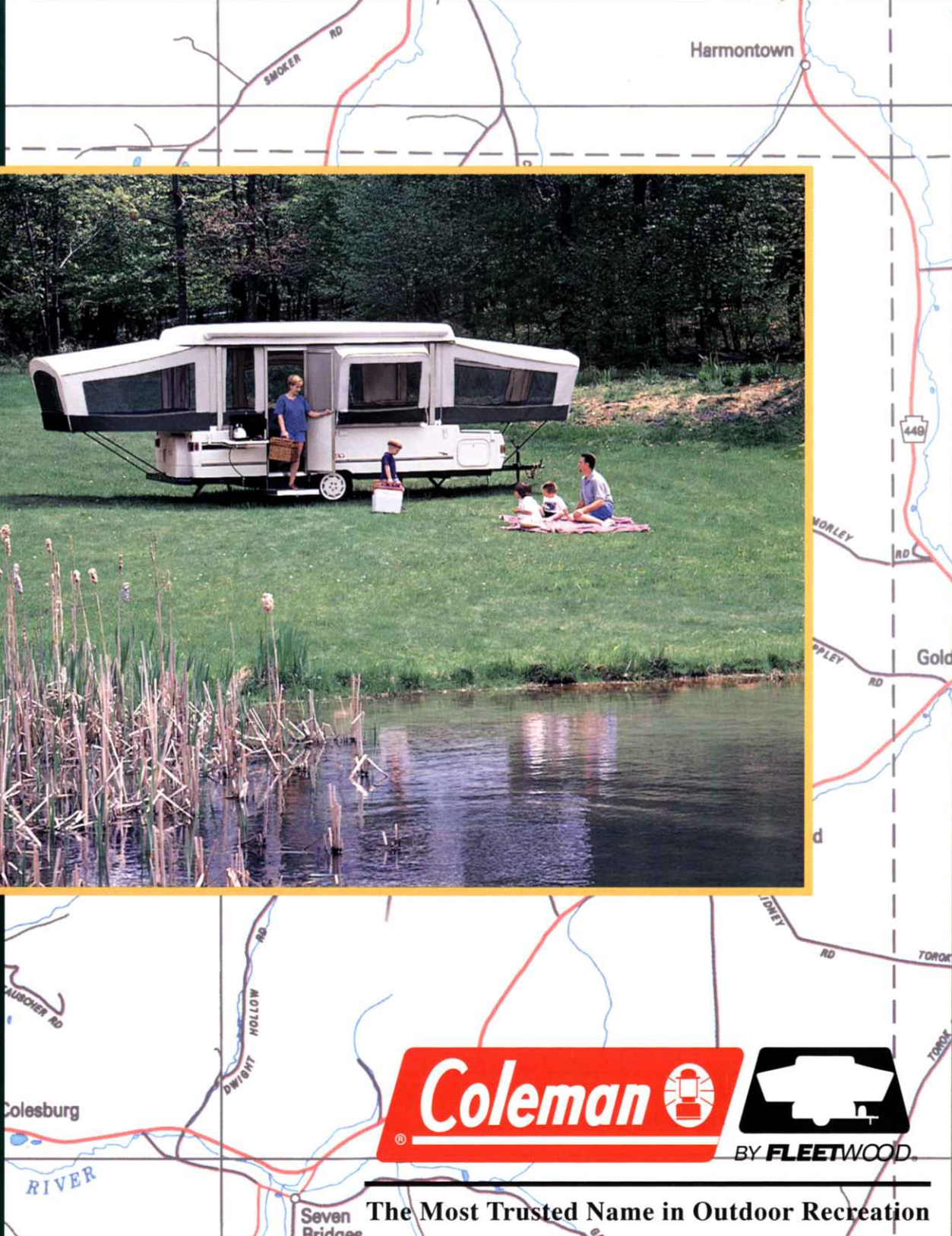

**Coleman** 



BY **FLEETWOOD**

The Most Trusted Name in Outdoor Recreation

# A CENTURY OF PROUD TRADITION



Since  
1900

Camping and the experience of the great outdoors heritage is one of the most invigorating and satisfying activities we can enjoy, either as a family or individually. We're inspired by the outdoors and promise of adventure - everything from hiking and biking to just relaxing with family and friends. When it comes to camping, Coleman has always been a trusted part of the outdoors experience. A role we take very seriously, knowing that our future depends on the trust and loyalty you place in our products.

Our history runs deep not only with the folding trailers we produce, but also with our associates who build them...many of whom have grown up camping and continue to do so with their families. Our average associate has over 12 years of experience. This experience and their dedication to produce the highest quality campers in the world enable us to consistently provide our customers with the best value in a camping trailer.



Through the **Circle of Excellence Customer Satisfaction Program** every Coleman® Folding Trailer owner is contacted after 6 months of ownership to insure our product is meeting our customer's expectations.

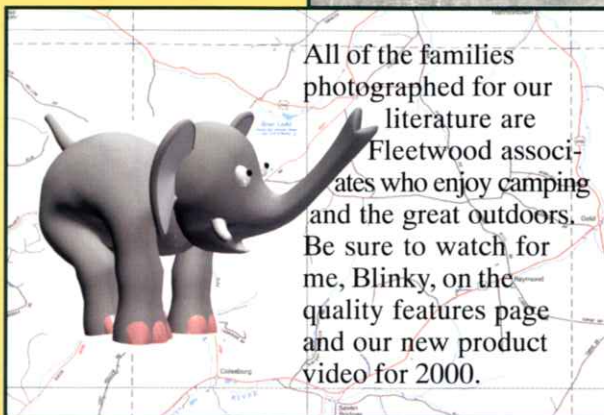

All of the families photographed for our literature are Fleetwood associates who enjoy camping and the great outdoors. Be sure to watch for me, Blinky, on the quality features page and our new product video for 2000.

## The Ultimate In Camping Comfort... GRAND TOUR ELITE SERIES



**2000** brings a new level of product design and innovation, with the Grand Tour Elite Series. The Niagara and Bayside offer more comfort and convenience than ever before, including a larger 3-way refrigerator, exterior aerodynamic body design and optional convenient portable gray water storage. Both models include the "user friendly" Ultra Glide-Out\* Dinette to quickly and easily expand your interior camping comfort and enjoyment.

\*Glide-Out™ design patent pending



▲ The Ultra Glide-Out™ expands your living space.



▲ 3-Way refrigerator with room for 2 liter bottles and plenty more.

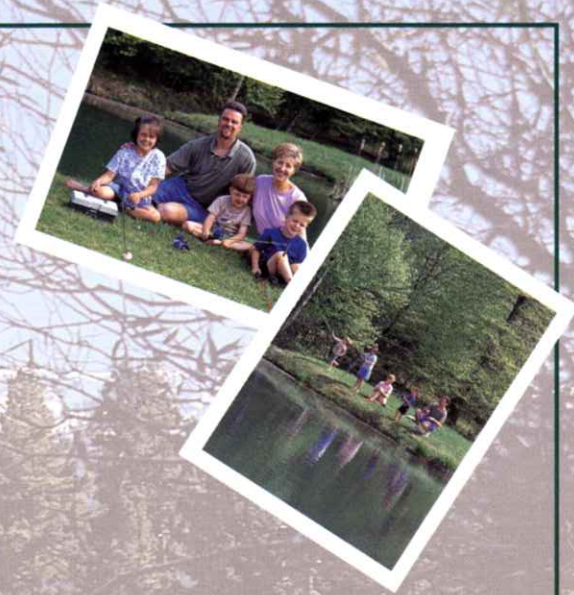

▲ Optional Gray Water System stores beneath trailer. (Gray Water System is available on all models except Destiny Series Taos.)



▲ The Gray Water Tank is portable for convenient waste water disposal...



◀ The Bay Window Galley provides a perfect view and additional living space.



◀ ...and easy set up.



# GRAND TOUR SERIES



▲ For fast and easy cleanup, outside.



▲ Cutlery Tray.



▲ Spice Rack.



## Optional Decor Group Package

**Niagara, Bayside, Utah, Westlake, Mesa & Sun Valley**

- 2 Sets Fitted Bed Sheets (King Size) & Pillow Cases
- Camper Caddie
- Vanity Mate
- Sink Cover/Cutting Board
- 1 Portable Light (Bayside & Niagara 2 Portable Lights)

**Cheyenne, Sea Pine & Santa Fe**

- 1 Set Fitted Bed Sheets (King Size) & Pillow Cases
- 1 Set Fitted Bed Sheets (Double Size) & Pillow Cases
- Camper Caddie
- Vanity Mate
- Sink Cover/Cutting Board
- 1 Portable Light

See pages 14-15 for item descriptions.



▲ Convenient Cassette Toilet and Shower.  
(Standard on Niagara, Westlake and Timberlake models.)

For either the experienced outdoor enthusiast or first time camper who expects the very best, the Grand Tour Series has so much to offer. New on certain models for this year are Natural Comfort sofas and love seats that take relaxation to an art form. All models also include our patented Swing-Level galley with abundant storage; two stoves for inside and outside cooking; and a wide safe entry

Stepper door with storage compartment. You'll appreciate the comfort and convenience features of a Coleman Folding Trailer from your first experience.





▲ Total relaxation with our Natural Comfort sofa, which converts to a bed...

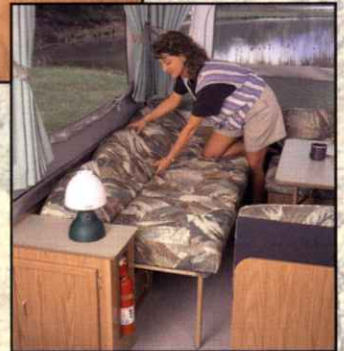

▲ Easy access to the 23 cu. ft. storage trunk, from outside...

...or inside.



**Happy Camper**

## Camping Tip

Keep a journal of your camping experiences. It will provide good rainy day memories of adventures past.

# DESTINY SERIES

The Destiny Series offers exceptional camping comfort and value, with the introduction of the all new Fairview, Timberlake and Sedona models. All models offer abundant interior living space. The Fairview features an Ultra Glide-Out Dinette and the Timberlake features a convenient cassette toilet and shower. There's no better way to connect with nature and experience the great outdoors than in a Coleman Folding Trailer.

## Optional Decor Group Package

### Fairview, Timberlake, Sedona & Taos

- Camper Caddie
- Sink Cover/Cutting Board
- Vanity Mate
- 1 Portable Light

*See pages 14-15 for item descriptions.*



▲ The Ultra Glide-Out dinette provides spacious seating.

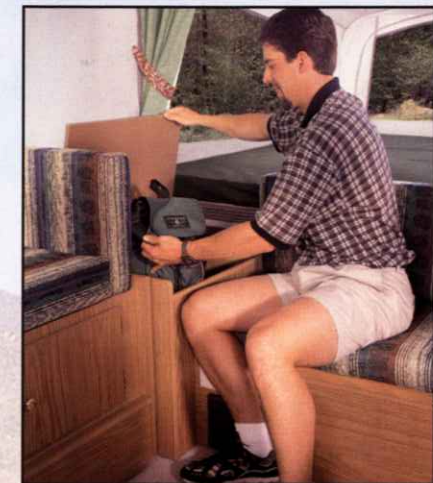

▲ Natural Comfort Sofa with access to flip-up Storage Hutch.





▲ Optional large 3-way gas/ electric refrigerator has adjustable shelves and plenty of storage space.





## Camping Tip

When using lanterns at night, keep them as far away from the campsite as possible. This will help draw bugs away from you.



# 2000 SPECIFICATIONS

|   | Grand Tour Elite Series |             | Grand Tour Series |             |             |            |          |          |          | Destiny Series |            |          |            |
|---|-------------------------|-------------|-------------------|-------------|-------------|------------|----------|----------|----------|----------------|------------|----------|------------|
|   | Niagara                 | Bayside     | Utah              | Westlake    | Mesa        | Sun Valley | Cheyenne | Sea Pine | Santa Fe | Fairview       | Timberlake | Sedona   | Taos       |
| STRATA®(ABS) One-Piece Roof   | Std.                    | Std.        | Std.              | Std.        | Std.        | Std.       | Std.     | Std.     | Std.     | N/A            | N/A        | N/A      | N/A        |
| Electric Power Lift   | Opt.                    | Opt.        | Opt.              | Opt.        | Opt.        | Opt.       | Opt.     | Opt.     | Opt.     | Opt.           | Opt.       | Opt.     | Opt.       |
| EZ-Crank Stabilizers w/Sand Pads  | Std.                    | Std.        | Std.              | Opt.        | Opt.        | Opt.       | Opt.     | Opt.     | Opt.     | N/A            | N/A        | N/A      | N/A        |
| EZ-Crank Stabilizers  | N/A                     | N/A         | N/A               | Std.        | Std.        | Std.       | Std.     | Std.     | Std.     | N/A            | N/A        | N/A      | N/A        |
| Telescoping Stabilizers   | N/A                     | N/A         | N/A               | N/A         | N/A         | N/A        | N/A      | N/A      | N/A      | Std.           | Std.       | Std.     | Std.       |
| Road Height   | 55"                     | 55"         | 55"               | 55"         | 55"         | 55"        | 55"      | 55"      | 55"      | 54"            | 54"        | 54"      | 47"        |
| Length (Closed)   | 7'3"x19'                | 7'3"x19'    | 7'3"x19'          | 7'3"x19'    | 7'3"x19'    | 7'3"x17'   | 7'3"x17' | 7'3"x15' | 7'3"x15' | 7'3"x17'       | 7'3"x17'   | 7'3"x15' | 6'8"x12'2" |
| Length (Open)   | 25'9"                   | 25'9"       | 25'9"             | 25'9"       | 25'9"       | 25'9"      | 21'11"   | 21'11"   | 21'11"   | 25'9"          | 25'9"      | 21'11"   | 17'        |
| Tire Size   | ST185/80D13             | ST185/80D13 | ST185/80D13       | ST185/80D13 | ST185/80D13 | B78-13ST   | B78-13ST | B78-13ST | B78-13ST | ST185/80D13    | B78-13ST   | B78-13ST | 5.30X12    |
| Wheel Covers  | Std.                    | Std.        | Opt.              | Opt.        | Opt.        | Opt.       | Opt.     | Opt.     | Opt.     | Opt.           | Opt.       | Opt.     | N/A        |
| Base Vehicle Weight, lbs.   | 2,688                   | 2,608       | 2,497             | 2,369       | 2,249       | 1,974      | 1,969    | 1,697    | 1,689    | 2,172          | 2,097      | 1,552    | 995        |
| Base Axle Weight, lbs.  | 2,550                   | 2,437       | 2,358             | 2,219       | 2,104       | 1,830      | 1,829    | 1,515    | 1,506    | 2,011          | 1,932      | 1,370    | 870        |
| Base Hitch Weight, lbs.   | 138                     | 171         | 139               | 150         | 145         | 144        | 140      | 182      | 183      | 161            | 165        | 182      | 125        |
| Electric Brakes   | Std.                    | Std.        | Std.              | Std.        | Std.        | Opt.       | Opt.     | Opt.     | Opt.     | Std.           | Std.       | Opt.     | N/A        |
| Cargo Capacity, lbs.  | 562                     | 642         | 753               | 881         | 1,001       | 1,026      | 1,031    | 803      | 811      | 1,078          | 903        | 949      | 705        |
| GVWR, lbs.  | 3,250                   | 3,250       | 3,250             | 3,250       | 3,250       | 3,000      | 3,000    | 2,500    | 2,500    | 3,250          | 3,000      | 2,500    | 1,700      |
| Storage Trunk, cu. ft.  | 23                      | 23          | 23                | 23          | 23          | N/A        | 23       | N/A      | N/A      | N/A            | N/A        | N/A      | N/A        |
| Cabinet Storage, cu. ft.  | 34                      | 40          | 40                | 37          | 42          | 38         | 35       | 40       | 39       | 53             | 39         | 41       | 25         |
| Total Storage Capacity, cu. ft.   | 57                      | 63          | 63                | 60          | 65          | 38         | 58       | 40       | 39       | 53             | 39         | 41       | 25         |
| Refrigerator Capacity, cu. ft.<br>(Opt. Refrigerator Capacity is 1.7 cu. ft.) | 2.4                     | 2.4         | Opt.              | Opt.        | Opt.        | Opt.       | Opt.     | Opt.     | Opt.     | Opt.           | Opt.       | Opt.     | N/A        |
| Built-In Ice Chest, qts.<br>(Portable Ice Chest)                              | N/A                     | N/A         | 57                | 57          | 57          | 57         | 57       | 57       | 57       | 57             | 57         | 57       | 32*        |
| Water Storage, gal. (UF=under floor)  | 20(UF)                  | 20(UF)      | 20(UF)            | 20(UF)      | 20(UF)      | 20(UF)     | 10(UF)   | 10(UF)   | 10(UF)   | 20(UF)         | 20(UF)     | 10       | 5          |
| Sleeping Capacity   | 8                       | 8           | 9                 | 9           | 9           | 9          | 8        | 8        | 7        | 8              | 8          | 7        | 6          |
| Living Area, sq. ft.  | 167                     | 167         | 167               | 155         | 155         | 155        | 143      | 143      | 143      | 167            | 155        | 143      | 91         |
| Interior Height   | 80"                     | 80"         | 80"               | 80"         | 80"         | 80"        | 80"      | 80"      | 80"      | 79"            | 79"        | 79"      | 79"        |
| Shower  | Std.                    | N/A         | N/A               | Std.        | N/A         | N/A        | N/A      | N/A      | N/A      | N/A            | Std.       | N/A      | N/A        |
| Cassette Toilet   | Std.                    | N/A         | Opt.              | Std.        | N/A         | N/A        | N/A      | N/A      | Opt.     | N/A            | Std.       | N/A      | N/A        |
| Hot Water w/Mixer Faucet  | Std.                    | Std.        | Opt.              | Std.        | Opt.        | Opt.       | Opt.     | Opt.     | Opt.     | Opt.           | Std.       | N/A      | N/A        |
| Fresh Water & Battery Charge Indicator  | Std.                    | Std.        | N/A               | N/A         | N/A         | N/A        | N/A      | N/A      | N/A      | N/A            | N/A        | N/A      | N/A        |
| Outside Shower  | Std.                    | Std.        | Opt.              | Std.        | Opt.        | Opt.       | Opt.     | Opt.     | Opt.     | Opt.           | Std.       | N/A      | N/A        |
| Potti Storage Cabinet   | N/A                     | Std.        | Std.              | N/A         | Std.        | Std.       | Std.     | Std.     | Std.     | Std.           | N/A        | Std.     | Std.       |
| Swing-Level® Galley   | Std.                    | Std.        | Std.              | Std.        | Std.        | Std.       | Std.     | Std.     | Std.     | N/A            | N/A        | N/A      | N/A        |
| Spice Rack & Cutlery Tray   | Std.                    | Std.        | Std.              | Std.        | Std.        | Std.       | Std.     | Std.     | Std.     | N/A            | N/A        | N/A      | N/A        |
| Fold-Over Galley  | N/A                     | N/A         | N/A               | N/A         | N/A         | N/A        | N/A      | N/A      | N/A      | Std.           | Std.       | Std.     | Std.       |
| Hi-Pressure Outside Stove   | Std.                    | Std.        | Std.              | Std.        | Std.        | Std.       | Std.     | Std.     | Std.     | N/A            | N/A        | N/A      | N/A        |
| Inside/Outside Stove  | N/A                     | N/A         | N/A               | N/A         | N/A         | N/A        | N/A      | N/A      | N/A      | Std.           | Std.       | Std.     | Std.       |
| Front Bed Size (mattress only)  | 77"x70"                 | 77"x70"     | 77"x70"           | 77"x70"     | 77"x70"     | 77"x70"    | 77"x70"  | 77"x70"  | 77"x70"  | 77"x70"        | 77"x70"    | 77"x70"  | 72"x48"    |
| Rear Bed Size (mattress only)   | 77"x70"                 | 77"x70"     | 77"x70"           | 77"x70"     | 77"x70"     | 77"x70"    | 77"x48"  | 77"x48"  | 77"x48"  | 77"x70"        | 77"x70"    | 77"x48"  | 72"x48"    |
| Quilted Bed Mattresses  | Std.                    | Std.        | Std.              | Std.        | Std.        | Std.       | Std.     | Std.     | Std.     | N/A            | N/A        | N/A      | N/A        |
| Natural Comfort Sofa or Love Seat   | Std.                    | Std.        | Std.              | Std.        | Std.        | Std.       | Std.     | Std.     | N/A      | N/A            | N/A        | N/A      | N/A        |
| Conv. Dinette Bed   | 71"x43½"                | 71"x43½"    | 71"x43½"          | 67"x40"     | 67"x40"     | 67"x40"    | 72"x43"  | 80½"x41" | 72"x43"  | 71"x43½"       | 67"x40"    | 72"x43"  | 74"x43"    |
| Slide-Out Bed Size  | N/A                     | N/A         | 67"x33"           | 67"x33"     | 80½"x33"    | 80½"x33"   | 67"x33"  | 80½"x33" | N/A      | N/A            | N/A        | N/A      | N/A        |
| Dinette Table Size  | 39"x30"                 | 39"x30"     | 39"x30"           | 39"x30"     | 39"x30"     | 39"x30"    | 39"x30"  | 39"x30"  | 39"x30"  | 39"x30"        | 39"x30"    | 39"x30"  | 39"x30"    |
| Stepper Door™   | Std.                    | Std.        | Std.              | Std.        | Std.        | Std.       | Std.     | Std.     | Std.     | N/A            | N/A        | N/A      | N/A        |
| Self Storing Step   | N/A                     | N/A         | N/A               | N/A         | N/A         | N/A        | N/A      | N/A      | N/A      | Std.           | Std.       | Std.     | Std.       |
| Spare Tire  | Std.                    | Std.        | Std.              | Std.        | Std.        | Std.       | Std.     | Std.     | Std.     | Std.           | Std.       | Std.     | Std.       |
| Box Size (inside)   | 12'                     | 12'         | 12'               | 12'         | 12'         | 12'        | 10'      | 10'      | 10'      | 12'            | 12'        | 10'      | 8'         |

- \*Gross Vehicle Weight Rating is equal to Base Vehicle Weight plus Cargo Capacity.
- When ordering installed refrigerator, the built-in ice chest is deleted.
- Options May Be Dealer Installed.



## Additional Grand Tour Elite Special Features

### STANDARD on Niagara & Bayside Models.

- 2.4 cu. ft. 3-Way Gas/Electric Refrigerator
- Hot Water w/Mixer Faucet
- Outside Shower w/Hot Water
- Fresh Water & Battery Charge Indicator
- EZ-Crank Down Stabilizer Jacks with Sand Pads\*
- ABS Spare Tire Cover\*
- ABS Gas Bottle Cover
- Electric Brakes
- Stylish Wheel Covers

### Grand Tour Extras...

#### At No Extra Charge!

- One-Piece Seamless STRATA (ABS) Roof\*
- Exclusive Natural Comfort Quilted Bed Mattresses\*
- Roof Air Conditioner Ready
- Sectional Sunbrella 302 Breathable Acrylic Tenting\*
- Swing-Level Galley with Full Upper & Lower Storage\*
- Wide & Safe Stepper Door\*
- Extra Wide, One-Piece Screen Door\*
- Two Stoves-High Pressure Outside Stove\* & Low Pressure Inside Stove
- Portable Dinette Table\*
- Comfort Zone High Density Foam Seat Cushions\*
- Posi-Lock Stainless Steel Lift System\*
- Clear Vinyl Windows\*
- Extra Fine Mesh Screening\*
- Under-Floor Water Storage
- Two Double Ceiling Lights
- EZ-Crank Down Stabilizer Jacks\*
- One-Piece Structurwood Floor & Bed Wood\*
- Spare Tire & Lug Wrench
- Tubular Steel Frame\*
- Full Perimeter Aluminum Bed Frames\*
- Permanently Attached Bed Supports\*
- Impact Resistant Front & Rear ABS Panels\*
- Scratch Resistant Krystal Kote Aluminum Side Panels
- Self-Storing Swivel Tongue Dolly Jack\*
- Vinyl Spare Tire Cover
- Vinyl Gas Bottle Cover
- Two Sets of Privacy Curtains

## Grand Tour Elite Floor Plans

### Niagara

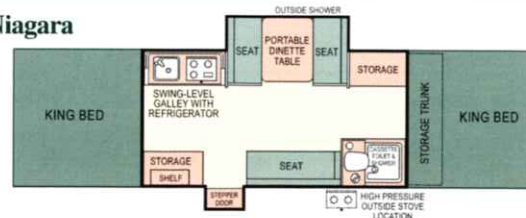

### Bayside



## Grand Tour Floor Plans

### Utah

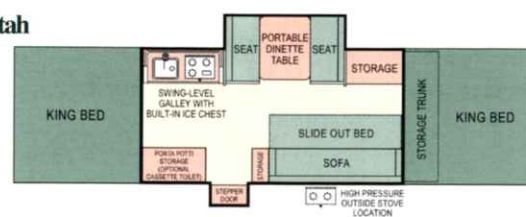

### Westlake

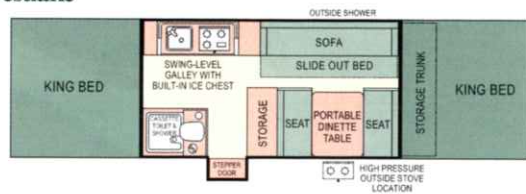

### Mesa

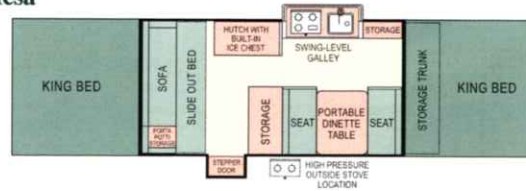

### Sun Valley

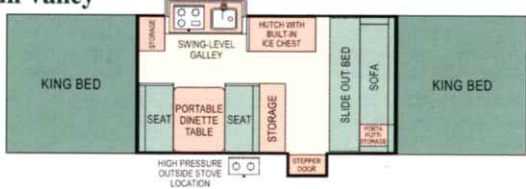

## Cheyenne

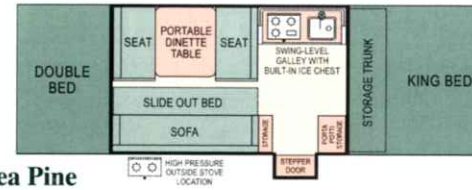

## Sea Pine

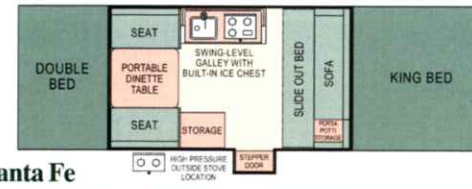

## Santa Fe

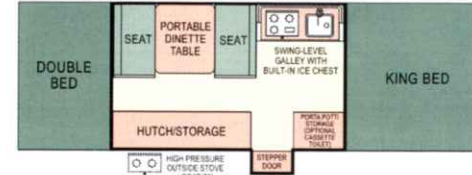

## Destiny Floor Plans

### Fairview

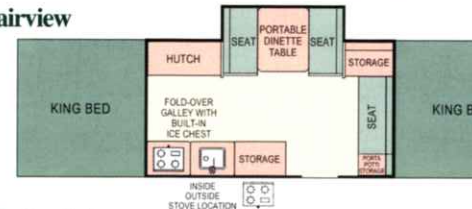

### Timberlake

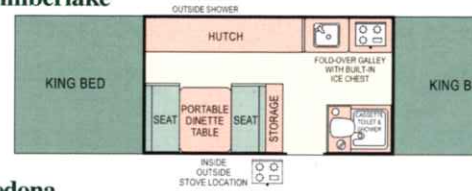

### Sedona

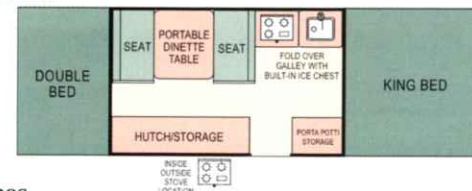

### Taos

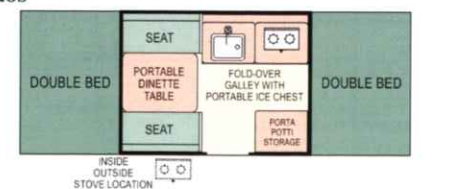

## Destiny Extras...

### At No Extra Charge!

- Insulated Aluminum Roof
- Roof Air Conditioner Ready (Except Taos Model)
- Sectional Sunbrella 302 Breathable Acrylic Tenting\*
- Full Upper & Lower Storage Fold-Over Galley
- Extra Wide, One-Piece Screen Door\*
- Large Built-In Ice Chest (Taos Offers Portable Ice Chest)
- Transportable Inside/Outside Stove
- Portable Dinette Table\*
- Comfort Zone High Density Foam Bed & Seat Cushions\*
- Posi-Lock Stainless Steel Lift System\*
- Clear Vinyl Windows\*
- Extra Fine Mesh Screening\*
- Two Ceiling Lights
- Telescoping Stabilizer Jacks
- One-Piece Structurwood Floor & Bed Wood\*
- Spare Tire & Lug Wrench
- Tubular Steel Frame\*
- Full Perimeter Aluminum Bed Frames\*
- Permanently Attached Bed Supports\*
- Impact Resistant Front & Rear ABS Panels\*
- Scratch Resistant Krystal Kote Aluminum Side Panels
- Self-Storing Swivel Tongue Dolly Jack\*
- Slide-Out Step
- Two Sets of Privacy Curtains
- Vinyl Spare Tire Cover
- Vinyl Gas Bottle Cover

# The Coleman® Folding Trailer Advantage!

Offering the Smartest Design Features and Construction Available...

Lightweight, free-standing portable dinette table can be used inside or out.

\*Strong, dependable, stainless steel lifter system features a Posi-Lock crank mechanism and self draining lifter arms that won't rust or bind.

\*Exclusive High density, Comfort Zone™ seat cushion foam provides durable comfort. Certain models offer all new "Natural Comfort" sofas and love seats.

\*Automotive-style, double sidewall construction allows body panels to be easily and inexpensively replaced if damaged.

Krystal-Kote® finish aluminum side body panels resist scratching and marring.

ABS impact resistant front and rear body panels provide protection from road gravel and stones.

Under floor water storage on all Grand Tour Series and Destiny Series Fairview & Timberlake models frees up valuable interior storage space.

Seamless, molded wheel wells that won't rust or allow water or dust to penetrate the trailer interior.

Exclusive, D-range 13" tires on certain models provide increased capacity and durability. (Destiny Series Taos model offers 12" tires) Wheels are attached with 5 lug nuts for added safety.

\*Grand Tour Series offer an exclusive self-storing Stepper™ door that is extra wide, sturdy and safe. Destiny Series offer a slide-out step.

Seamless, one-piece Structurwood® flooring provides a strong, consistently level floor that won't warp or delaminate.

Built-in ice chest or optional 3-way gas/electric refrigerator offers plenty of food storage. (Refrigerator standard on Grand Tour Elite models and not available in Destiny Series Taos model).

\*Grand Tour Series offer an exclusive molded, one-piece STRATA™ (ABS), seamless roof that is strong, durable and guaranteed not to leak...ever! The Destiny Series offer an insulated aluminum roof. All roofs have built-in canopy track

Clear vinyl windows for a brighter interior on overcast days, plus fine mesh screening to keep even the tiniest insects out.

\*Grand Tour Series offer exclusive two-stove cooking convenience with a high pressure outside stove and a low pressure inside stove. The Destiny Series offer a single inside/outside low pressure transportable stove.

\*Spacious upper and lower storage in the Grand Tour Series exclusive Swing-Level® galley and Destiny Series Fold-Over galley.

Angled conestoga bed design allows end windows to be opened for cross-ventilation even in a rainstorm.

\*Exclusive Sunbrella® 302 acrylic tenting fabric is highly breathable so it won't trap heat or odors, plus it will not crack, mildew, dry rot, fade or leak...and it's hypoallergenic.

\*Grand Tour Series offer exclusive Natural Comfort™ quilted bed mattresses providing comfortable therapeutic support for a good night's rest. Destiny Series offer high density EnviroCure® foam mattresses for maximum comfort and support.

\*Seamless, one-piece Structurwood® beds have full perimeter aluminum frames to prevent warping and provide easy setup without binding. (All beds tested to over 1,000 lbs. capacity. Destiny Series Taos model tested to over 750 lbs.)

\*Easy to position, self-storing attached bed supports can't be lost or left behind.

\*Full perimeter, tubular steel frame offers greater strength and durability plus protects trailer wiring from road debris.

\*Exclusive, self-storing, swivel tongue dolly jack with permanently attached wheel. Dolly jack won't interfere with tow vehicle's rear mounted spare tire or tailgate.

\*Grand Tour Series offer EZ Crank-Down stabilizers providing convenient, easily accessible and dependable way to stabilize the trailer. Grand Tour Series Niagara, Bayside and Utah models offer EZ Crank-Down Stabilizers with sand pads. Destiny Series offer telescoping stabilizers. (Stabilizers not shown)

Front storage trunk on certain models provides up to 23 cubic feet of space for camping gear, with easy access from the top, side or inside the trailer.

\*Features detailed on pages 12-13.

## Coleman® Folding Trailers...Convenience and Safety!

Coleman Folding Trailers offer more than just shelter. Each trailer is designed to make your camping experiences comfortable, relaxing, and as safe as possible. From features that assist you in setting up quickly and easily, to protection for keeping you warm and dry on those not-so-sunny days, to innovative engineering for easy maintenance and service of your trailer. Coleman Folding Trailers is leading the way in both convenience and safety to provide you with years of worry-free camping.

### Lifter System

- Stainless steel lifter system will not corrode or rust.
- It is designed to require minimal effort to raise the roof.
- Its unique location allows accessible servicing without removing interior walls and cabinets.
- The lift arms extend through the trailer sidewall and are attached to the frame, allowing rain water to flow through onto the ground, not into the trailer.
- The crank mechanism is equipped with posi-lock, allowing the operator to stop and release the crank handle without fear of kick-back or free-fall.
- The system is free-standing, safe and does not require additional support to prevent the roof from accidentally coming down.

### Sunbrella Tenting

- The **exclusive** Sunbrella 302 Tenting is made of breathable acrylic material that's hypoallergenic and guaranteed waterproof.
- Won't mildew, dry rot, fade, or crack.
- Because of its special breathable design, moisture and odors escape without a roof vent.
- Meets or exceeds the Federal Government's Flame Retardancy code 302 standards.
- Sectional design provides a less expensive way to replace damaged sections.
- Continuous, double-needle stitching and double lap-fold seams prevent unraveling and provide strong water-tight seals from the very first time it gets wet.

### Stabilizers

- Crank-down stabilizers on the Grand Tour Series are easily accessible and simple to operate.

- Stabilizer with sand pads make a solid foundation on soft or sandy ground (sand pads standard on Elite models; optional on Grand Tour Series)

### Dolly Jack

- Exclusive**, self-storing, swing-up dolly jack has a permanently attached wheel, so it doesn't require assembly.
- The jack is mounted to the side of the trailer tongue so it won't interfere with the tow vehicle's rear-mounted spare tire or tailgate.

### Tires

- The **exclusive** D-Load Range (certain models) tires provide increased capacity and durability.
- Five lug nuts are used on each wheel for added safety.
- A lug-nut wrench is included as standard equipment with each trailer.

### Stepper Door

- Exclusive** Stepper Door (Grand Tour Series) provides an extra wide, sturdy and safe entry step into the trailer.
- The door features a convenient, lockable storage compartment.

### Screen Door

- One-piece screen door requires no assembly and easily sets into place.
- It's self-contained in a single frame so the trailer does not need to be perfectly level for installation.
- The door is a full 24 ½ inches wide to allow easy and safe access to the trailer.
- The door knob is located at waist-level. For easy use without stooping or bending to reach.

- The automatic spring-loaded door return provides hands-free closing.

### Bunk Ends

- Exclusive** Conestoga-style, angled bunk ends, combined with fine mesh screening, allows good cross-ventilation, even when it rains.

### Beds

- The beds glide out with minimal effort and feature full-perimeter aluminum frames to prevent warping and binding.
- Bed supports are easy to position and are self storing so they can't be misplaced.

### Glide-Out Dinette

- Exclusive** Ultra Glide-Out dinettes (certain models) can be set in place with minimal effort.
- They do not require additional stabilizers and are tested to over 1,000 lbs. capacity.

### Swing-Level & Fold-Over Galleys

- The **exclusive** Swing-Level (Grand Tour Series) and Fold-Over (Destiny Series) galleys position quickly and easily and provide plenty of upper and lower storage.
- Items don't need to be removed when traveling and the Swing-level galley design provides a no-spill feature so items remain in place when positioning the galley.
- As a safety precaution the galleys incorporate an automatic power control switch that shuts off electricity to the trailer when set in the travel position.

**Coleman Folding Trailers by Fleetwood... Campers Built for Life!**

*"We Back Our Product Better Because We Build It Better"*

2000 COLEMAN FOLDING TRAILERS

**HASSLE FREE**

## WARRANTY

THE INDUSTRY'S BEST BUYER PROTECTION PLAN

**LIMITED LIFETIME\***

**MOLDED STRATA™ (ABS) ONE-PIECE ROOF**  
(Excluding Porches, Timberluxe, Deluxe & Teak Models)

**TUBULAR STEEL FRAME**

**ONE-PIECE STRUCTURWOOD™ FLOOR**

**ONE-PIECE STRUCTURWOOD™ BED PLATFORM**

**STAINLESS STEEL LIFTER SYSTEM**

**LIMITED FIVE YEAR\***

**EXCLUSIVE SUNBRELLA™ 302**  
**ACRYLIC TENTING MATERIAL**  
(Call us without an appointment to help you choose!)

**LIMITED ONE YEAR\***

**ALL OTHER TRAILER COMPONENTS**  
(Excluding Tires)

With Fleetwood, you don't have to call all over the country if you need service. Your nearest authorized Fleetwood Folding Trailer dealer provides a single source for all your service needs. Your Fleetwood extended life warranty on this your authorized Fleetwood Folding Trailer provides complete details. This warranty gives you specific legal rights and you may also have other rights which vary from state to state.

\*specified structural components... covers repair of defective parts, labor, and freight for the first full year and repair of specific defective parts and labor for years two and beyond from date of purchase... for as long as you own your trailer.

**WE BACK OUR PRODUCT BETTER BECAUSE WE BUILD IT BETTER!**





*With Coleman Folding Trailers, you don't have to call all over the country if you have a problem. Your nearest authorized Coleman Folding Trailer dealer provides a single source for all your service needs.*

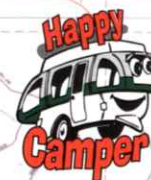

## Camping Tip

Make a campfire almost smokeless. Lay larger pieces of wood on the bottom, build up with smaller layers. Then place the kindling on top...different, but it works!



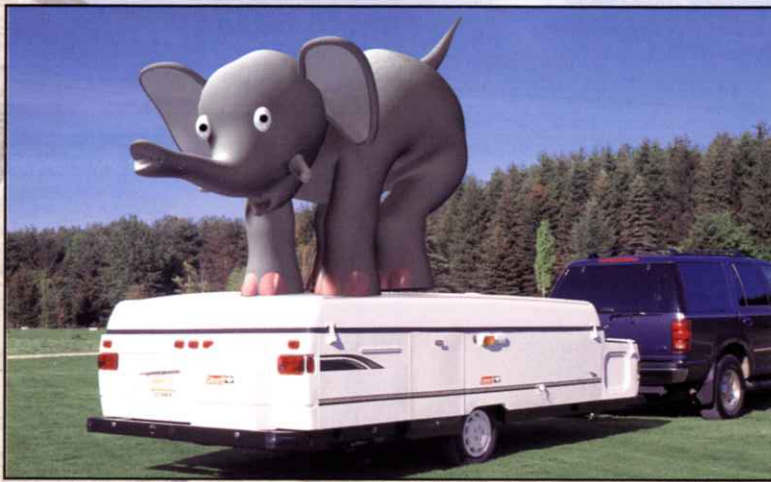

▲ **The Strongest Roof in the Industry with a Limited Lifetime Guarantee.** Coleman's, patented one-piece STRATA™ (ABS) roof is guaranteed not to leak...ever! It's extremely strong, durable design protects against all types of harsh weather, including damaging hail.

**The Number One Outdoor Tenting Fabric in the Industry with an Exclusive Limited 5 Year Guarantee.**

Exclusive Sunbrella® 302 fabric's superior breathability allows, humidity and cooking odors to escape while keeping rain out. The fabric will not fade, crack, mildew or dry rot, plus it's extremely strong, durable and hypoallergenic.

The clear vinyl windows provide an unobstructed view, providing a brighter interior even on cloudy days. Plus, the fine mesh screening lets in the slightest breeze while keeping the smallest insect out.

The tenting is assembled using continuous double needle stitching and double lap-fold seams to prevent unraveling and provides a secure watertight seal.



**Exclusive Natural Comfort™ Mattresses.** Our quilted Comfort-Zone™ mattress uses environmentally safe EnviroCure® high density foam which provides a superior level of comfort, therapeutic support and durability for a good night's rest. (Destiny Series feature high density foam mattresses) ➤

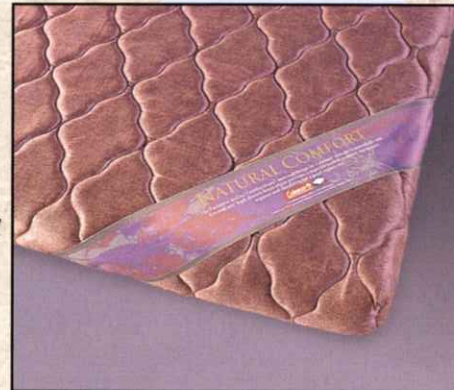

◀ **Natural Comfort™ sofas and love seats provide a high level of comfort and attractiveness (certain models).**



◀ **Most Dependable Lift System in the Industry with Limited Lifetime Guarantee.** Heavy gauge, stainless steel lifter arms will not rust or bind. They run directly through the trailer's double sidewall construction attaching to the outer side of the frame. This allows rain water to drain completely through and onto the ground, eliminating the need for protective lift arm covers.



▲ **Standard equipment Lug Wrench to make tire changing easier.**

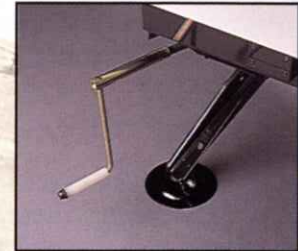

▲ **EZ Crank-down stabilizers provide a convenient easily accessible and dependable way to stabilize your trailer. The optional sand pads provide a solid foot print on soft ground or sand.**

(Destiny Series feature telescoping stabilizers. Sand Pads standard on Niagara, Bayside & Utah)



▲ **Exclusive self-storing swivel dolly jack with permanently attached wheel will not interfere with tow vehicles tailgate or rear mounted spare tire.**



▲ **Exclusive Swing-Level<sup>®</sup> galley design!**

A fully stocked galley sets in place easily, plus the cantilever upper galley stays parallel to the floor when positioning, preventing its contents from spilling or tumbling upside down. (Destiny Series offer a full storage fold over galley.)



▲ **Coleman's one-piece screen door** is easy to set in place and is extra wide for easy access, plus has an automatic spring return so you can't accidentally leave the door open. **The Exclusive Stepper<sup>™</sup> Door** patented design provides an exceptionally wide, safe and sturdy step for easy access to the trailer. (Destiny Series provide a slide-out step.)



▲ **Exclusive Durable "Rough Country" Construction**

Coleman features an interlocking, full perimeter skeletal framework of riveted and welded aluminum and steel that stands up to twisting and racking even on rough country roads.

▼ **The Strongest Frame in the Industry with a Limited Lifetime Guarantee.** The Coleman full perimeter tubular steel frame offers greater strength and durability over c-channel frames. The Coleman frame supports the weight of the trailer load and distributes road stress more evenly providing a stronger foundation and greater towing stability. (Test performed by an independent testing & research laboratory - showing c-channel frame failing at approximately 2,600 pounds of pressure... the tubular frame supporting 15,000 pounds of pressure.)



Coleman Folding Trailer Frame

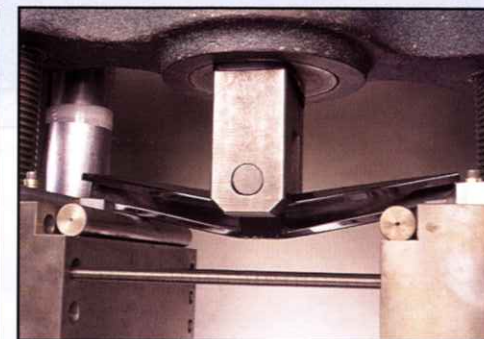

Other Folding Trailer Frame

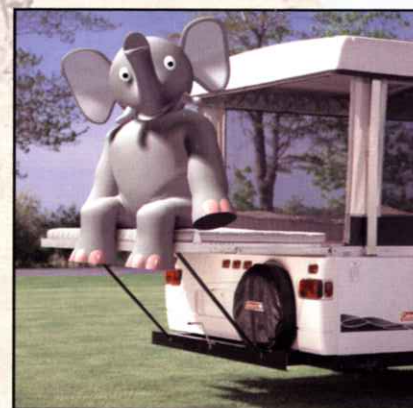

▲ **The Sturdiest and Most "User Friendly" Bed Support System in the Industry!** Seamless, one-piece Structurwood<sup>®</sup> beds with full perimeter aluminum frames prevent beds from warping and binding. Plus, with self-storing attached bed supports there's no possibility for them to be lost or misplaced. Bunk ends are tested to support over 1,000 pounds. (750 pounds on Taos model)



▲ **Cooking is easy...inside or out!** The **Grand Tour Series** comes standard with two stoves, an outside high pressure stove shown here that is efficient even in a wind storm and low pressure stove on the inside galley. The **Destiny Series** comes with a transportable low pressure stove that can be used inside or out.



▲ Double your living space with this Coleman Screen Room, featuring fine mesh screening and full perimeter skirting.



◀ Exterior bunkend hideaway provides attractive privacy for bikes and extra camping gear.



◀ Gray water system includes portable tank for convenient waste water disposal.

(Not available on Destiny Series Taos model. With added weight an anti-sway/weight distribution control is strongly recommended for towing stability. Trailer should be towed only with an empty gray water storage tank.)



◀ Keep cool this summer with roof mounted air conditioning. (2000 model trailers feature standard factory air prep, except Taos model. See your dealer for proper BTU sizing and installation requirements.)



▲ A genuine Yakima® rack system gives you the option to take all your toys with you with the available canoe brackets & straps, bike carrier and cargo basket.



◀ Add the finishing touch to your Grand Tour Series trailer with ABS gas bottle and spare tire covers. (Standard on Niagara and Bayside models. ABS gas bottle cover not shown.)

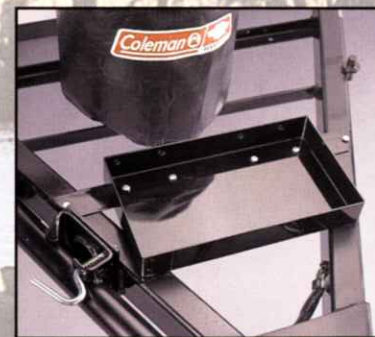

▲ Optional tongue mounted battery tray.



▲ Free standing portable table can provide additional dining or serving space.



▲ Double your living space with this Coleman Deluxe Add-A-Room featuring fine mesh screening, privacy panels, clear vinyl rain flaps and heavy duty zippered sections for easy setup and take down. (See page 2 for optional canopy, shown separately.)



▲ Energy efficient LP gas forced-air furnace, with electronic ignition, provides 16,000 BTUs of heating with thermostat controlled comfort.



▲ Setup as easy as 1-2-3 with convenient electric power lift with remote control.



▲ Handy portable light.



▲ Perfect out of the way bed storage shelf for night time items. (Not available on Taos model.)



▲ Optional color coordinated fitted sheets and pillow cases are available for all Grand Tour Models.



▲ This handy soft side detachable Camper Caddie® wardrobe makes trip preparation quick, easy and provides loads of personal storage.



▲ The Coleman Vanity Mate™ provides convenient storage for tooth brushes, toiletries, paper towels and other daily necessities.



◀ Sink cover cutting board.

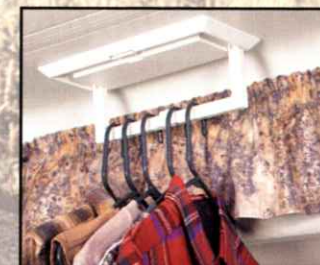

◀ This convenient fold-up wardrobe rack provides extra space to hang clothes. Standard on all Grand Tour models. (See your dealer for optional wardrobe rack for Destiny Series models.)

# We'll Take You There!



Manufactured under license from the Coleman Company, Inc. by Fleetwood Folding Trailers, Inc.



Fleetwood Folding Trailers subscribes to the Tread Lightly principles of traveling only on designated routes, respecting the rights of others, educating yourself, and camping responsibly.



Your Local Fleetwood Folding Trailer Dealer:

FLEETWOOD Folding Trailers, Inc. • 258 Beacon St. • Somerset, PA 15501 • (814) 445-9661

Visit our Website [www.colemantrailers.com](http://www.colemantrailers.com)

A TINY LITTLE DIVISION OF  
FLEETWOOD Enterprises, Inc. • P.O. Box 7638 • Riverside, CA 92513-7638  
[www.fleetwood.com](http://www.fleetwood.com)

If your local dealer is not indicated call toll-free,  
24 hours: 1-800-444-4905 or write / e-mail to the address above.

We are doing  
our part to  
protect the  
environment by  
printing this  
brochure on  
recycled paper



Coleman and Coleman are registered trademarks of The Coleman Company, Inc. used under license. Photography and product information in this brochure was accurate at the time of publication, subsequent refinements may appear in the final product without incurring any obligation to incorporate such changes in any product previously manufactured. Specifications are subject to change without notice. Selected decorator items shown in the photography are not part of the product unless specified. All liquid capacities, weights, and dimensions are approximate.  
©1999 Fleetwood Folding Trailers, Inc./The Coleman Company, Inc. Enterprises, Inc.

Litho in USA CPB0799