

We Build Lasting M E M O R I E S



-  Grand Tour SeriesPg. 4
-  Destiny SeriesPg. 6
-  SpecificationsPgs. 8 & 9
-  Warranty InfoPg. 11
-  Standard Features . . .Pg. 12 & 13
-  AccessoriesPg. 14 & 15

1 9 9 8



The Most Trusted Name in Outdoor Recreation

1998 Grandview SP at Somerset Lake, PA, (with options)

Coleman



BY **FLEETWOOD**.

A Proud Family Tradition Since 1900...

When pioneers pressed westward for land and opportunity they left their homes and packed all they would need for the journey. Those were difficult times and those who were not prepared were unsuccessful, but for those who were, their dreams became reality. While we no longer pack up and venture into nature's unknown out

of necessity, we are still inspired by the pioneer spirit we have inherited from our ancestors.

That same pioneer spirit remains inherent in all of us. The value of enjoying time with your family and friends in the great outdoors.

A value that has been a part of the Coleman® tradition since 1900.

Whether you are a veteran camper looking to upgrade or just starting out, we can help take the hassle and confusion out of finding the best value in a folding trailer. We provide you with the selection and choice of products you need and all the support you expect. We recognize that when you invest in a Coleman® Folding Trailer by Fleetwood®, you're investing in your family.

We respect the investment you're making when you decide to purchase our product and we take our responsibility seriously. Have a look at the different models and features we have to offer you in 1998...from our family to yours.



Through the **Circle of Excellence Customer Satisfaction Program** all Coleman® Folding Trailer owners are contacted to insure our product is meeting our customer's expectations.



Expand your camping comfort...

All new for 1998 are three Grand Tour Ultra Glide-Out™ models, the Grandview, Grandview SP, and Bayside. There's no better way to enjoy the great outdoors than with the expanded living space offered by Coleman® Folding Trailer's exclusive Ultra Glide-Out™ design. The perfect vehicle for quality family time. 

(Glide-Out™ design patent pending)



The NEW Ultra Glide-Out™ expands your living space, while bringing your family closer together...



Convenient cassette toilet & shower...



Large open floor space...



Spacious dining area...



We love spending time together enjoying the great outdoors.

One thing's for sure, these are the times a family will never forget.



CAMPING TIP

Keep A Journal: Encourage your children to keep a journal of daily activities, wildlife sightings and hiking details. This information can be used later in writing letters to family and friends or for school writing assignments.

This page features the Grandview SP model, shown with optional canopy, ABS spare tire cover and gas bottle cover.

Experience the Best with the Grand Tour Series...

The comfort and convenience of our 1998 Grand Tour Series is evident from the moment you see it...from its stylish exterior design to its spacious interiors.

Wherever your travels take you, you'll have the time-tested quality and reliability of a Coleman® Folding Trailer by Fleetwood®. Get ready for the most enjoyable travel companion your family has ever experienced! 

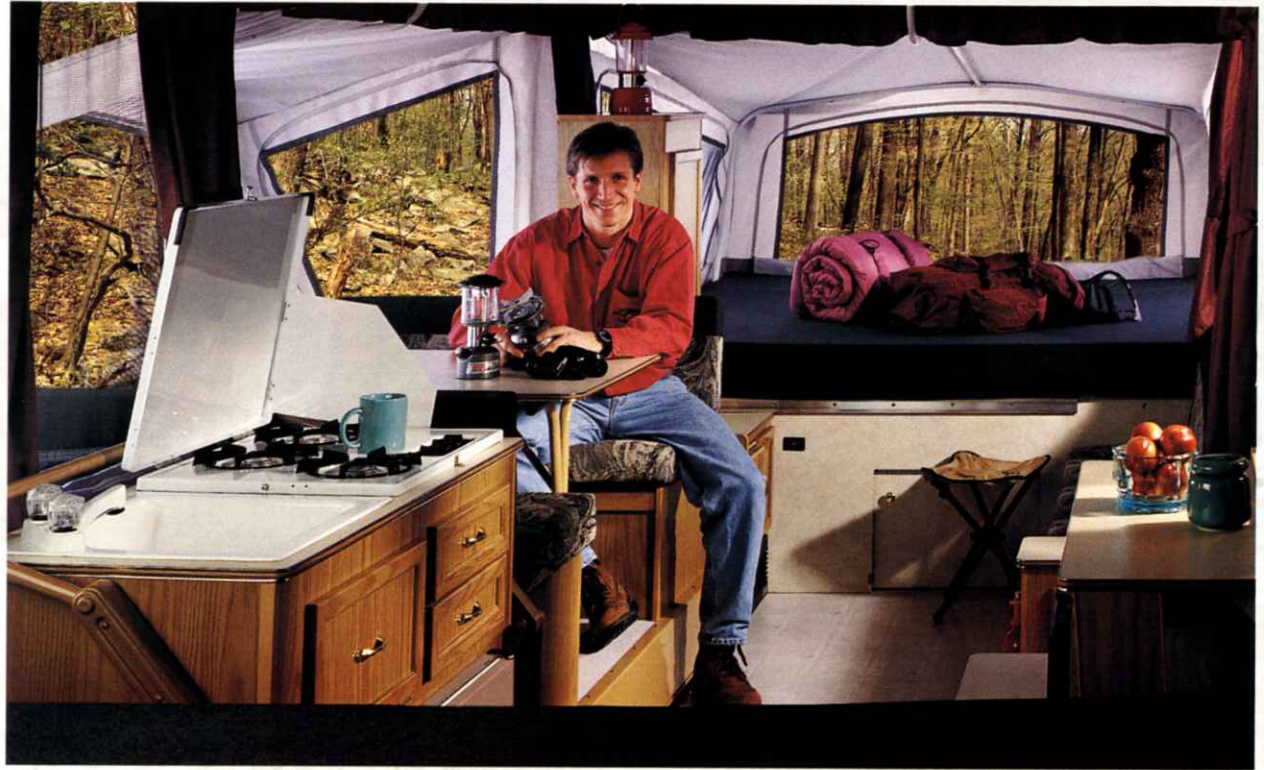

All the space you need to do the things you enjoy most...



Good times with good friends after a day of hiking...



NEW wardrobe provides convenient storage for clothes...



NEW Ultra Glide-Out™ dinette provides spacious seating...



The bay window galley area adds space and light for cooking and clean-up...



We came across an antique car show today and spent some time chatting with new acquaintances. I think it was E.B. White who said, "Everything in life is somewhere else, and you get there in a car." Truer today than ever before, but what do you do when you get there? Since we had our Coleman® folding trailer with us, the possibilities to that question were endless.



Plenty of comfortable seating for you and your friends...



Additional sleeping space with slide-out bed...



Fast and easy clean-up with the outside shower...

This page features the Sun Ridge model, shown with optional ABS spare tire cover.



CAMPING TIP

Vegetables wrapped in aluminum foil with two tablespoons of water will cook in about 15 minutes over hot coals.



Camping in Comfort with the Destiny Series...

Our new 1998 Destiny Series combines convenient features, plenty of storage and comfort you'll appreciate at a price you can afford.

There's no better way to enjoy the great outdoors than in a Coleman® Folding Trailer by Fleetwood®.



Large dining area for family fun...



Enjoying the simple pleasures of life with your family...



Easy access to the 26cu. ft. storage trunk...



This page features the Cheyenne model, shown with optional Yakima Roof Rack System and vinyl spare tire cover.



There's plenty of space to relax, making our camping together much more enjoyable...



Optional refrigerator with room for 2 litre bottles and plenty more...



Sometimes it rains when we're camping, so we nestle down, heat up some hot chocolate, sit back, and listen to the soft, soothing murmur of the falling rain. We soon learn that Mother nature is a hypnotist as she casts her peaceful spell with each fragile drop. We wouldn't trade these moments together for anything.



This page features the Redwood model, shown with optional vinyl spare tire cover, gas bottle cover, and entry step.



CAMPING TIP

Dip Wooden matches in nail polish or paraffin to keep them dry.



Niagara

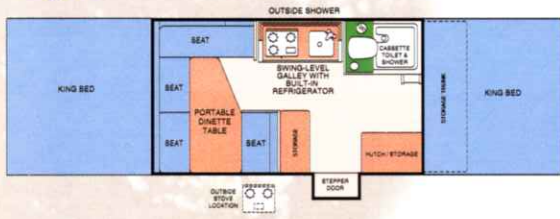

Bayside

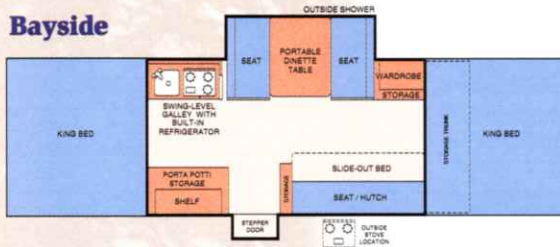

Grandview SP

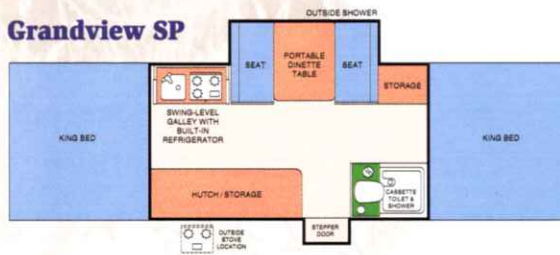

Grandview

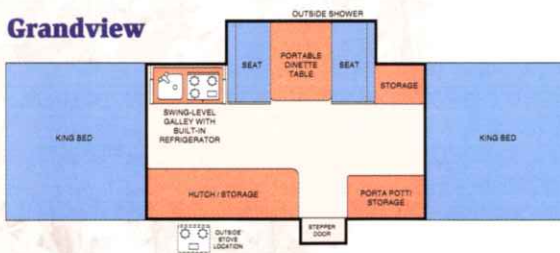

Sun Ridge

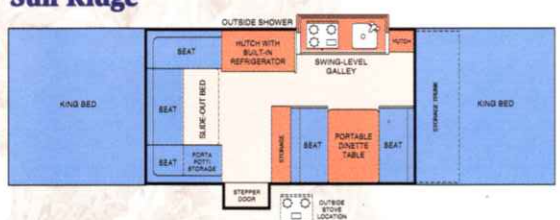

1998 Grand Tour Series

FLOOR PLANS AND SPECIFICATIONS

	Niagara	Bayside (Glide-Out)	Grandview SP (Glide-Out)	Grandview (Glide-Out)	Sun Ridge
ABS One-Piece Roof	Std.	Std.	Std.	Std.	Std.
Hydraulic Lift	Std.	N/A	N/A	N/A	N/A
EZ Crank-Down Stabilizers	Std.	Std.	Std.	Std.	Std.
Road Height	55"	55"	55"	55"	55"
Length (Closed)	7'3"x19'	7'3"x19'	7'3"x17'	7'3"x17'	7'3"x19'
Length (Open)	25'9"	25'9"	25'9"	25'9"	25'9"
Tire Size	C78-13ST	C78-13ST	C78-13ST	C78-13ST	C78-13ST
Base Vehicle Weight, lbs.	2,425	2,632	2,350	2,350	2,334
Base Axle Weight, lbs.	2,223	2,492	2,163	2,163	2,217
Base Hitch Weight, lbs.	202	140	187	187	117
Electric Brakes	Std.	Std.	Std.	Std.	Std.
Cargo Capacity, lbs.	825	618	900	900	916
Storage Trunk, cu. ft.	26	26	N/A	N/A	26
Refrigerator Capacity, qts.	57	57	57	57	57
Water Storage, gal.	20(UF)	10 (UF)	20(UF)	10(UF)	10 (UF)
Sleeping Capacity	8	9	8	8	9
Living Area, sq. ft.	155	178	178	178	155
Interior Height	80"	80"	80"	80"	80"
Shower	Std.	N/A	Std.	N/A	N/A
Cassette Toilet	Std.	N/A	Std.	N/A	N/A
Hot Water w/Mixer Faucet & Demand Elec. Water Pump	Std.	Std.	Std.	Std.	Std.
Outside Shower	Std.	Std.	Std.	Std.	Std.
Potti Storage Cabinet	N/A	Std.	N/A	Std.	Std.
Swing-Level Galley	Std.	Std.	Std.	Std.	Std.
Hi-Pressure Outside Stove	Std.	Std.	Std.	Std.	Std.
Bed Size	77"x70"	77"x70"	77"x70"	77"x70"	77"x70"
Bed Size	77"x70"	77"x70"	77"x70"	77"x70"	77"x70"
Conv. Dinette Bed	52"x80½"	35"x74"	43¼"x71¼"	43¼"x71¼"	39"x70"
Slide-out Bed Size	N/A	43"x71"	N/A	N/A	37"x80"
Dinette Table Size	28"x54"	28½"x42½"	28½"x42½"	28½"x42½"	30"x39"
Cabinet Storage, cu. ft.	37	43	38	48	45
Outside Storage Access	Std.	Std.	Std.	Std.	Std.
Stepper Door	Std.	Std.	Std.	Std.	Std.
Spare Tire	Std.	Std.	Std.	Std.	Std.

- Gross Vehicle Weight Rating is equal to Base Vehicle Weight plus Cargo Capacity.
- Options May Be Dealer Installed.

Grand Tour Extras... At No Extra Charge!

- One-Piece Seamless ABS Roof*
- Sectional Sunbrella® 302 Breathable Acrylic Tenting*
- Swing-Level Galley with Full Upper & Lower Storage*
- Hot water w/mixer faucet and demand electric water pump
- Outside shower w/hot water
- Extra Wide, Full View, One-Piece Screen Door*
- Wide & Safe Stepper™ Door*
- Two Stoves- High Pressure Outside Stove* & Low Pressure Inside Stove
- Portable Dinette Table*
- Comfort Zone™ High Density Foam Bed & Seat Cushions*
- Waist Level Posi-Lock Stainless Steel Lift System*
- Clear Vinyl Windows*
- Extra Fine Mesh Screening*
- Under-Floor Water Storage
- Two Double Ceiling Lights
- EZ Crank Down Stabilizer Jacks with Sand Pads*
- One-Piece Structurwood® Floor & Bed Wood*
- Spare Tire
- Tubular Steel Frame*
- Leaf Spring Suspension*
- Full Perimeter Aluminum Bed Frames*
- Permanently Attached Bed Supports*
- 1,000 Pound Bed Capacity*
- Front & Rear ABS Panels*
- Krystal Kote® Aluminum Side Panels*
- Self-Storing Swivel Tongue Dolly Jack*

*Look for features detailed on pages 12-13, or Coleman Advantage illustration on page 10.

Optional Value Pack

- ABS Spare Tire Cover
- ABS Gas Bottle Cover
- Two Sets of Privacy Curtains
- Two Portable Bed Lights

Destiny Extras...

At No Extra Charge!

- One-Piece Seamless ABS Roof* (except on Redwood & Taos models)
- Sectional Sunbrella® 302 Breathable Acrylic Tenting*
- Swing-Level® Galley with Full Upper & Lower Storage* (except on Redwood & Taos models which feature Fold-over galleys)
- Extra-Wide One-Piece Screen Door*
- Wide & Safe Stepper™ Door with lockable storage* (except on Redwood & Taos models)
- Built-In Ice Chest
- Transportable Inside/Outside Stove
- Portable Dinette Table*
- Comfort Zone™ High Density Foam Bed & Seat Cushions*
- Posi-Lock Stainless Steel Lift System*
- Clear Vinyl Windows*
- Extra Fine Mesh Screening*
- EZ Crank Down Stabilizer Jacks* (except on Redwood & Taos models)
- One-piece Structurwood® Floor & Bed Wood*
- Spare Tire
- Tubular Steel Frame*
- Leaf Spring Suspension*
- Full Perimeter Aluminum Bed Frames*
- Permanently Attached Bed Supports*
- 1,000 Pound Bed Capacity* (Taos model 750 lb. capacity)
- Front & Rear ABS Panels*
- Krystal Kote® Aluminum Side Panels*
- Self-Storing Swivel Tongue Dolly Jack*

*Look for features detailed on pages 12-13, or Coleman Advantage illustration on page 10.

Optional Value Pack

- Two Sets of Privacy Curtains
- Vinyl Gas Bottle Cover
- Vinyl Spare Tire Cover
- One Portable Bed Light

NOTE: Step is offered in place of Bed Light only with Redwood & Taos models.

1998 Destiny Series

FLOOR PLANS AND SPECIFICATIONS

	Westlake	Rio	Mesa	Cheyenne	Sea Pine	Santa Fe	Redwood	Taos
ABS One-Piece Roof	Std.	Std.	Std.	Std.	Std.	Std.	N/A	N/A
EZ Crank Down Stabilizers	Std.	Std.	Std.	Std.	Std.	Std.	N/A	N/A
Road Height	55"	55"	55"	55"	55"	55"	51 1/2"	47"
Length (Closed)	7'3"x16'10"	7'3"x19'	7'3"x16'10"	7'3"x16'9"	7'3"x14'9"	7'3"x14'9"	7'3"x13'9"	6'8"x11'5"
Length (Open)	25'9"	25'9"	25'9"	21'11"	21'11"	21'11"	18'8"	17'
Tire Size	C78-13ST	C78-13ST	B78-13ST	B78-13ST	B78-13ST	B78-13ST	5.30x12	5.30x12
Base Vehicle Weight, lbs.	2,116	2,140	1,949	1,874	1,615	1,615	1,364	995
Base Axle Weight, lbs.	1,953	2,007	1,827	1,764	1,440	1,440	1,242	870
Base Hitch Weight, lbs.	164	133	123	110	175	175	122	125
Electric Brakes	Std.	Std.	Opt.	Opt.	Opt.	Opt.	Opt.	Opt.
Cargo Capacity, lbs.	1,134	1,110	1,051	1,126	885	885	926	705
Storage Trunk, cu. ft.	N/A	26	N/A	26	N/A	N/A	N/A	N/A
Built-In Ice Chest, qts.	57	57	57 & 76	57	57 & 76	57	57	57
Water Storage, gal.	20(UF)	10	10	10	10	10	10	5
Sleeping Capacity	8	9	9	8	8	7	6	6
Living Area, sq. ft.	155	155	155	130	130	130	108	90
Interior Height	80"	80"	80"	80"	80"	80"	79"	79"
Shower/Cassette Toilet	Std.	N/A	N/A	N/A	N/A	N/A	N/A	N/A
Hot Water w/Mixer Faucet & Demand Elec. Water Pump	Std.	Opt.	Opt.	Opt.	Opt.	Opt.	N/A	N/A
Outside Shower	Std.	Opt.	Opt.	N/A	Opt.	N/A	N/A	N/A
Potti Storage Cabinet	N/A	Std.	Std.	Std.	Std.	Std.	Std.	Std.
Swing-Level Galley	Std.	Std.	Std.	Std.	Std.	Std.	N/A	N/A
Fold-Over Galley	N/A	N/A	N/A	N/A	N/A	N/A	Std.	Std.
Inside/Outside Stove	Std.	Std.	Std.	Std.	Std.	Std.	Std.	Std.
Bed Size	77"x70"	77"x70"	77"x70"	77"x48"	77"x48"	77"x48"	77"x48"	72"x48"
Bed Size	77"x70"	77"x70"	77"x70"	77"x70"	77"x70"	77"x70"	77"x48"	72"x48"
Conv. Dinette Bed	52"x80 1/2"	52"x80 1/2"	39"x65"	41"x73"	40 1/2"x80 1/2"	41"x71 1/2"	41"x68"	40"x74"
Slide-out Bed Size	N/A	N/A	37"x80"	30"x70"	33"x80"	N/A	N/A	N/A
Dinette Table Size	28"x54"	28"x54"	28 1/2"x39"	30"x41"	30"x41"	30"x41"	26"x41"	30"x39"
Cabinet Storage, cu. ft.	36	52	38	31	32	34 1/2	26	24
Outside Storage Access	N/A	Std.	N/A	Std.	N/A	N/A	N/A	N/A
Stepper Door	Std.	Std.	Std.	Std.	Std.	Std.	N/A	N/A
Spare Tire	Std.	Std.	Std.	Std.	Std.	Std.	Std.	Std.

- When ordering installed refrigeration, the built-in ice chest is deleted.
- Gross Vehicle Weight Rating is equal to Base Vehicle Weight plus Cargo Capacity.
- Options May Be Dealer Installed.

Westlake

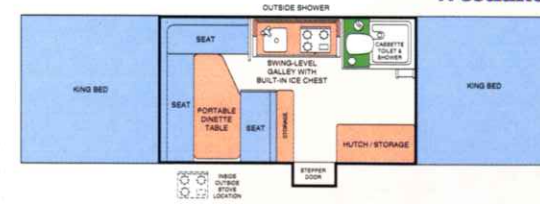

Rio

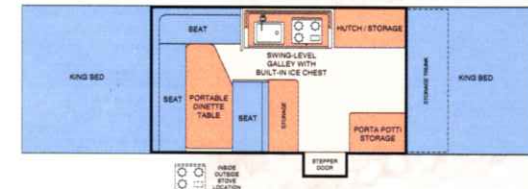

Mesa

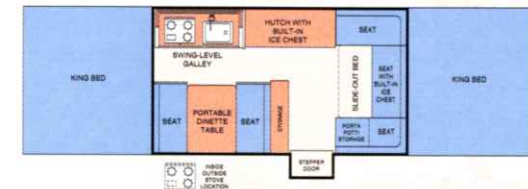

Cheyenne

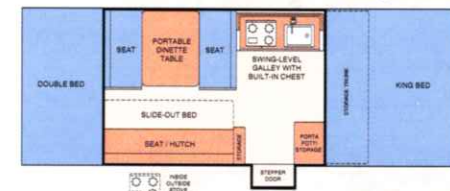

Sea Pine

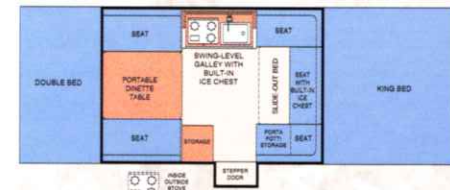

Santa Fe

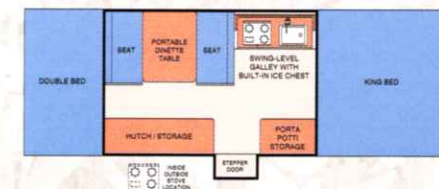

Taos

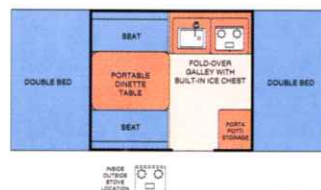

Redwood

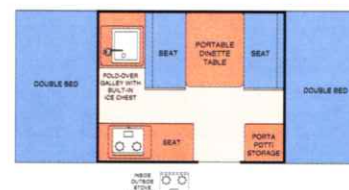

Lightweight, free-standing portable dinette table can be used anywhere.

* Built-in ice chest or refrigerator offers plenty of food storage. (refrigerator not available in Taos model).

* Exclusive, seamless one-piece, ABS roof is strong, durable and will not leak...ever! (Redwood & Taos models offer conventional aluminum roof)

* Clear vinyl windows for a brighter interior on overcast days, plus fine mesh screening to keep even the tiniest bugs out.

* Simple, dependable stainless steel lifter system features a Posi-Lock crank and self draining lifter arms that won't rust or bind.

Automotive-style double sidewall construction allows body panels to be easily and inexpensively replaced if damaged.

Krystal-Kote® finish aluminum side body panels that resist scratching and marring.

ABS impact resistant plastic front and rear body panels for protection from road gravel and stones.

Underfloor water storage on all Grand Tour Series models frees up valuable interior storage space.

Seamless, polyethylene wheel wells that won't rust or allow water or dust to enter the trailer.

* Exclusive slipper-leaf spring suspension system adjusts itself to the weight of the trailer load and distributes road stress over a wider area of the frame for safety and dependability.

Wheels are attached with 5 lug nuts for added safety.

* Exclusive self-storing Stepper™ door is extra wide, sturdy and safe (Redwood & Taos models offer optional slide-out self-storing step).

* Feature detailed on pages 12-13.

* Seamless, one-piece Structurwood® flooring provides a strong, consistently level floor that won't warp or delaminate, plus offers a stable underlayment to keep your vinyl floor looking good.

* Exclusive wide, one-piece aluminum screen door with automatic spring return (Grand Tour Series offers full-view/ventilation screen door). (Door not shown)

* Exclusive self storing swing-up tongue dolly jack with permanently attached wheel.

* Exclusive two-stove cooking convenience on Grand Tour Series and single inside/outside transportable stove on Destiny Series models.

* Spacious upper and lower storage in the Swing-Level™ galley. (Fold Over galley in the Redwood & Taos models.)

* Sunbrella® 302 acrylic tenting fabric is highly breathable and will not crack, mildew, dry rot, fade or leak.

* Seamless one-piece Structurwood® beds have full perimeter aluminum frames to prevent warping and provide easy setup without binding. (All beds tested to 1,000 lbs. except Taos model which is tested to 750 lbs.)

High density, Comfort Zone™ seat and bed cushion foam provides lasting therapeutic support and comfort.

* Permanently attached bed supports that can't be lost or misplaced.

* Full perimeter tubular steel frame offers greater strength and durability plus protects trailer wiring from road debris.

Quality CONSTRUCTION

The Coleman® Folding Trailer Advantage!

Offering the Best Features and Construction Available...





Protection For Those **NOT**-So-Sunny Days

Sumbrella 302' Acrylic Tenting

Is resistant to cracking, dry rot, mildew, fading and abrasion. It's highly breathable so it won't trap heat, moisture or odors.

The tenting is assembled using continuous double needle stitching and double lap-fold seams to prevent unraveling and provides a watertight seal.

Stainless Steel Lifter System

Each lift arm extends through the trailer sidewall and is attached to the frame. This allows water to flow freely through the arm and onto the ground.

Exclusive One-Piece Seamless Roof

Two ABS panels with an injected foam center provide strong, durable protection against all elements, no matter how severe.

The urethane foam insulation provides a heat barrier during hot summer days and a noise barrier during driving rain.

One-Piece Screen Door

The screen door provides a tight, secure seal along the tenting sides and trailer walls to prevent leaking or insects from entering.

Angled Bunk Ends

The tapered Conestoga-style bunk ends combined with the exclusive fine mesh screening allow you to keep end windows open for good ventilation, even during rain storms.



"Engineered To Be The Best"

"This is a great product, but is there a great warranty?"

FLEETWOOD FOLDING TRAILERS

HASLE FREE WARRANTY

THE INDUSTRY'S BEST BUYER PROTECTION PLAN
WE GUARANTEE IT!

LIMITED LIFETIME*

- MOLDED ABS ONE-PIECE SEAMLESS ROOF
- TUBULAR STEEL FRAME
- ONE-PIECE SEAMLESS STRUCTURWOOD® FLOOR
- ONE-PIECE STRUCTURWOOD® BED PLATFORM
- STAINLESS STEEL LIFTER SYSTEM

LIMITED FIVE YEAR*

- EXCLUSIVE SUNBRELLA® 302 ACRYLIC TENTING MATERIAL

LIMITED ONE YEAR*

ALL OTHER TRAILER COMPONENTS

LIMITED LIFETIME*

With Fleetwood, you don't have to call all over the country if you need service. Your nearest authorized Fleetwood Folding Trailer dealer provides a single source for all your service needs. Your Fleetwood extended life warranty, specified structural components, covers parts, labor, and freight for the first full year and parts and labor for as long as you own your trailer. *Ask your authorized Fleetwood Folding Trailer dealer for complete details.

WE BACK OUR PRODUCT BETTER BECAUSE WE BUILD IT BETTER!

FLEETWOOD
FOLDING TRAILERS

You Can Count On It!

With Coleman, you don't have to call all over the country if you have a problem. Your nearest authorized Coleman Folding Trailer dealer provides a single source for all your service needs.



CAMPING TIP

For safety, large fires are not needed for cooking. It's much easier to control cooking temperatures with hot coals.





The Strongest Roof in the Industry with a Limited Lifetime Guarantee!

The exclusive, patented one-piece ABS roof is guaranteed not to leak...ever! It's extremely strong, durable design protects against all types of harsh weather, including damaging hail. (Photograph for demonstration purposes only to show roof strength, cargo capacities for specific models are listed on pages 8 & 9)



Most Dependable Lift System in the Industry with a Limited Lifetime Guarantee!

Heavy gauge, stainless steel lifter arms will not rust or bind and run straight through the trailer's double side wall attaching to the side of the frame. This allows water to drain completely through onto the ground, eliminating the need for protective lift arm covers.

Standard Coleman® Features Provide You with Comfort, Convenience and Value



The Number One Outdoor Tenting Fabric in the Industry with an Exclusive Limited 5 Year Guarantee!

Sunbrella® 302 fabric's unique breathability demonstrated by a bubble machine (to the right) allows air, humidity and cooking odors to escape while keeping rain out. The fabric will not fade, crack, mildew or dry rot, plus it's extremely strong, durable and hypoallergenic.



The clear vinyl windows provide a clear, unobstructed view, even on cloudy days. Plus, the fine mesh screening lets in the slightest breeze while keeping the smallest insect out.

The tenting is assembled using continuous double needle stitching and double lap-fold seams to prevent unraveling and provides a watertight seal.

Crank down stabilizers make stabilizing your trailer fast and easy.



Self-storing swing-up dolly jack with permanently attached wheel makes set-up and tear-down quick and easy.





The Strongest Frame in the Industry with a Limited Lifetime Guarantee... Plus a More Rugged and Dependable Suspension System!

The Coleman® full perimeter tubular steel frame combined with leaf spring suspension offers greater strength and durability over torsion axle systems. The Coleman system adjusts itself to the weight of the trailer load and distributes road stress over a wider area of the frame providing greater towing stability. (Test performed by an independent testing & research laboratory – showing 10,000 pounds of pressure on frame and suspension systems.)

Coleman® Folding Trailer

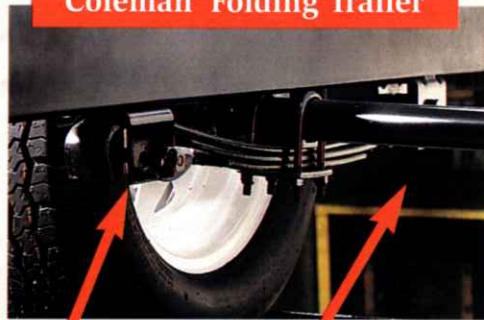

45% of Load

45% of Load

(Remaining 10% of load on tongues of trailers)

90% of Load

Other Folding Trailers

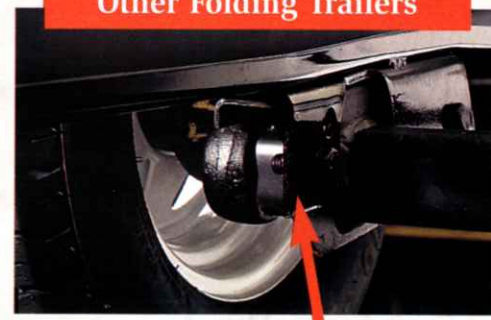

NEW exclusive Swing-Level® galley design!

A fully stocked galley is easy when “there’s a place for everything, and everything is in its place.” Both Coleman® series offer spacious, full upper and lower galley storage.

*(Swing-level galley not available on Redwood & Taos models)
(Bayside model Swing-level galley shown)*

The Sturdiest and most “user friendly” Bed Support System in the Industry!

Seamless, one-piece Structurwood® beds with full perimeter aluminum frames prevent beds from warping and binding to make set-up quick and easy. Plus, with permanently attached bed supports there’s no possibility for them to be lost or misplaced. Bunk ends are designed to support 1,000 pounds (750 pounds on Taos model).



Coleman® folding trailers feature an interlocking, full perimeter skeletal framework of riveted and welded aluminum and steel that stands up to twisting and racking on rough country roads.



Exclusive one-piece screen door is easy to set in place and is extra wide for easy access, plus has an automatic spring return so you can’t accidentally leave the door open. **Exclusive Stepper™ Door** design offered in both series featuring a wide, sturdy step for easy access to the trailer. (Redwood & Taos offer an optional slide-out step.)



*Cooking is easy... inside or out! The **Grand Tour Series** comes standard with two stoves, an outside high pressure stove shown here and a permanent stove on the inside galley. The **Destiny Series** comes with a transportable stove that can be used inside or out.*



CAMPING TIP

Always remember the Camper’s Creed: Take only pictures, leave only footprints!

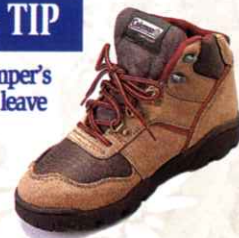



Natural Additions To Your Outdoor Adventures...

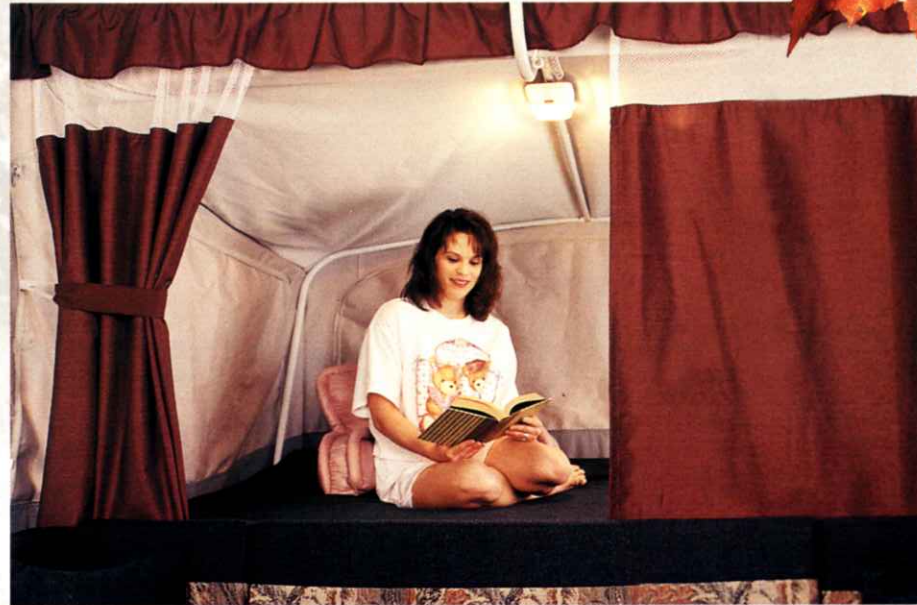

Privacy curtains feature top netting to allow unobstructed heating and cooling air circulation. Portable bed light offers convenient lighting for night-time reading.



Protect your LP gas bottle from road grime, while adding the finishing touch to the front of your camper with an ABS (Grand Tour Series) or vinyl (Destiny Series) cover. Optional battery tray and case shown with ABS gas bottle cover (battery not included).



Large three-way refrigerator has adjustable shelves and space for large 2 liter bottles, plus operates on LP gas, 120V or 12V power supplies. (Standard on all Grand Tour models)



Keep cool this summer with roof mounted air conditioning. (See your dealer for proper BTU sizing and installation requirements).



Exterior bunk-end hideaway provides attractive looking privacy for bikes and extra camping gear.



Free-standing portable table, provides additional dining space on select models.



Double your living space with this Coleman® Add-A-Room featuring fine-mesh screening, privacy panels, and heavy duty hardware. (See page 3 for optional canopy, shown separately).



This rugged self-storing step provides easy access for Redwood and Taos models.



Protect your spare tire from road grime and harmful UV rays, while adding the finishing touch to your camper with an ABS cover (Grand Tour Series) or vinyl cover (Destiny Series).



A genuine Yakima® roof rack system gives you the option to take it all with you with the available canoe straps, bike carrier, and cargo basket.



This convenient fold-up wardrobe rack provides extra space to hang clothes. Standard on all Grand Tour models. (Available only on ABS roofs. See your dealer for optional wardrobe rack for Redwood and Taos models).



Energy efficient LP gas forced-air furnace, with electronic ignition, provides 16,000 BTUs of heating with thermostat controlled comfort.



Wardrobe provides convenient storage for clothes. (Standard on Bayside. Optional on Niagara, Westlake and Rio models)



We Build Lasting M E M O R I E S

"Your Coleman Folding Trailer is always ready to go whenever you are"

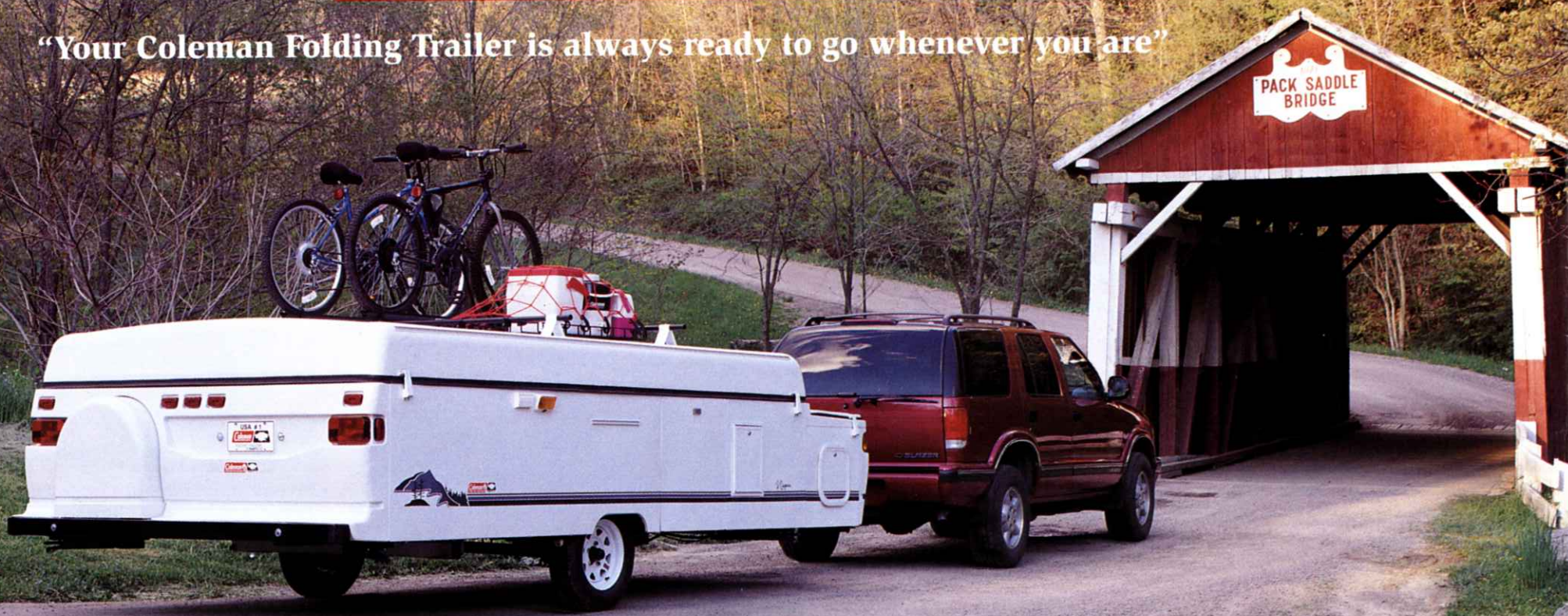

TREAD LIGHTLY! OFFICIAL SPONSOR[®]
ON PUBLIC AND PRIVATE LAND

Fleetwood Folding Trailers subscribes to the Tread Lightly principles of traveling only on designated routes, respecting the rights of others, educating yourself, and camping responsibly.

Manufactured under license from the Coleman Company, Inc. by Fleetwood Folding Trailers, Inc.



FLEETWOOD FOLDING TRAILERS, INC. • R.D. 2 • Somerset, PA 15501 • (814) 445-9661
A Division Of
FLEETWOOD ENTERPRISES, INC. • P.O. Box 7638 • Riverside, CA 92513-7638

If your local dealer is not indicated call toll-free,
24 hours: 1-800-444-4905 or write to the address above.

Visit us at our WEB site: www.fleetwood.com

We are doing our part to protect the environment by printing this brochure on recycled paper



Coleman[®] and  are registered trademarks of The Coleman Company, Inc., used under license.

Photography and product information included in this brochure was accurate at the time of publication. Subsequent refinements may appear in the final product without incurring any obligation to incorporate such changes in any product previously manufactured. Specifications are subject to change without notice. Selected decorator items shown in the photography are not part of the product unless specified. All liquid capacities, weights, and dimensions are approximate.

©1997 Fleetwood Enterprises, Inc.

Litho in USA 7/97 • Edition 1