

*Experience America's Best!*

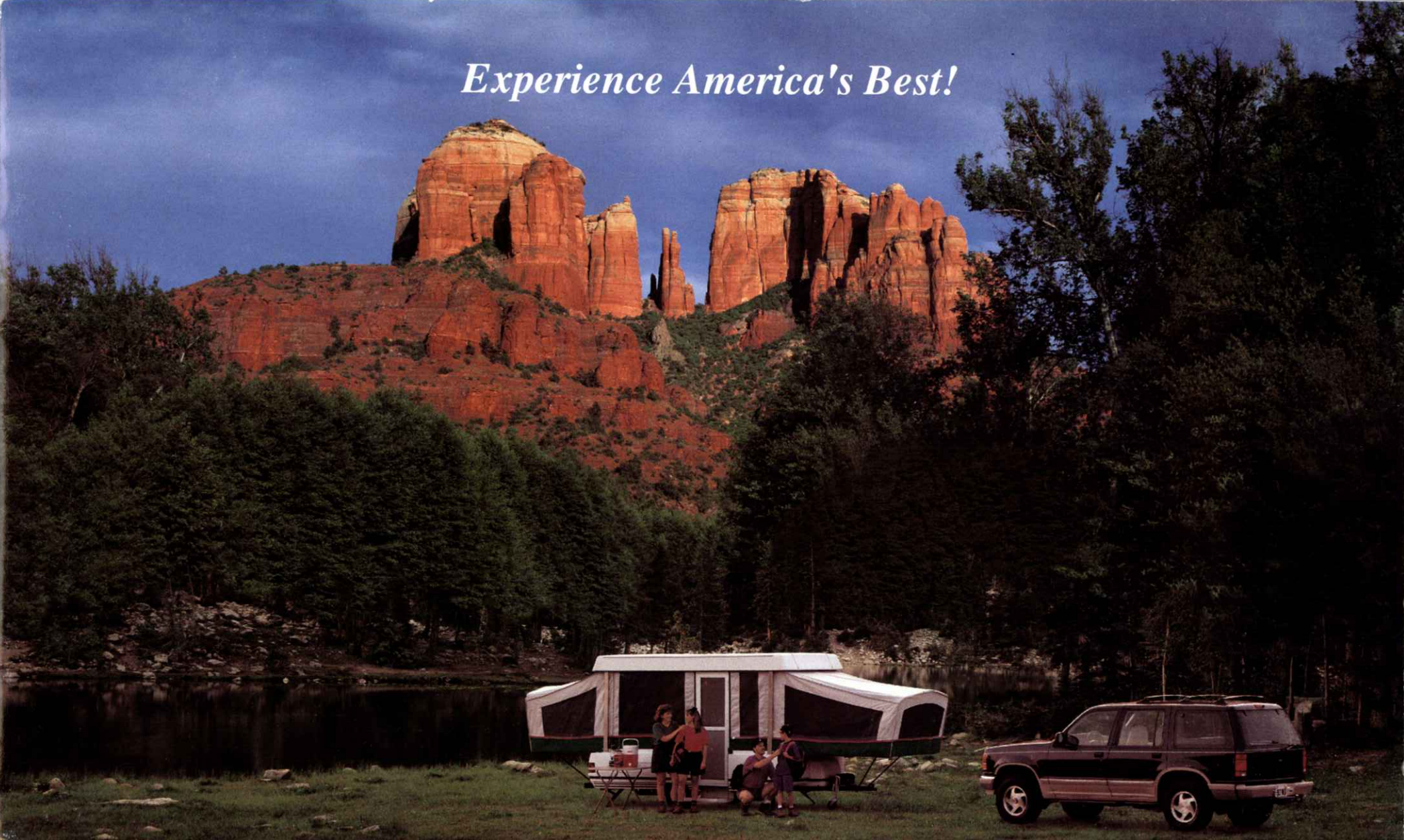

**Coleman**<sup>®</sup>



**FOLDING TRAILERS**  
BY **FLEETWOOD**<sup>®</sup>



Printed On  
Recycled Paper

1994



# Coleman and Fleetwood: A Heritage of Building High Quality Products with a Dedication to Total Customer Satisfaction.

## Look At The Company Behind The Product

When you're thinking about the purchase of a folding trailer, it pays to look at the company behind the product. Be sure the company you plan to buy from will be there for you, not just tomorrow...but years down the road. You can count on the fact that Fleetwood and Coleman will be here to support your purchase for years to come.

With a camping heritage that spans more than 90 years, and an ongoing commitment to innovative design and quality, Coleman quickly became known as the "best value" in the camping industry. Fleetwood accomplished its own industry benchmark when the company became the world's largest producer of manufactured homes and recreational vehicles.

Quality and customer satisfaction take time and must be earned every day. Coleman and Fleetwood have invested the time it takes to develop the industry knowledge and expertise that keeps our customers coming back...time and time again.



This brochure is printed on recycled, coated paper so it can be reclaimed and used again. Like a lot of our customers, we believe it's time to do what we can to protect and preserve our environment. By using recycled paper we've saved approximately 1,216 trees, 500,513 gallons of water, 135 cubic yards of landfill space, and 293,150 kilowatt hours of electricity (enough to run 33-36 homes for one year)\*. We hope that as you enjoy the camping experience and our great outdoors heritage you will remember the camper's creed...

**"Take only pictures and  
leave only footprints".**

\* Source: American Paper Institute;  
Numbers are estimated.

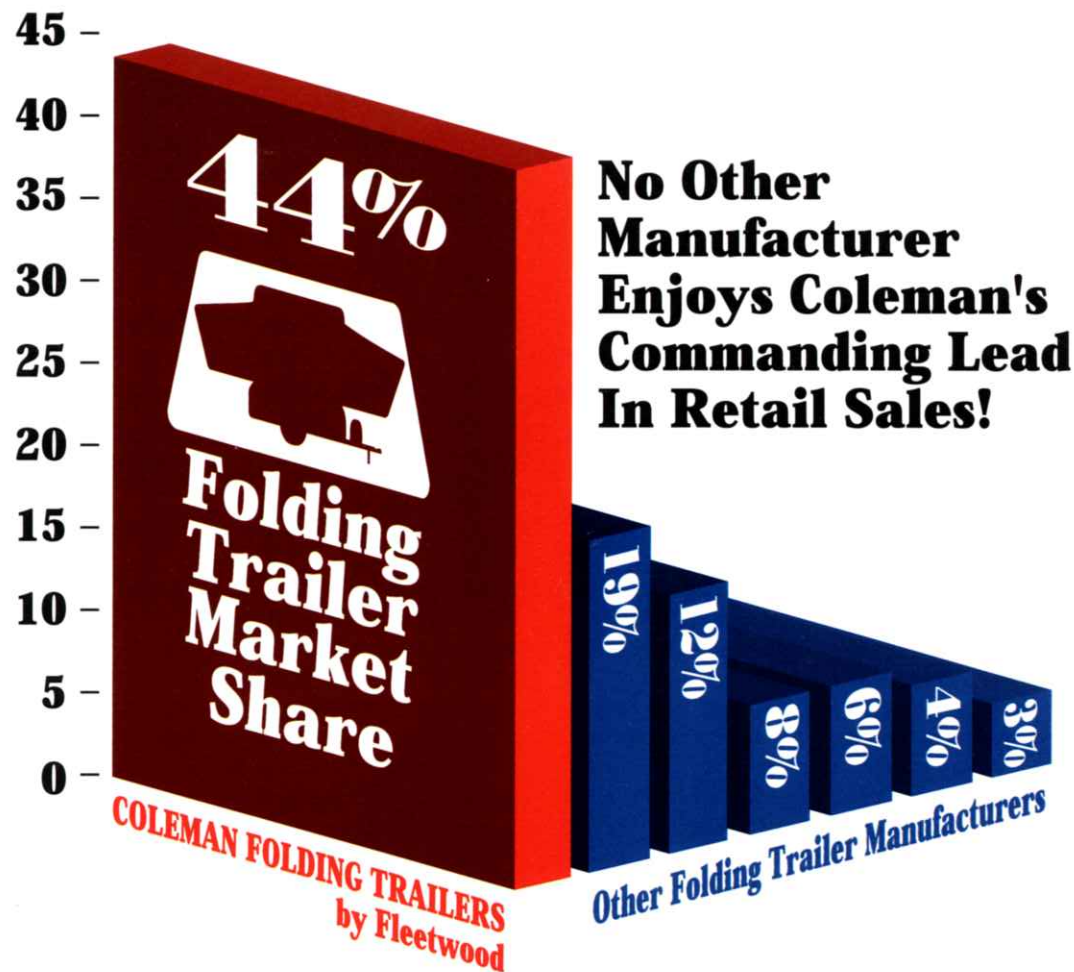

Source: Statistical Surveys, April 1993 Figures



# The Customer Comes First With Us

For Coleman, it all started quietly enough back in 1900 by a man named William C. Coleman. W.C., as most of his friends called him, started the company as a "one-man private utility". Back then the company was called the Hydro Carbon Light Company. The company rented lamps to stores, lodge halls, churches and other public buildings, and eventually, to homes beyond the reach of electric service. Coleman grew with a basic, simple customer philosophy... "No Light - No Pay". The philosophy stuck, and even today we believe that no product is truly sold unless and until it's delivering a satisfactory service to its user.

During World War II, Coleman's creativity was rewarded with unprecedented sales for his famed G.I. Pocket Stove and special lanterns. After the war, the growth of

outdoor recreation found Coleman ready with picnic jugs, portable heating appliances, tents, sleeping bags, backpacking gear and folding trailers.

## Fleetwood Begins Producing Revolutionary New Products

Meanwhile, following World War II, a dreamer and tinkerer named John C. Crean started his first business in the garage of his small home in Southern California, by selling venetian blinds to trailer manufacturers. This business venture was the humble beginning for John's more direct involvement in the housing industry. Housing built in a factory was John's vision to make the "American Dream" of owning a home a reality for more Americans.

In 1950 John Crean took a bold step and founded his own company. He named it Fleetwood. Putting his practical ideas into action, John opened his initial manufactured housing production facilities in Anaheim, California. From this modest beginning, the company steadily grew, becoming the largest producer

of manufactured housing in the world today.

In 1964, John Crean expanded into the recreational vehicle business. Fleetwood grew by leaps and bounds as recreational vehicles became a very popular and affordable way to vacation and enjoy the great outdoors.

## Coleman and Fleetwood Join Forces

Over the years, both Coleman and Fleetwood have grown steadily, establishing reputations built on providing customer value and satisfaction. Coleman has come to symbolize "the greatest name in the great outdoors" with an unparalleled commitment to outdoor recreation. The Fleetwood name is widely recognized for superior quality and value and can be found on one out of every three RVs on the road today. Now that Coleman and Fleetwood have joined forces, the combined commitment to quality and value continues to foster uniquely superior products with even greater customer appeal and satisfaction.

# "There's nothing like a Coleman Folding Trailer!"



These Coleman Folding Trailer owners survived the "Storm of the Century" in Florida with their Coleman Folding Trailer. Through all the torrential rains, hail, tornado alert and 60-90 mph winds, their Coleman Folding Trailer came through totally unscathed. "Neighbors and friends came by to see how 'those people in the folding trailer' made out", said Florence Halmose. "Well, it passed with flying colors." If our trailers can survive these conditions, they should be able to stand up to whatever you can dish out!



## CIRCLE OF EXCELLENCE CUSTOMER SATISFACTION PROGRAM

"We Care..."

Fleetwood's commitment to customer satisfaction is evident through our Circle of Excellence Customer Satisfaction Program. Each and every purchaser of a Coleman folding trailer receives a personal phone call or a written survey after six months of ownership of their camper to insure that our product is continuing to provide a satisfactory service. Fleetwood and our dealers are committed to providing quality products and quality service for your peace of mind and complete satisfaction.





## AMERICANA

### The Best of the Best!

Whether you're moving up from a tent, or trading up from another brand, there's no better way to see this great country than with a Coleman folding trailer. It's truly America's best. And with the top-of-the-line Americana, you get everything you want in a folding trailer...the styling, the quality, the innovation and of course, the features. There's simply nothing else comparable.

① The 1994 Sequoia is easy to tow and rides smoothly behind the family vehicle. ② All Americana models feature large, convenient outside storage areas for your tools, lanterns or fishing gear.



# AT A GLANCE

## WILLIAMSBURG

Road Height.....47"  
 Base Vehicle Weight.....1,715 lbs.  
 Trailer Length (open).....22'8"  
 Sleeps.....7

## SEQUOIA

Road Height.....47"  
 Base Vehicle Weight.....1,715 lbs.  
 Trailer Length (open).....22'8"  
 Sleeps.....7

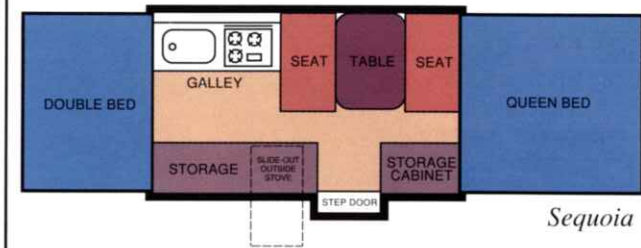
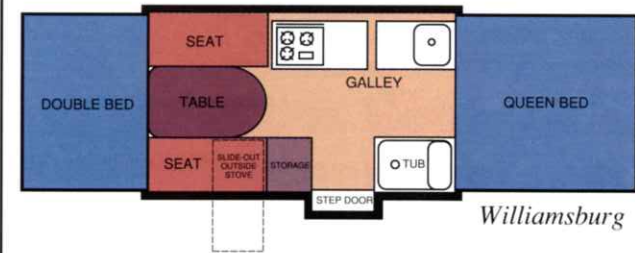

## Americana Exclusive Features

- ✓ Aerodynamic Body Styling
- ✓ Electric Brakes
- ✓ Under Floor Water Storage
- ✓ Lockable Utility Port
- ✓ Recessed Lights and Top Latches
- ✓ Outside Hot Water Shower
- ✓ Outside Access to Inside Storage
- ✓ Mini Blinds
- ✓ 3-Way Convertible Ice Chest
- ✓ Hydraulic Power Lift System
- ✓ Crank Down Stabilizer Jacks
- ✓ Porta Potti® (Williamsburg only)
- ✓ Sunbrella® 302 Acrylic Tenting Material w/Exclusive 5-Year Warranty





1 Need more room when family or friends stop by? The Sequoia Folding Trailer is a perfect way to get that extra bedroom space, a second kitchen or a place to set the kid's table. Whether it's a sleep-over party, a backyard barbeque or a playhouse for the kids...Coleman Folding Trailers mean more than just camping.

2 The large and versatile Coleman Convertible Ice Chest can be used upright with slide-in food shelves, or on its back, chest-style.

3 All Americanas feature the added convenience of a high-pressure, high efficiency outside cookstove in addition to an inside low pressure stove.

4 For hosing off the kids and pets, or just cleaning a mess of fish, you can't beat this exterior shower for convenience.

5 With Americana's Swing-Level® galley, you can pack things where they belong before you hit the road. Then once you arrive, just swing the galley into position. Everything stays just the way you packed it.

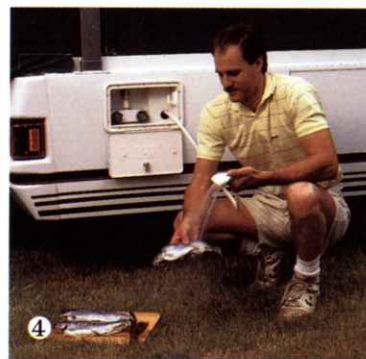

## CAMP TIPS

Keep bugs away from your camp table by pouring a puddle of pancake syrup (or thick sugar water) 10 to 15 feet away from your camper. The pests will leave your food for the sticky mess.

Dip wooden matches in nail polish or paraffin to keep them dry.

Vegetables wrapped in aluminum foil with two tablespoons of water will cook in about 15 minutes over hot coals.





1 All outside storage and utility compartments lock for security. 2 Fleetwood "Easy-Jack" stabilizers crank down into position without kneeling on the ground. 3 The 1994 Williamsburg interior with spacious, double Swing-Level® galley. 4 The Williamsburg model features hot water, tub and shower. When not in use, the shower top conceals the tub and doubles as a bedside nightstand.



The ultimate in protective tenting fabric, Sumbrella® 302 is produced exclusively for Coleman, and includes a 5-year warranty.

## New For 1994! Easy To Use Hydraulic Lift System

The all new hydraulic lift system is a cinch to use, and so convenient! To operate, simply turn a switch and watch as your folding trailer sets up automatically. The durable hydraulic pump and motor are powered by an available optional battery located on the tongue of the trailer. Heavy gauge wire is used to connect the battery to the pump for efficient transmission of the 12V DC current. When the cylinder is fully extended, a safety latch engages the end of the cylinder to insure ease of operation and safety. Once you're ready to lower the trailer back to its folding position, just release the safety latch and turn in the valve handle. It's that simple!

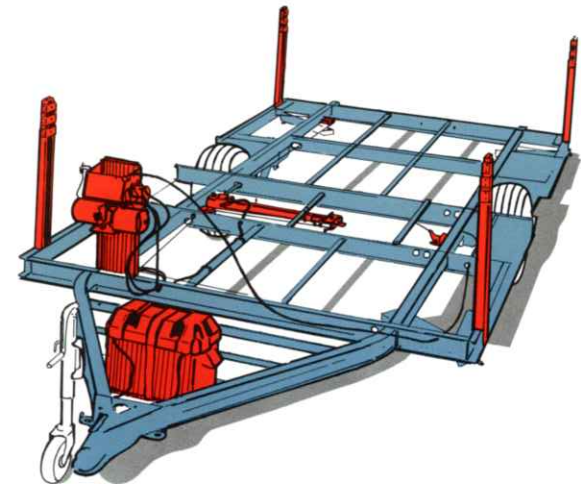



# FOUR SEASONS



1

1 Enjoy the best of both worlds in the 1994 Yosemite. You get the comfort of a travel trailer and the ease of towing a folding trailer. 2 The new Yosemite is as easy to set up as one.. 3 two.. 4 three!



## FOUR SEASONS

### *Folding Trailer Models With A Solid New Twist*

The exciting Cape Cod and brand new Yosemite folding trailers offer the comfort and feel of a travel trailer, with the economy and ease of towing a folding trailer. These folding hardwall models feature solid panel walls made of maintenance-free and impact-resistant ABS plastic. The sidewalls set up automatically as the trailer roof is being raised. Then, with a simple twist of the sidewall latch, the walls are locked and secured in place. Extra-large tempered and tinted safety glass sliding windows circulate fresh air and offer a panoramic view of your surroundings.

### *Instant Traction*

*Here's a simple trick. Put a few composition roof shingles in your vehicle for your next trip. If you get stuck, simply place the shingles under the tires with the rough side down...instant traction!*





# FOUR SEASONS

## AT A GLANCE

### YOSEMITE

Road Height.....57"  
 Base Vehicle Weight.....1,850 lbs.  
 Trailer Length (open).....22'5"  
 Sleeps.....7

### CAPE COD

Road Height.....57"  
 Base Vehicle Weight.....1,751 lbs.  
 Trailer Length (open).....22'5"  
 Sleeps.....7

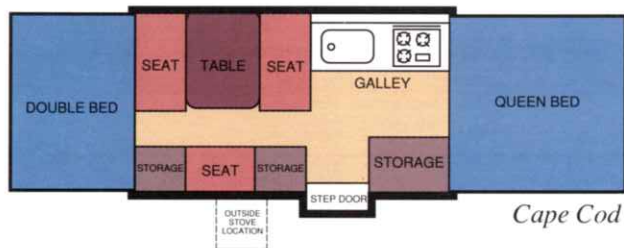
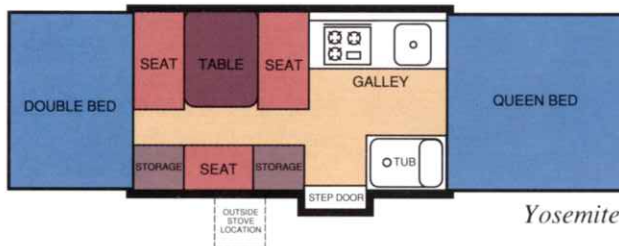

The new 1994 Yosemite interior features Coleman's exclusive, patented Swing-Level® galley for maximum storage and ease of operation. This new model also includes a convenient bathtub with hot water and shower. The shower top converts the tub into a handy bedside nightstand when not in use.

## CAMP TIPS

An average tree that lives for 50 years generates over \$30,000 worth of oxygen and is worth another \$60,000 in air pollution control!



## Four Seasons Exclusive Features

- ✓ Solid Impact-Resistant ABS Sidewalls
- ✓ Large, Tinted, Tempered Safety Glass Windows
- ✓ Largest Interior Height - 7'1" Headroom
- ✓ Bumper - Standard Equipment
- ✓ Hydraulic Power Lift on Yosemite
- ✓ Crank Down Stabilizer Jacks on Yosemite
- ✓ Sunbrella® 302 Acrylic Tenting on Yosemite





1



2



3



4

### Pioneer Exclusive Features

- ✓ Swing-Level® Full Storage Galley
- ✓ Outside Ground Fault Receptacle
- ✓ Two Stoves - Outside High Pressure & Inside Low Pressure
- ✓ Tent Storage Pockets
- ✓ Full View Screen Door with Removable Panels

1 Any occasion can be a celebration in the well appointed and stylish Columbia interior. Plenty of table space and comfortable seating allows room for everyone to take part in the fun. 2 All Pioneer models feature the added convenience of a high-pressure, high efficiency outside cookstove to cook up extra birthday treats or whatever you're in the mood for. 3 Great things come in small packages with the easy to tow Columbia. 4 The new Columbia shares the popular Pioneer style graphics and affordable price tag.

## POCKET STEW

For each serving, place a hamburger patty in the center of a square of heavy-duty aluminum foil. Add seasoning and cover with thinly sliced potatoes, onions, carrots and peas. Top with a slice of bacon. Fold the ends of the foil under until thickened handles are formed. Lay on a bed of coals and turn as needed for 15 to 20 minutes. Slit open the package and enjoy.







1 The all new Avalon includes this unique storage trunk that opens to a large 17 cu. ft. storage space when the bed is retracted. 2 When the bed is extended, access is through hatches on either side of the trailer... 3 ...or through a sliding door on the interior of the camper. 4 The new 1994 Avalon. 5 The Avalon provides a colorful backdrop and a comfortable retreat for a great outdoor family adventure.



## AT A GLANCE

<p style="text-align: right;"><i>Arcadia</i></p>	<p><b>ARCADIA</b>                  Road Height.....47"                  Base Vehicle Weight.....1,490 lbs.                  Trailer Length (open).....22'8"                  Sleeps.....7</p>
<p style="text-align: right;"><i>Avalon</i></p>	<p><b>AVALON</b>                  Road Height.....47"                  Base Vehicle Weight.....1,740 lbs.                  Trailer Length (open).....22'8"                  Sleeps.....7</p>
<p style="text-align: right;"><i>Chesapeake</i></p>	<p><b>CHESAPEAKE</b>                  Road Height.....47"                  Base Vehicle Weight.....1,445 lbs.                  Trailer Length (open) .....22'8"                  Sleeps ..... 7</p>
<p style="text-align: right;"><i>Columbia</i></p>	<p><b>COLUMBIA</b>                  Road Height.....47"                  Base Vehicle Weight.....1,099 lbs.                  Trailer Length (open).....18'                  Sleeps .....6</p>

## Great Family Value with the Spirit of Adventure!

Wherever you go, or whatever your recreational pursuit, any one of the great new Pioneer models will surround your family in vacation comfort and convenience. You'll love the uncompromising value in the 1994 Pioneer series.





1



2



3



4



5



6

1 Set up the games, pull out the food and let the fun begin! The 1994 Arcadia has plenty of room for kids and adults alike. And who could ask for a better view of the great outdoors! 2 These handy mesh pockets are great storage for sunglasses, a flashlight, wallet, maps or other smaller items. 3 Coleman's exclusive and patented Swing-Level® galley is a snap to set up and use. 4 Mealtime, anytime is made so much easier with a well-stocked galley...talk about storage space! 5 The 1994 Arcadia. 6 The ultimate in Pioneer creature comfort is the Arcadia with hot water, bathtub and shower. When not in use, the shower top converts the tub into a handy bedside nightstand.



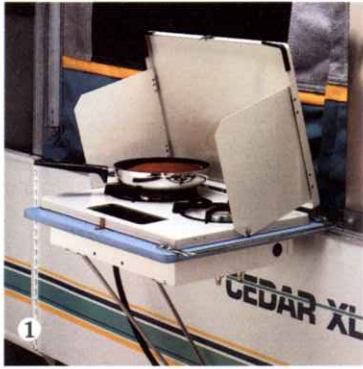

## CAMP TIPS

A square knot is a good knot to use when connecting two pieces of rope of the same size. It's also the easiest to untie.

The common plantain weed, long considered a "nuisance weed", contains a juice in the leaves to soothe mosquito bites.

- 1 The Destiny portable inside/outside stove.
- 2 The 1994 Rio Grande features unique storage areas, plus plenty of relaxing room.
- 3 Enjoying the great outdoors with the Rio Grande.
- 4 Rio Grande's innovative and large 17 cu. ft. storage trunk opens wide when the bed is retracted.
- 5 When the bed is extended, access is through hatches on either side of the trailer...
- 6 ...or through a sliding door on the interior of the camper.
- 7 Two large sliding pantries on either side of the storage access door are perfect for stowing jars and canned goods.







1 The 1994 Cedar XL interior features front dinette seating and two full-size double beds. 2 The 1994 Cedar XL offers economical and easy towing. 3 For the ultimate in convenient storage, the Cedar XL is designed to provide the maximum both inside ... 4 ... and outside.

# AT A GLANCE

## RIO GRANDE

Road Height.....47"  
 Base Vehicle Weight.....1,460 lbs.  
 Trailer Length (open).....21'  
 Sleeps.....7

## ROYALE

Road Height.....47"  
 Base Vehicle Weight.....1,270 lbs.  
 Trailer Length (open).....21'  
 Sleeps.....7

## CEDAR XL

Road Height.....47"  
 Base Vehicle Weight.....1,255 lbs.  
 Trailer Length (open).....17'  
 Sleeps.....6

## CEDAR

Road Height.....45"  
 Base Vehicle Weight.....995 lbs.  
 Trailer Length (open).....17'  
 Sleeps.....6

## ROANOKE

Road Height.....45"  
 Base Vehicle Weight.....995 lbs.  
 Trailer Length (open).....17'  
 Sleeps.....6

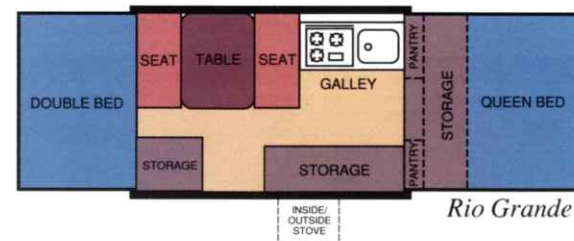

Rio Grande

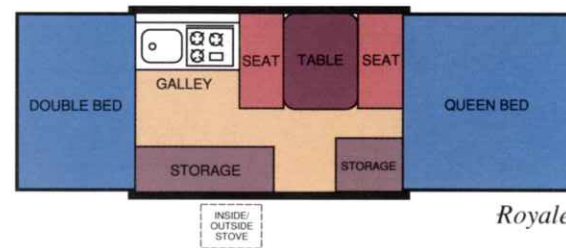

Royale

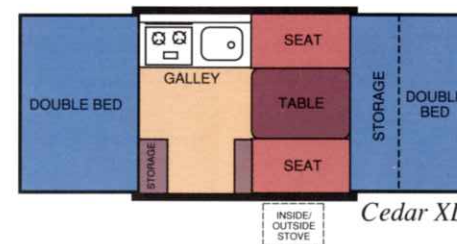

Cedar XL

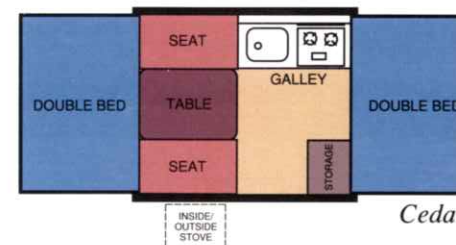

Cedar

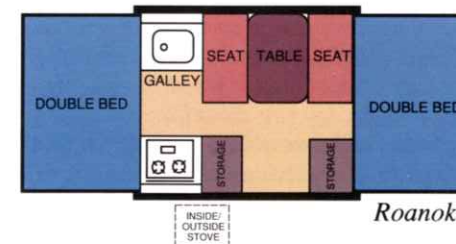

Roanoke



# Every Coleman Trailer Has These Standard Features

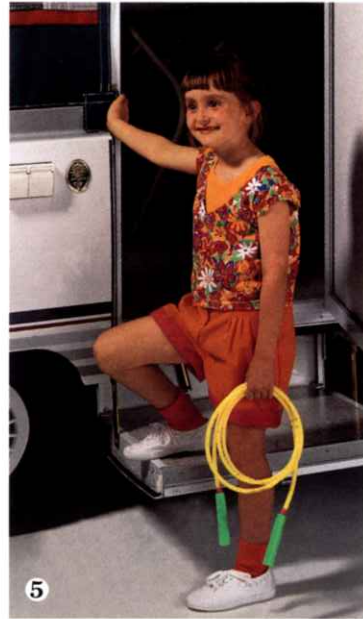

14

❶ All Coleman tables provide spacious dinette seating with the added benefit of total portability for use indoors or out. ❷ All models feature Porta Potti® storage areas. ❸ Coleman ice chests come in three big sizes, depending on the model you choose, and they're portable...so you don't lose valuable interior cabinet storage space, as with built-in ice chests (when ordering factory installed refrigeration the ice chest is omitted). ❹ For hands-free washing, this ingenious water faucet hold-down lever does the trick. ❺ Coleman's exclusive, patented Stepper Door™ is lighted for nighttime safety

and positioned at just the right height for entry convenience (except on Destiny models). ❻ All Coleman folding trailers offer an incredible amount of headroom above the beds for your personal comfort. ❼ This tongue dolly jack easily swivels down for unhitching, and makes maneuvering your camper a snap! Swivel it back up and it automatically locks in place for towing. ❽ Coleman's one-piece full view design, all-aluminum screened entry door features lightweight, easy set-up. Plus, a zip-lock bug proof seal and automatic spring-tension return.



# A C C E S S O R I E S



**1** A set of privacy curtains and a portable bed light are the perfect accessories for late night reading when you don't want to disturb your guests or the kids. **2** This handy CamperCaddie™ makes trip preparation a snap. Pack it like a suitcase. Roll it up and pop it in the camper or your trunk. When you set up camp, simply unroll it and hang it right up. **3** This 1.5 cu. ft. Dometic® three-way refrigerator operates on LP gas, 120V or 12V power supplies. **4** Rear mount bike carrier. **5** Keep cool with roof mounted air conditioning (see your dealer for proper sizing and cooling requirements). **6** Choose an energy efficient 12,000 or 20,000 BTU forced air furnace with thermostat control and electronic ignition for convenience and reliability. **7** Looking for a little extra space to hang some clothes? This wardrobe rack is just the ticket.





1



2



3



5



2



4



6

- 1 The large Coleman Convertible Ice Chest can be used upright with slide-in food storage shelves, or pull out the shelves and use it chest-style (standard on all Americana and Four Seasons models).
- 2 Protect your LP bottles from road grime, while adding the finishing touch to the front of your camper with a vinyl or ABS cover (depending on trailer model).
- 3 Nearly double the size of your camper with this canopy and screen room combination. Coleman screen rooms also feature privacy panels.
- 4 When it comes to cargo racks and roof top accessories, people trust the Yakima® brand.
- 5 You'll appreciate the convenience of this rugged, self-storing entry step on your Destiny model (Pioneer, Four Seasons and Americana models feature a Stepper Door™ as standard equipment).
- 6 Add a little extra style to your Coleman folding trailer with these sporty wheel covers.
- 7 Have the convenience of 12V power with this battery mount kit (battery not included).
- 8 On Pioneer models, covering the spare tire protects the tire from road grime and the damaging effects of the sun's UV rays.



7



4



8



# We Back 'Em Better Because We Build 'Em Better!

Quality construction is just as important as the exceptional comfort, convenience and eye appeal you'll find in every Coleman folding trailer. Coleman uses nothing but the finest grade materials inside and out. Just compare our straight-forward product guarantee to that of any other manufacturer.

**Coleman's Lifetime Limited Warranty guarantees the structural integrity of the lift system, floor, bed structure wood material and steel frame for lifetime to the original purchaser. In addition, the roof is covered by a five-year limited warranty and the Evolution®3 tenting material by a three-year limited warranty to the original purchaser. Our Sunbrella® 302 acrylic tenting material carries a five-year limited warranty to the original purchaser.**

① Coleman's patented fail-safe lift system operates smoothly every time because the integral telescoping lifters and main cables are made of heavy gauge stainless steel to prevent binding or rusting.

② Like the finest homes, Coleman folding trailers feature wood floors. Specially treated, waterproof, one-piece O.S.B. provides foot comfort, insulation and quality seamless construction. All Coleman beds feature the same seamless one-piece quality construction.

③ For maximum protection from the elements, Coleman roof construction consists of an aluminum bonded insulated sandwich panel with single seam

design. Coleman roofs are warranted for five full years for both parts and labor.

④ Another added benefit for your camping comfort is that all Coleman trailers feature state-of-the-art Evolution® 3 or Sunbrella® 302 acrylic tent material. Whether Evolution® 3 or Sunbrella® 302, our tenting won't mildew or dry rot. The fabric's unique breathability allows humidity and cooking odors to escape, while keeping rain out. Coleman tenting is extremely strong and durable to stand up against tears, rips and punctures. It's also hypoallergenic and resists stains and acid rain damage. Sunbrella® 302 and Evolution® 3 tenting materials are to tenting what Gore® Tex® is to foul weather clothing.

⑤ Just as your home's sturdiness and integrity depends on a sound foundation, so a trailer's durability and lasting value depends on its chassis. The frame for all Coleman trailers is warranted for the **lifetime** to the original purchaser. Our warranty includes parts and labor coverage and even freight to ship the parts.

With Coleman and Fleetwood backing you all the way, you can vacation with confidence and security because you're traveling with America's best folding trailer and the best folding trailer guarantee. Make this year's vacation exciting and memorable by choosing a traveling companion that won't let you down...a Coleman folding trailer by Fleetwood!

# The Coleman Warranty: We've Got You Covered!

## LIFETIME LIMITED WARRANTY

No other manufacturer builds uncompromising quality into their trailers like Coleman by Fleetwood. And that's why we can offer a **Lifetime Limited Warranty** on many major structural components. It's the best product guarantee in the industry. The closer you look...the more quality you see. Ask your Coleman dealer for complete details.

*(Warranty available to the original purchaser in the USA and Canada only.)*

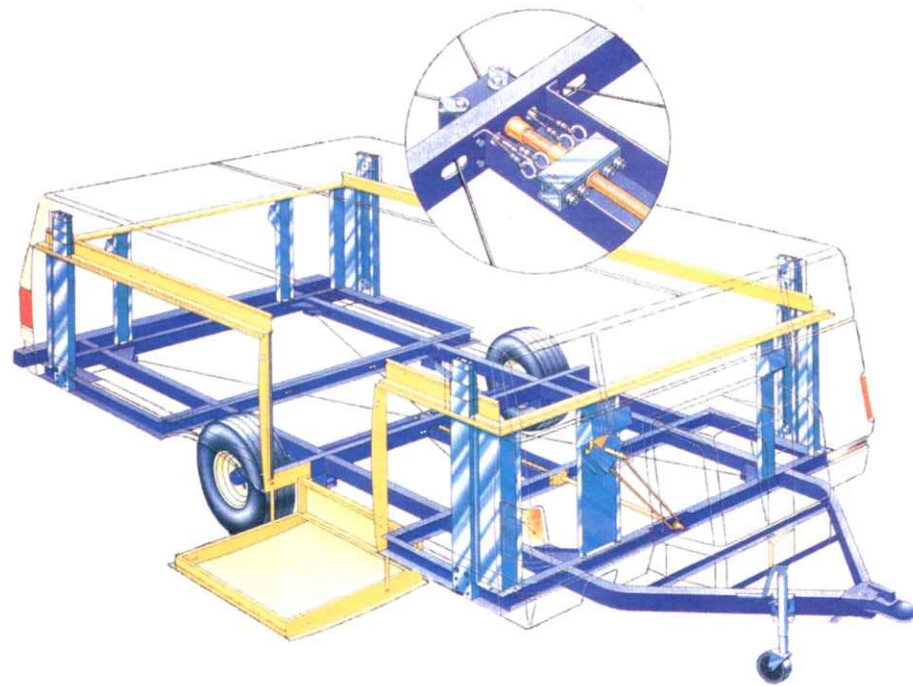

*Coleman features an interlocking, full-perimeter skeletal framework that is exclusive and unique to Coleman folding trailers. This superior design provides a smoother ride on rough roads and a longer life compared to other brands.*



**Water Hold-Down Lever** - allows "hands free" constant flow of water to make mealtime preparation and clean up a snap

**Wood Cabinetry & Decorator Hardware** - attractive, yet rugged and easy to maintain

**Headroom** - a full 36" of headroom means you can sit upright in bed without hitting your head

**Maximum Storage Galley** - more convenient and usable storage area than in any competitive product

**Bed Heights** - bed height is convenient and ideal for extra seating with high density foam for maximum comfort & support

**Impact Resistant Front & Rear ABS Plastic Panels** - protection from stones and road gravel

**Krystal-Kote® Finish Side Body Panels** - resists marring and scratching

**Superior Side Wall Construction** - aircraft/automotive-type double wall construction for durability, strength and light weight

**Subfloor Construction** - specially treated waterproof one-piece O.S.B. wood flooring, carries a Limited Lifetime Warranty

**Wheel Wells** - seamless, rust-and dent-proof

**Stepperlite™** - provides illumination at the doorstep entrance for nighttime safety (Americana, Pioneer and Four Seasons models)

**Self-Storing Stepper Door™** - a safe, wide and sturdy step, positioned low enough for children, a Coleman exclusive feature! (Americana, Pioneer and Four Seasons models)

**Lifter Cable** - 1/8" diameter stainless steel aircraft cable; double the thickness of most competitors

**Lifter Arm** - heavy-gauge stainless steel lift arm that won't rust or bind. Lift system carries a Lifetime Limited Warranty

**Undercarriage Perimeter** - rugged quality of aircraft riveted and screw construction

**Clear Vinyl Windows** - allow more light inside to brighten the living area, especially important on overcast days

**Roof Construction** - insulated sandwich panel, single seam design for the ultimate protection from the elements, Limited 5-Year Warranty

**Dinette Construction** - 4" thick upholstered, wood-backed bench seating for long-lasting durability and comfort

**Lightweight Portable Dinette Table** - free-standing so it can be used anywhere

**Tenting Materials:**

**Evolution® 3** - won't mildew or rot, fully water resistant and easy to maintain, carries an exclusive **Limited 3-Year Warranty** (Destiny, Pioneer and Cape Cod models)

**Sunbrella® 302** - resists ultraviolet, mildew, rot, chlorine and atmospheric chemicals and includes a **Limited 5-year Warranty** (standard on Americana and Yosemite models, optional on Pioneer, Destiny and Cape Cod models at a premium upcharge)

**Angled Wing Bed Design** - combined with fine mesh screening allows you to keep the privacy end flaps open for cross ventilation, even in a rain storm

**Full Perimeter Aluminum Bed Frames** - provide consistent, dependable roll-out and roll-in of the beds without warping or binding. Coleman seamless one-piece beds are tested to 1,000 pound capacity. Bed wood carries a Lifetime Limited Warranty.

**Permanently Attached Bed Supports** - so they can't be lost or left behind at home or at the campsite

**Full Perimeter Tubular Steel Chassis** - for strength, durability and reliability. Carries a Lifetime Limited Warranty.

# Construction

No One Builds 'em Like Coleman.  
The Closer You Look...  
The More Quality You See

Why do you see **more** Coleman folding trailers on the road than any other brand? Style, innovative design and enduring value have a lot to do with it. But perhaps the greatest reason of all is because the Coleman model you're considering has been **built to last!**

No other manufacturer builds quality into their product like Coleman. And that's why Coleman can offer a Lifetime Limited Warranty on many major structural components. We feel it's the best product guarantee in the industry. Ask your dealer to give you all the details.\*



\*Warranty available to the original purchaser in the USA and Canada only.

## Lifetime Limited Warranty

Coleman trailers carry a Lifetime Limited Warranty on major structural components. See your authorized Coleman dealer for complete details.



All New For 1994!  
Durable, Long Life Sunbrella® 302 Fabric Provides Greater Benefits

• **Long Lasting Durability** - New for 1994, Sunbrella® 302 fabrics are standard on all Americana and Yosemite models and available as an option on Cape Cod, Pioneer and Destiny models. Sunbrella® 302 is made from the same acrylic fiber as awnings, boat fabrics and convertible car tops for long lasting durability and toughness. Sunbrella® 302 resists ultraviolet, mildew, rot, chlorine and atmospheric chemicals.

• **Comfortable in All Weather** - Sunbrella® 302 has breathable freshness for greater comfort in all types of weather.

• **Easy To Clean** - Sunbrella® 302 is coated with a DuPont Teflon® soil and stain resistant finish that makes cleanup a breeze. To spot wash, just sponge briskly with a soapy solution of Ivory Liquid or Joy in lukewarm water, then sponge thoroughly with clear water and allow to air dry.



# 1994 SPECIFICATIONS

	Americana		Four Seasons		Pioneer			Destiny					
	Williamsburg®	Sequoia®	Yosemite™	Cape Cod™	Arcadia®	Avalon™	Chesapeake®	Columbia™	Rio Grande™	Royale®	Cedar XL™	Cedar®	Roanoke®
<b>CONSTRUCTION</b>													
Built-in spare tire mount	S	S	S	S	S	S	S	S	S	S	S	S	S
Impact resistant front & rear ABS plastic panels	S	S	S	S	S	S	S	S	S	S	S	S	S
Bumper	S	S	S	S	O	O	O	O	S	S	S	S	S
Evolution® 3 tenting	-	-	-	S	S	S	S	S	S	S	S	S	S
Sunbrella® 302 tenting	S	S	S	O	O	O	O	O	O	O	O	O	O
Hydraulic lift	S	S	S	-	-	-	-	-	-	-	-	-	-
Crank down stabilizers	S	S	S	O	O	O	O	O	-	-	-	-	-
<b>TOWING</b>													
Road height (inches)	47	47	57	57	47	47	47	47	47	47	47	45	45
Base vehicle weight (lbs.)	1,715	1,715	1,850	1,751	1,490	1,740	1,445	1,099	1,460	1,270	1,255	995	995
Base hitch weight (lbs.)	130	165	160	173	145	150	125	145	90	125	80	125	125
Base axle weight (lbs.)	1,585	1,550	1,690	1,578	1,345	1,590	1,320	954	1,370	1,145	1,175	870	870
Trailer size (closed)	6'8"x15'7"	6'8"x15'7"	6'8"x14'11"	6'8"x14'11"	6'8"x14'10"	6'8"x14'10"	6'8"x14'10"	6'8"x12'7"	6'8"x16'4"	6'8"x13'5"	6'8"x14'2"	6'8"x11'5"	6'8"x11'5"
Electric brakes	S	S	S	S	O	S	O	O	O	O	O	O	O
Tire size (inches)	20.5x8x10	20.5x8x10	20.5x8x10	20.5x8x10	20.5x8x10	20.5x8x10	20.5x8x10	20.5x8x10	20.5x8x10	5.30x12	5.30x12	5.70x8	5.70x8
Hub caps	O	O	O	O	O	O	O	O	O	O	O	O	O
Coupler size	2"	2"	2"	2"	2"	2"	2"	2"	2"	2"	2"	2"	2"
<b>LIVING</b>													
Sleeping capacity	7	7	7	7	7	7	7	6	7	7	6	6	6
Trailer length (open)	22'8"	22'8"	22'5"	22'5"	22'8"	22'8"	22'8"	18'	21'	21'	17'	17'	17'
Living area (square feet)	129	129	129	129	129	129	129	93	114	114	90	90	90
Interior height (open)	6'7"	6'7"	7'1"	7'1"	6'7"	6'7"	6'7"	6'7"	6'7"	6'7"	6'7"	6'7"	6'7"
Overhead dome lights	4	4	4	4	2	2	2	2	2	2	2	2	2
Ice box/cooler (quarts)*	68	68	68	68	48	48	48	48	48	48	40	40	40
Tub/Shower/Hot Water Heater	S	-	S	-	S	-	-	-	-	-	-	-	-
Hot water with mixer faucet	S	S	S	-	S	-	-	-	-	-	-	-	-
Demand electric water pump	S	S	S	-	S	-	-	-	-	-	-	-	-
Potti	S	O	S	O	S	O	O	O	O	O	O	O	O
Potti storage cabinet	S	S	S	S	S	S	S	S	S	S	S	S	S
Galley/Swing-Level® or Fold Over	SL	SL	SL	SL	SL	SL	SL	SL	FO	FO	FO	FO	FO
Porcelain range w/# burners	3	3	3	3	3	3	3	2	3	3	2	2	2
Hi-pressure outside stove w/shelf	S	S	S	S	S	S	S	S	-	-	-	-	-
Low-pressure inside/outside stove	-	-	-	-	-	-	-	-	S	S	S	S	S
Mattress size (inches)	74x72 51x72	74x72 51x72	74x72 51x72	74x72 51x72	74x72 51x72	74x72 51x72	74x72 51x72	48x72 48x72	72x72 48x72	72x72 48x72	48x72 48x72	48x72 48x72	48x72 48x72
Convertible dinette bed size (inches)	49x73	40x73	40x70	40x70	39x70	39x68	40x73	40x74	36x65	36x65	40x73	40x73	36x59
Mattress thickness (inches)	4	4	4	4	4	4	4	4	3	3	3	3	3
Dinette table size (inches)	30x48	30x39	30x39	30x39	30x39	30x39	30x39	30x39	30x36	30x36	30x39	30x39	30x36
25 ft. 12-volt auto. extension cord	O	O	O	O	S	O	O	O	O	O	O	O	O
<b>STORAGE</b>													
Built-in water tank	UF (20 gal.)	UF (20 gal.)	UF (20 gal.)	10 gal.	10 gal.	-	-	-	-	-	-	-	-
Portable water tank	-	-	-	-	-	10 gal.	10 gal.	10 gal.	10 gal.	10 gal.	10 gal.	10 gal.	10 gal.
Outside ground fault receptacle	S	S	S	S	S	S	S	S	-	-	-	-	-
Cabinet storage (cubic feet)	44	32	39	45	38	54	41	31	55	39	49	29	28
Number of drawers	8	6	4	4	2	7	4	2	7	5	-	-	-
Outside storage access	S	S	-	-	-	S	-	-	S	-	S	-	-

\* When ordering factory installed refrigeration, the ice chest is omitted.  
© Copyright 1993 Fleetwood Enterprises, Inc.

S-Standard Equipment O-Optional Equipment - Not Available UF-Under Floor SL-Swing-Level FO-Fold Over

**FOLDING TRAILER DIVISION  
FLEETWOOD FOLDING TRAILERS, INC.**  
R.D. 2 • Somerset, PA 15501

**CORPORATE HEADQUARTERS  
FLEETWOOD ENTERPRISES, INC.**  
P.O. Box 7638 • Riverside, CA 92513-7638

**BY FLEETWOOD®**

Coleman and the Coleman Parallelogram are registered trademarks of The Coleman Company, Inc. used under license.

Product information and photography included in this brochure were as accurate as possible at the time of publication. Subsequent refinements may be evident in the final product. Prices and specifications are subject to change without notice. Selected decorator items shown in the photographs are not part of the product unless specified. All liquid capacities are approximate and dimensions are nominal.

Litho in USA 7/93 - Edition 1

Your local Coleman dealer is: