



1988 COLEMAN CAMPING TRAILERS



*Building
Memories* →



Building Memories

Camping. One of life's most enjoyable and rewarding experiences. Coleman has been an important part of camping for over 85 years, building memories for millions of families. Our commitment to excellence is a tradition...and this year's line of exciting camping trailers builds on our long heritage of quality. The joy of camping is enhanced with the best combination of comfort, convenience, safety and beauty. All this plus a solid warranty and our dedicated dealer network make sure you and your family get full enjoyment from your new Coleman Camping Trailer.

OUR WARRANTY MEANS BUSINESS



To deserve your business, we start with a quality-built product. Your trust in that claim demands a commitment through a strong warranty...and our Life-time Limited Warranty means business. The structural integrity of our lift system, floor, and steel frame is warranted for the lifetime of the original purchaser. Because we build Coleman Camping Trailers right, we can afford to give you the best warranty in the business.

You can depend on it. Compare for yourself! Ask your Authorized Coleman Dealer for details.



Coleman automotive-type dual sidewall bodies also provide a safety buffer zone against interior damage and allow easy, inexpensive reparability.

Coleman wiring is outdoor-type wiring—fully insulated and enclosed for safety, and fully protected against moisture, heat, cold and the chance of becoming frayed or severed. You can depend on it far from home.

Coleman Camping Trailers are built to take on the great outdoors. From smooth interstates to rough mountain passes, you can depend on quality craftsmanship and our easy-to-tow aerodynamic design to get you through the toughest conditions.

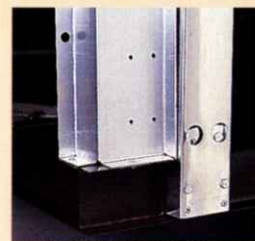

Coleman uses tough, American steel "box beam" frame construction for basic rugged strength and solid dependability.

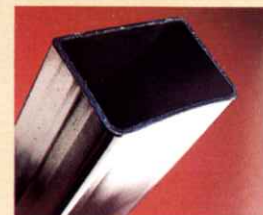

Sidewalls and corner supports of durable, heavy-gauge aluminum are riveted to the frame (not "screwed and glued") to provide an extra measure of individual component strength and a maximum of "unitized" integrity.

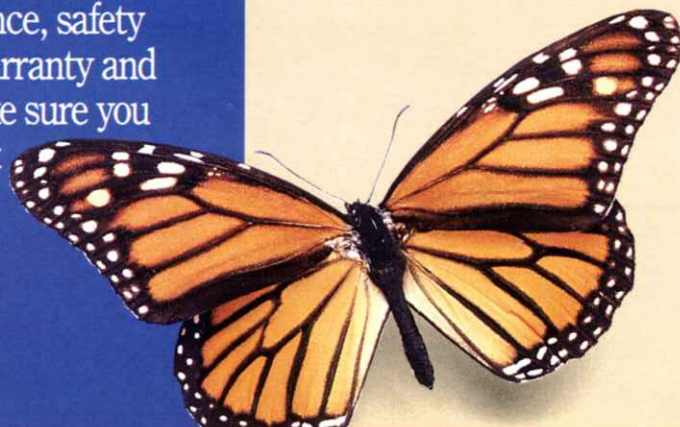



The lift system can be easily operated by a child turning the two-position posi-crank. The fail-safe mechanism functions smoothly on stainless steel needle bearings. And it operates effortlessly and dependably every time because the integral telescoping lifters are solidly bolted to the frame and made of strong, heavy-gauge stainless steel that won't rust or bind.



Coleman's patented lift system utilizes 75' of heavy-gauge (1/8" diameter) ultra-strong stainless steel aircraft cable. It's rustproof and virtually unbreakable—stronger by far than you'll find in other campers.



Coleman gives you a choice of fine exterior tenting materials: natural fiber Weathertex™ canvas or man-made Evolution 3®*—a fabric unaffected by extreme humidity. Both feature tight new lock stitching that won't "run" when snagged, and back tacking at all stress areas for good looks and long-lasting Coleman performance.

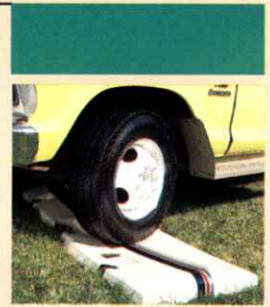

Acrylic-coated, high-impact ABS front and rear panels won't crack or chip under the toughest conditions. This high-tech material comes up looking great after years of bumping, banging, whipping branches and flying rocks.

*Evolution 3 is a registered trademark of the Kimberly-Clark Corporation.



BLANDEX

Like the finest homes, Coleman trailers feature wood floors. Specially treated, one-piece Blandex®* construction not only provides more foot comfort, insulation and reduced weight, it eliminates moisture build-up found in metal-to-flooring construction in other trailers—the cause of inner and outer floor deterioration. No Coleman trailer floor has ever had to be replaced!



No dark smoked vinyl here! Coleman brightens your world with tough, clear vinyl windows that lighten your living space by day and let you count the stars by night.



*Blandex is a registered trademark of the Blandin Wood Products Co.

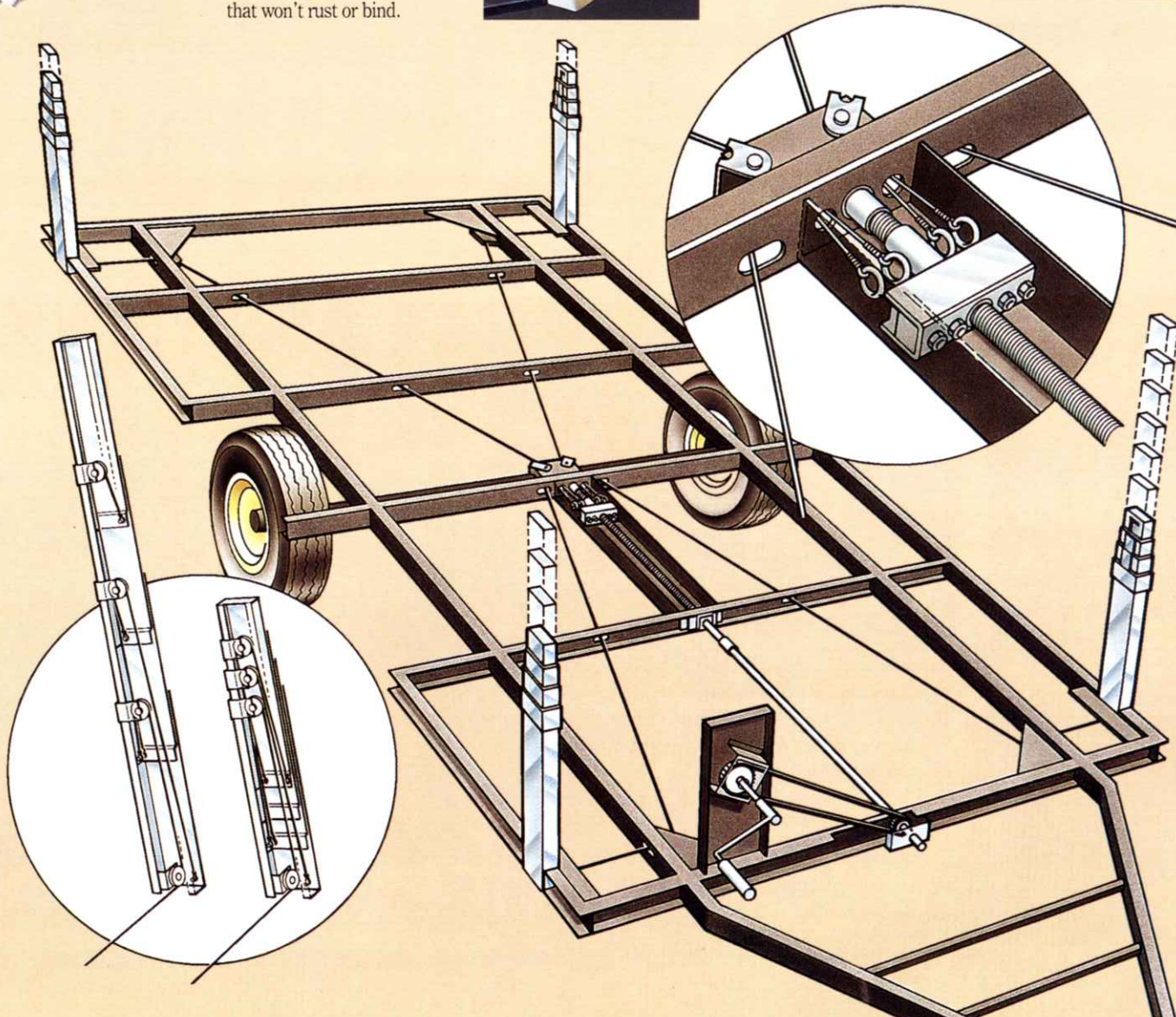

A good place to get the Coleman "Quality Perspective" is on the under perimeter. There are no glues, staples or flimsy sheet metal screws in this critical area. Coleman uses rivets and rugged hex-head tech screws for maximum strength and integrity.

FEATURES

Nobody, but NObody knows more about camping than Coleman. And we know what carefree fun it can be, especially when you get all the performance and all the "little things" you'll find in a Coleman Camping Trailer.

That's why we put all of our years of painstaking experience into the design of every camper we build. Detail after detail is carefully planned, designed and executed to enhance every Coleman trailer's performance on the road and at the campsite. And enhance *your* every camping adventure.

Coleman trailers are designed with the whole family in mind—from the location of the door latch to the extra headroom, quick-cooking stoves and dozens of other features unique to Coleman.

Find out more from your Coleman Dealer. Then *experience* America's best in a Coleman Camping Trailer!

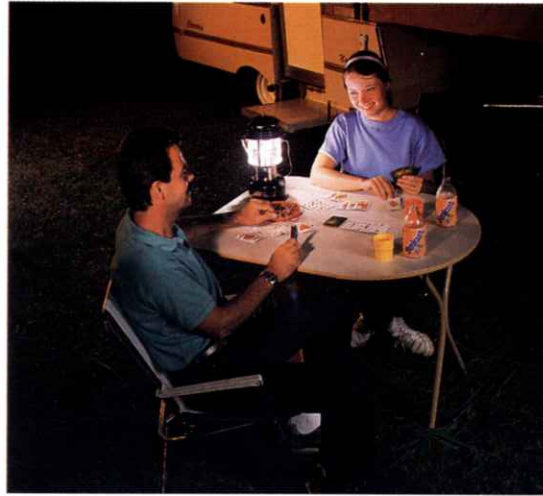

Coleman's dinette table is freestanding and portable. Eat inside or "dine out" with nature any time you choose.



A vinyl moisture barrier at the base of the end canopy, keeps your bedding bone dry, even during a rainstorm.



Coleman's comfortable, wood-backed dinette seats are locked in place. They support and stay put far better than loose throw cushions that fold up and slide about when you're sitting.



Conestoga-designed end canopies are angled to permit air flow and cross ventilation while channeling off streams of rainwater.



You'll find sitting on Coleman's beds gives you plenty of headroom as well as allows your feet to rest comfortably on the floor. If you sit on other campers' beds, you'll realize just what a pleasant difference this makes.

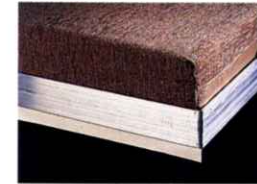

Coleman is unique among camping trailers because all beds are aluminum-framed to prevent warping. For long-lasting, quality construction, depend on Coleman.



The Stepper™ door features Coleman's Stepperlite™ for illumination where you need it most—at the doorstep.



CAMPING CONVENIENCE AT ITS BEST



Two exclusive Coleman features give you in-and-out convenience you won't find in any other camper. The self-storing Stepper™ door is a wide, sturdy step at a height even small children find comfortable. And the one-piece aluminum screen door has a privacy window panel, waist-level knobs and built-in automatic return. You'll appreciate these and many other extra touches Coleman builds in.

Coleman trailers make setting up easy and eliminate "misplaced part frustration" through permanently attached bed supports, dolly wheel (except Colorado®), step, stabilizing jacks and dinette table legs. This is just part of the design excellence that raises the quality of camping life for Coleman owners. In addition, Coleman provides 5" to 6" more interior headroom than most other trailers. It's roominess you'll grow to appreciate quickly.

Coleman Camping Stoves work like a breeze in a breeze. Our dependable outdoor stove generates 10,000 BTUs per burner—enough to cook in outdoor breezes. Other stoves, designed primarily for indoor use, don't function nearly as well. Outdoor cooking in a breeze is a breeze with Coleman.



Coleman ice chests may be used in the upright or chest position. Great to take along on a picnic or use it on your boat.



Waist-level lifter crank position makes raising or lowering the camper effortless, even for a child.



Lifter crank and stabilizer handles are stored in a convenient, easy-access compartment in the body.



Swing-down stabilizers are permanently bolted on for quick, easy, rock-solid stabilizing.



The swing-down, self-storing dolly wheel makes hitching up, un-hitching and positioning a snap.



Coleman's bed supports are permanently attached to the Conestoga™ wing beds. To set up, simply pull out the bed.

CAMP TALES

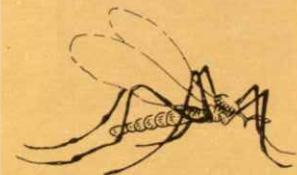

ITCHING TO BE USEFUL

The common plantain weed, long considered a “nuisance weed”, contains a juice in the leaves to soothe mosquito bites.

“

The trade-in value on our old Coleman was so good, we bought a new Chesapeake on the spot.

Clayton Nicholson
New Whiteland, Indiana

”

Plantation™

The Plantation is the flagship of the Coleman Camping Trailer Line, and this year it's our 20th anniversary special. The drop floor design in the galley area also features a built-in gas/electric refrigerator, three burner stove and oven, a porcelain sink and generous counter, drawer and cabinet space. For extra creature comfort, the Plantation features a private solid wall shower/tub and toilet area and two queen size beds. We've even added an outdoor ground fault receptacle. The Plantation is easy-to-tow and designed to maximize space and create a large living area you'd expect in a solid-wall trailer.





The striking beauty of the Plantation begins with a drop floor in the galley area. Built-in gas/electric refrigerator, porcelain sink, three-burner stove, oven, and plenty of counter, drawer and cabinet space make it easy to cook up the catch of the day.

The side dinette features wood-backed seat cushions for dining comfort. Extra seating is yours by turning the wardrobe into a loveseat. A private bathroom with toilet and solid-wall tub/shower arrangement make even the most rustic setting habitable.



The hardwall tub/shower enclosure sets up quickly and easily. Shower compartment includes tub, shower curtain and toilet.



Easy access from the outside of the camper allows you to empty the toilet without hauling anything more than a handy container.



Your own "comfort station", in the privacy of your camper, is built in.



A special cabinet with canned goods organizer keeps jars and other shelf items neat and easy to find. You'll wish you had this in your kitchen at home!



The fully equipped galley has roomy cabinets, easy-slide drawers and ample counter space built into the stationary galley.

The combination wardrobe/loveseat provides extra seating with the cushions in place. Upright, it's a handy wardrobe.

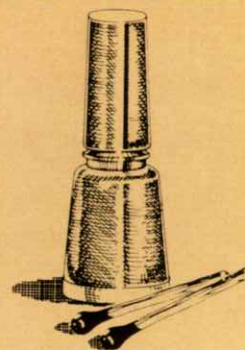

SURE FIRE

Dip wooden matches in nail polish or melted paraffin to keep them dry.

“

Our Savannah is real roomy. I'm 6' and our Coleman has more headroom and goes beyond anything we've rented or tried.

Stephen Hagenhoff
Oxnard, California

”



Americana™

Get close to the great outdoors in comfort. The Coleman Americana Series offers an array of quality features for luxurious living *anywhere*: Plush 4" thick mattresses, exclusive Swing-Level® galley and 3-burner stove, the Coleman Convertible™ ice chest, lined draperies, beautiful fabrics and much, *much* more.

Choose the Americana best suited for your family. *Any* Americana you select has the convenience and performance you expect from Coleman—the most respected name in the great outdoors.

“
The beds in our Sequoia are so comfortable and the perfect height with loads of headroom. We tried other camping trailers and nothing measures up to a Coleman.”

Edith Hoven
Oradell, New Jersey

”



A square knot is a good knot to use when connecting two pieces of rope of the same size; it's also the easiest to untie.





Americana™ interiors are designer-coordinated in the finest fabrics. The best in polyesters, olefins, polished cottons and a new material of 100% Marquesa® Lana upholstery yarns are used. All new interior fabrics exceed upholstery standards. Americana™ drapes have a full backing.



Both the queen and double beds have plush 4" thick mattresses to make day's end a welcome time.



Only Coleman Americana™ trailers feature the exclusive Swing-Level® galley. Stove, sink and spacious cabinets are set up by lifting the handle.



The Sequoia® features an outdoor stove too! Just slide the high-efficiency 20,000 BTU unit out of the side panel and you're all set for outdoor cooking.



The Williamsburg® enclosed tub/shower gives you the privacy you need for refreshing cleanups.

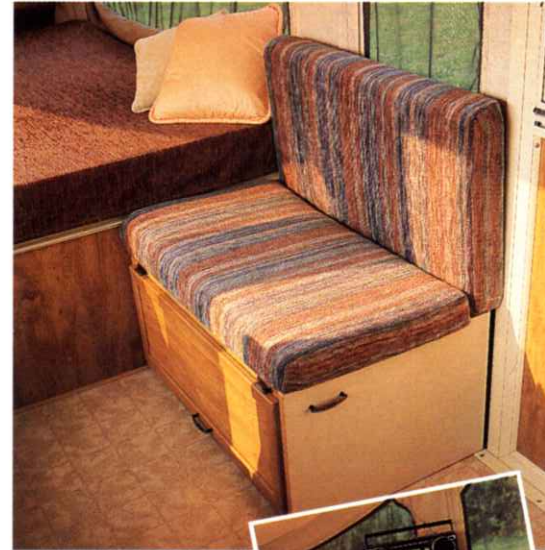

The Shenandoah® provides you with hanging storage in a vertical wardrobe. Or choose to use it in the down position with cushions for extra seating.



“
With the
shower in our
Williamsburg,
we can go to
more rustic
spots because
we don't need
campground
facilities.

David Blanchard
Schertz, Texas

”

“
Our
Coleman
Shenandoah
sets up real
easy and with
the roof air
conditioner,
we get the
best of the
outdoors with
indoor
comfort.

Mrs. Raymond Barnhouse
Garner, North Carolina

”

“
Our
Columbia is
loads of fun
for the whole
family. We
were raised
on camping
and our two
kids love it!

Mark Morel
Mason, Ohio

”



When crossing
a stream in fast
water or rough
bottom, a stout
stick about
6 ft. long will
enable you
to maintain
your balance
and feel for
drop-offs.

Pioneer®

Coleman
Pioneer
camping trailers
offer features you'd
expect to find in
more expensive
campers...plus
Coleman exclusives
you won't find
elsewhere at *any*
price. All Pioneer
models offer
6'5" headroom,
a fully equipped
galley, water tank,
free-standing dinette
table and more
"asked-for" features
like the unique
Stepper™ door with
deadbolt lock,
Stepperlite™ and
one-piece aluminum
screen door with
automatic return.
Clear vinyl windows,
dome lights, power
converter and other
items are built in.

Get economy and
efficiency without
sacrificing quality
and convenience—in
a Coleman Pioneer
Camping Trailer.





Coleman quality means economy with elegance! Pioneer® trailers feature the same craftsmanship, dependability and easy-to-live-with comfort Coleman is famous for throughout the world.



The Chesapeake® side dinette provides an added measure of hominess and makes serving, seating and eating cheerful and convenient for the whole family.



Sturdy as well as beautiful, these spacious oak wood finish metal cabinets are impervious to odors, easy to clean and provide plenty of storage room.



The new Expand-a-bed in the Columbia is a unique way of making a small package bigger, better and easier.



The Chesapeake and Newport feature lined drapes just like your home.

Coleman-designed screening lets in the slightest breeze and keeps out the smallest gnat.



“

We were so impressed with our neighbor's Coleman camping trailer, we just had to have one of our own—and we love our Coleman Newport.

Catherine Swiger
South Portland, Maine

”

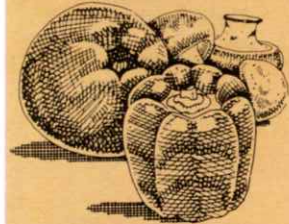

FOILED AGAIN!

Vegetables, wrapped in aluminum foil with two tablespoons of water, will cook up in 15 minutes over hot coals.

Colorado®

Colorado is America's best camping value for the down-to-earth outdoorsman who wants the fun and feel of tenting in the comfort of a dependable Coleman camper. Its unique design provides sleeping quarters for four adults. The built-in canopy, portable dinette table and huge 600 lb. cargo capacity (and base axle weight of only 515 lbs.) affords a new dimension in outdoor adventure with its enclosed eating, sleeping and relaxing comfort. Best of all, it's a Coleman!



This handy stove shelf accessory makes a perfect spot for mounting your Coleman outdoor stove.



Simply roll back the tarp...



Raise and secure the canopy bow...

Easy to tow, a snap to set up and super comfortable to sleep in, the Colorado® is a whole lot of camper for a surprisingly low price. And best of all—it's quality-crafted by Coleman all the way through.

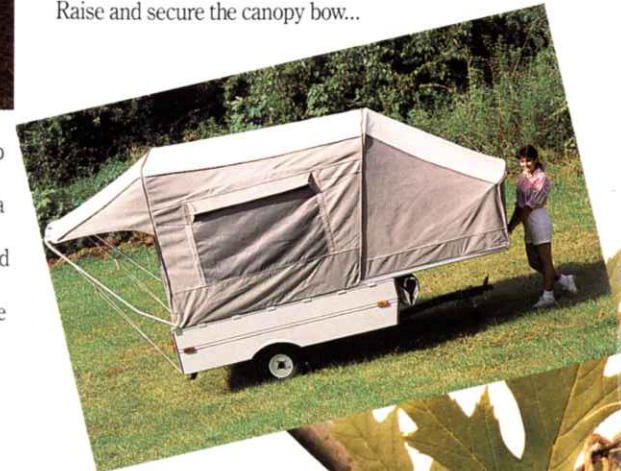

And pull out the bed. It's up!

Americana™ SERIES

SUN VALLEY®

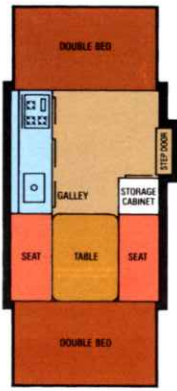

- Sleeps Six
- Two Double Beds
- Three Burner Stove
- Wardrobe Rack
- 995 lbs. Total Vehicle Wt.

LARAMIE™

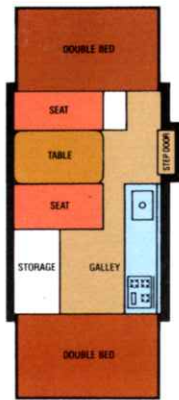

- Sleeps Six
- Two Double Beds
- Side Dinette/ Dine-A-Lounge
- Outside Storage Access
- 995 lbs. Total Vehicle Wt.

LARAMIE™ LTD

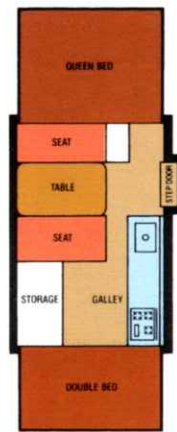

- Sleeps Seven
- One Queen Bed
- One Expand-a-bed
- Side Dinette/ Dine-A-Lounge
- Outside Storage Access

SHENANDOAH®

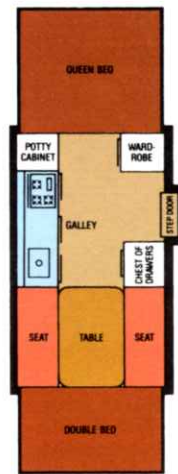

- Sleeps Seven
- One Queen Bed and One Double Bed
- Wardrobe/Love Seat
- Potty Cabinet

SEQUOIA®

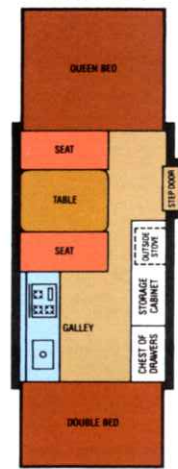

- Sleeps Seven
- One Queen Bed and One Double Bed
- Potty Compartment
- Outside Cooking

WILLIAMSBURG®

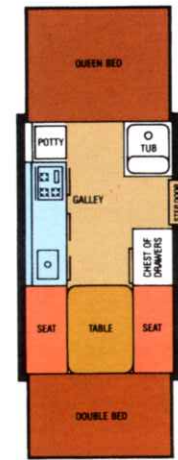

- Sleeps Seven
- One Queen Bed and One Double Bed
- Portable Potty
- Tub and Shower
- Hot Water Heater

Plantation™

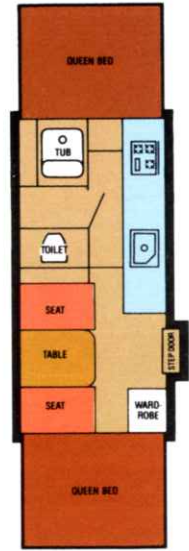

- Sleeps Eight
- Two Queen Beds
- Hardwall Shower/Tub
- Private Toilet
- Drop Floor Design
- Canned Goods Drawer
- Outside Ground Fault Receptacle

Pioneer® SERIES

COLUMBIA™

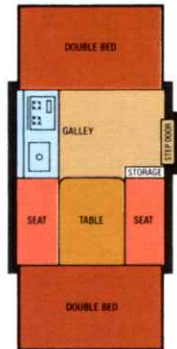

- Sleeps Six
- One Double Bed
- One Expand-a-bed
- 955 lbs. Total Vehicle Wt.

NEWPORT®

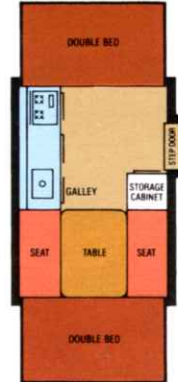

- Sleeps Six
- Two Double Beds
- Six AMP Power Converter
- Lined Drapes

CHESAPEAKE®

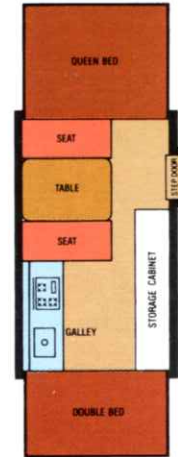

- Sleeps Seven
- Six AMP Power Converter
- One Queen Bed
- One Double Bed
- 41 cu. ft. Cabinet Storage

Colorado®

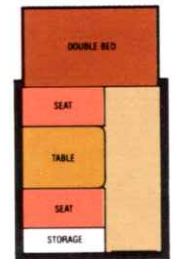

- Sleeps Four
- One Double Bed
- Converta Lounge
- Sleeps Two
- Built In Canopy
- 575 lbs. Total Vehicle Wt.



#See back page for explanation of base axle weight.

ACCESSORIES



**BOAT/
LUGGAGE RACK**
Secure a boat, canoe or extra luggage with this handy rack. It distributes the weight evenly over the trailer for driving safety, with virtually no appreciable difference in the camper's economical "one extra gallon per hundred miles" towing mileage.

**STOVE BRACKET,
STOVE AND GRILL**
Generate 20,000 BTUs of outdoor cooking power. This unit attaches to the outside of the trailer. The stove is standard on the 1988 Sequoia®; optional on all other models.

**INSTALLED
REFRIGERATOR**
It keeps foods fresh and supplies your ice. Operates on AC/DC current or LP gas.

FOURTEEN



REAR MOUNT BIKE RACK

This rear-mounted bike rack leaves the camper top clear for mounting air conditioner or other top-mounted accessories.



FURNACE

Choose from 12,000 or 20,000 BTU forced air furnace to extend your camping season. Keep warm on chilly nights or frosty mornings.



BICYCLE RACK

Take along your bikes. This rack mounts on the top of the trailer and carries two bikes in the upright position.



CANOPY/SCREENED ROOM COMBINATION

Choose between burgundy and gray strobe pattern or the traditional brown and white striped pattern self-storing canopy. Add on the optional screened room for significantly increased enclosed living space.



ICE CHEST COUNTERTOP

Create extra counter space. Attractive countertop clips on to the top of the ice chest.



AIR CONDITIONER

Keep cool on the hottest days. This roof-mounted air conditioner mounts on all 9-ft. and 11-ft. Americana™ Series trailers. For mounting on Pioneer® Series, see your authorized Coleman dealer.



GAS BOTTLE COVER

Protects the propane container and valves from dirt, road spray and the elements.



VANITY BOARD

Includes large mirror, shelf, towel rack, cup dispenser and toothbrush holder.

HEAVY-DUTY STORAGE BUMPER

Now an ideal spot for fishing rods!

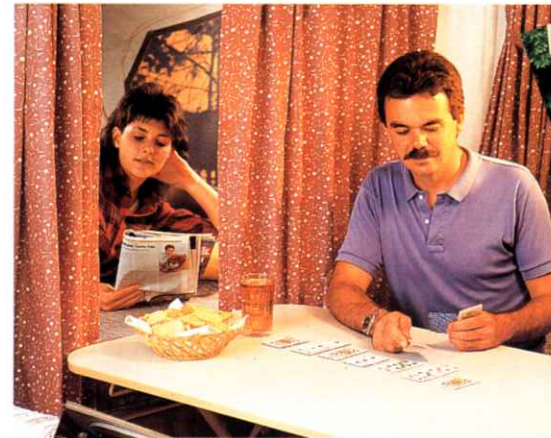

PRIVACY CURTAINS

Create a "private" room with these attractive lined curtains.

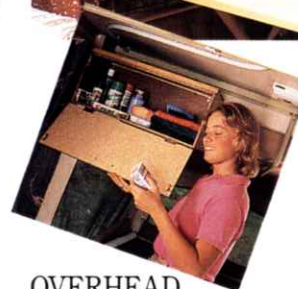

OVERHEAD STORAGE CABINET

Provides extra space that comes in handy.

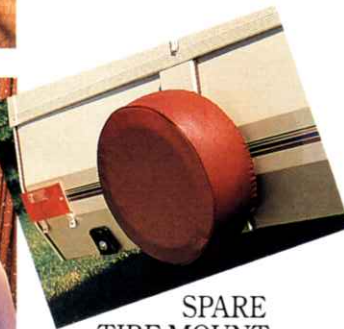

SPARE TIRE MOUNT

Provides more trunk room in your car. For Pioneer® Series only.



STONE GUARD

Pioneer stone guard kit protects your Pioneer from stone chips or other road hazards and keeps your trailer looking good for years.



BEDBAG™

For comfort, there's nothing quite like the Coleman BedBag. Choose from two sizes 56" x 80" double or 74" x 80" queen. Three color combinations and matching pillowshams are included.



SPECIFICATIONS

ONLY COLEMAN OFFERS ALL OF THESE STANDARD FEATURES ON ALL PLANTATION™, AMERICANA™ AND PIONEER® SERIES TRAILERS

- Insulated hard top§
- Aerolite tubular steel frame
- Baked-on aluminum side panels
- Bright annealed stainless steel telescoping lifts§
- Sliding leaf spring suspension (Torsion bar suspension Plantation only)
- Safety chains and 1 7/8" ball coupler (2" ball Plantation only)
- One-piece swing-up tongue jack§
- Attached stabilizers
- One-piece aluminum, self-closing screen door with sliding privacy panel§
- Self-storing Stepper™ door with deadbolt lock§
- Attached bed supports
- Brass pressure city water hook-up§
- 115-volt AC outlets
- Outside sink drainage system§
- Stepperlite™ §
- 4-way ventilation with screening
- Clear vinyl storm windows
- Cushioned-vinyl floor coverings
- Towel racks
- Porcelain sinks§
- Freestanding dinette table
- Vinyl-covered fabric over beds
- End bed moisture barrier
- 20 lb. gas bottle and regulator§

§ not available on Colorado

Models	Plantation™	Williamsburg®	Sequoia®	Shenandoah®	Laramie LTD™	Laramie™	Sun Valley®	Chesapeake®	Newport®	Columbia™	Colorado™
Constr.											
Built-in spare tire mount	S	S	S	S	S	S	S	0	0	0	0
High impact ABS frt. & rear panels (built-in rock shield)	S	S	S	S	S	S	S	—	—	—	—
Split bumper	—	S	—	—	—	—	—	—	—	—	—
Full bumper	S	0	0	0	0	0	0	0	0	0	—
Evolution™ 3	S	0	0	0	0	0	0	0	0	0	S
Road height	54"	47"	47"	47"	47"	45"	45"	47"	47"	44"	43"
Base vehicle wt. *	2200	1480	1355	1360	1202	995	995	1365	1095	955	575
Base axle wt. **	1995	1360	1240	1240	1098	895	895	1250	990	855	515
Base hitch wt.	205	120	115	120	104	100	100	115	105	100	60
Trailer size (closed)	6'9 1/4" x 17'5 1/4"	6'8" x 14'11"	6'8" x 14'11"	6'8" x 14'11"	6'8" x 12'11"	6'8" x 12'11"	6'8" x 12'11"	6'8" x 14'11"	6'8" x 12'11"	6'8" x 11'3"	6'3 1/2" x 10'5 1/2"
Electric brakes	S	S	0	0	0	0	0	0	0	0	—
Tire size 4.80 x 8	—	—	—	—	—	S	S	—	—	S	S
Tire size 20.5 x 8 x 10	—	S	S	S	S	0	0	S	S	0	—
Tire size B78 x 13 STLRC	S	—	—	—	—	—	—	—	—	—	—
Living											
Hub caps	S	S	S	S	S	S	S	0	0	0	0
Sleeping capacity	8	7	7	7	7	6	6	7	6	6	4
Trailer length (open)	26'2"	23'4"	23'4"	23'4"	21'4"	19'4"	19'4"	23'4"	19'4"	17'6"	14'8"
Living area (Ft²)	152	129	129	129	104	104	104	129	104	94	64
Interior height (open)	6'8"	6'5"	6'5"	6'5"	6'5"	6'5"	6'5"	6'5"	6'5"	6'5"	6'7"
Overhead dome lights	5	4	4	4	4	4	4	2	2	1	—
Built-in refrigerator	S	0	0	0	0	0	0	0	0	0	—
Coleman ice box (optional w/installed refrigerator)	0	S	S	S	S	S	S	S	S	S	0
Tub/Shower/Hot Water Heater	S	S	—	—	—	—	—	—	—	—	—
Solid-wall enclosed bath compartment w/installed toilet	S	—	—	—	—	—	—	—	—	—	—
Portable toilet	—	S	0	0	0	0	0	0	0	0	0
Potty storage cabinet	—	—	S	S	S	S	—	S	—	—	—
Swing-Level® Galley	—	S	S	S	S	S	S	—	—	—	—
Flip-up galley w/storage	—	—	—	—	—	—	—	S	S	S	—
Porcelain 2-burner range w/cover	—	—	—	—	—	—	—	—	S	S	—
Porcelain 3-burner range w/cover	—	S	S	S	S	S	S	S	—	—	—
3-burner range w/built-in oven	S	—	—	—	—	—	—	—	—	—	—
Mattress size	68" x 75"	75" x 72"	75" x 72"	75" x 72"	75" x 72"	51" x 72"	51" x 72"	75" x 72"	51" x 72"	51" x 72"	45" x 72"
	68" x 75"	51" x 72"	51" x 72"	51" x 72"	51" x 72"	51" x 72"	51" x 72"	51" x 72"	51" x 72"	51" x 72"	—
Mattress thickness	4"	4"	4"	4"	4 1/3"	4"	4"	4"	3"	3"	3"
Dinette table size	27" x 36"	30" x 48"	30" x 39"	30" x 48"	27" x 36"	27" x 36"	30" x 39"	30" x 39"	30" x 39"	30" x 39"	30" x 39"
Convertible dinette bed size	36" x 72"	49" x 73"	40" x 73"	49" x 73"	36" x 66"	36" x 66"	40" x 73"	40" x 73"	40" x 73"	40" x 73"	40" x 73"
25' 12-volt auto. extension cord	—	S	0	0	0	0	0	0	0	0	—
Storage											
Built-in water tank w/fill spout	18 gal.	18 gal.	10 gal.	10 gal.	10 gal.	10 gal.	10 gal.	—	—	—	—
Portable water tank (5 gal.)	—	—	—	—	—	—	—	S	S	S	—
Outside ground fault receptacle	S	—	—	—	—	—	—	—	—	—	—
Demand electric water pump	S	S	0	0	0	0	0	—	—	—	—
Cabinet storage (cubic feet)	37	37	41	46	33	33	37	41	35	26	13
Drawers #	8	5	4	5	2	2	2	—	—	—	—
Wardrobe rack	—	S	S	0	S	S	S	0	0	0	—
Fold down wardrobe w/cushions	S	—	—	S	—	—	—	—	—	—	—
Vanity	—	—	—	—	S	S	—	—	—	—	—

S—Standard equipment. O—Optional equipment.
 **Base axle weight is base vehicle weight less the hitch weight.
 †Two positions with ratchet.

*As shipped less optional accessories.
 Weights are plus or minus 5%.

Due to continuing improvements, The Coleman Company, Inc., reserves the right to make changes in prices, color, material specifications and models at any time without notice. Camping and trailer equipment shown in product photography or illustrations may be optional at additional costs. Consult your Coleman dealer.

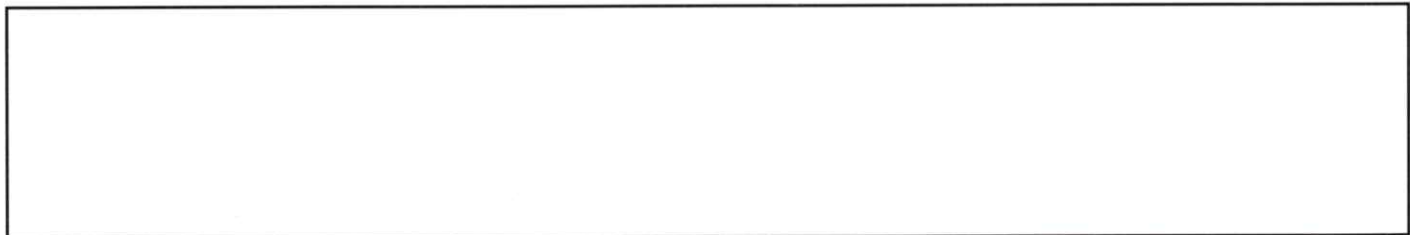

The Coleman Company, Inc.
 Camping Trailer Division
 Somerset, PA 15501

CAMPING TRAILERS