

Rediscover the American Spirit in a Coleman Camping Trailer





Quality Design You'll Appreciate!

**From the World's Most
Respected Name in Camping**

Coleman's experience and reputation for "sweating the details" shines through on the road and at the campsite. That's because we *know* camping. And, we know that the quality and fun of camping can be greatly affected by your camper's performance and the "little things"—not always provided for in other designs. Don't let little things affect your camping adventures. Have all the carefree fun and excitement camping is meant to be—go Coleman! Here are a few good reasons why:



The Stepper™ door



The Stepper™ door features Coleman's Stepperlite™ for illumination where you need it most—at the doorstep.

Coleman's exclusive, self-storing Stepper™ is a big, wide, sturdy step. It's positioned low enough to accommodate even small children and makes entrance or exit from the living area easier than in other campers. It makes loading and unloading much easier, too.



Built for "creature comfort," Coleman trailers feature an exclusive, extra-wide, one-piece aluminum screen door with a privacy window panel, waist-level knobs and built-in automatic return. These are all features you'll come to appreciate more and more in daily use, especially when loading and unloading supplies and equipment.



Coleman's dinette table is freestanding and portable. Eat inside or "dine out" with nature anytime you choose.

Coleman's comfortable, wood-backed dinette seats are locked in place. They support and stay put far better than loose throw cushions that fold up and slide about when you're sitting.



Coleman trailers make set-up easy and eliminate "misplaced part frustration" through *permanently attached* built-in bed supports, dolly wheel (except Colorado™), step, stabilizing jacks and dinette table legs. This is just part of the excellence in design that raises the quality of camping life for Coleman owners. Coleman design provides 5" to 6" more interior headspace than most

other trailers. It's roominess you'll grow to appreciate quickly. We build our trailers right. And, we back them with a five-year limited warranty on major components. The warranty covers parts and labor for the first three years and parts for the remaining two years.

See your authorized Coleman dealer for details and compare. We think you'll agree that it's the best warranty in the business.



A. Lifter crank and stabilizer handles are stored in a convenient, easy-access compartment in the body.

B. Swing-down stabilizers are permanently bolted on for quick, easy, rock-solid stabilizing.

C. The swing-down, self-storing dolly wheel makes hookup, unhooking and positioning easy and effortless.

D. Waist-level lifter crank position makes raising or lowering the camper effortless for even a child.

E. No one, but *no* one knows camp stoves like Coleman. Our dependable outdoor stove generates 10,000 BTUs per burner—enough to cook in outdoor breezes—where other stoves, designed primarily for indoor use, don't function nearly as well. Outdoor cooking in a breeze is a breeze with Coleman.

F. Coleman's beds are positioned to give you plenty of headroom as well as allow your feet to

rest comfortably on the floor when sitting. If you've visited other campers, you'll realize just what a pleasant difference this makes.

G. Coleman's bed supports are permanently attached to the Conestoga™ wing beds. To set up, simply pull out the bed and pull down supports.



“

No bothering with boxes to pack and unpack kitchen items. The Swing Level™ galley lets you keep cupboards fully packed.

Clint Courtney
Brooklyn Center, Minnesota

”

AN AVERAGE TREE THAT LIVES FOR FIFTY YEARS GENERATES OVER \$30,000 WORTH OF OXYGEN AND IS WORTH ANOTHER \$60,000 IN AIR-POLLUTION CONTROL.



THE AMERICANA™ SERIES.

Camping the way you've dreamed of it...
"No lodge or resort could offer this. It's just like we owned a home here. And we're not miles away from all this beautiful country. We're right here in the middle of it—every minute is an adventure. The Americana™ makes it all perfect."

Take luxurious comfort anywhere you want to be. The Coleman Americana™ Series provides a whole array of features that put quality living into camping adventure. A whole new selection of beautiful fabrics, lined drapes, exclusive Swing Level™ galley, 3-burner stove, Coleman Convertible™ 3-way cooler and big, plush 4"-thick mattresses. And much, much more.





The Williamsburg® enclosed tub/shower provides all the accommodating clean-up comfort of home.



Coleman's exclusive Swing Level™ galley is found only in Americana™ Series trailers. Stove, sink and spacious storage cabinets are all in one place; you simply lift the handle and you're ready to cook!



The Americana™ combines the great outdoors with the comforts of home. The interiors are designer coordinated in colors and fabrics of the finest material. Only the best in polyesters, olefins, polished cottons and a new material of 100% Antron® nylon called Hopsak™ is used. All fabrics in our new interiors exceed upholstery standards by at least four times. Americana™ drapes are quality finished with a full backing.



Queen-sized bed and double bed, with plush 4"-thick-mattresses, make the end of the day a welcome time.



Convenient outside storage on the Laramie™ for those items needed while traveling.



Talk about convenience! The Sequoia® features an outdoor stove, too! Simply slide the high-efficiency 20,000 BTU unit out of the side panel and you're all set for quick outdoor cooking at the campsite or on the way.



The cozy side dining table location of the Coleman Laramie™ also enhances its functional roominess.



“
Our
Williamsburg
is exactly
what we wanted
...affordable
quality you
can see.

Edward Eberts, Jr.
Ashville, Ohio



INSTANT TRACTION

Owning a 4WD is not always the answer, and digging out of mud or soft ground is not a pleasant task. Here's a simple trick. Put a few composition roof shingles in your vehicle on your next trip. If you get stuck, simply place the shingles under the tires with rough side down...instant traction.

“
Our 4½-year-old
cranks up our
Shenandoah® —
the lift system's
that easy!

Mark Truman
Thousand Oaks, California

“
Even though
John is 6'6",
he sleeps
comfortably
in the queen-
size bed.

Mrs. John Perry
Arlington, Texas

”

KEEP BUGS
AWAY FROM
YOUR CAMP
TABLE BY
POURING A
PUDDLE OF
PANCAKE
SYRUP (OR
THICK SUGAR
WATER) 10-15
FEET AWAY
FROM YOUR
CAMPER. THE
PESTS WILL
LEAVE YOUR
FOOD FOR THE
STICKY MESS.

“

Having the
outside stove
on our Sequoia®
is like tent
camping
without a tent
...only better!

R. J. Baumgartner
Greenbelt, Maryland

”

The Americana™ Series With Features That Make It The “Standard Of Excellence”

Sun Valley®

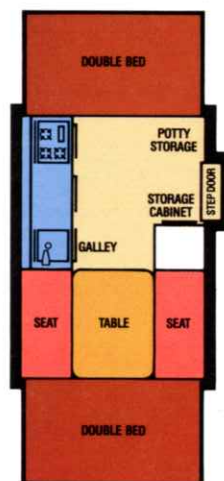

- Sleeps six
- Two double beds
- Three-burner stove
- Wardrobe rack
- 10" tires
- 895-lb. base axle wt.*

Laramie™

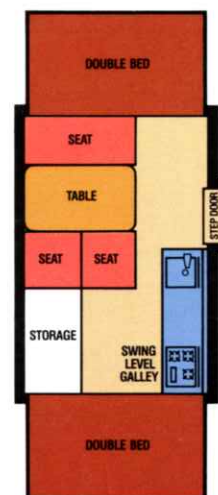

- Sleeps six
- Two double beds
- Side dinette
- Outside storage access
- 10" tires
- Wardrobe rack
- 895-lb. base axle wt.*

Shenandoah®

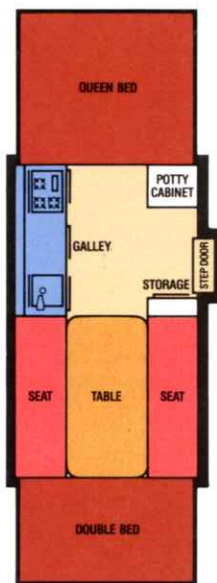

- Sleeps eight
- One queen-size bed and one double bed
- 56" dinette seats six or more (makes into another queen-size bed)
- Three-burner stove
- Wardrobe rack
- 1,240-lb. base axle wt.*

Sequoia®

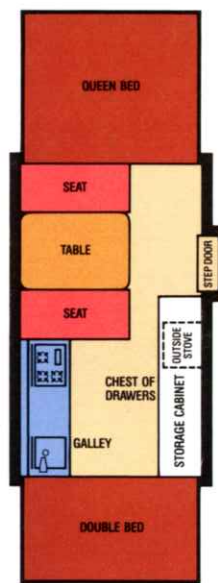

- Sleeps seven
- One queen-size bed and one double bed
- Side dinette
- Three-burner interior stove
- Three-burner exterior stove
- Wardrobe rack
- Chest of drawers
- 1,240-lb. base axle wt.*

Williamsburg®

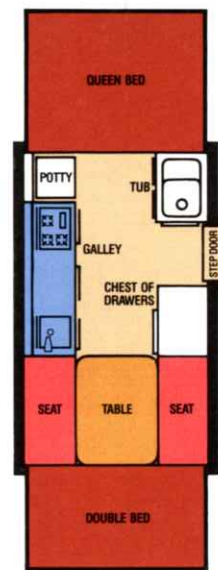

- Sleeps seven
- One queen-size bed and one double bed
- Three-burner stove
- Tub and shower
- Portable toilet
- Hot water heater
- Wardrobe rack
- Chest of drawers
- 1,365-lb. base axle wt.*

*For explanation of "base axle weight," see back page.

The Pioneer™ Series With Features That Make It America's Best Buy

Jamestown®

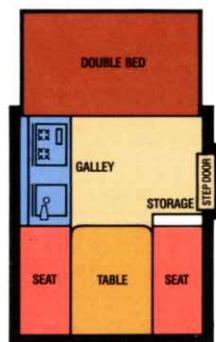

- Sleeps four
- One double bed
- Two vinyl windows
- Three-amp power converter
- 790-lb. base axle wt.*

Redwood®

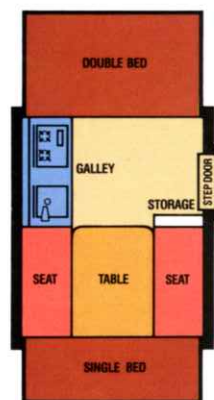

- Sleeps five
- One double bed and one single bed
- Vinyl-backed drapes
- Three-amp power converter
- 847-lb. base axle wt.*

Columbia™

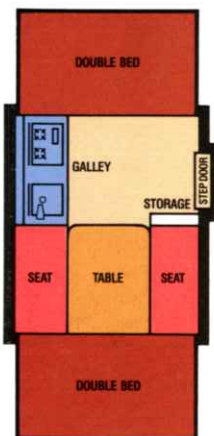

- Sleeps six
- Two double beds
- Waist-level crank
- Three-amp power converter
- 885-lb. base axle wt.*

Newport™

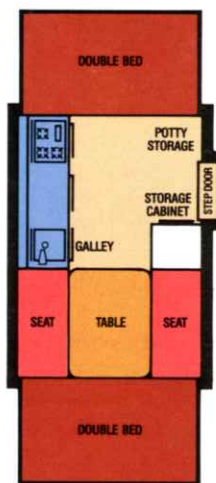

- Sleeps six
- Two double beds
- Vinyl-backed drapes
- 10" tires
- Six-amp power converter
- 990-lb. base axle wt.*

Chesapeake®

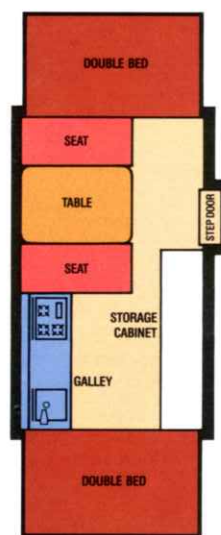

- Sleeps six
- Two double beds
- Three-burner stove
- Side dinette
- Six-amp power converter
- 680-lb. cargo capacity
- Lined drapes
- 1,185-lb. base axle wt.*

*For explanation of "base axle weight," see back page.

“
The heaviest
rainstorm
hit us, but we
stayed cozy
and dry in
our Columbia™.”

William Breuer
Filmore, New York

”

POCKET STEWS

For each serving, place a hamburger patty in the center of a square of heavy-duty aluminum foil. Add seasoning and cover with thinly sliced potatoes, onions, carrots and peas. Top with a slice of bacon. Fold the ends of the foil under until thickened handles are formed. Lay on a bed of coals and turn as needed for 15 to 20 minutes. Slit open the package and serve.

“
We've been
Coleman people
for 29 years.
You stick with
what's good.”

Ernest J. Langstone
Babylon, New York

”

HOLDING A
FISH UPSIDE
DOWN KEEPS IT
FROM SQUIRMING
SO YOU CAN
REMOVE THE
HOOK MORE
EASILY.

“

*It tows so
light and low—
it practically
rides along
for free!*

Nolan Hancock
Lenoir, North Carolina

”

WILDERNESS WASTE

Nature will recycle
anything we leave
behind. But it takes
an incredibly
long time:

Orange peel—two
weeks to six months.
Ordinary paper—six
months to two years.
Plastic-coated paper—
one to five years.
Plastic bags—10 to
20 years.
Camera film—20 to
30 years.
Nylon fabric (or rope)—
30 to 40 years.
Old boot soles—50 to
80 years.
Aluminum cans (and
pull tabs)—80 to
100 years.

THE PIONEER™ SERIES.

Economy and quality camping—
a Coleman exclusive

“It's more than you would expect even from Coleman. It's great to be 'right there,' enjoying every minute of our time together and having all the advantages of home in a good-looking, very dependable and fun-to-live-with Pioneer. Come out and see us. Our address is, 'America.'”

The Coleman Pioneer™ Series offers economy and efficiency without sacrificing superior quality and convenience. The five distinctive models all feature: 6'5" interior headroom, complete 36"-high galley with stove, cover, splash guard and water tank, freestanding dinette table and hard-backed dinette cushions that convert to an extra bed. Also, Coleman Stepper™ door with deadbolt lock, Stepperlite™, and one-piece aluminum screen door with automatic return. And such quality bonuses as clear vinyl windows with vinyl-backed drapes*, dome lights, power converter and more that you'll find only in a Coleman.

*Chesapeake® features lined drapes.





Sturdy, as well as beautiful, these spacious oak wood finish metal cabinets provide plenty of storage room right where you want it.

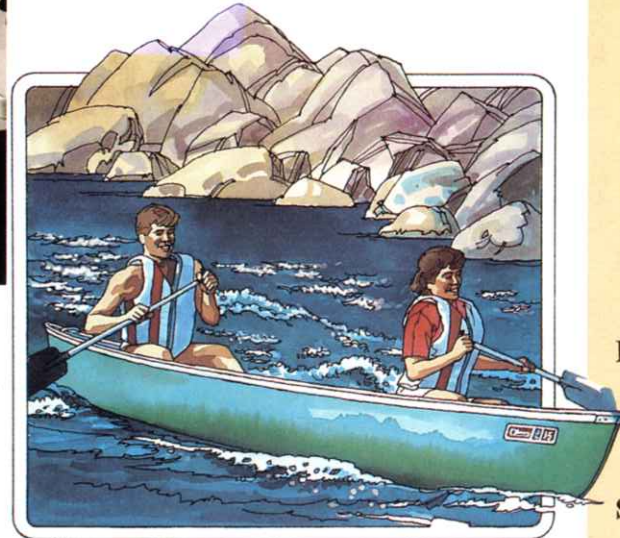

“
My wife
loves the way
our Coleman
camper tows.
We got our
money's worth.

Troy Cooner
Jay, Florida

”

**BRUSHLESS
SHAVING
CREAM CAN BE
USED FOR
MOISTURIZING
DRY, CHAPPED
SKIN, AS FIRST
AID FOR
CRACKED
FINGERS AND
EVEN STOPPING
SMALL LEAKS
IN CANVAS.
PEOPLE SOME-
TIMES EVEN
SHAVE WITH IT.**



Coleman quality means economy with elegance! Pioneer™ Series trailers feature the same craftsmanship, dependability and easy-to-live-with comfort Coleman is famous for throughout the world.

The Chesapeake® side dinette provides an added measure of hominess, and makes serving, seating and eating cheerful and convenient for the whole family.



Drapery fabrics* are use-enhanced by a “no-show-through” vinyl backing for complete privacy anywhere. Chesapeake® trailers feature lined drapes.

Coleman-designed screening lets in the slightest breeze while keeping out the smallest gnat.



“
In twenty
minutes, I'm
all set up
and ready to
go hunting.

Richard Andruchuk
Providence, Rhode Island

”

Enjoy Discovering America More With Accessories For Adventuring



Heavy-Duty Storage Bumper
Now! An ideal spot for fishing rods!



Air Conditioner
Keep cool on the hottest days. This roof-mounted air conditioner mounts on all 9-ft. and 11-ft. Americana™ Series trailers. For mounting on Pioneer™ Series, see your authorized Coleman dealer.



Vanity Board
Includes large mirror, shelf, towel rack, cup dispenser and toothbrush holder.



Privacy Curtains
Create a "private" room with these attractive, lined curtains.

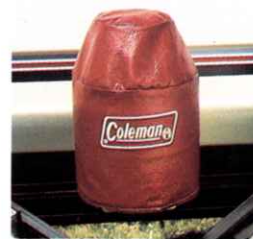
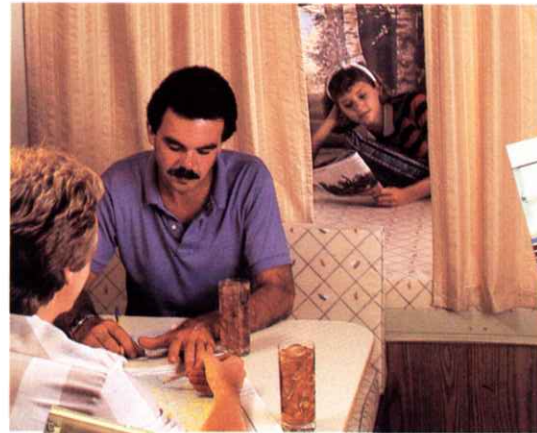

Gas Bottle Cover
Protects the propane container and valves from dirt, road spray and the elements.



Spare Tire Cover
Looks neat and protects your spare tire.



Overhead Storage Cabinet
Provides extra space that comes in handy.



Boat/Luggage Rack

Secure a boat, canoe or extra luggage with this handy rack. It distributes the weight evenly over the trailer for driving safety, with virtually no appreciable difference in the camper's economical "one extra gallon per hundred miles" towing mileage.

Stove Bracket, Stove and Grill

Generate 20,000 BTUs of outdoor cooking power. This unit attaches to the outside of the trailer. The stove is standard on the 1986 Sequoia®; optional on all other models.

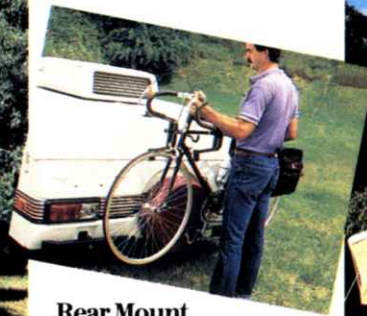

Rear Mount Bike Rack

This rear-mounted bike rack leaves the camper top clear for mounting air conditioner or other top-mounted accessories.



Canopy and Screened Room Combination

Choose between burgundy and gray strobe pattern or the traditional brown and white striped pattern self-storing canopy. Add on the optional screened room for significantly increased enclosed living space.



Furnace

Choose from a 12,000 or 16,000 BTU forced air furnace to extend your camping seasons. Keep warm on chilly nights and frosty mornings.



Bicycle Rack

Take along your bikes. This rack mounts on the top of the trailer and carries two bikes in the upright position.



3-Way Refrigerator

This unit is completely portable. It keeps foods fresh and supplies your ice. Operates on AC/DC current or LP gas.



REDISCOVER AMERICAN VALUE

Discover the Colorado™!
Rugged, Lightweight, Comfortable,
Convenient and Coleman...

The ideal camping vehicle for hunter, fisherman, basic camper and down-to-earth outdoorsman. Coleman's innovative Colorado™ features the enclosed eating, relaxing and sleeping comfort of a camping trailer without sacrificing the fun and feel of tenting.

Only 515-lb. base axle wt., the Colorado's™ unique folding design—comparable to a modern dome tent—provides a surprisingly spacious interior. Enough room to sleep four adults. And it features such Coleman conveniences as high-density foam mattresses, a built-in canopy, a portable dinette table and a cargo capacity exceeding 600 lbs.



Easy to tow, a snap to set up and super comfortable to sleep in, the Colorado™ is a whole lot of camper for a surprisingly low price.

And, best of all—it's quality crafted by Coleman, all the way through.



Simply roll back the tarp...



Raise and secure the canopy bow...



And pull out the bed. It's up!



This handy stove shelf accessory makes a perfect spot for mounting your Coleman outdoor stove.

From a Tradition of Excellence...

A NEW WORLD OF CAMPING LUXURY

THE COLEMAN PLANTATION SERIES

Experience the luxury, style and roominess of the Plantation™ Tara™ and Savannah™ models. Large, elegant living areas combined with every convenience and comfort to make camping a sheer delight. Get all the details in a beautiful new full color brochure from your authorized Coleman dealer.



More Coleman Quality for the Great Outdoors

MasterCraft
A Coleman Company

MasterCraft
Rt. 9, Box 152, Binfield Rd.
Maryville, TN 37801
615-983-2178



Crosman Air Guns
980 Turk Hill Rd.
Fairport, NY 14450
716-223-6000



Western Cutlery
180 Pike Rd.
P.O. Box 1539
Longmont, CO 80501
303-773-5900



Golden Eagle Archery
104 South Mill
P.O. Box 310
Creswell, OR 97426
503-895-3371



The Coleman Company, Inc.
Outing Products Group
250 North St. Francis
Wichita, KS 67281
316-261-3211



Hobie Cat
4925 Oceanside Blvd.
P.O. Box 1008
Oceanside, CA 92045
619-758-9100



O'Brien International
14615 N.E. 91st St.
Redmond, WA 98052
206-881-5900



Skeeter Products, Inc.
1 Skeeter Rd.
P.O. Box 230
Kilgore, TX 75662
214-984-0541



The Coleman Company, Inc.
Peak 1
250 North St. Francis
Wichita, KS 67201
316-261-3211

Serving areas outside the United States of America are The Canadian Coleman Company Ltd. and the Coleman International Division. The Coleman Heating & Air Conditioning Group produces the fine heating and cooling systems for residential and recreational use. 15

Only Coleman Offers All of These Standard Features on All Americana™ and Pioneer™ Series Trailers

- Insulated hard top
- Aerolite tubular steel frame
- Baked-on aluminum side panels
- Bright annealed stainless steel telescoping lifts
- Sliding leaf spring suspension
- Safety chains and 1 7/8" ball coupler
- One-piece swing-up tongue jack
- Attached stabilizers
- One-piece aluminum, self-closing door with sliding privacy panel
- Self-storing Stepper™ door with deadbolt lock
- Attached bed supports
- Brass pressure city water hook-up
- Three 115-volt AC outlets
- Outside sink drainage system
- Stepperlite™
- 4-way ventilation with screening
- Clear vinyl storm windows
- Cushioned-vinyl floor coverings
- Towel racks
- Porcelain sinks
- Freestanding dinette table
- Vinyl-covered canvas over beds
- End bed moisture barrier
- 20 lb. gas bottle and regulator

Coleman Colorado™ Features:

- 18 ounce vinyl-coated top
- Aerolite tubular steel frame
- Fire-retardant 10.1 Army duck canvas
- Baked-on aluminum side panels
- Sliding leaf spring suspension
- Safety chains and 1 7/8" ball coupler
- Two attached stabilizers and two stack jacks
- Freestanding dinette table
- Aluminum framed canvas door
- Attached bed supports
- 4-way ventilation with screening
- Clear vinyl storm windows
- Vinyl-covered canvas over beds
- End bed moisture barrier, etc.

Note: The Colorado Trailer is not equipped with electrical, plumbing or cooking equipment.



The Coleman Company, Inc.
Camping Trailer Division
Somerset, PA 15501

CAMPING TRAILERS

Models	Jamestown®	Redwood®	Columbia™	Newport™	Chesapeake™	Laramie™	Sun Valley®	Shenandoah®	Sequoia®	Williamsburg®	Colorado®
Constr.											
Built-in spare tire mount	0	0	0	0	0	S	S	S	S	S	0
High impact ABS frt. & rear panels (built-in rock shield)	—	—	—	—	—	S	S	S	S	S	—
Split bumper	0	0	0	0	0	0	0	0	0	S	—
Evolution™ 3	0	0	0	0	0	0	0	0	0	0	—
Towing											
Road height	44"	44"	44"	47"	47"	45"	45"	47"	47"	47"	43"
Base vehicle wt. *	905	952	955	1,095	1,300	995	995	1,360	1,355	1,485	575
Base axle wt. **	790	847	855	990	1,185	895	895	1,240	1,240	1,365	515
Base hitch wt.	115	105	100	105	115	100	100	120	115	120	60
Trailer size (closed)	6'8" x 11'3"	6'8" x 1'3"	6'8" x 11'3"	6'8" x 12'11"	6'8" x 14'11"	6'8" x 12'11"	6'8" x 12'11"	6'8" x 14'11"	6'8" x 14'11"	6'8" x 14'11"	6'3 1/2" x 10'5 1/2"
Electric brakes	0	0	0	0	0	0	0	0	0	S	—
Tire size 4.80 x 8	S	S	S	—	—	S	S	—	—	—	S
Tire size 20.5 x 8 x 10	0	0	0	S	S	0	0	S	S	S	—
Hub caps	0	0	0	0	0	S	S	S	S	S	0
Waist level crank positions	S	S	S	S	S	S†	S†	S†	S†	S†	—
Living											
25' 12-volt auto. extension cord	0	0	0	0	0	0	0	0	0	S	—
Trailer length (open)	12'4"	15'10"	17'6"	19'4"	21'4"	19'4"	19'4"	23'4"	23'4"	23'4"	14'8"
Living area (F ²)	68	83	94	104	129	104	104	129	129	129	64
Interior height (open)	6'5"	6'5"	6'5"	6'5"	6'5"	6'5"	6'5"	6'5"	6'5"	6'5"	6'7"
Overhead dome lights	1	1	1	2	2	2	2	2	2	2	—
Dining											
Towel racks	S	S	S	S	S	S	S	S	S	S	—
Coleman ice box	Chest	Chest	Chest	Chest	Chest	3-Way 68 Qt.	3-Way 68 Qt.	3-Way 68 Qt.	3-Way 68 Qt.	3-Way 68 Qt.	—
Swing-Level™ Galley	—	—	—	—	—	S	S	—	—	—	—
Flip-up galley w/storage	S	S	S	S	S	—	—	—	—	—	—
Porcelain 2-burner range w/cover	S	S	S	S	—	—	—	—	—	—	—
Porcelain 3-burner range w/cover	—	—	—	—	S	S	S	S	S	S	—
Porcelain sink	S	S	S	S	S	S	S	S	S	S	—
Dinette table (freestanding)	30" x 39"	30" x 39"	30" x 39"	30" x 39"	30" x 39"	27" x 40"	30" x 39"	30" x 56"	30" x 39"	30" x 39"	30" x 39"
Sleeping											
Sleeping capacity	4	5	6	6	6	6	6	8	7	7	4
Mattress size	51" x 72"	51" x 72"	51" x 72"	51" x 72"	51" x 72"	51" x 72"	51" x 72"	75" x 72"	75" x 72"	75" x 72"	45" x 72"
Mattress thickness	3"	3"	3"	3"	4"	4"	4"	4"	4"	4"	3"
Convertible dinette bed size	40" x 73"	40" x 73"	40" x 73"	40" x 73"	40" x 73"	40" x 70"	40" x 73"	60" x 73"	40" x 73"	40" x 73"	40" x 73"
Storage											
20# gas bottle and regulator	S	S	S	S	S	S	S	S	S	S	—
Built-in water tank w/fill spout	—	—	—	—	—	10 gal.	10 gal.	10 gal.	10 gal.	18 gal.	—
Portable water tank (5 gal.)	S	S	S	S	S	—	—	—	—	—	—
Tub & shower	—	—	—	—	—	—	—	—	—	S	—
Hot water heater	—	—	—	—	—	—	—	—	—	S	—
Demand electric water pump	—	—	—	—	—	0	0	0	0	0	—
Cabinet storage (cubic feet)	26	26	26	35	41	37	37	46	41	36	13
Portable toilet	0	0	0	0	0	0	0	0	0	S	0
Portable toilet storage area	—	—	—	S	—	S	S	S	S	S	—
Portable toilet storage cabinet	—	—	—	—	—	—	—	S	—	—	—
Drawers	—	—	—	—	—	3	2	3	4	5	—
Wardrobe rack	0	0	0	0	0	S	S	S	S	S	—

S—Standard equipment. 0—Optional equipment. *As shipped less optional accessories.
 **Base axle weight is base vehicle weight less the hitch weight. Weights are plus or minus 5%.
 †Two positions with ratchet.

Due to continuing improvements, The Coleman Company, Inc., reserves the right to make changes in prices, color, material specifications and models at any time without notice. Camping and trailer equipment shown in product photography or illustrations may be optional at additional costs. Consult your Coleman dealer.

