



Folding Travel Trailers. A New Tradition in Family Camping Luxury.

PLANTATION





Savannah™

Style and roominess are the key words which describe the Savannah's interior. The rich wood tones are contrasted with blue print cotton-and-polyester-blend overdrapes against beige undercurtains. This cozy living space is complete with a three-burner stove and a spacious countertop. Below, ample drawer and cupboard space is provided for those extended camping trips. Six adults can sleep comfortably on 4-inch-thick foam mattresses. The two double beds in the sleeping quarters are covered with a stylish, durable cotton fabric in a reversible decorator print. The Armstrong™ flooring will stay beautiful even after years of use. Camp in comfort and style in the Coleman Savannah.



Storage Cabinet

An overhead cupboard above the sink for convenient storage of items you use most often.

Oven

Make a "down-home" breakfast in the optional oven. It can be easily installed in the space provided.



Gas Furnace with Thermostat
Delivers 19,500 BTUs for year-round camping comfort.



Savannah™ and Tara™ Standard Features



Enclosed Tub/Shower Facility
The hardwall enclosure sets up quickly and easily. Shower compartment includes tub, shower curtain and potty.



Enamel Sink
Color-coordinated, high-gloss enameled sink measures 14" x 14" x 5". Can be hooked-up to campground water supply or the camper's 18-gallon cold and 6-gallon hot water tanks.

Gas/Electric Refrigerator
Food spoilage is a thing of the past in the Tara and Savannah. Dometic 211, 3-way refrigerator has adjustable temperature settings. Switches easily from gas to 12v or 110v.



Wardrobe/Seat/Potty Compartment
It's a handy wardrobe when standing upright with space underneath to store a second potty. In the down position, with the seat and back cushions in place, it becomes a love seat.



Cotton/Polyester Draperies
The beige undercurtains and matching blue print overdrapes add a decorator touch to your trailer while providing complete privacy.

Accessories

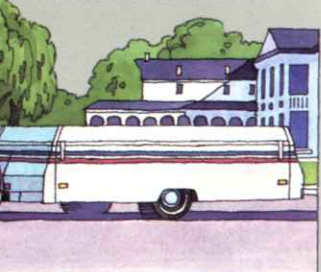

Air Conditioning
Coleman TSR™ or Delta T™ will keep your trailer cool and dry in the hottest weather. Heat strip delivers 5,600 BTUs to take the chill out of the morning air. Ask your Coleman dealer for specifications and installation details.



Canopy
Easy to attach to the trailer, easier to set up. Canopy and components roll up and store in the storage pouch which is attached to the roof of the trailer. Screen room can be added, if desired.



Tara™

A drop floor highlights the elegance of the Tara, putting it into a class by itself. The solid wall creates a private "master suite" which includes a queen-sized bed and a tub/shower/potty compartment. Also featured in the Tara is a side dinette and a wardrobe which converts to a love seat for extra seating. The modern decorator look is completed with coordinated over-and-under draperies made of easy-care cotton/polyester-blend fabric. The stationary galley is a dream come true with the built-in 3-way gas/electric refrigerator, three-burner range and plenty of counter space. A variety of cabinets and drawers enhance the functionality of this superbly designed kitchen area. Quality Armstrong™ flooring provides lasting quality and beauty to this spacious trailer. Tara—the utmost in style, comfort and convenience.

Privacy Curtains

They match the overdrapes for a coordinated look in your trailer. Convert sleeping quarters into private rooms.



Spare Tire Cover

Protects the spare tire and keeps it clean while adding a "finished" look to the trailer's exterior.

THE COLEMAN® HERITAGE TRAVELS ON.

Coleman has provided camping enthusiasts with quality outdoor products for 85 years. From this long tradition of excellence, Coleman boldly developed an innovative line of camping trailers with an advanced design and superior construction. Today, these feature-packed folding trailers are recognized as the number one selling brand in the world.

Coleman is now taking another bold step toward meeting the needs of campers. Introducing the Plantation™ Series—the world's first Folding Travel Trailers. The Plantation Tara™ and Savannah™ provide you, your family and guests with many of the luxury features of a solid-wall travel trailer in easy-to-tow folding camping trailers. Inspect the Plantation Series with your Coleman Camping Trailer Dealer. You'll see why we are convinced the Tara and Savannah are the perfect alternatives to conventional travel trailers.

In the closed position, these new trailers are just slightly larger than other Coleman trailers. Open the trailer, step inside and instantly become aware of how Coleman designers maximized the added space and created a large, elegant living area. As you examine the interior, you'll find many features which you may not expect to find in a fold-down trailer. For instance, both the Tara and Savannah are equipped with a hardwall-enclosed tub and shower compartment, a wardrobe which converts to a love seat, and a power-exhaust roof vent.

If you are the chef of your camping group, you will appreciate the spacious galley with plenty of counter space for easy meal preparation. And below the countertops there is plenty of drawer and cupboard space as well as a built-in gas/electric refrigerator and an optional oven. The increased space of the dinette area makes meal time more enjoyable for everyone. There is even a built-in, thermostatically-controlled 19,500 BTU gas furnace to keep your trailer at the temperature you desire during those chilly evenings. And come morning, you'll awake refreshed after a relaxing night's sleep on a 4"-thick reversible foam mattress. For your listening enjoyment both the Tara and Savannah are pre-wired for an AM/FM stereo system.

As the years go by, you'll be thankful for the superior construction of the Plantation Series trailers. The box-beam tubular steel frame, the hi-impact ABS front and rear panels and the Coleman exclusive automotive-type construction (the strongest and lightest in the industry) combine for superior quality. Other features such as the one-piece aluminum screen door and the one-piece Stepper™ door with dead-bolt lock help provide years of worry-free service.

That's why the Plantation Series Folding Travel Trailers are backed by the Coleman five-year limited warranty.

For the luxury, for the quality construction, for your overall camping comfort and peace of mind, move into a Plantation Series Folding Travel Trailer and be a part of a new camping heritage built on the Coleman tradition for excellence.

Two Unique Floor Plans for Camping Comfort and Convenience

Savannah™

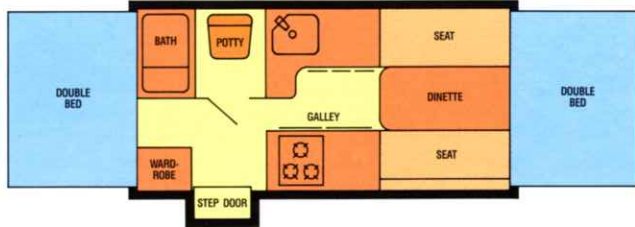

- Sleeps up to six adults
- 1,865 lb. curb weight*
- Two double beds with 4" thick foam reversible mattresses
- 3-burner range
- Built-in 3-way gas/electric refrigerator
- Solid wall tub/shower/potty compartment
- Wardrobe/seat/potty cabinet
- Pre-wired for stereo system

Tara™

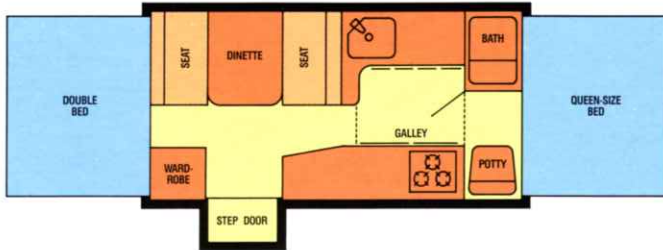

- Sleeps up to 7 adults
- 1,865 lb. curb weight*
- One-piece queen-size bed and one double bed with 4" thick foam reversible mattresses
- 3-burner range
- Built-in 3-way gas/electric refrigerator
- Solid wall tub/shower/potty compartment
- Wardrobe/seat/potty cabinet
- Pre-wired for stereo system

*Curb weight is the dry weight of the vehicle minus hitch weight.



CAMPING TRAILERS

Specifications

	Savannah	Tara
CONSTRUCTION FACTS:		
Insulated hard top	S	S
Steel box beam frame	S	S
Spare tire mount	S	S
Fire retardant canvas	S	S
Baked enamel side panels (aluminum)	S	S
High impact ABS front & rear panels (stone guard)	S	S
Full bumper (aluminum)	S	S
Bright annealed stainless steel lifts	S	S
TOWING FACTS:		
Road height	54"	54"
Hitch weight	185	185
Curb weight	1,865	1,865
Trailer size closed	17' 5 1/4" x 6' 9 3/4"	17' 5 1/4" x 6' 9 3/4"
Electric brakes	S (10")	S (10")
Rubber ride axle	S	S
30" free length of chain and 2" coupler	S	S
Tire size	B7813ST LRC	B7813ST LRC
Full hub caps	S	S
SET-UP FACTS:		
Swing-up tongue jack	S	S
Attached stabilizers	4	4
1-piece screen door	S	S
Stepper™ door	S	S
Attached bed supports	S	S
LIVING FACTS:		
25' auto extension	S	S
Brass city water hookup	S	S
115vac to 12vdc converter	15 amp	15 amp
115vac outlets	9	7
Outside drain	S	S
Stepperlite™	S	S
4-way ventilation	S	S
Clear vinyl windows	4	3
Trailer length open	23' 7 1/2"	25' 3"
Living area (square feet)	138	150
Interior height open	79"	79"
Overhead dome lights	5	4
Drapes w/sheers	S	S
Floor covering	S	S
Power exhaust roof vent 14" x 14"	S	S
Hot/cold mixer faucet	S	S

	Savannah	Tara
DINING FEATURES:		
Dometic 211 3-way refrigerator	S	S
Full galley w/storage	S	S
Porcelain 3-burner stove	S	S
Cover	S	S
Sink	14" x 14" bowl	14" x 14" bowl
Dinette table/free standing	33" x 48"	30" x 36"
SLEEPING:		
Sleeping capacity	6	7
Mattress size front	51" x 75"	74 x 75"
Mattress size rear	51" x 75"	51" x 75"
Mattress thickness	4"	4"
Dinette size	51 1/2" x 77"	36 1/2" x 74 1/2"
Vinyl covered canvas over bed ends	S	S
Bed end moisture barrier	S	S
STORAGE FEATURES:		
20# gas bottle & regulator	S	S
Tub/shower	S	S
Hot water heater	6 gal.	6 gal.
Demand pump	S	S
Cabinet storage (cubic feet)	49.8	35.8
Portable toilet	S	S
Bathroom	S	S
Drawers	7	5
Wardrobe	S	S
Break-away device	S	S
S—Standard equipment		
Due to continuing improvements, The Coleman Company, Inc. reserves the right to make changes in prices, color, material specifications and models at any time without notice. Camping and trailer equipment shown in product photography or illustrations may be optional at additional costs. Consult your Coleman dealer.		