

FIND YOUR PLACE IN THE SUN.

# 1983 Coleman Folding Camping Trailers



WE HAVE A BRIGHT REPUTATION FOR QUALITY.

## Comfort, Luxury and Coleman Quality Throughout

The all new Royale™ gives you 19'-6" of wide open space, with a beautifully designed and well-equipped interior worthy of its name.



**The Coleman experience—  
our bright reputation for quality.**

It all began over 80 years ago with a man named W.C. Coleman, a school teacher and part-time salesman, who had a product he believed in—the Coleman® Arc Lamp—and a business philosophy based on quality, service and customer satisfaction.

"Nothing is really sold until it is delivering a satisfactory service for the user," W.C. was fond of saying. It's a conviction that has served the Coleman Company well since 1900.

Today, our bright reputation for quality is recognized throughout the world. And nowhere is that quality more evident than in our 1983 line of Coleman® Folding Camping Trailers.

**A Coleman trailer is a good  
investment.**

With a Coleman trailer you can share adventures and fun just about anywhere; you can travel and camp in style...and for less.

A 1983 Coleman Folding Camping Trailer, equipped with cooking and sleeping facilities, soon pays for itself, saving you the high cost of restaurants and hotels. Moreover, Coleman quality assures years of dependability and a high resale value.

**Easy to set up, easy to tow.**

Lift system equipped with heavy gauge no-rust stainless steel lifter arms and aircraft-type cable—strongest in the industry—enables a quick, reliable set-up.

On the road, a wide-track wheel base and heavy-duty suspension provide safe, smooth towing. Additional features such as lightweight construction and a streamlined, low-profile design permit even compact cars to tow a Coleman trailer without straining your fuel budget.

**Ten new models**

The quality features that made Coleman the #1 choice of American consumers have been improved even further. In terms of overall value, the ten new 1983 models highlighted here are the best ever.





The 1983 Williamsburg™

# Jamestown™ and Jamestown LTD™

Two great ways to get off the ground with comfort and economy.

- opens to 12'-4"
- sleeps up to four
- 685 lb. curb wt.
- 765 lb. curb wt. (LTD)

- stainless steel lift arms
- crank-up lift system
- 51" x 72" double bed
- Jamestown LTD includes a complete galley, with gas bottle and regulator and portable five-gallon water tank.

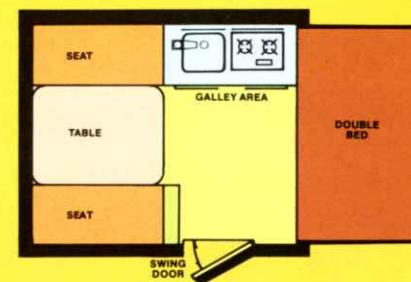

# Columbia™

Our family-sized economy model—that's big on comfort.

- opens to 17'-6"
- sleeps up to six
- convenient 35" galley height

- 6'-5" interior height
- two 51" x 72" double beds
- 860 lb. curb wt.
- stainless steel lift arms
- crank-up lift system

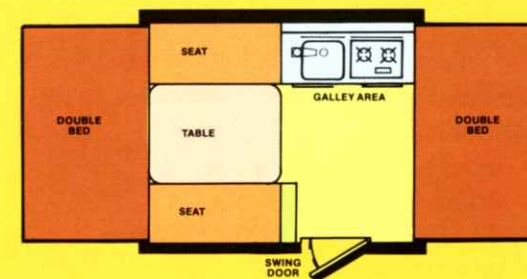

# Colonial® and Colonial XL®

Deluxe campers that go great with today's compact cars.

- Colonial opens to 15'-10"; sleeps up to five
- Colonial XL opens to 17'-6"; sleeps up to six
- built-in 10-gallon water tank

- porcelain sink and stove
- 855 lb. curb wt. for Colonial; 875 lb. curb wt. for Colonial XL
- wing bed moisture barrier
- 45" low-towing profile
- Dotted line shows XL bed size.

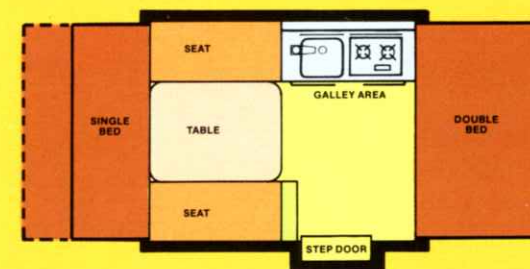

# Sun Valley™

Its full-size interior and light weight make camping affordable family fun.

- opens to 19'-4"
- deluxe six-sleeper
- chest of drawers

- galley countertop work area
- three-burner range
- 895 lb. curb wt.
- 4" mattress thickness

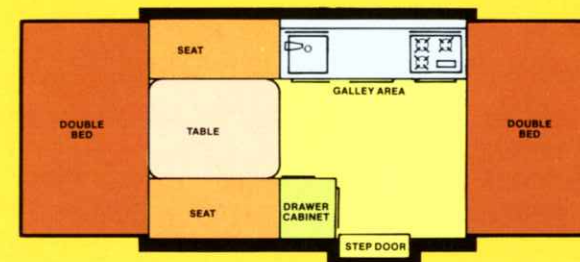

# Royale™

Spacious accommodations—with the feel for the majestic.

- opens to 19'-4"
- deluxe six-sleeper
- three-burner, chrome-finish range
- queen-size bed
- front cabinet storage area
- 895 lb. curb wt.
- stainless steel sink

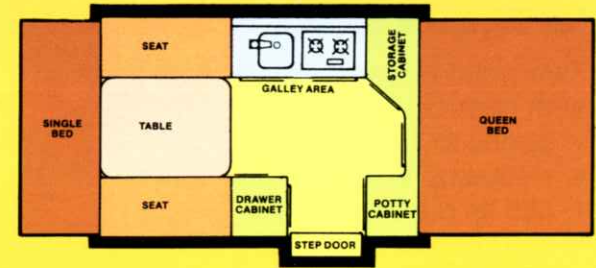

# Shenandoah™

Elegant dining for six with plenty of elbow room.

- opens to 21'-4"
- deluxe seven-sleeper
- 63" dinette; seats six or more
- wardrobe rack
- potty storage cabinet
- three-way cooler
- chest of drawers
- 1220 lb. curb wt.

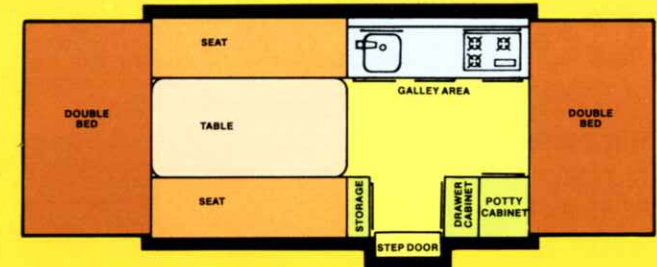

# Sequoia™

Bringing the family together in style.

- opens to 23'-4"
- sleeps up to seven
- large galley countertop work area
- front cabinet storage area
- queen-size bed
- 1220 lb. curb wt.

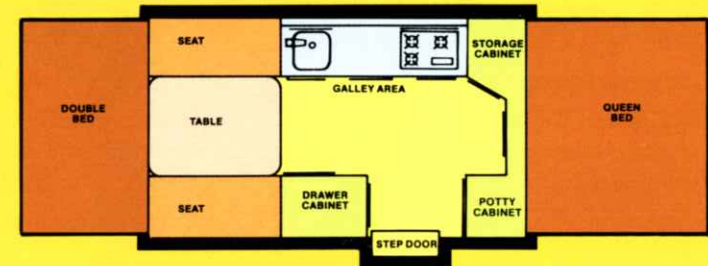

# Williamsburg™

All the comforts of home...away from home.

- opens to 23'-4"
- sleeps up to seven
- one-piece queen-size bed
- hot water heater
- portable toilet
- electric water pump
- built-in 18-gallon water tank
- tub and shower
- new Evolution™ 3 tent fabric is strong, lightweight, mildew-resistant, and breathable for less humidity.
- 1340 lb. curb wt.

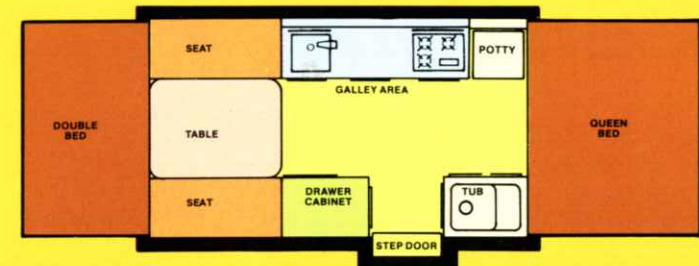



**Great indoors made for the great outdoors.**

New 1983 fabrics and colors have Coleman campers looking better than ever. And Coleman's exclusive Conestoga™ wingbed

design provides excellent four-way ventilation, as well as 36" of headroom over the beds.



**The Sequoia™**—a rich interior with lots of features that count; offers 59 cubic ft. of storage space and a large work area.



**The Shenandoah™**—elegant surroundings that include a wardrobe rack, a chest of drawers and a large dinette that seats six.

# Coleman stands alone in quality and feature attractions.



All 1983 Coleman camping trailers come equipped with a strong insulated top, strong enough to hold an air conditioner, insulated to reflect summer heat and help keep the interior cool. Closer to the ground, Coleman features styled wheel wells for easy tire removal. The tires themselves are engineered to each model for optimum performance. Optional 12" tires are also available for those back country roads. Other standards such as double wall construction, heavy-duty suspension and a 3" box beam steel frame give every 1983 Coleman the rugged durability needed for a long life on and off the road.

1. 35" galley counter height—just like home
2. fully equipped kitchen
3. soil-resistant, easy-to-clean fabric (Olefin)
4. nylon rollers for smooth operation of sliding beds
5. beautiful wicker-look cushioned-vinyl floor covering
6. undercoated one-piece floor
7. hard-backed dinette cushions
8. free-standing removable dinette table
9. one-piece aluminum screen door (not shown)
10. Stepper™ door
11. permanently attached self-storing wing bed supports
12. aluminum side panels—rust-free and lightweight
13. styled and open wheel wells

14. stainless steel lifter arms—won't rust or bind
15. swing-up dolly wheel—permanently attached
16. 3" box beam frame for strength and reliability
17. self-storing Posilok stabilizer supports
18. wing beds with full perimeter aluminum frame

The following features are standard on most models:

19. high-density 4" mattresses for a good night's sleep
20. 12-volt converter
21. ABS front and rear panels— aerodynamic styling and lighter weight
22. moisture barrier around bed and canvas (not shown)



# Check These Outstanding Coleman Features

Use this list to help find the Coleman that's right for you.\*

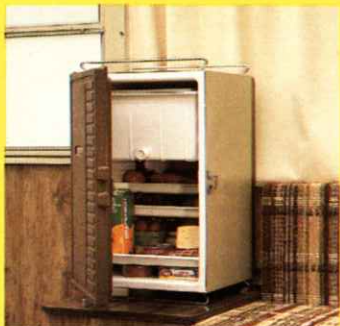

❑ **1. Coleman Convertible™ 3-Way Cooler**—portable 68-quart ice chest with urethane insulation—will keep ice so long it'll spoil! Standard on deluxe models.



❑ **2. 36" bed height area**—Coleman's exclusive bed bow and canvas support system allows a tall person to sit up in bed without hitting his/her head; standard on all models.



❑ **3. Attached bed supports**—permanently attached, easy to store, so they can't get lost; standard on all models.



❑ **4. Self-storing Posilok stabilizer**—securely levels camper on uneven terrain; standard on all models.



❑ **5. Brass city-water hook-up**—standard on all models except Jamestown.™

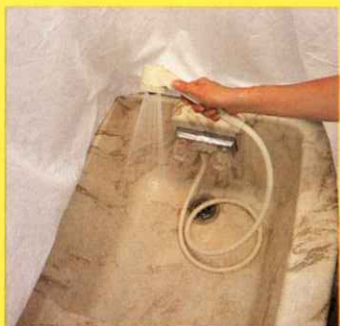

❑ **6. Shower/tub**—includes a built-in 18-gallon water tank, electric water pump and hot water heater; standard on Williamsburg.™



❑ **7. Self-Storing Stepper™ door**—the exclusive, sturdy Coleman step that folds up and features a dead bolt lock for security; standard on all but Jamestown and Columbia™ models.



❑ **8. One-piece screen door with outside light**—outside light provides nighttime convenience; insectproof and weathertight aluminum screen door opens easily and locks.



❑ **9. Wardrobe rack**—enables you to hang clothes out of the way; standard on Shenandoah,™ Sequoia™ and Williamsburg, optional on all others.



❑ **10. Double needle stitching and fine mesh screening**—double stitching for double strength on canvas seams; fine mesh screening lets air in, keeps insects out; standard on all models.



❑ **11. Electrical outlets**—115-volt AC; standard on all models except Jamestown and Jamestown™ Ltd.



❑ **12. Stainless steel lifter arms with aircraft-type cable**—Exclusive steel needle-bearing pulleys provide years of dependable service; standard on all models.



❑ **13. Swing-up dolly wheel**—wheel permanently attached to prevent loss or damage—easy and convenient to use.



❑ **14. Chest of drawers**—featured on Sun Valley,™ Royale,™ Shenandoah, Sequoia and Williamsburg.



❑ **15. 63" dinette**—extra-large dinette that seats six or more; featured on Shenandoah.

\*Features are on selected models. See specification page for model feature comparison.

# Coleman accessories go the "extra" mile.



**1. Boat/luggage rack**—enables trailer to carry a boat, canoe or extra luggage; distributes weight evenly over the trailer.



**2. Furnaces**—12,000 and 16,000 BTUs; thermostatically controlled, forced-air units.



**3. Bicycle rack**—mounts on rear of trailer and holds two bicycles; removable when not in use.



**4. Electric lift**—battery-operated motor electrically raises and lowers the roof.

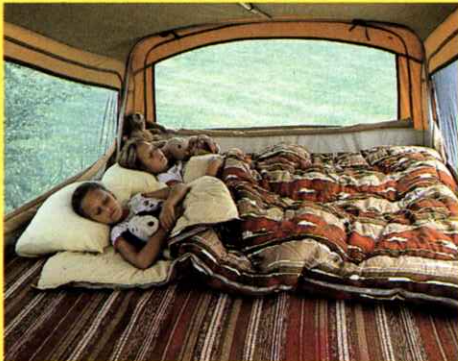

**5. Slumber pak**—one Coleman double sleeping bag and two pillows made to fit a Coleman double bed.



**6. Heavy-duty storage bumper**—for added trailer protection, choose a split bumper or the one-piece storage bumper.



**7. AC/DC portable refrigerator**—makes ice cubes and goes anywhere.



**8. Stove bracket, stove and grille**—attaches to the outside of the trailer for convenient outdoor cooking.



**9. Air conditioner**—roof-mounted, keeps trailer cool and comfortable on those hot, humid days.

**10. Refrigerator**—keeps food fresh and eliminates ice worries; operates on AC/DC or LP gas.



**11. Dressing room cabana**—attaches to camper; ideal for changing clothes at the beach, or for an optional self-contained toilet.



**12. Canopy and screened room combination**—self-storing canopy extends living area. Add-on screened family room attaches easily to canopy.



**13. Gas bottle cover**—protects your propane supply and container from the elements.

**14. Spare tire cover**—protects spare tire from weather while enhancing overall trailer appearance.

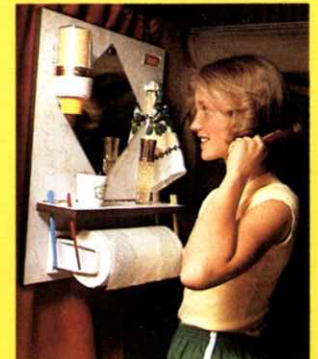

**15. Vanity board**—features large mirror, shelf, paper towel rack, cup dispenser and toothbrush holder.

## A safe, easy, economical tow

Low profile and wide-track design make Coleman® Folding Campers ideal for the cars of the 80's.



## We have a bright reputation for quality.

From the basic economy of the Jamestown™ to the big comfort and convenience of the Williamsburg™, there's a 1983 Coleman Folding Camping Trailer that's just right for you.

At your service is an extensive experienced Coleman dealer network that stretches across the U.S, into Canada and even overseas.

Wherever you see the Coleman name, you can be assured of one thing: good value for your money. That's a promise we've kept for over 83 years.



# Specifications

	Models	Jamestown™	Jamestown™ Ltd.	Columbia™	Colonial®	Colonial® XL	Royale™	Sun Valley™	Shenandoah™	Sequoia™	Williamsburg™	
<b>Constr. Facts:</b>	Insulated hard top	S	S	S	S	S	S	S	S	S	S	
	3 inch tubular steel frame	S	S	S	S	S	S	S	S	S	S	
	Spare tire mount	0	0	0	S	S	S	S	S	S	S	
	Fire-retardant 10.1 army duck canvas tent	S	S	S	S	S	S	S	S	S	0	
	Fire-retardant Evolution™ 3 tent	—	—	—	—	—	—	—	—	—	S	
	Baked-on enam. alum. side pnls.	S	S	S	S	S	S	S	S	S	S	
	Hi-impact ABS frt. & rear panels (built-in rock shield)	—	—	—	S	S	S	S	S	S	S	
	Split bumper	0	0	0	0	0	0	0	0	0	0	S
	Road height (in.)	44	44	44	45	45	45	45	47	47	47	47
	*Hitch weight (lbs)	90	105	100	105	100	105	100	120	120	120	120
	*Curb weight (lbs)	685	765	860	855	875	895	895	1220	1220	1340	1340
Trailer size (closed)	6'8" x 11'3"	6'8" x 11'3"	6'8" x 11'3"	6'8" x 11'3"	6'8" x 11'3"	6'8" x 12'11"	6'8" x 12'11"	6'8" x 14'11"	6'8" x 14'11"	6'8" x 14'11"	6'8" x 14'11"	
<b>Towing Facts:</b>	Electric brakes	0	0	0	0	0	0	0	0	0	S	
	Sliding leaf spring suspension	S	S	S	S	S	S	S	S	S	S	
	Safety chains & 1½" ball coupler	S	S	S	S	S	S	S	S	S	S	
	Tire size 4.80 x 8	S	S	S	—	—	—	—	—	—	—	
	Tire size 5.70 x 8	0	0	0	S	S	S	S	—	—	—	
	Tire size 20.5 x 8 x 10	0	0	0	0	0	0	0	S	S	S	
	Hub caps	0	0	0	0	0	0	0	S	S	S	
	<b>Set-up Facts:</b>	Waist level crank position	—	—	—	S	S	†	†	†	†	†
		One-piece swing-up tongue jack	S	S	S	S	S	S	S	S	S	S
		Attached stabilizers	2	2	2	4	4	4	4	4	4	4
		Alum. one-piece screen door	S	S	S	S	S	S	S	S	S	S
Self-storing Stepper™ door w/dead bolt lock		—	—	—	S	S	S	S	S	S	S	
Attached bed supports		S	S	S	S	S	S	S	S	S	S	
<b>Living Features:</b>		25' 12-volt auto extension cord	S	S	S	0	0	0	0	0	0	0
		Brass pressure city-water hookup	—	S	S	S	S	S	S	S	S	S
		115 VAC to 12 VDC Converter	—	—	3 AMP	6 AMP	6 AMP	6 AMP	6 AMP	6 AMP	6 AMP	15 AMP
		115-volt AC outlets	—	—	2	3	3	3	3	3	3	3
		Outside sink drainage system	—	S	S	S	S	S	S	S	S	S
	Patio light	—	—	—	S	S	S	S	S	S	S	
	Bright annealed stainless steel telescoping lifts	S	S	S	S	S	S	S	S	S	S	
	4-way screened ventilation	S	S	S	S	S	S	S	S	S	S	
	Clear vinyl storm window(s)	S	S	S	S	S	S	S	S	S	S	
	Trailer length (open)	12'4"	12'4"	17'6"	15'10"	17'6"	19'4"	19'4"	21'4"	23'4"	23'4"	
	Living area (Ft²)	68	68	94	83	94	106	104	117	129	129	
Interior height (open)	6'5"	6'5"	6'5"	6'5"	6'5"	6'5"	6'5"	6'5"	6'5"	6'5"		
Overhead dome lights	1	1	1	2	2	2	2	2	2	2		
Vinyl-lined drapes w/tie backs	0	0	0	S	S	S	S	S	S	S		
Cushioned-vinyl floor covering	S	S	S	S	S	S	S	S	S	S		

	Models	Jamestown™	Jamestown™ Ltd.	Columbia™	Colonial®	Colonial® XL	Royale™	Sun Valley™	Shenandoah™	Sequoia™	Williamsburg™
<b>Dining Features:</b>	Towel racks	—	1	1	1	1	2	2	2	2	2
	Coleman ice box	0	Chest	Chest	Chest	Chest	3-Way 68 Qt.	3-Way 68 Qt.	3-Way 68 Qt.	3-Way 68 Qt.	3-Way 68 Qt.
	Flip-up galley with permanent storage	—	S	S	S	S	S	S	S	S	S
	2-burner range	—	Brushed Chrome	Brushed Chrome	Porcelain	Porcelain	—	—	—	—	—
	3-burner range w/permanent cover	—	—	—	—	—	Brushed Chrome	Brushed Chrome	Porcelain	Porcelain	Porcelain
	Sink	—	Stainless Steel	Stainless Steel	Porcelain	Porcelain	Stainless Steel	Stainless Steel	Porcelain	Porcelain	Porcelain
	Dinette table (portable)	30 x 39 S	30 x 39 S	30 x 39 S	30 x 39 S	30 x 39 S	30 x 39 S	30 x 39 S	30 x 56 S	30 x 39 S	30 x 39 S
	20# gas bottle and regulator	—	S	S	S	S	S	S	S	S	S
	Built-in water tank w/fill spout	—	—	—	10 Gal.	10 Gal.	10 Gal.	10 Gal.	10 Gal.	10 Gal.	18 Gal.
	Portable water tank (5 gal.)	—	5 Gal.	5 Gal.	—	—	—	—	—	—	—
	Tub & shower	—	—	—	—	—	—	—	—	—	S
Hot water heater	—	—	—	—	—	—	—	—	—	S	
Elec. water pump	—	—	—	0	0	0	0	0	0	S	
Cabinet storage (cubic feet)	20	26	26	26	26	41	37	48	50	36	
Portable toilet	0	0	0	0	0	0	0	0	0	S	
Portable toilet storage	—	—	—	—	—	Cabinet	Area	Cabinet	Cabinet	Area	
Wardrobe rack	0	0	0	0	0	0	0	S	S	S	
Drawers	—	—	—	—	—	3	3	5	3	3	
<b>Sleeping</b>	Sleeping capacity	4	4	6	5	6	6	6	7	7	7
	Mattress size (in.)	51 x 72	51 x 72	51 x 72	51 x 72	51 x 72	75 x 72	51 x 72	51 x 72	75 x 72	75 x 72
	Mattress thickness (in.)	3	3	3	3	3	4	4	4	4	4
	Convertible dinette bed size (in.)	40 x 73	40 x 73	40 x 73	40 x 73	40 x 73	40 x 73	40 x 73	60 x 73	40 x 73	40 x 73
	Vinyl-covered canvas over beds	S	S	S	S	S	S	S	S	S	S
	End bed moisture barrier	—	—	—	S	S	S	S	S	S	S

S—standard equipment; 0—optional. \*As shipped less optional accessories. †Two positions with ratchet. Weights are plus or minus 3%.

Due to continuing improvements, The Coleman Company, Inc. reserves the right to make changes in prices, color, material specifications and models at any time without notice. Camping and trailer equipment shown in product photography or illustrations may be optional at additional costs. Consult your Coleman dealer.



**CAMPING TRAILERS**

The Coleman Company, Inc.  
Camping Trailer Division  
Somerset, PA 15501

Copyright © 1982 The Coleman Company, Inc.

Form No. CFL1982-10/82 Litho in U.S.A.

