



Can Am X3 Quick Shift Race Plate

(Part #51-270010)

DISCLAIMER

The purchaser understands, recognizes, and agrees that the suitability of any part sold or manufactured by Lone Star Racing for a particular application is the purchaser's decision and that the purchaser is not relying on the skill or judgment of Lone Star Racing regarding suitability of any product or service. Prices and product designs are subject to change without notice. All parts manufactured by Lone Star Racing have a one year limited warranty against defects in material and workmanship unless otherwise specified. Liability is limited to repair or replacement of the defective parts to the original purchaser only. This warranty shall not apply to any product which has been repaired or altered in any way so as in our judgment to affect its performance, including those parts that have been subject to misuse, abuse, negligence or any other occurrence beyond the control of Lone Star Racing. Lone Star Racing reserves the right to determine if claims are legitimate. We do not warranty moving parts such as ball joints, bearings, or bushings. Lone Star Racing is not liable for consequential damage or injury due to the use or misuse of any product built or sold by Lone Star Racing.

The illustrations in this document show typical construction of the different assemblies and may not reproduce the full detail or exact shape of the parts; however, they represent parts that have the same or similar function.

WARNING

- **This instruction sheet MUST be given to the purchaser.**
- Read and understand these instructions before installing product
- This product does not provide additional roll over protection
- This product is not intended as an anchor point for pulling
- Do not use product if there are any signs of damage
- Factory torque wrench tightening specifications must strictly be adhered to.
- Some components may be HOT. Always wait for engine to cool down before performing work.
- Always wear EYE PROTECTION AND APPROPRIATE GLOVES when using power tools.
- Unless otherwise specified, engine must be OFF when performing any operation on the vehicle.
- Always be aware of parts that can move, such as wheels, transmission components, etc.



Parts Included:

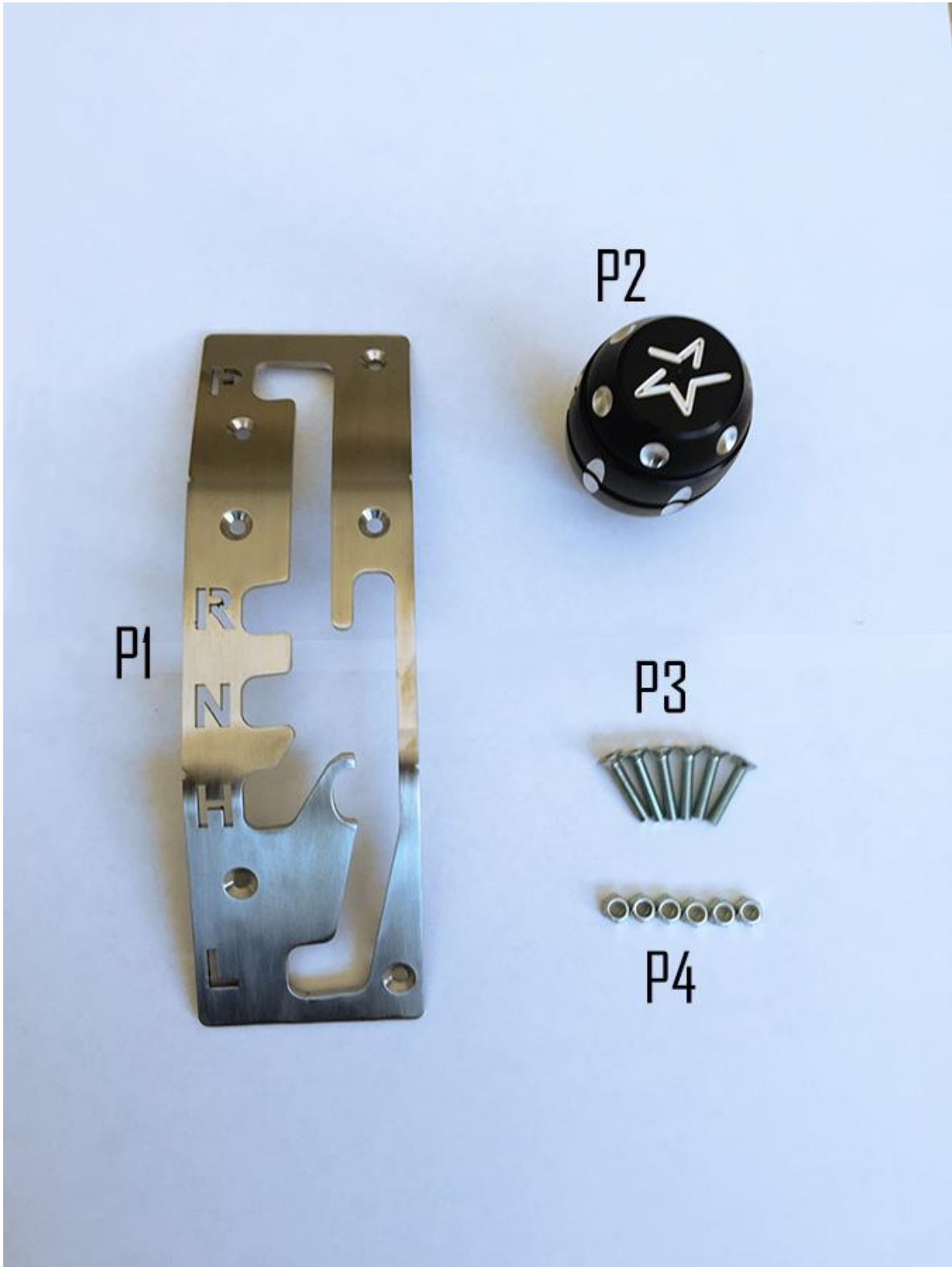



#	Description	Quantity
P1	Shift Plate	1
P2	Shift Knob	1
P3	M4 x .7 x 20 Flat Head Bolts	6
P4	M4 x .7 Nylon Locknuts	6

Installation notes:

- Use a T30 Torx socket to remove the 6 bolts holding down the front center console then slide off grab handle and unthread shift knob.(fig 1-1)



Figure 1-1



- On 4 seat models you must remove rear portion of center console. Start by removing 3 Torx bolts.(fig 2-1)



Figure 2-1

- On 2 and 4 seat models remove plastic push pins in rear of center console.(fig 3-1)



Figure 3-1

- Remove plastic piece by pulling side panels away from upper piece. Then on 4 seat model you must remove the 5 Torx bolts(2 on each side, 1 on top) holding down the center console.(fig 4-1)

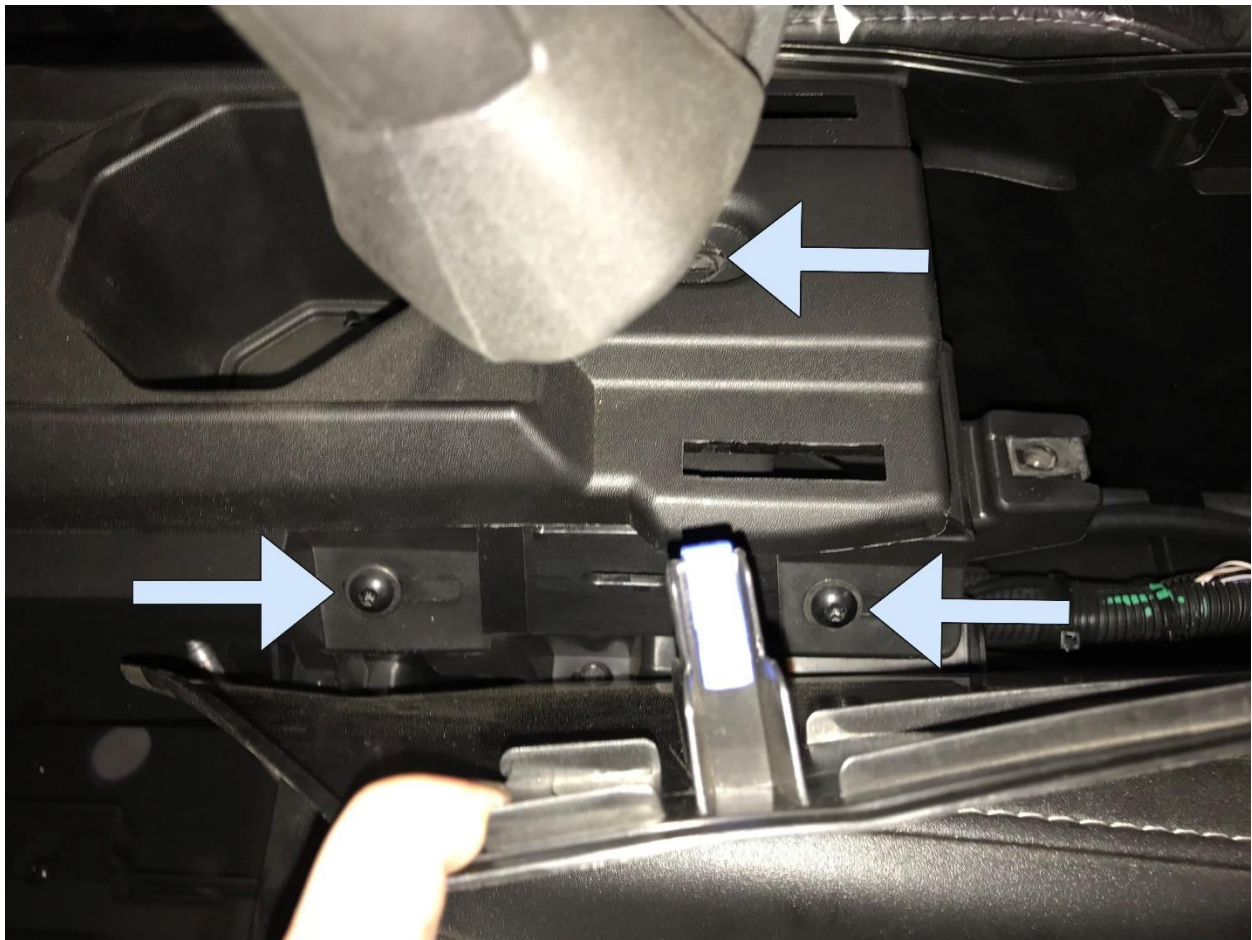

Figure 4-1

- Remove center console by sliding forward and up. Then unbolt shifter gate by removing 3 bolts.(fig 5-1)

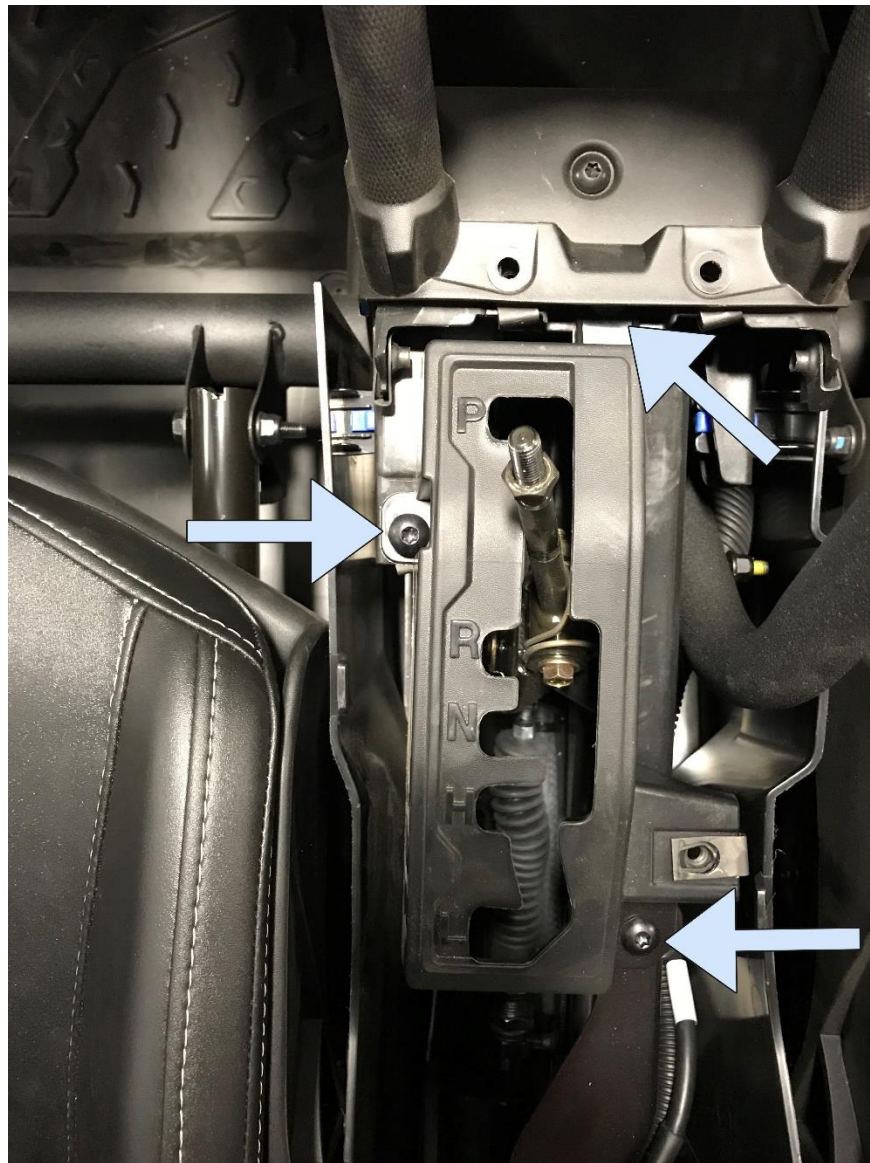

Figure 5-1

- Clamp shift plate to shift gate making sure the left edges align.(fig 6-1)



Figure 6-1

- Drill holes in shift gate starting at top. After you drill a hole insert a bolt and double check the plate is still aligned. Once you have drilled all holes and inserted the bolts you can mark the area of the shift gate that needs to be cut off.(fig 7-1)



Figure 7-1

- Remove bolts and shift plate. Using a grinder or cut off wheel you can cut off the areas you previously marked. It is ok to trim a little more than marked since it will not show under the plate.(fig 8-1)



Figure 8-1

- Bolt plate onto shift gate and tighten. Now you can assemble everything in the reverse order of disassembling. Once everything is in place install the shift knob by threading on and tightening jam nut below.

