

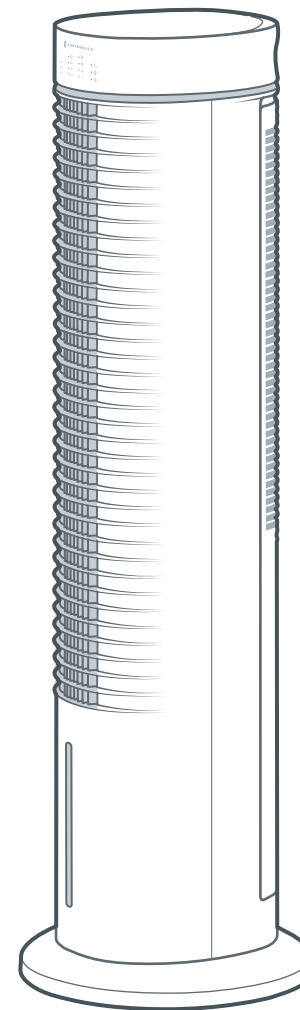

AIR COOLER



TT-TF008
User Manual

TAOTRONICS

Questions or Concerns?
support@taotronics.com

THANK YOU

FOR BEING OUR CUSTOMER



Your purchase is truly appreciated!
We hope you are over-the-moon with our product!

CONTENTS

IMPORTANT SAFETY INSTRUCTIONS	02
KNOWING YOUR AIR COOLER	04
USING YOUR AIR COOLER	08
CLEANING AND MAINTENANCE	15
TROUBLESHOOTING	18

01

IMPORTANT SAFETY INSTRUCTIONS

Cooling and
Humidifying Air In
Your Living Room



DANGER

BEFORE USING THIS APPLIANCE READ ALL INSTRUCTIONS AND CAUTIONARY MARKINGS IN YOUR USER MANUAL AND ON THE APPLIANCE



DO NOT touch or hold the mains plug with wet hands.

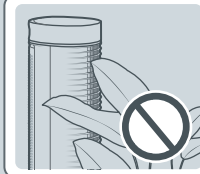

DO NOT block or cover air flow to or from the Fan while in operation.

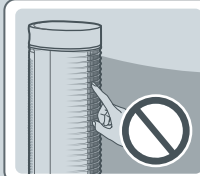

DO NOT insert fingers or objects through the grille while in operation.

INTENDED USE

- This appliance is not intended for use by persons (including children) with reduced physical, sensory or mental capabilities, or lack of experience and knowledge, unless they have been given supervision or instruction concerning the use of the appliance by person responsible for their safety.
- Close supervision is necessary when any appliance is used by or near children. Children should be supervised to ensure that they do not play with the appliance. Cleaning and user maintenance shall not be done by children unless they are older than 8 and supervised.
- Use the appliance only for intended household purposes as described in this User Manual. Any other use is not recommended that may cause fire, electric shock, or injury to persons.

RELATED TO USE

- DO NOT use this Fan to ventilate areas where flammable liquids or vapors are used, stored or are present.
- DO NOT attempt to disassemble, repair, modify or replace any part any part of your product. All servicing should be performed by qualified personnel only.
- Always make sure to place the Fan on a flat, level surface before operation.
- Keep the cord out of heavy traffic areas and where it will not be tripped over. To avoid fire hazard, NEVER route cord under furniture or appliances.
- Always unplug the appliance before cleaning, making any repairs or servicing, or whenever not in use.
- It is normal that there is noise during operation. If too loud, please set the fan to lower speed.

ELECTRICITY SAFETY

- This appliance must be provided with correct voltage via a professionally installed power socket. Make sure the voltage indicated on the label of the appliance is the same as your local supply.
- **DO NOT** operate the fan with a damaged cord or plug or if the product malfunctions, is dropped or damaged in any manner.
- To reduce the risk of fire or electric shock, DO NOT use this fan with any solid-state speed control device.
- **IMPORTANT** - This appliance has a polarized plug (one blade is wider than the other). To reduce the risk of electric shock, this plug is intended to fit in a polarized outlet only one way. If the plug does not fit fully in the outlet, reverse the plug. If it still does not fit, contact a qualified electrician. Do not attempt to rig this safety feature.
- This product employs overload protection (fuse). A blown fuse indicates an overload or short-circuit situation. If the fuse blows, unplug the product from the outlet. Replace the fuse according to the instructions in this manual (follow product marking for proper fuse rating) and check the product. If the replacement fuse blows, a short-circuit may be present and the product should be discarded or returned to an authorized service facility for examination and/or repair.

FOR HOUSEHOLD USE ONLY

SAVE THESE INSTRUCTIONS



Regular Check

HAVE YOUR AIR COOLER CHECKED REGULARLY FOR ANY SIGN OF MALFUNCTION!

Check if Plug, cord or appliance is damaged

Stop using, check FAQ and contact TaoTronics Support Team.

SPECIFICATIONS

Model	TT-TF008
Input	120V~ 60Hz
Rated Power	65W
Max Cap. Of Water	6L / 1.5 Gallon
Max Oscillation	80°

02

KNOWING YOUR AIR COOLER

Cooling and Humidifying Air In Your Living Room

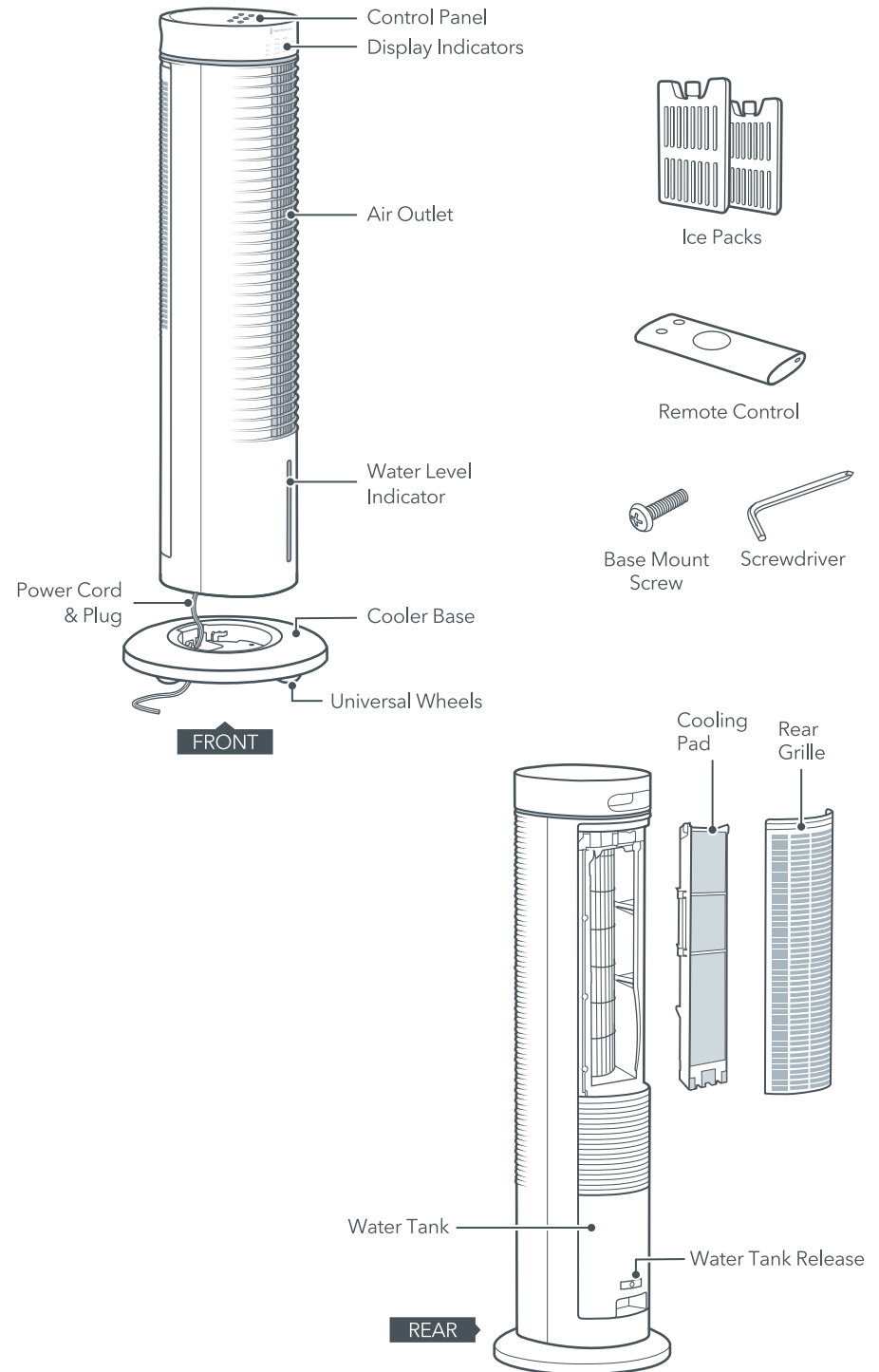

Control Panel



Cooling / Humidifying

Press to turn on or off cooling / humidifying.



Auto ON/OFF Timer

- Short press to select 1-15h timer (Hold to quickly skip to desired timer).
- To cancel, press to timer indicator off.



Fan Mode

Press to select Normal / Natural / Sleep mode.



Oscillation

Press to start or stop oscillating.



Power ON/OFF

Turn on/Standby mode.



Fan Speed

Press repeatedly to cycle through 4 speed levels.

LED Display

The LED display panel features a grid of icons and buttons. At the top, there are three rows of icons: a water drop, a clock, and a fan speed icon; a water drop, a warning sign, and a fan speed icon; and a circular arrow, a fan speed icon, and a fan speed icon. Below these are four columns of buttons: 'Cooling / Humidifying' (water drop icon), 'Low Water Protection' (warning sign icon), 'Oscillation' (circular arrow icon), and 'Timer' (1h~8h text). Below these are four columns of buttons: 'Fan Speed' (fan speed icon), 'Sleep Mode' (moon icon), 'Natural Mode' (palm tree icon), and 'Normal Mode' (fan speed icon). At the bottom, there is a warning icon and the text '1-15h timer is displayed cumulatively.'

Remote Control



For added convenience, the same control buttons can be found on the remote control.

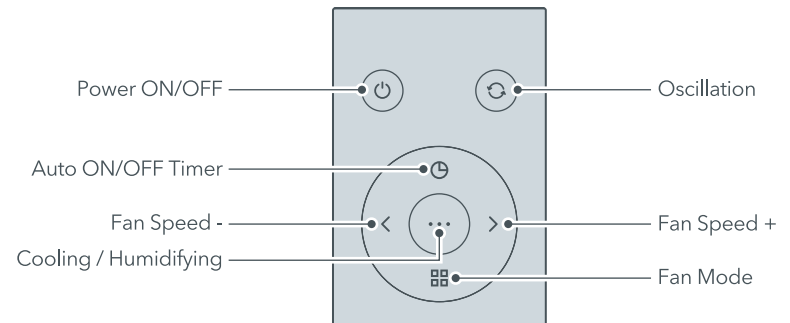

03

USING YOUR AIR COOLER

Cooling and Humidifying Air In Your Living Room

Getting the Most from Air Cooler

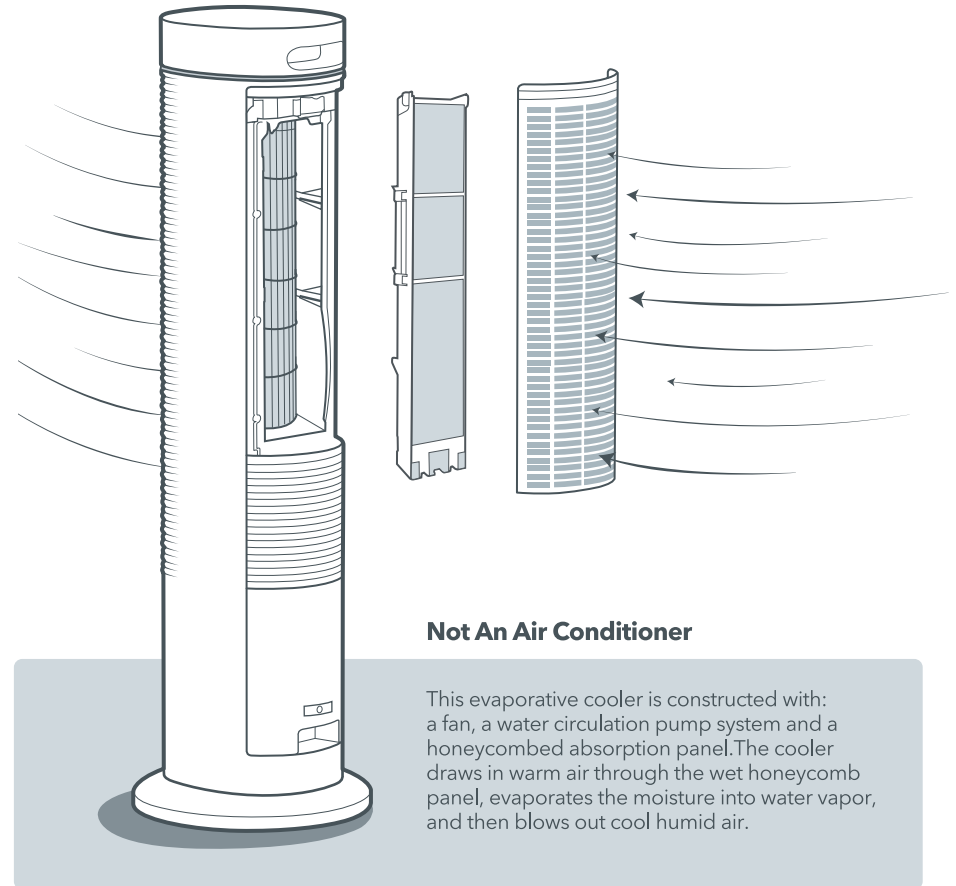

Not An Air Conditioner

This evaporative cooler is constructed with: a fan, a water circulation pump system and a honeycombed absorption panel. The cooler draws in warm air through the wet honeycomb panel, evaporates the moisture into water vapor, and then blows out cool humid air.

1

Open window or leave the door ajar for circulation of fresh and dry air.

2

Cool smaller areas such as single rooms, office cubicles and personal spaces.

3

Use with air conditioner to circulate air more efficiently in summer.

4

Use as a humidifier to add moisture in relatively dry environments.

5

Use as a tower fan without turning on Cooling / Humidifying.

Assembling the Base



DO NOT operate the air cooler without base properly installed in place.

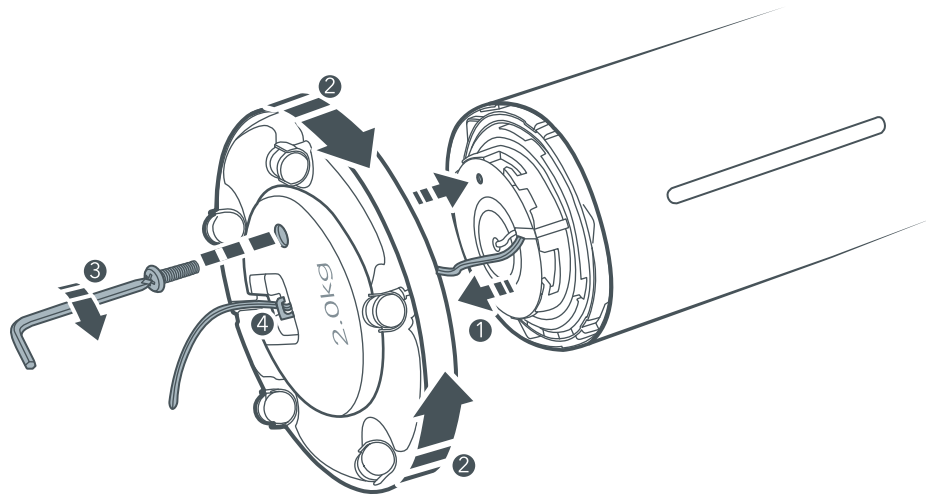

- 1 Run the power cord through the threading hole of the unassembled base.
- 2 Align with the sliding slot on the base. Rotate clockwise to install onto the body.
- 3 Secure the base by screwing the included screw in the locating hole.
- 4 Fix the power cord to the wire clasp and straighten the cord.

Filling the Water Tank (2 Ways)

1.

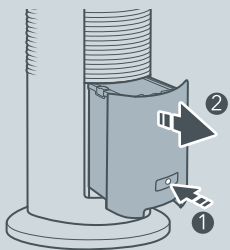

Press the Release button to pull out water tank.

2.

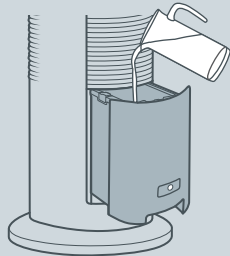

Add water into the tank (below MAX line).

3.

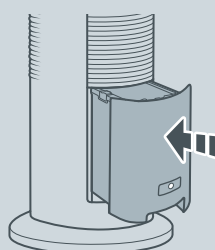

Push the water tank back in place.

Way 2

1.

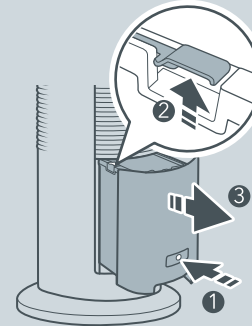

Press the Release button then pull up the Lock Catch to draw out the tank.

2.

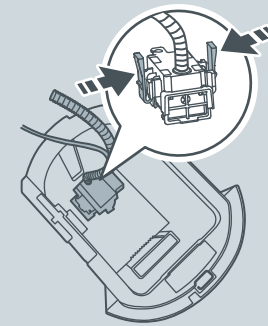

Press both sides to completely separate the water pump.

3.

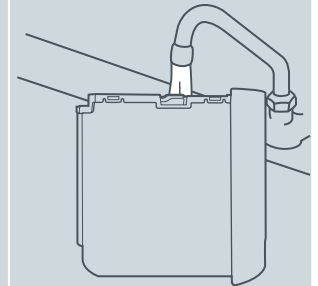

Remove the water tank and add water (below MAX line).

4.

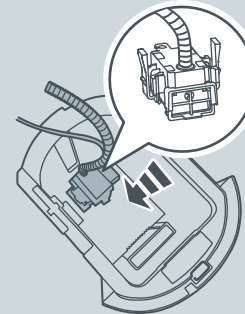

Align and lock the water pump back.

5.

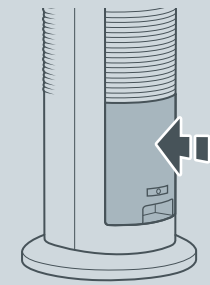

Push tank back and lock in place.

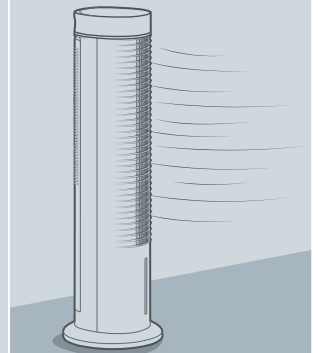

Using the Ice Pack (Optional)



The Air Cooler includes two ice packs (can be frozen repeatedly and recycled) for added cooling. Use one or both as per your needs. Turn off the unit and unplug before adding or taking out the ice packs.

1.



Freeze in the refrigerator for more than 4 hours.

2.

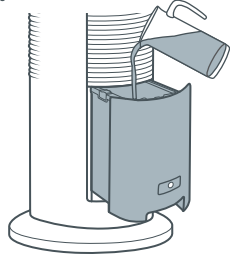

Press the release button to pull out water tank and add water (below Max line).

3.

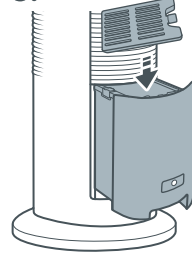

Water + ice pack shall not exceed Max line.

Add ice pack and push water tank in place.

Additional Features



Low Water Protection

When there is not enough water in the water tank or the tank is removed under Cooling / Humidifying mode, Low Water Protection will be activated with a flashing.

To reactivate Humidifying, fill water to the max level and turn on Cooling / Humidifying function again.



Indicators in 50% Brightness

If no operation is done within 40 seconds after turned on, the indicators will reduce to 50% brightness.

Press any button to exit 50% brightness.



15-Hour Auto Shut Off

When the fan has been working for 15 hours continuously without any other operation, it will shut off automatically.

Replacement of Batteries



- Replace with new batteries of the same type when replacement is required.
- When not using the remote control for a long time, please take out the batteries.
- DO NOT attempt to dismantle the batteries.
- DO NOT dispose the batteries in fire, batteries may explode or leak.
- DO NOT use rechargeable batteries.

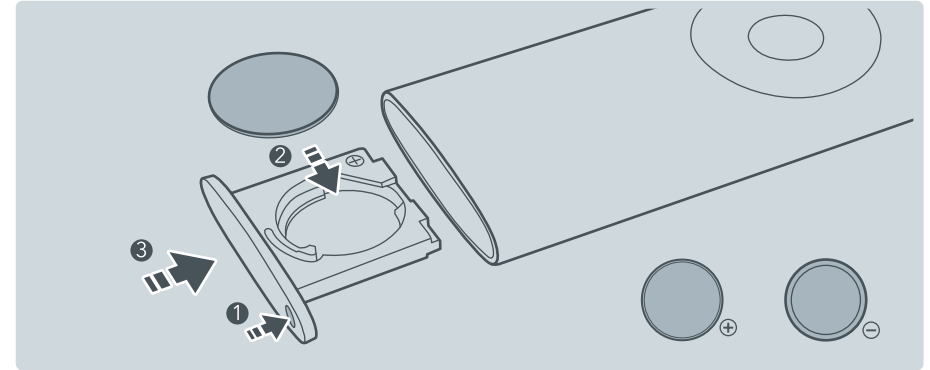

- 1 Press the locking button to remove the battery holder.
- 2 Replace the battery with the same type (CR2025, 3V), making sure the (+) side facing up.
- 3 Push in the holder until securely locked into place.



WARNING:

Chemical Burn Hazard. Keep batteries away from children.

This product contains a lithium button/coin cell battery. If a new or used lithium button/coin cell battery is swallowed or enters the body, it can cause severe internal burns and can lead to death in as little as 2 hours. Always completely secure the battery compartment. If the battery compartment does not close securely, stop using the product, remove the batteries, and keep it away from children. If you think batteries might have been swallowed or placed inside any part of the body, seek immediate medical attention.

The cells shall be disposed of properly, including keeping them away from children. Even used cells may cause injury.

Fuse Replacement



This air cooler features a fused safety plug which is designed to cut off electric current to the fan if an electrical fault occurs. If your fan loses power and you suspect that the fuse on your fan has blown,

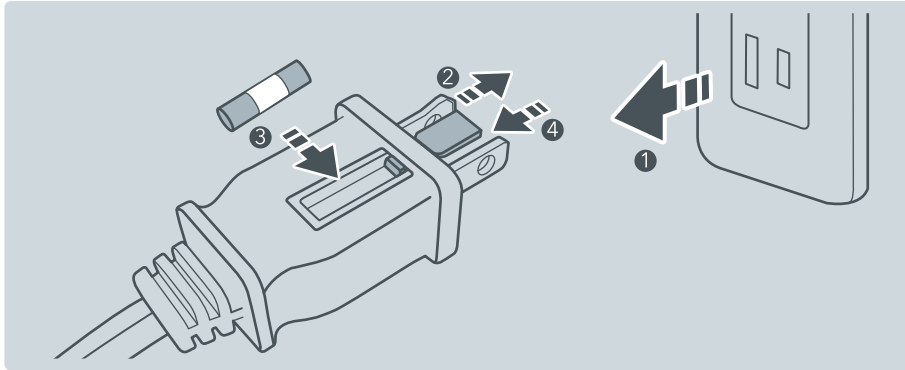

- 1 Grasp plug and remove from the electrical outlet.
- 2 Slide fuse cover, located on the top of the plug, towards the prongs of the plug.
- 3 Remove the blown fuse and snap a new fuse (2.5 Amp, 125 Volt only) into place.
- 4 Slide the cover back to close the fuse compartment.

04

CLEANING AND MAINTENANCE

Cooling and
Humidifying Air In
Your Living Room



- Always make sure the Air Cooler is turned off and unplugged before cleaning.
- DO NOT stick any foreign objects or your fingers inside of the unit.
- Never immerse in water or allow water to drip into the motor housing.
- DO NOT clean with abrasive chemicals or flammable cleaning agents.

Cleaning

Outer Surface

- Wipe with a soft, dry cloth. If necessary, wipe with a damp cloth.
- Completely dry before reconnecting to a power source.

Rear Grille & Cooling Pad



- To prevent from becoming clogged with dust and other buildup, we recommend that it be cleaned at least once every two weeks.
- Completely dry and install back after cleaning.

1.

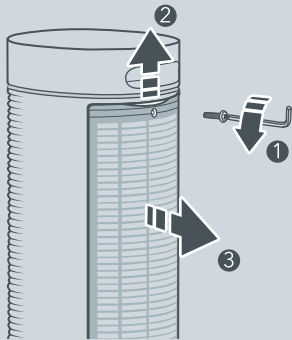

Unscrew the locking screw, pull up and remove the rear grille.

2.

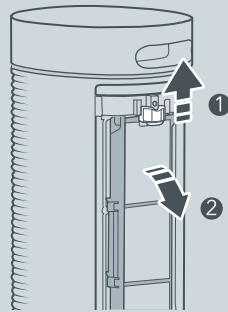

Pull up the clasp and take out the cooling pad.

3.

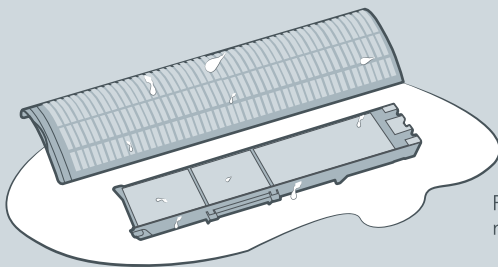

Rinse the cooling pad. Brush and rinse the rear grille.

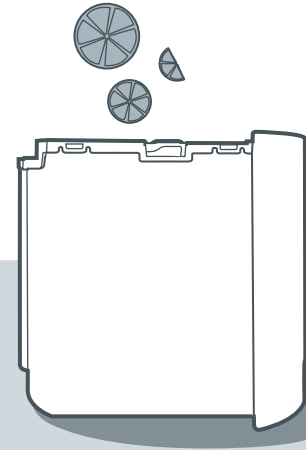

Water Tank

Empty and clean the water tank regularly to ensure hygienic use (remove hard water and mineral deposits).

1. Separate the water tank from the water pump (See "Filling the Water Tank").
2. Clean and rinse the tank. For excessive hard water buildup, clean with a diluted vinegar solution and rinse thoroughly.
3. After cleaning, lock the water pump back. Push water tank and lock in place.

Filter on Water Pump

For safety use of the water pump, remember to clean the filter on a regular basis.

1. Press both sides to separate the water pump.
2. Remove the filter on the pump and rinse with water.

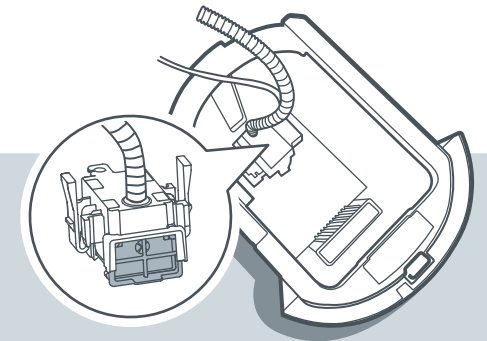

For storage, you may leave the air cooler covered to protect it from dust. Store it in a cool, dry location.

05

TROUBLE- SHOOTING

Cooling and
Humidifying Air In
Your Living Room

Excessive noise

It is normal that there is noise during operation. If too loud, please set the air cooler to lower speed.

Airflow sound

Normal sound from water pump which will not affect the cooling effect and operation.

Air cooler does not operate

- Make sure the air cooler is connected to a powered electrical outlet.
- Check that the dust filter and water tank are locked in place.

Not cool enough

- Check the water level in the tank and make sure there is enough water.
- Check that the Cooling / Humidifying function is turned on.
- Wait a few minutes for the cooling pad to be fully saturated with water after turned on.
- Not an air conditioner. The air cooler is for added cooling and humidifying than normal fan. You can use with air conditioner to circulate air more efficiently.

Water is coming out of the vents

The cooling pad may be clogged with debris. Rinse the cooling pad and dry completely.

The troubleshooting guide addresses the most common problems. If problems persist, feel free to contact the Customer Support at

support@taotronics.com 

WARRANTY AND SERVICE

Thanks for choosing TaoTronics Air Cooler.

This product is covered with TaoTronics product and labor warranty for 12 months from the date of its original purchase.

The warranty will not apply in cases of:

- Accident, misuse, or repairs performed by unauthorized personnel.
- Any unit that has been tampered with or used for commercial purpose.
- Normal wear and tear of wearable parts.
- Use of force, damage caused by external influences.
- Damage caused by non-observance of the User Manual, e.g. connection to an unsuitable mains supply or non-compliance with the instructions.
- Partially or completely dismantled appliances.
- Defects caused by or resulting from damages from shipping or from repairs, service, or alteration to the product or any of its parts that have been performed by a repair person not authorized by TaoTronics.

We can only provide after sales service for products that are sold by TaoTronics or TaoTronics authorized retailers and distributors. If you have purchased your unit from a different place, please contact your seller for return and warranty issues.

※ **Please have your invoice and order ID ready before contacting Customer Support.**

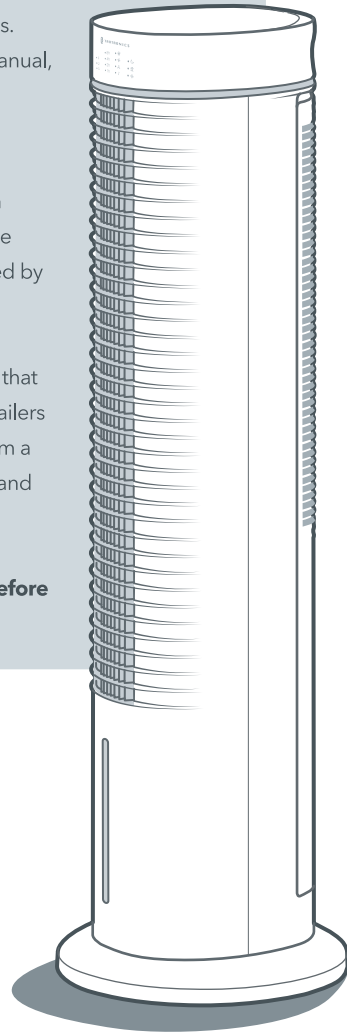



support@taotronics.com



www.taotronics.com



Manufacturer: Shenzhen NearbyExpress Technology Development Co.,Ltd.
Address: Floor 7, Building E, Galaxy World Phase II, Shenzhen, China



Intertek
3189196
MADE IN CHINA

尺寸：140*210mm

装订成册

材质：封面120克书纸 内页80克书纸