

尺寸：210*148mm

骑马钉

封面128g铜版纸，内页80g书纸

 **TAOTRONICS**
www.taotronics.com



E-mail:
support@taotronics.com

MANUFACTURER
Manufacturer: Shenzhen NearbyExpress Technology Development Co.,Ltd.
Address: Floor 7, Building E, Galaxy World Phase II, Shenzhen, China



LISTED Made in China

TT- EE015_V1.0_EN

Model: TT-EE015
TaoTronics Dehumidifier
User Guide

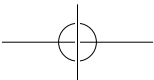

Contents

- 01** **IMPORTANT SAFETY INSTRUCTIONS**
 - 03** **ELECTRICAL INFORMATION**
 - 04** **Package Contents**
 - 05** **Product Diagram**
 - 06** **Before First Use**
 - 06** **Getting Started**
 - 08** **Operations and Functions**
 - 12** **Draining the Collected Water**
 - 18** **Cleaning and Maintenance**
 - 20** **Specifications**
 - 21** **Troubleshooting**
 - 24** **Warranty and Service**
- 

IMPORTANT SAFETY INSTRUCTIONS

**READ AND FOLLOW ALL SAFETY INFORMATION AND INSTRUCTIONS.
KEEP FOR FUTURE REFERENCE.**

FOR HOUSEHOLD USE ONLY

To prevent injury to the user or other people and property damage, the following instructions must be observed. Incorrect operation due to ignoring of instructions may cause harm or damage.

The seriousness of danger or damage is classified by the following indications.

WARNING

Indicates a potential hazard that, if not avoided, could result in death or serious injury.

CAUTION

Indicates a potential hazard that, if not avoided, may result in minor or moderate injury.

WARNING

When using electrical appliances, basic precautions should always be followed to reduce the risk of fire, electric shock, and injury to persons, including the following:

This product should be used only in accordance with the specifications outlined in this

User Guide. Usage other than what has been specified here may result in serious injury.

Read all instructions before using the appliance.

This appliance must be provided with correct voltage via a professionally installed power socket. Make sure the voltage indicated on the label of the appliance is the same as your local supply.

Do not operate or turn off the dehumidifier by plugging in or unplugging the device. Use the control panel instead.

Do not use the appliance with a damaged cord or plug or after malfunctions occur, or has been damaged in any manner.

This appliance is not intended for use by persons (including children) with reduced physical, sensory or mental capabilities, or lack of experience and knowledge, unless they have been given supervision or instruction concerning the use of the appliance by person responsible for their safety.

Do not use the dehumidifier near flammable gas or combustibles, such as gasoline, benzene, thinner, etc.

DO not use an extension cord with this appliance.

Keep the cord out of heavy traffic areas. To avoid fire hazard, NEVER put the cord under rugs, near heat registers, radiator, stoves, or heaters.

To protect against electrical hazards, do not immerse in water or other liquids.

NEVER drop or insert your finger or other foreign objects into any ventilation or exhaust opening as this may damage the product and could cause electrical shock or fire.

Do not run the power cord under carpeting, or cover it with rugs or runners. Keep the cord away from areas where it may be tripped over.

Do not route the cord under furniture or appliances. Arrange the cord away from traffic area and where it will not be tripped over.

If the unit is damaged or malfunctions, do not continue to operate it. Unplug the product from the electrical outlet. Refer to the troubleshooting section and contact the Customer Support at support@taotronics.com.

Use appliance only for intended household purposes as described in this User Guide. Any other use is not recommended that may cause fire, electric shock, or injury to persons.

Do not attempt to modify or repair the product by yourself. Only a repair technician may disassemble or repair this product.

To Reduce The Risk of Fire or Electric Shock, Do Not Use This Appliance With Any Solid-State Speed Control Device.

CAUTION

Always unplug the dehumidifier before moving, cleaning or whenever the dehumidifier is not in use.

If the supply cord is damaged, it must be replaced by the manufacturer, its service agent or similarly qualified persons in order to avoid a hazard.

Never use the appliance unless it is fully assembled and with filters in place.

Always place and use the appliance on a dry, stable, level, and horizontal floor strong enough to support the unit with a full bucket of water. Make sure the appliance cannot be easily knocked over by a person or object.

The water collected in the bucket must be discarded. The water should never be used for drinking.

Never install the product near a bathtub or any water container.

Do not place anything on top of the appliance.

Do not sit, stand or place heavy objects on the appliance.

Store in a dry area, away from direct sunlight, when not in use.

Always grip the top handle and keep the unit upright when transporting from room to

room. Do not tilt the product on its side or upside-down.

If the dehumidifier was transported tilted on its side, you must position it upright again and wait at least 24 hours before using it.

If the dehumidifier is knocked over during use, turn off the dehumidifier and unplug it from

the main power supply immediately. Visually inspect the dehumidifier to ensure there is no damage. If you suspect the dehumidifier has been damaged, contact Customer Service for repair or replacement.

In a thunderstorm, the power must be cut off to avoid damage to the dehumidifier due to lightning.

READ AND SAVE THESE INSTRUCTIONS

ELECTRICAL INFORMATION

Be sure the dehumidifier is properly grounded. To minimize shock and fire hazards, proper grounding is important. This power cord is equipped with a three-prong grounding plug for protection against shock hazards.

Your dehumidifier must be used in a properly grounded wall socket. If your wall socket is not adequately grounded or protected by a time delay fuse or circuit breaker, have a qualified electrician install the proper socket.

Avoid fire hazard or electric shock. Do not use an extension cord or an adapter plug. Do not remove any prong from the power cord.

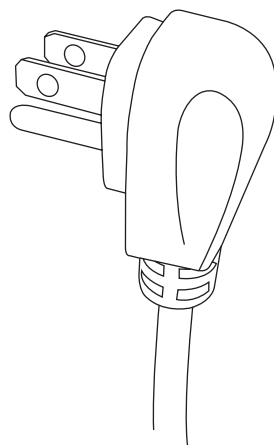

Package Contents

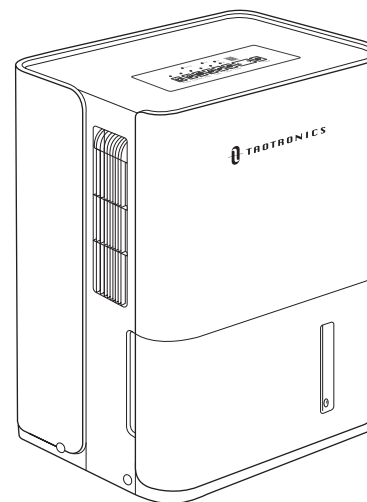

1 x TaoTronics Dehumidifier (TT-EE015)

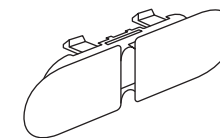

1 x Power Cord Buckle (placed in water bucket)

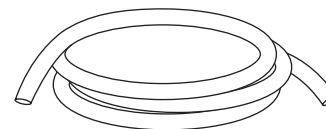

1 x Auto Pump Drain Hose



1 x User Guide



1 x Quick Start Guide

Product Diagram

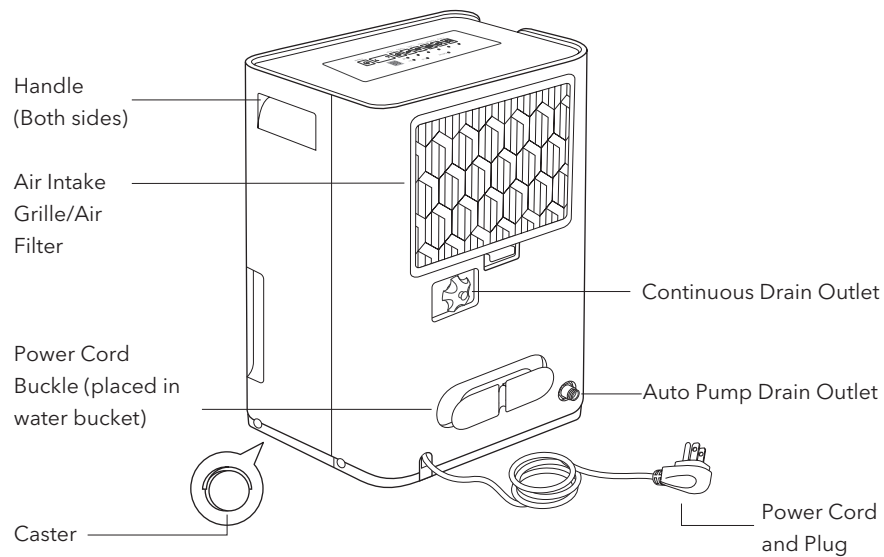
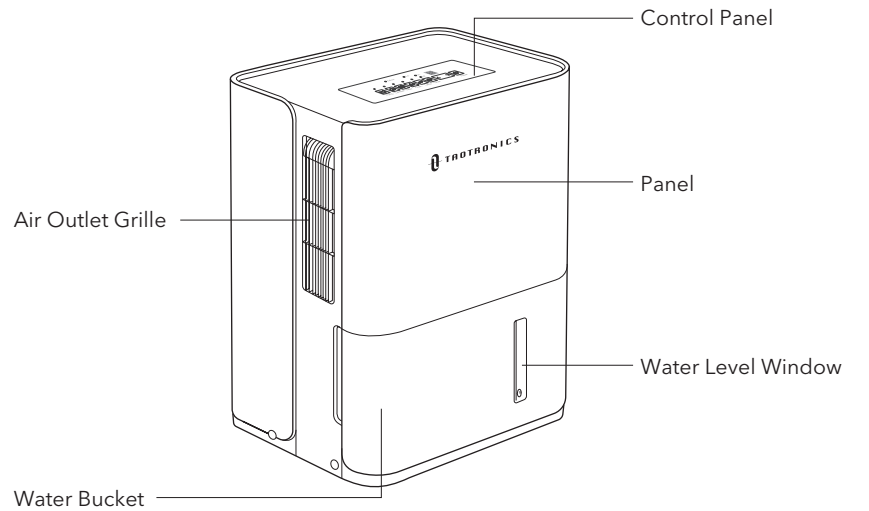

Before First Use

This unit may have been tilted or placed upside down during transportation. To prevent any internal damage and ensure this unit works properly, please set it upright for at least 24 hours before initial use to allow the refrigerant to stabilize.

Getting Started

- 1 Carefully take out your dehumidifier from the box and remove all packaging materials.
- 2 Place the unit on a firm, level and flat floor.

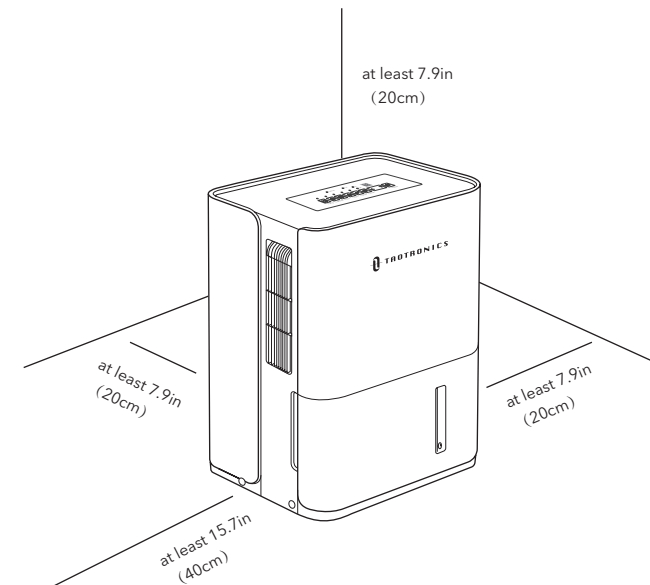

For proper air circulation, locate the unit at least 20cm of air space on all sides of the unit (at least 40cm of air space on air outlet).

Make sure none of the grilles are blocked. Make sure the Casters installed at four points on the bottom of the dehumidifier can move freely.

3 Take out the power cord buckle from the water bucket of the dehumidifier, then install by pressing it into the rear cover.

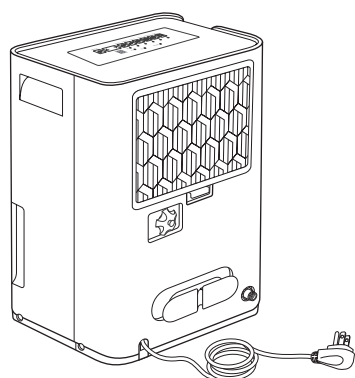
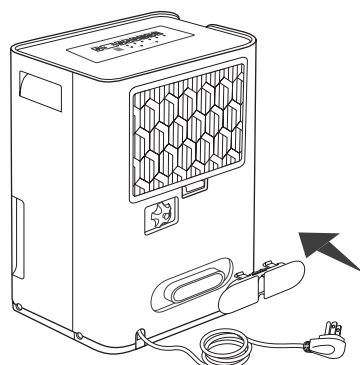

4 Plug into an appropriate voltage AC outlet. Then the dehumidifier is ready for use.

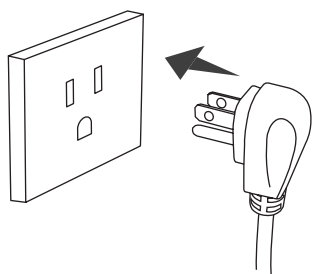

Note:

For optimal efficiency, the dehumidifier shall be operated in an enclosed area. Keep all doors, windows and other outside entrances to the room closed.

Place the dehumidifier in an area where the temperature will not drop below 41°F (5°C). This dehumidifier is designed to operate with a working environment between 41°F (5°C) and 90°F (32°C).

Do not force casters to move over carpet, or move the dehumidifier with water in the bucket. (The dehumidifier may tip over and spill water.)

Once the power cord buckle has been installed, it cannot be removed. The power cord buckle is used only when storing the unit.

Operations and Functions

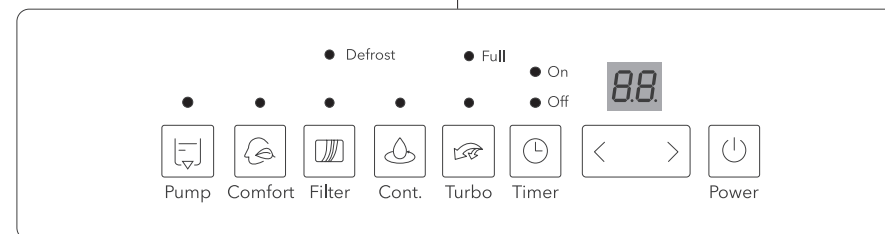
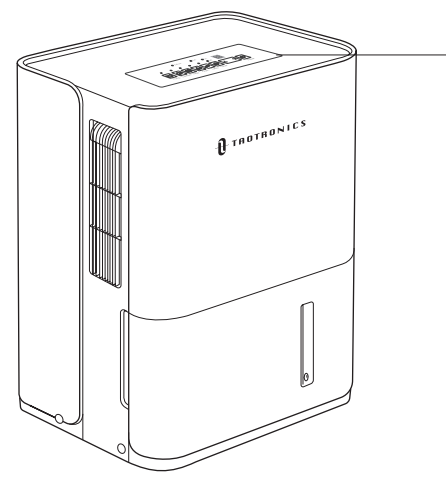

Power Button

Press to turn the dehumidifier ON or OFF.



LED Display

Shows the current ($\pm 5\%$ accuracy) room %humidity level in a range of 30% to 90% RH (Relative Humidity).

Shows the set %humidity level (35% ~ 85% RH) or Auto Start/ Stop time (0 ~ 24) while setting.

Malfunction Code	Meaning
AS	Humidity sensor error
ES	Temperature sensor error
P2	Water bucket full or not secured properly in place. Empty the water bucket and place it in the right position.

Note: When one of the above malfunctions occurs, turn off the dehumidifier, and check for any obstructions. Restart the unit, if the problem still persists, turn off the unit and unplug the power cord. Contact the Customer the Customer Support at support@taotronics.com for repair and/or replacement.



Auto Pump Drain Mode

Press to activate the Auto Pump Drain function. When the water bucket is full, the drain pump will automatically pump the water out of the bucket to the drain. For detailed information, please see “**Continuous Water Drainage - Using the Auto Pump Drain Option**” section.



Comfort Button

Press to turn the comfort function on/off. Under this mode, the humidity cannot be adjusted manually but will be preset to a recommended comfortable and healthy level based on the ambient temperature.

Ambient Temperature	<65 °F	65 -77 °F	>77 °F
Relative Humidity	55 %	50 %	45 %



Filter Button

When the Filter indicator is ON, it is time to clean the filter. Switch the unit OFF and carefully remove the filter from the unit and clean.

The Filter indicator will flash after 250 hours of operation. To reset after cleaning the filter, press the Filter button and the indicator will go off.



Humidity Setting

Set the humidity level within a range of 35% to 85%RH in 5% increments.

For drier air, press < button to set a lower RH%.

For damper air, press > button to set a higher RH%.



Timer Setting

Press < or > button to set Auto Start and Auto Stop timer from 0.0 to 24.



Continuous Button

Press to activate the Continuous Mode, the unit will dehumidify continuously.



Turbo Button

Press to control the fan speed: High or Normal fan speed. When the Turbo indicator is on, the unit is running at High fan speed.



Timer Button

Press to activate Auto Start and Auto Stop feature. Then press < or > button to set the timer from 0.0 to 24.

Auto Stop Timer:

When the unit is ON, press the Timer Button, the OFF indicator will be illuminated. Then press < or > to set the number of hours (0.5-24 hours) you want the unit to run before it switches off.

Auto Start Timer:

When the unit is OFF, press the Timer Button, the ON indicator will be illuminated. Then press < or > to set the number of hours (0.5-24 hours) you want the unit to start running automatically.

Note: In 5 seconds without operation, the Timer starts function. Then the LED display will show the previous humidity setting.

To cancel Timer settings, turn the unit ON or OFF at any time or adjust the timer setting to 0.0.

When code “P2” is displayed, the Auto Start / Stop function will also be cancelled.

● Defrost

Auto Defrost

When frost builds up on the evaporator coils, the internal compressor will turn off and the fan will continue to run until the frost has melted. Once the internal coils have defrosted and dried, the compressor or fan will automatically restart and dehumidifying will resume.

● Full

Water Bucket Full / Not Secured Properly In Place

When the water bucket is full or not secured properly in place, the indicator will be illuminated. To switch off the indicator, empty the water bucket and place it in the right position.

● On

Auto Start Indicator

When the Auto Start feature is activated, the ON indicator will be illuminated.

● Off

Auto Stop Indicator

When the Auto Stop feature is activated, the OFF indicator will be illuminated.

When both Auto Start and Auto Stop feature are activated, the ON and OFF indicators will be illuminated.

Other Features**Auto Shut Off**

When the humidity setting is reached, the dehumidifier will shut off automatically after about 3 minutes (the fan motor will continue running for about 3 minutes).

When the water bucket is full and/or not secured properly in place, the dehumidifier will shut off automatically (the fan motor will continue running for a few seconds).

Auto Restart

If the dehumidifier shuts off unexpectedly due to power outage, the dehumidifier will restart with the previous function setting automatically when the power resumes.

Draining the Collected Water**(Three ways to drain the collected water)****Using the Water Bucket**

When the water bucket is full, the dehumidifier will automatically shut OFF and the Full indicator will illuminate.

- 1 Grip both sides of the water bucket, gently pull it out.

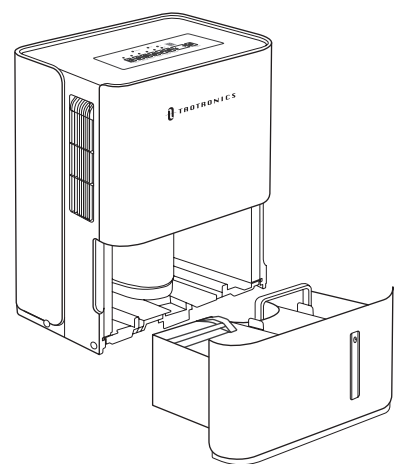
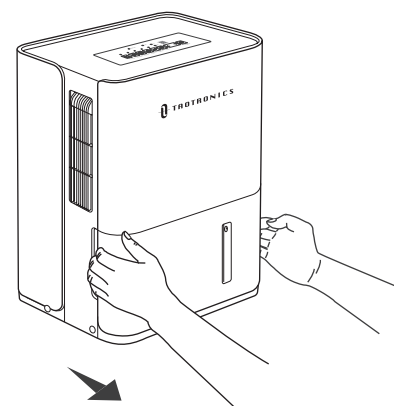

- 2 Grip the handle inside the water bucket and pour the water out.

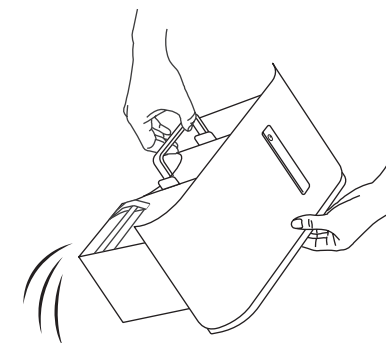

- 3 Place the empty water bucket back. Keep the bucket in the correct position and securely seated for the dehumidifier to operate.

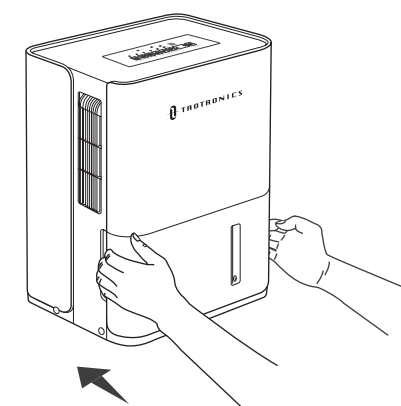

IMPORTANT:

Always drain and discard the water collected in the water bucket. The water is not clean and cannot be used for drinking.

IMPORTANT:

Do not move the dehumidifier when the Water Bucket is full as it will be heavy and can cause water spillage.

Note:

There is a Float inside the water bucket that senses the water level to automatically stop dehumidification when the water bucket is full. Do Not Remove This Float.

Make sure the dehumidifier is placed on a firm, level and flat floor to avoid any possible float failure or water leakage.

Float

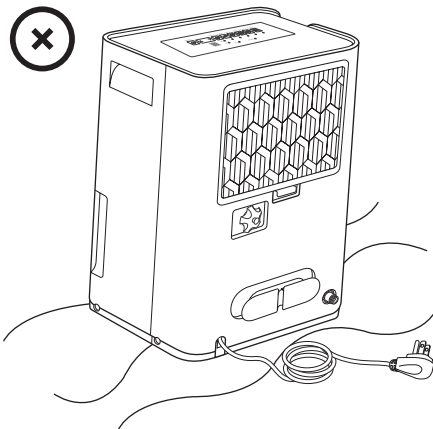
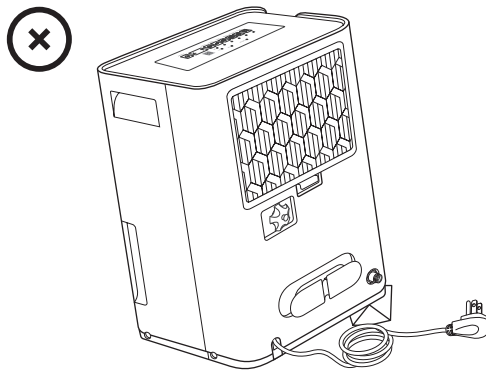
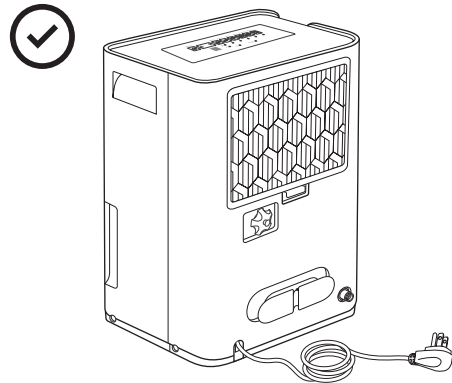
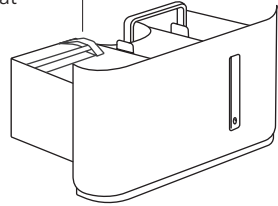

Continuous Water Draining - Using a Continuous Water Drain Hose

Water can be automatically emptied into a floor drain by attaching the unit with a continuous water drain hose (not included) and a female threaded end (not included). The floor

drain or a suitable drainage facility shall be lower than the drain outlet of the dehumidifier. Make sure the water hose is not bent or kinked to let the water flow out smoothly.

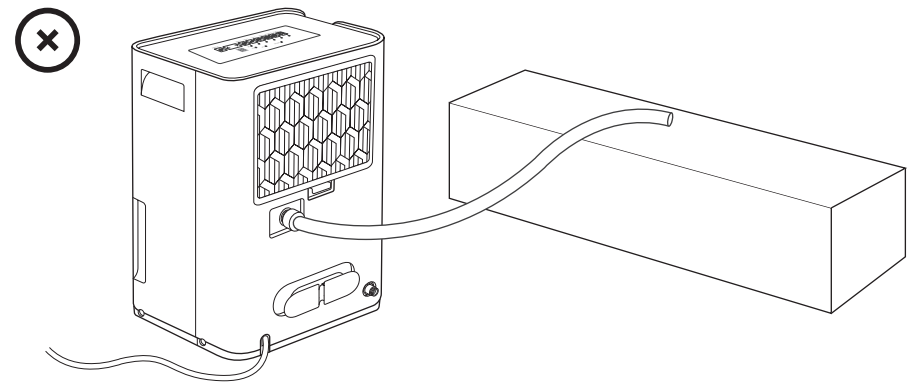
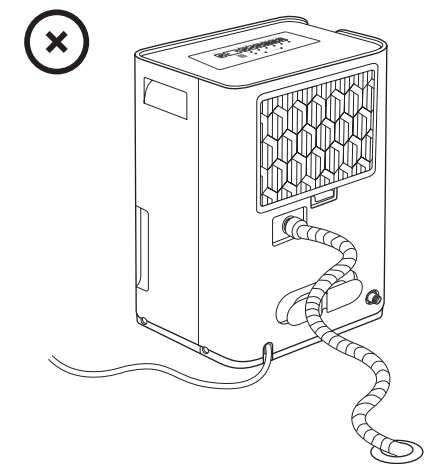
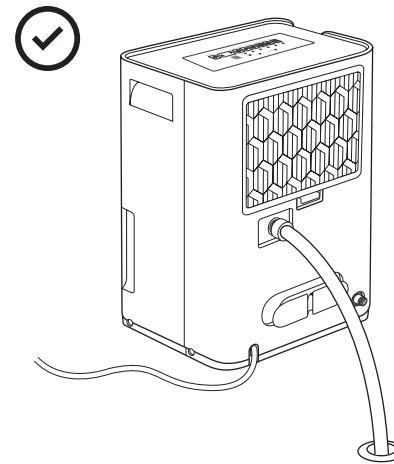

Note:

Make sure the water hose is secured over the drain and will not fall out of place causing unwanted water spillage.

When the continuous drain feature is not being used, remove the drain hose from the outlet and dry the water in it. Then screw the Water Drain Cap back.

15

Continuous Water Drainage - Using the Auto Pump Drain Option

The Auto Pump Drain is available if you want to use the continuous drain function, but the drain is further away, or located above the dehumidifier. When the water bucket is full, the drain pump will automatically pump the water out of the bucket to the drain.

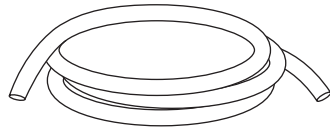

Auto Pump Drain Hose 16.4 ft.(5m)

1 Attach the Auto Pump Drain Hose to the Pump Drain Outlet located on the back side of the dehumidifier.

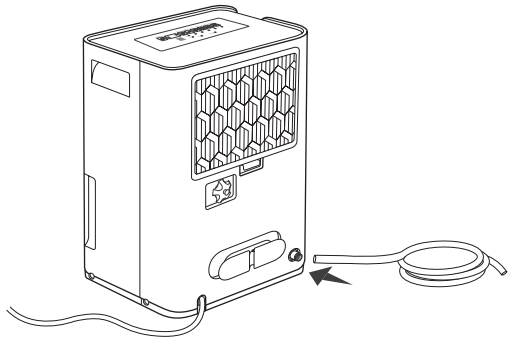

2 Press the Pump Button to activate the Auto Pump Drain function. Once on, the indicator will light up.

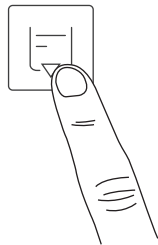

16

3 Place the other end of the tube into the sink or drain. The water can be pumped up to 16.4 ft (5 m) vertically or horizontally. When the water bucket is full, the drain pump will automatically pump the water out of the bucket to the drain.

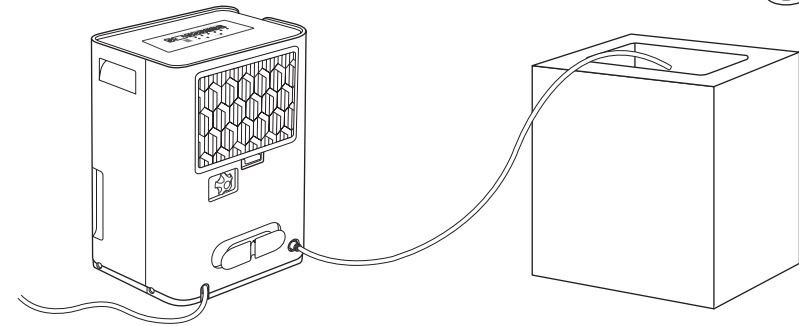
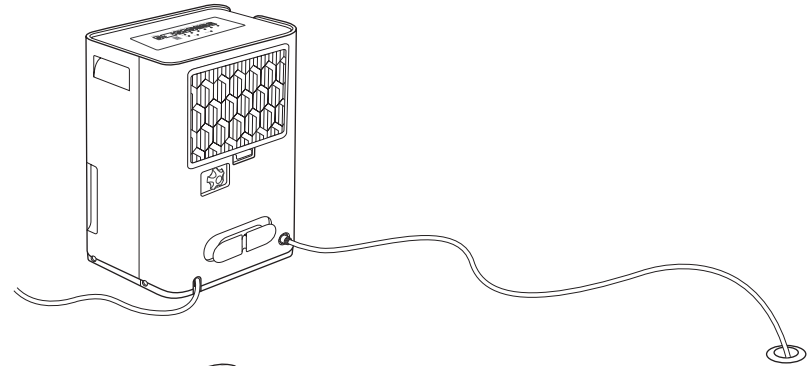

4 To remove the pump drain hose from the outlet, press the Pump Button to turn off the Auto Pump Drain function first, then press the pump drain outlet to pull the drain hose out.

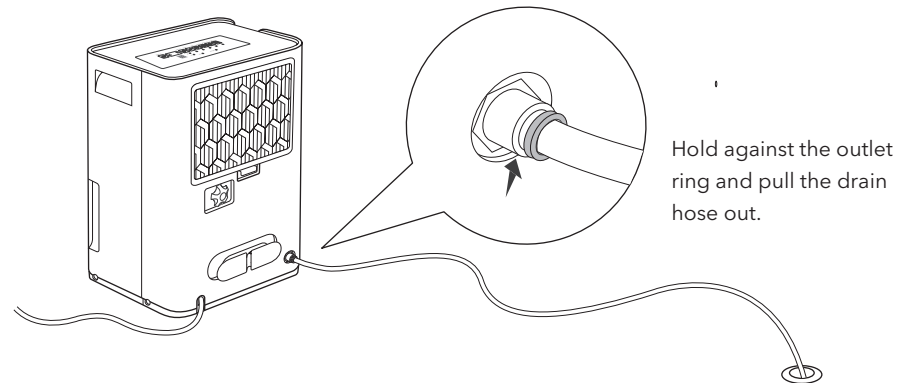

Note:

Before the pump operation is activated, make sure the Auto Pump Drain Hose is installed into the unit and the continuous drain hose is removed from the unit.

Make sure the hose is secure so there are no leaks.

Do not use this operation when the outdoor temperature is equal to or less than 32 °F.

When the pump operational failure occurs, the Pump indicator will flash. Please turn off the unit and unplug the power cord.

1 Remove the water bucket from the unit, take down the pump and remove the filter of the pump.

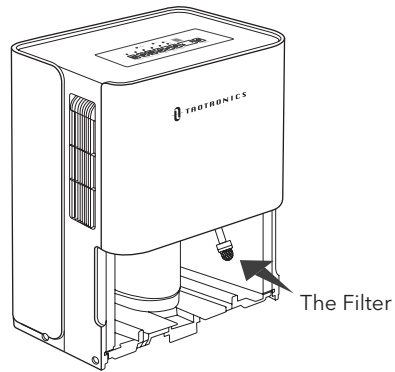

2 Rinse the filter with water and reinstall it after cleaning.

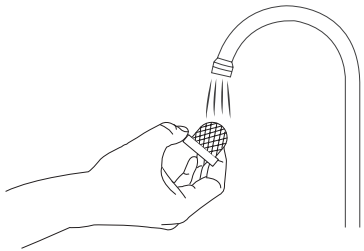

3 Check that the pump drain hose does not link or back.

4 Empty the water in the bucket.

5 Reinstall the pump hose if it drops and place the water bucket properly.

6 Turn on the unit. If the error repeats, contact TaoTronics Customer Support at support@taotronics.com.

Cleaning and Maintenance

WARNING: Always switch OFF the dehumidifier and unplug it from the electrical outlet before cleaning or maintaining.

Cleaning the Main Unit

Switch OFF and unplug the dehumidifier from the electrical outlet.

Use a soft cloth with water or a mild detergent to clean the outer case. Do not use bleach or other abrasive cleaners, etc. on and/or in the unit while cleaning as they will damage the product.

Use a vacuum attachment or soft brush to clean the air outlet grille which can get soiled easily.

Do not splash water directly onto the main unit. Doing so may cause an electrical shock, insulation deterioration, or rust in the unit.

Do not stick any foreign objects or your fingers inside of the unit.

2 Carefully pull out the filter from the dehumidifier.

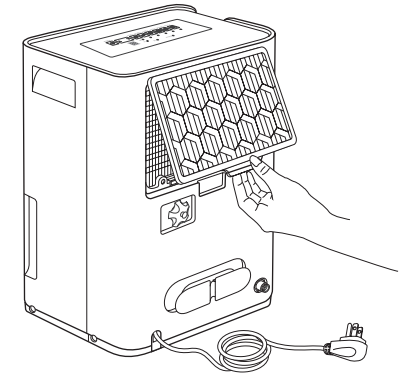

3 Rinse the air filter under running water, or vacuum away the dust with a vacuum cleaner.

4 Dry in a cool, shaded place, then carefully install it back to the unit.

Note:

Do not operate the dehumidifier without a filter because dirt and dust particles will clog it and reduce the performance.

Cleaning the Air Filter

The Air Filter located at the back of the dehumidifier helps to remove dust particles from the air. For optimum dehumidification, it is recommended to clean the air filter every 2 weeks based on normal operating conditions.

1 Switch OFF and unplug the dehumidifier from the electrical outlet.

Cleaning the Water Bucket

To prevent growth of mold, mildew and bacteria, it is recommended to clean the water bucket based on actual conditions.

- 1 Partially fill the bucket with clean water and add a little mild detergent. Swish it around in the bucket, empty and rinse.

- 2 After cleaning, place the water bucket back and secure properly in place for the dehumidifier to operate.

Note:

Do not use a dishwasher to clean the bucket.

End of Season Storage & Maintenance

When not using the dehumidifier for an extended period of time:

Switch OFF and unplug the dehumidifier from the electrical outlet.

Wait one day, then empty the water bucket and let it dry.

If your dehumidifier is connected to the continuous drain hose, you must disconnect the hose, dry and then place the drain cap back to the drain outlet.

Clean the main dehumidifier, water bucket and air filter. Dry the air filter and install back to the unit.

Make sure all parts of the dehumidifier and accessories are dry before storage.

Cover the dehumidifier with a cloth/ plastic bag before storage, to protect the surface from dust and scratches.

It is recommended to coil the power cord and store it off the floor to ensure it is protected from bends and kinks.

Store the unit upright in a dry, well-ventilated place, away from direct sunlight.

Specifications

Model	TT-EE015
Power Supply	115V~60Hz,1Ph
Rated Input	545W
Rated Current	5.2A
Moisture Removal	50Pints/day
IEF	1.8L/kWh
Refrigerant Type	R410A/7.40ozs
Design Pressure	540/300PSIG
Water Bucket Volume	6L

Troubleshooting

The following troubleshooting guide addresses the most common problems. If problems

persist, contact the Customer Support at support@taotronics.com.

Problem	Possible Causes	Solution
Malfunction Codes on LED Display	AS: Humidity sensor error	Contact TaoTronics Customer Support.
	ES: Temperature sensor error	Contact TaoTronics Customer Support.
	P2: Water bucket full or not secured properly in place	Empty the water bucket and place it in the right position.
Dehumidifier does not start	Power cord is not properly plugged in.	Connect the plug to a powered electrical outlet.
	Power cord is damaged.	Immediately stop using and contact TaoTronics Customer Support.
	Water bucket is full or not secured properly in place.	Empty the water bucket and secure it properly in place.
	Preset humidity level is reached.	This is normal. When the humidity setting is reached, the dehumidifier will shut off automatically.
Dehumidifier runs constantly / does not stop	Too large area to be dehumidified.	The capacity of your dehumidifier may not be adequate for the room it is used in. It is recommended to add an extra dehumidifier for large areas.
	A door or window is open, letting in new moisture.	For optimal efficiency, the dehumidifier shall be operated in an enclosed area. Keep all doors, windows and other outside entrances to the room closed.
	Continuous Button pressed.	Check if the dehumidifier is running under Continuous Mode

Problem	Possible Causes	Solution
Dehumidifier does not dry the air as it should	Not enough free space around the dehumidifier.	Make sure there are no curtains, blinds or furniture blocking the front or back of the dehumidifier. Leave the unit at least 20cm/8in free space around and at least 40cm/16in free space above.
	Air intake or outlet is blocked.	Remove objects blocking the air intake or outlet.
	Air filter is dirty/blocked.	Clean the air filter (see Cleaning and Maintenance).
	Temperature in the room is too low.	The dehumidifier is designed to operate between 41°F (5°C) and 89°F (32°C). Moisture removal is greatly reduced if room temperature is out of this temperature range.
	A door or window is open, letting in new moisture.	For optimal efficiency, the dehumidifier shall be operated in an enclosed area. Keep all doors, windows and other outside entrances to the room closed.
	Humidity level setting is too high.	Decrease the humidity level setting.
	There are other sources of humidity in the room (e.g. boiling water in pot).	Turn off kerosene heater or something giving off water vapor in the room.

Problem	Possible Causes	Solution
Dehumidifier does not dry the air as it should	Insufficient time for the dehumidifier to remove moisture.	After initial installation, allow 24 hours operation to maintain desired dryness.
Excessive noise	Air filter is dirty/blocked.	Clean the air filter (see Cleaning and Maintenance).
	Dehumidifier is tilted or placed on an uneven surface.	Place the unit on a level and flat floor.
	Fan is working.	It is normal that the fan creates sounds during operation.
Frost appears on the coils	Dehumidifier has been recently turned on in low room temperatures (usually below 41°F (5°C)).	This is normal. The dehumidifier comes with Auto Defrost feature.
Water does not drain from the water hose	Some floors may have an uneven surface which may affect the continuous draining function.	The water hose must be placed lower than the drain outlet of the dehumidifier. Make sure the water hose is not bent or kinked to let the water flow out smoothly.
Water on floor	Hose to connector or hose connection may be loose.	Check the connections between the hose and the drain outlet.
	You intended to use the water bucket to collect water but the back drain cap is removed.	Screw the drain cap back to the unit.

Warranty and Service

This product is covered with TaoTronics product and labor warranty for 12 months from the date of its original purchase. If any problems occur, please contact the TaoTronics Customer Care Centre via the contact information listed in this User Guide.

We can only provide after sales service for products that are sold by TaoTronics or TaoTronics authorized retailers and distributors. If you have purchased your unit from a different place, please contact your seller for return and warranty issues.

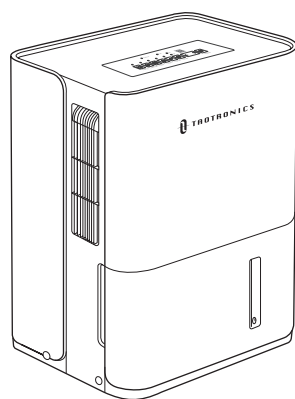

For any questions or concerns, please email us at **support@taotronics.com**