

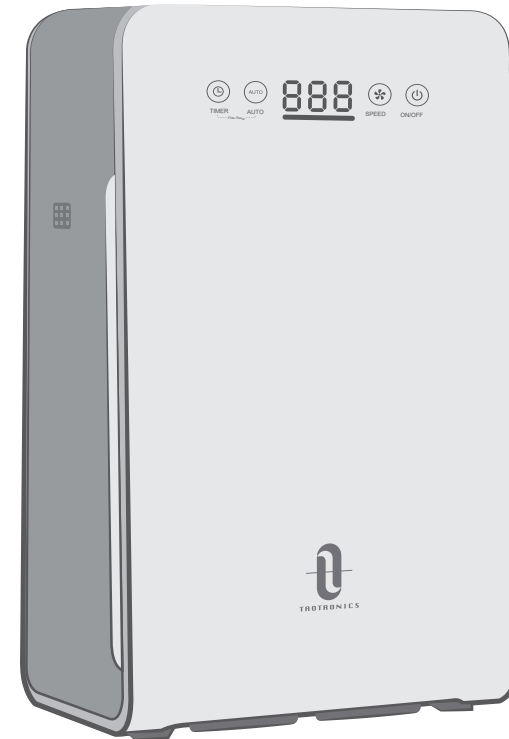

AIR PURIFIER



 E-mail: support@taotronics.com

 www.taotronics.com

MANUFACTURER

Manufacturer: Shenzhen NearbyExpress Technology Development Co.,Ltd.

Address: Floor 7, Building E, Galaxy World Phase II, Shenzhen, China



MADE IN CHINA

TT-AP007_V1.1_EN

Model: TT-AP007

User Manual

TABLE OF CONTENTS

IMPORTANT SAFETY INSTRUCTIONS -----	01-04
SPECIFICATIONS -----	05
KNOWING YOUR AIR PURIFIER -----	05
GETTING STARTED-----	06
USING YOUR AIR PURIFIER-----	07-09
REPLACING THE MULTIFUNCTION FILTER -----	10
CLEANING AND MAINTENANCE -----	11
TROUBLESHOOTING -----	12-13
WARRANTY AND SERVICE -----	14
CERTIFICATIONS -----	15



THANKS FOR CHOOSING **TAOTRONICS AIR PURIFIER**. PLEASE READ THIS USER GUIDE THOROUGHLY BEFORE USE AND RETAIN IT FOR FUTURE REFERENCE.



IMPORTANT SAFETY INSTRUCTIONS

BEFORE USING THIS APPLIANCE READ ALL INSTRUCTIONS AND CAUTIONARY MARKINGS IN YOUR USER GUIDE AND ON THE APPLIANCE

WHEN USING AN ELECTRICAL APPLIANCE, BASIC PRECAUTIONS SHOULD ALWAYS BE FOLLOWED, INCLUDING THE FOLLOWING:

- 1 This appliance is not intended for use by persons (including children) with reduced physical, sensory or mental capabilities, or lack of experience and knowledge, unless they have been given supervision or instruction concerning the use of the appliance by person responsible for their safety.
- 2 To avoid fire or shock hazard, plug the appliance directly into a right AC electrical outlet. This appliance must be provided with correct voltage via a professionally installed power socket. Make sure the voltage indicated on the label of the appliance is the same as your local supply.
- 3 DO NOT operate the appliance if the plug, the main cord or the appliance itself is damaged. Always make sure that the plug is inserted properly into a wall outlet.
- 4 Close supervision is necessary when any appliance is used by or near children. Children should be supervised to ensure that they do not play with the appliance. Cleaning and user maintenance shall not be done by children unless they are older than 8 and supervised.
- 5 DO NOT immerse air purifier in water or liquids. Doing so may result in damage to the appliance, electric shock, or fire.
- 6 DO NOT use the air purifier in wet or humid environments.
- 7 Keep the cord out of heavy traffic areas. To avoid fire hazard, NEVER put the cord under rugs, near heat registers, radiator, stoves, or heaters.
- 8 DO NOT plug in the appliance or operate the control panel with wet hands.
- 9 DO NOT run the power cord under carpeting. Do not cover cord with throw rugs, runners or similar coverings.

- 10 DO NOT route cord under furniture or appliances. Arrange the cord away from traffic area and where it will not be tripped over.
- 11 DO NOT use an extension cord with this unit.
- 12 DO NOT use the air purifier in an enclosed space where flammable, combustible or explosive gases are present.
- 13 NEVER drop or insert any objects into any openings.
- 14 NEVER block the air openings, grille / outlets or place the unit on a soft surface such as a bed or sofa, as this could cause the unit to tip over, blocking the air inlet or outlet.
- 15 DO NOT attempt to repair or adjust any electrical or mechanical functions on this unit. Doing so will void your warranty. The inside of the unit contains no user serviceable parts. All servicing should be performed by qualified personnel only.
- 16 Always place and use the appliance on a dry, stable, level, and horizontal surface. Make sure the appliance cannot be easily knocked over by a person or object.
- 17 DO NOT sit, stand or place heavy objects on the appliance.
- 18 DO NOT place the appliance directly below an air conditioner to prevent condensation from dripping onto the appliance.
- 19 Always unplug the air purifier before moving it, opening the grille, changing filters, cleaning or whenever the air purifier is not in use. Be sure to pull by the plug, not the cord.
- 20 DO NOT use the filter as fuel or for similar purposes.
- 21 Always make sure to place the air purifier on a flat, level surface before operation.

- 22 Always wash your hands thoroughly after changing or cleaning a filter.
- 23 Use the appliance only for intended household purposes as described in this User Guide. Any other use is not recommended that may cause fire, electric shock, or injury to persons.

FOR HOUSEHOLD USE ONLY

READ AND SAVE THESE INSTRUCTIONS

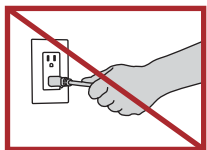

Be sure to pull by the plug, not the cord

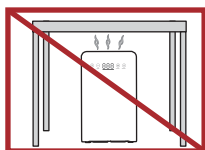

DO NOT block the air openings, grille / outlets.



Always unplug the air purifier before moving, cleaning or whenever not in use.



DO NOT immerse in water or liquids.

SPECIFICATIONS

Model	TT-AP007
Voltage	US / CA: 120V~60Hz
Rated Power	55 W
Rated CADR	260 m ³ /h
Applicable Area	26 m ² / 280 ft ²
Noise	≤59 dB

KNOWING YOUR AIR PURIFIER

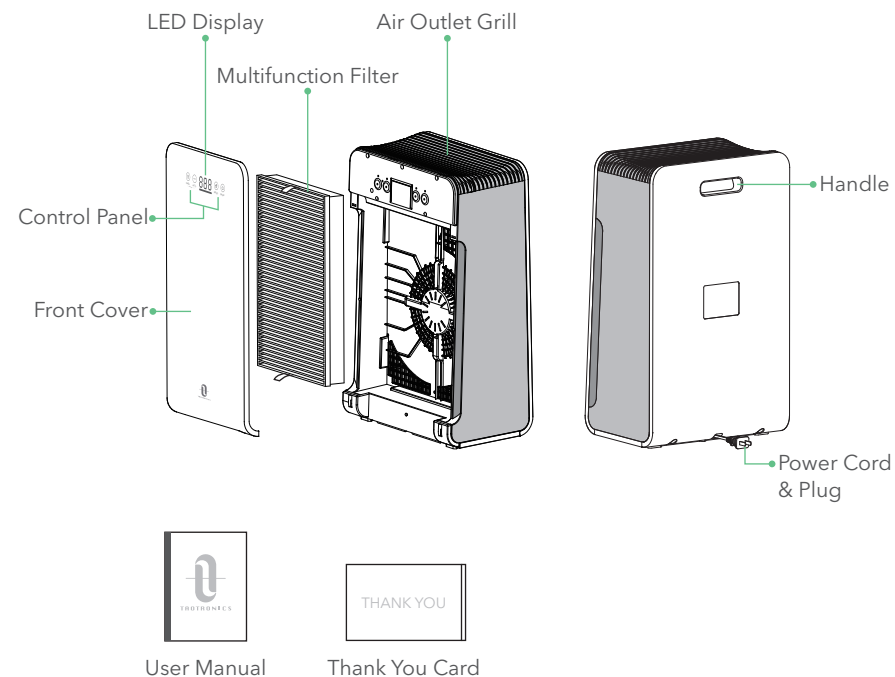

GETTING STARTED

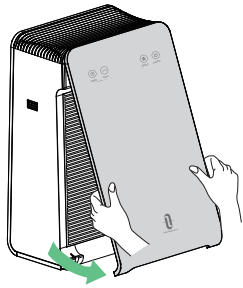

1

Open and remove Front Cover.

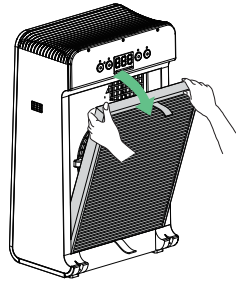

2

Hold pull tabs to take out Multifunction Filter.

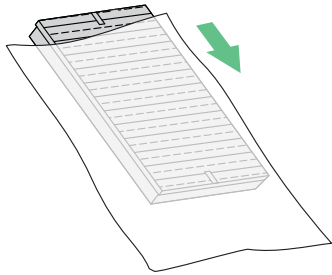

3

Remove from its plastic packaging.

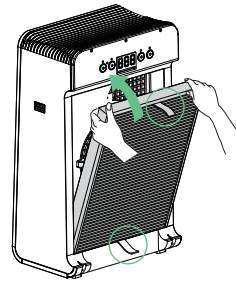

4

Install Multifunction Filter back (pull tabs facing out).

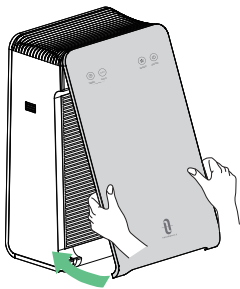

5

Align the matching slots and buckle up Front Cover.



6

Place the unit on a firm, level and flat surface. (Leave 15 in / 38 cm of clearance for proper air flow)

USING YOUR AIR PURIFIER

Control Panel & LED Display

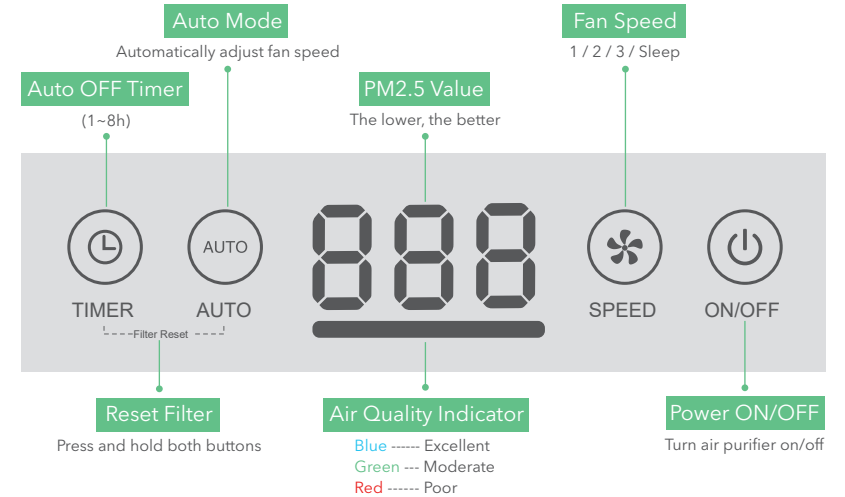

Quick Start Of Your Air Purifier

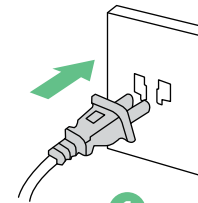

1

Plug into an appropriate electrical outlet.

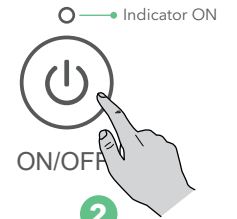

2

Tap to turn ON the air purifier (Auto Mode ON by default).

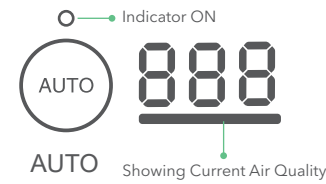

3

Auto Mode is turned ON by default, the fan speed will be adjusted intelligently.

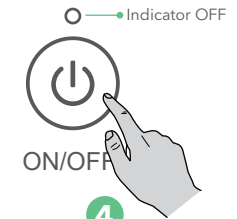

4

Tap to turn OFF when finished using it.

Operation And Functions

Auto Mode

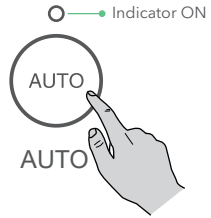

- In Non-Auto Mode, tap **AUTO** to activate Auto Mode.
- When Auto Mode is enabled, the fan speed is adjusted intelligently according to the air quality.

Fan Speed Control

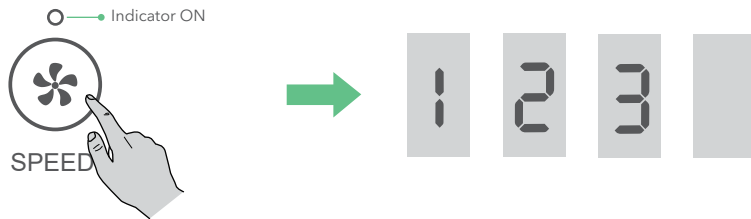

- When the unit is on, tap **SPEED** repeatedly to cycle through the adjustable fan speeds: 1, 2, 3 and Sleep (Low -> Medium -> High -> Sleep).
- When Sleep Mode is selected, all indicators will turn off. The air purifier will run quietly under lowest possible fan speed, making it ideal for use while sleeping.
- When adjusting the fan speed under Auto Mode, the Auto Mode will be exited automatically.

Auto OFF Timer

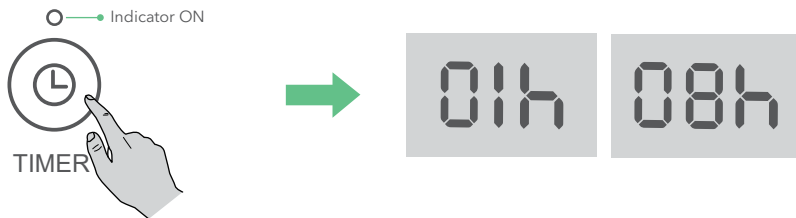

- When the unit is on, tap **TIMER** repeatedly to select the desired auto off time (1 to 8 hours).
- When time reaches zero, the air purifier will go into standby mode.
- To cancel, tap **POWER** to turn off the air purifier.

Filter Reset

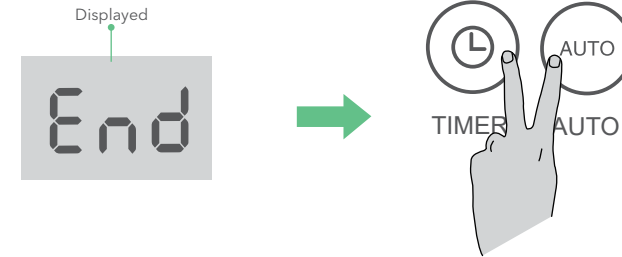

- **End** will display as a reminder to change the Multifunction Filter.
- After replacing, press and hold **TIMER** and **AUTO** simultaneously for 3 seconds to reset the filter.

REPLACING THE MULTIFUNCTION FILTER



1

End will display as a reminder to change the Multifunction Filter.

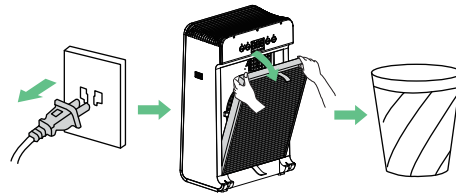

2

Unplug the air purifier. Remove the old Multifunction Filter and properly dispose of it.

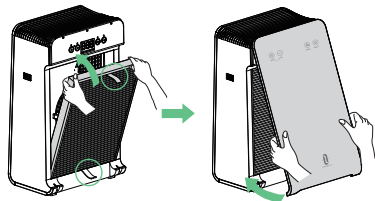

3

Replace with a new one. Install the filter and front cover back.

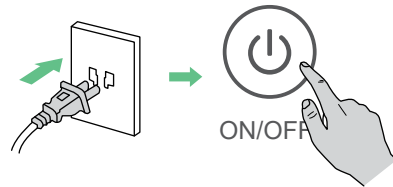

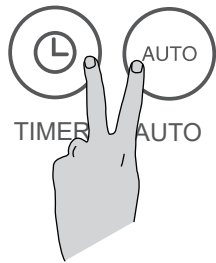

4

Plug in and tap  to turn on the air purifier.



5

Press and hold  and  simultaneously for 3 seconds to reset the filter.

Note:

- **Important:** Always make sure the air purifier is turned off and unplugged before replacing the filter.
- It is recommended to replace the Multifunction Filter every 6 to 8 months (depending on the frequency of use and air quality).

CLEANING AND MAINTENANCE

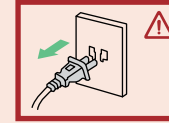

Always make sure the air purifier is turned off and unplugged before cleaning.

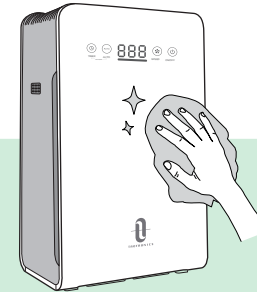

Outer Surface

Wipe with a soft, dry cloth. If necessary, wipe with a damp cloth, then immediately dry.

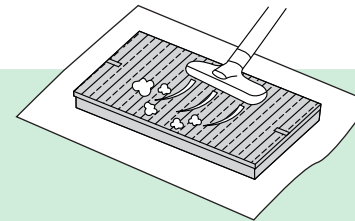

Multifunction Filter

Vacuum up dust with a vacuum cleaner once every two weeks. Do not wash.

Note:

- DO NOT stick any foreign objects or your fingers inside of the unit.
- Never immerse the air purifier in water and never allow water to drip into the motor housing.
- DO NOT clean with abrasive chemicals or flammable cleaning agents.
- For storage, you may leave the unit covered to protect it from dust. Store it in a cool, dry location.

TROUBLESHOOTING

The following troubleshooting guide addresses the most common problems. If problems persist, feel free to contact the Customer Support at support@taotronics.com.

Problem	Possible Causes	Solution
End Filter Change Indicator does not disappear	The air purifier has been reset incorrectly	Replace the filter and reset by pressing and holding the Timer and Auto Buttons for 3 seconds
Air purifier does not power on or respond to button controls	Unit is not plugged in or the power socket is not switched on	Connect the plug to a powered electrical outlet
	Power socket is not working properly	Try plugging the air purifier into a different outlet
	Power cord is damaged	Immediately stop using and contact TaoTronics Support Team
	Air purifier is malfunctioning	Contact TaoTronics Support Team
Insufficient air flow	Fan speed is on low setting	Press Fan Speed Button to adjust the fan speed
	Filter packaging has not been removed	Remove the filter from its packaging before use
	Not enough free space around the unit to ensure ventilation	Leave 15 in / 38 cm of clearance for proper air flow
	Filter is clogged and not replaced	Replace the filter
Poor air purification quality	Room size exceeds the expected size the unit covers	Select the right air purifier as per the actual room size
	Air intake or outlet is blocked	Remove objects blocking air intake or outlet
	Filter is not properly placed inside the housing	Properly place the filter (see Replacing the Multifunction Filter)
	Filter is dirty and cannot produce fresh air anymore	Replace the filter (see Replacing the Multifunction Filter)
	Not enough free space around the unit to ensure ventilation	Leave 15 in / 38 cm of clearance for proper air flow

Excessive noise	Filter packaging has not been removed	Remove the filter from its packaging before use
	Foreign objects inside the unit	Immediately discontinue use and contact TaoTronics Support Team. DO NOT attempt to open the air purifier
	Unit is placed on an uneven surface	Place the unit on a level and flat place
Producing an unpleasant odor	Filter is dirty and cannot produce fresh air any more	Replace the filter (see Replacing the Multifunction Filter)
	High humidity levels have caused mildew to grow on the filter	Replace the filter, and move the air purifier to a room where the relative humidity is less than 85% RH

WARRANTY AND SERVICE



Thanks for choosing TaoTronics Air Purifier. This product is covered with TaoTronics product and labor warranty for 12 months from the date of its original purchase.

The warranty will not apply in cases of:

- Accident, misuse, or repairs performed by unauthorized personnel.
- Any unit that has been tampered with or used for commercial purpose.
- Normal wear and tear of wearable parts.
- Use of force, damage caused by external influences.
- Damage caused by non-observance of the User Guide, e.g. connection to an unsuitable mains supply or non-compliance with the instructions.
- Partially or completely dismantled appliances.
- Defects caused by or resulting from damages from shipping or from repairs, service, or alteration to the product or any of its parts that have been performed by a repair person not authorized by TaoTronics.

We can only provide after sales service for products that are sold by TaoTronics or TaoTronics authorized retailers and distributors. If you have purchased your unit from a different place, please contact your seller for return and warranty issues.

*** Please have your invoice and order ID ready before contacting Customer Support.**

TAOTRONICS

Model Number TT-AP007

Default Warranty Period 1 Year

Extend your warranty to 30 months at taotronics.com/warranty

Order ID

Date of Purchase

Purchased From

SUPPORT

Should your product prove defective within the specified warranty period, or any questions regarding warranty or service, email us at support@taotronics.com.

FCC Compliance

This device complies with Part 15 of the FCC Rules. Operation is subject to the following two conditions:

- (1) This device may not cause harmful interference, and
- (2) This device must accept any interference received, including interference that may cause undesired operation.

Model:
TT-AP007

成品尺寸：148*210mm

装订成册

材质：封面128克铜版纸 内页80克书纸