



REHASENSE



# SPACE LX

THE EVERYDAY ROLLATOR



+44 (0) 0333 220 0704



ukadmin@rehasense.com



www.rehasense.co.uk

# SPACE LX

## THE EVERYDAY ROLLATOR



### THE BESTSELLER

The SPACE LX rollator combines intuitive design, smooth lines and high-strength alloy materials. Maximum user weight of 150 kg. The lightweight design makes it easy to walk, lift and turn – indoors and outside. Backrest and stick holder included. Available in medium or large and a choice of 3 colours.

### FEATURES AT A GLANCE

- Comes with a comfortable back strap
- Large shopping bag for carrying up to 5 kg
- Ergonomic handles with locking function
- Handle height extremely convenient and easy to adapt
- Patented, red, "Click & Safe" safety catch
- Ingenious carrying handle: ergonomic handle grips under the mounting bars for lifting and carrying the rollator
- All-round safety reflectors available for shopping bag, frame and handles
- Incl. edge guard and step pedal

### SIZES & COLOURS

Large: Sober Grey, Champagne Gold, Electric Blue  
 Medium: Sober Grey, Champagne Gold, Electric Blue



### TECHNICAL DETAILS

Weight:	Max. load capacity	Seat height	Seat width	Width folded	Total width	Distance between handles	Handle heights
Large 5.8 kg + basket 330 g	up to 150 kg	Large 62 cm	46 cm	Large 22 cm	Large 62 cm	56 cm	Large 80-102 cm
Medium 5,7 kg + basket 330 g		Medium 55 cm		Medium 22 cm	Medium 62 cm		Medium 72-85 cm

### SPECIAL FEATURES

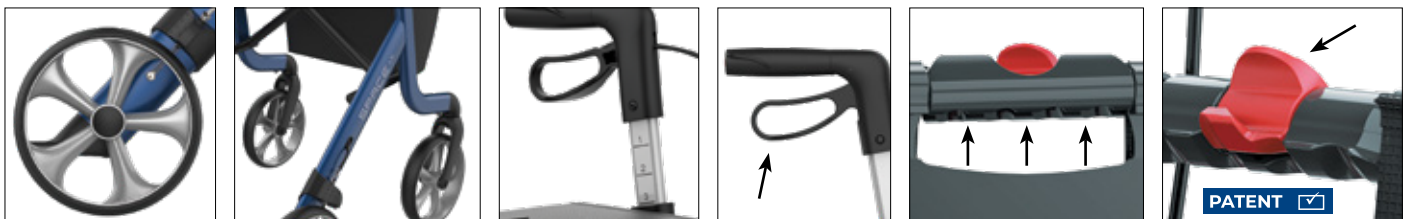

Maintenance free brakes and reliable TPE-wheels

Unique aluminium frame profile ensuring the lightest construction though durability up to 150 kg

Smooth adjustable handle height and lockable handbrakes

Brake lever can be operated without much effort

Ergonomic gripping for lifting and carrying

Thanks to the „Click & Safe“ lock, the rollator closes securely

### ACCESSORIES

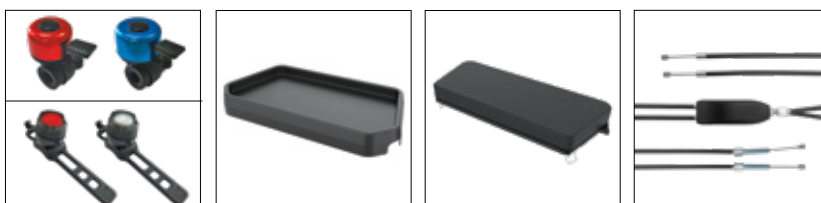

Bells & LED lights

Tray

Padded seat

One hand brake

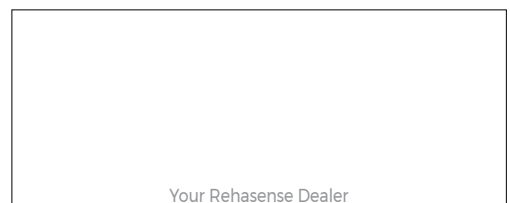

Your Rehasense Dealer



Rehasense's quality management system complies with both the ISO 9001 and ISO 13485 standards, as confirmed by TUV NORD. Rehasense's medical devices are CE-marked and meet the requirements of EU Regulation 2017/745 (MDR.) Rehasense's medical devices are UKCA-marked and meet the requirements of MHRA regulations.

