



TERRA SUMMER

## CONTENT

1 - MEASUREMENTS AND PREPARATION	04
2 - FRAME ASSEMBLY	
- ASSEMBLING A FRAME WITH CENTER UPRIGHTS	05
- ASSEMBLING A FRAME WITHOUT CENTER UPRIGHTS	09
3 - FRAME INSERTION	12
4 - INSTALLING THE CAPPING	13
5 - INSTALLING THE SLATS	14
6 - INSTALLING THE CENTER CAPPING	15
7 - INSTALLING THE OPERATING PROFILE	16

## IN THE BOX

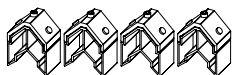

4X Corners



Sprocket



Lock



Clip

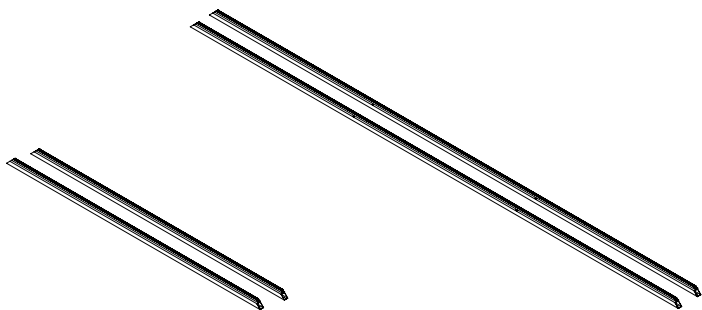

2X V-frame

2X H-frame

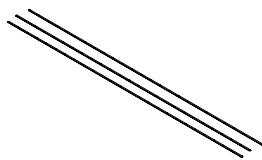

Operating profile

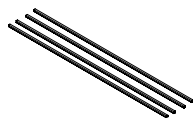

U-shaped cache without holes

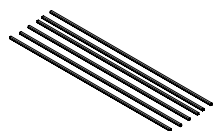

U-shaped cache without holes

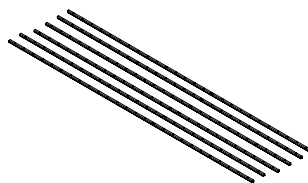

U-shaped cache with holes

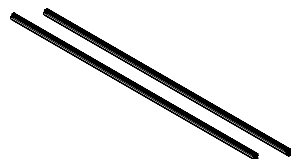

Center uprights

## NEEDED TOOLS

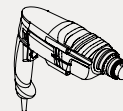

Drill

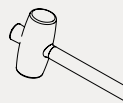

Mallet

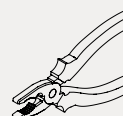

Pliers

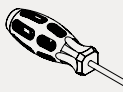

Screwdriver

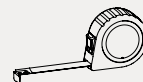

Measuring tape



Allen key

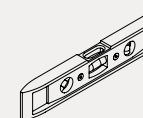

Level

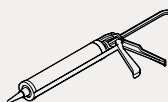

Caulking



Step ladder

## MEASUREMENTS AND PREPARATION

1

A

Make sure the interior dimensions of the opening match the opening dimensions on the delivery note.

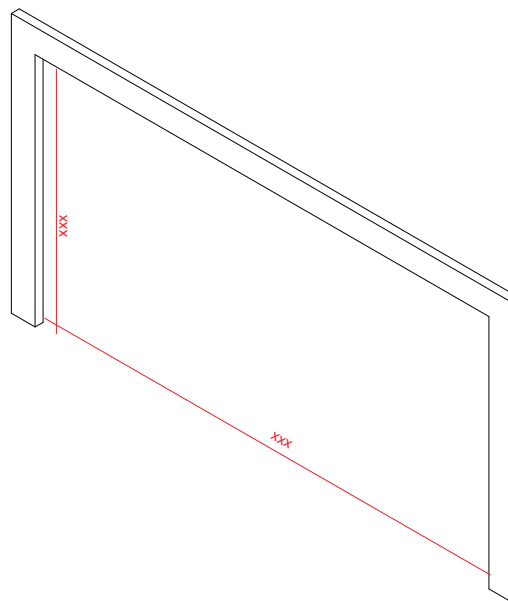

B

Open the boxes.

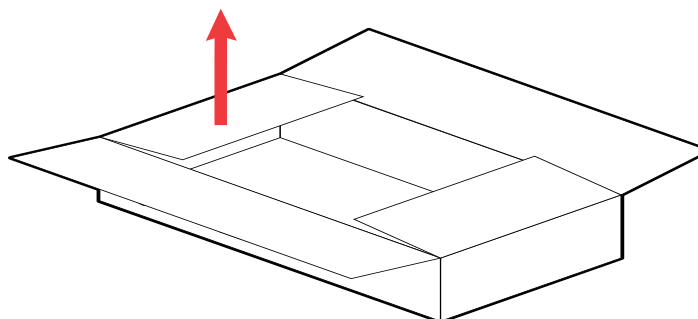

## FRAME ASSEMBLY

# 2

### ASSEMBLING A FRAME WITH CENTER UPRIGHTS

(If you have only one panel, go to page 9)

#### A

Take the bottom frame and insert the center uprights into the small aluminum tabs in the bottom frame.

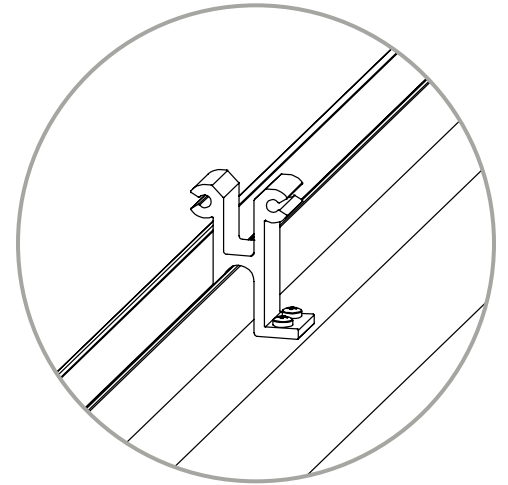
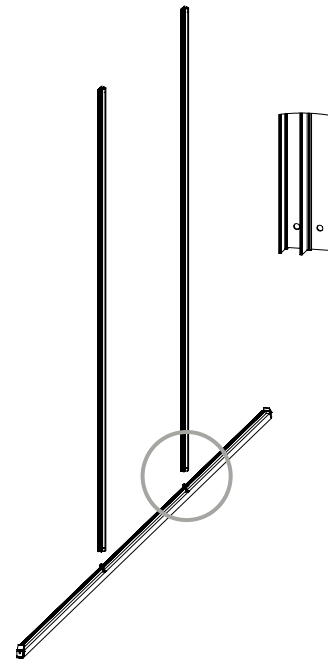

#### B

Attach the center uprights to the bottom frame by inserting the screws into the screw holes at the bottom of the center uprights.

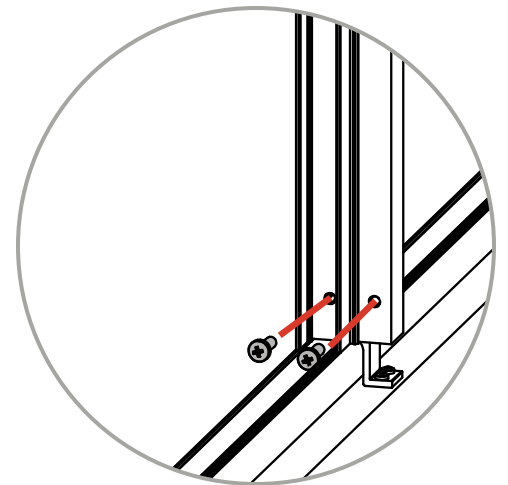
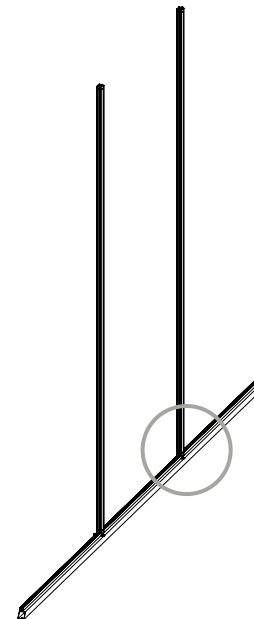

# C

Insert two of the four corner pieces into the ends of the bottom frame.

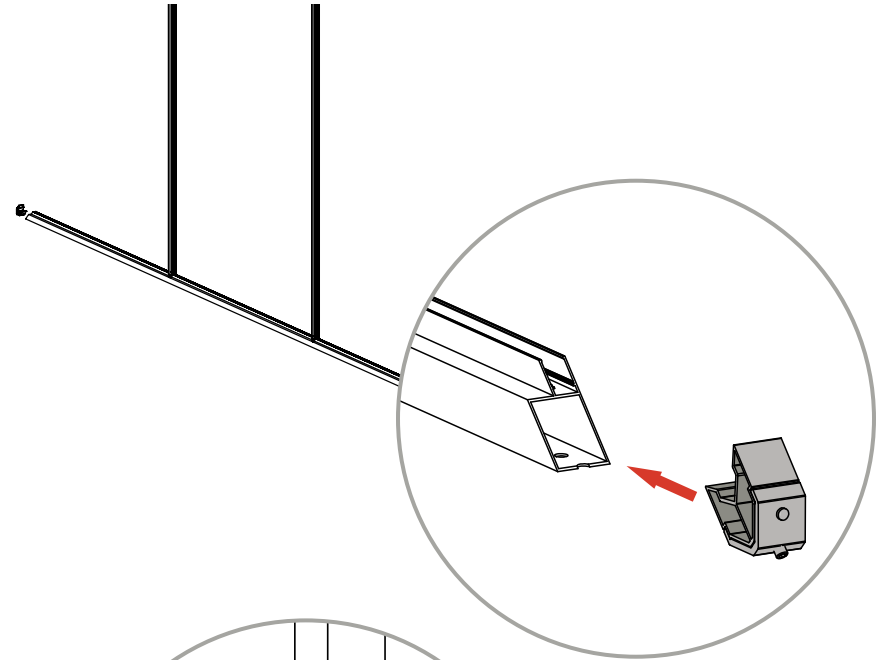

# D

Slide the side uprights on to the corner pieces of the bottom frame.

Use the Allen key to gently tighten the bottom corners so they are 90 degrees.

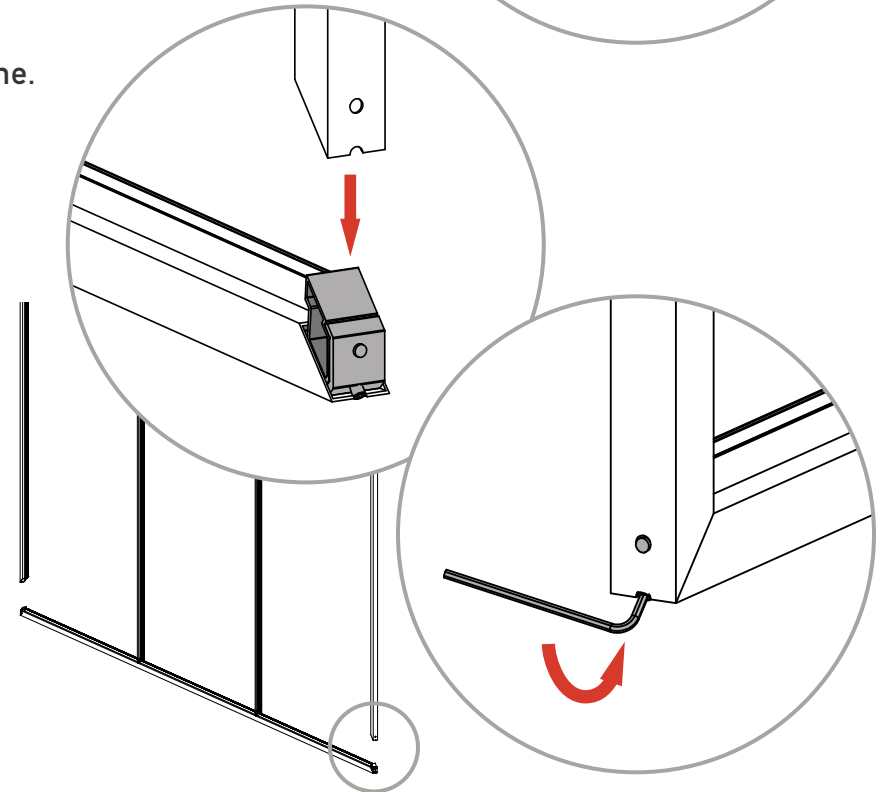

TO ENSURE THE CORNER IS PROPERLY SEATED, MAKE SURE YOU ARE WORKING ON A FLAT SURFACE. YOU CAN ALSO USE YOUR FINGERS TO MAKE SURE THE CORNER PINS PROTRUDE EVENLY ON BOTH SURFACES BEFORE TIGHTENING WITH THE ALLEN KEY.

**E**

Insert the remaining corner pieces into the ends of the top frame.

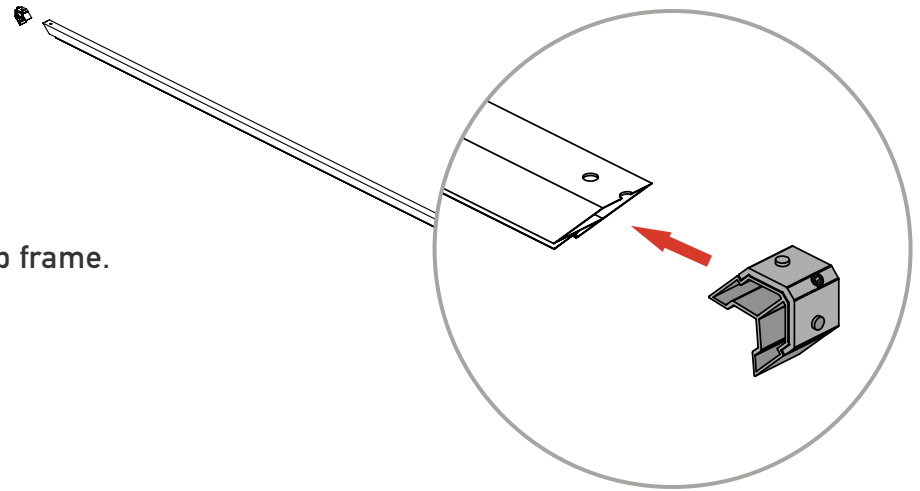

**F**

Take the top frame and simultaneously insert the aluminum tabs into the center uprights and the corner pieces into the side uprights.

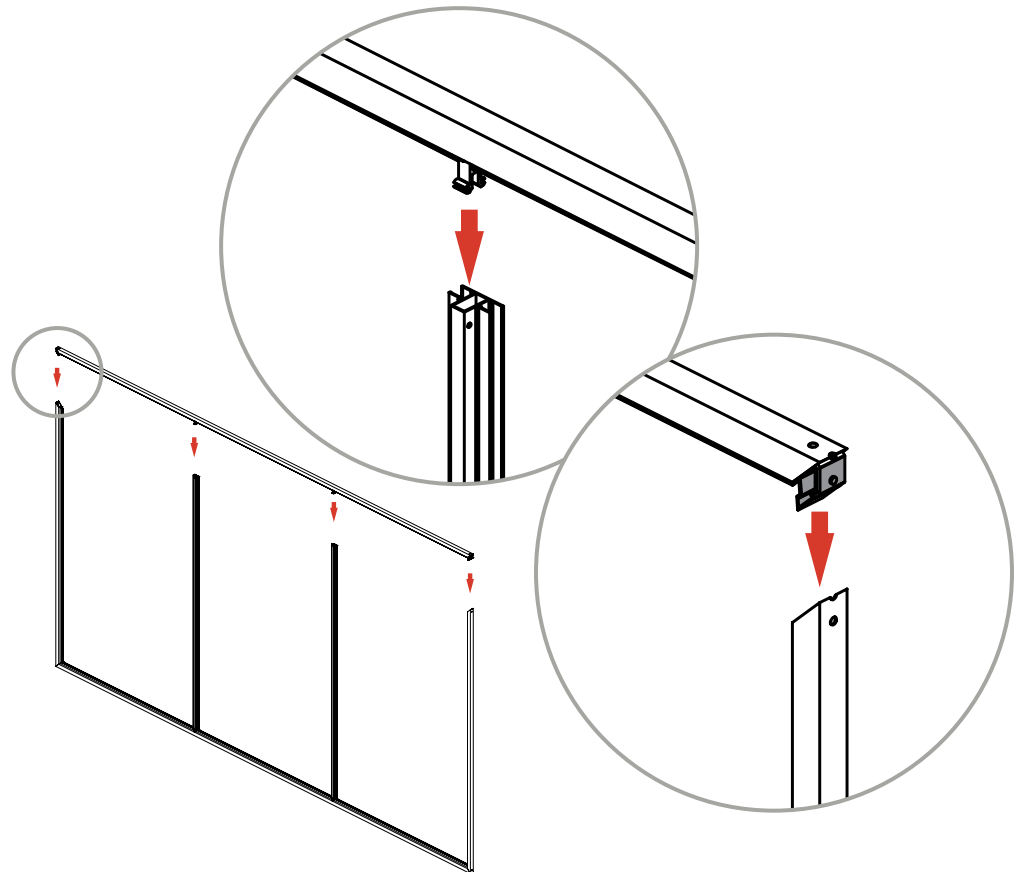

**G**

Attach the center uprights to the top frame by inserting the screws into the screw holes at the top of the center uprights.

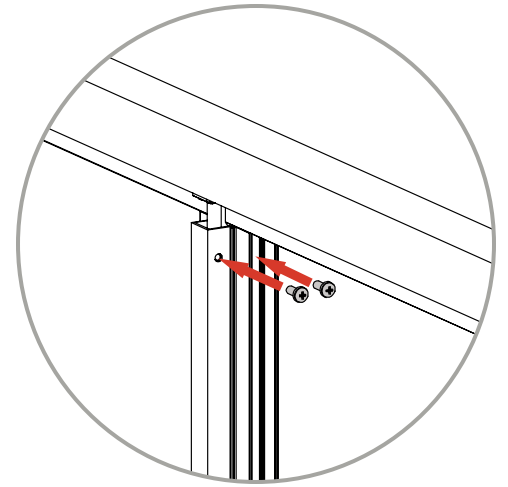
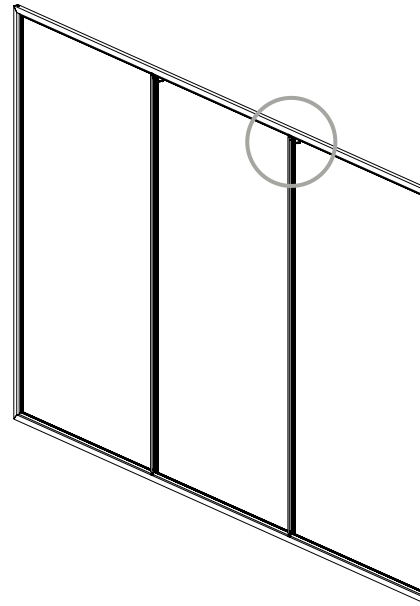

**H**

Use the Allen key to tighten the top corners so they are 90 degrees.

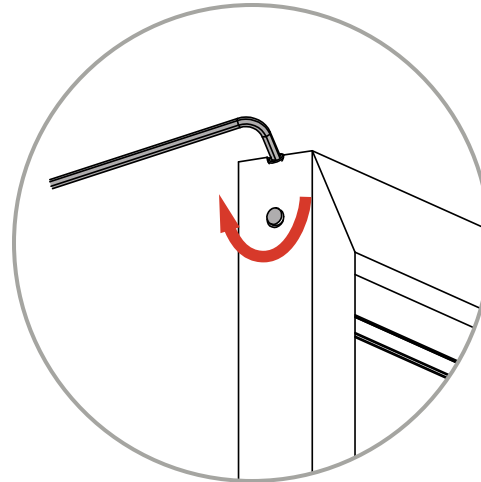

**I**

Securely tighten all four corners and ensure the frame ends are perfectly aligned.



# 2

## ASSEMBLING A FRAME WITHOUT CENTER UPRIGHTS

### A

Take the bottom frame and insert two of the four corner pieces into the ends of the bottom frame.

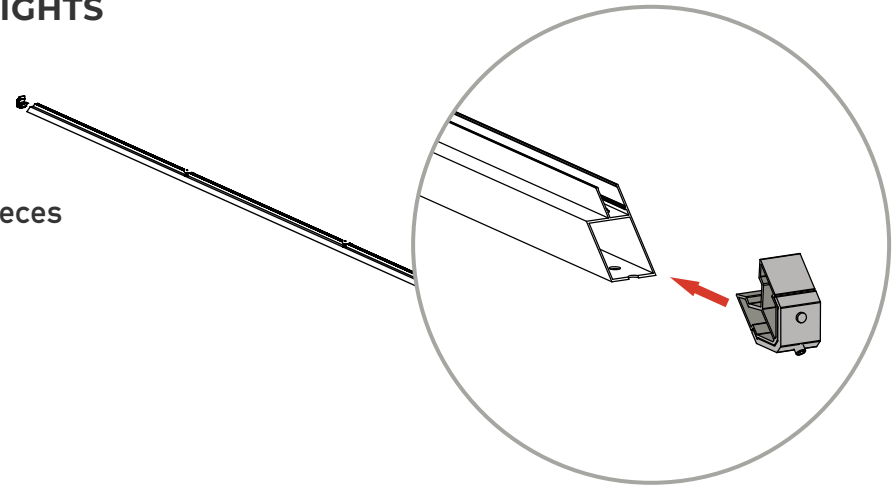

### B

Slide the side uprights on to the corner pieces of the bottom frame. Use the Allen key to gently tighten the bottom corners so they are 90 degrees.

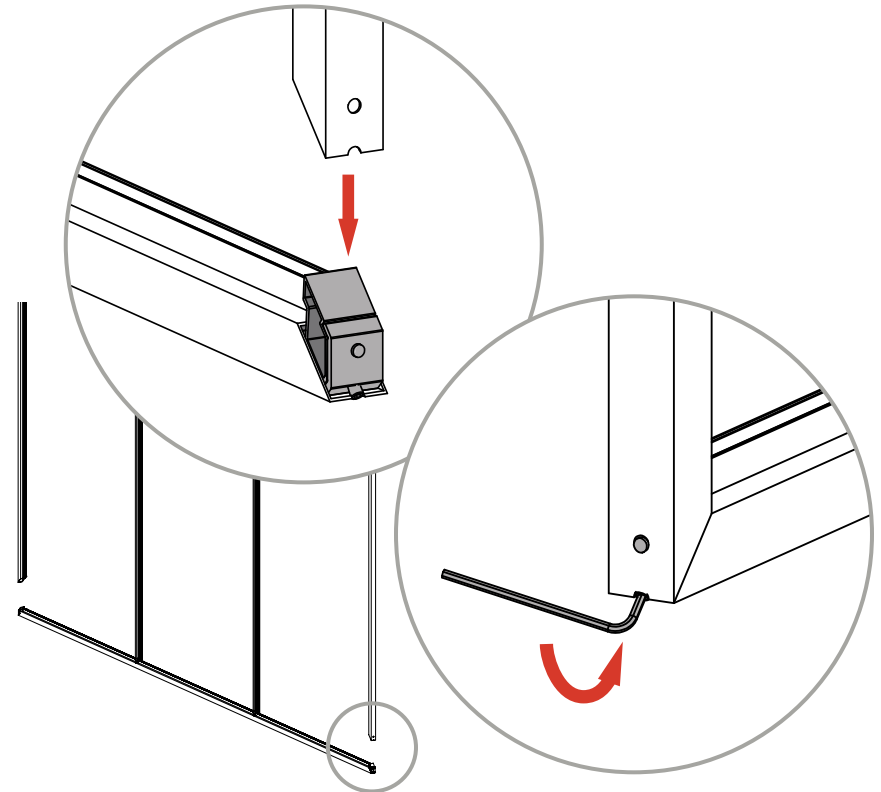

TO ENSURE THE CORNER IS PROPERLY SEATED, MAKE SURE YOU ARE WORKING ON A FLAT SURFACE. YOU CAN ALSO USE YOUR FINGERS TO MAKE SURE THE CORNER PINS PROTRUDE EVENLY ON BOTH SURFACES BEFORE TIGHTENING WITH THE ALLEN KEY.

**C**

Insert the remaining corner pieces into the ends of the top frame.

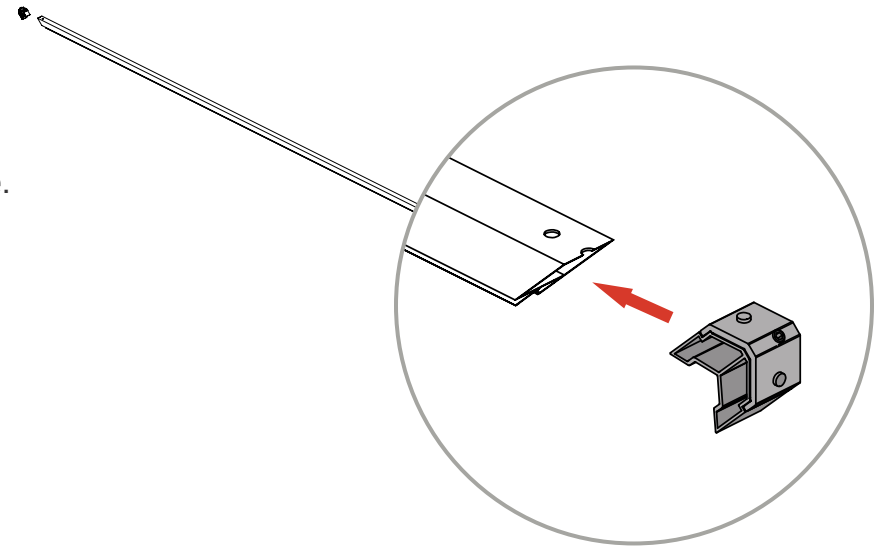

**D**

Take the top frame and insert the corners into the side uprights.

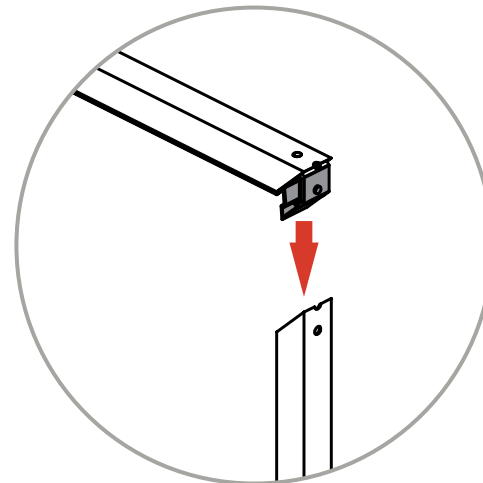

## E

Use the Allen key to tighten the top corners so they are 90 degrees.

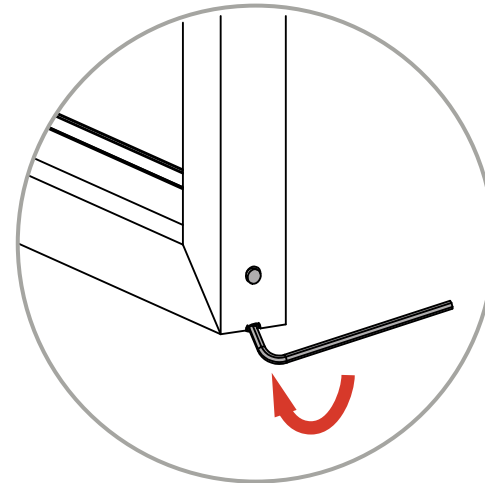

## F

Securely tighten all four corners and ensure the frame ends are perfectly aligned.

## FRAME INSERTION

# 3

### A

Make sure the dimensions of the opening allow the frame to fit inside the opening without being forced.

The widest part of the frame must be on the outside of the opening.

### B

Slide the frame into the opening.

### C

Using all the screw holes around the edge of the frame, secure the frame with appropriate screws for the material the frame is being attached to.

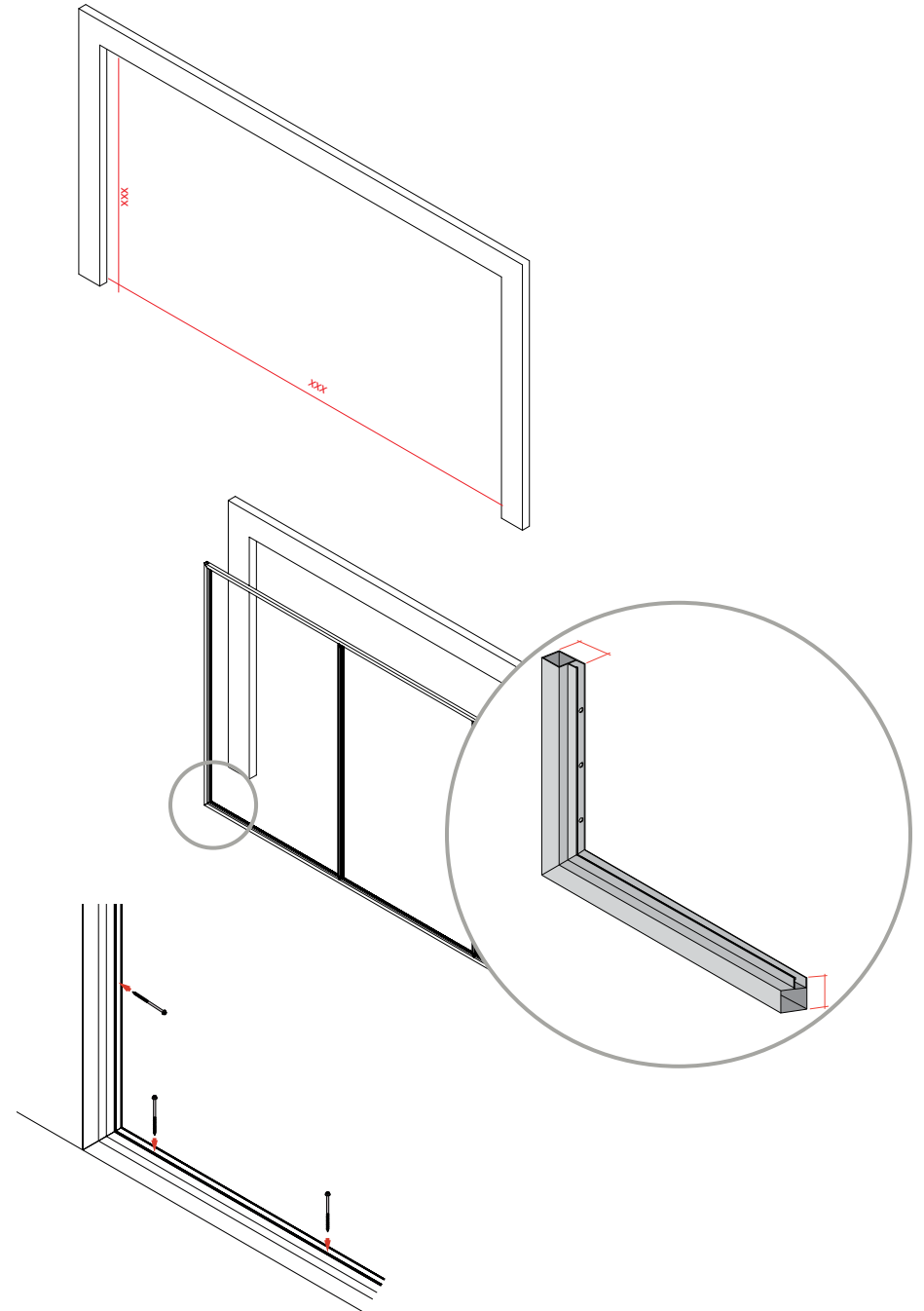

## INSTALLING THE CAPPING

4

A

Take the U-shaped caps without holes and slide them into the inner grooves of the top and bottom frames.

If you have more than two panels, the longest U-shaped caps must be used for the center panels.



THE U-SHAPED CAPS WITH HOLES ARE MARKED WITH AN ARROW.

B

Slide the U-shaped caps with holes into the left or right groove of each panel ensuring that the arrows point upward.

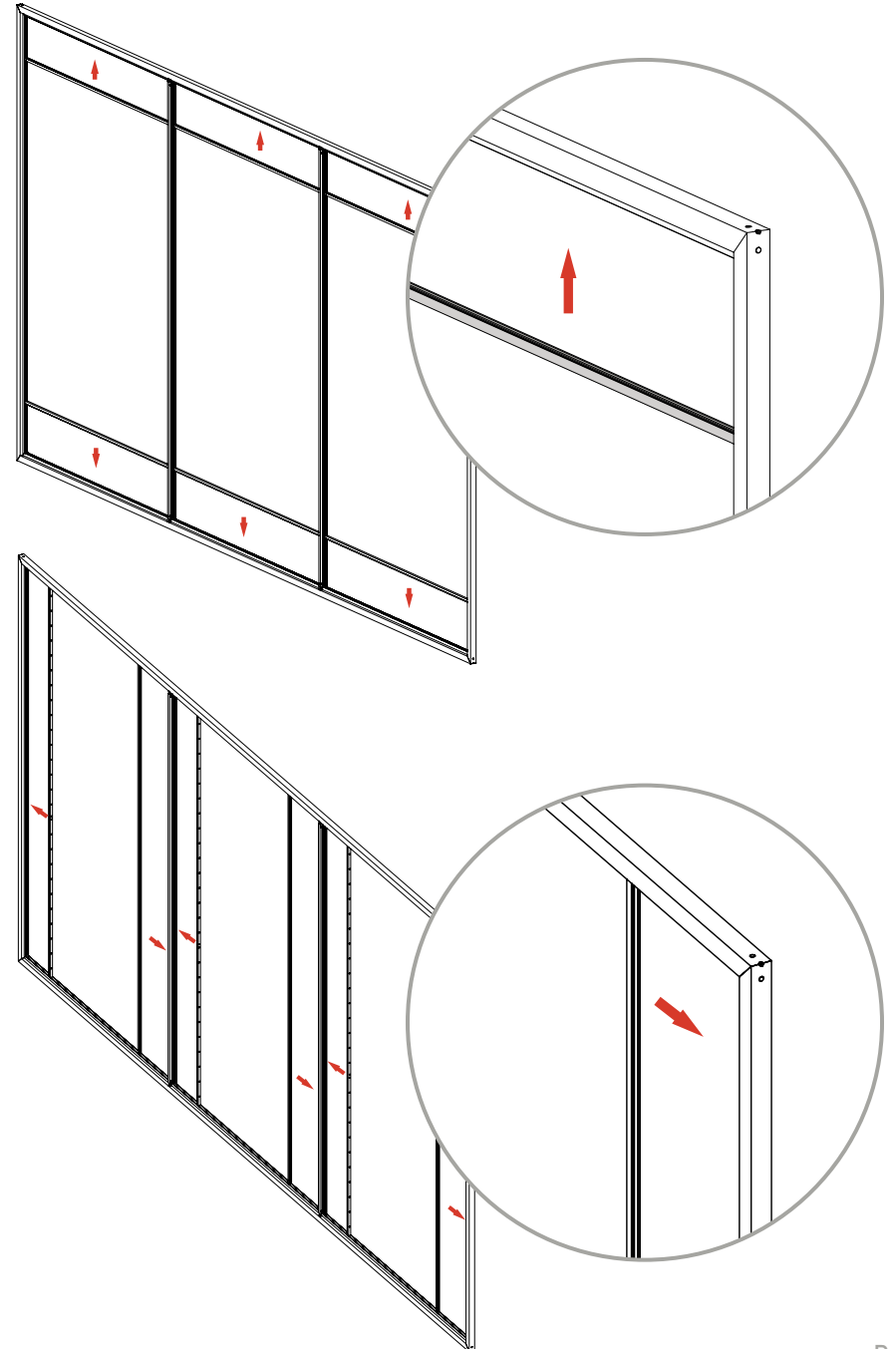

## INSTALLING THE SLATS

5



IF YOU HAVE MORE THE TWO PANELS,  
THE LONGEST SLATS MUST BE USED  
FOR THE CENTER PANELS.

**A**

Starting with the operating slat, insert it into the side U-shaped cap in the hole marked by a colored dot. Insert the side with the P-shaped plastic part first, making sure the plastic part that protrudes points upward and toward the inside of the panel. This side will be the operating profile side.

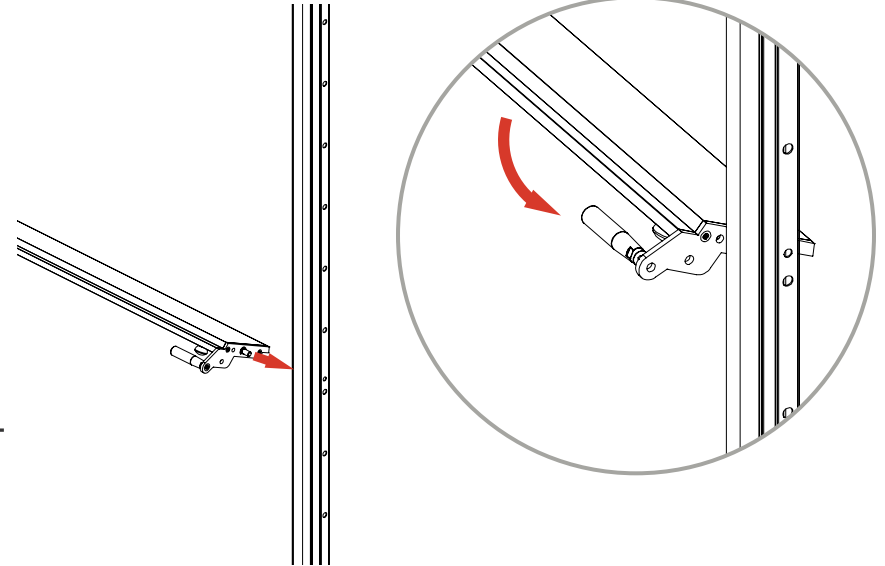

**B**

Slide the other end of the slat into the opposite hole marked by a colored dot by pressing on the sliding plastic rod, which allows it to go into the opposite hole.

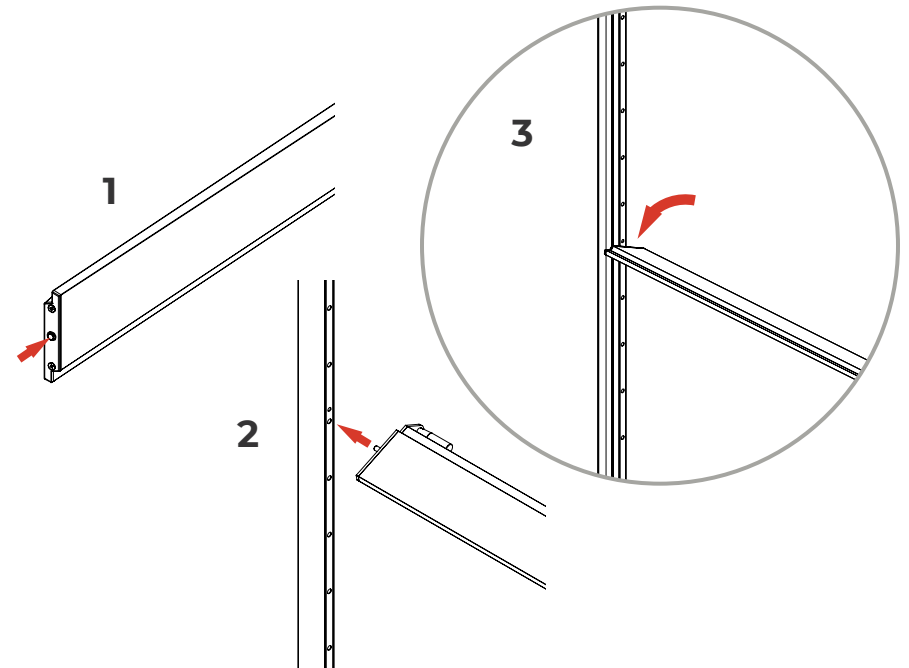

**C**

Repeat steps 5A and 5B for each slat, starting with the bottom slats and moving upward.

## INSTALLING THE CENTER CAPPING

6

A

Clip the center caps on to the center uprights.

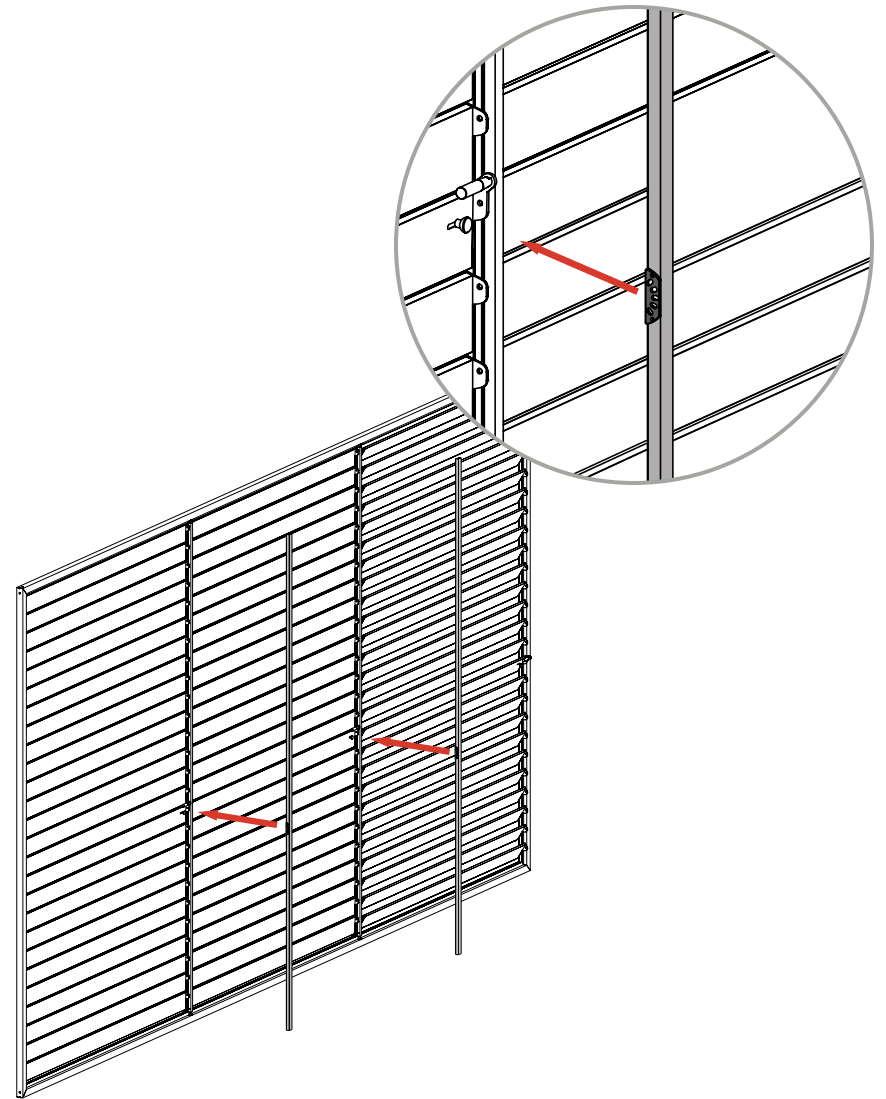

## INSTALLING THE OPERATING PROFILE

# 7

### A

With the operating profile outside the P-shaped plastic parts on the slats, insert the plastic sprocket from the inside to the outside of the panel.

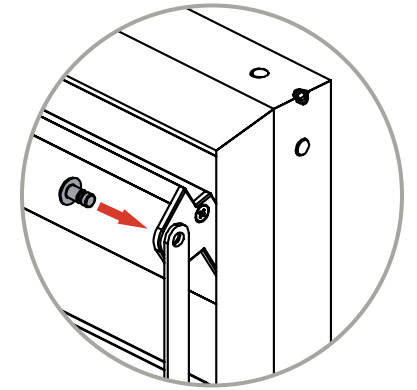
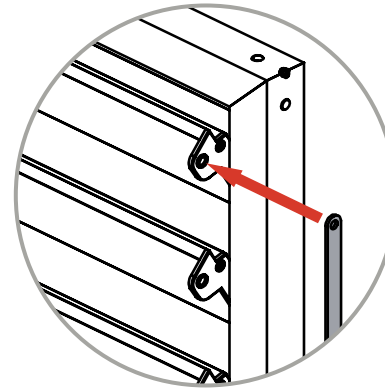

### B

Slide the hollow plastic locking piece onto the sprocket and clamp the sprocket with the narrowest hole in the locking piece facing the sprocket.

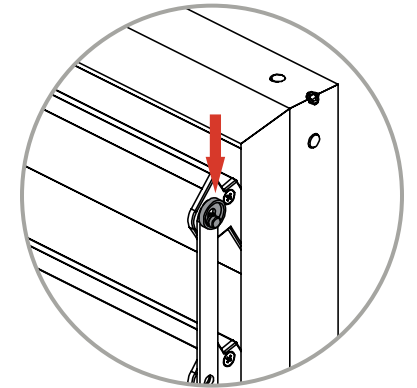
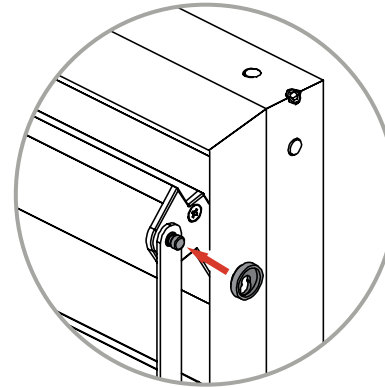

### C

Insert and clip the plastic clip inside the plastic locking piece.

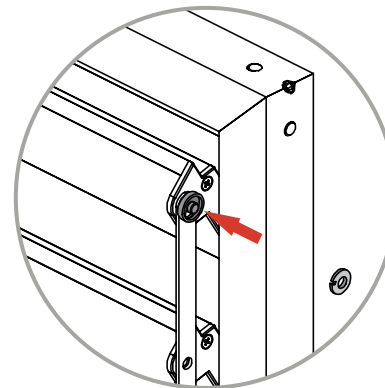

### D

Repeat steps 8A to 8C for each of the slats.



# TERRA SUMMER

1-800-515-6652

[info@terrasummer.com](mailto:info@terrasummer.com)

[terrasummer.com](http://terrasummer.com)