

WIWIURKA

Pikler Arch Tutorial



Greetings from Wiwiurka workshop.
Thank you for purchasing a handmade toy.



Assembly time: 30/40 minutes.
Difficulty level: basic.

Please make sure you have the following parts:

Parts



X9

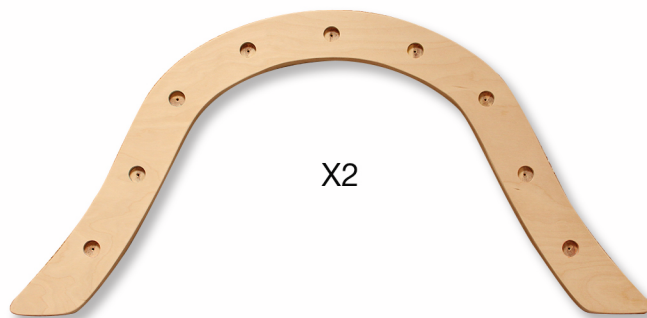

X2



X18



X18

WIWIURKA

For the assembly you will need:

Electric or manual screwdriver.

Before starting:

- Assemble this item on a soft surface such as cardboard or carpet, to protect the pieces.
- Remove all wrapping material before you start to assemble.
- Organize all your pieces in advance. Sorting will make assembly more efficient.
- Do NOT tighten all screws until completely assembled.
- Keep hardware parts out of reach of children.

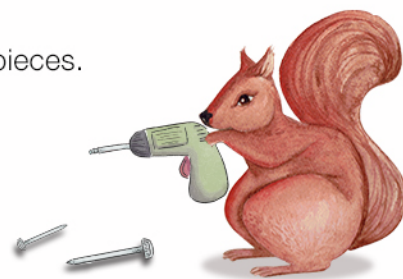

Instructions:

Attach rods to the first arch panel using the screws. This process is better done with 2 people.

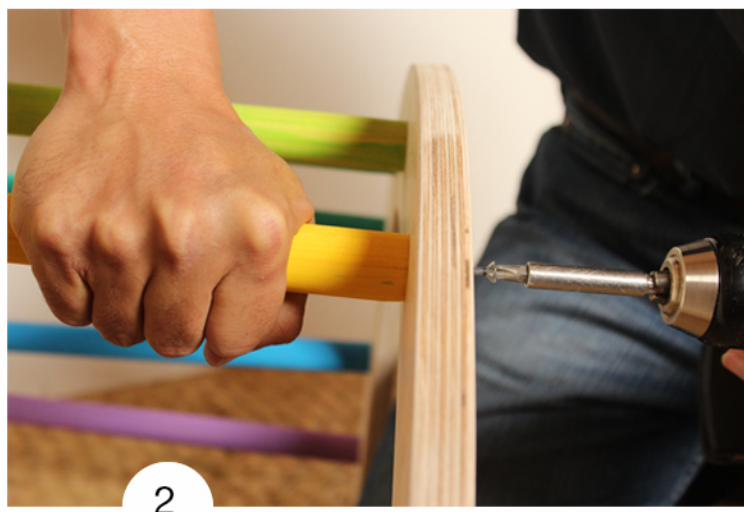
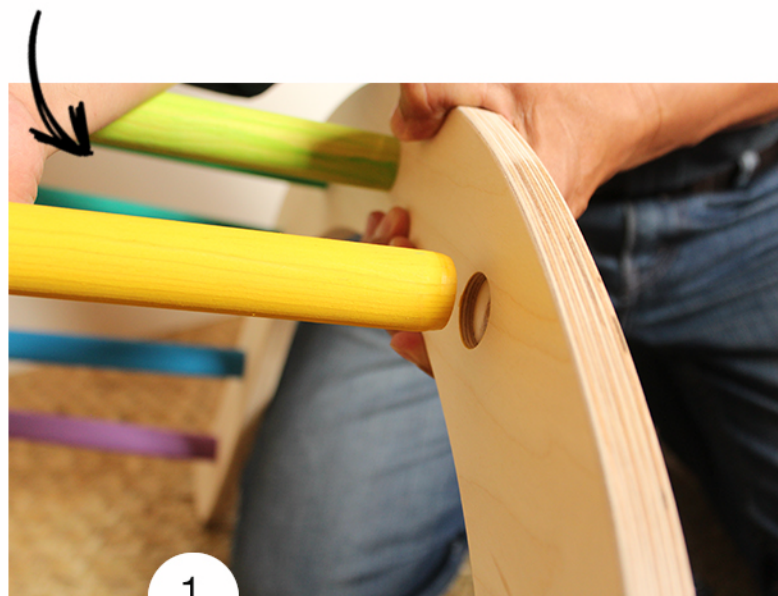

WIWIURKA

Lay the first arch panel on a flat surface with rods facing up. Carefully insert the rods in the second arch panel making sure they align with their slots, and attach them using the screws.

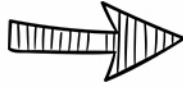

Place the arch on a flat level surface to make sure the arch is level and then tighten the screws. Press firmly. In case the arch is not level, loosen the screws and re-tighten as needed.

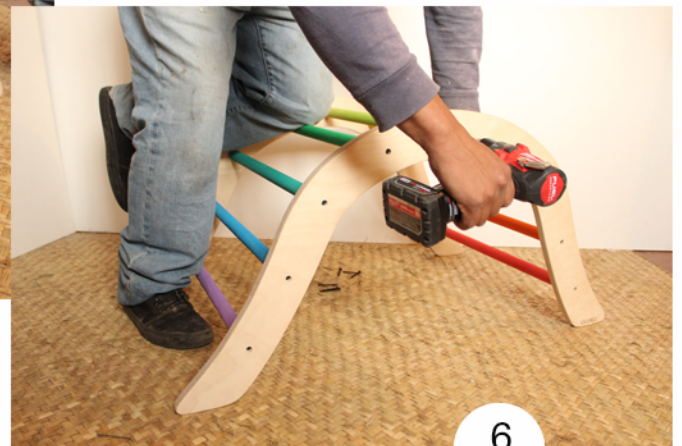

WIWIURKA

Apply a small amount of wood glue on the screw caps, insert them in the countersink applying pressure and let dry.



Safety & Care instructions:

- Place the Pikler Arch on a non-slip mat or surface.
- Age range: 9 mths to 30 mths
- Maximum weight limit: 70 lbs
- Avoid contact with water as this may damage the wood.
- Wipe with a soft dry cloth to protect finish, avoid the use of chemicals or household cleaners.
- Never leave children alone without adult supervision.

Questions and suggestions:

hola@jugueteswiwiurka.com