







Kugellager Auszieh-Satz, K-22-B

Set of bearing extracting tools, K-22-B

www.KUKKO.com/K-22-B



Inhalt/ Contents

Inhalt/ Art.-No.	mm	Inhalt/ Art.-No.
 21-5	28-40	 KS-22-01-GH
21-6	35-46	 G-22
21-7	45-58	 22-2
21-8	56-70	

Wichtiger Tipp/ Important Tip

G-22

Im Set enthaltener 3-K Griff zur besseren Führung des Abziehvorganges mit Gleithammer.

3-K handle for slide hammers including the set for improved guidance during the removal process.

- Gute Haptik durch ergonomischen Griff.
Good surface feel due to ergonomic handle.
- Für maximale Kraftübertragung auch bei nassen und öligen Händen.
For maximum transfer of force, even when hands are wet or greasy.
- Alles fest im Griff – vor, während und nach dem Abziehvorgang.
Secure grip – before, during and after the removal process.



Garantie-Erweiterung/ Guarantee-extension



**GARANTIE-ERWEITERUNG
AUF 5 JAHRE**
GUARANTEE-EXTENSION
TO 5 YEARS

register.kukko.com



Sicherheits -und Gebrauchshinweise/ Safety instructions

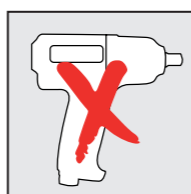
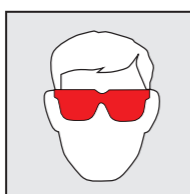
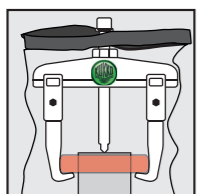

INFO: Gleithammer und Innenauszieher/ INFO: slide hammer and internal extractors

Kombination von Gleithammer mit 2- und 3-schaligen Innenauszieher

Combination of internal extractors with slide hammer

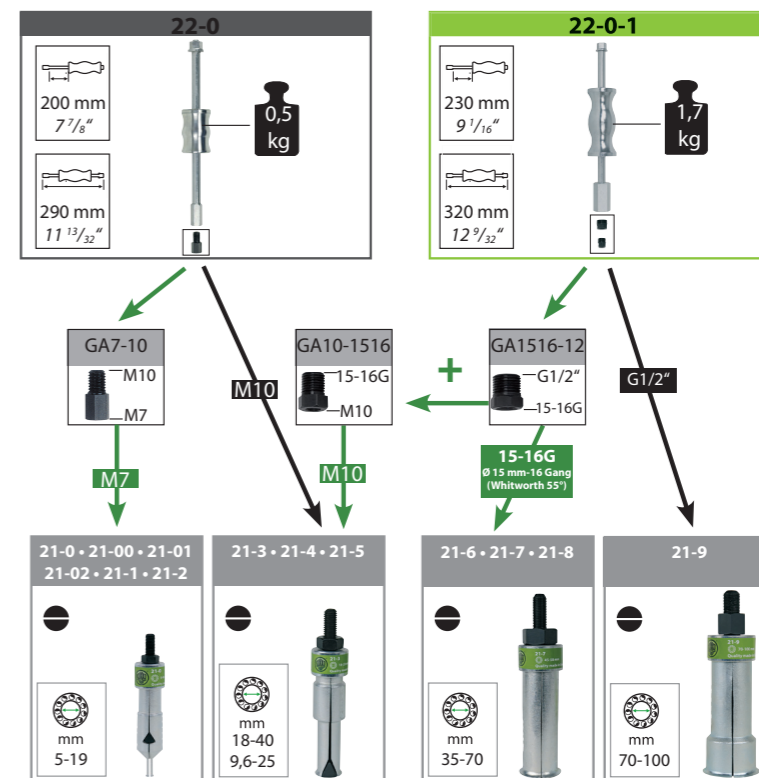

INFO: Gegenstützen und Innenauszieher/ INFO: counterstays and internal extractors

Kombination von Gegenstütze mit 2- und 3-schaligen Innenauszieher, Serie 21

Combination of internal extractors with counterstays

