

## INSTALLATION OF 'OUTBACK' ROOF CONSOLE

### 200 SERIES LANDCRUISER GXL 9/07 – CURRENT

PART NO. RC200

For this installation you will need a **long** Phillips screwdriver, **short** Phillips screwdriver, electric or battery drill, 'stubby' 3.5mm drill bit, **sharp** Stanley knife and electrical tape.

#### **VEHICLE PREPARATION:**

Switch interior light to off position, remove interior light from roof and disconnect plug. Remove globe and put away with light for refit at a later date. Wrap plug in bubble wrap, tape up to avoid rattling and tuck back into cavity in roof.



Remove front light pod from roof of vehicle; to do this lower sunglasses holder and pop out two small plastic inserts covering holding screws, undo screws and retain for console installation. Pull down hard on front of light pod to unclip from roof, unplug light pod from wiring harness and put aside for refit to vehicle at a later date.



**Front Mounting Bracket installation:** Use **long** Phillips screwdriver and fasten the Front Mounting Bracket to plastic fixing plugs for light pod using the two original screws.

**Rear Fixing Bracket installation:** Slide Rear Fixing Bracket forward over front metal lip of interior light hole. Use a Stanley knife to cut a small section of roof lining away first to allow bracket to slide all way forward ensuring bracket is in **centre** of light hole. Using a small electric or battery drill insert a 'stubby' 3.5mm drill bit with **only 20mm protruding from chuck**, carefully drill up through one hole in Rear Fixing Bracket and fasten using 12# x 12mm Phillips screw. Drill up through other hole and fasten using 12# x 12mm screw.



#### **INSTALLATION PREPARATION:**

Connect console wiring extension supplied to console wiring loom; connect **red to red**, **white to white** and **yellow to yellow**. Tape up all connections.

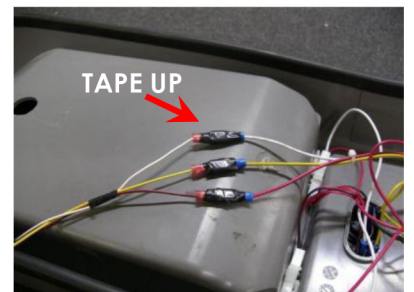

**Comfortable work position:** Slide seats all way back; if right handed, sit in passenger seat; if left handed, sit in driver seat.

**Console and rear interior light wiring:** Stand console upright on front seat and plug console wiring into front lighting harness.

Close doors and test lights. There is an on/off switch located behind front lights, when switch is **off** it acts as a kill switch; no lights will work. When switch is **on** lights will work independently as map/interior lights when doors are shut and timer switches off. When doors are opened lights will work as door/interior lights.



### **CONSOLE INSTALLATION:**

Use 'Blu-Tack' in fit kit to adhere one of the 6mm x 30mm round head bolts to **long** Phillips screwdriver, put a small amount of 'Loc-Tite' on thread and store in convenient location, eg: in/on centre console.

Hold console up in position **over Front Mounting Bracket** ensuring bracket slides/fits in between front of console and rear of radio surround/storage tray. Look up under rear mounting hole and line up captive nuts in Rear Fixing Bracket with slotted fastening holes, tuck wiring loom out of way so as not to jam between console body and bracket. **Loosely** fasten console up to one of the captive nuts in Rear Fixing Plate using the 6mm x 30mm bolt 'Blu-Tacked' to screwdriver.

Push up hard on front of console and **finger fasten** front of console to Front Mounting Bracket using the two 6mm x 16mm **black** Phillips head bolts supplied. Then do bolts up tight using **short** Phillips screwdriver.

'Blu-Tack' other 6mm x 30mm round Phillips head bolt onto screw driver, apply 'Loc-Tite' and fasten into Rear Fixing Bracket; tighten both bolts. **NOTE:** *Only tighten rear bolts up firm so console is held to roof. **DO NOT** tighten so as to bend rear mounting plate downwards; do rear bolts up with equal tension.*

Open Locker Box and remove Microphone Cable Holder and Rear Mounting Hole Cover from inside; fasten Hole Cover in place using screws supplied. Fasten Microphone Cable Holder in place as per radio installation instructions.

## **Fit Kit: RC200**

- One (1) Front Mounting Bracket
- One (1) Rear Fixing Bracket
- One (1) Console wiring adaptor
- Two (2) square plastic grommets (GX model only)
- Two (2) 10# x 16mm self tapping screws (GX model only)
- Two (2) 12# x 12mm Phillips self tapping screws
- Two (2) 6mm x 16mm **black** Phillips round head bolts
- Two (2) 6mm x 30mm Phillips round head bolts
- One (1) Small piece of 'Blu Tack'
- Three (3) x 100mm Sticky back foam pieces

# RADIO INSTALLATION

## Radio Insert Installation: for smaller size radios

**PLEASE NOTE: Radio Inserts NOT INCLUDED.**

Decorative side of insert faces outwards and snaps out over bottom of tray surround.

To install insert, squeeze top and bottom together; push/bend sides and squeeze into tray surround from inside to outside until bottom lip on decorative side of insert snaps/pops out over bottom of tray surround, prize with fingers to ensure bottom lip of insert is in place over tray surround as described. **Do not** scratch or mark insert or surround by prising/levering with tools; use hands/fingers only.



## Radio Installation:

Place protective cover on work bench to avoid scratching console. Place console on protective cover and using a sharp knife cut a 30mm x 100mm section out of storage tray 25mm in from where rear of radio will be when installed. Use a small amount of methylated spirits on a clean cloth to clean exposed part of console and bottom rear of radio.

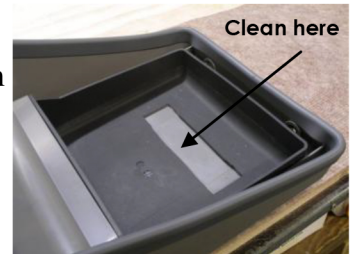

Peel one side of protective backing from foam strip supplied; apply pressure with palm of hand to adhere foam to exposed part of console. Peel backing off other side of foam strip and add one or more strips of foam to suit different size radios (see chart below). This will keep radio level with bottom of surround.



Insert radio on an angle until radio protrudes 15mm out over bottom of tray surround or insert and straighten; lay flat onto sticky back foam and apply firm pressure to top of radio with palm of hand for 30 seconds to ensure good adhesion.



## Sticky back foam chart:

- One (1) strip- standard size radios
- Two (2) strips- Icom and Uniden
- Three (3) strips- GME Electrophone

## Microphone and Microphone Cable Holder installation:

Install in a position that suits best, depending on vehicle and Radio model. Ensure microphone or microphone cable and holder does not foul on sun visor when pulled down.



Microphone clip on slight angle



Left hand cable outlet radios



Microphone clip on acute angle