



# Encapsulation Installation Manual



**YOUR GUIDE TO CONFIDENCE  
FROM THE GROUND UP**



FOR TRAINING VIDEOS AND ADDITIONAL RESOURCES, VISIT  
[YOURCRAWLSPACE.COM](https://yourcrawlspace.com)

## Introducing Our Innovative, Damage-Free System

Ready to learn how to install the crawlspace encapsulation industry's most innovative and effective system? The **Your Crawlspace System** is the only proven, patented, and permanent solution on the market, offering a complete seal *without the use of mechanical fasteners*.

It's also the safest and simplest system to install, cutting the average labor time in half and backed

by a 25-year warranty. The finished product will be a beautifully encapsulated crawlspace that will reduce moisture, conserve energy, preserve value, and provide a healthy living environment throughout the home.

[Let's get to work!](#)

# Details Before We Dive In

There are a few things you should know before beginning the **Your Crawlspace** installation process. Please be sure to read the following page carefully.

## YCS WALL AND PIER ADHESIVES

The Your Crawlspace Magic Sealant/Adhesive is VOC compliant and works on almost all foundation walls in any condition.\* The adhesive will attach to metal, brick, wood, stone, block, dirty, wet, dry—even over spiderwebs! Consider a test spot if you are concerned your foundation may not receive the adhesive. Please contact YCS with any questions.

*\*Longer curing times if below 40 degrees. Do not leave products outside in cold conditions before installation.*

## BUILDING CODE COMPLIANCE

Due to local building code variations, home owners are responsible to verify and comply with all local codes and requirements. If there are any questions or concerns with the structure, or any of the systems in the home a professional foundation contractor should be consulted. If the home has a pest control contract, we also recommend consulting the company to be certain they approve the system. Some companies require treatment before installation and a wider inspection strip than the building code. The Your Crawlspace system complies with the International Residential Code.

## CERTIFICATION AND TRAINING

For certification and training on the YCS System please contact us. We can come to your location or we offer quarterly training opportunities at our facility here in Charleston, SC.

**PRO TIP:** If you're familiar with crawlspace encapsulations or sealed vapor barriers, please follow our procedures and don't use past techniques to attach our system to the foundation wall.

Please only follow the instructions laid out in this manual. Not only can drilling holes or using mechanical fasteners damage the foundation wall, they will compromise the effectiveness of the Crawl Curtain. If used as instructed, our system will save hours of labor costs, be easier on installers, and perform better than any other system. These installation instructions have been extensively tested in the laboratory and in thousands of homes nationwide.



# THE YCS PROCESS

## Step 1: GET TO KNOW YOUR CRAWLSPACE.

Before we get into the installation, let's review some of the more common terms for parts of the crawlspace. By getting familiar with these terms,

you will have a clearer understanding of the installation process.

*(See instructional videos at [YourCrawlspace.com](http://YourCrawlspace.com))*

## Step 2: CONDUCT YOUR INITIAL CRAWLSPACE INSPECTION.

Prior to installing any new materials, an assessment of the crawlspace should be done to determine the extent of preparation involved. By checking this list beforehand, you can be sure your crawlspace will be a safe place to work.

If any of the items on the checklist are problem areas, they need to be either removed or repaired as required.

For example, if there is standing water in the

crawlspace, then that water needs to be either pumped or siphoned out and the low area filled in with dirt so water will not accumulate there. You may consider a sump pump.

We want to make sure that the crawlspace is a safe place to work, so if there are any damaged wires, duct work, or broken plumbing, please make repairs as required to meet your local code. If there are items in question, please consult with a building official or a construction professional.

- \_\_\_ Check for adequate access to the crawlspace
- \_\_\_ Debris in space (garbage, building materials, etc.)
- \_\_\_ Check for Insects (termites, wasps, bees, etc.)  
*May need to treat for pests before install.*
- \_\_\_ Look for animals or other critters (rodents, snakes, etc.)
- \_\_\_ Check for pooled water on ground
- \_\_\_ Check for wet or damp ground in the crawlspace
- \_\_\_ Note levelness of dirt in crawlspace
- \_\_\_ Crawlspace Insulation (fiberglass, foam)
- \_\_\_ Check wood joists & framing condition
- \_\_\_ Verify column & support locations
- \_\_\_ Note drain & vent piping locations
- \_\_\_ Note water supply piping locations
- \_\_\_ Check for plumbing drain leaks
- \_\_\_ Check for sump pumps & condensation pumps
- \_\_\_ Verify ductwork condition and locations
- \_\_\_ Note air handlers and fan locations
- \_\_\_ Note foundation vents
- \_\_\_ Note wiring and other electrical devices
- \_\_\_ Check for adequate lighting
- \_\_\_ Check exterior drainage around house
- \_\_\_ Gutters and downspouts
- \_\_\_ Ensure that water is directed away from the foundation
- \_\_\_ Is there a gas operated system in the crawlspace?  
*\*Must be vented properly.*

### **Step 3: PREPARE AN ACCURATE SKETCH BASED ON MEASUREMENTS INSIDE THE CRAWLSPACE.**

Take note of all item locations that will need to penetrate the material, such as supports and pipes. Ask about our YCS sketch app to assist with this.

*(See YCS System instructional videos at [YourCrawlspace.com](http://YourCrawlspace.com))*



### **Step 4: CHECK THAT YOUR CRAWLSPACE ACCESS PANELS OR DOORS ARE LARGE ENOUGH TO EASILY ENTER AND EXIT THE CRAWLSPACE.**

It is recommended that the door is at least 4" higher than exterior grade and that the door is made of a non-corroding material. Use foam weather striping or other means to seal the door

air tight when closed and provide a positive means to hold the door closed such as hasps and latches.\*

*\*See the YCS slot/lock crawlspace doors.*

### **Step 5: ENSURE THAT ALL DEBRIS IS REMOVED.**

This includes wood, cans, tires, bottles, masonry block, bricks, large rocks, sharp objects, or anything else that will hold water, attract critters, or possibly cause a material puncture.

Consider the YCS 36 mil premium drain mat vapor barrier for wet or rough areas.

*(See instructional videos at [YourCrawlspace.com](http://YourCrawlspace.com))*

### **Step 6: PROVIDE ADEQUATE LIGHTING.**

For an efficient installation, proper lighting in the crawlspace is crucial. We recommend two strings of six bulb lights set up in the area, with approximately 15 minutes of setup time.

**PRO TIP:** We recommend creating negative air pressure to reduce dust into the living space, by using an exhaust fan/air scrubber with a hose at the crawl door.

## **Step 7: INSPECT THE TOP 3 TO 12 INCHES OF INSIDE OF THE FOUNDATION WALLS AND OTHER SUPPORT STRUCTURES.**

This inspection is to ensure the area will receive the adhesive. Consider testing a spot if in question.

## **Step 8: ENSURE THAT CRACKS AT SILL PLATE AND BOTTOM JOIST ARE SEALED AIR TIGHT.**

YCS Magic Sealant/Adhesive is recommended for gaps from 0" to ¼". Spray expanding foam should be used for gaps wider than ¼".

---

## **Step 9: ENSURE THAT A MINIMUM 3" WIDE\* TERMITE INSPECTION GAP IS CLEARLY VISIBLE AROUND THE TOP PERIMETER OF THE FOUNDATION WALL.**

If evidence of termite or other pests are found, be sure to remedy the situation before going further with the installation. If there is a pest management contract, check with the company to ensure that the crawlspace encapsulation system does not interfere their system or warranty if applicable.

*\*May consider a larger inspection area (3" to 12") depending on termite activity in your area. 8 inches up the foundation wall sealed and attached satisfies IRC.*

---

## **Step 10: SEAL FOUNDATION VENTS AND OTHER EXTERIOR WALL PENETRATIONS AIR TIGHT.**

This is accomplished by using our 1" x 8" x 16" flex foam vent cover cut to fit snugly in the interior side of the vent opening. The vent cover can friction fit or can be held in place by YCS adhesive. Use expanding foam or caulk to seal

any other openings and cracks to the outside. Please contact YCS if you are in a flood zone. Our FEMA approved vents may help with flood insurance.

---

## **Step 11: CHECK THAT ALL APPLIANCE DISCHARGE PIPES AND DUCTS TERMINATE OUTSIDE THE CRAWLSPACE.**

This includes any pipes or ducts from kitchen, baths, laundry items, condensate drains, and

most importantly, gas appliances. Make sure they also terminate at the exterior of the building.



## Step 12: LEVEL AND CROWN CRAWLSPACE SOIL TO ELIMINATE THE POSSIBILITY OF STANDING WATER.

Smooth soil to prevent hills and valleys. Grade crawlspace floor to one or more low points. Provide drains or sumps at the lowest points if necessary. Slope all drain piping to daylight.

Crawlspace drains should not be connected to foundation or gutter drains. Consider YCS 36 mil. Premium drain mat if ground is wet.

## Step 13: TAKE ALL APPLICABLE MOISTURE CONTROL MEASURES.

Note that some of these suggestions will not apply to all installations, but each must be taken

into consideration and addressed if they apply to your home.

- Ensure that the slope of exterior finished grade is away from the building. Provide a method to transport roof runoff away from the house, such as gutters and downspouts.
- Exterior of foundation wall surfaces should be waterproofed when the crawlspace is located below exterior grade.
- If required, provide drainage from under the vapor barrier to the outside with a sump pump system.
- If the crawlspace elevation is above grade, provide a floor drain in the low point of the floor.
- Provide flood vents when required by local code that will minimize air flow.
- Spray fungi and mildew treatments to trouble areas and below floors of bathrooms or other areas where there is the possibility of leaks. See YCS Cleaners and Benefect Disinfectant.

## Step 14: BASED ON YOUR SKETCH, DETERMINE THE MOST ADVANTAGEOUS WAY TO ORIENTATE THE MATERIAL TO MINIMIZE CUTTING AND JOINTS.

Always cut material to provide a minimum 6" overlap. Use pre-cut material for installation around columns and piers. (See YCS System instructional videos at [YourCrawlspace.com](http://YourCrawlspace.com))

**PRO TIP:** Only one side of the wall and pier curtain will adhere to a concrete, stone, brick, or steel foundation wall or support pier. Our patented material is 100% plastic coated on one side. No adhesive will attach to this side of the material, to the wall, or pier. The other side is completely coated except for a two inch strip at the top. The light blue side with the activation strip goes against the wall and pier. **Be sure that the fibrous activation strip is on the wall side of the material.**

## Step 15: INSTALL MATERIAL AROUND ALL COLUMNS AND PIERS.

Material must be a minimum of 12" up the piers. Use adhesive around the perimeter of the column or pier and use YCS Seam Tape to seal the seam.

Apply adhesive with a bead that is approximately 3/16" to 1/4" in diameter.

## Step 16: INSTALL THE WALL MATERIAL UP THE FOUNDATION WALL, STOPPING 3" TO 12" INCHES FROM THE SILL PLATE.

Use the YCS Seam Tapes for vapor barrier seaming. YCS Seam Tape will NOT work on the foundation wall. If your liner gets wet, the normal tapes will not adhere properly, unless you are using our YCS Magic Seam Tape.

This step is best accomplished by two workers. As one worker applies the adhesive bead near the top of the foundation wall, the second worker follows, pressing the wall material's adhesive sensitive strip into the adhesive bead with his fingertips. Please press the liner completely into the YCS Magic Sealant/Adhesive. Note that too much adhesive will cause prolonged cure times.

**PRO TIP:** If you are using the wall insulation, you'll need to leave the material a minimum of 4" from the top of the sill plate. Use a 3/16 inch bead of YCS Magic Sealant/Adhesive around the top perimeter of the foundation wall.

## Step 17: BEGIN FLOOR INSTALLATION AT THE FURTHEST POINT FROM THE CRAWLSPACE ACCESS DOOR.

Pieces of floor material should be lapped a minimum of six inches. All lap joints are sealed with the YCS Seam Tapes or YCS Seam Weld. Ground

cover should be applied so as to minimize ripples, wrinkles, or stress on the material. Final installation should appear flat.

## Step 18: INSULATE THE BAND JOIST WITH MINIMUM R13 FIBERGLASS BATT INSULATION, OR PER YOUR LOCAL CODE.

Don't skip this step. Putting insulation in the rim joist is very important!



## Step 19: INSTALL A DEHUMIDIFIER.

Most areas will need to have a dehumidifier for several months out of the year to condition the crawl space. Ensure that the dehumidifier has a way to drain condensate water to the exterior of the crawl space. This can be achieved by either gravity or a condensate pump.

Always include the YCS Vent Fan, a code-approved ventilation system for sealed crawlspaces. This fan can be adjusted to provide 1(one) CFM per

50 square feet to meet 2018 IRC (International Residential Code). This fan provides crawlspace air exchange, improves air quality, and extends the life of the dehumidifier (see attached code IRC 2018).

**PRO TIP:** Your state may have variances to the IRC.

## Step 20: INSTALL A REMOTE HUMIDITY MONITOR.



### CONGRATULATIONS ON A PROPERLY SEALED CRAWLSPACE!

By following the YCS System, you've saved time, improved the air quality of the home, and made a lasting investment, all without punching holes in the foundation. That's what we call **confidence from the ground up.**

If you have any further questions for the YCS team, contact us today at **843-887-3247** to speak with an experienced team member.

# APPENDIX

The following pages contain illustrations depicting various types of foundation materials and applications. Use these pages as a reference point to determine which type of foundation and attachment you are working with. Whether the foundation is brick, block, or stone, we have instructions to help you through the process.

## A Sealed Crawlspace on Stone

### APPLICATION: GROUND LINER 6" UP WITH YCS WALL ATTACHMENT TAPE

Check out the diagram below to see how to install the innovative and proprietary **YCS System** on your next project. Our system creates a permanent seal without the use of mechanical fasteners, which means no holes in the foundation—ever.

Ready to get confidence from the ground up? Let's get started.

- 1 Any YCS Ground Vapor Barrier applied 6"-20" up the foundation wall
- 2 3/16" bead of YCS Magic Adhesive
- 3 YCS Wall Attachment Tape

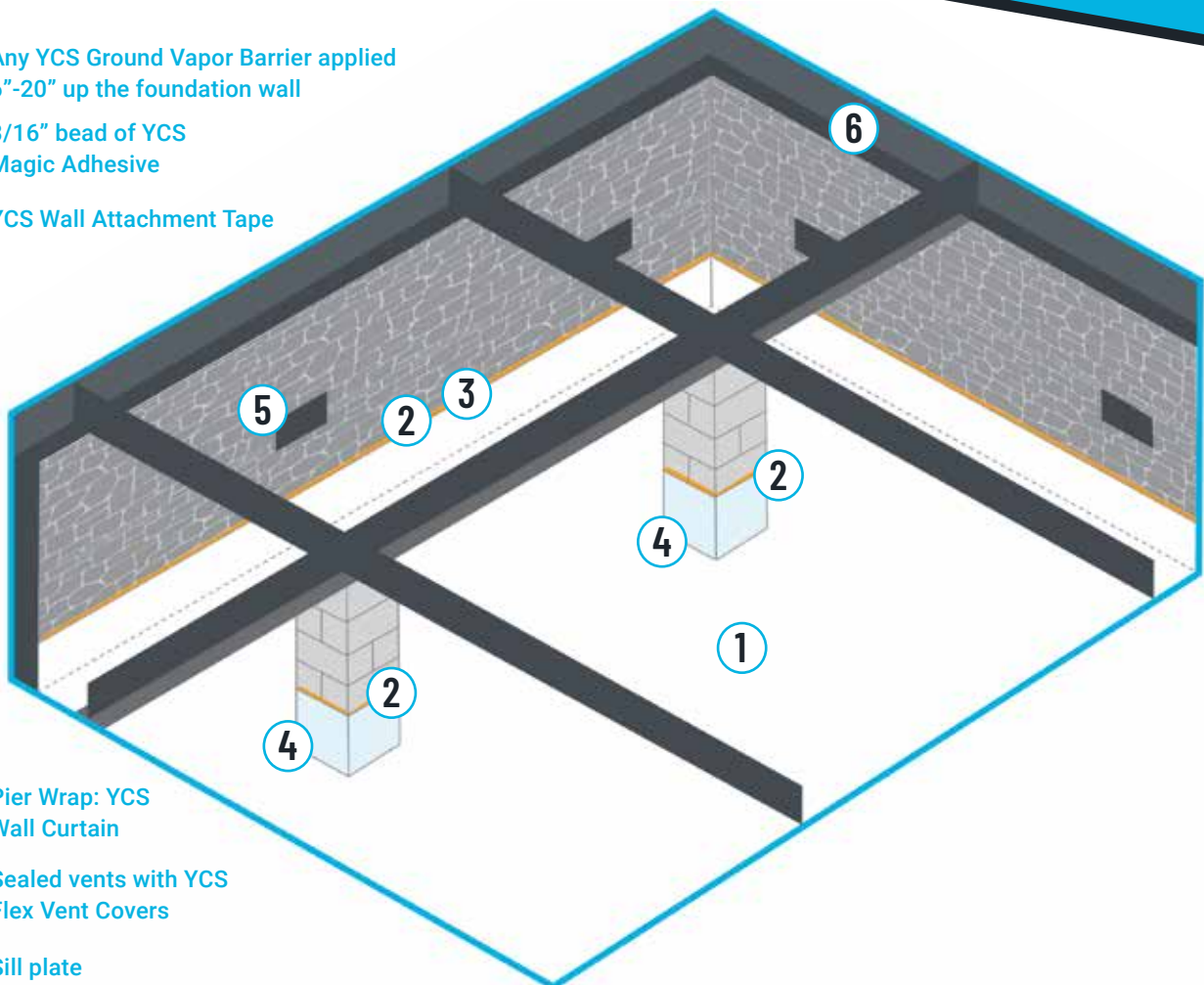

- 4 Pier Wrap: YCS Wall Curtain
- 5 Sealed vents with YCS Flex Vent Covers
- 6 Sill plate

① Any YCS Ground Vapor Barrier

② 3/16" bead of YCS Magic Adhesive

③ YCS Wall Attachment Tape

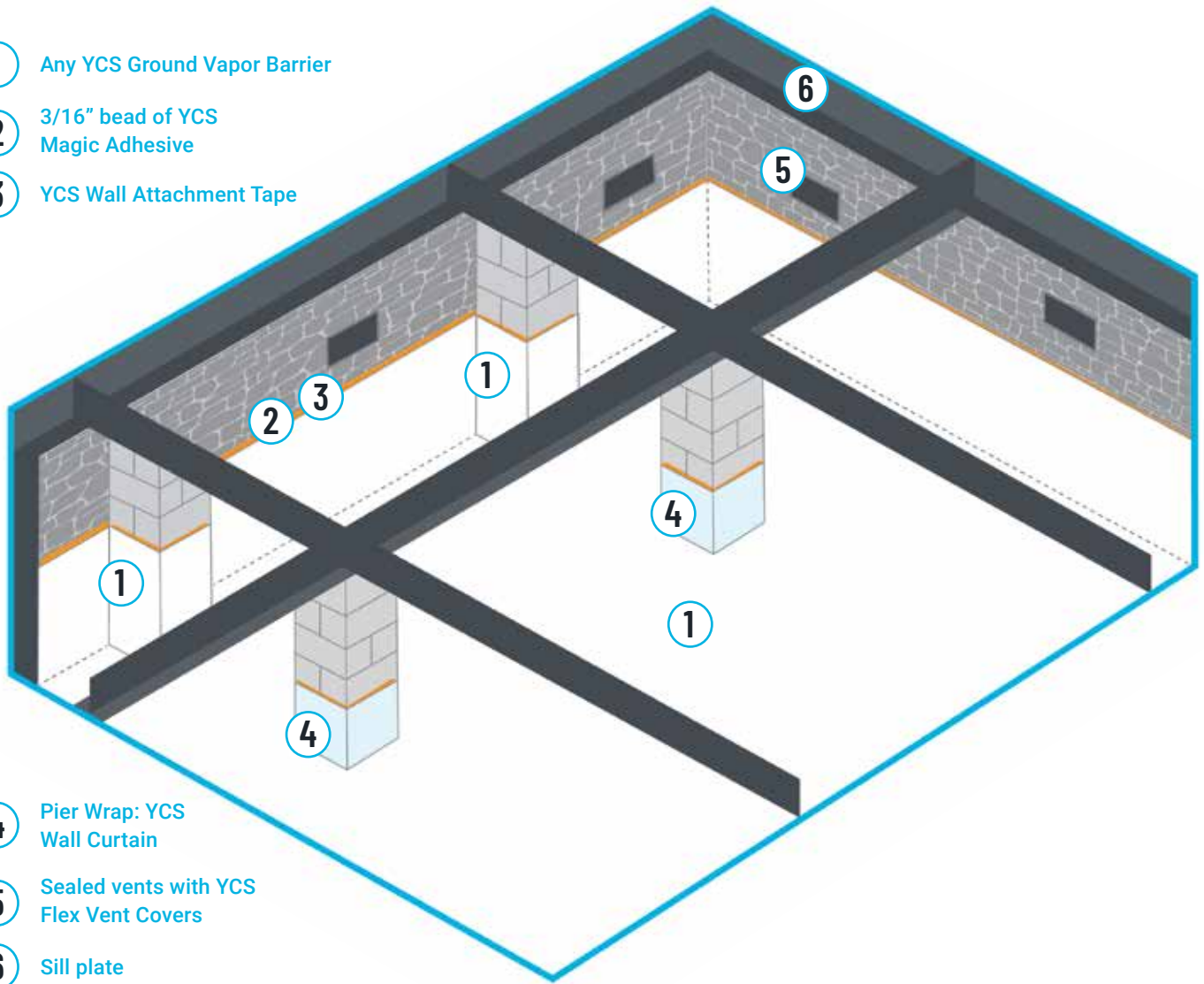

④ Pier Wrap: YCS Wall Curtain

⑤ Sealed vents with YCS Flex Vent Covers

⑥ Sill plate

## A Sealed Crawlspace on Stone

### APPLICATION: YCS WALL ATTACHMENT TAPE

Check out the diagram below to see how to install the innovative and proprietary **YCS System** on your next project. Our system creates a permanent seal without the use of mechanical fasteners, which means no holes in the foundation—ever.

**Ready to get confidence from the ground up? Let's get started.**

# A Sealed Crawlspace on Stone

## APPLICATION: PRECUT LINERS WITH YCS WALL ATTACHMENT TAPE

Check out the diagram below to see how to install the innovative and proprietary **YCS System** on your next project. Our system creates a permanent seal without the use of mechanical fasteners, which means no holes in the foundation—ever.

**Ready to get confidence from the ground up? Let's get started.**

- ① Any YCS Ground Vapor Barrier
- ② 3/16" bead of YCS Magic Adhesive
- ③ YCS Precut Wall Liners

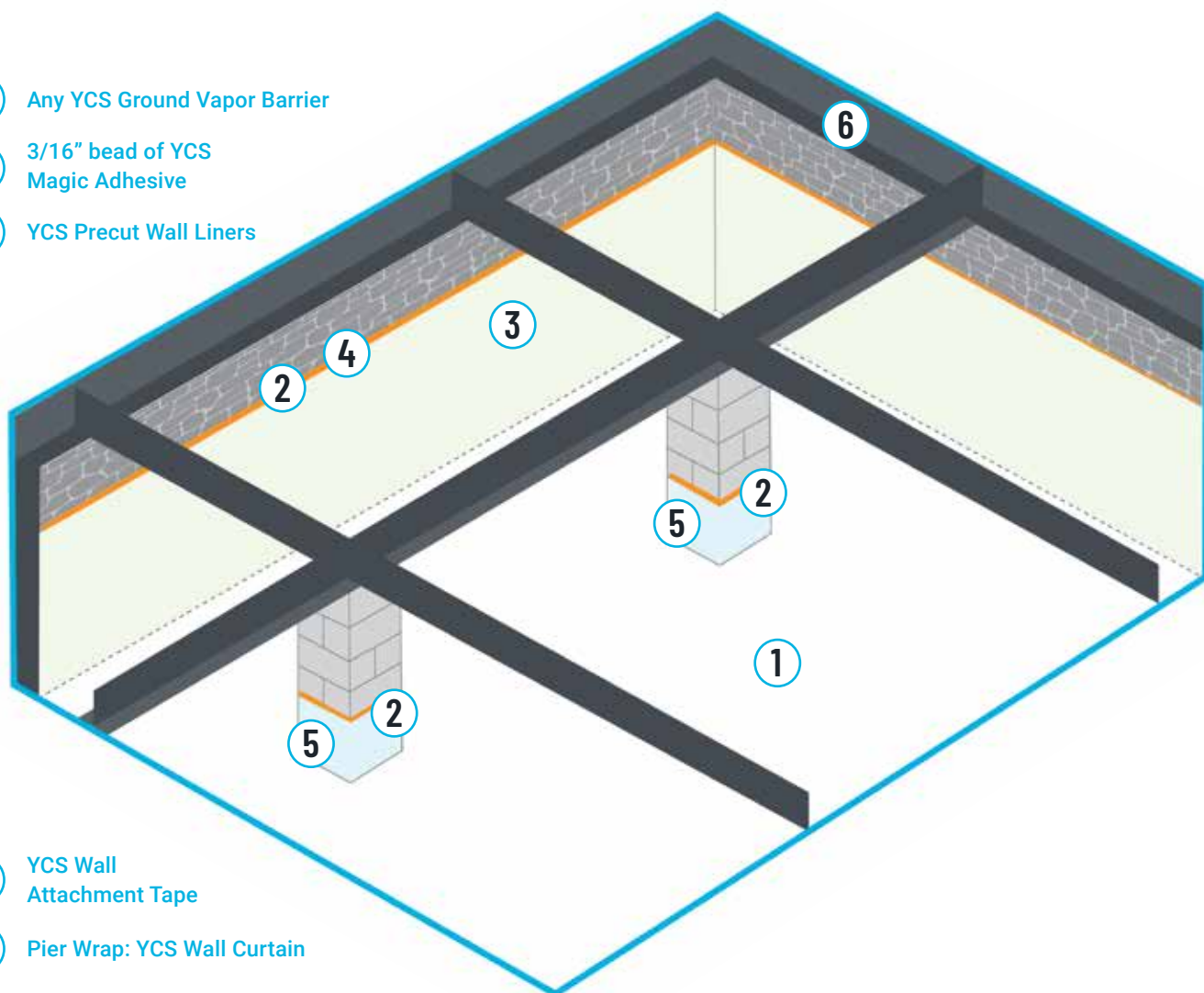

- ④ YCS Wall Attachment Tape
- ⑤ Pier Wrap: YCS Wall Curtain
- ⑥ Sill plate



① Any YCS Ground Vapor Barrier

② 3/16" bead of YCS Magic Adhesive

③ YCS Wall Attachment Tape

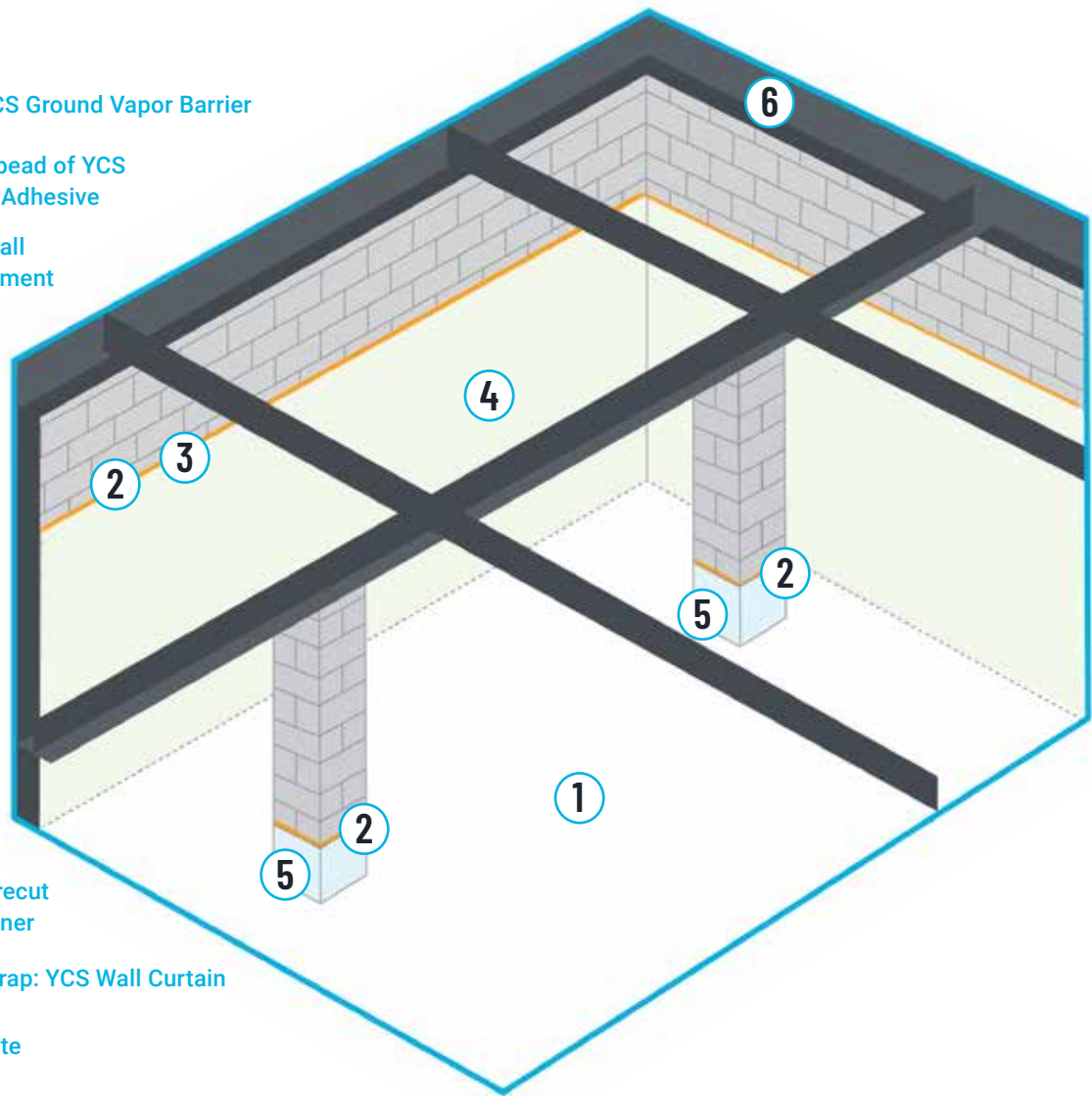

④ YCS Precut Wall Liner

⑤ Pier Wrap: YCS Wall Curtain

⑥ Sill plate

## A Sealed Tall Crawlspace on Block

APPLICATION: YCS WALL ATTACHMENT TAPE ON 4' WALLS AND HIGHER

Check out the diagram below to see how to install the innovative and proprietary **YCS System** on your next project. Our system creates a permanent seal without the use of mechanical fasteners, which means no holes in the foundation—ever.

**Ready to get confidence from the ground up? Let's get started.**

# A Sealed Crawlspace on Block

## APPLICATION: GROUND LINER 6" UP AND YCS WALL ATTACHMENT TAPE

Check out the diagram below to see how to install the innovative and proprietary **YCS System** on your next project. Our system creates a permanent seal without the use of mechanical fasteners, which means no holes in the foundation—ever.

**Ready to get confidence from the ground up? Let's get started.**

① Any YCS Ground Vapor Barrier applied 6"-20" up the foundation wall

② 3/16" bead of YCS Magic Adhesive

③ YCS Wall Attachment Tape

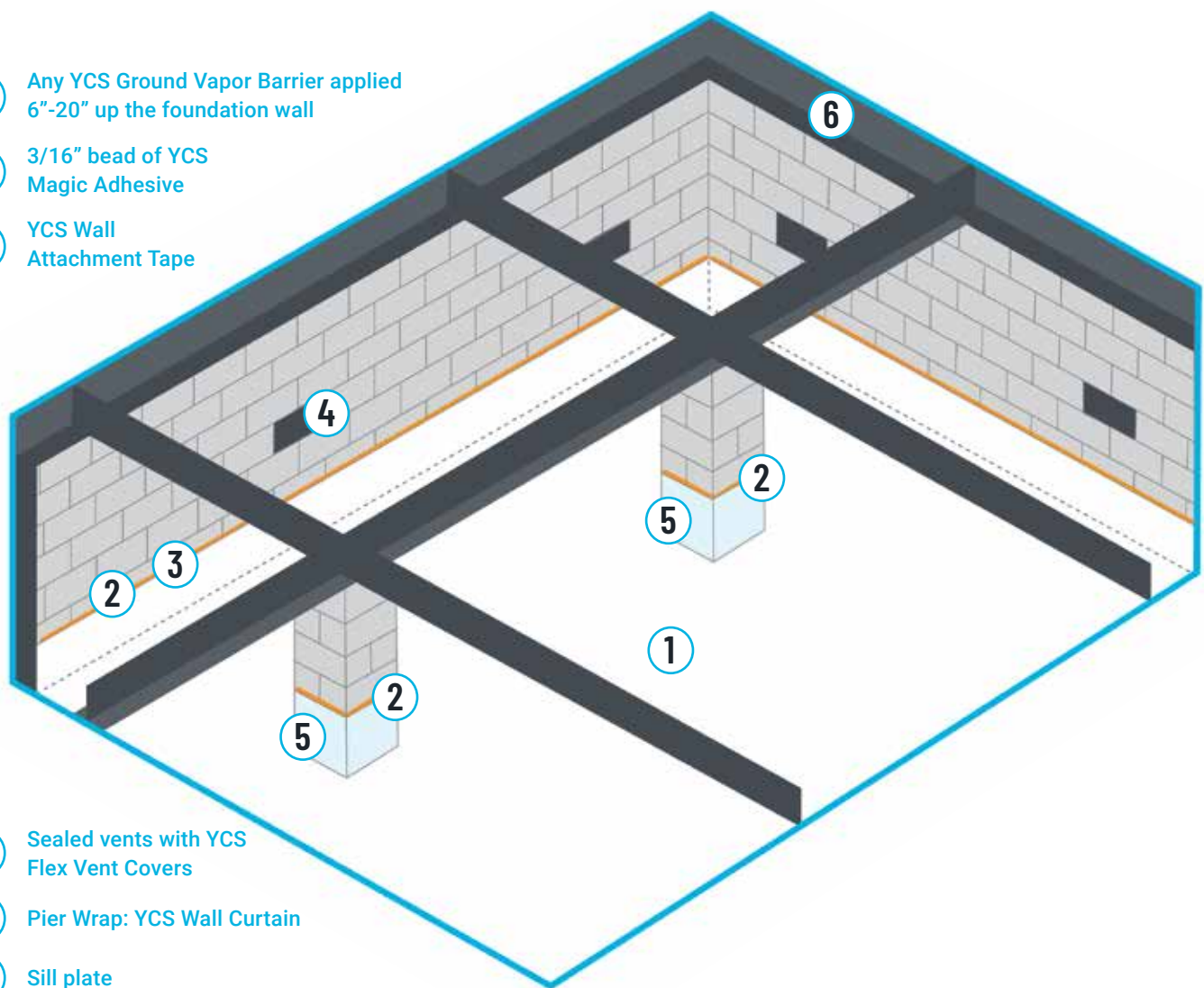

④ Sealed vents with YCS Flex Vent Covers

⑤ Pier Wrap: YCS Wall Curtain

⑥ Sill plate



- ① 36mil YCS Ground Vapor Barrier applied 6"-20" up the foundation wall
- ② 1/4" bead of YCS Magic Adhesive\*
- ③ Pier Wrap: YCS Wall Curtain

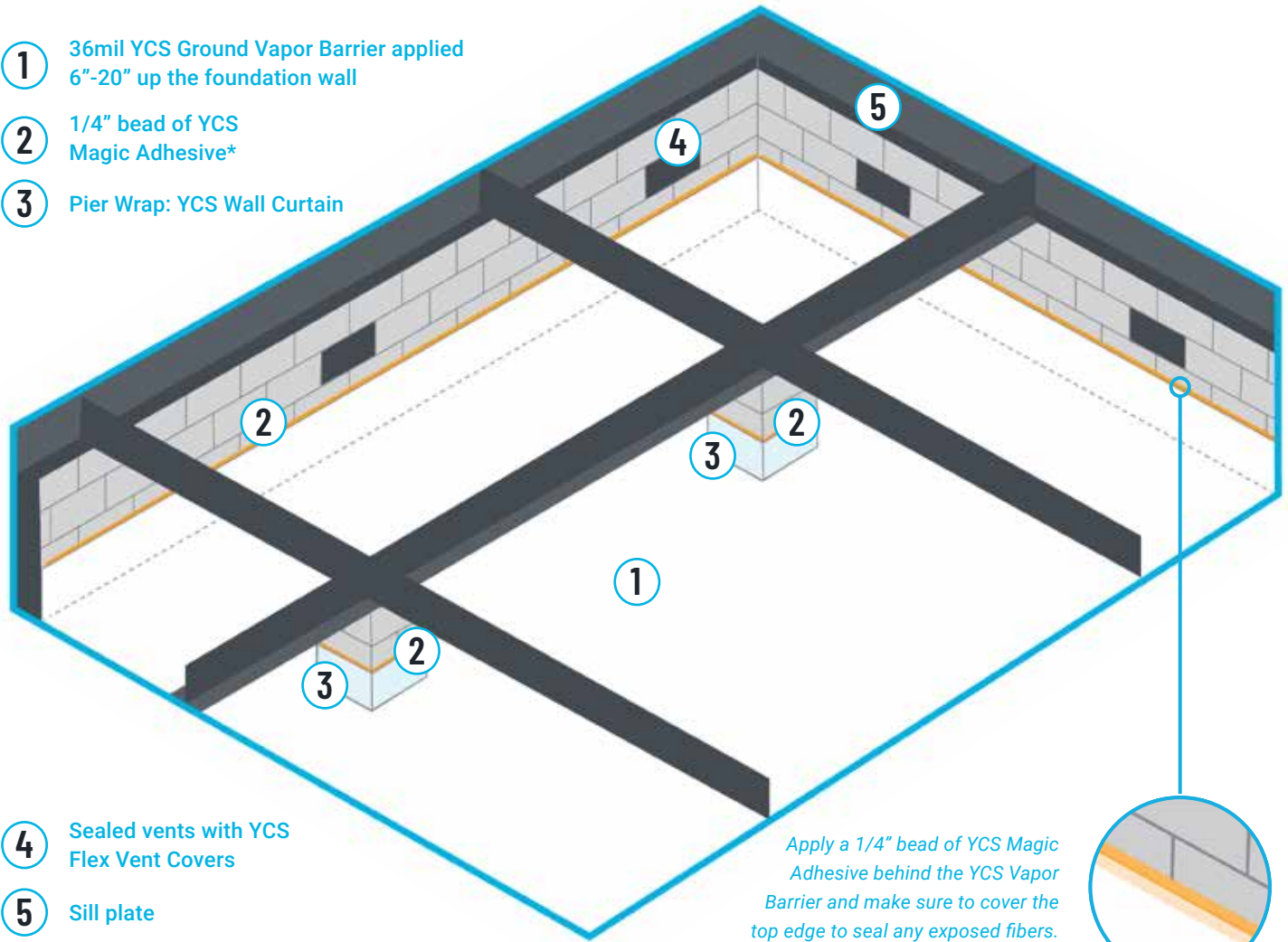

- ④ Sealed vents with YCS Flex Vent Covers
- ⑤ Sill plate

*Apply a 1/4" bead of YCS Magic Adhesive behind the YCS Vapor Barrier and make sure to cover the top edge to seal any exposed fibers.*

## A Sealed Tall Crawlspace on Block

### APPLICATION: GROUND LINER 6" UP

Check out the diagram below to see how to install the innovative and proprietary **YCS System** on your next project. Our system creates a permanent seal without the use of mechanical fasteners, which means no holes in the foundation—ever.

**Ready to get confidence from the ground up? Let's get started.**

# A Sealed Crawlspace on Block

## APPLICATION: YCS CRAWL CURTAIN

Check out the diagram below to see how to install the innovative and proprietary **YCS System** on your next project. Our system creates a permanent seal without the use of mechanical fasteners, which means no holes in the foundation—ever.

**Ready to get confidence from the ground up? Let's get started.**

- ① Any YCS Ground Vapor Barrier
- ② 3/16" bead of YCS Magic Adhesive
- ③ YCS Wall Curtain

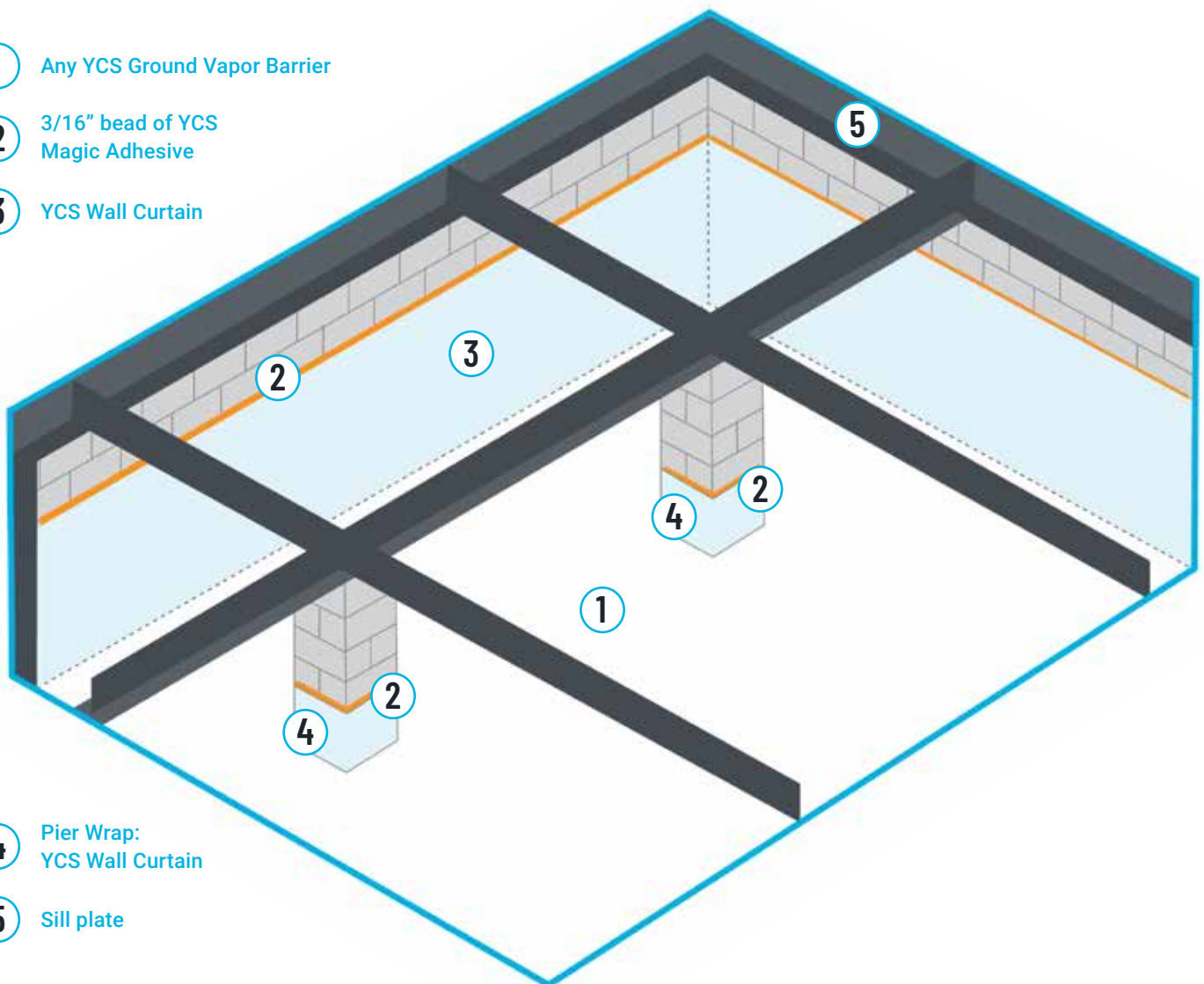

- ④ Pier Wrap:  
YCS Wall Curtain
- ⑤ Sill plate

- ① Any YCS Ground Vapor Barrier
- ② 3/16" bead of YCS Magic Adhesive
- ③ YCS Precut Wall Liner
- ④ YCS Wall Attachment Tape

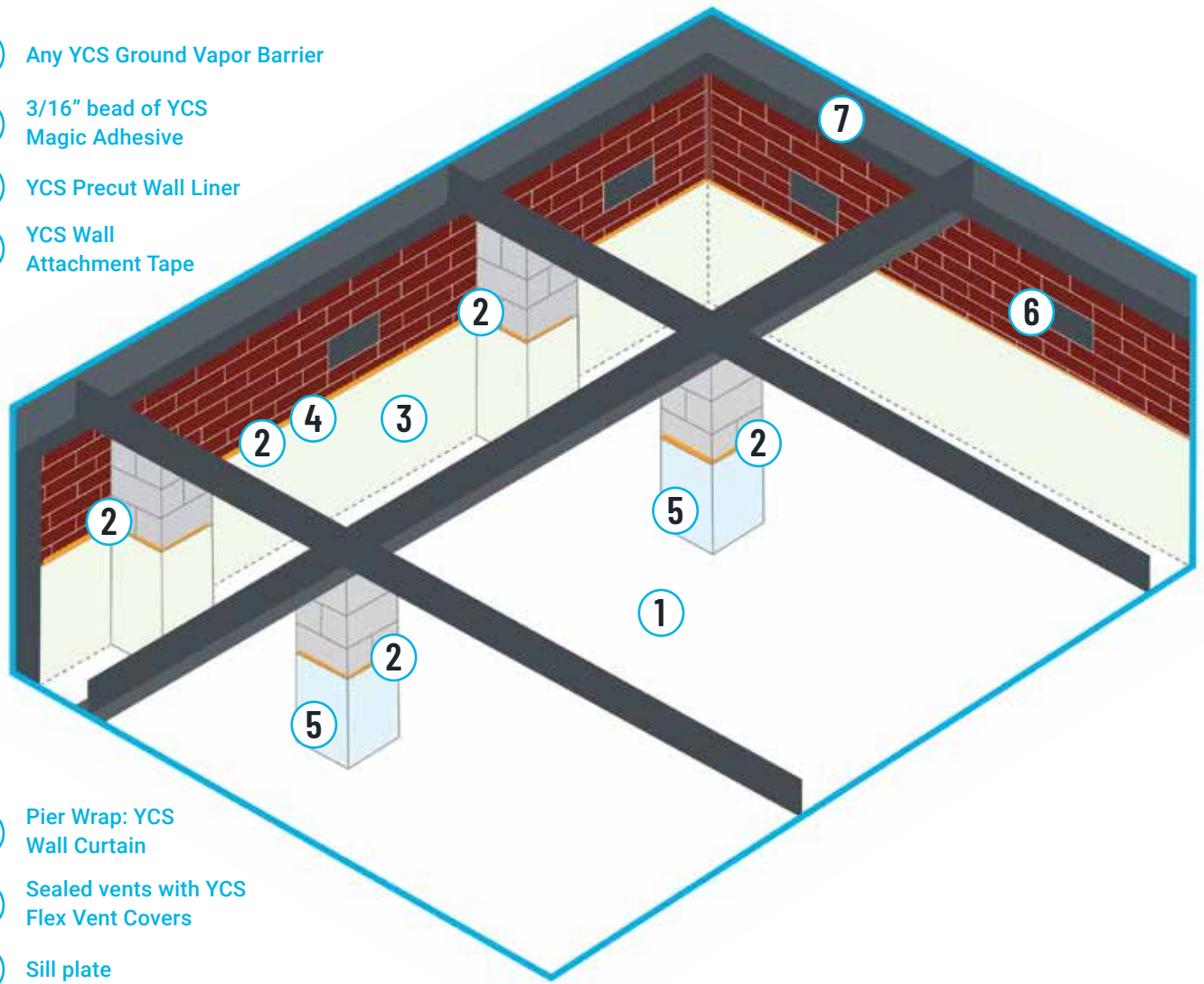

- ⑤ Pier Wrap: YCS Wall Curtain
- ⑥ Sealed vents with YCS Flex Vent Covers
- ⑦ Sill plate

## A Sealed Crawlspace on Brick

### APPLICATION: YCS WALL ATTACHMENT TAPE WITH EXTERIOR PIERS & WEeping MORTAR

Check out the diagram below to see how to install the innovative and proprietary **YCS System** on your next project. Our system creates a permanent seal without the use of mechanical fasteners, which means no holes in the foundation—ever.

**Ready to get confidence from the ground up? Let's get started.**

# A Sealed Crawlspace on Smooth Brick

## APPLICATION: YCS CRAWL CURTAIN

Check out the diagram below to see how to install the innovative and proprietary **YCS System** on your next project. Our system creates a permanent seal without the use of mechanical fasteners, which means no holes in the foundation—ever.

**Ready to get confidence from the ground up? Let's get started.**

- ① Any YCS Ground Vapor Barrier
- ② 1/4" bead of YCS Magic Adhesive\*
- ③ YCS Wall Curtain (2'-4' up foundation wall)\*\*

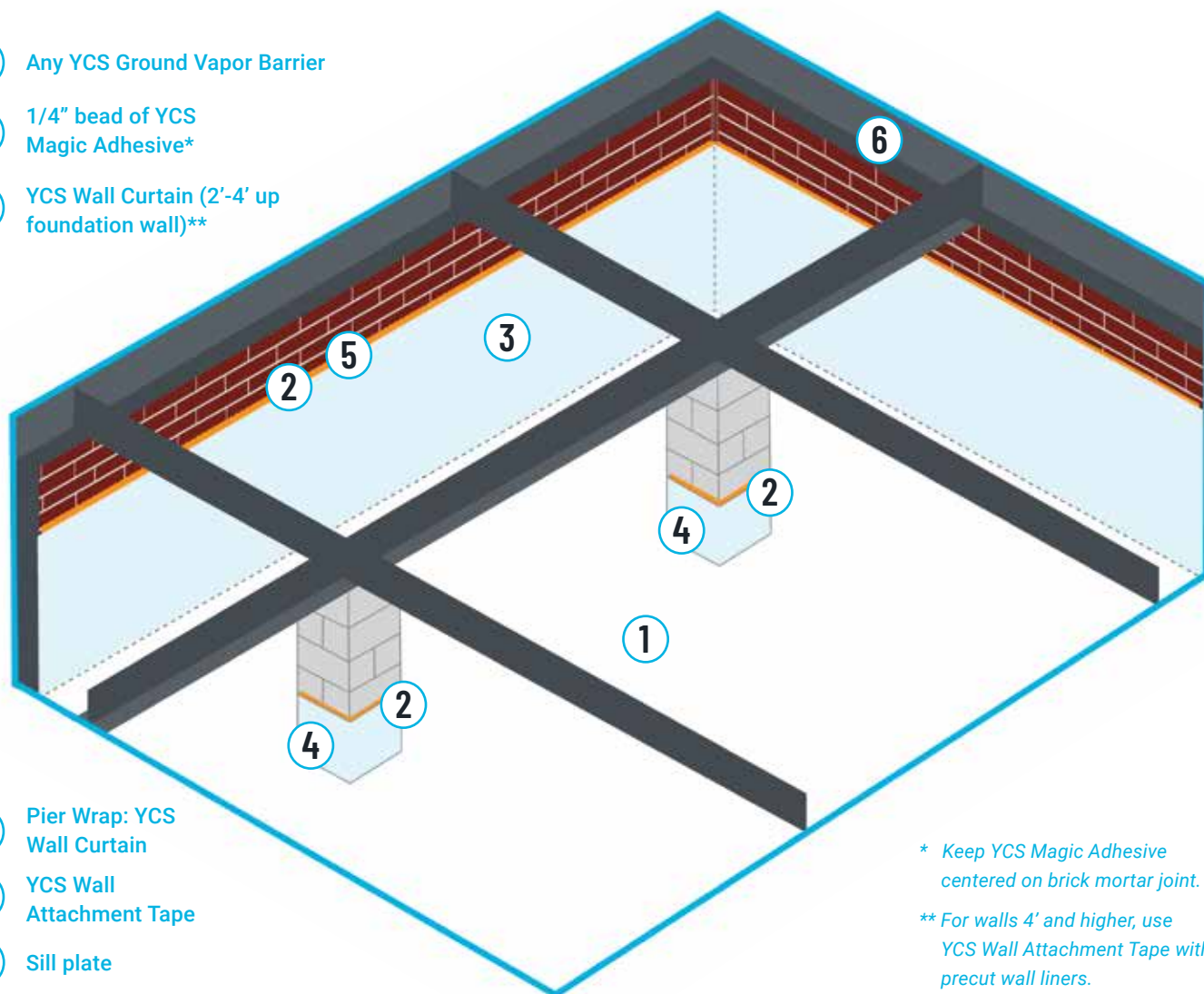

- ④ Pier Wrap: YCS Wall Curtain
- ⑤ YCS Wall Attachment Tape
- ⑥ Sill plate

\* Keep YCS Magic Adhesive centered on brick mortar joint.

\*\* For walls 4' and higher, use YCS Wall Attachment Tape with precut wall liners.



① YCS 36mil Ground Vapor Barrier applied 6"-20" up the foundation wall

② 3/16" bead of YCS Magic Adhesive

③ Pier Wrap: YCS Wall Curtain

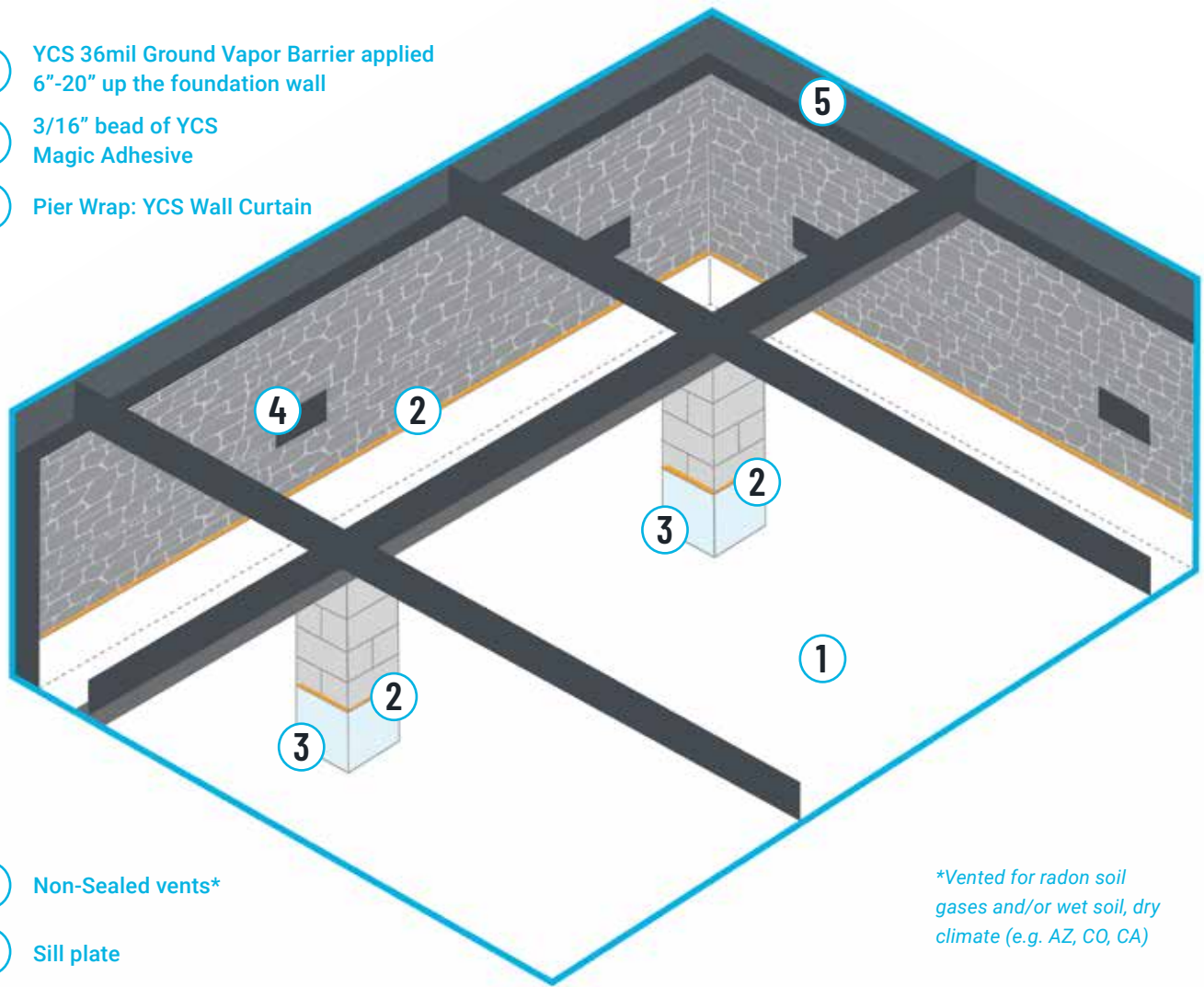

④ Non-Sealed vents\*

⑤ Sill plate

*\*Vented for radon soil gases and/or wet soil, dry climate (e.g. AZ, CO, CA)*

## A Non-Sealed Crawlspace: Any Surface

### APPLICATION: 36 MIL GROUND LINER FLIP-UP 6" WITH MAGIC ADHESIVE

Check out the diagram below to see how to install the innovative and proprietary **YCS System** on your next project. Our system creates a permanent seal without the use of mechanical fasteners, which means no holes in the foundation—ever.

**Ready to get confidence from the ground up? Let's get started.**

