

cleanology
touchless
DISPENSER
FOAM SOAP



User Guide

PRODUCT DETAILS:

1. Power button/ Indicator light
2. Spout
3. Sensor
4. Pump
5. Container
6. Battery compartment

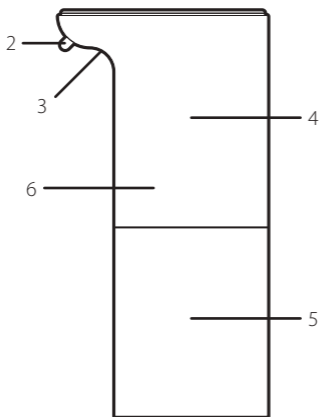
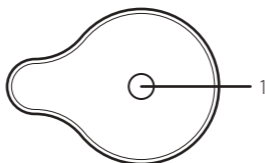

INSTALLING BATTERIES:

1. Disconnect the pump from the container, as shown below.

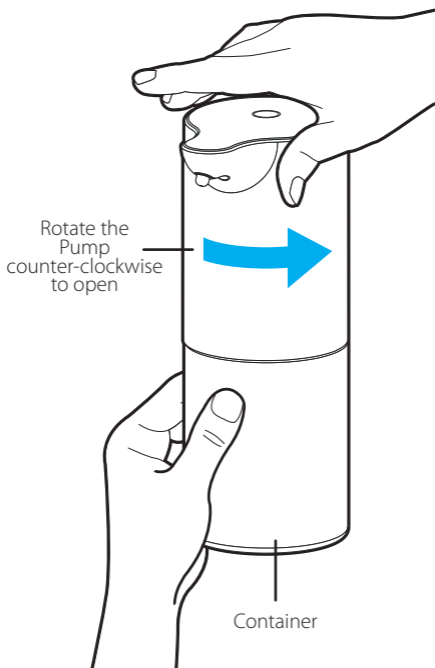

2. Open the battery cover, and insert four AA alkaline batteries (not included).

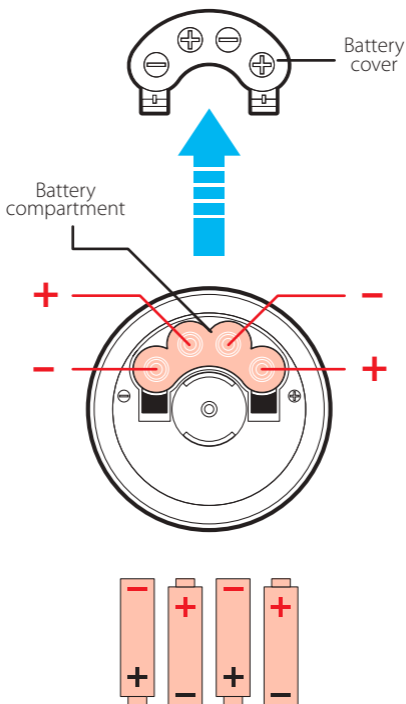

Make sure to align the batteries as shown above

POWER ON:

Press the Power button, the light will flash white, indicating the dispenser is powered on.

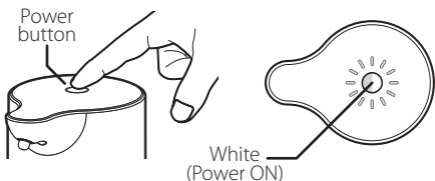

POWER OFF:

Press the power button, the light will flash blue, indicating the dispenser is powered off.

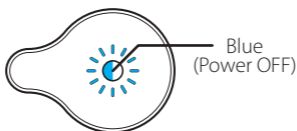

Note: If the indicator light works and the pump fails to operate, please check the polarity of the batteries.

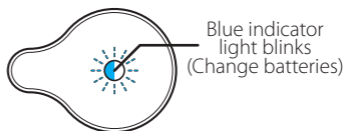

When the indicator light flashes blue, that means the batteries require replacement. Please make sure to replace all four batteries and do not mix old and new batteries as that will affect the pumps performance.

USING DIFFERENT SOAPS:

The dispenser supports most types of soaps. It is not required to add water when using foam soap. Liquid hand soap and dish soap require adding water as explained below.

Foam soap:

Does not require adding water

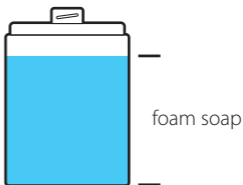

Liquid soap:

Suggested 50 : 50 ratio of water : soap

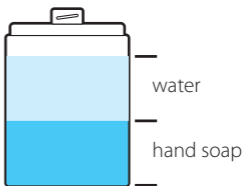

Dish soap:

Suggested 60 : 40 ratio of water : soap

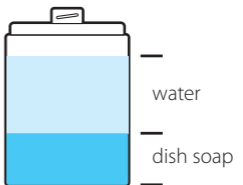

Note: Different soaps have different consistencies. Add water until the desired foam thickness and pump performance is achieved.

FILLING THE CONTAINER:

1. Pour the foam or liquid soap into the container.

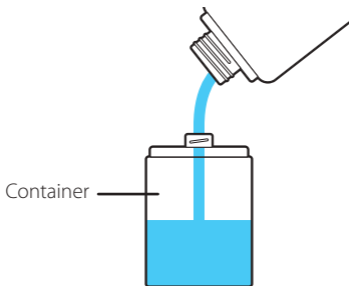

2. If using liquid soap and water, shake the container before sealing it with the pump.



Correct

Shake the container
sideways without the
pump



Incorrect

Do not shake the
container up and down
with the pump



Please make sure when mixing the soap and water or cleaning the dispenser, to avoid getting liquid into the pump's circuitry.

3. Seal the container.

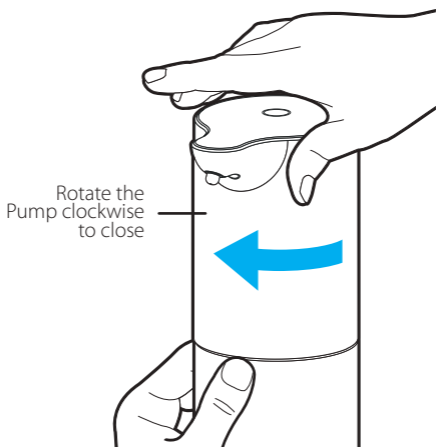

USING THE DISPENSER:

1. Place your hand about 2" under the sensor as shown below.

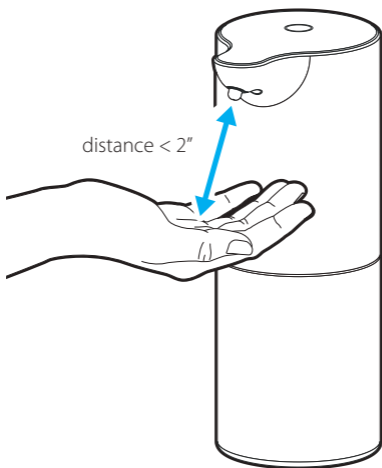

2. Wait until all the foam has been dispensed before moving your hand.



You can purchase Cleanology foam soap refill bags at **www.cleanologyproducts.com**



*This product is covered by a 1- Year limited warranty. For assistance, please visit **www.southern telecom.com** and select "support" and then select "Cleanology".*

cleanology

www.cleanologyproducts.com

Distributed by: Southern Telecom, Inc. Brooklyn, NY 11220

Cleanology is a trademark of Southern Telecom, Inc.

Made in China