

Botanical Bonsai

Grow beautiful bonsai trees from seed

Getting Started

Preparing The Coir

You will need...

- a waterproof container
- approx 150ml water
- 5 coir disks (included in this kit)

Simply place the coir disks into a waterproof container. Add the water and leave to absorb. The coir will expand to 3 times its original size. Once the coir has stopped expanding, stir it round to ensure there are no hard lumps. If you need to extra water do this a little at a time.

Assembling

Your Eco-Kit

Stage 1

Slide tabs out carefully so they are not damaged.

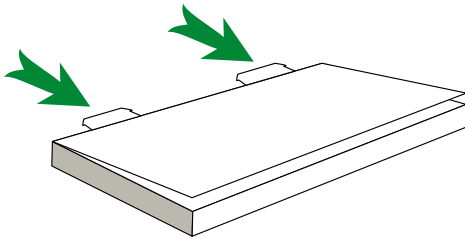

Stage 2

Insert the drip tray into your stadium.

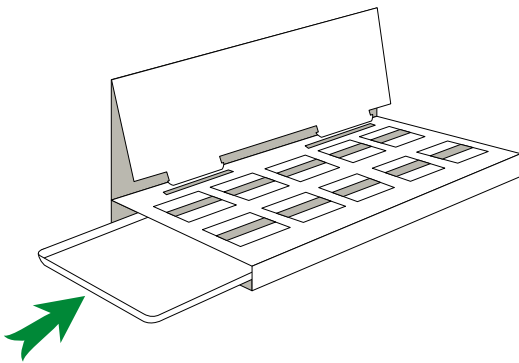

Stage 3

Slide tabs into internal slots so that they anchor securely into position then fold down the flaps where the cells will go. Doing this now will make it easier to insert the planting cells later.

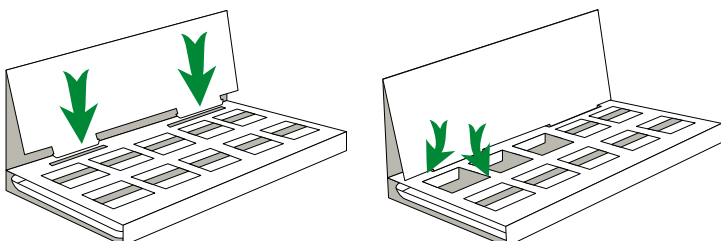

Stage 4

Your plant cells come in flat sheets of two that need to be Separated. Take care when doing this so that the cells do not tear.

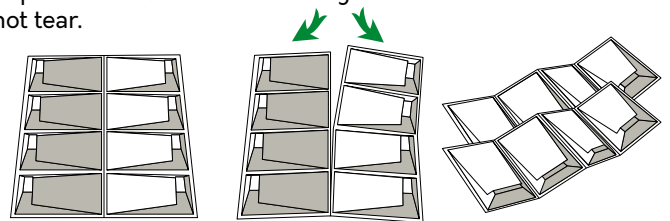

Stage 5

To create the planting cells, gently fold the 4 panels into a square with the tabs facing inwards.

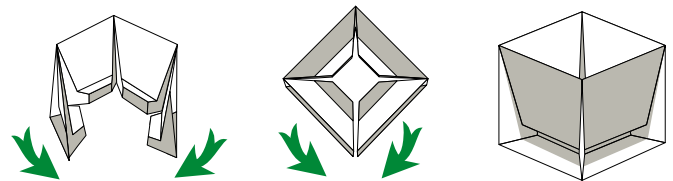

Stage 6

Slot the planting cells into your stadium. You are now ready to start growing.

