

Male Adapter SAM

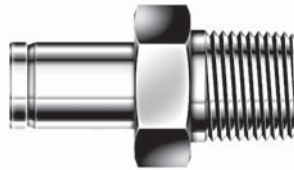
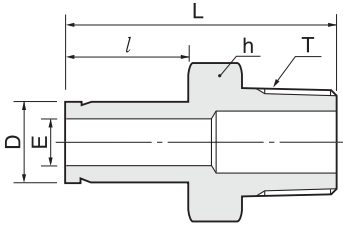

Connects fractional S-LOK port to female NPT thread

Part No.	Tube O.D.		T (NPT)	E Min.	Width across flat		l	L
	D in	mm			h in	mm		
SAM -2-2N	1/8	3.17	1/8	2.03	7/16	11.11	13.45	29.50
SAM -2-4N	1/8	3.17	1/4	2.03	9/16	14.28	13.45	34.80
SAM -3-2N	3/16	4.76	1/8	3.04	7/16	11.11	14.20	30.22
SAM -3-4N	3/16	4.76	1/4	3.04	9/16	14.28	14.20	35.56
SAM -4-2N	1/4	6.35	1/8	4.31	7/16	11.11	15.75	31.80
SAM -4-4N	1/4	6.35	1/4	4.31	9/16	14.28	15.75	37.08
SAM -4-6N	1/4	6.35	3/8	4.31	11/16	17.46	15.75	37.84
SAM -4-8N	1/4	6.35	1/2	4.31	7/8	22.22	15.75	43.43
SAM -5-2N	5/16	7.93	1/8	5.58	7/16	11.11	16.80	32.76
SAM -5-4N	5/16	7.93	1/4	5.58	9/16	14.28	16.80	38.10
SAM -6-2N	3/8	9.52	1/8	6.86	7/16	11.11	17.50	33.50
SAM -6-4N	3/8	9.52	1/4	6.86	9/16	14.28	17.50	38.90
SAM -6-6N	3/8	9.52	3/8	6.86	11/16	17.46	17.50	39.60
SAM -6-8N	3/8	9.52	1/2	6.86	7/8	22.22	17.50	45.20
SAM -8-4N	1/2	12.70	1/4	9.40	9/16	14.28	23.20	44.50
SAM -8-6N	1/2	12.70	3/8	9.40	11/16	17.46	23.20	45.20
SAM -8-8N	1/2	12.70	1/2	9.40	7/8	22.22	23.20	50.50
SAM -10-6N	5/8	15.87	3/8	11.90	11/16	17.46	24.70	47.40
SAM -10-8N	5/8	15.87	1/2	11.90	7/8	22.22	24.70	52.30
SAM -10-12N	5/8	15.87	3/4	11.90	1-1/16	26.98	24.70	52.30
SAM -12-8N	3/4	19.05	1/2	14.73	7/8	22.22	24.70	52.30
SAM -12-12N	3/4	19.05	3/4	14.73	1-1/16	26.98	24.70	52.30
SAM -12-16N	3/4	19.05	1	14.73	1-3/8	34.92	24.70	57.91
SAM -14-12N	7/8	22.22	3/4	17.27	1-1/16	26.98	26.70	54.30
SAM -16-12N	1	25.40	3/4	20.32	1-1/16	26.98	31.70	58.70
SAM -16-16N	1	25.40	1	20.32	1-3/8	34.92	31.70	66.00
SAM -20-20N	1-1/4	31.75	1-1/4	25.90	1-3/4	44.45	40.00	80.26
SAM -24-24N	1-1/2	38.10	1-1/2	31.75	2-1/8	53.98	51.50	94.48
SAM -32-32N	2	50.80	2	43.68	2-3/4	69.85	68.40	119.38

S-LOK Adapter eliminates alignment problems

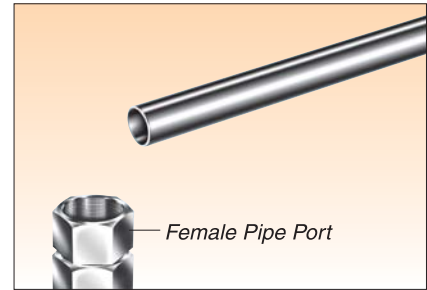

In the direction shown the female port is required to connect with tubing.

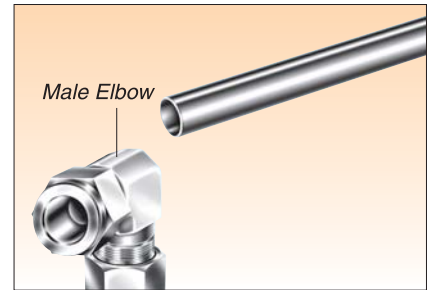

The male elbow is positioning in the wrong direction.

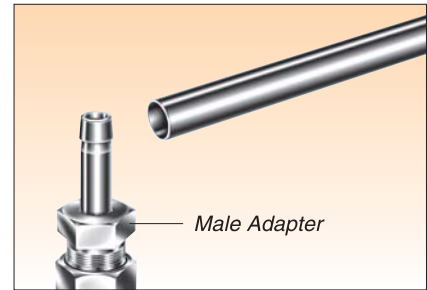

To eliminate the problem, use a male adapter into the female port.

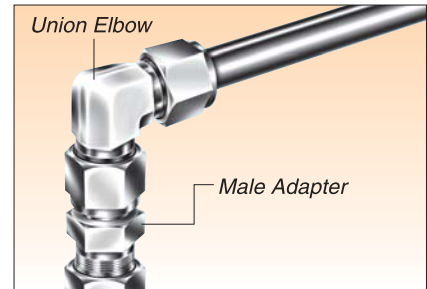

Connect a union elbow to the adapter by tightening the S-LOK port with a wrench while holding the elbow wrench pad in the desired direction