

REVISIONS

DATE BY

APPROVED BY:

DRAFTSMAN:

KC

SCALE:

1/4" = 1'

DATE:

X/X/XX

DRAWING NAME:

BUILDING:

SHEET:

K1-FP

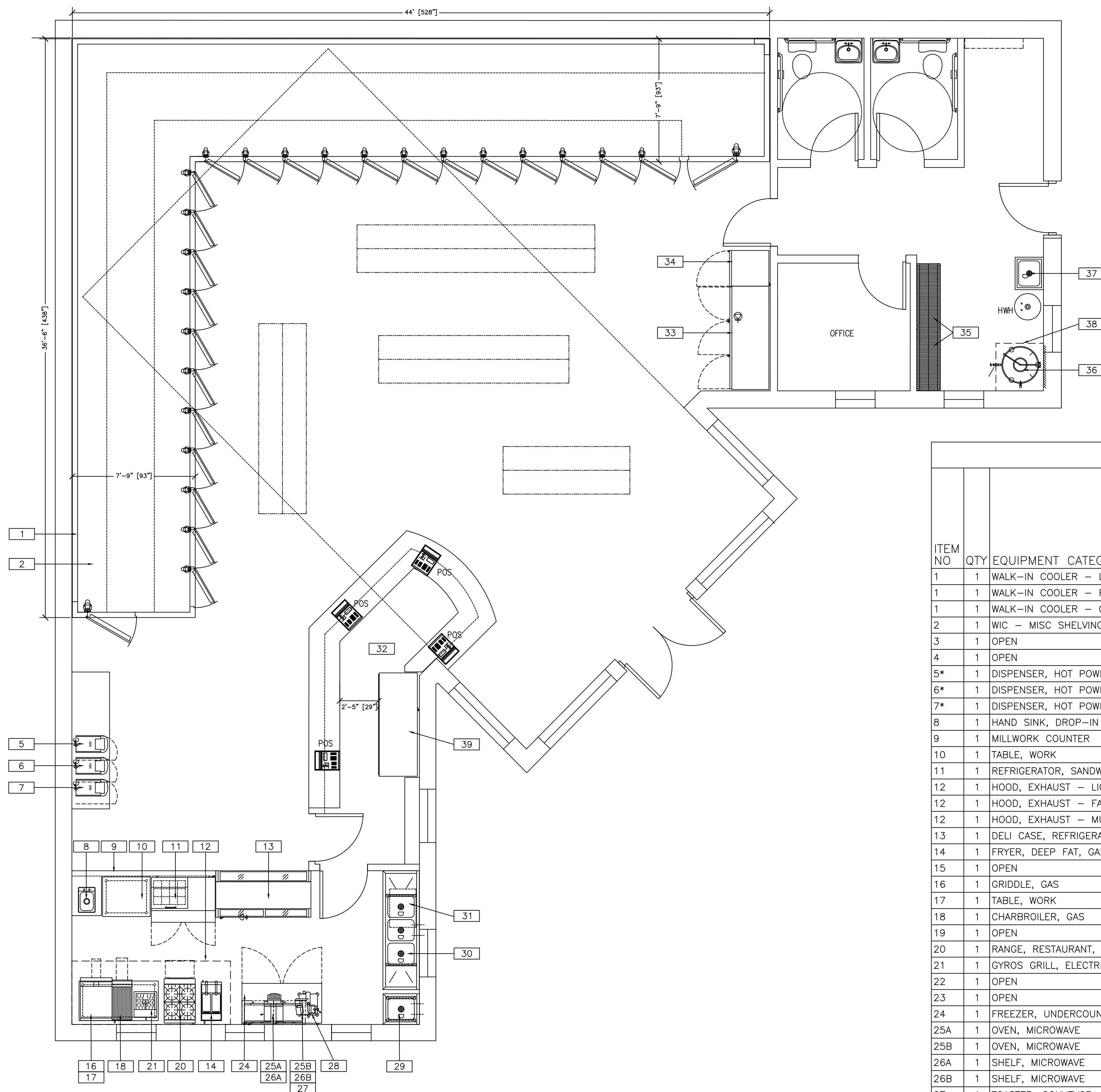

PLAN VIEW
 1/4" = 1' 1

EQUIPMENT SCHEDULE																	
ITEM NO	QTY	EQUIPMENT CATEGORY	MANUFACTURER	MODEL NUMBER	VOLTS	PHASE	AMPS	HP	NEMA	PLUG	DIRECT	GAS SIZE (IN)	MBTUH	COLD WATER SIZE (IN)	HOT WATER SIZE (IN)	INDIR DRAIN SIZE (IN)	DIRECT DRAIN SIZE (IN)
1	1	WALK-IN COOLER - LIGHTS	SRC REFRIGERATION		120	1					X						
1	1	WALK-IN COOLER - FAN	SRC REFRIGERATION		208/230	3					X					1	
1	1	WALK-IN COOLER - COMPRESSOR	SRC REFRIGERATION		208/230	3					X						
2	1	WIC - MISC SHELING/DUNNAGE, IF REQ'D															
3	1	OPEN															
4	1	OPEN															
5*	1	DISPENSER, HOT POWDERED DRINK	BY OTHERS		120	1	15.0		5-15P	X				.25			
6*	1	DISPENSER, HOT POWDERED DRINK	BY OTHERS		120	1	15.0		5-15P	X				.25			
7*	1	DISPENSER, HOT POWDERED DRINK	BY OTHERS		120	1	15.0		5-15P	X				.25			
8	1	HAND SINK, DROP-IN	EAGLE GROUP/METAL MASTERS	SR10-14-5-1										.5	.5	1.5	
9	1	MILLWORK COUNTER	BY OTHERS														
10	1	TABLE, WORK	EAGLE GROUP/METAL MASTERS	UT3036B													
11	1	REFRIGERATOR, SANDWICH/SALAD PREP	TRUE FOOD SERVICE	TSSU-48-12M-B	120	1	8.6	0.33	5-15P	X							
12	1	HOOD, EXHAUST - LIGHTS	LARKIN	96" x 48"	120	1	5.0				X						
12	1	HOOD, EXHAUST - FAN	LARKIN	96" x 48"	208	1	8.0	1			X						
12	1	HOOD, EXHAUST - MUA	LARKIN	96" x 48"	208	1	5.3	.75			X						
13	1	DELI CASE, REFRIGERATED	TRUE FOOD SERVICE	TDBD-72-2	120	1	14.0	0.5	5-20P	X						1.5	
14	1	FRYER, DEEP FAT, GAS	DEAN	SR42G							X	0.75	105				
15	1	OPEN															
16	1	GRIDDLE, GAS	STAR MANUFACTURING	624MD								0.75	40				
17	1	TABLE, WORK	EAGLE GROUP/METAL MASTERS	T3036GS													
18	1	CHARBROILER, GAS	STAR MANUFACTURING	6015CBD								0.75	40				
19	1	OPEN															
20	1	RANGE, RESTAURANT, GAS	U.S. RANGE	X24-4L								.75	145				
21	1	GYROS GRILL, ELECTRIC	KRONOS	JAS	115	1	12				X						
22	1	OPEN															
23	1	OPEN															
24	1	FREEZER, UNDERCOUNTER, COMPACT	TRUE FOOD SERVICE	TUC-60F	120	1	10.9	0.25	5-15P	X							
25A	1	OVEN, MICROWAVE	PANASONIC	NE-1064	120	1	13.4		5-15P	X							
25B	1	OVEN, MICROWAVE	PANASONIC	NE-1064	120	1	13.4		5-15P	X							
26A	1	SHELF, MICROWAVE	EAGLE GROUP/METAL MASTERS	MWS1824													
26B	1	SHELF, MICROWAVE	EAGLE GROUP/METAL MASTERS	MWS1824													
27	1	TOASTER, CONVEYOR	STAR MANUFACTURING	QC51-350	120	1	13.8		5-15P	X							
28	1	SLICER, FOOD	GLOBE FOOD EQUIPMENT	GC12	115	1	5.0	0.33	5-15P	X							
29	1	SINK, SCULLERY, 1 COMPARTMENT	EAGLE GROUP/METAL MASTERS	414-16-1										0.5	0.5	1.5	
30	1	SINK, CONVENIENCE STORE	EAGLE GROUP/METAL MASTERS	414-16-3-18										.5	.5	1.5	
31	1	GREASE TRAP	ASHLAND	4820													2
32	4	POS	BY OTHERS		120	1											
33	1	DISPLAY CASE, FROZEN	TRUE FOOD SERVICE	GDM-72F	120/208	1	14.1	1.5	14-20P	X							
34	1	DISPLAY CASE, FROZEN	TRUE FOOD SERVICE	GDM-23F	120	1	13.0	0.75	5-20P	X							
35	2	SHELVING UNIT, STARTER, METAL, WIRE	EAGLE GROUP/METAL MASTERS	S4-74-1848Z													
36	1	KETTLE, STEAM JACKETED	GROEN	BY OWNER	208	3	30				X			0.5	0.5	2	
37	1	MOP SINK, MISC.	EAGLE GROUP/METAL MASTERS	F1916										.5	.5	2	
38	1	HOOD, EXHAUST/CONDENSATE - FAN	LARKIN	36" x 36"	115	1	4.4	.125			X						
39	1	DISPLAY CASE, REFRIGERATED	TRUE FOOD SERVICE	GDM-69	120	1	12.0	0.5	5-15P	X							