



OPTIMUSGEAR®

**DEFENDER HARNESS
INSTALLATION INSTRUCTIONS**



CONTENTS

DEFENDER HARNESS INSTALLATION INSTRUCTIONS.....	1
INSTALLING VEHICLE TETHERS.....	4
INSTALLING DEFENDER HARNESS ON A DOG.....	6
TRAVELLING IN A VEHICLE WITH YOUR DOG.....	6
LEASH.....	8
APPENDIX A – LATCH.....	11
APPENDIX B – LEASH ADDITION (SOLD SEPERATELY).....	12
APPENDIX C – POO BAG ROLL HOLDER (SOLD SEPERATELY).....	13
APPENDIX D – ADDITIONAL INFORMATION.....	14

Thank you for purchasing your Optimus Gear® Defender Harness. For additional instructions and demonstrations please visit our YouTube channel or our website www.optimusgear.com. If you require further assistance please email contact@optimusgear.com and we will be happy to assist you.

The Defender Harness has been crash tested using equipment and test conditions certified for FMVSS 213. The harness maintained its structural integrity when subjected to these conditions.

If the Defender Harness is involved in a collision, it cannot be used again and must be discarded. Crashes can cause imperceptible damage and subsequent use may result in serious injury or death. Do not use the Defender Harness if it is damaged or missing parts.

If you are in a collision you while using the Defender Harness you may qualify for a replacement product. Email contact@optimusgear.com to begin the review process.

WARNING

Failure to use this product in accordance with the OWNER'S MANUAL INSTRUCTIONS may cause serious INJURY OR DEATH to dog(s) or human(s). Always follow proper instructions for use and care of product and verify all hardware connections are fully engaged and secure. If the product is modified or altered all warranties are void

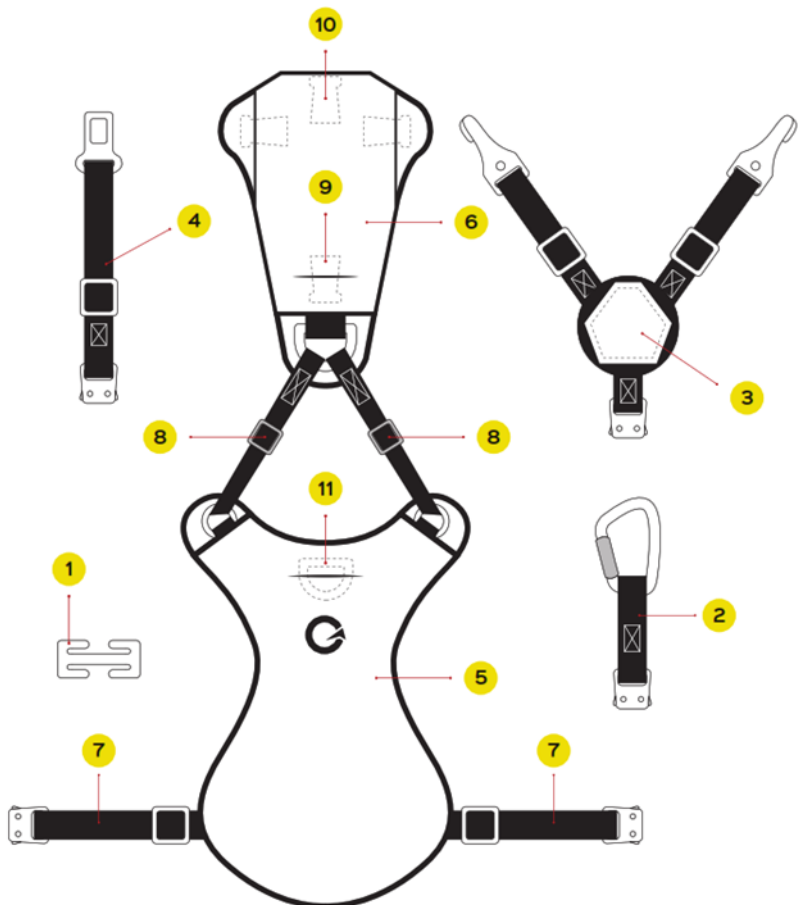

Figure 1

Table 1 - Defender Harness Parts

#	PART NAME
1	Seat belt cinch
2	Upper tether assembly
3	Lower tether assembly (LARGE HARNESS)
4	Lower tether assembly (SMALL & MEDIUM HARNESS)
5	Chest panel
6	Back panel
7	Body straps
8	Shoulder straps
9	Shoulder Buckle
10	Rear Buckle
11	Chest D-Ring

INSTALLING VEHICLE TETHERS

Determine the seat where you will install the Defender Harness in your vehicle. Valid seating positions are as follows.

- Large Harness – Any seat that has a LATCH system installed.
*APPENDIX A
- Medium Harness – Captain or bench seat
- Small Harness – Captain or bench seat

1) Harness Connections

- Hold the seat belt male connector at the top of the seat belt (Figure 2)

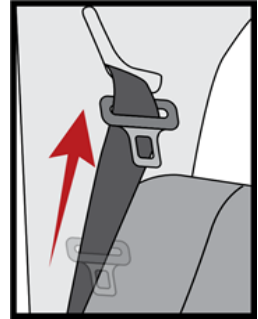

Figure 2

- Pinch the seat belt and weave the seat belt through the cinch ① (Figure 3).

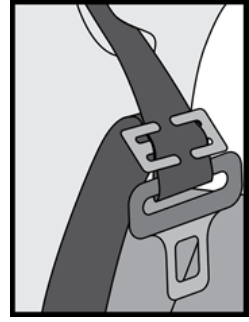
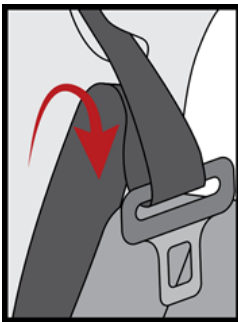

Figure 3

- Install the upper tether assembly carabiner ② into the hole of the seat belt male connector (Figure 4)

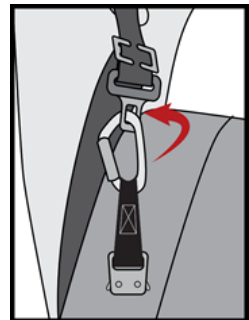

Figure 4

2) Lower Tether Installation (Large Harness)

- Install the lower tether ③ to the LATCH anchors in your vehicle (Figure 5). See Appendix A for a description of how to use your LATCH anchors. For first time use in your vehicle, initially maximize the lower tether length. It will be adjusted in a future step

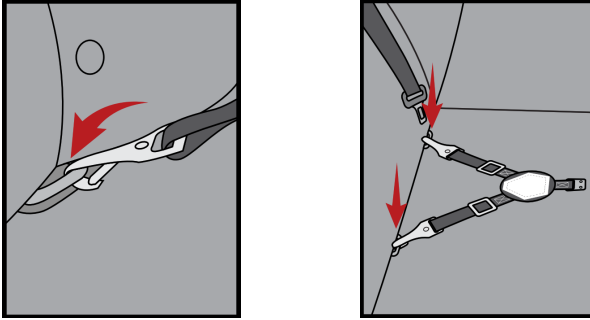

Figure 5

3) Lower Tether Installation (Small & Medium Harness)

- Install the lower tether seat belt adapter ④ in your vehicle's seat
- For the first time using the harness in your vehicle, initially maximize the lower tether ④ length. It will be adjusted in a future step.

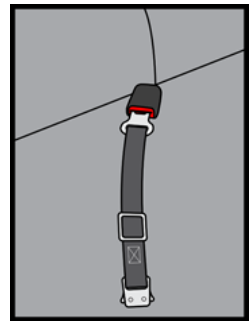

Figure 6

4) Disassembly

The upper and lower tethers can stay in your vehicle until a person needs to use the seat. When this happens perform the following steps:

- Remove the lower tether ③ or ④
- Remove the upper tether ②
- The seat belt cinch ① can be completely removed or for convenience, it can be partially unwoven (Figure 7).

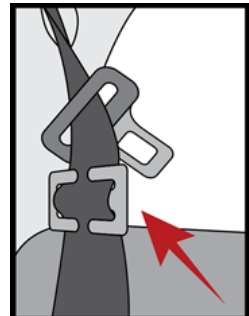

Figure 7

INSTALLING DEFENDER HARNESS ON A DOG

Place the harness over your dog's head and position the Optimus Gear® logo (on the chest panel ⑤) in the center of your dog's chest (Figure 8).

- Adjust the body straps ⑦ and shoulder straps ⑧ so that two fingers fit snugly underneath (Figure 8).

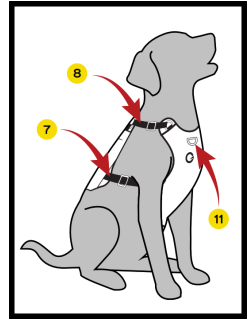

Figure 8

TRAVELING IN A VEHICLE WITH YOUR DOG

- Connect the lower tether ③ or ④ to the rear buckle ⑩.

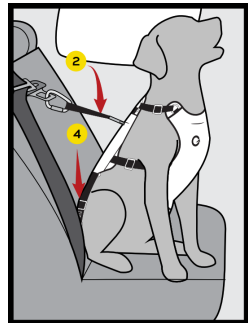

Figure 9

- Connect the upper tether ② to the shoulder buckle ⑨.

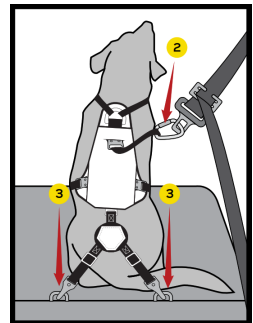

Figure 10

- Adjust the lower tether ③ or ④ length to allow your dog to sit and lie down comfortably. Your dog should not be able to stand.

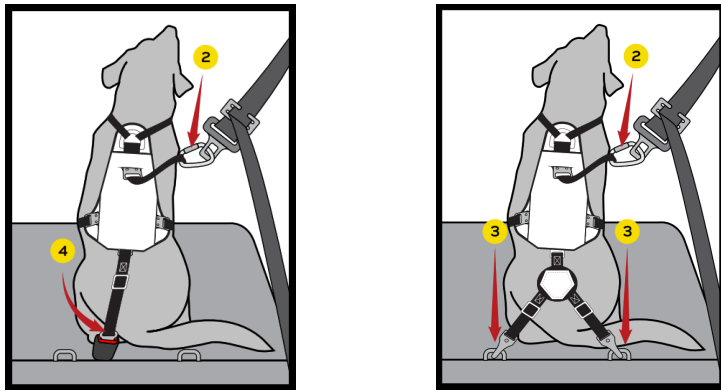

Figure 11

PRODUCT CARE INSTRUCTIONS

To clean your Optimus Gear® Defender Harness or any of its accessories, we recommend placing them in the washing bag that your Defender Harness came in.

- Connect all buckles
- Place Optimus Gear® products in washing bag
- Machine wash cold
- Do not use fabric softeners
- Do not bleach
- Hang to dry
- Do not iron
- Do not dry clean



75% nylon

25% polyester mesh

Aluminium hardware

CA63409

REV 00

LEASH

#	PART NAME
1	Padded Handle
2	Multi-function Buckle
3	Accessory D-Ring
4	Poo Bag Clip
5	Double Swivel

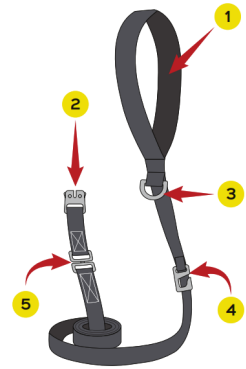

Figure 12

Connections

Your Optimus Gear® leash can be attached to your Defender Harness in three places or to D-Rings used on collars.

- Shoulder Buckle ⑨
- Rear Buckle ⑩
- Chest D-Ring ⑪
- Collar*

* The Optimus Gear® Leash is designed to be used with the same size classification of Defender Harness and an Optimus Gear® Collar. Other collars must have an equal diameter D-Ring to perform optimally.

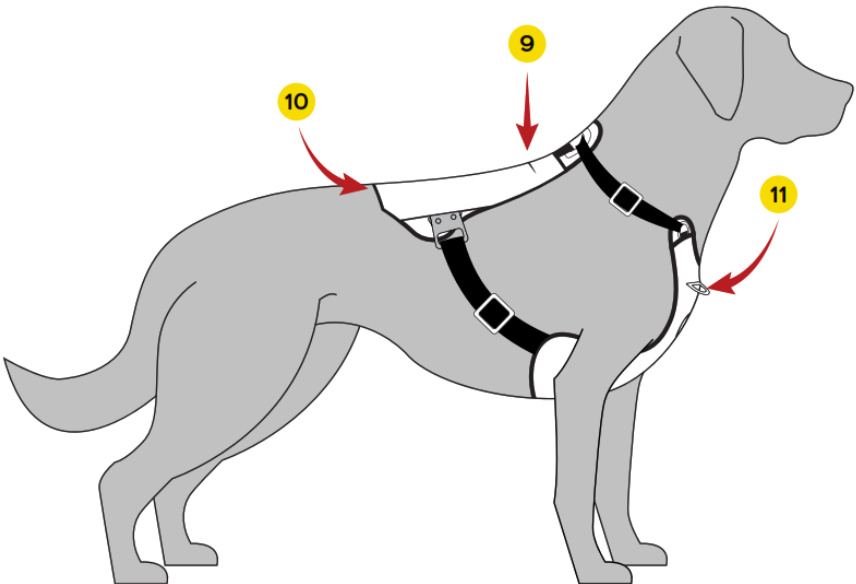

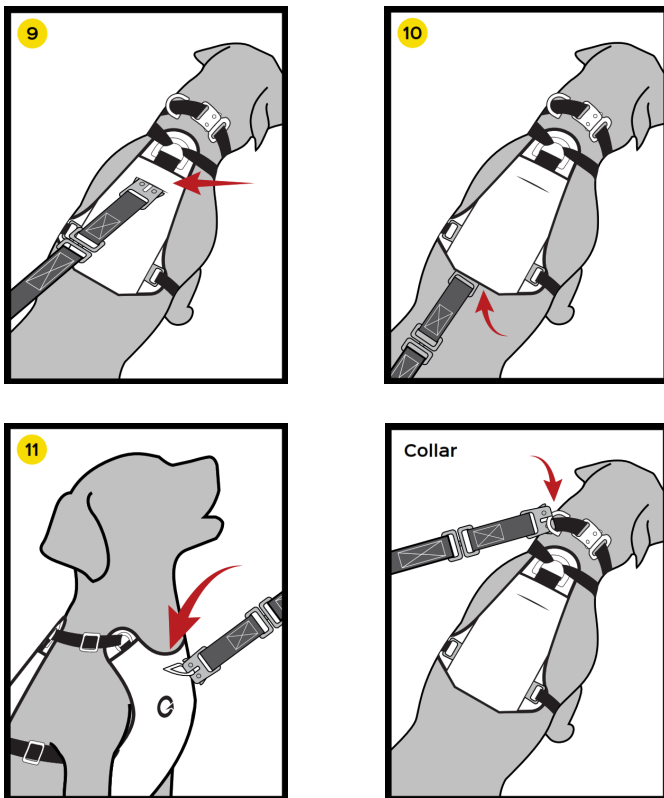

Figure 13 – Leash Connection Points

Suggested basic activities for each connection:

- Shoulder Buckle (walking, running)
- Rear Buckle (walking, running, pulling)
- Chest D-Ring (walking / obedience training)
- Collar D-Ring (walking)

Accessory D-Ring

The D-Ring ③ on your Optimus Gear® Leash can be used for:

- Attachment to multi-function buckle to make the leash wearable
- Optimus Gear® accessory attachment (ex. Poo Bag Roll Holder)
- Leash Addition attachment (walking multiple dogs, other activities)

POO BAG CLIP

The figures below show the method of securing a full poo bag to the poo bag clip

- Tie a knot in your poo bag and hang it on the poo bag clip (Figure 14).

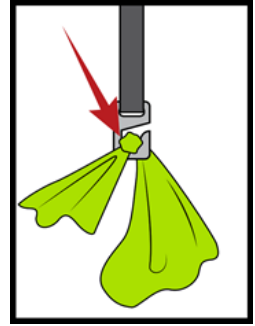

Figure 14

- Wind the bag around the poo bag clip as shown (Figure 15).

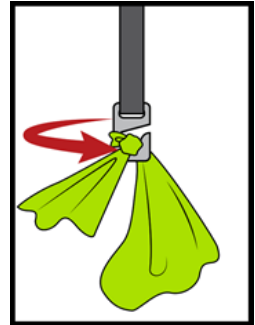

Figure 15

APPENDIX A – LATCH

Vehicles manufactured after 2004 will have one or more LATCH anchorage systems. The LATCH anchors will be present at seat crease (Figure 16)

Your owner's manual will have more information on the location and load ratings.

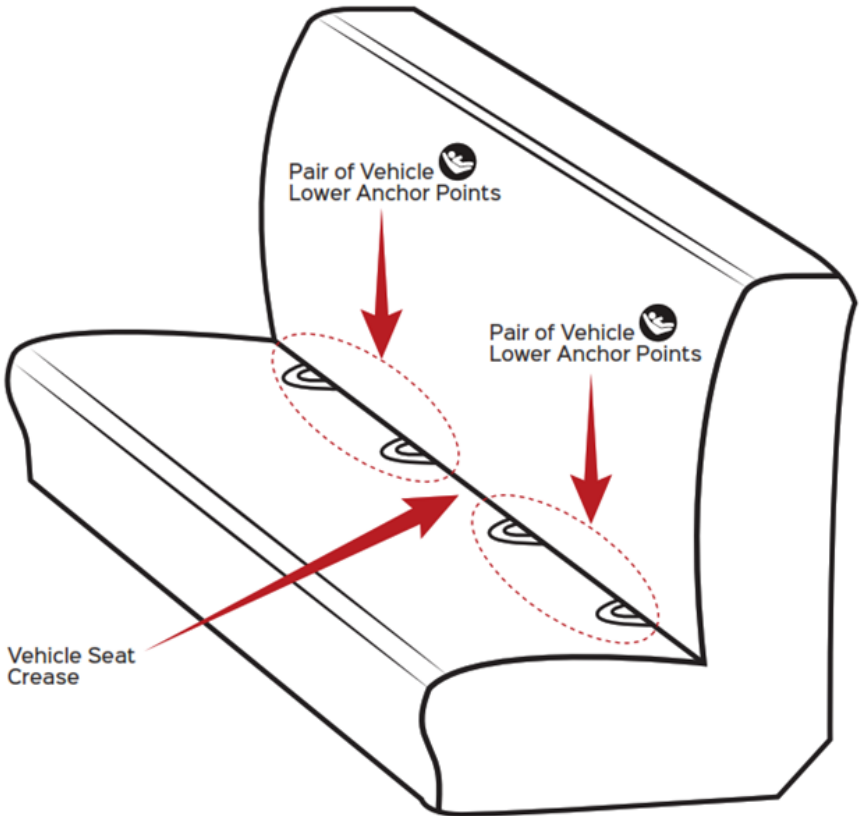

Figure 16

APPENDIX B – LEASH ADDITION

(SOLD SEPERATELY)

#	PART NAME
1	Swivel carabiner
2	Multi-function buckle
3	Accessory D-Ring
4	Poo Bag Clip

1) Walking multiple dogs

- Attach the carabiner to the D-Ring (Figure 18)
- Attach both multi-function buckles to the dog's collars or attachments on the Defender Harness

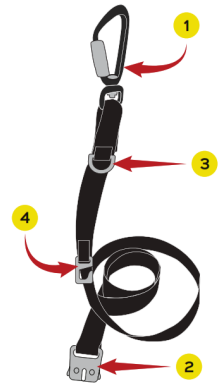

Figure 17

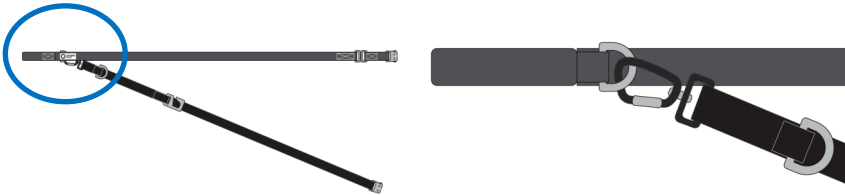
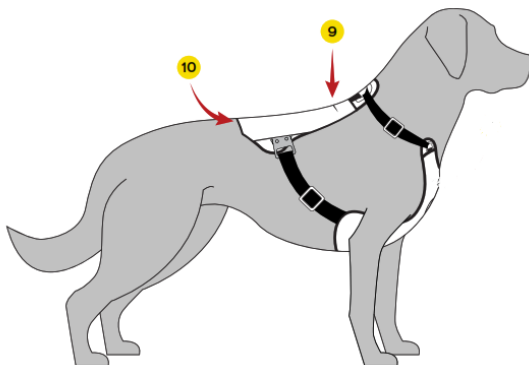

Figure 18 - OG Leash with Leash Addition

2) Pulling a sled using the Defender Harness

- Attach the Multi-Function Buckle to the Defender Harness shoulder buckle ⑨.
- Attach the leash addition's leash connector to the Defender Harness rear buckle ⑩.
- Attach the carabiner to the object being pulled (load cannot exceed 100 [kg]).



APPENDIX C – POO BAG ROLL HOLDER

(SOLD SEPERATELY)

#	PART NAME
1	poo bag access hole
2	s-biner clip
3	leash retainer elastic
4	belt webbing loop

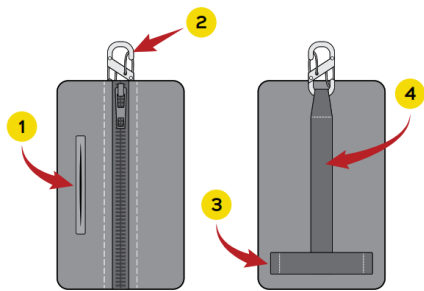

Figure 20

- Slide the leash retainer elastic ③ over leash handle (Figure 21).
- Attach the s-biner ② to the leash D-ring (Figure 22).
- The s-biner ② can be used to attach the poo bag roll holder to other convenient locations such as a backpack, purse, other Optimus Gear® accessories, etc.
- Attach the poo bag roll holder to a belt with belt webbing loop ④ (Figure 23)

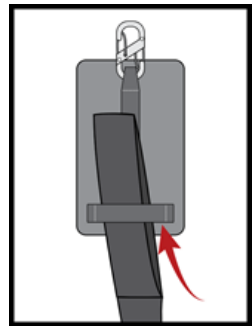

Figure 21

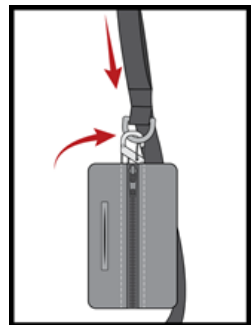

Figure 22

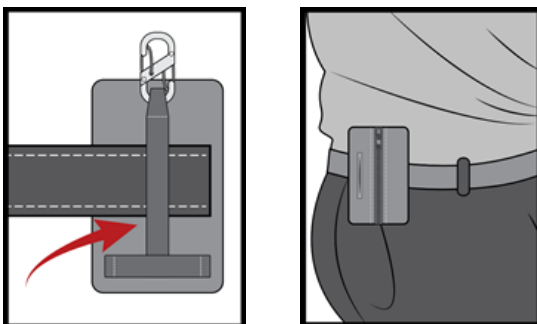

Figure 23

APPENDIX D – ADDITIONAL INFORMATION

VIDEO TUTORIALS

For additional instructions on the Defender Harness and accessories, visit our YouTube® channel or website (www.optimusgear.com). Available videos are:

- OG Defender Harness – Highlights
- OG Defender Harness – Overview
- OG Defender Harness – Installation
- OG Defender Harness – Leash Connections

SIZE CHARTS

HARNESS SIZE CART

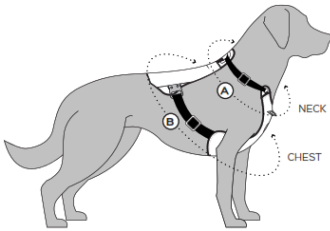

	SMALL	MEDIUM	LARGE
Ⓐ NECK in (cm)	13 - 16 in (33 - 41 cm)	14 - 18 in (35 - 46 cm)	17 - 20 in (43 - 51 cm)
Ⓑ CHEST in (cm)	21 - 27 in (53 - 69 cm)	25 - 33 in (63 - 84 cm)	28 - 39 in (71 - 99 cm)
MAXIMUM WEIGHT lbs (kg)	25 lbs (11.3 kg)	45 lbs (20.4 kg)	75 lbs (34 kg)

COLLAR SIZE CART

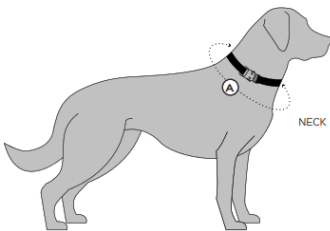

	SMALL	MEDIUM	LARGE
Ⓐ NECK in (cm)	9 - 13.5 in (27 - 35 cm)	12 - 17 in (30 - 43 cm)	14 - 21 in (35 - 54 cm)
WEBBING WIDTH in (cm)	5/8 in (1.6 cm)	3/4 in (1.9 cm)	1 in (2.5 cm)

OTHER OPTIMUS GEAR® PRODUCTS

To complete your suite of Optimus Gear® products make sure to review:

- OG Collar
- OG SeatShields



Dear Customer,

Thank you for purchasing an Optimus Gear Defender Harness! We are confident that it will serve you well for years to come. If you have any questions regarding your purchase please contact us directly at contact@optimusgear.com. We will respond promptly.

Your satisfaction is our ultimate goal.

A handwritten signature in black ink that reads 'Gordon Templeton'.

Gordon Templeton, CEO

HAPPY WITH YOUR PURCHASE?

If so, please let other customers know by posting a review on our website, Google or with the vendor that you purchased the product from.

**JOIN US FOR EXCLUSIVE OFFERS
AND PRODUCT UPDATES**



@OPTIMUSGEARCO