



OPTIMUSGEAR®

**DEFENDER HARNESS
INSTALLATION INSTRUCTIONS**



CONTENTS

DEFENDER HARNESS INSTALLATION INSTRUCTIONS..... 1

INSTALLING VEHICLE TETHERS..... 4

INSTALLING DEFENDER HARNESS ON A DOG..... 6

TRAVELLING IN A VEHICLE WITH YOUR DOG..... 6

LEASH..... 8

LEASH CONVERTOR.....10

APPENDIX A – LATCH.....11

APPENDIX B – LEASH LINK (SOLD SEPERATELY)..... 12

APPENDIX C – POO BAG ROLL HOLDER (SOLD SEPERATELY).....13

LIABILITY DISCLAIMER.....14

ADDITIONAL WARNINGS.....16

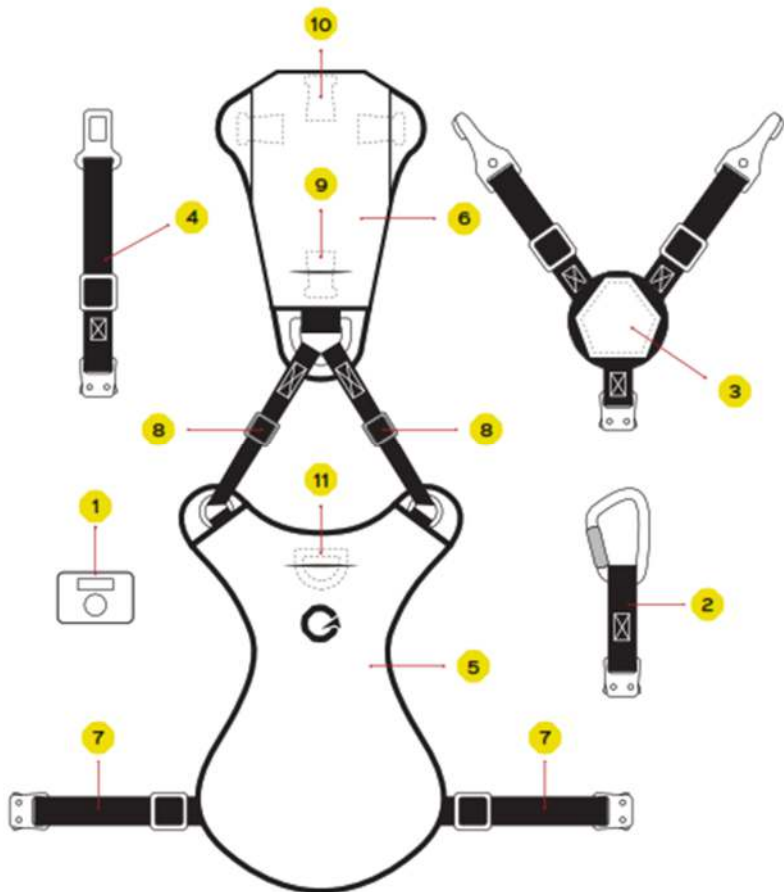

Figure 1

Table 1 - Defender Harness Parts

#	PART NAME
1	Seat belt receiver cover
2	Upper tether assembly
3	Lower tether assembly (LARGE HARNESS)
4	Lower tether assembly (SMALL & MEDIUM HARNESS)
5	Chest panel
6	Back panel
7	Body straps
8	Shoulder straps
9	Shoulder Buckle
10	Rear Buckle
11	Chest D-Ring

INSTALLING VEHICLE TETHERS

Determine the seat where you will install the Defender Harness in your vehicle. Valid seating positions are as follows.

- Large & X-Large – Seat with a LATCH system. (APPENDIX A)
- X-Small, Small & Medium Harness – Captain or bench seat

1) Lower Tether Installation (Large & X-Large Harness)

- Install the lower tether ③ to the LATCH anchors in your vehicle (Figure 2). See Appendix A for a description of how to use your LATCH anchors. For first time use in your vehicle, initially maximize the lower tether length. It will be adjusted in a future

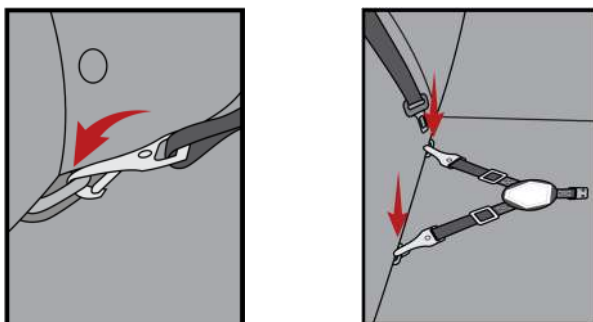

Figure 2

2) Lower Tether Installation (X-Small, Small & Medium Harness)

- Install the seat belt receiver cover ① (Figure 3).
- Install the lower tether seat belt adapter ④ in your vehicle's seat (Figure 3).
- The first time using the harness in your vehicle, initially maximize the lower tether ④ length. It will be adjusted in a future step.

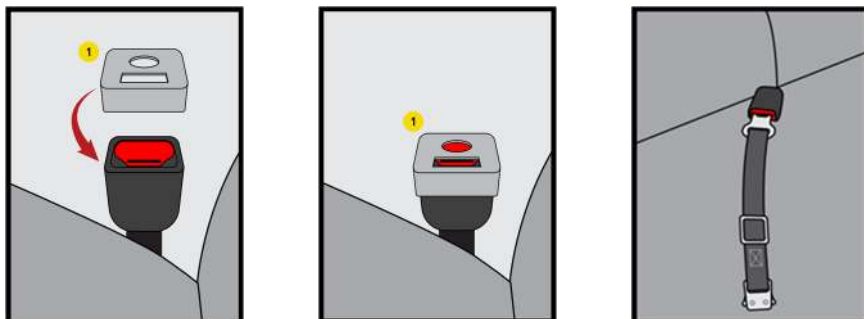

Figure 3

3) Upper Tether Installation (All Sizes)

- Open the upper tether carabiner ② (Figure 4).

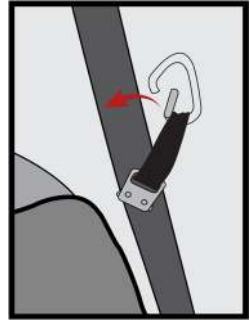

Figure 4

- Install the seat belt inside the upper tether assembly carabiner. Ensure the carabiner latches fully (Figure 5). The carabiner should be able to slide freely on the seat belt.

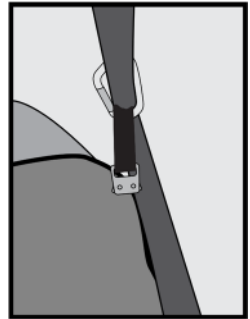

Figure 5

4) Disassembly

The upper and lower tethers can stay in your vehicle until a person needs to use the seat. When this happens perform the following steps:

- Remove the lower tether ③ or ④
- Remove the upper tether ②

INSTALLING DEFENDER HARNESS ON A DOG

Place the harness over your dog's head and position the Optimus Gear® logo (on the chest panel ⑤) in the center of your dog's chest (Figure 6).

- Adjust the body straps ⑦ and shoulder straps ⑧ so that two fingers fit snugly underneath (Figure 6).

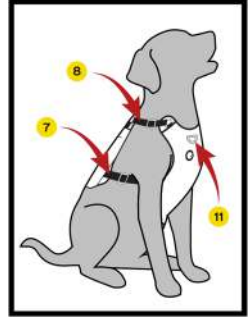

Figure 6

TRAVELING IN A VEHICLE WITH YOUR DOG

- Connect the lower tether ③ or ④ to the rear buckle ⑩ (Figure 7) & (Figure 8).

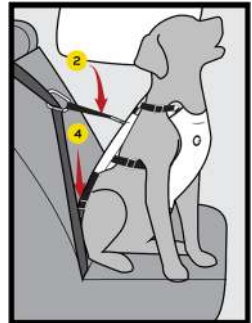

Figure 7

- Connect the upper tether ② to the shoulder buckle ⑨ (Figure 7) & (Figure 8).

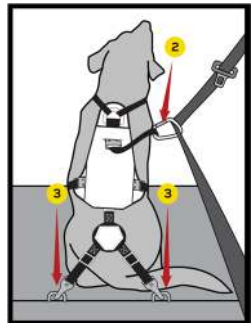

Figure 8

- Adjust the lower tether (3) or (4) length to allow your dog to sit and lie down comfortably (Figure 9). Your dog should not be able to stand.

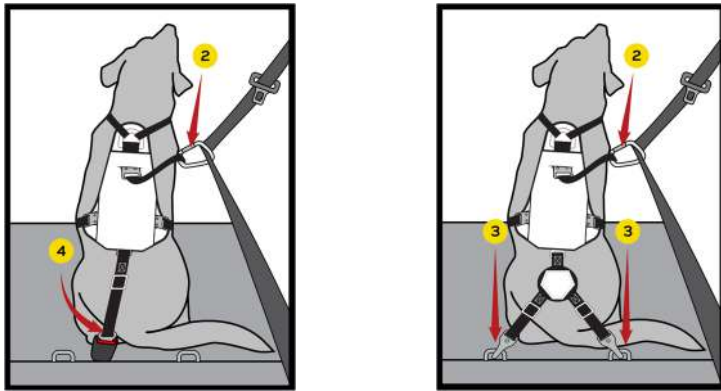

Figure 9

PRODUCT CARE INSTRUCTIONS

To clean your Optimus Gear® Defender Harness or any of its accessories, we recommend placing them in the OG Washing Bag, or a suitable alternative.

- Connect all buckles
- Place Optimus Gear® products in washing bag
- Machine wash cold
- Do not use fabric softeners
- Do not bleach
- Hang to dry
- Do not iron
- Do not dry clean



75% nylon

25% polyester mesh

Aluminium hardware

CA63409

LEASH

#	PART NAME
1	Padded Handle
2	OmniLink Buckle
3	Accessory D-Ring
4	Poo Bag Clip
5	Double Swivel



Figure 10

Connections

Your Optimus Gear® leash can be attached to your Defender Harness in three places or to D-Rings used on collars.

- Shoulder Buckle ⑨
- Rear Buckle ⑩
- Chest D-Ring ⑪
- Collar*

* The Optimus Gear® Leash is designed to be used with the same size classification of Defender Harness and an Optimus Gear® Collar. Other collars must have an equal diameter D-Ring to perform optimally. Optimus Gear® is not responsible for any product damage or jammed due to improper use.

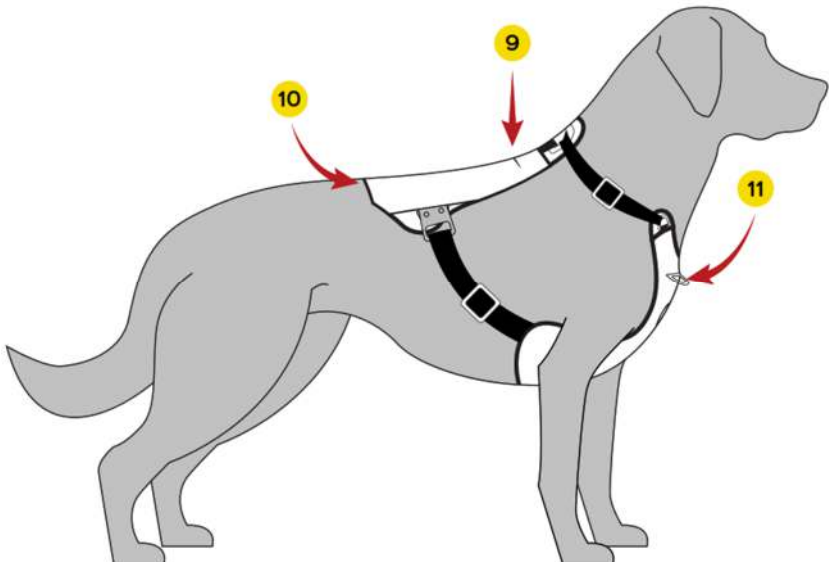

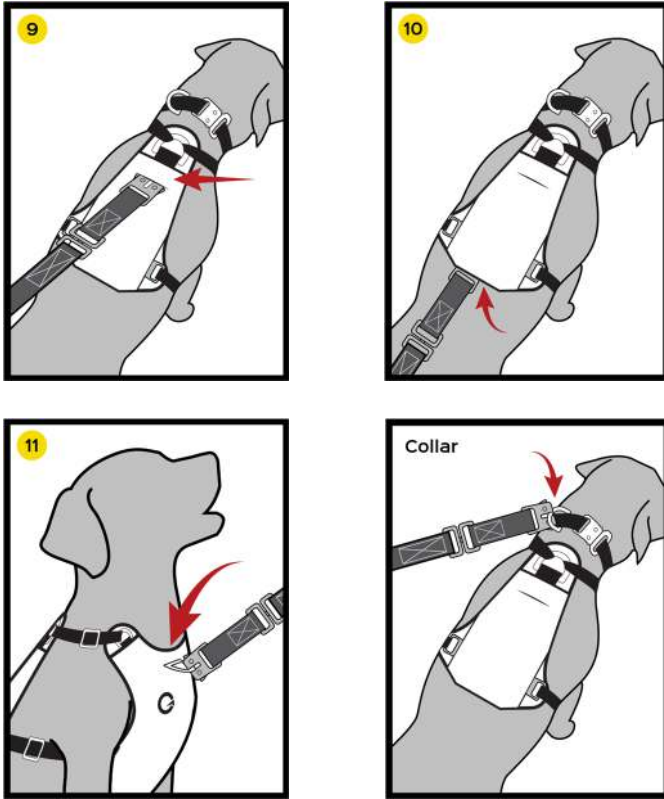

Figure 11 – Leash Connection Points

Suggested basic activities for each connection:

- Shoulder Buckle (walking, running)
- Rear Buckle (walking, running, towing)
- Chest D-Ring (walking / obedience training)
- Collar D-Ring (walking)

Accessory D-Ring

The D-Ring ③ on your Optimus Gear® Leash can be used for:

- Attachment to OmniLink buckle to make the leash wearable
- Optimus Gear® accessory attachment (ex. Poo Bag Roll Holder)
- Leash Link attachment (walking multiple dogs, other activities)

LEASH CONVERTOR

#	PART NAME
1	D-Ring
2	OmniLink buckle

Connections

Using the OmniLink buckle the Optimus Gear® Leash Converter can be attached to your Defender Harness in three places or to D-Rings used on collars.

- Shoulder Buckle ⑨
- Rear Buckle ⑩
- Chest D-Ring ⑪
- Collar*

* The Optimus Gear® Leash is designed to be used with the same size classification of Defender Harness and an Optimus Gear® Collar. Other collars must have an equal diameter D-Ring to perform optimally.

With the Optimus Gear® Leash Converter, any leash can be used to attached to your Defender Harness. Simply attach any other leash to the Leash Converter D-Ring (Figure 13).

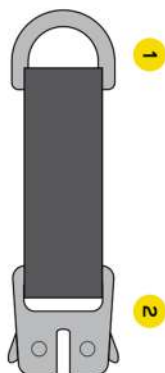

Figure 12



Figure 13

APPENDIX A – LATCH

Vehicles manufactured after 2004 will have one or more **LATCH** anchorage systems. The **LATCH** anchors will be present at seat crease (Figure A1).

Your owner's manual will have more information on the location and load ratings.

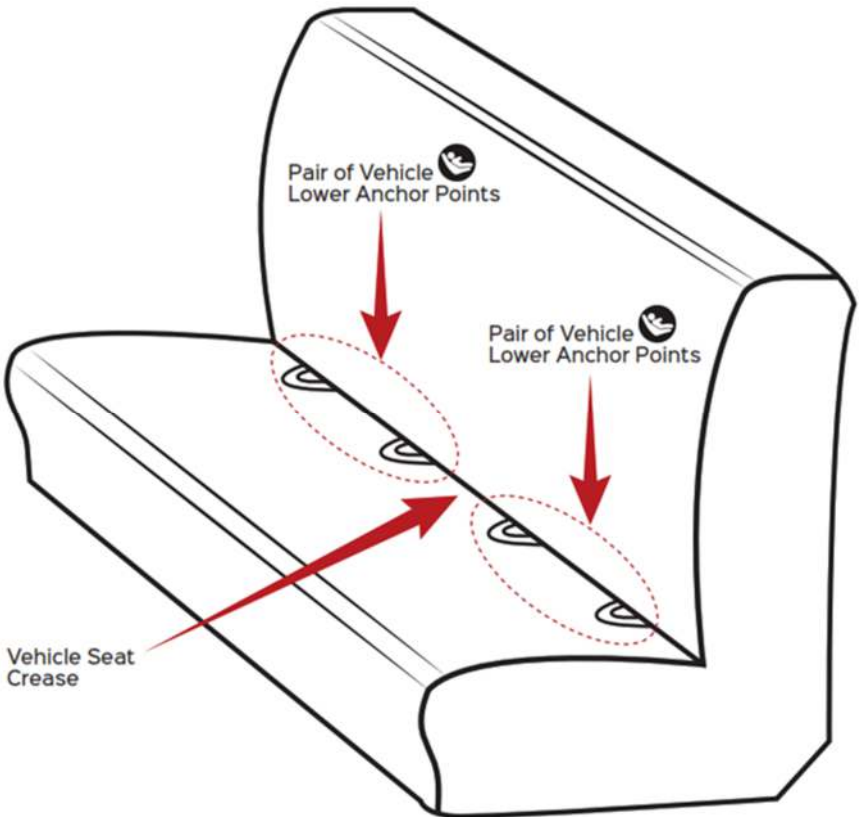

Figure A1

APPENDIX B – LEASH LINK

(SOLD SEPERATELY)

#	PART NAME
1	Swivel carabiner
2	OmniLink buckle
3	Accessory D-Ring
4	Poo Bag Clip

1) Walking multiple dogs

- Attach the carabiner to the D-Ring (Figure B1).
- Attach both OmniLink buckles to the dog's collar or attachments on the Defender Harness (Figure B2).



Figure B1



Figure B2 - OG Leash with Leash Addition

2) Pulling a sled using the Defender Harness

- Attach the OmniLink Buckle to the Defender Harness shoulder buckle ⑨.
- Attach the leash addition's leash connector to the Defender Harness rear buckle ⑩.
- Attach the carabiner to the object being pulled (load cannot exceed 100 [kg]).

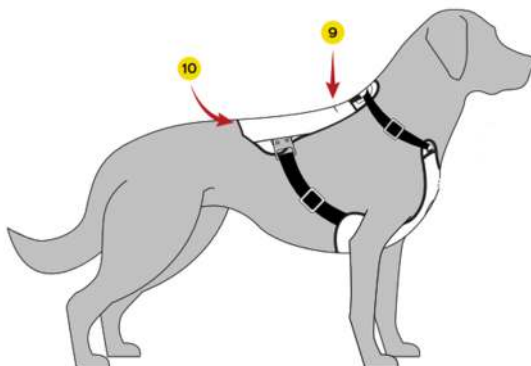

APPENDIX C – POO BAG ROLL HOLDER

(SOLD SEPERATELY)

#	PART NAME
1	Poo bag access hole
2	S-biner clip
3	Leash retainer elastic
4	Belt webbing loop

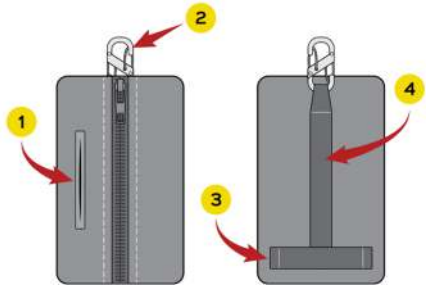

Figure C1

- Slide the leash retainer elastic ③ over leash handle (Figure C2).
- Attach the s-biner ② to the leash D-ring (Figure C3).
- The s-biner ② can be used to attach the poo bag roll holder to other convenient locations such as a backpack, purse, other Optimus Gear® accessories, etc.
- Attach the poo bag roll holder to a belt with belt webbing loop ④ (Figure C4)

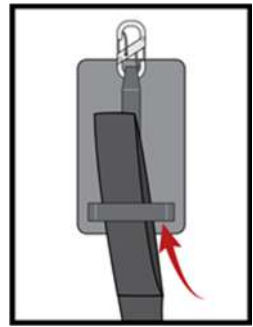

Figure C2

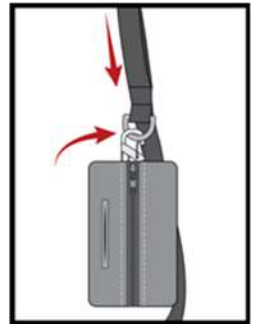

Figure C3

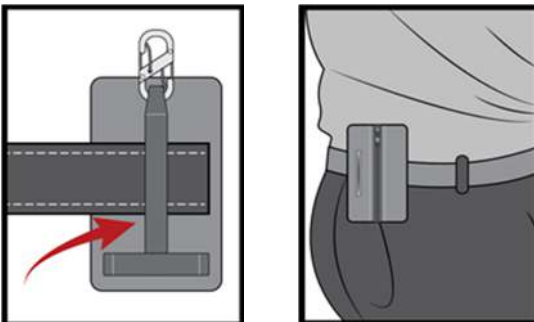

Figure C4

LIABILITY DISCLAIMER

Important Notice

By purchasing and using our Defender Harness, provided by Optimus Gear, you acknowledge and agree to the following terms and conditions. Please read this disclaimer carefully before using our products.

1. ****No Liability for Loss or Damage****: Optimus Gear shall not be held responsible or liable for any loss or damage to any animal or person in the vehicle when using our products, including but not limited to injuries, fatalities, or property damage.
2. ****Safe Usage****: Users are responsible for correctly installing and using our dog seat belts according to the provided instructions. Optimus Gear is not liable for any injuries or accidents resulting from improper installation or use.
3. ****Not a Substitute for Vehicle Safety Measures****: Our crash-rated dog seat belts are designed to enhance pet safety during transportation, but they are not a substitute for other vehicle safety measures. Users should always follow all applicable vehicle safety regulations and guidelines.
4. ****User's Responsibility****: Users are solely responsible for assessing whether our products are suitable for their specific vehicle and pet. Optimus Gear is not liable for any compatibility issues or consequences thereof.
5. ****Assumption of Risk****: The use of our products carries inherent risks, and by using them, you assume all associated risks and liabilities.

6. **Warranty Contact**: In the event of a crash or accident, users may contact Optimus Gear to inquire about eligibility for warranty coverage as stated in our warranty terms.

7. **Legal Compliance**: Users are responsible for ensuring that their use of our products complies with all local, state, and federal laws and regulations.

8. **Lawsuits**: In the event of any legal action, you agree that any dispute shall be resolved through arbitration and not through litigation, and you waive any right to pursue a class action lawsuit.

By purchasing and using our Defender Harness, provided by Optimus Gear, you acknowledge that you have read and understood this disclaimer and agree to its terms. If you do not agree with these terms, please do not use our products.

Please ensure that your warranty terms explicitly outline the conditions under which customers may contact you after a crash for warranty inquiries. As always, consider consulting with a legal professional to confirm that this disclaimer aligns with your specific needs and complies with relevant laws and regulations in your jurisdiction.

ADDITIONAL WARNINGS

Thank you for purchasing your Optimus Gear® Defender Harness. For additional instructions and demonstrations please visit our YouTube® channel or our website www.optimusgear.com. If you require further assistance please email contact@optimusgear.com and we will be happy to assist you.

WARNINGS

Failure to use this product in accordance with the OWNER'S MANUAL INSTRUCTIONS may cause serious INJURY OR DEATH to dog(s) or human(s). Always follow proper instructions for use and care of product and verify all hardware connections are fully engaged and secure. If the product is modified or altered all warranties are void.

The Defender Harness has been crash tested using equipment and test conditions certified for FMVSS 213. The harness maintained its structural integrity when subjected to these conditions.

If the Defender Harness is involved in a collision, it cannot be used again. Crashes can cause imperceptible damage and subsequent use may result in serious injury or death. Do not use the Defender Harness if it is damaged or missing parts.

If you are in a collision you while using the Defender Harness you may qualify for a replacement product. Email contact@optimusgear.com to begin the review process.

Never leave dog unattended, even when sleeping. Dog may become tangled in harness or tether straps and suffocate or strangle.

Never attach two UAS connectors to one vehicle lower anchor point unless specifically allowed by the vehicle manufacturer.

This restraint system may only be used in these classes of vehicles: passenger cars, multi-purpose passenger vehicles and trucks that have vehicle lap/shoulder belts and seat belt receiver and/or tether anchors as required by harness size.



Dear Customer,

Thank you for purchasing an Optimus Gear Defender Harness! We are confident that it will serve you well for years to come. If you have any questions regarding your purchase please contact us directly at contact@optimusgear.com. We will respond promptly.

Your satisfaction is our ultimate goal.

A handwritten signature in black ink that reads "Gordon Templeton".

Gordon Templeton, CEO

HAPPY WITH YOUR PURCHASE?

If so, please let other customers know by posting a review on our website, Google or with the vendor that you purchased the product from.

**JOIN US FOR EXCLUSIVE OFFERS
AND PRODUCT UPDATES**



@OPTIMUSGEARCO