

Joseph
Joseph®

DoorStore™ Utensils

Installation instructions



How to install

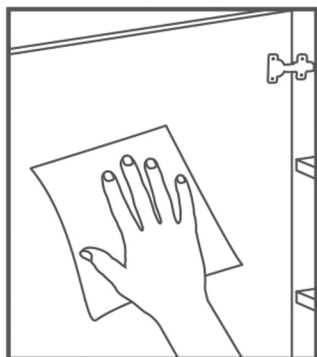

1. Clean and dry surface before application.

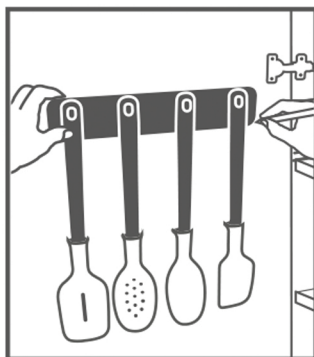

2. Ensuring the cupboard door can close, lightly mark the position of the rack edges with a pencil.

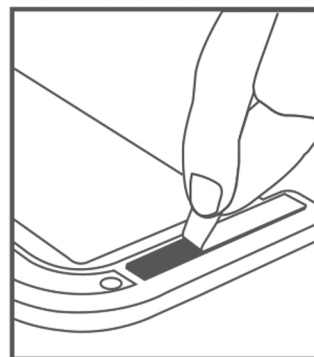

3. Remove the utensils and peel off backing tape.

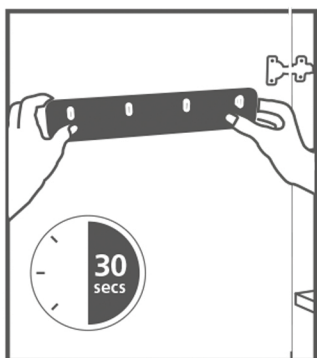

4. Align rack edges with pencil marks and press firmly for 30 seconds.

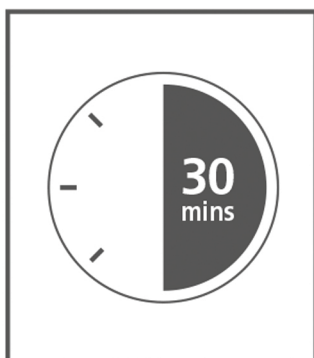

5. Wait 30 minutes before storing the utensils.

