



# EXQ021

## ALUMINUM PROFILE

SURFACE MOUNT ANGLED PROFILE

### DESCRIPTION

Accent illumination without glare. Compact and versatile. 2 meters in length. Line of light. Made from high quality anodized aluminum.

### DIMENSIONS (in MM)

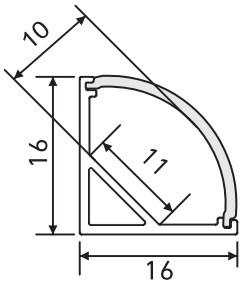

### FEATURES

- Dot free frosted lens to pair with Luminiz LED strip
- Includes end caps and mounting brackets
- Extrusion acts as heatsink
- 45° beam angle

### APPLICATIONS

Interior lighting, cabinets, stairs, glass cases, decorative dry wall ceilings and walls, floors, retail & store front windows

### ACCESSORIES

Endcaps



EXECQ021

Brackets/Clips



EXCL04