

INVISIBLE FIXINGS BUTTON TYPE—WALL/INSTALLATION SURFACE MUST BE FLAT

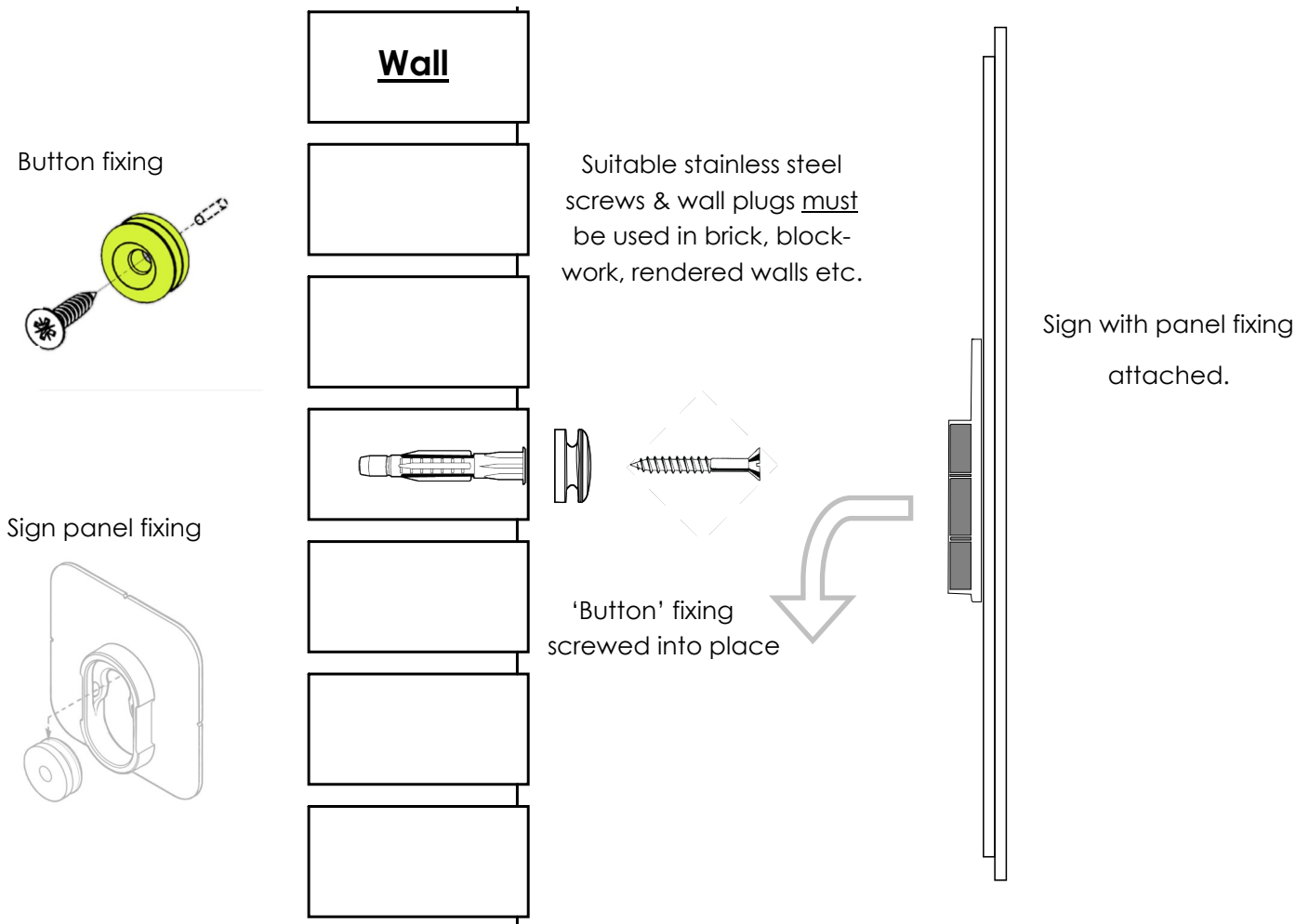

Carefully measure the hole centres using the sign back.

Transfer the hole centres onto the wall. It's important these are accurate.

Drill a suitable hole and insert wall plug (wall plug not included).

Using the stainless steel screws, attach the 'button' fixings into place on the wall.

DO NOT OVERTIGHTEN AND DAMAGE BUTTON FIXINGS, AN ELECTRIC DRILL OR SCREWDRIVER IS NOT RECOMMENDED

Align the fixings and push the sign over the button and then downwards into place, listen for the click.

**HANDLE WITH GREAT CARE
PLEASE FOLLOW INSTRUCTIONS FOR INSTALLATION CAREFULLY
KREATIV DESIGN CAN'T BE HELD RESPONSIBLE FOR
INCORRECT HANDLING OR INSTALLATION**



KREATIV-DESIGN