



User Guide

Installing and setting up the Hik-Connect App on a smartphone

Version 1.2 Updated April 2020

Copyright © 2020 StockCam UK

Contents

1.	Installing the App on your smartphone	1
1.1.	Go to your smartphone Store to download the free app:	1
1.2.	Search for the app in your App/Play Store:	1
2.	How to set up the app on your smartphone (prior to logging in)	2
2.1.	Open the Hik-Connect App on your smartphone	2
2.2.	Allow Hik-Connect to access media files on your smartphone.....	2
2.3.	Select Country or Region.....	2
3.	How to login to the app	4
3.1.	Logging in.....	4
3.1.	Now you are logged in – device(s) should be listed (remote access).....	6
3.2.	Inputting Verification Code to access the device(s).....	7
3.3.	Adding your device to your smartphone locally.	8
3.4.	Changing the name of your local device you have added (to something meaningful)	13

1. Installing the App on your smartphone

1.1. Go to your smartphone Store to download the free app:

iPhone users will download/install the app from **App Store**



Android users will download/install the app from **Play Store**



1.2. Search for the app in your App/Play Store:

Search for the App **Hik-Connect**

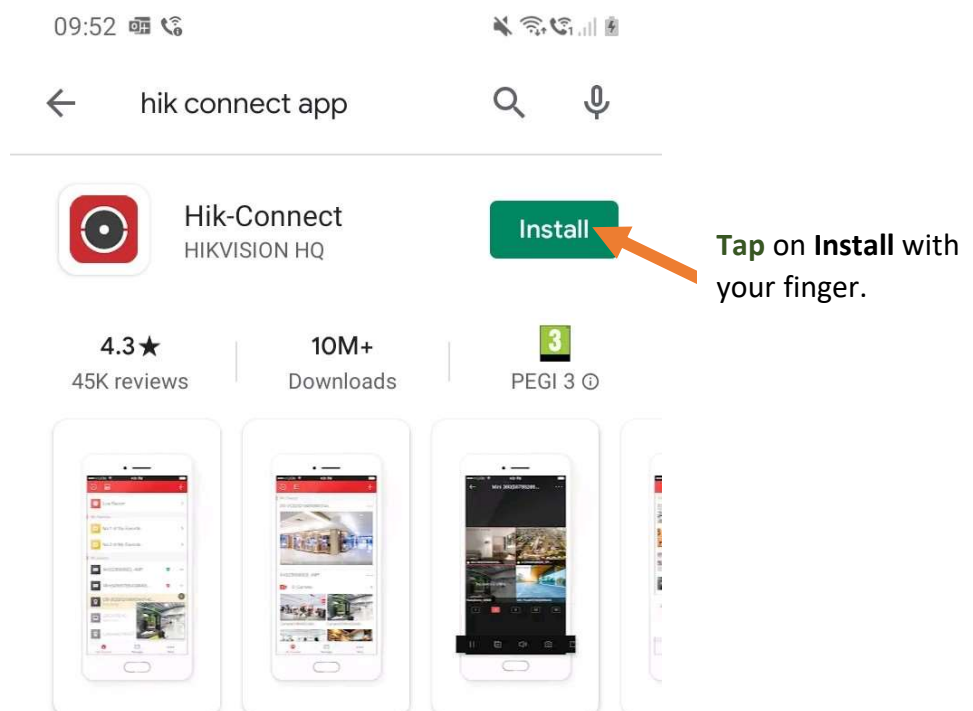

2. How to set up the app on your smartphone (prior to logging in)

2.1. Open the Hik-Connect App on your smartphone

Tap on your Hik-Connect App and wait for it to load

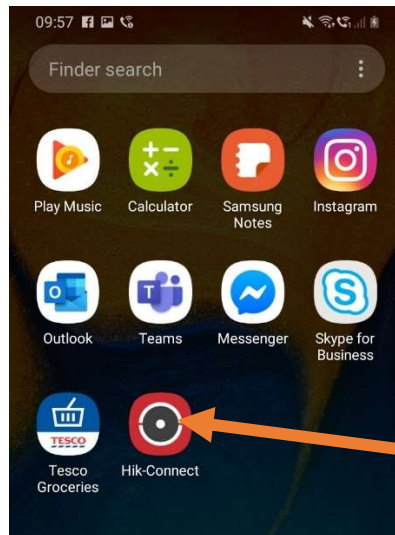

Tap on the **Hik-Connect** app with your finger.

2.2. Allow Hik-Connect to access media files on your smartphone

You may see a message asking if you want to Allow or Deny Hik-Connect to access photos, media and files on your device. Click **Allow**, otherwise you won't be able to save photos from your camera if you need to.

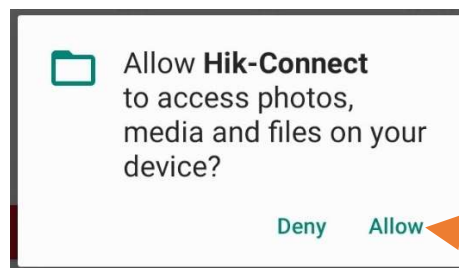

Tap on **Allow** with your finger.

2.3. Select Country or Region

Tap on the red button



Tap on **Select Country or Region** with your finger.



You will then be prompted with a list - Country/Region, scroll down to **United Kingdom** and **Tap** on it, a tick will appear to the right of it (a blue tick on Android devices).

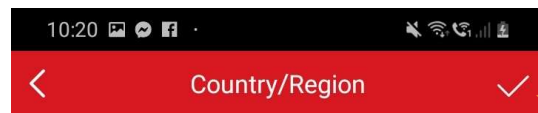

b) Tap on the **tick** at the top right, to confirm your choice.

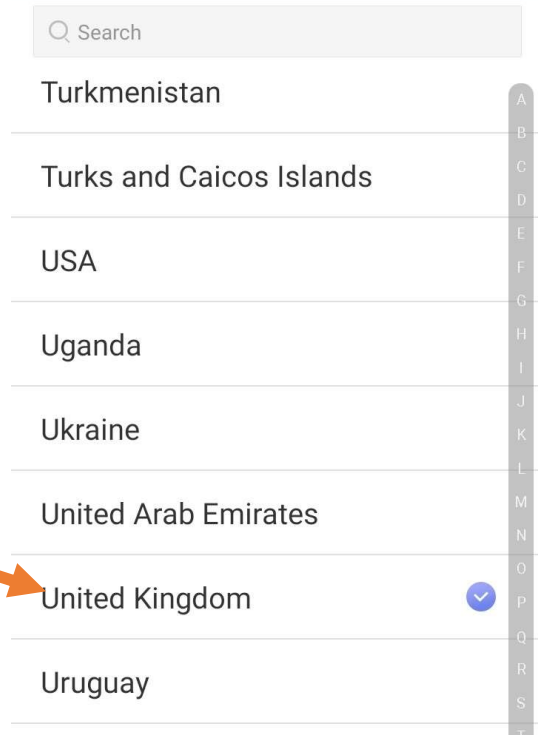

a) Tap on **United Kingdom** with your finger. A tick appears.

3. How to login to the app

3.1. Logging in.

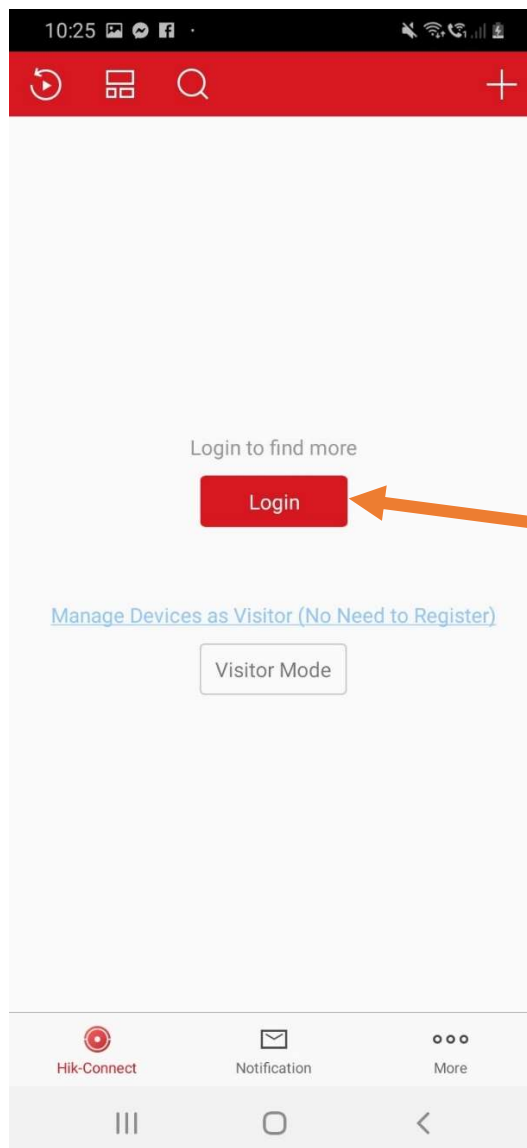

Tap on Login with your finger.

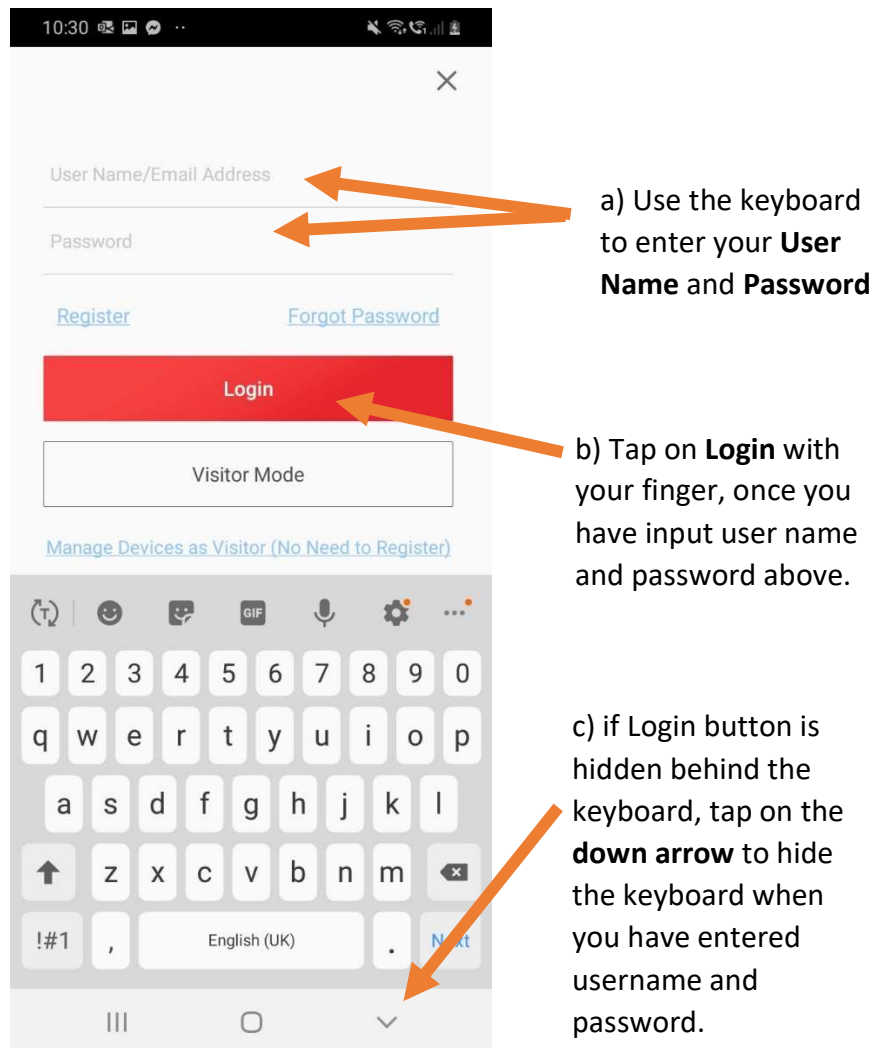

You will have been given a **username**, **password** and **verification code** for your account, you will need all three to access your account and view live footage from the camera(s). Make a note of them here if you need to.

Username:	
Password:	
Verification Code:	

You will be able to change the password yourself to something more memorable once you are happy the system is working as expected.

You **may** see a message regarding blocking push notifications, you can skip this step and **Ask Me Later** if you wish.

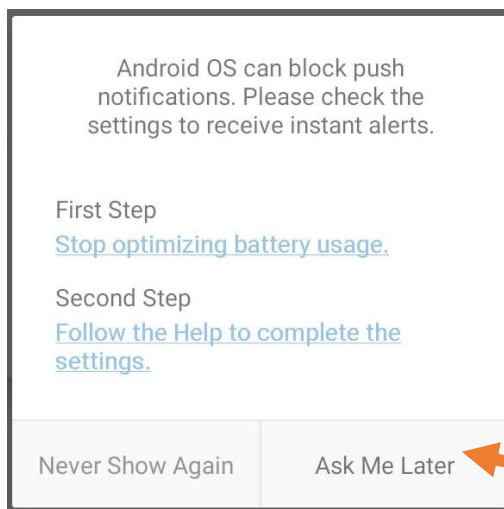

Tap **Ask Me Later** to set this up once your camera(s) are working.

3.1. Now you are logged in – device(s) should be listed (remote access).

You should now see your device(s) once you are logged in, this could be an NVR (if you have a Network Video Recorder), or camera(s) if you don't have the NVR. The device(s) listed will be the device StockCam have setup for you to access remotely (i.e. away from your farm/premises). This should be a dark colour logo next to each device in picture a), if the device(s) is grey as in picture b) this means your app can't see your device, and there are troubleshooting steps to go through (different user guide) for this.

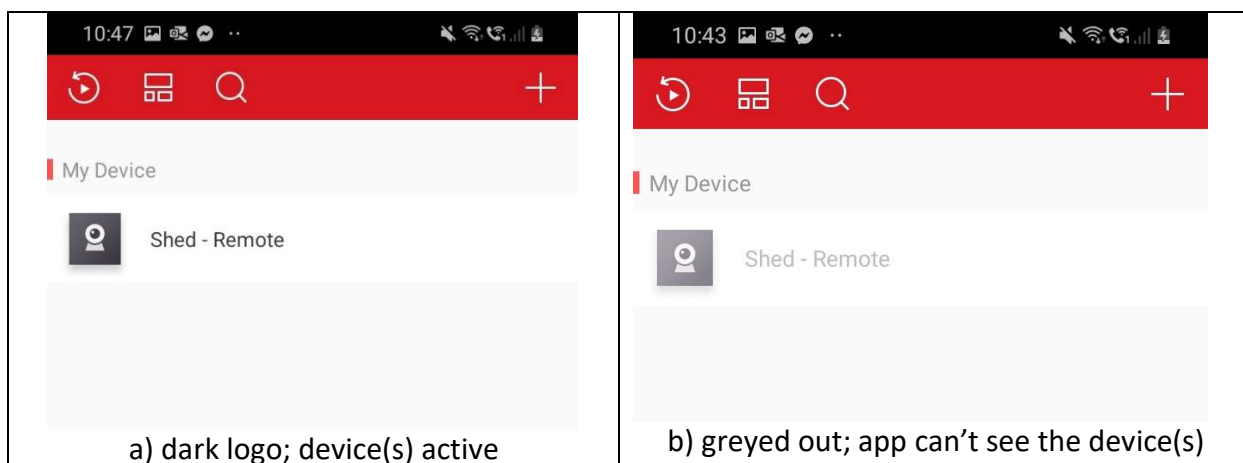

3.2. Inputting Verification Code to access the device(s)

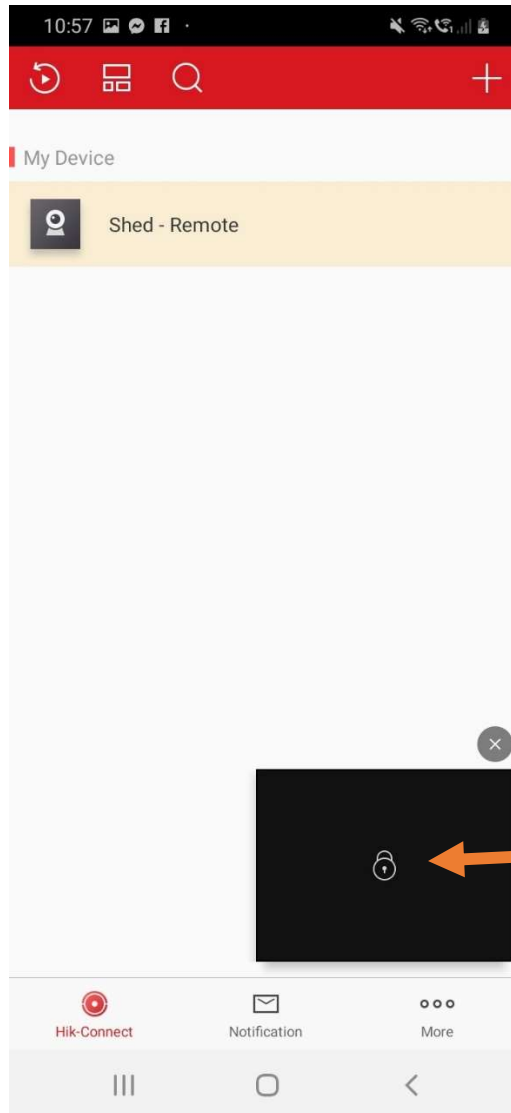

a) Tap **Device (e.g. Shed – Remote)** with your finger, you will then see a black box appear for the device with a padlock in the centre of it.

b) Tap **Padlock** with your finger, you will then be prompted for the verification code. If you have more than one device you will need to tap on the padlock on each device.

You will now be prompted to enter the Verification Code

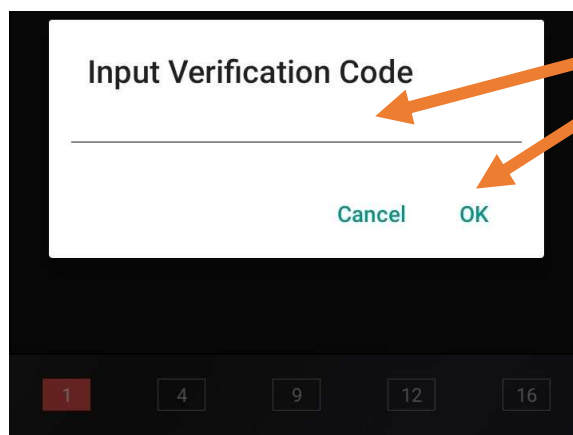

c) **Tap** in the box/field and enter the verification code you have been given, then **Tap on OK**.

Your camera(s) should not be active and visible on your account.

3.3. Adding your device to your smartphone locally.

Once you are logged in and have input the verification code, you will be able to see the device(s) that StockCam have setup **remotely** for you. This means that you are viewing the camera(s) as if you were away from your premises/farm. There may be a slight delay with the live view using this method to access the camera if you are at home using your wireless network. This is because your smartphone may be going out to the internet and back in again to access the camera(s). To speed this up when you are at home, you can add the device(s) **locally**, that is your NVR if you have one, or each individual camera if you don't have an NVR.

To do this, click on the + sign at the top right of your screen

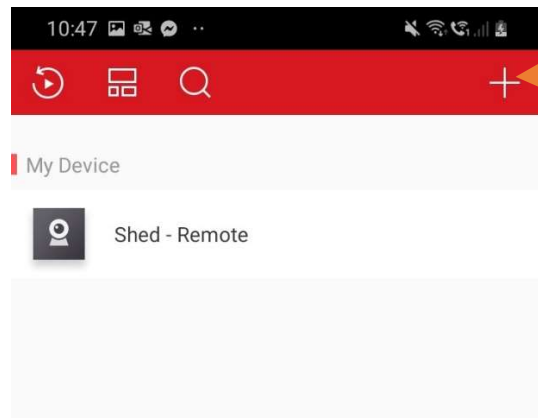

a) **Tap** on the + sign to add device(s) locally to speed up the live view (so there is less delay)

Now **Tap** on **Online Device** (make sure you are connected to your home wireless network first otherwise this will not work).

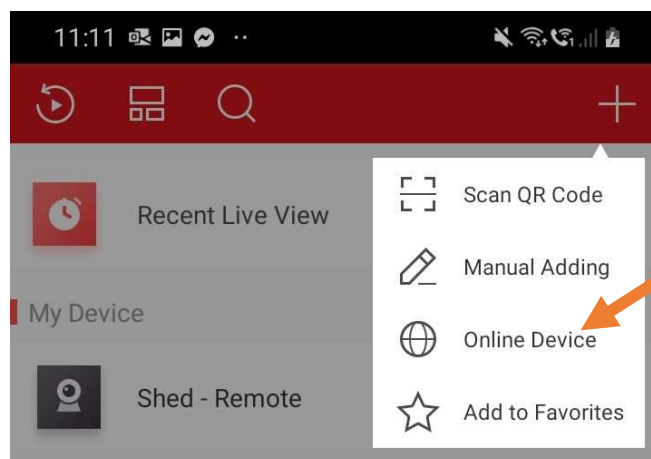

a) **Tap** on **Online Device**

You will then see a list of potential devices to add (the amount you see depends on how many cameras you have, or if you have an NVR). If you have an NVR please **tap** on this (usually the IP address of an NVR is 192.168.1.200 or 192.168.0.200). If you don't have an NVR, then add each camera individually.

In this example, I will add a device with IP address 192.168.10.201 (this is just an example, yours will be a different address).

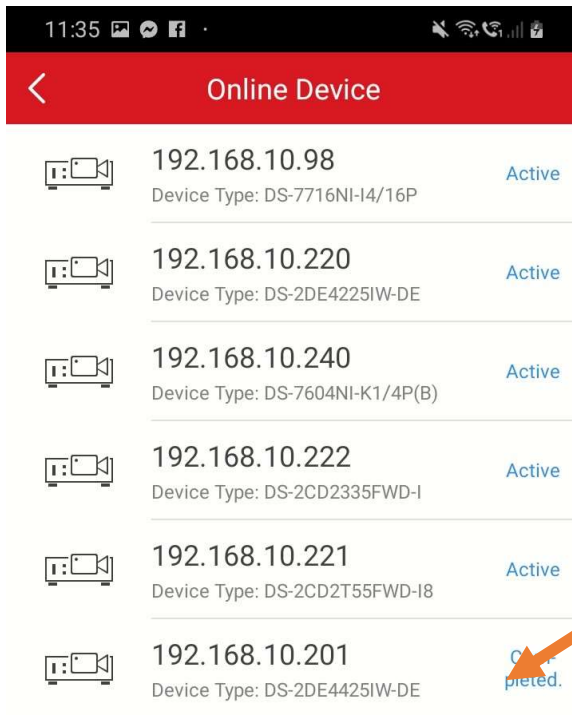

Tap on the device you want to add e.g. 192.168.1.200 (NVR) or 192.168.1.201 (camera 1)

You will then be prompted for the username and password, this is for the camera or NVR, you will have been given this, the username is always **admin** and the password normally matches the Hik-Connect password to login to the app.

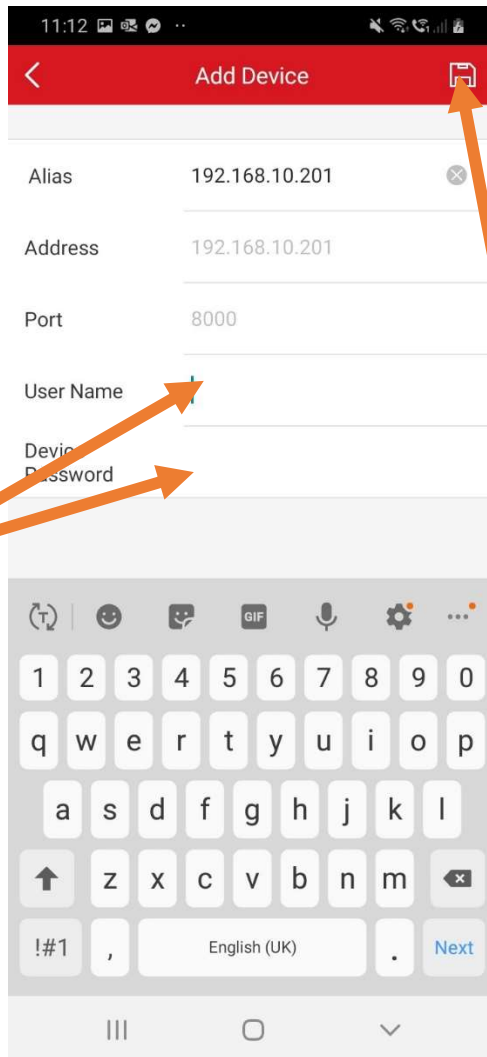

a) **Tap** on each box and enter username (admin) and password (usually same as Hik-Connect app password)

b) **Tap** on the save button (looks like a floppy disk),

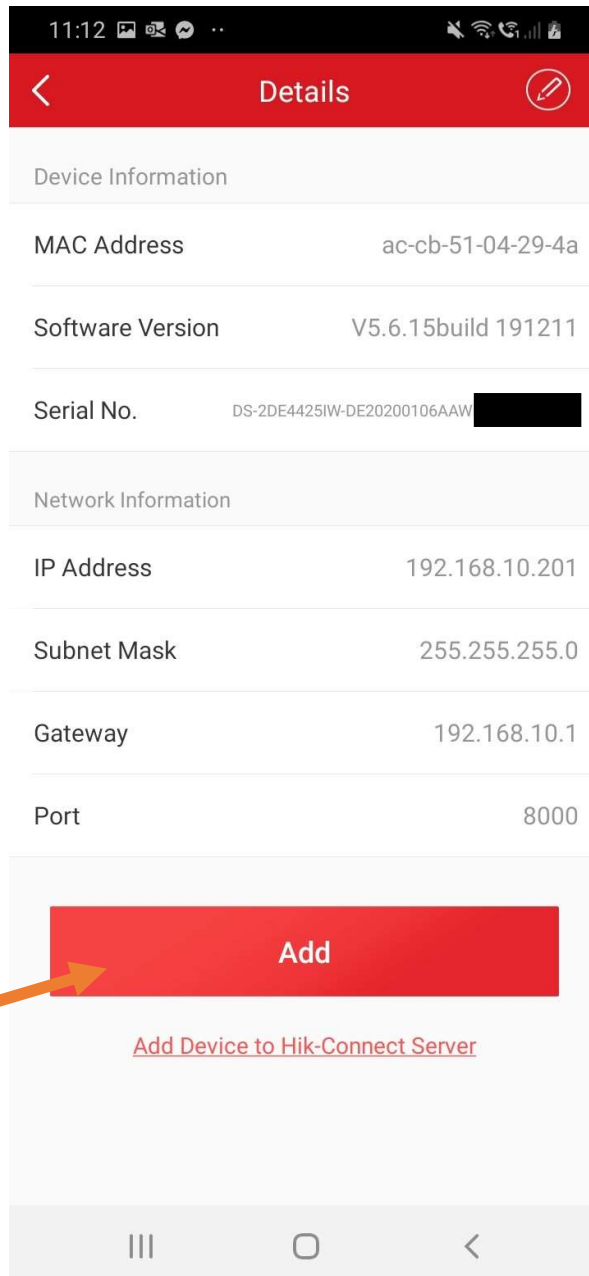

a) **Tap** on Add to save the local access to the device (camera or NVR)

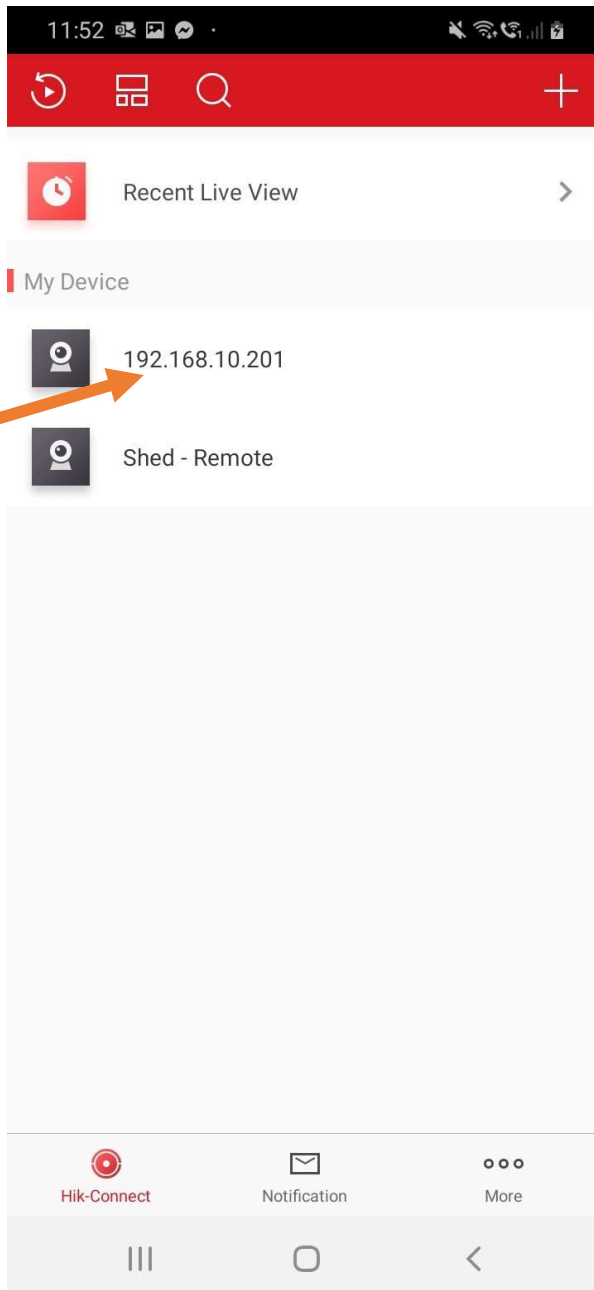

a) The device has been added for local access, use this one when you are at home accessing the camera(s). You can change the name to something more meaningful.

3.4.Changing the name of your local device you have added (to something meaningful)

- a) To change the name of the device you have added (to give it a more meaningful description). **Tap** on the device you have added (e.g. tap on 192.168.1.200 or 192.168.1.201).

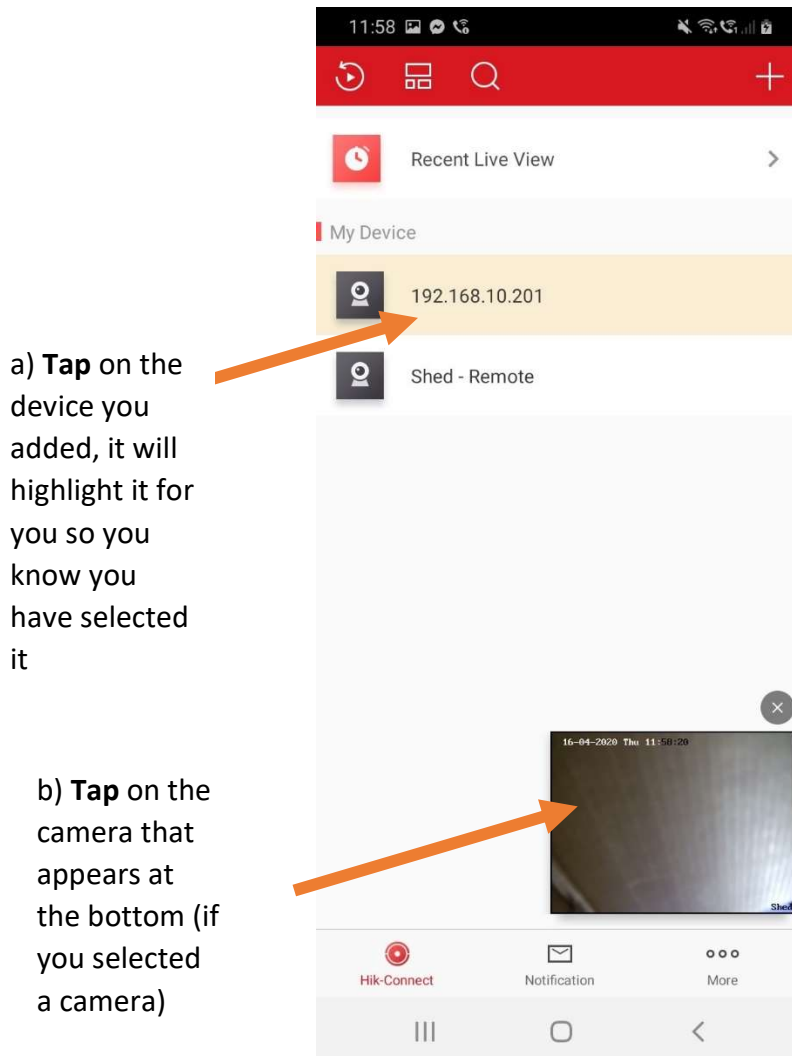

- b) You can then **Tap** on the camera listed.

c) Now **Tap** on the three dots ... at the top right of the screen.

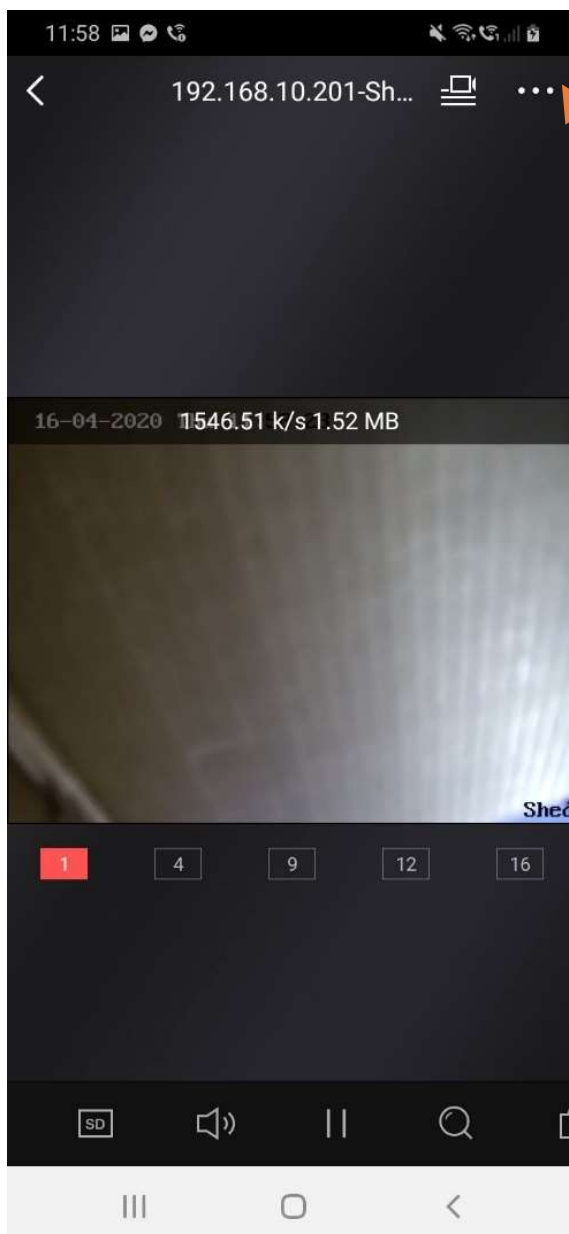

c) **Tap** on the three dots ...

d) Now **Tap** on **Settings**

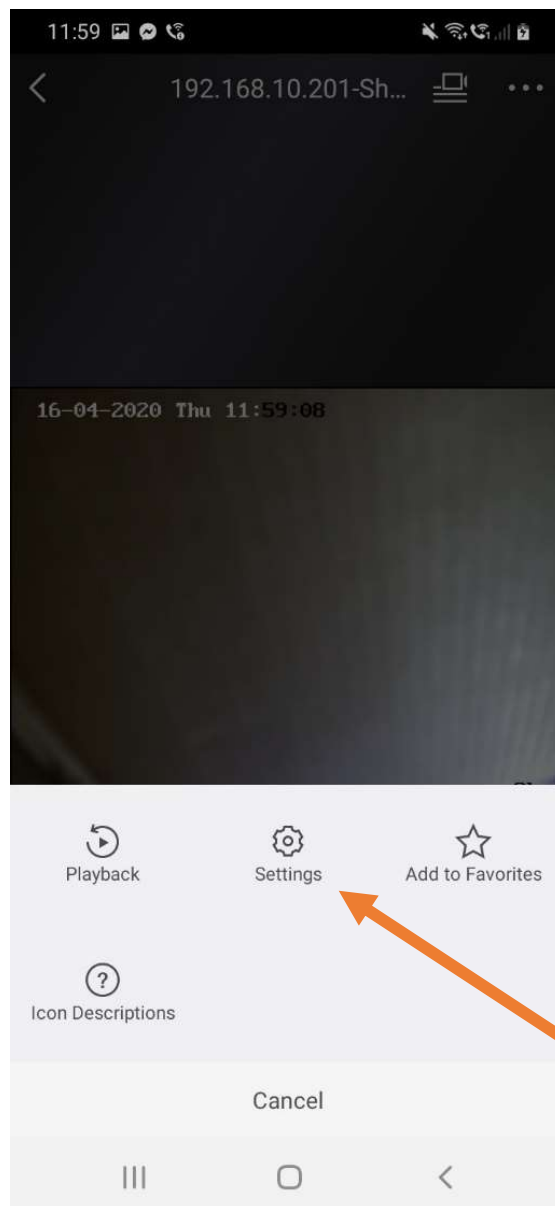

d) **Tap** on **Settings**

e) Now **Tap** on the **Edit** button at the top right of the screen (looks like a pencil).

Adding Type	IP/Domain
Alias	192.168.10.201
Address	192.168.10.201
Port	8000
User Name	admin
Device Password
Camera No.	1

e) **Tap** on **Edit**
(looks like a pencil)

f) Now **Tap** on the box next to **Alias**. Alias is the name you want to change, so for example enter **Shed – Local**

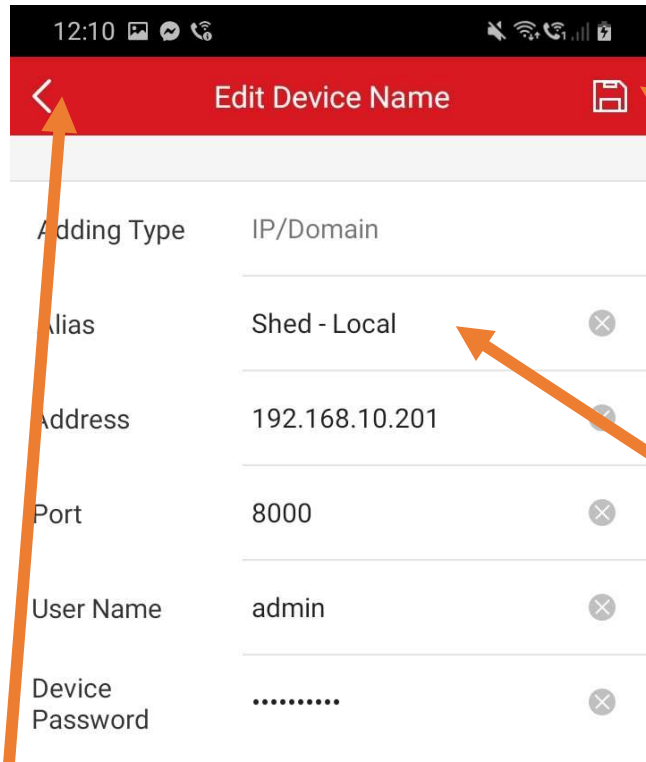

g) **Tap** on the **Save** button, this looks like a floppy disk

f) **Tap** on the box next to **Alias** and enter the name you want for the device, we suggest you put – Local at the end of it so you know it is to access it from home / your wireless network.

h) **Tap** on the **Back** button (twice)

g) Now **Tap** on the **Save** button at the top right (looks like a floppy disk).

h) Now you can **Tap** on the back arrow at the top left of your screen, tap on the back arrow again to go back to your devices listed.

i) You should now see the name has changed.

