

CWI 8A1 Installation Instructions

Installation Instructions

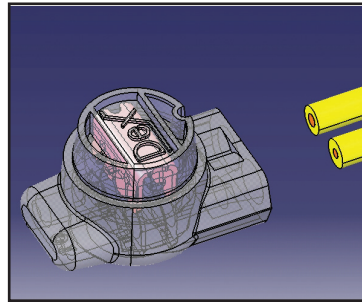

1. Approved Crimping tool



2. Ensure the wires to be terminated are cut flush and cleanly. Important no ragged edges are present on the insulation.

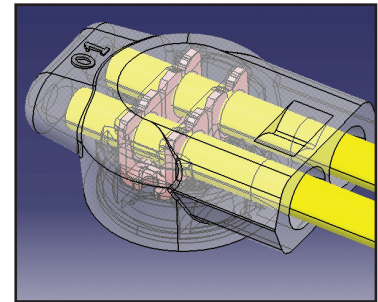

3. Fully insert wires fully into the connector base. The wires are visible in the base so you can see they inserted fully past the IDC blade contact. Pre-crimp if required using fingers if performing multiple crimping

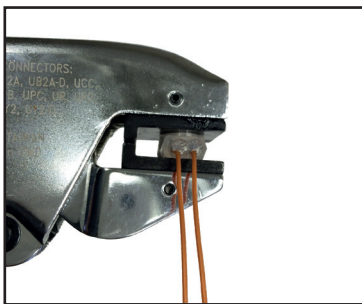

4. Use approved tooling for 2/3 wire connector terminations when installing. Apply pressure evenly to the top of the connector during crimping.

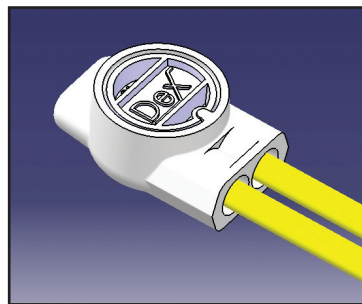

5. Fully crimp top cover so its flush with base housing top.