

## TYXIA 2600

**EN Battery powered  
multifunction  
transmitter**



### Technical characteristics

- Power supply: Lithium 3 V CR2032 battery life up to 8 years depending on use
- Class III insulation
- Storage temperature: -10°C/+50°C
- Operating temperature: -10°C/+40°C
- IP 40 (flush mounting box)
- Dimensions: 41 x 36 x 8 mm
- X3D wireless remote control device: 868.7 MHz to 869.2 MHz
- Maximum radio power < 10 mW
- Receiver category: 2



**EN** The TYXIA 2600 can control the lighting, lighting dimming, roller shutters, control systems and scenarios.

It is compatible with the following control types:

- Single or double switch.
- Single or double push-button.
- 3-way roller shutter switch.

### 1 - Stage 1: Install your product

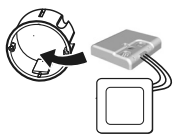

Install the TYXIA 2600 in the flush mounting box of the switch.

**!** Do not strip the wires when they are connected to the product as you could damage the internal connector.

#### 1.1 Connection instructions for IN1 - COM - IN2 terminals

- Use the wires supplied.
- Push the wire fully into the terminal.

**Removal recommendations**  
Turn the wire while pulling on it.

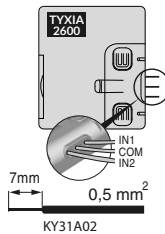
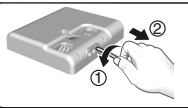

**Switch**  
single or double.

**Push-button**  
single or double.

Local control wires can be extended up to 10 m (separate from the 230 V).

### 2 - Stage 2: Determine the operating mode

By default, the operating mode of the TYXIA is mode 1:

- 1a to control the lighting via an On/Off switch,
- 1b to control a roller shutter via a Raise/Stop/Lower 3-way switch,

**IMPORTANT: If you approve this selection, go directly to stage 3, 'Associate your product'.**

Otherwise, determine the operating mode suited to your system.

Lighting control      Scenario control  
Lighting dimmer      Roller shutter control

Use								
Control								
Mode	1a	2a	3a *	2a	4a	1b	2b	3b
Association	A or B > 3s					A + B > 3s		

(\* Lighting dimmer compatibility: See the dimmer manual)

#### • For modes 1a, 2a, 3a and 4a

- Buttons A and B can be configured separately.
- Press the button to be configured for 6 seconds (A or B).
- The red LED lights up, switches off then switches on steady, release.
- The LED displays the number of green flashes of the current operating mode.

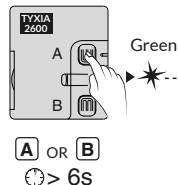

- Successively press button A to change the mode.

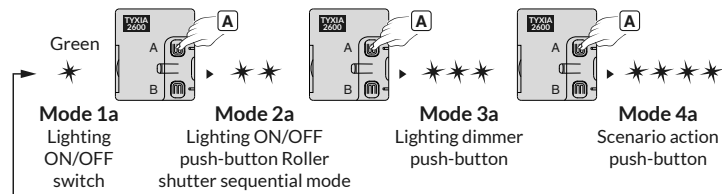

- Confirm the selected mode by pressing button B for 3 seconds until the LED turns green.

**Confirmation**

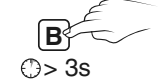

#### 2.1 • For modes 1b, 2b and 3b

- Press buttons A and B at the same time and hold for 6 seconds.
- The red LEDs light up, go out and light up steady, release.
- The LEDs display the number of green flashes of the current operating mode.

- Successively press the button A to change mode.

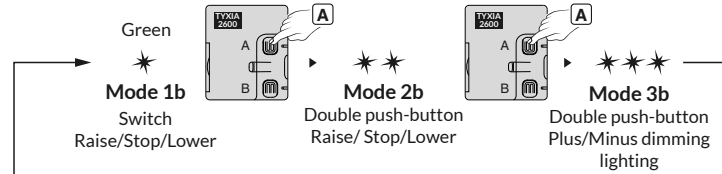

- Confirm the selected mode by pressing button for 3 seconds until the LED turns green.

**Confirmation B**



### 3 - Stage 3: Associate your product

**Important:** If you have selected operating mode 4a (scenario control), set each item to the required state (e.g. shutters lowered, lighting off) before moving on to stage 1.

**1** - Set the receiver to association wait mode (refer to the user guide).

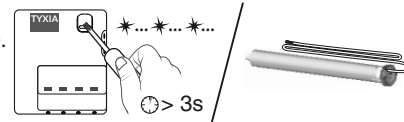

**2** - Associate the TYXIA 2600

- **Modes 1a, 2a, 3a, and 4a:**  
Send the association command by pressing the button of the channel to associate (A or B) for 3 seconds.

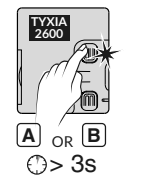

- **Modes 1b, 2b and 3b:**  
Send the association command by pressing the buttons A or B for 3 seconds at the same time.

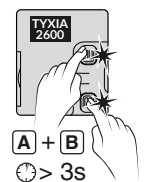

**3** - The products are associated of the LED of the receiver or receivers is no longer flashing.

### Troubleshooting

**Summary of functions :**

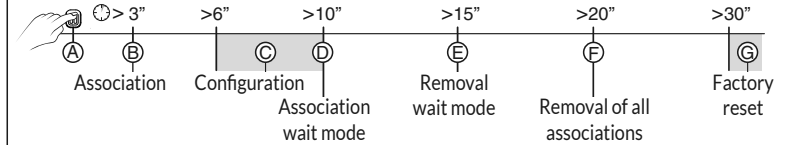

**A** Checking the transmitter operating mode.

- Briefly press button A or B.
- The LED or LEDs flash:
- 1 green flash: **MODE 1**
- 2 green flashes: **MODE 2**
- 3 green flashes: **MODE 3**
- 4 green flashes: **MODE 4**

**B** Association

- Press the transmitter button or buttons for 3 seconds (according to configuration) until the LED flashes. Release

**C** Configuration

- Press the transmitter button for 6 seconds.
- The LED flashes, then becomes steady, release.

**D** Association wait mode for a receiver from the emitter

- Press button A, B or A + B for 10 seconds until the red LED flashes twice in succession.
- Associate a new product.

**E** Removal wait mode for a receiver from the emitter

- Press button A, B or A + B for 15 seconds until the red LED flashes 3 times in succession.
- Press the transmitter to be removed for 3 seconds: the link with the receiver is removed.

**F** Remove all associations

- Press button A, B or A + B for 20 seconds until the red LED flashes 4 times. Channels A, B, or A + B are removed from all the receivers.

**G** Factory reset

- Press button A, B or A + B for 30 seconds until the LED or LEDs flash then switch off.
- The configuration of channel A, B or A+B is reset (mode 1 by default). Repeat the operation for each channel to reset.

• **The TYXIA 2600 cannot be associated with a receiver.**

- Check that the selected operating mode matches the function to be used.
- Check that the receiver is in association wait mode.
- Check that the receiver is within wireless range (100 m in free field). The propagation could be affected, so avoid installing products near large metal masses (beams, etc.) or an electrical switchboard.

• **Impossible to control an associated receiver**

- Check that the receiver is correctly associated with the transmitter.
- Check that the receiver did not remain in association mode
- Check the transmitter battery.

• **The transmitter LED does not come on**

- Press a button of the transmitter for 3 seconds to exit the storage mode (energy saving).

• **Battery replacement**

Use a tool to remove the battery.

