

INSTRUCTION MANUAL



MODEL NUMBER: HC03010-US

SINGLE SERVE COFFEE MACHINE



HADEN

ESTD. ENGLAND 1958

How Can We Help?

The Haden team is always interested in what you have to say, so why not get in touch?



Call us

California: +1 562 942 0492

Outside California: +1 866 942 0492

Available Monday - Friday

8am - 4:30pm P.T



Email us

service@hadenusa.com



Write to us

**Team Haden, Studio Designs,
6027 Bandini Blvd, Commerce, CA
90040**



Visit us

www.hadenusa.com

COMPONENTS

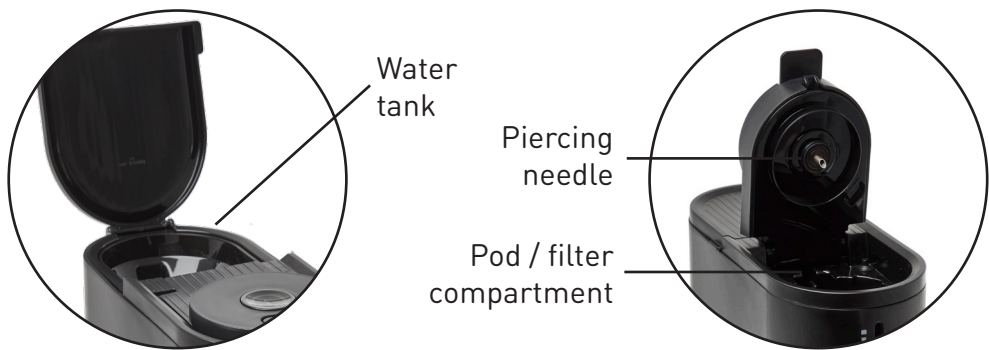

IMPORTANT SAFEGUARDS

When using this coffee machine, basic safety precautions should always be followed including the following:

1. Read all instructions.
2. Make sure that your outlet voltage corresponds to the voltage stated on the rating label of the coffee machine.
3. Do not operate any coffee machine with a damaged cord or plug or after the coffee machine malfunctions or has been damaged in any manner. Return coffee machine to the nearest authorized service facility for examination, repair, or adjustment.
4. Do not touch hot surfaces. Use lid and lever.
5. All the accessories must be complete and in good condition.
6. To protect against fire, electric shock and injury to persons do not immerse product, cord, plug, in water or any other liquid.
7. Close supervision is necessary when any appliance is used by or near children.
8. Unplug from outlet when not in use and before cleaning. Allow to cool before placing or taking off parts, and before cleaning the coffee machine.
9. The use of accessories not recommended by Haden may result in fire, electric shock or injury to persons or damage to the coffee machine.
10. Indoor and household use only.
11. Do not let cord hang over edge of table or counter, or touch hot surfaces.
12. Do not place on or near a hot gas or electric burner, or in an oven.
13. Do not use the coffee machine for other than intended use.
14. To disconnect, remove plug from wall outlet. Always hold the plug but never pull the cord.
15. The coffee machine can be only operated on a flat, stable surface.
16. Connect the coffee machine to the power supply. Before inserting the single serve pods or ground filter pod ensure the water tank is filled with water not higher than the "MAX" mark.

17. When brewing coffee, to avoid personal injury from steam and hot water, do not open the water tank lid and keep all body parts away from the coffee machine.
18. This coffee machine is not intended for use by persons (including children) with reduced physical, sensory or mental capabilities, or lack of experience and knowledge, unless they have been given supervision or instruction concerning use of the coffee machine by a person responsible for their safety.
19. Children should be supervised to ensure that they do not play with the coffee machine.

NOTES ON THE CORD PLUG

This appliance has a polarized plug. To reduce the risk of electric shock, this plug is intended to fit into a polarized outlet only one way. If the plug does not fit fully into the outlet, reverse the plug. If it still does not fit, contact a qualified electrician. Do not attempt to modify the plug in any way.

CAUTION: STEAM

To avoid personal injury and product damage caused by steam and hot water, do not open the water tank during use or open the pod compartment. Keep hands away from the coffee machine whilst brewing coffee. Please make sure the program is finished before moving the coffee cup.

PROPER USE OF COFFEE MACHINE

Please use single serve pods or coffee powder.

To keep the coffee machine in good working condition, we recommend that the coffee machine should be descaled regularly.

Save these instructions.

BEFORE FIRST USE

Remove all packaging and stickers from the coffee machine. Check that all accessories are completely intact and the coffee machine is not damaged.

Clean the accessories with clean water and mild detergent. Allow each part to dry thoroughly before fitting them back into the coffee machine according to the “**CLEANING AND MAINTENANCE**” section.

INITIAL CLEANING CYCLE

1. Plug the coffee machine into a ground outlet.
2. Fill a 10oz mug with water. Lift open the water tank lid and pour into the water tank. Close the lid and place the mug on the drip grill.
3. Press the ON button. The LED will start to flash to indicate the brewing cycle has started. The hot water will automatically start dispensing after approximately 2 minutes. Once complete pour away this water.



Repeat this process one more time to ensure efficient cleaning.

The single serve coffee machine is now ready to brew coffee.

BREWING COFFEE - SINGLE SERVE POD

1. Plug the coffee machine into a ground outlet.

2. Fill a mug with the desired amount of water (6oz minimum, 14oz maximum). Lift open the water tank lid and pour into the water tank. Close the lid and place the mug on the drip grill.



3. Adjust the height of the nozzle for smaller and larger mugs by using the nozzle lever. Remove the drip grill to accommodate for a travel mug.



4. Lift the lid to open the pod compartment.

5. Place a single serve pod inside the pod holder and place inside the pod compartment.

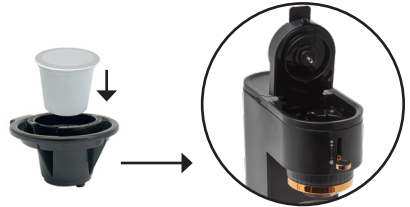

6. Close the lid, this will pierce the pod.

7. Press the ON button. The LED will start to flash to indicate the brewing cycle has started. Coffee will automatically start dispensing after approximately 2 minutes.



NOTE: The coffee machine will automatically go into standby mode once the brew cycle is complete.

CAUTION: There are sharp needles that puncture the pod above the pod holder and in the bottom of the pod holder. To avoid risk of injury, do not put your fingers in the pod holder.

BREWING COFFEE - GROUND COFFEE

1. Plug the coffee machine into a ground outlet.

2. Fill a mug with the desired amount of water (6oz minimum, 14oz maximum). Lift open the water tank lid and pour into the water tank. Close the lid and place the mug on the drip grill.



3. Adjust the height of the nozzle for smaller and larger mugs by using the nozzle lever. Remove the drip grill to accommodate for a travel mug.



4. Open the ground filter pod and fill with your favorite ground coffee. Flatten it down tightly and close.



5. Place the filled ground filter pod inside the compartment.

6. Close the lid.

7. Press the ON button. The LED will start to flash to indicate the brewing cycle has started. Coffee will automatically start dispensing after approximately 2 minutes.



Note: The coffee machine will automatically go into standby mode once brew cycle is complete.

CLEANING & MAINTENANCE

CAUTION: Be sure to unplug the coffee machine before cleaning. To protect against electrical shock, do not immerse cord, plug or unit in water or any other liquid. After each use, always make sure the plug is removed from wall outlet.

1. Clean the accessories with clean water and mild detergent after each use.

CAUTION: There is an exit needle in the base pod holder. To avoid risk of injury, do not put your fingers in the pod holder.

NOTE: This exit needle can become blocked. Carefully use a straightened paper clip to remove any coffee grounds during cleaning.

2. Wipe the exterior surface of unit with a soft, damp cloth to remove stains.
3. The drip grill can be removed for cleaning. Replace the drip grill after finishing cleaning.
4. After brewing coffee, it is recommended to clean the piercing needle to prevent coffee powder build up. This can affect the normal use of the coffee machine. To clean the needle, carefully insert a straightened paper clip into the hole, gently move it around to loosen any coffee grounds.
5. Close the lid and run a cleaning cycle (page 6). Do not insert any coffee pods or ground coffee during these cycles. Please be careful during cleaning to avoid any injury to hands.

DESCALING

To keep your coffee machine operating efficiently, we recommend descaling at least once a month (once a week for areas with hard water) to remove any mineral deposits.

1. Connect the coffee machine to a ground outlet.
2. Dissolve 20g citric acid in clean water and add the solution into the water tank to the maximum mark (14oz).
3. Remove the drip grill and place a mug (14oz) in the drip tank and then press the ON button.
4. Once the brewing cycle is completed, discard this water.
5. Run two or more cycles with clean water to flush the coffee machine thoroughly.
6. After descaling, the coffee machine is ready for use.

NOTE: Do not immerse the coffee machine in water.

TECHNICAL DETAILS

Model Code	HC03010-US
Rated Voltage	120V ~ 60HZ
Rated Power	1050W
Capacity	6 - 14oz (max)

TROUBLE SHOOTING

Problem	Cause	Solution
Water flows out of the funnel when filling the water tank with water.	The water amount exceeds the maximum level of the water tank.	The water in the water tank should be between the minimum and maximum level.
Water leakage is found at the bottom of the coffee machine.	There is too much waste water in the drip tray.	Empty the waste water in the drip tray.
	There is a malfunction in the coffee machine.	Contact the local service agent for maintenance.
Water leakage found from the lid when brewing coffee.	The coffee powder has not been flattened properly in the filter.	Remove the coffee powder filter and refill, ensuring the coffee powder is flattened tightly.
	The top lid has not been closed fully in position.	Close the top lid well in position.
Acid (vinegar) taste exists in espresso coffee.	The appliance has not been cleaned correctly.	Clean the coffee machine according to the section of "BEFORE FIRST USE".
	The coffee powder has been incorrectly stored and spoiled.	Please use fresh coffee powder, or store unused coffee powder in a cool, dry place.
Coffee grounds found in the coffee.	Coffee machine needs cleaning	Please refer to "CLEANING & MAINTENANCE"
After pressing the ON button, the LED changes from slow to rapid flashing and no water dispensed	The water tank is not filled with water.	Ensure the minimum amount of water 6oz is placed in the tank before use.

TROUBLE SHOOTING

Problem	Cause	Solution
The coffee machine does not work.	The power outlet is not plugged in.	Plug the power plug into a wall outlet correctly, if the coffee machine still does not work, please contact Customer Services.
	Not enough water in the coffee machine.	Ensure the minimum amount of water 6oz is placed in the tank before use.
	The top lid has not been closed properly in position.	Close the top lid properly.
After pressing the ON button, the LED rapidly flashes and no	The water tank is not filled with water.	Ensure the minimum amount of water 6oz is placed in the tank before use.
The coffee machine does not dispense water or little water is dispensed.	There is water still in the water tank from previous brew.	Place a mug on the drip tray and turn on the coffee machine. Allow the tank to completely drain. Discard contents and refill the water tank.
	The piercing needle is blocked by coffee powder.	Please refer to "CLEANING & MAINTENANCE"
	There is limescale found in the water tank.	Please refer to "DESCALING"
	The coffee machine is malfunctioned.	Please contact Customer Services.

This coffee machine has no serviceable parts, Do not disassemble.

LIMITED WARRANTY

This warranty applies to products purchased and used in the U.S. and Canada. This is the only express warranty for this product and is in lieu of any other warranty or condition. This product is warranted to be free from defects in material and workmanship for a period of one (1) years from the date of original purchase in Canada and one (1) year from the date of original purchase in the U.S. During this period, your exclusive remedy is repair or replacement of this product or any component found to be defective, at our option; however, you are responsible for all costs associated with returning the product to us and our returning a product or component under this warranty to you. If the product or component is no longer available, we will replace with a similar one of equal or greater value. This warranty does not cover glass, filters, wear from normal use, use not in conformity with the printed directions, or damage to the product resulting from accident, alteration, abuse, or misuse.

This warranty extends only to the original consumer purchaser or gift recipient. Keep the original sales receipt, as proof of purchase is required to make a warranty claim. This warranty is void if the product is used for other than single-family household use or subjected to any voltage and waveform other than as specified on the rating label (e.g., 120V ~ 60 Hz). We exclude all claims for special, incidental, and consequential damages caused by breach of express or implied warranty. All liability is limited to the amount of the purchase price. Every implied warranty, including any statutory warranty or condition of merchantability or fitness for a particular purpose, is disclaimed except to the extent prohibited by law, in which case such warranty or condition is limited to the duration of this written warranty. This warranty gives you specific legal rights. You may have other legal rights that vary depending on where you live. Some states or provinces do not allow limitations on implied warranties or special, incidental, or consequential damages, so the foregoing limitations may not apply to you.



HADEN

ESTD. ENGLAND 1958