

# TOTAL WORKING VOLUME = 1740 Litres

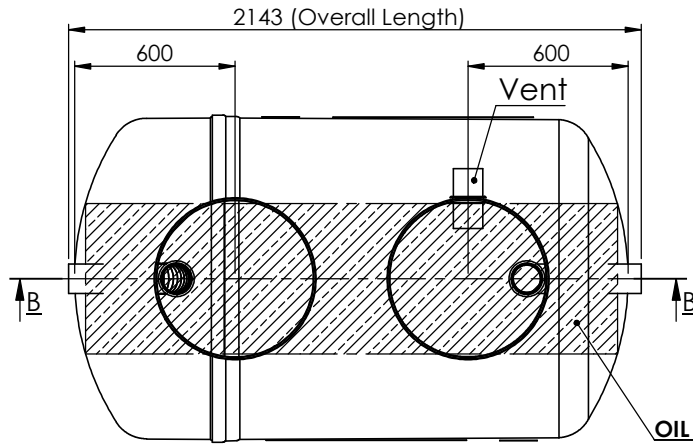

**OIL / GREASE SEPARATION AREA = 1.8m<sup>2</sup>**

Product	Size
NSG	04

Inlet Invert	
ww	Invert
05	0.5m Invert
10	1.0m Invert
15	1.5m Invert

Pipework Orientation	
x	Orientation
A	Refer To TDS0033
B	
C	
D	
E	
F	
G	
H	
K	

- Notes:-
1. Inlet Invert To Be Confirmed By Customer.
  2. Pipework Orientation (A, B, C etc.) Dependant On Site Pipework Layout. To Be Specified At Order Stage.
  3. Standard Minimum Pipework Size Is Ø110mm.
  4. If Required, Extensions Will Be Supplied Loose To Be Fitted On-Site Using Silicon Sealant (Supplied By Others).
  5. Tanks Can Be Installed In Either Granular Or Concrete Backfill - Please See Manual For Details.

Standard Connections Sizes	
y	Connection (Ø)
A	Ø110
C	Ø160

z	Branding
B	Clearwater

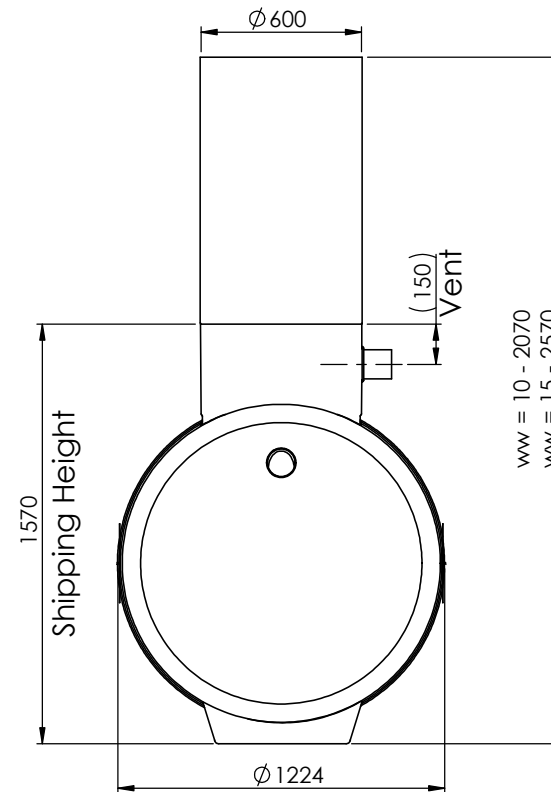
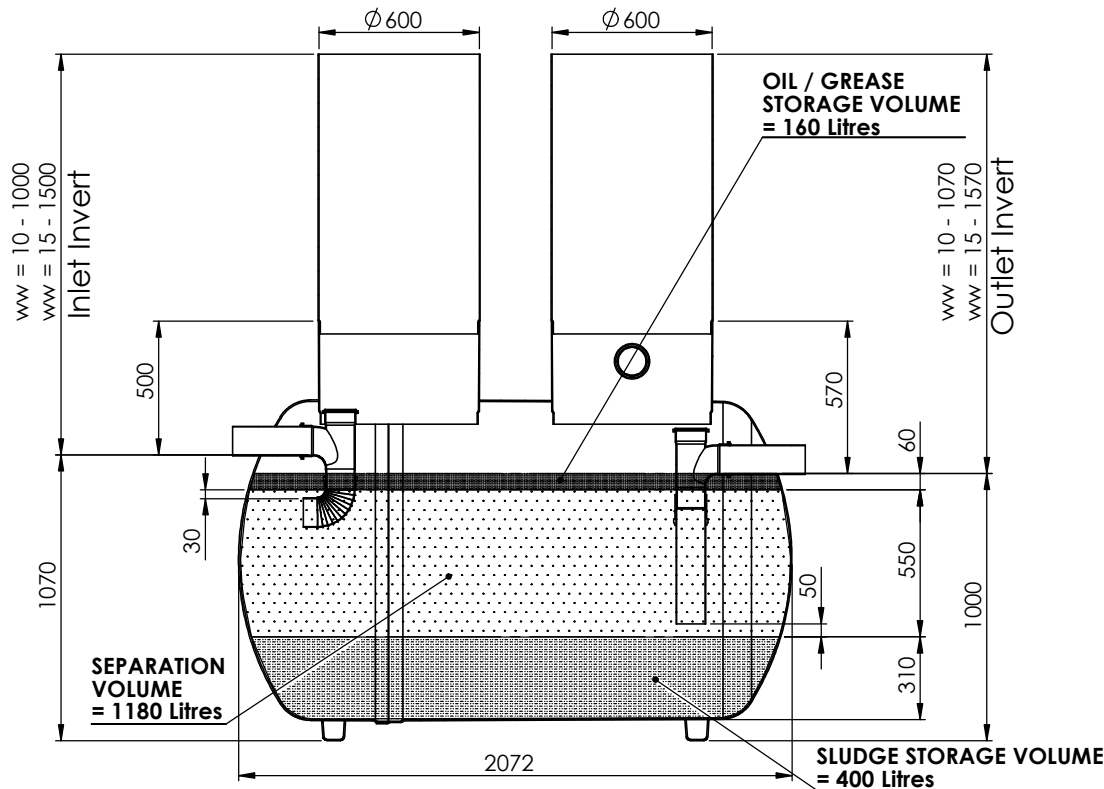

Please Check with Environmental Treatment Systems Limited For The Latest Issue Of This Drawing			
Issue	Date	Drawn by	Approved by
03	11/02/16	L.Steward	
02	04/09/15	L.Steward	

Material : Various	Tolerance :
Finish :	Thickness : n/a
Weight : 96.61 Kg Kgs	Surface Area :

<b>Drawing : DS1269B</b>	Page 1 of 1
Ø1.2m NSG04 Grease Separator - 2000L	

All dimensions in mm	Scale: Not to scale
----------------------	---------------------

Clearwater reserve the right to alter the details of this drawing without prior notice. This drawing is copyright and may not be reproduced or used without the written permission of Clearwater.



T:\Drawing Data\02 - Sales Drawings\DS\DS - 12\DS1269B