

WORM DRIVE & SCREW CLAMPS

MIKALOR



Worm Drive Hose Clamp – 9mm – Mikalor

Mikalor's patented ASFA-L premium Worm Drive hose clamps are manufactured in Spain in accordance with DIN3017. Their innovative housing is designed for high strength whilst remaining compact. The cold-formed stamped band is smooth on the underside and bevelled at the edges, protecting the hose from damage. Mikalor's Worm Drive Hose Clips are manufactured to the highest quality from Stainless Steel material.

Applications

W2

- Agricultural
- Automotive
- Fluid Transfer
- Hardware
- White Goods

W4 / W5

- Food Processing
- Marine Industry
- Petrochemical Industry

Materials – see section 7.2

- **W2** Screw – Zinc Plated Steel
Band & Housing – 430 SS
- **W4** 304 SS
- **W5** 316 SS

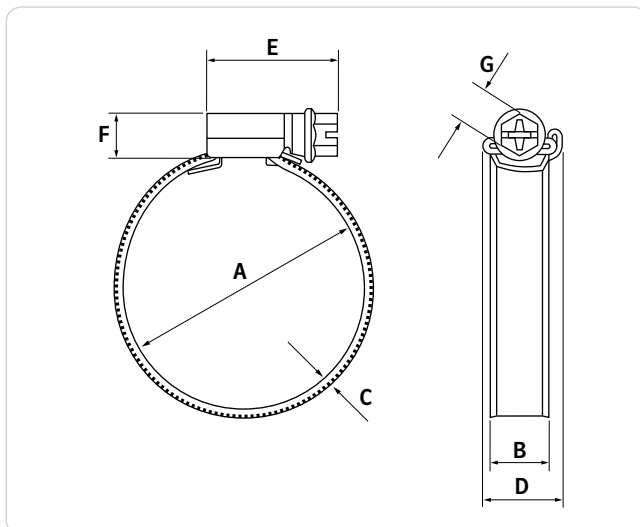

HCL Part No	Diameter Range (A) mm	Band Width (B) mm	Band Thickness (C) mm	Max Width (D) mm	Head Length (E) mm	Head Height (F) mm	Hex Screw A/F (G) mm	Max Torque Nm	Box Quantity
WD-9-DIN-8	8 – 16	9.0	0.6	14.0	22.1	10.0	7.0	3.0	200
WD-9-DIN-12	12 – 22								
WD-9-DIN-16	16 – 27								
WD-9-DIN-20	20 – 32								
WD-9-DIN-25	25 – 40		25.6						
WD-9-DIN-30	30 – 45								
WD-9-DIN-32	32 – 50		0.7		29.6			4.0	100
WD-9-DIN-40	40 – 60								
WD-9-DIN-50	50 – 70								
WD-9-DIN-60	60 – 80								
WD-9-DIN-70	70 – 90	29.6		50					
WD-9-DIN-80	80 – 100								
WD-9-DIN-90	90 – 110	25							
WD-9-DIN-100	100 – 120								
WD-9-DIN-110	110 – 130								
WD-9-DIN-120	120 – 140								
WD-9-DIN-130	130 – 150								
WD-9-DIN-140	140 – 160								

All weights, dimensions & quantities are subject to a 2.5% tolerance. To add material selection to the HCL Part No: for W2, add "W2".

Installation Tools



MT-D-01



MT-TD-01