

INSTALLATION AND SETUP GUIDE

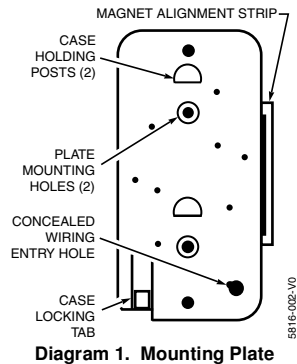

Diagram 1. Mounting Plate

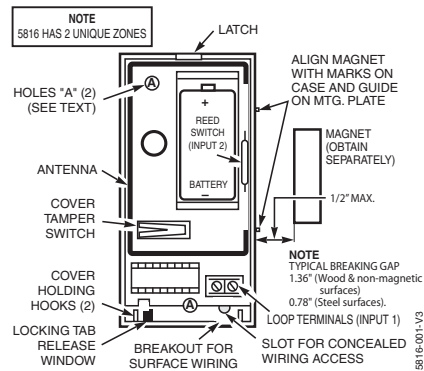

Diagram 2. Transmitter, Cover Removed

GENERAL INFORMATION

The 5816 Door/Window Transmitter has its own unique serial number permanently assigned during manufacture. You must "enroll" the transmitter serial number in the control prior to its usage in the system. Refer to the control unit's installation instructions for further details. **Note:** During programming of the control unit, 5816 transmitters shall be treated as "RF" (i.e., supervised RF) Type (mandatory for UL installations).

The 5816 has two unique zones; the first is for a wired closed circuit contact loop and the second for its built-in reed switch (used in conjunction with a magnet as described below). Either or both zones may be used. *For UL installations, a contact may not be more than 3 feet from the transmitter.*

A built-in cover tamper switch is activated when the cover is removed.

INSTALLATION

Mounting

For proper orientation of the unit in relation to the mounting plate, loop wiring, and/or magnet, read all of this section before installing the unit.

The description that follows assumes that the unit will be mounted as shown in the diagrams, with the magnet (if used) located to the unit's right. The unit may, however, be installed in any direction, as long as the relationship of the unit to its mounting plate and (if used) magnet is maintained.

Although two holes are provided in the unit that would permit mounting directly to a surface (holes 'A' in Diagram 2) it is recommended that the mounting plate be used, for ease in removing the unit for servicing should it become necessary.

Before mounting the transmitter permanently, conduct Go/No Go tests (see control's instructions) to verify adequate signal strength and reorient or relocate the transmitter if necessary.

1. **Remove the transmitter's cover** using the finger latch.
2. **Disengage the supplied mounting plate from the unit** by releasing the locking tab while sliding the plate downward along the case back.
3. **If a wired contact loop is to be used with concealed wiring**, feed the wires through the concealed wiring entry hole at one corner of the mounting plate.
For surface wiring entry, a thin "breakout" area is provided in the case wall. Wiring can be run through this "breakout" in the case when attaching the case in step 5.
4. **Install the mounting plate**, with its case holding posts pointing up (in this example), in the location selected as described in the control unit's installation instructions. Use the flat head screws supplied.
5. **Attach the case back to the mounting plate** by sliding the keyhole slots in the case back down onto the mounting plate's case holding posts. The locking tab will click as the case back locks in place.
6. **If the unit's reed switch is to be used**, mount a No. 5899 Magnet (or equivalent; obtain separately) adjacent to the alignment marks on the case and the mounting plate's alignment strip at maximum 1/2 inch separation distance (see Diagram 2).

Note:

For wood & non-magnetic surfaces, the typical breaking gap is **1.36 inches**.
For steel and other magnetic surfaces, the typical breaking gap is **0.78 inches**.

Wiring Connections

With the battery still not inserted, connect the contact loop (if used) to the unit's loop terminals (see diagram). *The contact loop must use closed circuit devices.* The loop response time is a nominal 100mSec.

Note: *If the contact loop is not to be used, no connection is needed across its terminals.*

BATTERY INSTALLATION/REPLACEMENT

1. **Remove the transmitter's cover** (if it is not already off) as described in *Mounting Step 1*.
2. **Observe correct polarity and insert the battery** provided into the battery holder (see Diagram 2). *Take care not to bend the antenna.*

Note: Replace battery *only* with:

Panasonic CR123A, Duracell DL123A,
ADEMCO 466 or HUIDERUI CR123A.

3. **To replace the cover**, engage the hooks along one edge and snap shut.

FEDERAL COMMUNICATIONS COMMISSION STATEMENTS: The user shall not make any changes or modifications to the equipment unless authorized by the Installation Instructions or User's Manual. Unauthorized changes or modifications could void the user's authority to operate the equipment.

FCC/IC NOTICE: This device complies with Part 15 of the FCC Rules, and RSS-210 of IC. Operation is subject to the following two conditions: (1) This device may not cause harmful interference (2) This device must accept any interference received, including interference that may cause undesired operation.

Cet appareil est conforme à la partie 15 des règles de la FCC & de RSS-210 des Industries Canada. Son fonctionnement est soumis aux conditions suivantes: (1) Cet appareil ne doit pas causer d'interférences nuisibles. (2) Cet appareil doit accepter toute interférence reçue y compris les interférences causant une réception indésirable.

TO THE INSTALLER: Regular maintenance and inspection (at least annually) by the installer and frequent testing by the user are vital to continuous satisfactory operation of any alarm system. The installer should assume the responsibility of developing and offering a regular maintenance program to the user, as well as acquainting the user with the proper operation and limitations of the alarm system and its component parts. Recommendations must be included for a specific program of frequent testing (at least weekly) to insure the system's operation at all times.

REFER TO THE INSTALLATION INSTRUCTIONS FOR THE CONTROL WITH WHICH THIS DEVICE IS USED, FOR DETAILS REGARDING LIMITATIONS OF THE ENTIRE ALARM SYSTEM.

SUPPORT & WARRANTY

For the latest documentation and online support information, please go to: <https://mywebtech.honeywell.com/>

For the latest warranty information, please go to: www.honeywell.com/security/hsc/resources/wa.

For patent information, see www.honeywell.com/patents



MyWebTech



Warranty



Patents

SPECIFICATIONS

Dimensions: 1-9/16"W x 3-1/16"H x 1-3/16"D
(40mm x 78mm x 30mm)

Battery: 3V Lithium (see Note in step 2 of *BATTERY INSTALLATION/REPLACEMENT*)

BATTERY CAUTION: Risk of fire, explosion and burns. Do not recharge, disassemble, heat above 212 F (100 C) or incinerate. Dispose of used batteries promptly. Keep away from children.

Note: Constant exposure to high or low temperature or high humidity may reduce battery life.



N6482V2 4/98 Rev. E

Honeywell

2 Corporate Center Drive, Suite 100
P.O. Box 9040, Melville, NY 11747
Copyright © 2008 Honeywell International Inc.

www.honeywell.com/security