

Floor Faucet

Installation instructions

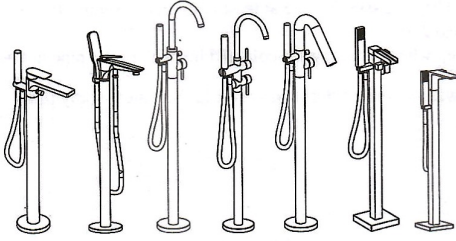

Floor faucet packing list:

Please refer to the list of standard accessories after unpacking. Check whether it is complete; if there is any defect, please contact your local dealer immediately. The content as follows:

No.	Item	Pc
1	Main Body	1
2	Escutcheon	1
3	Triangular flange	1
A	hand shower	1
C	shower hose	2
C	embedded box	1
7	Glove	1
8	hex wrench	1
0	instructions	1

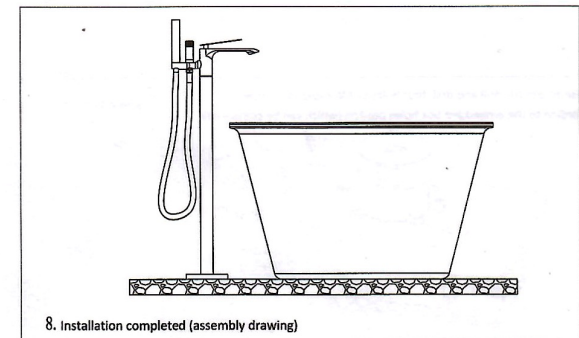
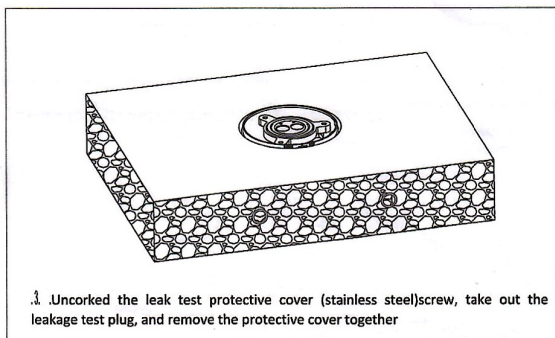
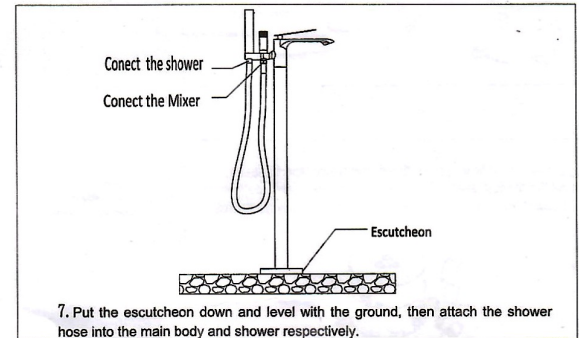
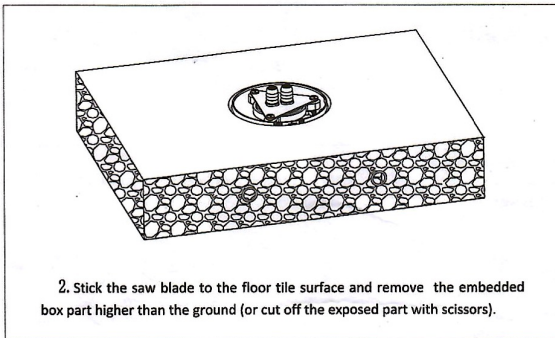
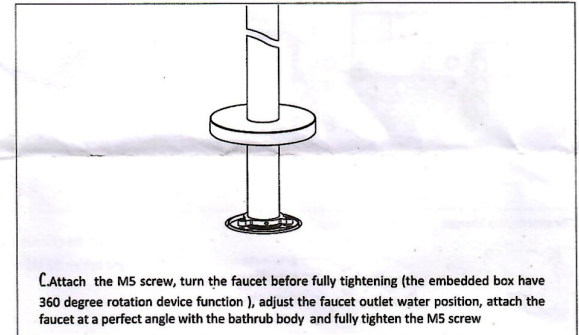
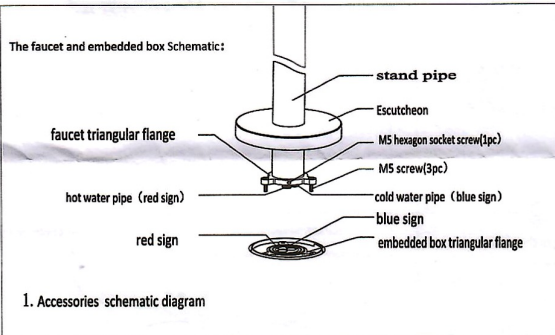
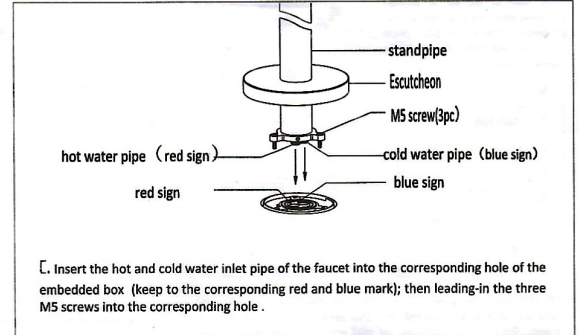
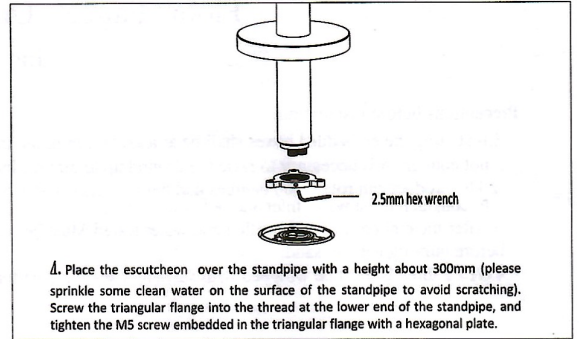
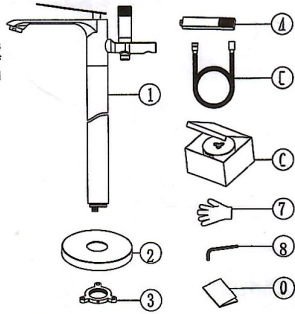

Floor Faucet Universal Embedded Box

Installation Instructions

Precautions before installation:

1. Installing the embedded boxes shall be at least 50mm in the thickness of the ground, The hole size shall be at least more than 230mm, If it is not enough, it is necessary to raise the ground up to 50mm; Increase the hole size up to 230mm;
2. The product can rotate 360 degrees and has universal water outlet function, Therefore, when installing the cold and hot water inlet pipe not need to considered the water inlet and outlet direction;
3. After the embedded box installed and water tested, Must be completely cleaned and washed out the dust and gravel in the water supply pipe before burying cement sand;
4. G1 / 2 threads must be wrapped with sufficient sealing tape for sealing.

The Embedded box packing list:

Please refer to the list of standard accessories after unpacking. Check whether it is complete; if there is any defect, please contact your local dealer immediately. The content as follows:

No.	Item	PC
1	Main body	1
2	Accessories	7
3	Instructions	1
4	Drain hose	1

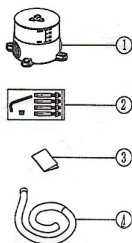

5. Install the M6 explosion screw into the four holes respectively.

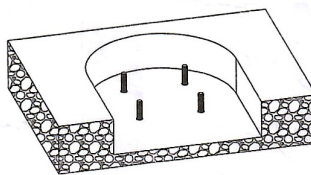

10. Prepare a plastic bucket, insert the transparent rubber hose into the top of the leak test plastic plug, open the corresponding water inlet valve in turn, and discharge the gravel and soil left in the pipeline respectively.

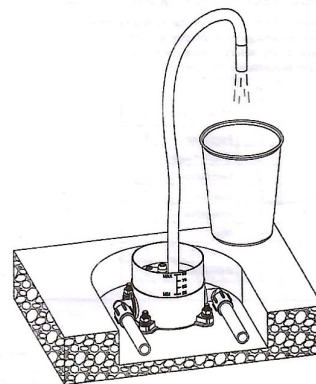

1. Before installation, the groove of embedded box and water inlet pipe shall be opened according to the required size: This product is universal inlet and outlet water, donnot need to consider the inlet and outlet water position. Just install it according to the red and blue sign (cold and hot sign) and reserve the distance from the bathtub body.

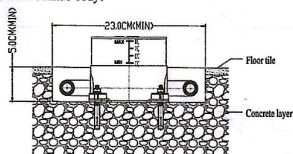

6. The G1 / 2 thread shall be wrapped with sufficient sealing tape for sealing. Tighten the water inlet pipe according to the red and blue (cold and hot) sign position. Put the embedded box into the M6 explosion screw.

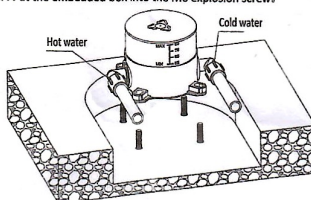

2. The embedded box schematic

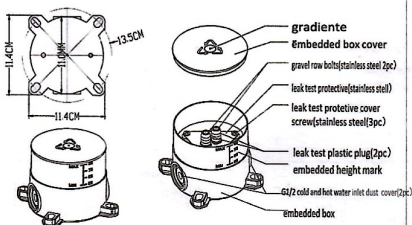

7. Adjust the embedded box is horizontal according to the gradient, and tighten the M6 nuts respectively after adjustment.

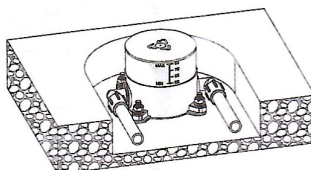

11. Use M5 hexagon wrench to Screw back 2 rows gravel bolts of the pressure and leakage test plastic plug.

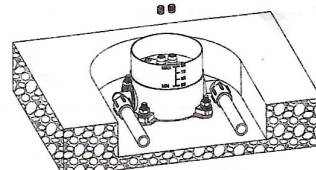

3. G1 / 2 threads must be wrapped with sufficient sealing tape for sealing; Screw out the the dust cover of G1 / 2 cold and hot water inlet, and attach the G1 / 2 elbow of cold and hot water inlet into the embedded box respectively.



8. Remove the embedded box cover, open the hot and cold water inlet valve to check it is water leakage. If it is leakage, it shall be repaired immediately, after confirming it is no leakage and continue the next installation; Close the hot and cold water valves after the test.

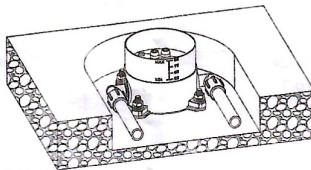

12. Cover the Embedded box to prevent sand entering.

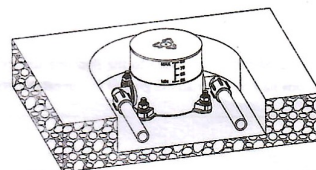

4. Use an electric drill and drill four holes of M6 explosion screw according to the embedded box holes position (which can be compared)

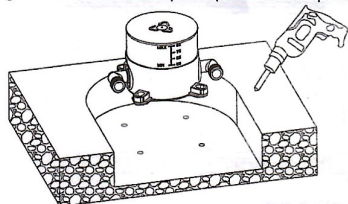

9. Screw out 2 rows of gravel bolts in the leakage test plastic plug with 5mm hexagonal wrench.

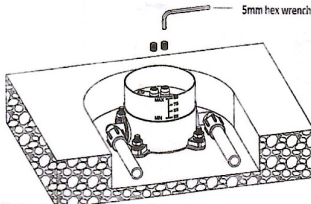

13. Backfiring sand, cement and paving floor tiles; Wait for the next installation

