

❖ Power / water pipe - layout

Before installation, well plan the pipe groove in the required position for the product according to the actual installation location of the wall and ceiling.

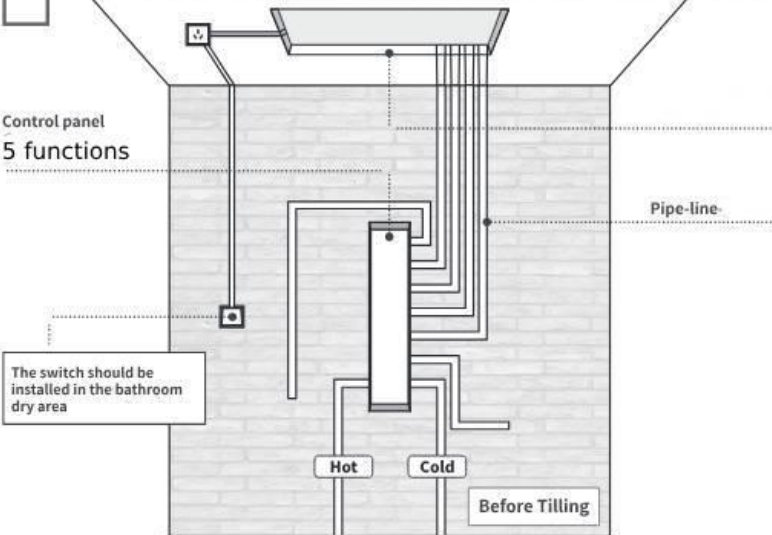

( The following grooves are for reference only, and the actual location depends on individual

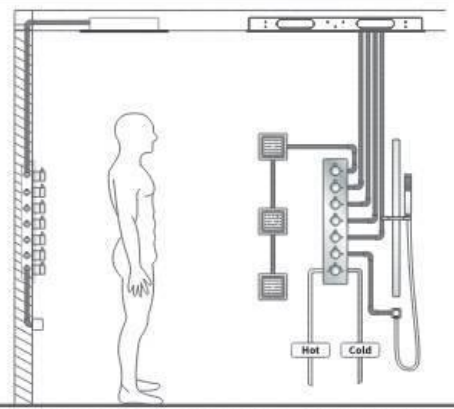

Schematic diagram of waterway installation

❖ Power / water pipe - layout

Before installation, well plan the pipe groove in the required position for the product according to the actual installation location of the wall and ceiling.

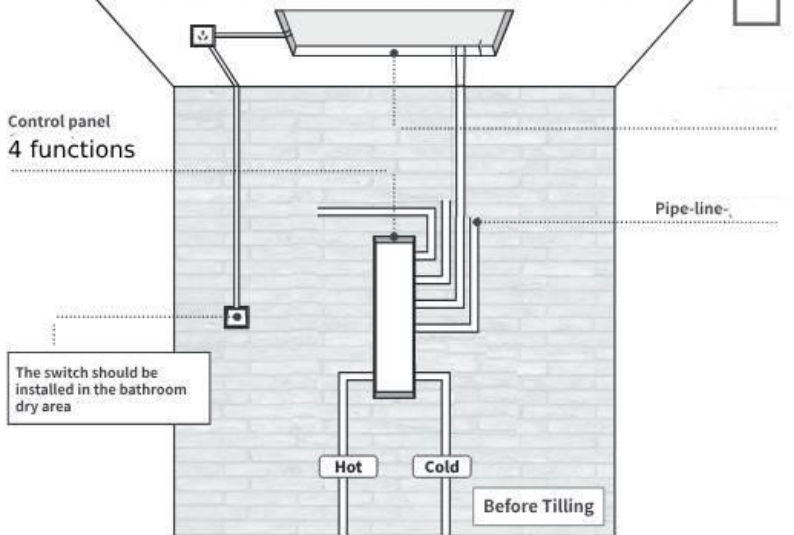

( The following grooves are for reference only, and the actual location depends on individual

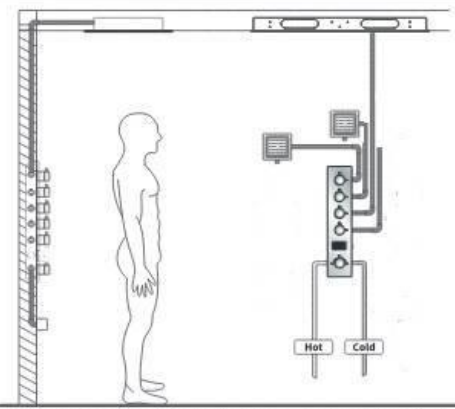

Schematic diagram of waterway installation

➤ **Power / water pipe - layout**

Before installation, well plan the pipe groove in the required position for the product

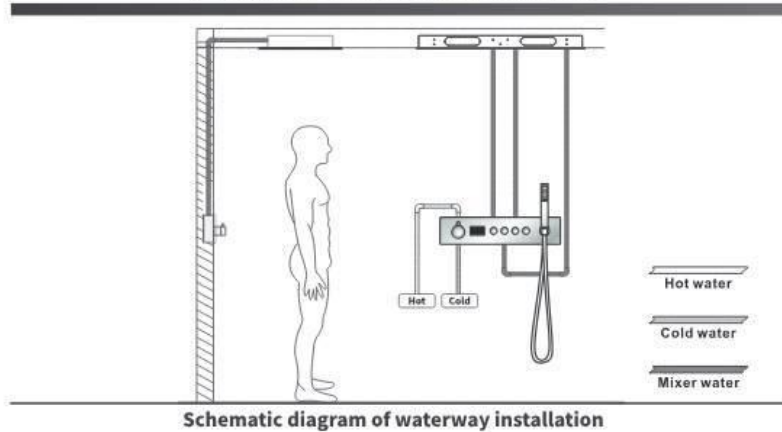
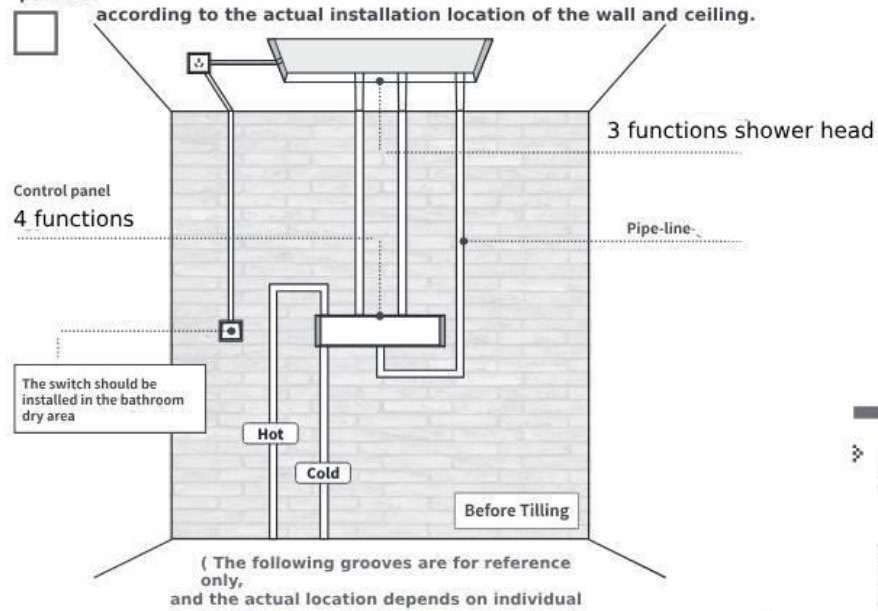

➤ **Luxury LED Shower spare parts Exterior Dimensions**

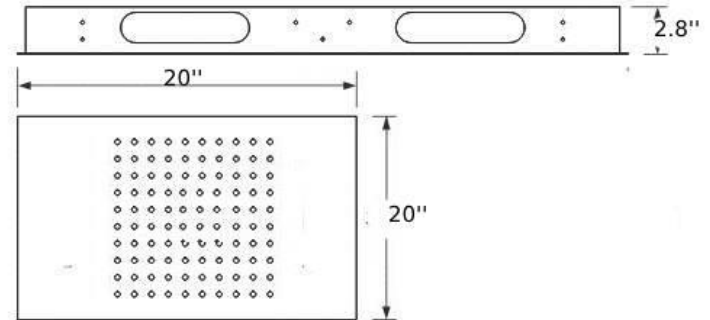

➤ **Luxury LED Shower spare parts Identification chart**

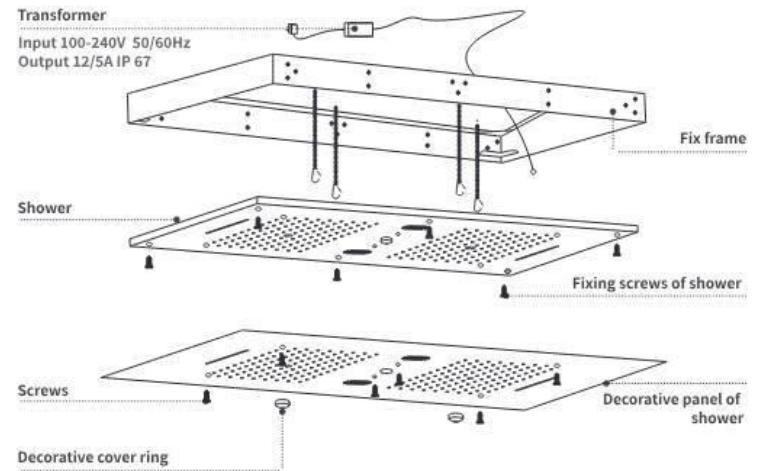

➤ **Luxury LED Shower spare parts method**

**1** Power / water pipe - layout

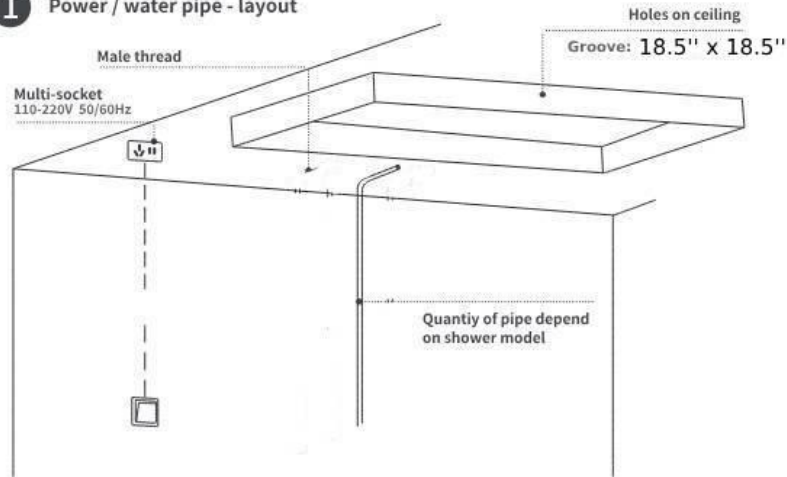

**2** Shower head installation fixed frame

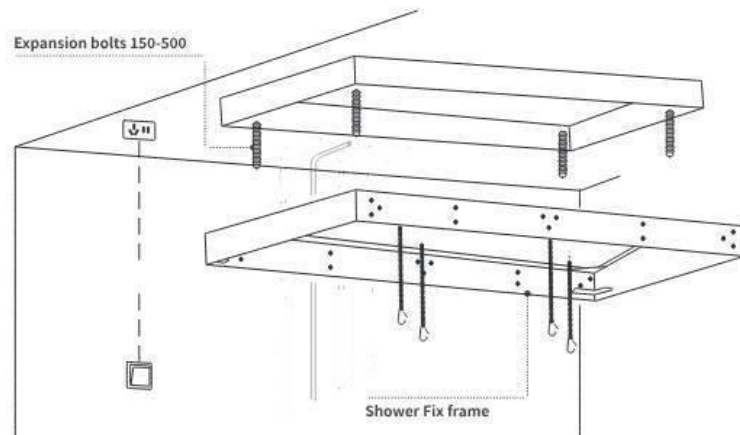

➤ **Luxury LED Shower spare parts installation instruction**

**3** layout for power / water pipe

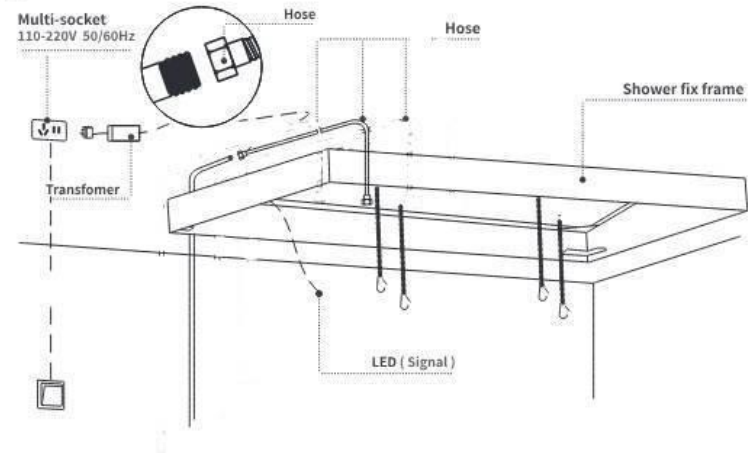

**4** Install Shower

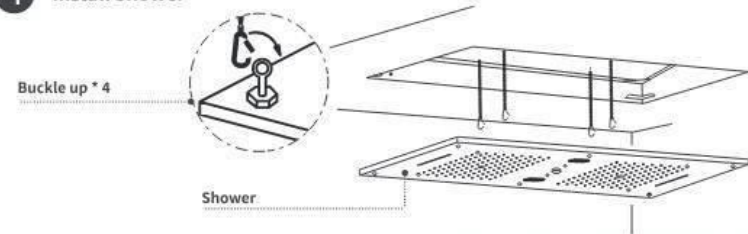

**5** Connect the water inlet pipe

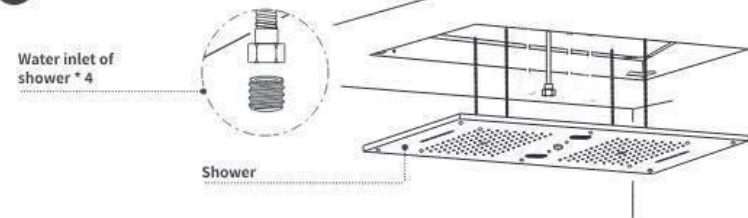

❖ **Luxury LED Shower spare parts installation instruction**

**6** Connect LED (signal line)

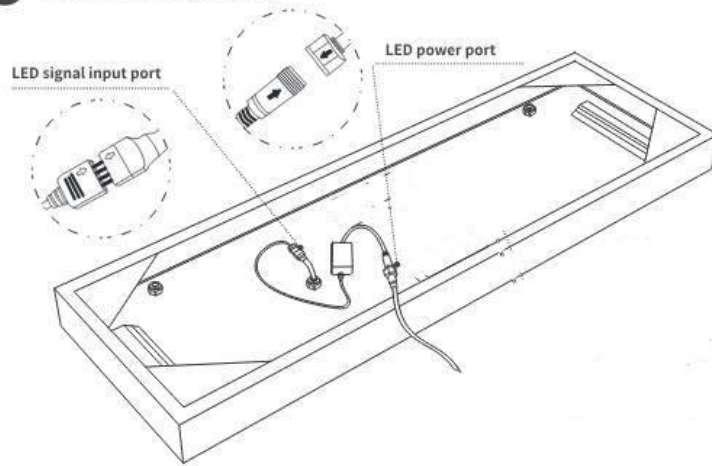

**7** Shower installation

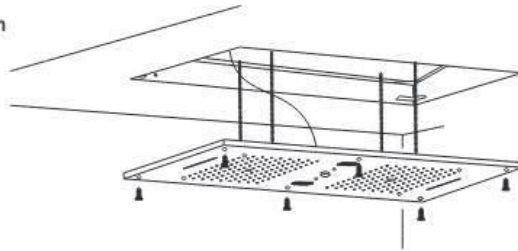

**8** Fix the decorative panel of shower

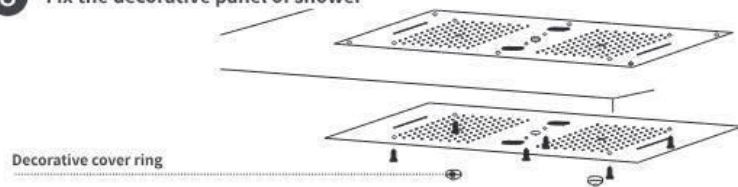

❖ **Installation method**

**9-1** 6 Function thermostatic control shower valve

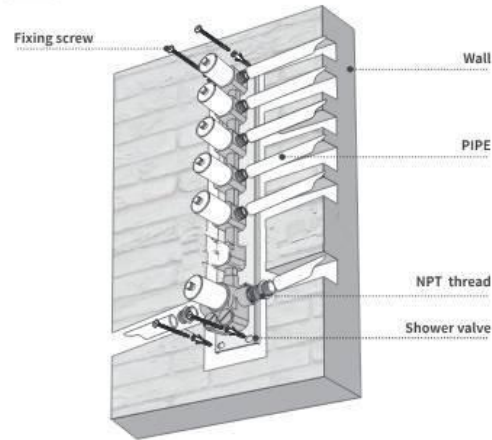

**Before Tiling**

Please grooved and install the shower valve according to the size drawing, the depth of



After the installation is complete, turn on the water source and try to see if the water is

**10-1** 6 Function thermostatic control shower valve

Install the handles

**After Tiling**

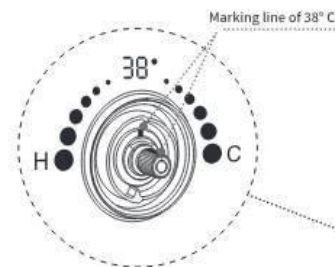

Thermostatic handle installation: Remove the handle and check whether the 38° C line of the thermostatic valve core is aligned as bellow picture. (This is the marking line for testing the water temperature of 38° C.)

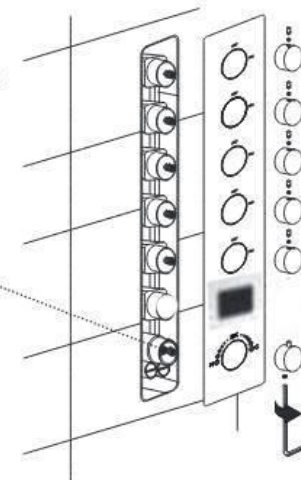



Installation method



9-2

4 Function thermostatic control shower valve

Before Tiling

Fixing screw

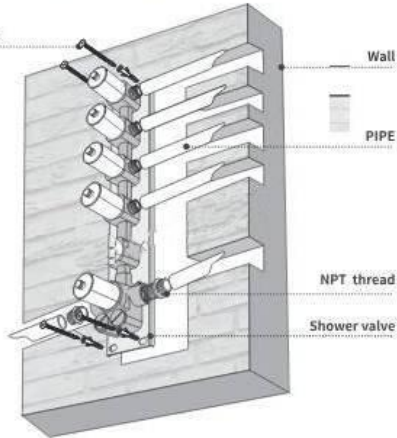

Please grooved and install the shower valve according to the size drawing, the depth of



After the installation is complete, turn on the water source and try to see if the water is

Installation method



9-3

4 Function thermostatic control shower valve

Before Tiling

Wall

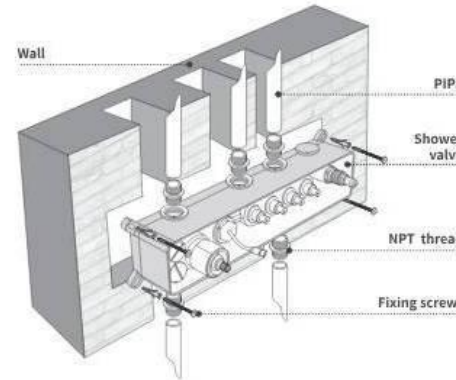

Please grooved and install the shower valve according to the size drawing, the depth of the groove is about 77-85mm

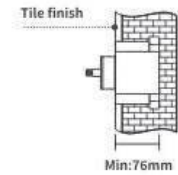

After the installation is complete, turn on the water source and try to see if the water is

10-2

5 Function thermostatic control shower valve

Install the handles

After Tiling

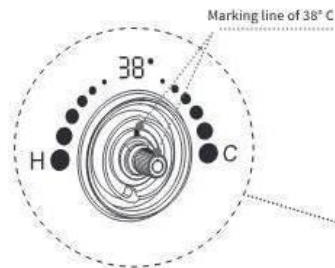

Thermostatic handle installation: Remove the handle and check whether the 38° C line of the thermostatic valve core is aligned as bellow picture. (This is the marking line for testing the water temperature of 38° C.)

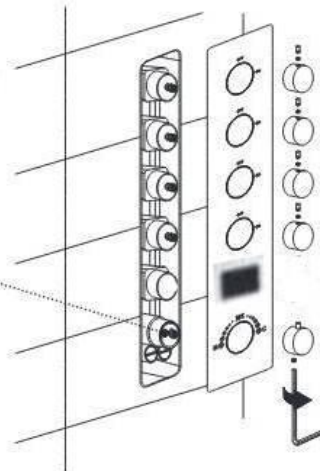

10-3

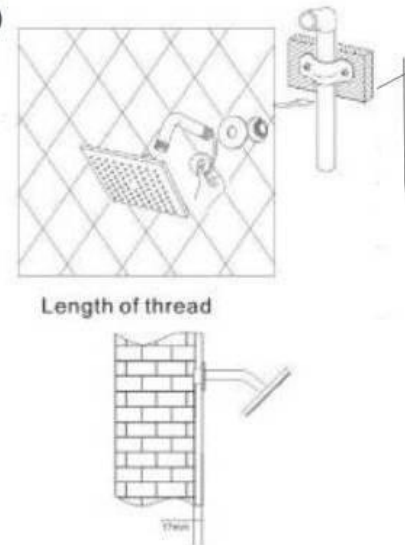

### Installation method

#### 11 Body jets \* 3

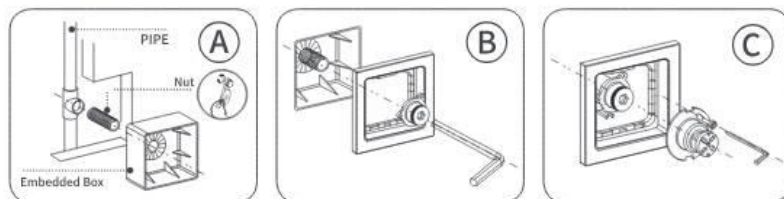

##### Before Tiling

1. Please groove 110\*100mm according to the embedded box size.
2. Wrap with the appropriate raw material and connect to the water inlet pipe.
3. Put the embedded box to the groove and fix the crews from back side.

##### After Tiling

1. Install the cover.
2. Fix the screws by using H10 hexagonal screw.

##### After Tiling

1. Line up the Card slot and the outside double-steel-bars and then push in completely.
2. Using the M4\*20 hexagon-socket screw to tighten the component and the connector. Make sure the cover component is not loose.

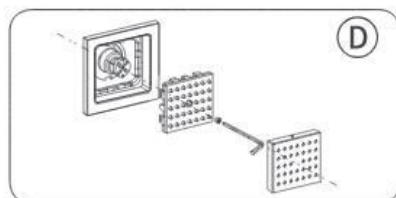

##### After Tiling

1. Install the components, make sure the 'components' steel-bars clip into the main body 'component's card slot. Then using the M4\*12 hexagon socket screw to tighten them. Pay attention to prevent deformation of the cover when you tighten them.
2. Install the cover.

#### 12 Water outlet connector

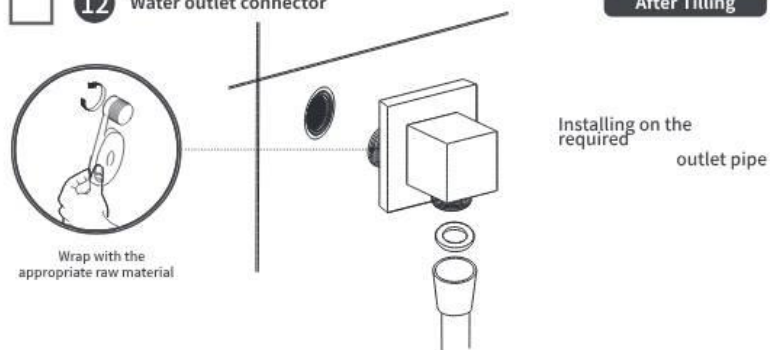

##### After Tiling

### Installation method

#### 13 Sliding Bra

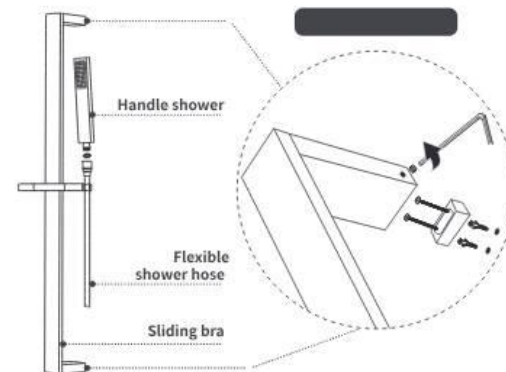

### USER MANUAL

Main parameter:  
 Panel controller:  
 Working Temp.: -20~60  
 Supply Voltage: DC12-24V  
 Size: L50\*W35\*H23mm  
 Output: 3Channel  
 Output Current: <2A(each channel)  
 Connection mode: common anode

Touch Remote:  
 Working voltage: 1.5V\*3V  
 Emission current: 10mA  
 Working Current: 300uA  
 Standby Current: 3uA  
 Standby time: 6 mouths  
 Control distance: 20M  
 Color pulley point: 60

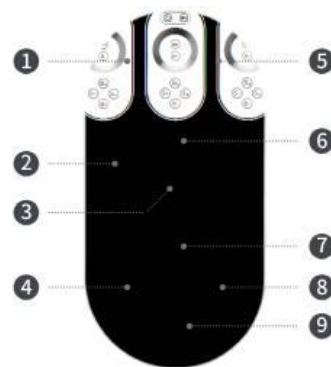

1. Turn ON/OFF
2. Color Touch Ring
- 3/6. Color Temperature adjusting
- 4/8. Dynamic Speed adjusting
5. Mode Switch
- 7/9. Dynamic Brightness adjusting