

nanobébé

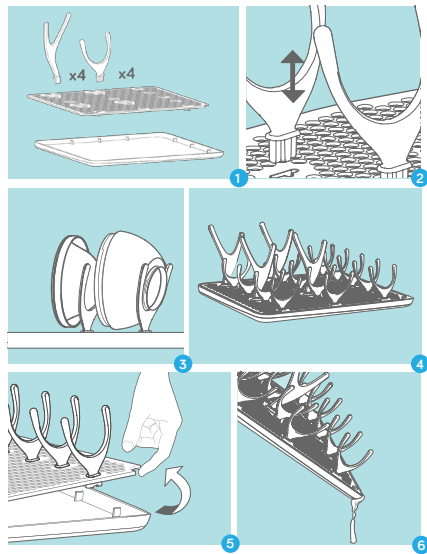

nanobébé

Please ensure that you read the entire instruction manual carefully prior to first use and retain it for future reference.

CAUTION!
THIS IS NOT A TOY.
KEEP OUT OF REACH OF CHILDREN.

CONTENTS

Top tray
Bottom tray
4 x long pegs
4 x short pegs



nanobébé



More from nanobébé

Bottle Cooler & Travel Pack
Multi-layered insulated baby bottle cooler.
Safely store and transport breast milk for on-the-go parents!

Flexy Pacifier/Soother
Extra-soft nipple/teat
Lightweight & ergonomic

Breastmilk Bags and Organizer
Fast thawing for optimal nutrient preservation

Smart Warming Bowl
Quick & even warming
Optimal for breastmilk

Compact Drying Rack
Fast, hygienic drying
Stores flat

Breastmilk Bottle
Designed to preserve breastmilk nutrients

Made in Israel for
Nutriits Ltd.
P.O. Box 7239
Tel Aviv, Israel 6107121
G20-00044-19-1

Customer service:
nanobebe.com

nanobébé

How to Use Your Drying Rack

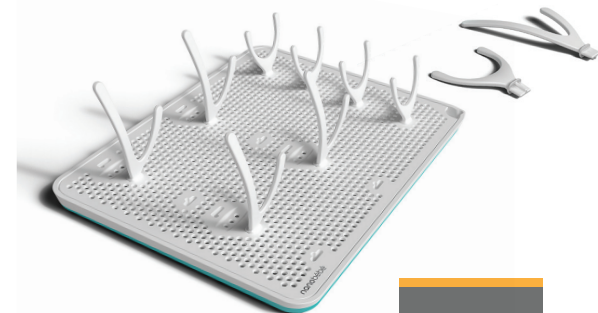

User manual

STORES
FLAT

nanobébé

Designed for fast and hygienic drying, our compact drying rack is both practical and beautiful. Two peg heights accommodate all bottle and accessory sizes. Peg arrangement is adjustable to suit your drying needs. Its detachable drip tray collects excess water, which can be easily poured into the sink. And when drying is done, it can be folded and stored flat.

- Folds to just one inch and stores flat
- Adjustable peg arrangement
- Open design for fast, hygienic drying
- Two peg heights accommodate all bottle and accessory sizes
- Detachable drip tray collects excess water
- BPA free



nanobébé

BEFORE FIRST USE

- Clean the product by immersing all parts in freshly boiled water for 5 minutes.
- Ensure parts are completely dry before assembly.

ASSEMBLY

- Always wash hands before handling the parts.
- Insert long and short pegs into designated slots, as shown in diagram 2. To make room for larger items, use fewer short pegs.

HOW TO FILL

- After washing, pour any excess water contained in the bottles or nipples/teats down the sink.
- To dry nanobébé bottles, disassemble the bottles and hang parts on or between pegs, as shown in diagram 3.
- Hang Pacifiers/Soothers, breast pump adapters and other accessories on pegs.

nanobébé

HOW TO EMPTY BOTTOM TRAY

- Always wash hands before handling the parts.
- Detach the top tray from the bottom tray by inserting your finger into the designated area in the corner of the drying rack and lifting the top tray, as shown in diagram 5.
- Tilt the bottom tray and pour water down the sink through the lip at the corner, as shown in diagram 6.

HOW TO TRAVEL WITH THE DRYING RACK

- Remove all pegs from the tray. Pull pegs forcefully to remove.
- Store all pegs between the top and bottom trays.
- Clean all parts and reassemble before using again.

CLEANING

- Always wash and rinse thoroughly before and after use to ensure hygiene.
- Disassemble completely before cleaning.
- Wash in hot soapy water, rinse in clean water, and let dry or place in the top rack of a dishwasher.

nanobébé

- Do not boil or steam.
- Do not use bleach or any other harsh chemicals.

STORAGE

- Ensure all parts are dry before storing.
- For flat storage, remove all pegs from the top tray and store them between the top and bottom trays.
- Store in a dry place.

